

DRAFT AIA Document G701™ - 2001

Change Order

PROJECT (Name and address):

Radcliff Elementary School Renovation
- Phase 3
1145 S. Dixie Boulevard
Radcliff, Kentucky 40160

CHANGE ORDER NUMBER: 001**DATE:** April 21, 2011**TO CONTRACTOR (Name and address):**

Morel Construction Co., Inc.
627 West Main Street
Louisville, Kentucky 40202

ARCHITECT'S PROJECT NUMBER: 1004**CONTRACT DATE:** January 10, 2011**CONTRACT FOR:** General ConstructionOWNER: ☒ARCHITECT: ☒CONTRACTOR: ☒FIELD: ☒OTHER: ☐**THE CONTRACT IS CHANGED AS FOLLOWS:**

(Include, where applicable, any undisputed amount attributable to previously executed Construction Change Directives)

Contractor shall omit culvert pipe, two headwalls and all associated labor and materials, and revise grades to create a shallow swale across the pavement to divert stormwater to the ditch on the north side of the Wilson Road entrance per Proposal Request No. 1. Unit prices established at the time of bid opening were utilized for this change order request. Deduct of \$1,505.00 from the contract.

The original Contract Sum was

The net change by previously authorized Change Orders

The Contract Sum prior to this Change Order was

The Contract Sum will be decreased by this Change Order in the amount of

The new Contract Sum including this Change Order will be

\$ 5,088,000.00

\$ 0.00

\$ 5,088,000.00

\$ 1,505.00

\$ 5,086,495.00

The Contract Time will be unchanged by Zero (0) days.

The date of Substantial Completion as of the date of this Change Order therefore is November 25, 2011.

NOTE: This Change Order does not include changes in the Contract Sum, Contract Time or Guaranteed Maximum Price which have been authorized by Construction Change Directive until the cost and time have been agreed upon by both the Owner and Contractor, in which case a Change Order is executed to supersede the Construction Change Directive.

NOT VALID UNTIL SIGNED BY THE ARCHITECT, CONTRACTOR AND OWNER.Sherman Carter Barnhart Architects PSC**ARCHITECT (Firm name)**

100 Mallard Creek Road, Suite 151,
Louisville, Kentucky 40207

ADDRESS**BY (Signature)**Kenny Stanfield AIA**(Typed name)****DATE**Morel Construction Co., Inc.**CONTRACTOR (Firm name)**

627 West Main Street, Louisville,
Kentucky 40202

ADDRESS**BY (Signature)**Richard A. Clauson**(Typed name)****DATE**Hardin County Schools**OWNER (Firm name)**

65 W.A. Jenkins Road, Elizabethtown,
Kentucky 42701

ADDRESS**BY (Signature)**Nannette Johnston**(Typed name)****DATE**



627 West Main Street
Louisville, KY 40202
502-568-6200 Fax 502-568-6234

REQUEST FOR CHANGE ORDER

MOREL CONSTRUCTION CO., LLC

SHERMAN CARTER BARNHART
100 Mallard Creek Rd., Suite 151
Louisville, KY 40207-5133

Attn: Ms. Myra Vaughn

Request No. 1R1
X-No. 1R1
Project Radcliff Elementary - Phase 3
Project No. 11-01

We hereby request your formal Change Order to our contract for the following changes in the Scope of Work.

Omit culvert pipe and headwalls at the new bus loop road per PR-01, dated 1-24-11.

Delete 28lf RCP @ \$21.25/lf	(\$595.00)
Delete 2ea Headwalls @ \$805/ea	(\$1,610.00)
Add 100cy mass earth @ \$7.00/cy	\$700.00

Subtotal (\$1,505.00)

Total DEDUCT amount of this Request for Change Order (\$1,505.00)

This Request is Valid for 15 Days
A Time Extension of 0 Days is Included in this Request

- A. We are proceeding with this work as per verbal authorization of _____
- B. We have completed this work as per verbal authorization of _____
- C. We will proceed with this work only upon receipt of this signed authorization or formal Change Order

SIGNED: _____

DATE: _____

MOREL CONSTRUCTION CO., LLC

1. ORIGINAL - Architect
2. COPY - Owner/Architect File
3. COPY - X File

By: Richard A. Clauson
Richard A. Clauson - Vice President

April 20, 2011
Date

COPY

Radcliff Elementary School
Renovation Phase 3
Proposal request number 001
Bischoff Brothers Excavating

Item Description		Deduct culvert pipe and headwalls at Wilson Road Entrance Create shallow Swale across the pavement to divert storm water			
	Description	quantity / hours	unit cost / rate	subtotal	
MATERIALS	12" RCP	-28	\$ 21.25	\$	(595.00)
	12" Headwalls	-2	\$ 500.00	\$	(1,000.00)
					total \$ (1,595.00)
					tax \$ (95.70)
					material total \$ (1,690.70)
LABOR Operator		8	\$ 42.95	\$	343.62
					labor total \$ 343.62
EQUIPMENT & OPERATOR	CAT D6 Dozer	6	\$ 126.50	\$	759.00
	CAT 12G Grader	2	\$ 126.50	\$	253.00
					equipment total \$ 1,012.00
					ITEM TOTAL \$ (335.08)

COPY



AIA® Document G709™ – 2001

Work Changes Proposal Request

PROJECT (Name and address):
Radcliff Elementary School
Renovation - Phase 1
1145 S. Dixie Boulevard
Radcliff, Kentucky 40160

PROPOSAL REQUEST NUMBER: 001

DATE OF ISSUANCE: January 24, 2011

OWNER: ☒

ARCHITECT: ☒

CONSULTANT: ☒

CONTRACTOR: ☒

FIELD: ☐

OTHER: ☐

OWNER (Name and address):
Hardin County Schools
65 W. A. Jenkins Road
Elizabethtown, Kentucky 42701

CONTRACT FOR: General Construction

CONTRACT DATE: January 10, 2011

ARCHITECT'S PROJECT NUMBER: 1004

FROM ARCHITECT (Name and address):
Sherman Carter Baggett Architects
PSC
100 Mallard Creek Road, Suite 151
Louisville, Kentucky 40207

TO CONTRACTOR (Name and address):
Motel Construction Co., Inc.
627 West Main Street
Louisville, Kentucky 40202

Please submit an itemized proposal for changes in the Contract Sum and Contract Time for proposed modifications to the Contract Documents described herein. Within Zero (0) days, the Contractor must submit this proposal or notify the Architect, in writing, of the date on which proposal submission is anticipated.

THIS IS NOT A CHANGE ORDER, A CONSTRUCTION CHANGE DIRECTIVE OR A DIRECTION TO PROCEED WITH THE WORK DESCRIBED IN THE PROPOSED MODIFICATIONS.

DESCRIPTION (Insert a written description of the Work):

Contractor shall provide credit pricing to omit culvert pipe, two headwalls and all associated labor and materials and revise grades to create a shallow swale across the pavement to divert stormwater to the ditch on the north side of the entrance per the attached drawing.

ATTACHMENTS (List attached documents that support description):

Drawing: "Revised Wilson Road Entrance"

REQUESTED BY THE ARCHITECT:

(Signature)

Myra Vaughn, Project Architect
(Printed name and title)

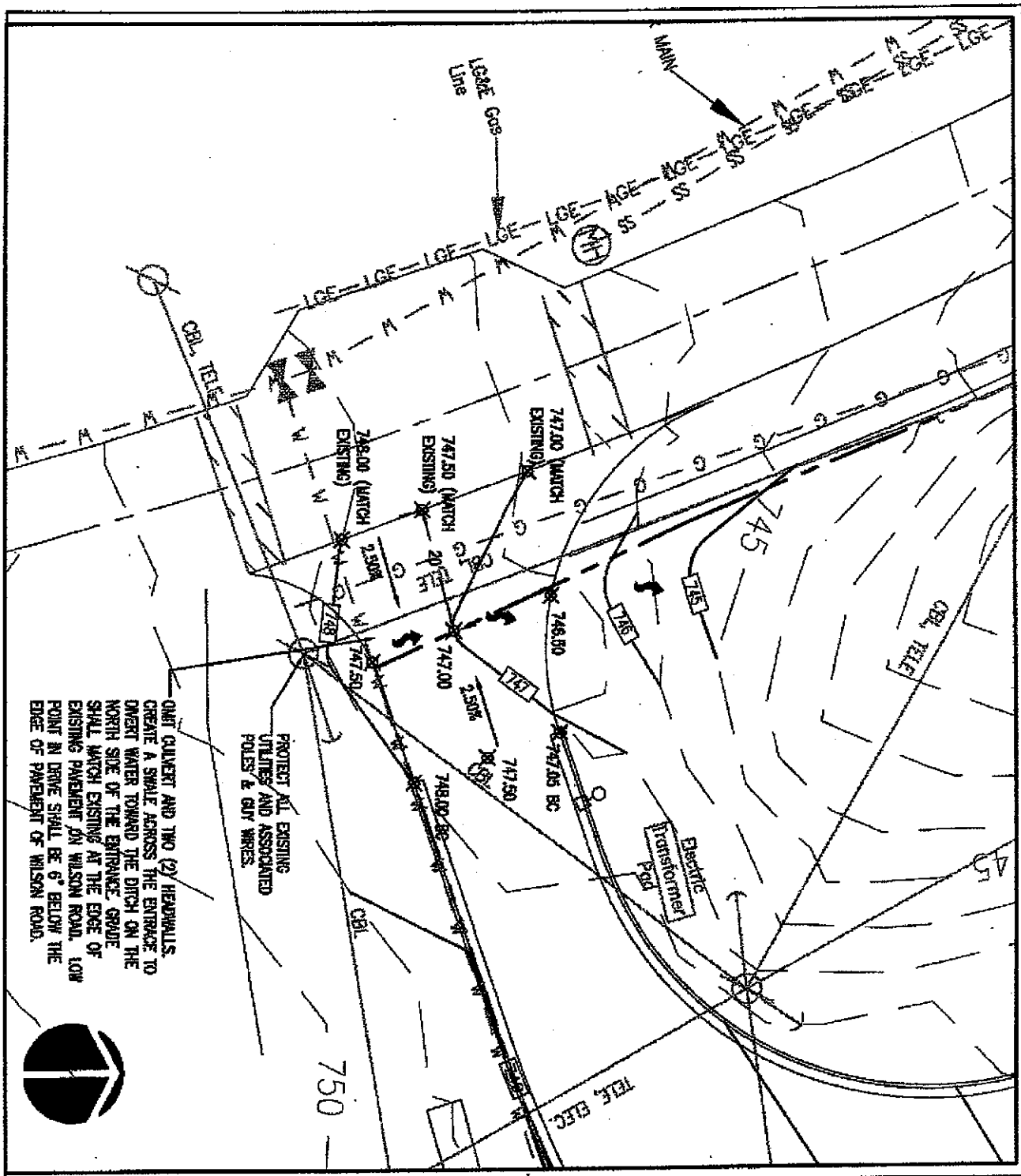

REVISED WILSON ROAD ENTRANCE

Sherman Carter Barnhart PSC

ARCHITECTURE • INTERIORS • LANDSCAPE ARCHITECTURE • CIVIL ENGINEERING

2800 INDEPENDENCE ROAD • LEXINGTON, KY 40504-3329 • PHONE (606) 221-1351 • FAX (606) 221-0495

DATE JANUAR 18, 2010

PROJECT NO. 1004

DRAWN KLB

SCALE: 1"=20'

PROJECT NAME

RADCLIFF ELEMENTARY SCHOOL

PROJECT LOCATION

RADCLIFF, KENTUCKY

KENTUCKY DEPARTMENT OF EDUCATION
DIVISION OF FACILITIES MANAGEMENT

CHANGE ORDER SUPPLEMENTAL
INFORMATION FORM

702 KAR 4:160

(Supplement to AIA G701 and G701/CMA Change Order Forms)

District: Hardin County District Code: 231 Facility Name: Radcliff Elementary School School Code:

BG #: 11-074 Project: Radcliff Elementary School Renovation – Phase 3 Contract/Bid Package:

Original Contract Sum: \$5,088,000.00 Change Order Number: 1

Requested Change Order Amount \$ (1,505.00) Time Extension Required: ☐ Yes ☒ No

NOTE: All change orders shall be submitted with complete cost breakdown including materials, labor, overhead and profit, and any other descriptive drawings and information.

Contract change requested by:

<input type="checkbox"/> Local Board of Education	<input type="checkbox"/> General Contractor
<input type="checkbox"/> Architect/Engineer	<input type="checkbox"/> Construction Manager
<input type="checkbox"/> Code Enforcement Official	<input checked="" type="checkbox"/> Other: <u>City engineer</u>

Change Order Description and Justification:

Contractor shall omit culvert pipe, two headwalls and all associated labor and materials, and revise grades to create a shallow swale across the pavement to divert stormwater to the ditch on the north side of the Wilson Road entrance per Proposal Request No. 1. Unit prices established at the time of bid opening were utilized for this change order request.

Cost Benefit to Owner:

Eliminating storm drainage design beyond school property boundary and revising design to address required storm drainage in the area.

Have contract unit prices been utilized to support the cost associated with this change order?

☒ Yes ☐ No

Is the cost for this change order supported by an alternate bid or competitive price quote(s)?

☐ Yes ☒ No

Does this change order affect the total Architect/Engineer design fee for this project? ☐ Yes ☒ No

Current A/E Contract Amount: \$

Fee Amount for this change +/-: \$

New A/E Contract Amount: \$

Board of Education Designee Signature

Date

Attach additional pages if necessary