



AIA® Document G731™ – 2019

Change Order, Construction Manager as Adviser Edition

PROJECT: *(name and address)*
Simpson County CTE Improvements &
Alternative School Addition
430 South College Street Franklin, KY
42134

OWNER: *(name and address)*
Simpson County Board of Education
P. O. Box 467 Franklin, KY 42135

CONTRACTOR: *(name and address)*
Diversified Electrical
3370 Industrial Drive Bowling Green, KY 42101

CONTRACT INFORMATION:
Contract For:
BP 260-07 Electrical
Date:
April 25, 2025

CHANGE ORDER INFORMATION:
Change Order Number:
028
Date:
May 07, 2026

ARCHITECT: *(name and address)*
Ross -Tarrant Architects
101 Old Lafayette Ave Lexington, KY 40502
CONSTRUCTION MANAGER: *(name and address)*
Alliance Corporation
116 E. College Street Glasgow, KY 42141

THE CONTRACT IS CHANGED AS FOLLOWS:

(Insert a detailed description of the change and, if applicable, attach or reference specific exhibits. Also include agreed upon adjustments attributable to executed Construction Change Directives.)

Cost associated with PR 010.

The original Contract Sum was	\$	750,465.05
Net change by previously authorized Change Orders	\$	47,446.41
The Contract Sum prior to this Change Order was	\$	797,911.46
The Contract Sum will be increased by this Change Order in the amount of	\$	1,170.00
The new Contract Sum including this Change Order will be	\$	799,081.46

The Contract time will be unchanged by (0) days.
The Contractor s Work shall be substantially complete on.

NOTE: This Change Order does not include adjustments to the Contract Sum or Guaranteed Maximum Price, or the Contract Time, that have been authorized by Construction Change Directive until the cost and time have been agreed upon by both the Owner and Contractor, in which case a Change Order is executed to supersede the Construction Change Directive.

NOT VALID UNTIL SIGNED BY THE ARCHITECT, CONSTRUCTION MANAGER, CONTRACTOR, AND OWNER.

ARCHITECT *(Signature)*

BY: Greg Hosfield, Ross-Tarrant Architects
(Printed name, title, and license number if required)

Date

CONSTRUCTION MANAGER *(Signature)*

BY: Sam Johnson, Alliance Corporation
(Printed name and title)

Date

CONTRACTOR *(Signature)*

BY: Wayne Wood, Diversified Electrical, Inc.
(Printed name and title)

Date

OWNER *(Signature)*

BY: Tim Schlosser, Simpson County Board of Education
(Printed name and title)

Date



PROPOSED CHANGE ORDER

PROJECT Franklin Simpson CTE Renovation & Addition

CONTRACTOR/SUPPLIER Diversified Electric

BID PACKAGE 260 28) 260 - 07

DETAIL ITEM	AMOUNT	
LABOR	\$	650.00
MATERIALS	\$	365.00
PROFIT & OVERHEAD	\$	155.00
BOND INSURANCE	\$	-
COST BREAKDOWN TOTAL	\$	1,170.00

Description
Cost Associated with PR 010

PR # 010 (ATTACH PR)

CHANGE ORDER INITIATED BY:

_____ ARCHITECT/ENGINEER
 _____ OWNER
 X _____ CONTRACTOR
 _____ CM
 _____ CODE OFFICIAL
 _____ OTHER _____

PLEASE INCLUDE THIS FORM WITH EVERY CHANGE ORDER.



CONSTRUCTION CHANGE COST SUMMARY

Project: Franklin Simpson CTE
 Change Description: PR 010 - Culinary Hood Power
 Date: 4/1/26

Bid Pkg	Contractor	Trade	TOTAL	Price Status	Comments
010	Scotty's	Site/Storm	\$ -	NA	
020	Scotty's	Asphalt Paving	\$ -	NA	
030	Alliance	General Trades	\$ -	NA	
050	Clark Metal Works	Structural Steel	\$ -	NA	
075	Gunter Roofing	Roofing	\$ -	NA	
080	Schiller Hardware	Steel Doors, Frames, Flush	\$ -	NA	
084	KY Mirror & Plate Glass	Aluminum Frame Entrance/Storefront	\$ -	NA	
092	Bennetts Contracting	Gypsum Board/Acoustical Panel Ceiling	\$ -	NA	
096	CDI Flooring	Flooring	\$ -	NA	
099	Premier Painting	Painting & Joint Sealants	\$ -	NA	
100	Atlas Metal Products	Misc Specialities	\$ -	NA	
123	US Specialities	Casework	\$ -	NA	
210	Twin Lakes Fire Protection	Fire Protection	\$ -	NA	
220	Lee Company	Mechanical & Plumbing	\$ -	NA	
260	Diversified Electric	Electrical	\$ 1,170.00	P	
TOTAL Cost			\$ 1,170.00		

O = Outstanding; A= Acceptable; R = Rejected; NA = Not Applicable

Comments:

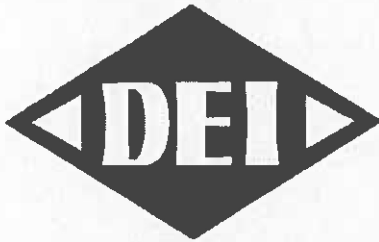

Diversified Electrical, Inc.

Commercial ♦ Industrial ♦ Maintenance ♦ Construction
CE # 11114 ♦ ME # 20515

March 30, 2026

ALLIANCE CORPORATION

Sam Johnson
116 E College Street
Glasgow, KY 42141

RE: Simpson County CTE – PR 010 – Culinary Hood Power

We propose to furnish and install all labor, material and equipment to complete the following scope of work.

- ❖ (1) 20A/3P breaker add to CAP1
- ❖ (1) 208V, 20A, 3-Phase power connection to Culinary Hood EFCP

Material	\$ 365.00
Labor	\$ 650.00
O&P	\$ 155.00
Quote.....	\$1,170.00

Exclusions and Clarifications

1. Quote valid for 7 days.
2. Overtime is not included.

Thank you for the opportunity to offer you this quote. If you have any questions, please give me a call.

Respectfully Submitted,

DIVERSIFIED ELECTRICAL, INC.

Wayne Wood
Vice President

SIMPSON CO. CTE IMPROVEMENTS
ALTERNATIVE SCHOOL ADDITIONS
FRANKLIN, KENTUCKY
ROSSTARRANT NO. 23066
MARCUM NO. 24519

MPE REQUEST FOR PROPOSAL

TO: Gaoda Jiang, Rosstarrant Architects

CC: Greg Hosfield, Rosstarrant Architects
Michael Orange, Marcum Engineering
Matt Morgan, Marcum Engineering

FROM: Jwain White, Marcum Engineering

DATE: March 20, 2026

SUBJECT: RFP Culinary Hood Exhaust/Makeup Power

RATIONALE:

RFI-030 identified the need for new power to existing hood exhaust and makeup air fans on the roof from the existing hood control panel. Power to hood control panel is covered by Tag Note 16 on E2.2.

DESCRIPTION OF REQUEST:

The Contractor shall provide power to existing hood exhaust/makeup air unit on the roof from the existing hood control panel as indicated on revised ME1.1, and E5.4.

The proposal shall be broken down to reflect labor, material, any unit costs, and mark-up.

ATTACHMENTS:

1. Revised ME1.1 – Mechanical-Electrical Roof Plan – Area A
2. Revised E5.4 – Electrical Schedules

END OF DOCUMENT

1	1/17/2025	REV	04/07
2			
3			
4			
5			
6			
7			
8			
9			
10			
11			
12			
13			
14			
15			
16			
17			
18			
19			
20			
21			
22			
23			
24			
25			
26			
27			
28			
29			
30			
31			
32			
33			
34			
35			
36			
37			
38			
39			
40			
41			
42			
43			
44			
45			
46			
47			
48			
49			
50			
51			
52			
53			
54			
55			
56			
57			
58			
59			
60			
61			
62			
63			
64			
65			
66			
67			
68			
69			
70			
71			
72			
73			
74			
75			
76			
77			
78			
79			
80			
81			
82			
83			
84			
85			
86			
87			
88			
89			
90			
91			
92			
93			
94			
95			
96			
97			
98			
99			
100			

ELECTRICAL CONSTRUCTION TAG NOTES
 APPLIES TO THE DRAWING ONLY

1. ALL ELECTRICAL WORK SHALL BE IN ACCORDANCE WITH THE NATIONAL ELECTRICAL CODE (NEC) AND ALL APPLICABLE LOCAL CODES.
2. ALL ELECTRICAL WORK SHALL BE INSTALLED IN ACCORDANCE WITH THE MANUFACTURER'S INSTRUCTIONS AND ALL APPLICABLE LOCAL CODES.
3. ALL ELECTRICAL WORK SHALL BE INSTALLED IN ACCORDANCE WITH THE NATIONAL ELECTRICAL CODE (NEC) AND ALL APPLICABLE LOCAL CODES.
4. ALL ELECTRICAL WORK SHALL BE INSTALLED IN ACCORDANCE WITH THE NATIONAL ELECTRICAL CODE (NEC) AND ALL APPLICABLE LOCAL CODES.
5. ALL ELECTRICAL WORK SHALL BE INSTALLED IN ACCORDANCE WITH THE NATIONAL ELECTRICAL CODE (NEC) AND ALL APPLICABLE LOCAL CODES.
6. ALL ELECTRICAL WORK SHALL BE INSTALLED IN ACCORDANCE WITH THE NATIONAL ELECTRICAL CODE (NEC) AND ALL APPLICABLE LOCAL CODES.
7. ALL ELECTRICAL WORK SHALL BE INSTALLED IN ACCORDANCE WITH THE NATIONAL ELECTRICAL CODE (NEC) AND ALL APPLICABLE LOCAL CODES.
8. ALL ELECTRICAL WORK SHALL BE INSTALLED IN ACCORDANCE WITH THE NATIONAL ELECTRICAL CODE (NEC) AND ALL APPLICABLE LOCAL CODES.
9. ALL ELECTRICAL WORK SHALL BE INSTALLED IN ACCORDANCE WITH THE NATIONAL ELECTRICAL CODE (NEC) AND ALL APPLICABLE LOCAL CODES.
10. ALL ELECTRICAL WORK SHALL BE INSTALLED IN ACCORDANCE WITH THE NATIONAL ELECTRICAL CODE (NEC) AND ALL APPLICABLE LOCAL CODES.
11. ALL ELECTRICAL WORK SHALL BE INSTALLED IN ACCORDANCE WITH THE NATIONAL ELECTRICAL CODE (NEC) AND ALL APPLICABLE LOCAL CODES.
12. ALL ELECTRICAL WORK SHALL BE INSTALLED IN ACCORDANCE WITH THE NATIONAL ELECTRICAL CODE (NEC) AND ALL APPLICABLE LOCAL CODES.
13. ALL ELECTRICAL WORK SHALL BE INSTALLED IN ACCORDANCE WITH THE NATIONAL ELECTRICAL CODE (NEC) AND ALL APPLICABLE LOCAL CODES.
14. ALL ELECTRICAL WORK SHALL BE INSTALLED IN ACCORDANCE WITH THE NATIONAL ELECTRICAL CODE (NEC) AND ALL APPLICABLE LOCAL CODES.
15. ALL ELECTRICAL WORK SHALL BE INSTALLED IN ACCORDANCE WITH THE NATIONAL ELECTRICAL CODE (NEC) AND ALL APPLICABLE LOCAL CODES.
16. ALL ELECTRICAL WORK SHALL BE INSTALLED IN ACCORDANCE WITH THE NATIONAL ELECTRICAL CODE (NEC) AND ALL APPLICABLE LOCAL CODES.
17. ALL ELECTRICAL WORK SHALL BE INSTALLED IN ACCORDANCE WITH THE NATIONAL ELECTRICAL CODE (NEC) AND ALL APPLICABLE LOCAL CODES.
18. ALL ELECTRICAL WORK SHALL BE INSTALLED IN ACCORDANCE WITH THE NATIONAL ELECTRICAL CODE (NEC) AND ALL APPLICABLE LOCAL CODES.
19. ALL ELECTRICAL WORK SHALL BE INSTALLED IN ACCORDANCE WITH THE NATIONAL ELECTRICAL CODE (NEC) AND ALL APPLICABLE LOCAL CODES.
20. ALL ELECTRICAL WORK SHALL BE INSTALLED IN ACCORDANCE WITH THE NATIONAL ELECTRICAL CODE (NEC) AND ALL APPLICABLE LOCAL CODES.

MECHANICAL CONSTRUCTION TAG NOTES
 APPLIES TO THE DRAWING ONLY

1. ALL MECHANICAL WORK SHALL BE IN ACCORDANCE WITH THE NATIONAL MECHANICAL CODE (NMC) AND ALL APPLICABLE LOCAL CODES.
2. ALL MECHANICAL WORK SHALL BE INSTALLED IN ACCORDANCE WITH THE MANUFACTURER'S INSTRUCTIONS AND ALL APPLICABLE LOCAL CODES.
3. ALL MECHANICAL WORK SHALL BE INSTALLED IN ACCORDANCE WITH THE NATIONAL MECHANICAL CODE (NMC) AND ALL APPLICABLE LOCAL CODES.
4. ALL MECHANICAL WORK SHALL BE INSTALLED IN ACCORDANCE WITH THE NATIONAL MECHANICAL CODE (NMC) AND ALL APPLICABLE LOCAL CODES.
5. ALL MECHANICAL WORK SHALL BE INSTALLED IN ACCORDANCE WITH THE NATIONAL MECHANICAL CODE (NMC) AND ALL APPLICABLE LOCAL CODES.
6. ALL MECHANICAL WORK SHALL BE INSTALLED IN ACCORDANCE WITH THE NATIONAL MECHANICAL CODE (NMC) AND ALL APPLICABLE LOCAL CODES.
7. ALL MECHANICAL WORK SHALL BE INSTALLED IN ACCORDANCE WITH THE NATIONAL MECHANICAL CODE (NMC) AND ALL APPLICABLE LOCAL CODES.
8. ALL MECHANICAL WORK SHALL BE INSTALLED IN ACCORDANCE WITH THE NATIONAL MECHANICAL CODE (NMC) AND ALL APPLICABLE LOCAL CODES.
9. ALL MECHANICAL WORK SHALL BE INSTALLED IN ACCORDANCE WITH THE NATIONAL MECHANICAL CODE (NMC) AND ALL APPLICABLE LOCAL CODES.
10. ALL MECHANICAL WORK SHALL BE INSTALLED IN ACCORDANCE WITH THE NATIONAL MECHANICAL CODE (NMC) AND ALL APPLICABLE LOCAL CODES.
11. ALL MECHANICAL WORK SHALL BE INSTALLED IN ACCORDANCE WITH THE NATIONAL MECHANICAL CODE (NMC) AND ALL APPLICABLE LOCAL CODES.
12. ALL MECHANICAL WORK SHALL BE INSTALLED IN ACCORDANCE WITH THE NATIONAL MECHANICAL CODE (NMC) AND ALL APPLICABLE LOCAL CODES.
13. ALL MECHANICAL WORK SHALL BE INSTALLED IN ACCORDANCE WITH THE NATIONAL MECHANICAL CODE (NMC) AND ALL APPLICABLE LOCAL CODES.
14. ALL MECHANICAL WORK SHALL BE INSTALLED IN ACCORDANCE WITH THE NATIONAL MECHANICAL CODE (NMC) AND ALL APPLICABLE LOCAL CODES.
15. ALL MECHANICAL WORK SHALL BE INSTALLED IN ACCORDANCE WITH THE NATIONAL MECHANICAL CODE (NMC) AND ALL APPLICABLE LOCAL CODES.
16. ALL MECHANICAL WORK SHALL BE INSTALLED IN ACCORDANCE WITH THE NATIONAL MECHANICAL CODE (NMC) AND ALL APPLICABLE LOCAL CODES.
17. ALL MECHANICAL WORK SHALL BE INSTALLED IN ACCORDANCE WITH THE NATIONAL MECHANICAL CODE (NMC) AND ALL APPLICABLE LOCAL CODES.
18. ALL MECHANICAL WORK SHALL BE INSTALLED IN ACCORDANCE WITH THE NATIONAL MECHANICAL CODE (NMC) AND ALL APPLICABLE LOCAL CODES.
19. ALL MECHANICAL WORK SHALL BE INSTALLED IN ACCORDANCE WITH THE NATIONAL MECHANICAL CODE (NMC) AND ALL APPLICABLE LOCAL CODES.
20. ALL MECHANICAL WORK SHALL BE INSTALLED IN ACCORDANCE WITH THE NATIONAL MECHANICAL CODE (NMC) AND ALL APPLICABLE LOCAL CODES.

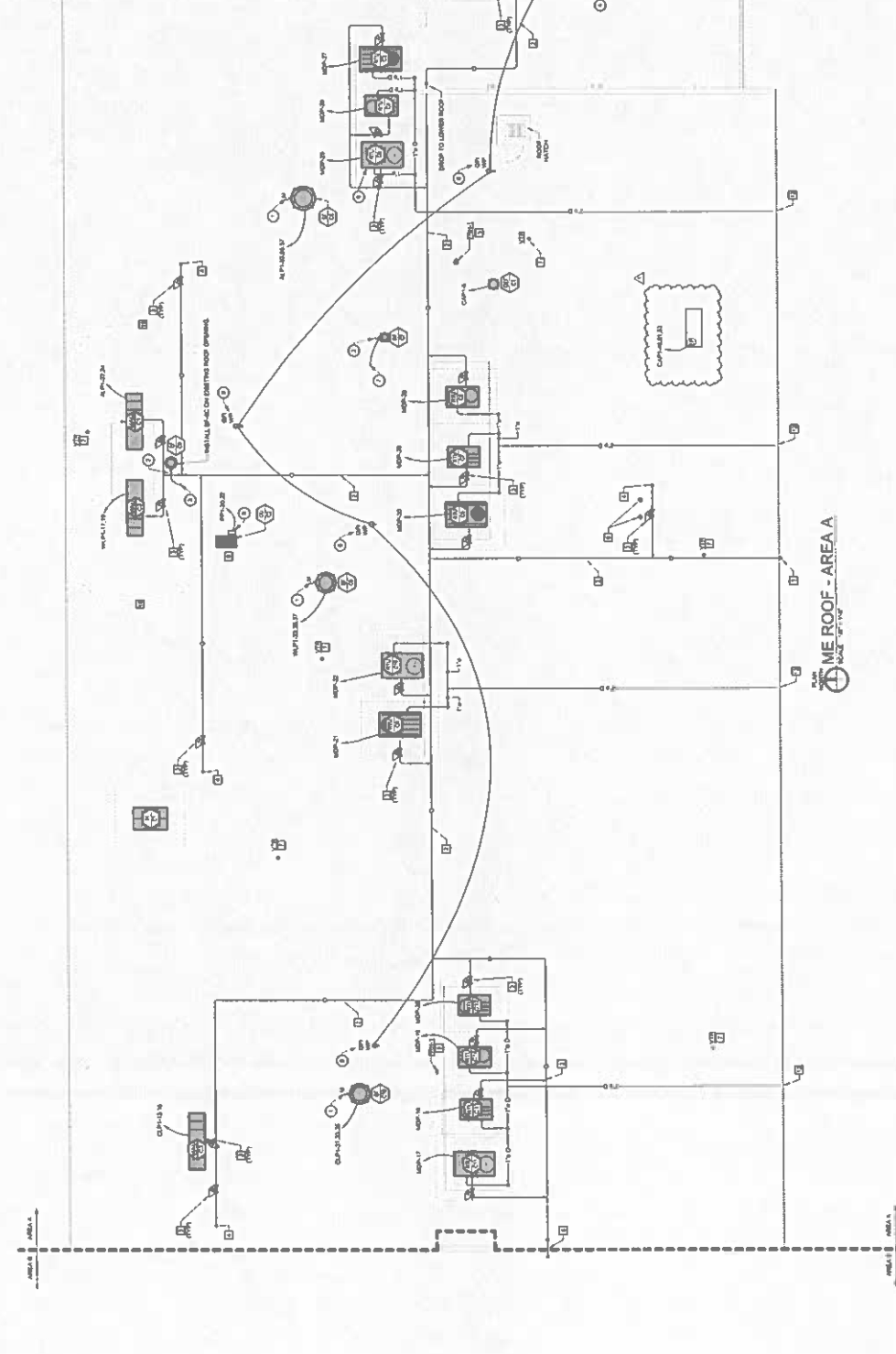

MARCUM ENGINEERING, LLC
 1125 WEST 11TH AVENUE, SUITE 100
 DENVER, CO 80202
 (303) 733-1111
 www.marcumeng.com

MEI
 MECHANICAL ELECTRICAL INSULATION
 1125 WEST 11TH AVENUE, SUITE 100
 DENVER, CO 80202
 (303) 733-1111
 www.meiinc.com

PROJECT INFORMATION

Project No.	ME-23-03
Project Name	ME ROOF - AREA A
Client	SIMPSON CO. CTE IMPROVEMENTS & ALTERNATIVE SCHOOL ADDITION
Location	1005 S. MILLER & CANTON, KY 40131
Scale	AS SHOWN
Date	11/17/2023
Drawn By	MEI
Checked By	MEI
Approved By	MEI
Discipline	MECHANICAL/ELECTRICAL
Sheet No.	ME-23-03
Total Sheets	1

SIMPSON CO. CTE IMPROVEMENTS & ALTERNATIVE SCHOOL ADDITION
 FOR:
 SIMPSON COUNTY BOARD OF EDUCATION
 1005 S. MILLER & CANTON, KY 40131

FACPAC Contract Change Order Supplemental Information Form (Ref# 64947)

Form Status: Saved

Tier 1 Project: CTE Improvements, Alternative School Addition, SES Roadway & Paving
 BG Number: 23-425 District: Simpson County (HB678) (535)
 Status: Active Phase: Project Initiation (View Checklist)

Contract: Diversified Electrical Inc, 0260, Electrical
 Type: CM Bid Package Proposed

Change Order Number 6
 Time Extension Required No
 Date Of Change Order 5/7/2026
 Change Order Amount To Date Increase

Construction Contingency

Calculations below are project wide. Remaining negative Construction Contingency may require the submission of a revised BG1.

Current Approved Amount	\$624,967.72
Net Approved COs	\$282,502.17
Remaining After Approved COs	\$342,465.55
Net All COs	\$333,916.16
Remaining After All COs	\$291,051.56

This Requested Change Order Amount \$1,170.00

+/-

Change In A/E Fee This Change Order

+/-

Change In CM Fee This Change Order \$0.00

+/-

Remaining Construction Contingency \$291,051.56

Balance

Contract Change Requested By Contractor
 Contract Change Reason Code Expansion of Scope
 Change Order Description And Justification
 Cost associated with PR 010.

Cost Benefit To Owner

The cost of this change order has been reviewed and determined to be reasonable.

Contract unit prices have been utilized No
 to support the cost associated with this
 change order.

Detailed Cost Breakdown

Contract unit prices have not been utilized, provide a detailed cost breakdown which separates labor, material, profit and overhead.

Detail Item	Amount	Percent of Total
Labor	\$650.00	55.56%
Materials	\$365.00	31.20%
Profit and Overhead	\$155.00	13.25%
Bond Insurance		0.00%
Cost Breakdown Total:	\$1,170.00	

Cost for this Change Order supported by an alternate bid or competitive price quote

No

Explain Why

Executed contract with contractor.

Change Order Supplemental Information Form Signature Page (Online Form Ref# 64947)

Architect

Date

Construction Manager

Date

Finance Officer

Date

Local Board of Education Designee

Date