

March 30, 2026

Mr. Sam Pauly
RossTarrant
101 Old Lafayette Avenue
Lexington, Kentucky 40502
p. (859)254-4018
e. spauly@rosstarrant.com

Subject: Proposal for Special Inspection Services
Marion County ATC
721 East Main Street
Lebanon, Kentucky 40033
Proposal #107026

Solid Ground Consulting Engineers, PLLC (Solid Ground) is pleased to provide you with this proposal for Special Inspections Services for the Marion County ATC project in 721 East Main Street, Lebanon, Kentucky 40033

This proposal details project information, proposed scope of services, schedule and estimated cost.

Project Description and Location

The project consists of Soils, Concrete, Masonry and structural steel The project will be located at 721 East Main Street in Lebanon, Kentucky 40033.

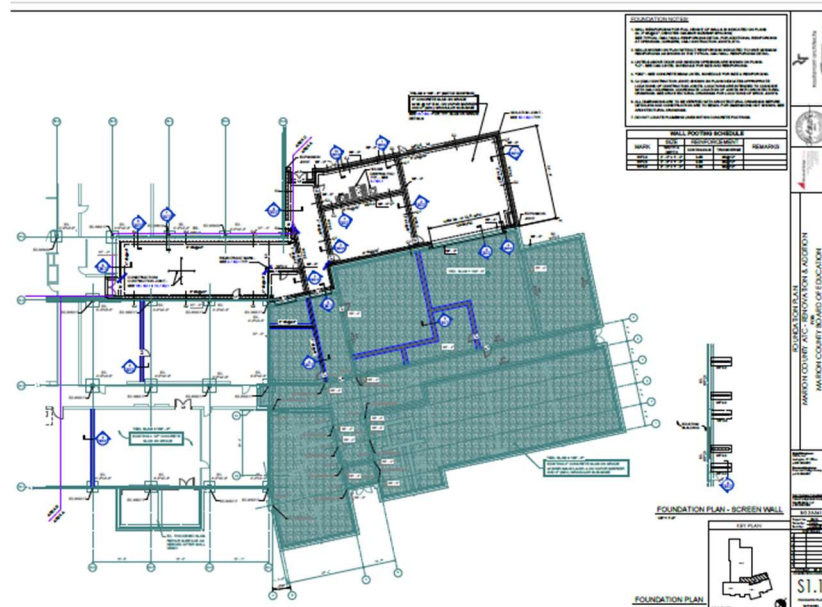

Scope of Services- Special Inspections

We will provide Special Inspection Services per Chapter 17 of the 2018 Kentucky Building Code. Based on the STRUCTURAL plans dated March 17, 2026, by Structural Design group, the following services will be performed:

Soils (KBC 1705.6)

- Observe materials below shallow foundations to verify foundation remediation is in accordance with plans and specifications.
- Observe that foundation bearing conditions are in compliance with the recommendations contained in the requirements set forth in the project plans, specifications, and the geotechnical report.
- We were not provided with civil plans for the project. Our scope of work does not include soil inspections for the site work of the building pad.

Concrete (KBC 1705.3)

- Verify use of the required design mix.
- Observe reinforcing steel, as well as anchor bolts, during foundations, slab-on-grade, and slab-on-deck construction.
- Placement of cast in place bolts or other embedded anchors prior to and during concrete placement.
- Perform FF/FL as per ASTM E-1155.
- Sample and perform tests on plastic concrete in the field which includes slump, air content, temperature, and other tests required by the project specifications.
- Review of placement and curing techniques of fresh concrete.
- Make 4 by 8-inch concrete cylinder specimens for compressive strength testing.
- Hydrate, test, and report concrete cylinder test specimens as required by the specifications.

Reinforced Masonry (KBC 1705.4)

- Observe the consistency of site-prepared mortar, placement of masonry units and the construction of mortar joints and location of reinforcement and connectors.
- Verification of size and location of structural elements, type, size and locations of anchors including details of anchorage of masonry to structural members, frames of other construction.
- Verify prior to grouting to ensure grout space is clean.
- Observe placement of grout.
- Observe construction of structural elements; to verify proper size, grade and type of reinforcement and protection of masonry during cold weather or hot weather.
- Observe construction to verify type, size grade and location of anchors.
- Observe preparation of required grout specimens and/or mortar specimens. These samples will be made every 5000 sqft of wall space during the Reinforced Masonry construction.

Steel Construction (KBC 1705.2)

- Perform structural steel inspections as per the project specifications.
- Perform field observations to verify the structural steel for compliance with the approved plan documents.
- Perform field observations of anchor bolts required for compliance to the approved plan documents.
- Perform ultra-sonic testing for welds greater than 5/16" or multi-pass fillet welds.
- Perform continuous inspection of slip critical connections.
- Perform visual inspections of steel decking screwing and welding.
- Perform continuous inspection on welds greater than 5/16".
- We assume the Steel Fabricator is approved and have not included a fabrication shop inspection.

Site Related Testing

- Site Work specifications reference Kentucky Transportation Cabinet's Standard Specifications for Road and Bridge Construction, latest edition (KYTC Specs) for earthwork, concrete placement, and asphalt placement.

Deficiencies shall be reported in writing to the owner and to the authority having jurisdiction. At the conclusion of the work, the registered design professional who made the structural observations shall submit to the authority having jurisdiction a written statement that the site visits have been made and shall identify any reported deficiencies that, to the best of the structural observer's knowledge, have not been resolved.

Schedule

We request 24-hour notice prior to providing on-call personnel to enable us to schedule the work efficiently. For final letter requests, we require a one (1) week notice prior to needing the letter. Collin Watson (240)849-8351 or Office at (888)255-4759

Compensation

Base Bid Based on the above scope of services and a review of the drawings provided, we propose a Special Inspections Base Bid of **\$27,000.00**. Invoices will be sent at the end of each month based on percentage of completion for the project.

Alternate-4 Based on the above scope of services and a review of the drawings provided, we propose a Special Inspections Lump Sum Fee of **\$2,000.00**. Invoices will be sent at the end of each month based on percentage of completion for the project

Authorization

Please sign the attached Proposal Acceptance Sheet and return one complete original of the proposal to us. This will act as authorization to proceed.



Payment Terms

The client understands that we will be compensated for performing the services in accordance with the scope of work detailed in this proposal. The client agrees to pay all charges not in dispute within 30 days of receipt of the invoice and recognizes that charges not paid within 30 days are subject to a late payment charge of 1.5 percent. The Client shall provide notification within 10 days of receipt of the invoice should the invoice contain charges the Client intends to dispute.

Proposal Acceptance

We appreciate the opportunity to provide our consulting services to you. We look forward to working with you on this project. If you have any questions, we would be glad to address them. If this proposal is acceptable as written, please have the person responsible for payment sign one copy and return it to our office. That will be our indication to begin work. Once again, thank you for considering our firm for this project.

SIGNATURE: _____

PRINTED NAME & TITLE: _____

DATE: _____

CLIENT or CLIENT REP: _____

SIGNATURE: _____

PRINTED NAME & TITLE: _____

DATE: _____

Please submit one copy to Solid Ground Consulting Engineers, PLLC by email correspondence or mail.

BILL TO (If different from Client or Client Rep)

Name: _____

Phone: _____

Email: _____

