

FACPAC Contract Change Order Supplemental Information Form (Ref# 64588)

Form Status: Saved

Tier 1 Project: Phase 6 Additions and Renovations - Project #175-520
BG Number: 21-042 District: Beechwood Independent (HB678) (026)
Status: Active Phase: Project Initiation (View Checklist)

Contract: Leo J. Brielmaier Co., 0302, General Trades
Type: CM Bid Package Proposed

Change Order Number 302-01
Time Extension Required No
Date Of Change Order 3/17/2026
Change Order Amount To Date Increase

Construction Contingency

Calculations below are project wide. Remaining negative Construction Contingency may require the submission of a revised BG1.

Current Approved Amount	\$2,677,743.00
Net Approved COs	\$790,818.50
Remaining After Approved COs	\$1,886,924.50
Net All COs	\$1,223,774.84
Remaining After All COs	\$1,453,968.16

This Requested Change Order Amount \$288,135.00

+/-

Change In A/E Fee This Change Order

+/-

Change In CM Fee This Change Order \$957.49

+/-

Remaining Construction Contingency

Balance

Contract Change Requested By Architect/Engineer; Local Board of Education

Contract Change Reason Code Expansion of Scope; Found Condition

Change Order Description And Justification

CC1 Softball Field grade beam and slab

PR2 Add masonry scope to project

Cost Benefit To Owner

Contract unit prices have been utilized No
to support the cost associated with this
change order.

**Change Order Supplemental Information Form Signature
Page (Online Form Ref# 64588)**



Architect

3/18/26

Date



Construction Manager

3-16-26

Date

Finance Officer

Date

Local Board of Education Designee

Date



AIA Document G701/CMa™ - 1992

Change Order - Construction Manager-Adviser Edition

OWNER
 CONSTRUCTION MANAGER
 ARCHITECT
 CONTRACTOR
 FIELD
 OTHER

PROJECT (Name and Address)
 BEECHWOOD INDEPENDENT SCHOOLS PHASE 6C
 54 BEECHWOOD ROAD
 FORT MITCHELL, KY 41017

CHANGE ORDER NUMBER: 302-01
INITIATION DATE: 3/17/2026

TO CONTRACTOR (Name and Address)
 LEO J. BRIELMAIER CO.
 PO BOX 32250
 CINCINNATI, OH 45232

PROJECT NUMBERS: 000744-6C
CONTRACT DATE: 12/1/2025
CONTRACT FOR: BP #302 GENERAL TRADES

THE CONTRACT IS CHANGED AS FOLLOWS:

CC1 Softball Field grade beam and slab
 PR2 Add masonry scope to project

The original Contract Sum was	2,534,900.00
Net change by previously authorized Change Orders	0.00
The Contract Sum prior to this Change Order was	2,534,900.00
The Contract Sum will be Increased by this Change Order in the amount of	288,135.00
The new Contract Sum including this Change Order will be	2,823,035.00

The Contract Time will be adjusted by 0 days.
 The date of Substantial Completion as of the date of this Change Order therefore is 9/18/2026.

NOT VALID UNTIL SIGNED BY THE CONSTRUCTION MANAGER, ARCHITECT, CONTRACTOR AND OWNER.

CODELL CONSTRUCTION COMPANY

ROBERT EHMET HAYES & ASSOCIATES, PLLC

CONSTRUCTION MANAGER (Firm Name)
 4475 ROCKWELL ROAD WINCHESTER, KY 40391

ARCHITECT (Firm Name)
 465 CENTER VIEW BLVD CRESTVIEW HILLS, KY 41017

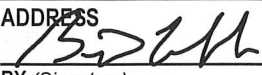
ADDRESS

 BY (Signature)

ADDRESS

 BY (Signature)

(Typed Name) **DATE:**

(Typed Name) **DATE:**

LEO J. BRIELMAIER CO.
CONTRACTOR (Firm Name)
 PO BOX 32250*CINCINNATI, OH 45232

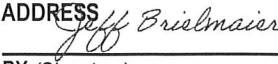
BEECHWOOD INDEPENDENT BOARD OF EDUCATION
OWNER (Firm Name)
 54 BEECHWOOD ROAD FORT MITCHELL, KY 41017

ADDRESS

 BY (Signature)

ADDRESS
 BY (Signature)

Jeff Brielmaier 3/19/26
 (Typed Name) **DATE:**

(Typed Name) **DATE:**



Change Order Review Form

CC#01 Softball Field grade beam and slab

CC#1

Beechwood Independent Schools Phase 6C (000744-6C)

54 Beechwood Road
Fort Mitchell, KY 41017

CC#01 Softball Field grade beam and slab

Date: 1/28/2026

To: Robert Ehmet Hayes & Associates, PLLC

From: Heath Preston

Attn:

CC: Bill Cobb

I have reviewed and approved the attachment pricing. Your approval and signature is required in order to process this change order. Please review the pricing and sign below if it is acceptable.

Description	BP	Amount
LEO J. BRIELMAIER CO.	302	26,597.00
Summary		Total
Total Days	0.00	26,597.00

Robert Ehmet Hayes & Associates, PLLC

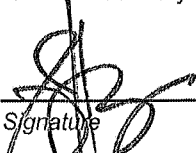
 _____

Signature

3/16/26

DATE:

Codell Construction Company
Heath Preston
 54 Beechwood Road
 Fort Mitchell, KY 41017
 hpreston@codellconstruction.com

LEO J. BRIELMAIER, CO.

GENERAL CONTRACTOR

P.O. Box 32250 • 5848 Winton Ridge Lane • Cincinnati, Ohio 45232

Telephone (513) 541-0458

Fax Number (513) 681-2228

March 2, 2026

REVISED

Codell Construction Co.
4475 Rockwell Road
Winchester, Ky 40391

Change Order # 2

Attention: Heath Preston

Reference: Beechwood Phase 6C Softball Field Dugout Grade Beam and Slab

We purpose to furnish and install all labor and material for new grade and concrete slab and install existing dugout.

Demo Labor 8 hrs. @ 85	\$ 680.00
Reinstall Dugout 12 hrs. @ 85	\$ 1,020.00
Dumpster	\$ 800.00
Concrete	\$ 19,895.00
Unofficial Total	\$ 22,395.00
Bond & Insurance 3%	\$ 672.00
Unofficial Total	\$ 23,067.00
Overhead and Profit 15%	\$ 3,460.00

Total Cost: \$ 26,527.00

Note: Quote is good for 15 Days

Concrete contractor did not include the whole pad in original proposal.

Respectfully Submitted:



Jeff Brielmaier



01/27/26

To: Jeff Brielmaier

VIA EMAIL: jeff@leobrielmaier.com

Re: Beechwood Independent Schools PCO #2537-01 (the "Project")

KNOSE CONCRETE CONSTRUCTION proposes to furnish the necessary labor, material, equipment & supervision required to complete the following scope of work for the Project. Please note attached STANDARD CONDITIONS, upon which Knose Concrete conditions its bid proposal pricing, should be incorporated into any contract between you and Knose Concrete for the Project.

To assist in your review and acceptance of this proposal, we have identified items and conditions in the scope of work that are included, excluded and/or qualified to assist you in evaluating this proposal.

We will complete the scope of work outlined below for the following pricing:

PCO #2537-01 Labor.....	\$10,087
PCO #2537-01 Material	\$6,725

SCOPE OF WORK:

38 LF- 12"x18" grade beam
120 SF- Dugout slab, 5" concrete, 42# mesh, 4" #304 gravel

PAYMENT TERMS:

Net 30 from date of invoice

Signature: _____
 Printed Name and Title: _____
 Company Name: _____
 Date Of Acceptance: _____

We are privileged to quote this work for you and look forward to serving you on the Project.

Please do not hesitate to call if you have any questions.

Sincerely,
KNOSE CONCRETE CONSTRUCTION, INC.

Drew Horton



5928 Hamilton Cleves Pike RD
 Cleves, OH 45002
 Phone 513-738-8200 - Cell 513-508-2875
dhorton@knoseconcrete.com



03/02/26

To: Jeff Brielmaier

VIA EMAIL: jeff@leobrielmaier.com

Re: Beechwood Independent Schools PCO #2537-02 (the "Project")

KNOSE CONCRETE CONSTRUCTION proposes to furnish the necessary labor, material, equipment & supervision required to complete the following scope of work for the Project. Please note attached **STANDARD CONDITIONS**, upon which Knose Concrete conditions its bid proposal pricing, should be incorporated into any contract between you and Knose Concrete for the Project.

To assist in your review and acceptance of this proposal, we have identified items and conditions in the scope of work that are included, excluded and/or qualified to assist you in evaluating this proposal.

We will complete the scope of work outlined below for the following pricing:

PCO #2537-01\$3,083.00

SCOPE OF WORK:

205 SF- Sidewalk, 5" concrete, 42# mesh, 4" #304 gravel

PAYMENT TERMS:

Net 30 from date of invoice

Signature: _____
Printed Name and Title: _____
Company Name: _____
Date Of Acceptance: _____

We are privileged to quote this work for you and look forward to serving you on the Project.

Please do not hesitate to call if you have any questions.

Sincerely,
KNOSE CONCRETE CONSTRUCTION, INC.

Drew Horton

5928 Hamilton Cleves Pike RD
Cleves, OH 45002
Phone 513-738-8200 - Cell 513-508-2875
dhorton@knoseconcrete.com

BEECHWOOD HIGH SCHOOL SOFTBALL FIELD DUGOUT HELICAL PILE FOUNDATIONS

54 BEECHWOOD ROAD
FORT MITCHELL, KENTUCKY 41017

CONSTRUCTION NOTES

HELICAL PILE INSTALLATION

- CONSTRUCT A HELICAL PILE FOUNDATION USING MATERIALS AS SHOWN AND DESCRIBED ON THESE PLANS. THIS WORK IS TO SUPPORT AN EXISTING DUGOUT STRUCTURE AT THE BEECHWOOD HIGH SCHOOL SOFTBALL FIELD IN FORT MITCHELL, KENTUCKY. THE GENERAL CONTRACTOR IS RESPONSIBLE FOR CLEARING ALL UTILITIES AND PROVIDING ACCESS FOR THE EQUIPMENT.
- THE HELICAL PILE FOUNDATION CONSISTS OF SIX (6) HELICAL PILES EMBEDDED IN A 36" DIAMETER DUGOUT. THE HELICAL PILE LAYOUT SHALL BE PERFORMED BY THE GENERAL CONTRACTOR. EMBEDMENT DEPTHS WILL BE BASED ON THE ACTUAL FIELD CONDITIONS AND THE TORQUE MEASUREMENTS AS DETERMINED BY THE GEOTECHNICAL CONSULTANT.
- THE PILES SHALL BE LOCATED AS SHOWN ON THE PLAN. THE PILES SHALL MAINTAIN A MAXIMUM BATTER DEVIATION OF 1" IN 10 FT. PILE LENGTH.
- THE CONTRACTOR SHALL MAINTAIN A RECORD OF EACH INSTALLED HELICAL PILE WHICH WILL INCLUDE AS MINIMUM THE PILE TOP ELEVATION, TORQUE AT 30" LENGTH INCREMENTS, DATE DRILLED, DATE COMPLETED, AND WEATHER CONDITIONS.
- THE TORQUE AND DEPTH SHOULD BE MONITORED AND APPROVED BY A QUALIFIED GEOTECHNICAL REPRESENTATIVE TO CONFIRM THE DESIGN ASSUMPTIONS.
- ALL HELICAL PILES SHALL BE 2-7/8" OD, 0.217" WALL THICKNESS HELICAL ANCHORS INC. OR APPROVED EQUAL WITH THE HELIX CONFIGURATION PER THE PILE SCHEDULE. USE EXTENSIONS AS NEEDED & CONNECT PER THE MANUFACTURER SPECIFICATIONS.
- HELICAL PILES SHALL BE CAPPED TO HELICAL PILE USING BOLTS & NUTS PER MANUFACTURER SPECIFICATIONS.
- THE DESIGN OF THE HELICAL PILES WAS BASED ON THE PROJECT GEOTECHNICAL REPORT PREPARED BY UES PROFESSIONAL SOLUTIONS 25, L.L.C. DATED 08/15/2025, AND THE DRAWINGS PREPARED BY REBBA ARCHITECTS, DATED 09/15/2025. THE HELICAL PILES WERE DESIGNED TO BEAR IN A STIFF TO VERY STIFF CLAY STRATUM AT AN APPROXIMATE DEPTH OF 15'-20' BELOW EXISTING GRADE. THE RECORD DRAWINGS FOR THE MINIMUM INSTALLATION TORQUE IS NOT TO BE USED AS A BASIS FOR DESIGN. THE DESIGNER'S INTENT IS TO ACHIEVE THE DESIGN TORQUE. PLEASE CONTACT CIVIL SOLUTIONS TO REVISE THE HELICAL PILE DESIGN AS NEEDED.
- CAPACITY OF THE HELICAL PILES SHALL BE DETERMINED BY MONITORING THE INSTALLATION TORQUE OF THE PILES. TORQUE IN THE FIELD IS MEASURED BY SUBTRACTING THE LEAD TORQUE FROM THE BACK PRESSURE GAUGE (IN PSI) AND CONVERTING THE DIFFERENCE TO TORQUE (FT-LBS) BY USING THE INSTALL MOTOR'S CALIBRATION DATA. THE INSTALLATION TORQUE IS MET WHEN THE PILE'S AVERAGE FIELD TORQUE IS EQUAL TO OR GREATER THAN THE DESIGN TORQUE OVER A MINIMUM LENGTH OF 3 FEET.

10. ALL HELICAL PILES SHALL BE INSTALLED TO THE MINIMUM TORQUE RATING PER THE PILE SCHEDULE. THE MAXIMUM INSTALLATION TORQUE FOR THE 75Z78217 PILE TYPE IS 13,000 FT-LBS.

CONCRETE

- CONCRETE WORK AND TESTING SHALL CONFORM TO ALL REQUIREMENTS OF ACI 301, SPECIFICATIONS FOR STRUCTURAL CONCRETE FOR BUILDINGS, EXCEPT AS MODIFIED BY THE SUPPLEMENTAL REQUIREMENTS BELOW, AND THE REQUIREMENTS FOR RESIDENTIAL CONCRETE CONSTRUCTION ACI 308.2-08.
- CONCRETE WORK IN COLD WEATHER SHALL CONFORM TO ALL REQUIREMENTS OF ACI 308.1 "STANDARD SPECIFICATION FOR COLD WEATHER CONCRETING" AND ACI 308R "COLD WEATHER CONCRETING".
- CONCRETE WORK IN HOT WEATHER SHALL CONFORM TO ALL REQUIREMENTS OF ACI 308R "HOT WEATHER CONCRETING" AND ACI 308R "HOT WEATHER CONCRETING". THE HUMAN CONCRETE TEMPERATURE AND WIND VELOCITY SHALL BE ENTERED INTO THE NOMOGRAPH OF THIS REFERENCE TO DETERMINE IF PRECAUTIONS AGAINST PLASTIC SHRINKAGE ARE REQUIRED.
- MATERIALS: (f_c BASED ON 28 DAY UNLESS NOTED)
 - CONCRETE UNLESS NOTED: f_c = 4,000 PSI, NORMAL WEIGHT AGGREGATE.
 - REINFORCING STEEL: ASTM A615 60 KSI YIELD DEFORMED BARS.
 - AD Mixtures containing Chloride are NOT PERMITTED IN REINFORCED CONCRETE OR CONCRETE CONTAINING METALS.
 - LAP SPlice REINFORCING BARS 48 BAR DIAMETERS UNLESS NOTED OTHERWISE.
 - BAR CLEARANCES BETWEEN ADJACENT BARS AND FORMWORK SHALL BE AS NOTED ON THE DRAWINGS OR A MINIMUM AS PER ACI REQUIREMENTS.
 - AT CORNERS AND INTERSECTIONS OF FOOTINGS, WALLS AND GRADE BEAMS, PROVIDE BAY CORNER REINFORCEMENT AT CORNERS AS SHOWN. PROVIDE MECHANICAL REINFORCING AROUND CORNER AND/OR INTO ABUTTING WALL OR GRADE BEAM. BARS SHALL HAVE EMBEDMENT OF 30 DIAMETERS (18" MIN.).
 - PROVIDE 3/4" CHAMFER AT CORNERS OF EXPOSED CONCRETE.

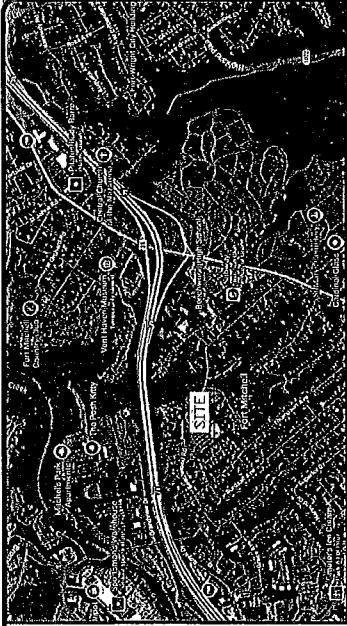

VICINITY MAP
NET TO SCALE

- ### INSPECTION ENGINEER REQUIREMENTS
- AN INSPECTION ENGINEER SHALL BE HIRED BY THE CONTRACTOR OR OWNER. INSPECTION ENGINEER SHALL BE A LICENSED PROFESSIONAL ENGINEER AND SHALL BE OPERATING WITHIN A STATE OF KENTUCKY.
 - INSPECTIONS WILL OCCUR CONTINUOUSLY DURING THE INSTALLATION OF THE HELICAL PILES.
 - ONE SET OF CONCRETE CYLINDERS SHALL BE CAST PER DAY IN ACCORDANCE WITH ASTM C31 FOR COMPRESSIVE STRENGTH TESTING.
 - SUMP AND AIR CONTENT (IF AIR ENTRAINED) OF CONCRETE TO BE TESTED PER LOAD IN ACCORDANCE WITH ASTM C143 AND ASTM C231.
 - THE INSPECTION ENGINEER SHALL NOTIFY THE CONTRACTOR OF ANY DEFICIENCIES AND ALLOW THE CONTRACTOR A REASONABLE OPPORTUNITY TO REPAIR ANY DEFECT BEFORE REPORTING THE DEFICIENCY IN WRITING TO THE OWNER.
 - THE INSPECTION ENGINEER IS RESPONSIBLE FOR READING AND UNDERSTANDING THESE DRAWINGS AND ASSUMING RESPONSIBILITY FOR THE ACCURACY OF THE INFORMATION. THESE COMPLETE SET OF THESE DRAWINGS WHEN PERFORMING INSPECTION DUTIES ON SITE.

Sheet List Table

Sheet Number	Sheet Title
FND-1	TITLE SHEET
FND-2	SITE PLAN
FND-3	FND PLAN, TYPICAL SECTION, & SCHEDULE

<p>CIVIL SOLUTIONS ENGINEERING THE EARTH™ 3760 Fulton Grove Road, Cincinnati, Ohio 45245 Office (513) 752-9500 Website: www.civilsolutions.net</p>		Date: 01/12/2026 Project No.: 26-1008 Sheet No.: FND-1														
TITLE SHEET BEECHWOOD HIGH SCHOOL SOFTBALL FIELD DUGOUT 54 BEECHWOOD ROAD FORT MITCHELL, KENTUCKY 41017		Designed By: KLO Drafted By: KLO Reviewed By: JKCA														
<table border="1"> <thead> <tr> <th colspan="2">REVISIONS</th> </tr> <tr> <th>No.</th> <th>Date</th> </tr> </thead> <tbody> <tr> <td>1</td> <td></td> </tr> <tr> <td>2</td> <td></td> </tr> <tr> <td>3</td> <td></td> </tr> <tr> <td>4</td> <td></td> </tr> <tr> <td>5</td> <td></td> </tr> </tbody> </table>			REVISIONS		No.	Date	1		2		3		4		5	
REVISIONS																
No.	Date															
1																
2																
3																
4																
5																



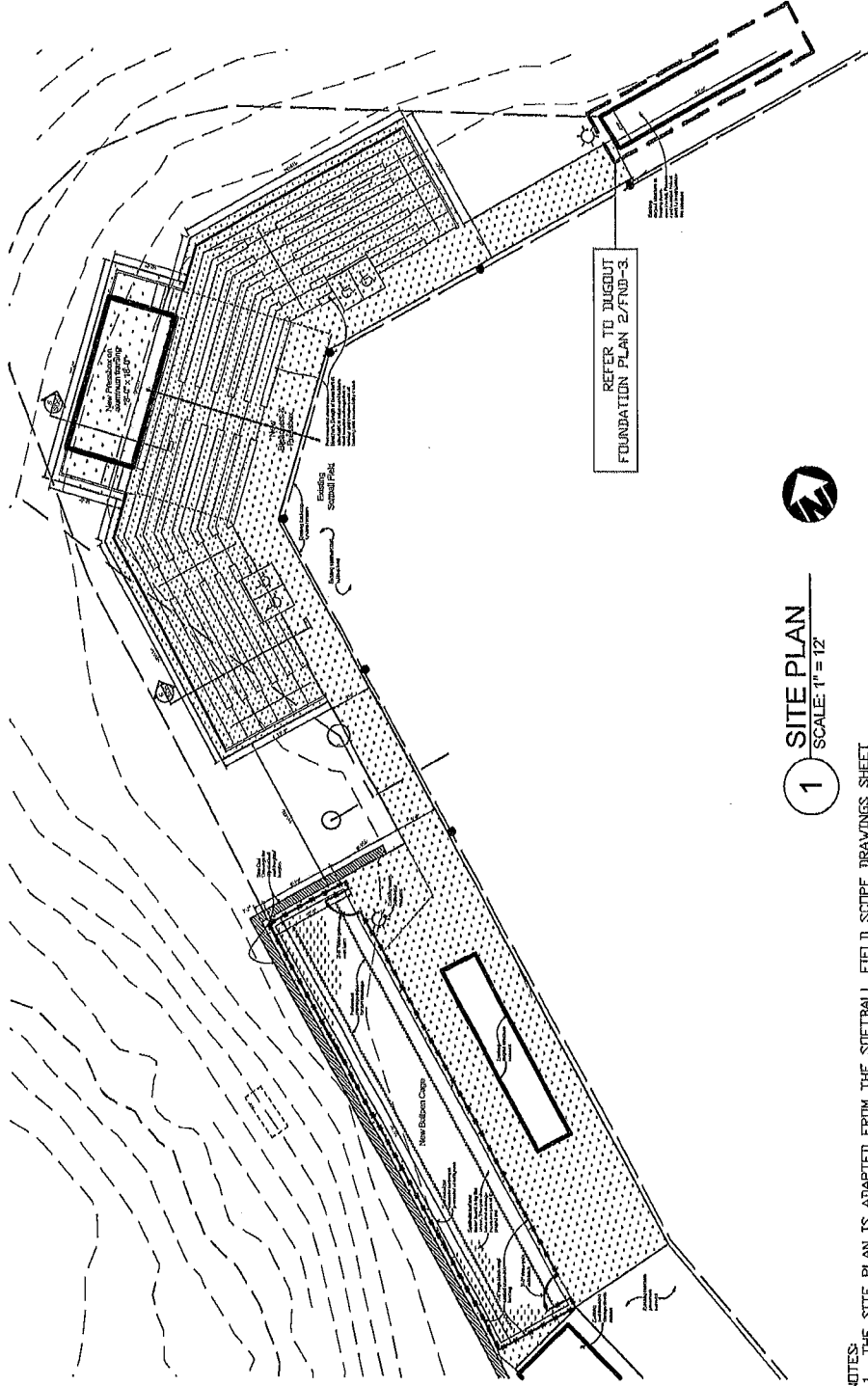

1 SITE PLAN
SCALE: 1" = 12'

NOTES:
1. THE SITE PLAN IS ADAPTED FROM THE SOFTBALL FIELD SCOPE DRAWINGS SHEET
S315 PREPARED BY REHKA ARCHITECTS PROJECT REF # 175-520, DATED 09/15/2025.

Date: 01/12/2026
Project No.: 26-1003
Sheet No.: FND-2

CIVIL SOLUTIONS
ENGINEERING THE EARTH™
3760 Fulton Grove Road, Cincinnati, Ohio 45245
Office (513) 752-8500 Website: www.civilsolutions.net

SITE PLAN
BEECHWOOD HIGH SCHOOL
SOFTBALL FIELD DUGOUT
54 BEECHWOOD ROAD
FORT MITCHELL, KENTUCKY 41017

REVISIONS	
No.	Date
1	
2	
3	
4	
5	

DESIGNED BY: KLO
DRAFTED BY: KLO
REVIEWED BY: JIKA

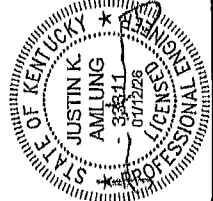

NOTES:
 1. CONFIRM DIMENSIONS AND HELICAL PILE LAYOUT WITH EXISTING DUGOUT STRUCTURE. HELICAL PILES TO BE LOCATED UNDER EACH TIMBER POST.

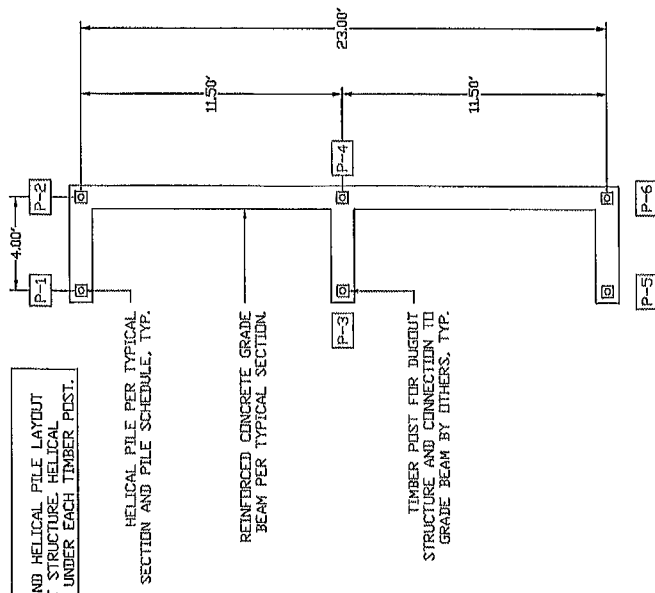

HELICAL PILE PER TYPICAL SECTION AND PILE SCHEDULE, TYP.
 REINFORCED CONCRETE GRADE BEAM PER TYPICAL SECTION.
 TIMBER POST FOR DUGOUT STRUCTURE AND CONNECTION TO GRADE BEAM BY OTHERS, TYP.

2 DUGOUT FOUNDATION PLAN
 SCALE: 1" = 5'

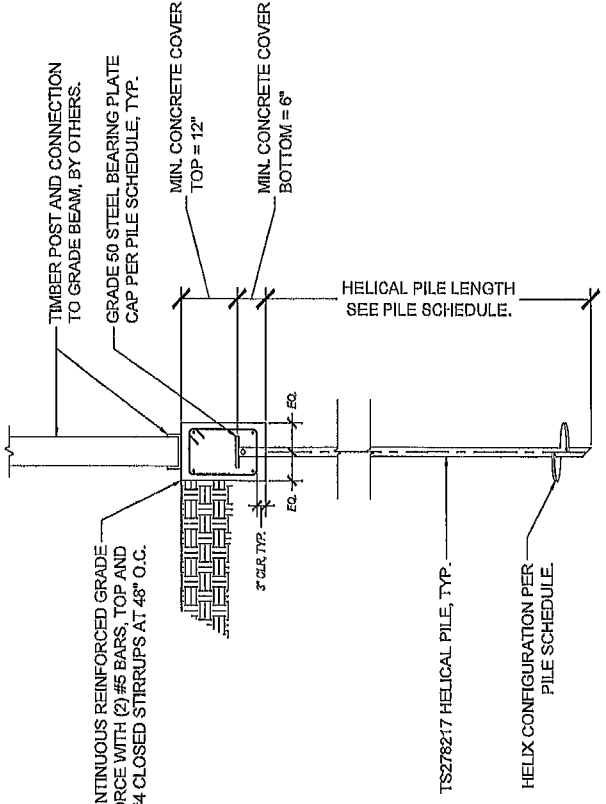

3 TYPICAL HELICAL PILE SECTION
 SCALE: 1" = 2'

HELICAL PILE SCHEDULE				
Helical Pile	Allowable Load (kips)		Helical Type	Estimated Length (ft)
	Compression	Tension		
P-1 TO P-6	5	5	TS278217	35'-30"

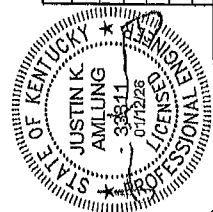

REVISIONS		Designed By:
No.	Date	KLO
1		
2		
3		
4		
5		

FND PLAN, TYPICAL SECTION, & SCHEDULE
 BEECHWOOD HIGH SCHOOL
 SOFTBALL FIELD DUGOUT
 54 BEECHWOOD ROAD
 FORT MITCHELL, KENTUCKY 41017

ENGINEERING THE EARTH™
 3760 Fulton Grove Road, Cincinnati, Ohio 45245
 Office (619) 752-9500 Website: www.civilsolutions.net

Date: 01/12/2026
 Project No.: 26-1003
 Sheet No.: FND-3

NOTES:
 1. ACCORDING TO THE PROJECT GEOTECHNICAL REPORT PREPARED BY UES PROFESSIONAL SOLUTIONS 25, LLC, DATED 08/15/2025, THE SLOPE BEHIND THE DUGOUT IS VERY STEEP AND EXPERIENCING GROUND MOVEMENT AS EVIDENCED BY THE LEANING DUGOUT STRUCTURE AND THE GAP BETWEEN THE CONCRETE PAVEMENT AND THE FENCE CURB. THE STABILITY OF THIS SLOPE WAS BEYOND THE SCOPE OF THIS PROJECT; HOWEVER, IT IS OUR OPINION THAT THE SLOPE IS UNSTABLE AND WILL LIKELY CONTINUE TO MOVE.
 2. THE HELICAL PILES HAVE BEEN DESIGNED TO SUPPORT THE VERTICAL LOAD FROM THE DUGOUT STRUCTURE. ANY FUTURE SLOPE/HORIZONTAL MOVEMENT WILL NOT BE PREVENTED BY THE INSTALLATION OF THE HELICAL PILES. UNLESS CHOSE THE HELICAL PILES TO MOVE WITH THE SLOPE, RENDERING THEM HELPLESS FOR THE STABILITY OF THE EXISTING SLOPE OR FOR ANY FUTURE PRESSURE OR FUTURE SLOPE MOVEMENT, FAILURE, OR RESULTING DAMAGE TO THE DUGOUT STRUCTURE. HELICAL PILES OR ADJACENT IMPROVEMENTS, NO SLOPE STABILIZATION MEASURES ARE INCLUDED IN THIS PROJECT. CIVIL SOLUTIONS IS NOT RESPONSIBLE FOR ANY DAMAGE OR PERFORMANCE ISSUES RESULTING FROM SLOPE INSTABILITY.

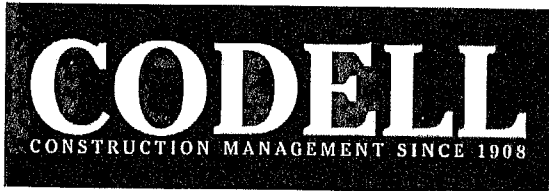

Change Order Review Form
PR#02 - Masonry Scope Added
PR #02

Beechwood Independent Schools Phase 6C (000744-6C)

54 Beechwood Road
Fort Mitchell, KY 41017

PR#02 - Masonry Scope Added

Date: 1/19/2026

To: Robert Ehmet Hayes & Associates, PLLC

From: Bill Cobb

Attn:

CC: Bill Cobb

I have reviewed and approved the attachment pricing. Your approval and signature is required in order to process this change order. Please review the pricing and sign below if it is acceptable.

PR#02 Add Masonry scope to project.

Description	BP	Amount
BLAU MECHANICAL INC.	311	0.00
CDI FLOORING	307	0.00
DELTA ELECTRICAL CONTRACTORS	312	0.00
ELITE MECHANICAL SERVICES, LLC	310	0.00
LEO J. BRIELMAIER CO.	302	261,538.00
TOADVINE ENTERPRISES	313	0.00
Summary		Total
Total Days	0.00	261,538.00

Robert Ehmet Hayes & Associates, PLLC

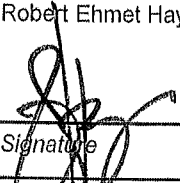
Signature

DATE:

Codell Construction Company
Bill Cobb
54 Beechwood Road
Fort Mitchell, KY 41017
bcobb@codellconstruction.com



AIA[®]

Document G709™ – 2018

Proposal Request

PROJECT: <i>(name and address)</i> Beechwood Schools Phase 6C Improvements 54 Beechwood Road Fort Mitchell, Kentucky 41017	CONTRACT INFORMATION: Contract For: Total Project Date: October 06, 2020	Architect's Project Number: 175-520 / BG #21-042 Proposal Request Number: 002 Proposal Request Date: January 16, 2026
OWNER: <i>(name and address)</i> Beechwood Independent Board of Education 50 Beechwood Road Fort Mitchell, Kentucky 41017	ARCHITECT: <i>(name and address)</i> Robert Ehmet Hayes & Associates, PLLC 465 Centre View Boulevard Crestview Hills, Kentucky 41017	CONTRACTOR: <i>(name and address)</i> Codell Construction Company 4475 Rockwell Road Winchester, Kentucky 40391

The Owner requests an itemized proposal for changes to the Contract Sum and Contract Time for proposed modifications to the Contract Documents described herein. The Contractor shall submit this proposal within Zero (0) days or notify the Architect in writing of the anticipated date of submission.
(Insert a detailed description of the proposed modifications to the Contract Documents and, if applicable, attach or reference specific exhibits.)

Provide pricing for masonry. Reference attached Bid Package #3 Masonry for scope.

THIS IS NOT A CHANGE ORDER, A CONSTRUCTION CHANGE DIRECTIVE, OR A DIRECTION TO PROCEED WITH THE WORK DESCRIBED IN THE PROPOSED MODIFICATIONS.

REQUESTED BY THE ARCHITECT:

Joseph Hayes, Member
 PRINTED NAME AND TITLE

SECTION 01900

LANGUAGE SPECIFIC TO INDIVIDUAL BIDS

(CONTRACTOR/SUBCONTRACTOR/SUPPLIER)

BID PACKAGE: #303 MASONRY

INCLUDED:

1. The requirements of all Division 0 and Division 1 Sections apply to this and all Contract Packages.
2. Furnish, install, and warrant all work shown on the drawings and described in the following specification sections:

042000 Unit Masonry
072100 Thermal Insulation (Brick Cavity Insulation Only)
3. Layout
4. Cleanup
5. Coordination with other trades
6. Contractor is to install loose steel lintels (for masonry work) 15' long and under supplied by **BP #302 General Trades.**
7. Contractor to install masonry embeds supplied by **BP #302 General Trades.**
8. Contractor shall provide temporary heat and enclosures so not to delay masonry during winter months.
9. Contractor is responsible for grouting hollow metal frames.
10. Contractor is responsible for supplying and installing masonry reinforcement.
11. Contractor is NOT responsible for installation of hollow metal door and access frames within masonry walls. **BP #302 General Trades** will set these frames in place so not to delay the work of the mason.
12. Contractor is responsible for flashing as it pertains to their scope of work including termination bar and sealant. Coordination must exist between contractors whose work joins one another.
13. Contractor is responsible for coordination and installation of reglets and flashing with other trades.
14. Contractor is responsible for sealing exterior masonry if required by contract documents.
15. Contractor is responsible for all site masonry.
16. Contractor shall clean site free of brick, block and masonry debris on daily basis.
17. Contractor is responsible for grouting beam and joist pockets.
18. Contractor and **BP #309 Painting** must agree on finish condition of masonry before applying paint.
19. Contractor is responsible for all dampproofing behind all masonry.
20. Contractor is responsible for brick sealers.

BREAKOUT ITEMS:

Mortar & Grout	Brick
Insulation	Masonry Accessories

SPECIAL INSTRUCTIONS:

1. Refer to Alternates Section 01030. It is the responsibility of the Bidder to include any alternates that are applicable to their bid package.
2. Review all pages of the plans and specifications to ensure coordination of your work with other trades.
3. Bidder is advised that all work to be performed will be governed solely by the plans, specifications, and addenda. Bidder is directed to the above specification sections for technical information and any additional items of work involved.
4. It shall be the responsibility of the bidder to determine which Bid Package or combination of Bid Packages the Bidder desires to bid.
5. **REFER TO THE FRONT OF SECTION 01900-LANGUAGE SPECIFIC TO INDIVIDUAL BIDS.**

LEO J. BRIELMAIER, CO.

GENERAL CONTRACTOR

P.O. Box 32250 • 5848 Winton Ridge Lane • Cincinnati, Ohio 45232

Telephone (513) 541-0458

Fax Number (513) 681-2228

February 10, 2026

Revised

Codell Construction Co.
4475 Rockwell Road
Winchester, Ky 40391

Change Order # 1A

Attention: Heath Preston

Reference: Beechwood Phase 6C Proo2 Masonry

We purpose to furnish and install all labor and material for the masonry work on the Beechwood Phase 6C project.

Dumpster	\$ 800.00
Masonry	<u>\$ 220,000.00</u>
Unofficial Total	\$ 220,800.00
Bond & Insurance 3%	<u>\$ 6,624.00</u>
Unofficial Total	\$ 227,424.00
Overhead and Profit 15%	<u>\$ 34,114.00</u>

Total Cost: \$ 261,538.00

Note: Quote is good for 15 Days

Respectfully Submitted:

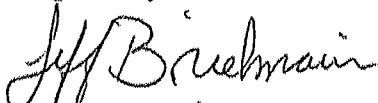
Jeff Brielmaier

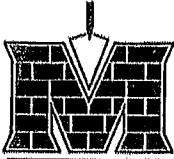

Miter Masonry Contractors, Inc.

421 Maple Avenue
Cincinnati, Ohio 45216
(513) 821-3334

2/9/2026

Revised Proposal

To: Leo J. Brielmaler Co.	Email: jeff@leobrielmaler.com
Attn: Jeff Brielmaler	Sender: Andy Krallman
Project: Beechwood Phase 6C	Total Pages Including Cover: 1

Base Bid: **\$220,000**

Spec Section: **042000 – UNIT MASONRY**

Bid Package: **#303 MASONRY**

Alternates: **#6 Football Press box – Included in base bid**

Exclusions: **Joint Sealants including caulking, Miscellaneous Steel Lintels, Setting of door frames, Cavity Insulation**

Clarifications: **Reasonable site access with rough terrain forklift is required, Price assumes clean and level footings/foundations**

Sales Tax Included: **Yes**

Prevailing Wage: **No**

Labor and Material: **Yes**

Plans & Specs: **Yes**

Addenda 1,2,3,4,5: **Noted and included**

Please feel free to call me with any questions.

Regards,

Andy Krallman
Miter Masonry Contractors, Inc.
513-821-3334
andy@mitermasonry.com