

MEMORANDUM

TO: Dr. Jesse Bacon, Superintendent

FROM: Thomas Stokes, Director of Facilities *TAS*

DATE: March 16, 2026

RE: BCHS PSC - BG 25-145 - Change Order 13 - Concrete Control Joint Installation

It is recommended that additional control joints be added at the elevated walkway concrete slab to mitigate superficial cracking. Joints were added by the architect, and then additional joints were requested by Facilities. Prior to the addition of joints as directed by Facilities, the contractor moved forward with separate joint pores for the architect directed control joints. After joints were placed, it was confirmed joints can be saw cut and achieve similar results. This Change Order covers work for both the architect directed control joints and additional joints as directed by Facilities.

I recommend approval of this request.

Bullitt **CENTRAL** Physical Science Center - Attached paperwork is listed below with *action items* noted for each:

- BP1 - BCHS PSC - G701-2017 - Change Order 13 - *for Board Signature*
- BP1 - BCHS PSC - FACPAC - Change Order 13 - Concrete Control Joint Installation - *for Board Signature*
 - *COR-14 REV BCHS Control Joints 2nd Level – For Board Reference, no action required.*

OUR MISSION IS TO INSPIRE AND EQUIP OUR STUDENTS TO SUCCEED IN LIFE

BULLITT COUNTY PUBLIC SCHOOLS IS AN EQUAL EDUCATION AND EMPLOYMENT INSTITUTION



AIA[®] Document G701[®] – 2017

Change Order

PROJECT: *(Name and address)*
 BCPS Phase III Athletics - Bid Package
 No. 1 - Bullitt CENTRAL Physical Science
 Center
 1330 KY-44
 Shepherdsville, KY 40165

CONTRACT INFORMATION:
 Contract For: Bullitt CENTRAL Physical
 Science Center

CHANGE ORDER INFORMATION:
 Change Order Number: 013

Date: 06-19-2025

Date: 03-23-2026

OWNER: *(Name and address)*
 Bullitt County Public Schools Board of
 Education
 1040 Hwy 44 East
 Shepherdsville, KY 40165

ARCHITECT: *(Name and address)*
 Studio Kremer Architecture, Inc.

CONTRACTOR: *(Name and address)*
 Calhoun Construction Services, Inc.

1231 South Shelby Street
 Louisville, KY 40203

7707 National Turnpike
 Louisville, KY 40218

THE CONTRACT IS CHANGED AS FOLLOWS:

(Insert a detailed description of the change and, if applicable, attach or reference specific exhibits. Also include agreed upon adjustments attributable to executed Construction Change Directives.)

See COR #14 and RFI #26 for Scope of Work include din this Change Order.

| | |
|--|------------------|
| The original Contract Sum was | \$ 13,577,217.19 |
| The net change by previously authorized Change Orders | \$ 360,523.60 |
| The Contract Sum prior to this Change Order was | \$ 13,937,740.79 |
| The Contract Sum will be increased by this Change Order in the amount of | \$ 16,174.00 |
| The new Contract Sum including this Change Order will be | \$ 13,953,914.79 |

The Contract Time will be unchanged by (0) days.

The new date of Substantial Completion will be

NOTE: This Change Order does not include adjustments to the Contract Sum or Guaranteed Maximum Price, or the Contract Time, that have been authorized by Construction Change Directive until the cost and time have been agreed upon by both the Owner and Contractor, in which case a Change Order is executed to supersede the Construction Change Directive.

NOT VALID UNTIL SIGNED BY THE ARCHITECT, CONTRACTOR AND OWNER.



ARCHITECT *(Signature)*

BY: Catherine Noble Ward, AIA
(Printed name, title, and license number if required)

3-13-2026

 Date



CONTRACTOR *(Signature)*

BY: Joel Pittard, Project Manager
(Printed name and title)

3/13/2026

 Date

OWNER *(Signature)*

BY: Dr. Jesse Bacon, Superintendent
(Printed name and title)

 Date

FACPAC Contract Change Order Supplemental Information Form (Ref# 64568)

Form Status: Saved

Tier 1 Project: Phase 3 Athletics - BCHS and BEHS Field Houses

BG Number: 25-145

District: Bullitt County (HB678) (071)

Status: Active

Phase: Project Initiation (View Checklist)

Contract: Calhoun Construction Services, Inc., 0001, BP1 - Bullitt Central Physical Science Center - General Construction

Type: General Contractor

Proposed

| | |
|-----------------------------|-----------|
| Change Order Number | 13 |
| Time Extension Required | No |
| Date Of Change Order | 3/23/2026 |
| Change Order Amount To Date | Increase |

Construction Contingency

Calculations below are project wide. Remaining negative Construction Contingency may require the submission of a revised BG1.

| | |
|------------------------------|----------------|
| Current Approved Amount | \$1,816,582.46 |
| Net Approved COs | \$522,918.58 |
| Remaining After Approved COs | \$1,293,663.88 |
| Net All COs | \$266,861.42 |
| Remaining After All COs | \$1,549,721.04 |

This Requested Change Order Amount \$16,174.00

+/-

Change In A/E Fee This Change Order \$808.70

+/-

Change In CM Fee This Change Order \$0.00

+/-

Remaining Construction Contingency \$1,549,721.04

Balance

Contract Change Requested By Architect/Engineer; BCPS Facilities

Contract Change Reason Code Expansion of Scope; Improved Plans/Specs

Change Order Description And Justification

It is recommended that additional control joints be added at the elevated walkway concrete slab to mitigate superficial cracking. Joints were added by the architect, and then additional joints were requested by Facilities. Prior to the addition of joints as directed by Facilities, the contractor moved forward with separate joint pores for the architect directed control joints. After joints were placed, it was confirmed joints can be saw cut and achieve similar results.

This Change Order covers work for both the architect directed control joints and additional joints as directed by Facilities.

Cost Benefit To Owner

Work can occur with trades on site in sequence with the construction schedule.

Contract unit prices have been utilized No to support the cost associated with this change order.

Detailed Cost Breakdown

Contract unit prices have not been utilized, provide a detailed cost breakdown which separates labor, material, profit and overhead.

| Detail Item | Amount | Percent of Total |
|------------------------------|--------------------|------------------|
| Labor | \$7,337.50 | 45.37% |
| Materials | \$6,587.50 | 40.73% |
| Profit and Overhead | \$2,089.00 | 12.92% |
| Bond Insurance | \$160.00 | 0.99% |
| Cost Breakdown Total: | \$16,174.00 | |

Cost for this Change Order supported No by an alternate bid or competitive price quote

Explain Why

Work can occur with trades on site in sequence with the construction schedule.

Change Order Supplemental Information Form Signature Page (Online Form Ref# 64568)



Architect

3-13-2026

Date

N/A

Construction Manager

Date



Finance Officer

3-16-26

Date

Local Board of Education Designee

Date

Change Order Request 14 - PCO #31 - BCHS Control Joints 2nd Level

845-- Bullitt Central High School Physical Science Center

3/13/2026



Summary of work

BCHS Control Joints 2nd Level

| Scope - Subcontractor | Description | Cost |
|---|---|--------------------|
| | | \$13,925.00 |
| o Concrete, Footer/Foundations/slabs - CCS Concrete | ==> BCHS Control Joints 2nd Level; includes added sawcut joints | ==> \$12,975.00 |
| o Sealants & Caulking - Professional Sealants | ==> BCHS Control Joints 2nd Level Sealants | ==> \$950.00 |
| | Sub Total: | \$13,925.00 |
| | Bond: | \$160.00 |
| | Fee: | \$2,089.00 |
| | Total | \$16,174.00 |

Approved By: _____

Submitted By: Calhoun

Date: _____

Date: 3/13/2026

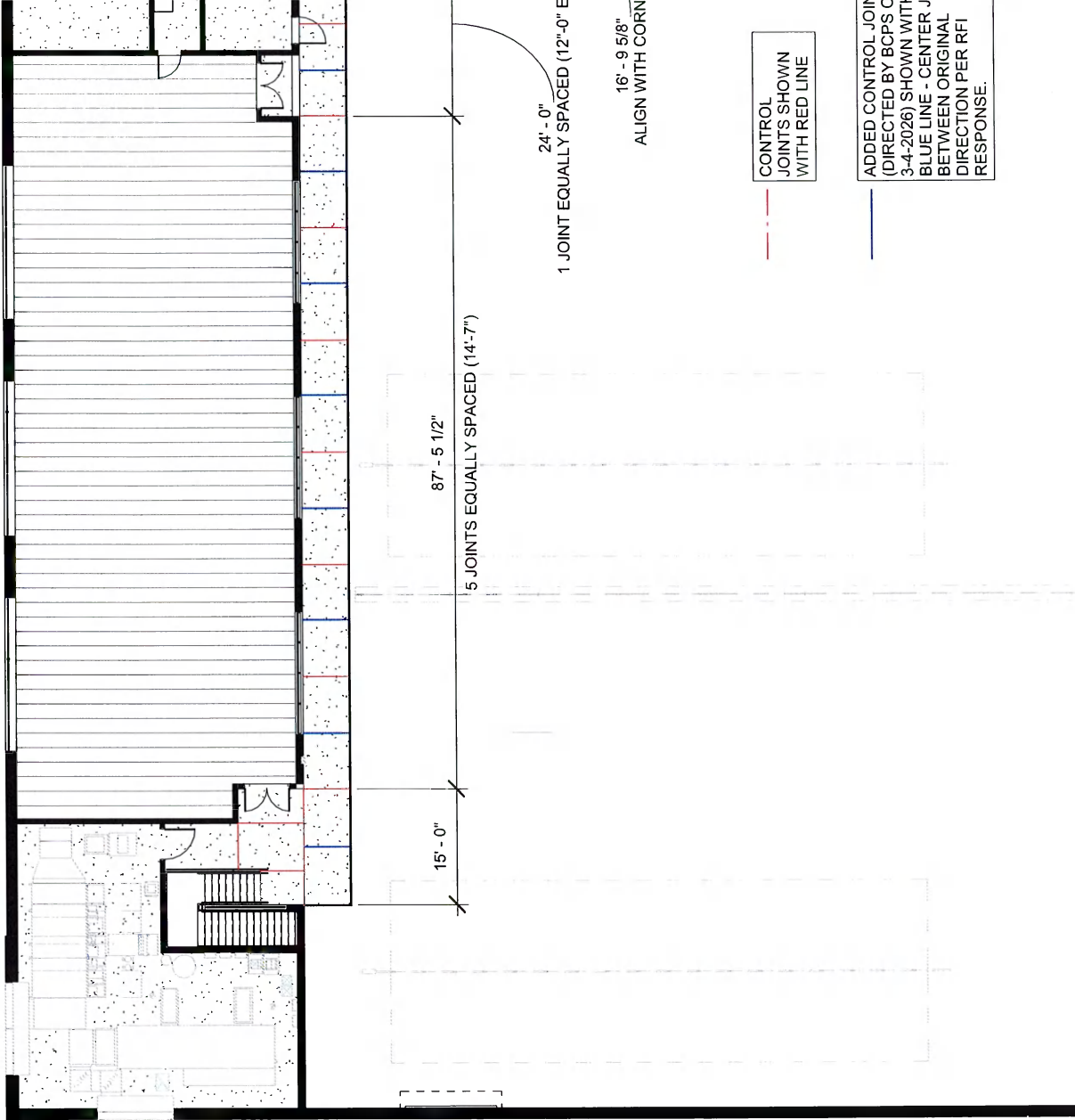

24'-0"
1 JOINT EQUALLY SPACED (12'-0" E)

16'-9 5/8"
ALIGN WITH CORN

87'-5 1/2"
5 JOINTS EQUALLY SPACED (14'-7")

15'-0"

CONTROL JOINTS SHOWN WITH RED LINE

ADDED CONTROL JOINT (DIRECTED BY BCPS C 3-4-2026) SHOWN WITH BLUE LINE - CENTER J BETWEEN ORIGINAL DIRECTION PER RFI RESPONSE.

Lyons, Tonya

From: Vanderside, Sarah
Sent: Tuesday, February 17, 2026 9:29 AM
To: Siscoe, Brad
Cc: LaMaster, Chad; Pittard, Joel; Goad, Grant; Lyons, Tonya; Barger, Brent
Subject: RE: Bullitt Central pour schedule

Categories: FIELDHOUSES Pricing

The additional cost for the bulkheads at all the control joints is \$11,050.00.

Any additional pours, beyond the originally planned (3) will be at a cost of \$6,325.00 each.

Sarah Vanderside | Project Manager

CALHOUN CONSTRUCTION SERVICES

Office: 502.493.1332

Cell: 502.275.9722

1703 S. Brook Street

Louisville, KY. 40208

www.calhounconstructs.com

From: Siscoe, Brad <BradSiscoe@calhounconstructs.com>
Sent: Tuesday, February 17, 2026 9:21 AM
To: Vanderside, Sarah <SarahVanderside@calhounconstructs.com>
Cc: LaMaster, Chad <chadlamaster@calhounconstructs.com>; Pittard, Joel <joelpittard@calhounconstructs.com>; Goad, Grant <grantgoad@calhounconstructs.com>; Lyons, Tonya <TonyaLyons@calhounconstructs.com>
Subject: Bullitt Central pour schedule

This is our pour schedule for Bullitt Central Second floor. If anything changes, there will be added cost.

Bradley Siscoe – General Superintendent

CALHOUN CONSTRUCTION SERVICES

Office: 502.493.1332

Cell: 812-707-1074

1703 S. Brook Street

Louisville, KY. 40208

www.calhounconstructs.com

Lyons, Tonya

From: Brent Murphy <brent@professionalsealantsinc.com>
Sent: Wednesday, February 18, 2026 7:08 AM
To: Lyons, Tonya
Subject: Re: BE and BC PSC - RFI#26 Clarification

This message needs your attention

- This is their first email to you.

Mark Safe

Report

Powered by Mimecast

Tonya,

RFI#26 - Bullitt East - \$950

RFI#26 - Bullitt Central - \$950

Thanks,

Brent Murphy

Project Manager

Professional Sealants, Inc.

3776 Old Madison Pike

Ft Wright, KY. 41017

Cell: 812-584-3765

From: Lyons, Tonya <TonyaLyons@calhounconstructs.com>

Sent: Tuesday, February 17, 2026 12:51 PM

To: Brent Murphy <brent@professionalsealantsinc.com>

Cc: Lyons, Tonya <TonyaLyons@calhounconstructs.com>

Subject: FW: BE and BC PSC - RFI#26 Clarification

Hi Brent... can you please send pricing for the joint sealants at the added controls joints shown on each building attached? I need the costs separated.

Thanks,

Tonya Lyons

Assistant Project Manager

CALHOUN CONSTRUCTION

1703 S. Brook Street
Louisville, KY 40208
Office (502)493-1332
Cell (770)241-9227



From: Lyons, Tonya <TonyaLyons@calhounconstructs.com>
Sent: Monday, February 16, 2026 1:21 PM
To: Vanderside, Sarah <SarahVanderside@calhounconstructs.com>
Cc: Pittard, Joel <joelpittard@calhounconstructs.com>; Goad, Grant <grantgoad@calhounconstructs.com>; Phillips, CJ <cjphillips@calhounconstructs.com>; Barger, Brent <brentbarger@calhounconstructs.com>; Lyons, Tonya <TonyaLyons@calhounconstructs.com>
Subject: FW: BE and BC PSC - RFI#26 Clarification

Sarah... please see attached following up to the RFI #26 response. Send pricing as needed.

Thanks,

Tonya Lyons

Assistant Project Manager
CALHOUN CONSTRUCTION
1703 S. Brook Street
Louisville, KY 40208
Office (502)493-1332
Cell (770)241-9227



From: Cate Noble Ward <Cate@studiokremer.com>
Sent: Monday, February 16, 2026 1:20 PM
To: Goad, Grant <grantgoad@calhounconstructs.com>; Lyons, Tonya <TonyaLyons@calhounconstructs.com>
Cc: Amy Hagan <ahagan@bkse.net>; Sam Clinard <sclinard@bkse.net>; Phillips, CJ <cjphillips@calhounconstructs.com>; Barger, Brent <brentbarger@calhounconstructs.com>
Subject: BE and BC PSC - RFI#26 Clarification

Grant,

To confirm here, control joints shown in the wrestling room per my response to RFI #26 can be omitted. Updated plans of both facilities are attached for your use.

Cate Noble Ward, AIA, LEED AP

Architect | Partner



studio kremer architects

1231 S Shelby St, Louisville KY 40203

TEL 502.499.1100 x2583

FAX 502.499.1101

studiokremer.com

From: Calhoun Construction Services <Calhoun_Construction_Services@procoretech.com>

Sent: Sunday, February 15, 2026 6:03 AM

To: Cate Noble Ward <Cate@studiokremer.com>

Subject: You have 1 overdue RFI

Calhoun Construction Services



DO NOT REPLY TO THIS EMAIL

This is a notification sent from an unmonitored email address.

1 RFI assigned to you is overdue.

To respond to this RFI, click on the link in this email or send a reply to the original email notification.

Overdue RFI (1 of 1)

RFI #26 was due on Friday, February 13, 2026.

QUESTION

Asked By:

Tonya Lyons (Calhoun Construction Services)

Date:

Thu Feb 5, 2026 at 11:20 am EST

Question:

The joints on the second-floor topping slabs are delineated "CJ". There are no specific joint details provided for the topping slab. Detail L/S3.1 depicts (2) joint options for construction joints and (2) joint options for contraction joints. Calhoun Concrete suggests using the option for stay in

place pour stop, (labeled number 4 on attached sheet). Please advise if this is acceptable.

Attachments: [Bullitt East - 2nd Floor Joint RFI.pdf](#)
[Bullitt Central - 2nd Floor Joint RFI.pdf](#)

All Replies

Answered By: Amy Hagan (Brown & Kubican, PSC)

Date: Mon Feb 9, 2026 at 03:13 pm EST

Response: Detail L/S3.1 does not apply to topping slabs, only slabs on grade.

Sawn contraction joints are not permitted, and the following shall be implemented during construction:

- Construction joints must be formed and welded wire fabric must be continuous through the joint
- Sections between construction joints should be poured alternately, with at least a week gap between pours
 - For example, every other section can be done in pour 1 and the remaining will be completed in pour 2 (this is an example, exact construction technique is a contractor means and methods item)

SKA, please advise if the same joint pattern used at North Bullitt (attached for reference) is your preferred layout, or if you would like to make revisions.

Attachments: [NBHS Control Joints - 2nd Level - Proposed by SKA.pdf](#)

ADDITIONAL DETAILS

Project: Bullitt Central HS Physical Science Center

Subject: 2nd Floor Concrete Joints (BHCS and BEHS) - PLEASE EXPEDITE

Date Initiated: 02/05/26

Created By: Tonya Lyons (Calhoun Construction Services)

Assigned To: Ward, Cate Noble (Studio Kremer Architects)

Responsible Contractor: Calhoun Construction Services

Received From: Sarah Vanderside (Calhoun Construction Services)

Distribution List: **Barger, Brent (Calhoun Construction Services)**
Goad, Grant (Calhoun Construction Services)
Hagan, Amy (Brown & Kubican, PSC)
Phillips, CJ (Calhoun Construction Services)
Pittard, Joel (Calhoun Construction Services)

Link: <https://app.procore.com/3220214/project/rfi/show/25541702>

Powered By Procore | support@procore.com | <https://support.procore.com>

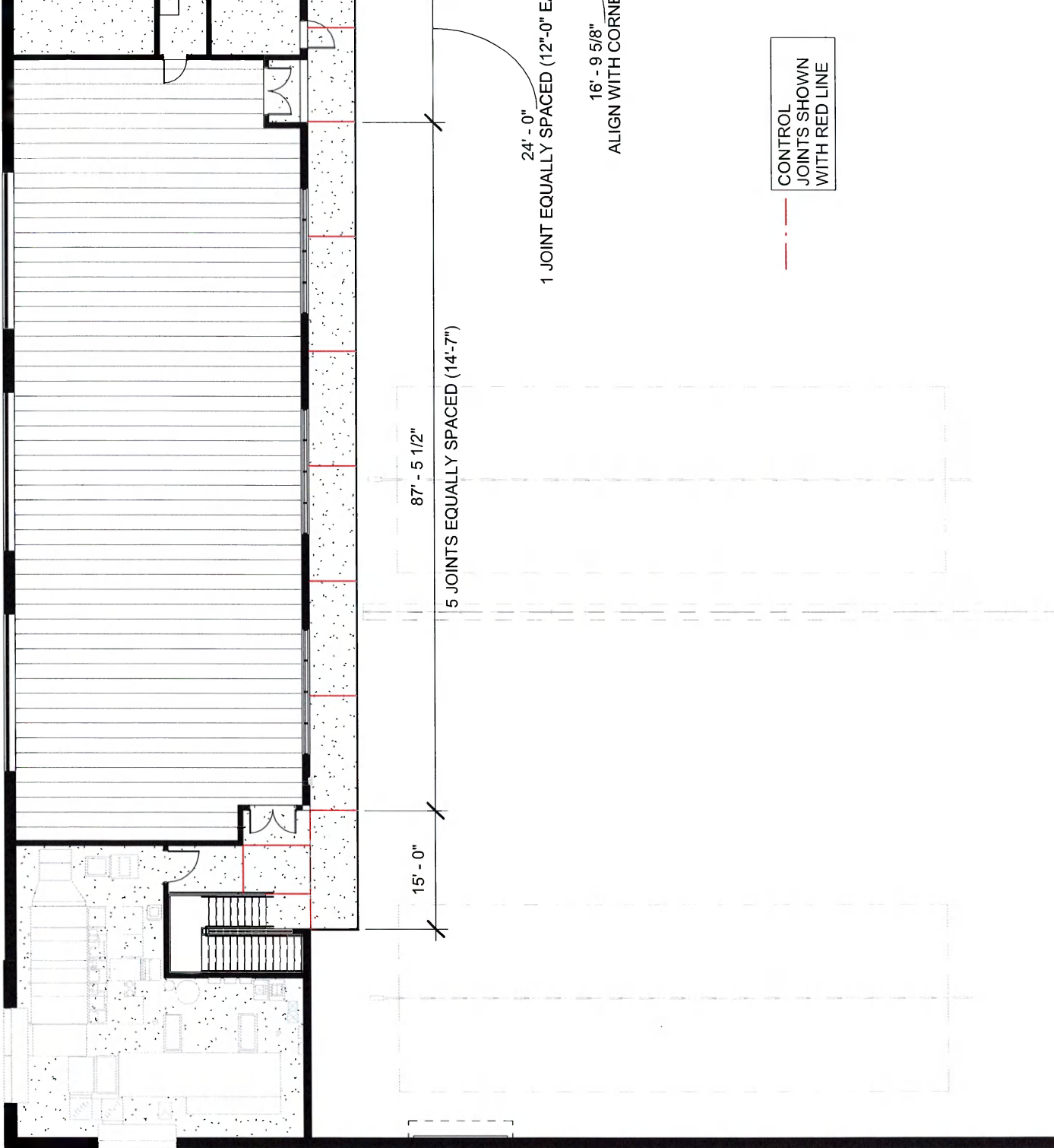

15'-0"

87'-5 1/2"

5 JOINTS EQUALLY SPACED (14'-7")

24'-0"
1 JOINT EQUALLY SPACED (12'-0" E)

16'-9 5/8"
ALIGN WITH CORNER

CONTROL
JOINTS SHOWN
WITH RED LINE

