



Kenton County School District | It's about ALL kids.

Issue Paper

DATE:

01/21/2026

AGENDA ITEM (ACTION ITEM):

Consider / Approve the design development plans for the Taylor Mill Elementary renovation project (BG 26-253) from Emboss Design.

APPLICABLE BOARD POLICY:

01.1 Legal Status of the Board; 04.31 Authority to Encumber and Expend Funds; 702 KAR 4:160

HISTORY/BACKGROUND:

The Design Development (DD) plans for the Taylor Mill Elementary renovation project reflects the input of the KCS D team, architects from Emboss Design, civil engineers from Bayer Becker, and mechanical engineers from CMTA Engineering. The project is focused on HVAC upgrade/replacement, roof replacement, and interior and exterior renovations. There have been no significant changes from the schematic design approved by the Board on January 5, 2026 to the currently proposed design development documents and the estimated construction cost remains at \$15,000,000.

FISCAL/BUDGETARY IMPACT:

Estimated project cost of \$18,135,000.00 (\$15,000,000.00 estimate for actual construction costs).

RECOMMENDATION:

Approve the design development plans for the Taylor Mill Elementary renovation project (BG 26-253) from Emboss Design.

CONTACT PERSON:

Matt Rigg, Chief Operations Officer

Principal/Administrator

Matthew Rigg
District Administrator

Superintendent

THIS DOCUMENT AND THE DESIGN AND DIMENSIONS INCORPORATED HEREIN, AS AN INSTRUMENT OF PROFESSIONAL SERVICE, IS THE PROPERTY OF EMBOSSED DESIGN, P.S.C. AND IS NOT TO BE REPRODUCED OR TRANSMITTED IN ANY FORM OR BY ANY MEANS, ELECTRONIC OR MECHANICAL, WITHOUT THE WRITTEN AUTHORIZATION OF EMBOSSED DESIGN, P.S.C. COPYRIGHT 1988-2025 EMBOSSED DESIGN, P.S.C. ALL RIGHTS RESERVED.

P:\2025\PR2025-073-TAYLOR MILL ELEMENTARY\05-DETAILED\05-ARCHITECTURAL SITE PLAN

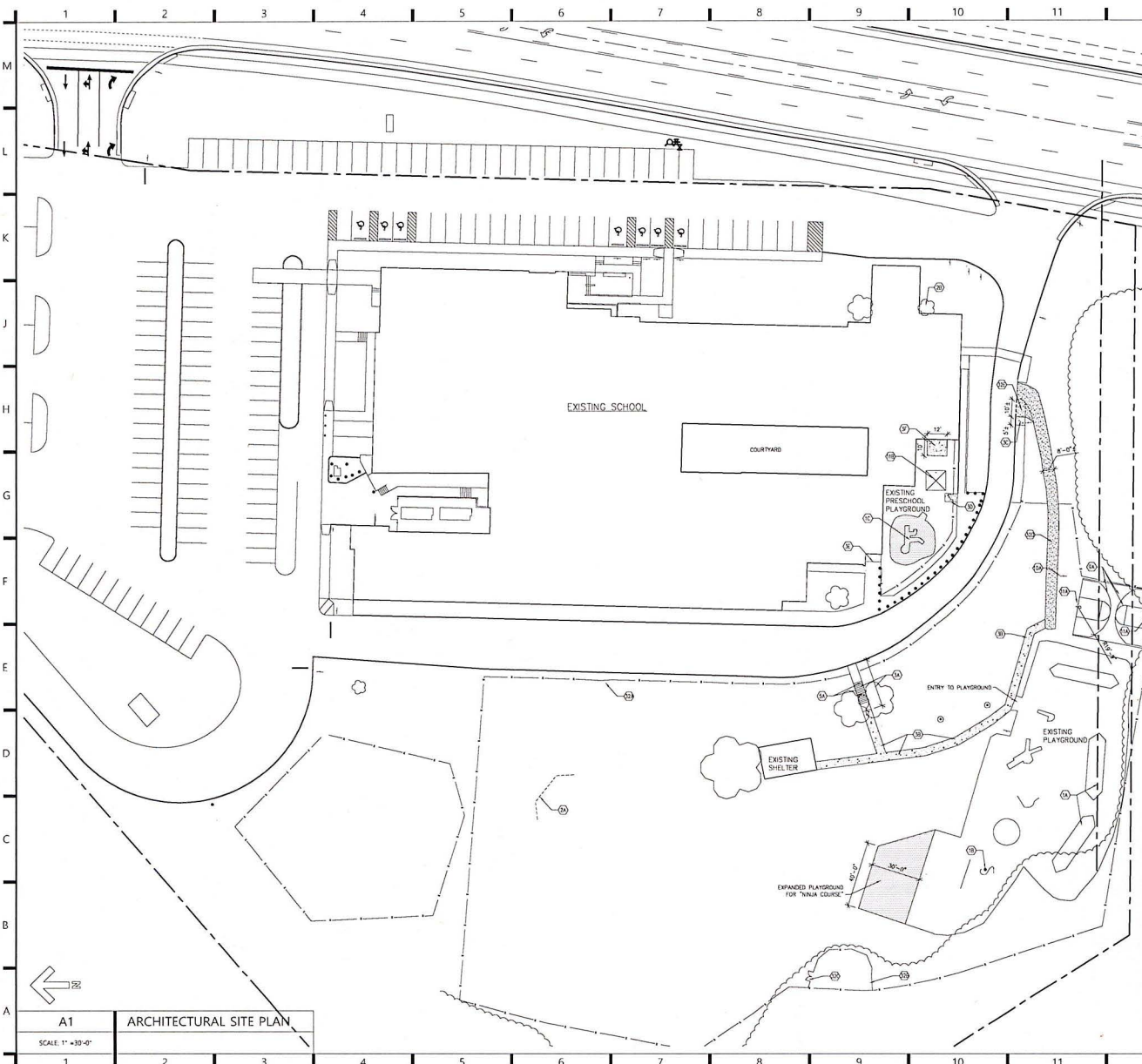

CONSTRUCTION NOTES

- 1A SWING SETS TO BE REMOVED BY GENERAL CONTRACTOR. NEW SWINGSETS TO BE PROVIDED & INSTALLED BY OWNER'S PLAYGROUND VENDOR.
- 1B CLIMBING POLE TO BE REMOVED BY GENERAL CONTRACTOR - VERIFY ITEM WITH OWNER PRIOR TO REMOVAL. NEW CLIMBING POLE TO BE PROVIDED & INSTALLED BY OWNER'S PLAYGROUND VENDOR.
- 1C PLAYGROUND EQUIPMENT AND MULCH TO BE REMOVED BY GENERAL CONTRACTOR. NEW PLAYGROUND EQUIPMENT TO BE PROVIDED BY OWNER'S PLAYGROUND VENDOR.
- 2A DEMO CHAINLINK FENCE BACKSTOP.
- 2B REMOVE TREE AND STUMP. BACKFILL HOLE WITH TOPSOIL AND SEED/STRAW.
- 3A DEMO EXISTING STAIRS AND LANDING PADS. PROVIDE NEW CONCRETE STAIRS (12" TREAD, MAX. 4" RISER, QUANTITY AS REQUIRED BY GRADE) AND LANDINGS TO MATCH EXISTING. STAIRS TO BE MIN. 5'-0" WIDE.
- 3B NEW 5'-0" WIDE, MIN. 4" THICK CONCRETE SIDEWALK OVER 4" DENSE GRADED COMPACTED AGGREGATE BASE. PROVIDE CONTROL JOINTS AT MAX. 5'-0" O.C. AND CONTROL JOINTS MAX. 30'-0" O.C.
- 3C REMOVE SECTION OF CONCRETE WALK (CURB TO REMAIN) TO CONTROL JOINT. PROVIDE NEW CONCRETE WALK (MATCH EX. THICKNESS, MIN. 4") SLOPED DOWN TO ASPHALT DRIVE.
- 3D NEW 5'-0" WIDE MIN. 4" THICK CONCRETE PAVING OVER 4" DENSE GRADED COMPACTED AGGREGATE BASE AT DATE. EXTEND 5'-0" BEYOND GATE IN PLAY AREA. OWNER TO PROVIDE RAMP TO TRANSITION TO MULCH.
- 3E GRIND DOWN UNLEVEL SIDEWALK FLUSH WITH ADJACENT SECTION OF SIDEWALK.
- 3F NEW MIN. 4" THICK CONCRETE PAD OVER 4" DENSE GRADED COMPACTED AGGREGATE BASE, CENTER ALONG WALL.
- 5A PROVIDE GALVANIZED 1-1/2" DIA. SCH. 40 PIPE HANDRAIL EACH SIDE OF STAIR. TOP OF HANDRAIL AT 36" EXTEND HANDRAIL 12" BEYOND TOP AND BOTTOM OF STAIRS AND RETURN TO POST. CORE DRILL AND SET VERTICAL POSTS IN NON-SHRINK, NON-METALLIC GROUT WITH SEALANT WASH.
- 6A PRESSURE WASH AND SEAL EXISTING CONCRETE PAVING. PAINT (WHITE) NEW 3-POINT ARC AND KEY STRIPING (2" WIDE) AS INDICATED.
- 10A REPLACE SIGN AND POST WITH NEW TO MATCH EXISTING (SEE PICTURE 1). SET IN CONCRETE.
- 11A REMOVE EXISTING BASKETBALL BACKBOARD/POLE/FOUNDATION. PROVIDE NEW ADJUSTABLE HEIGHT BACKBOARD, GOAL, AND STEEL POST (BASIS OF DESIGN TO BE "THIN GOLD" BY PRO DUNK). WRAP POST WITH EXTERIOR RATED PAINTING UP TO 6'-0".
- 11B 12'-0"x12'-0" EAVE OFFSET SINGLE POST PYRAMID SHADE SHELTER. BASIS OF DESIGN = SHADE SYSTEMS WITH COLNET SHADE FABRIC OR APPROVED EQUAL. PARKINATION, INC. - WARMY SANDRIES 204 LEEDS DR. VALPARAISO, IN 46383 [HTTPS://SHADESYSTEMS.COM](https://shade-systems.com) [HTTPS://PARKINATION.COM](https://parkination.com) STRUCTURE SHALL BE DESIGNED & ENGINEERED BY FABRIC SHADE MANUF. FOUNDATION DESIGN SHALL BE BY FABRIC SHADE SHELTER MANUF. (APPROX. SIZE = 36" DIA. X 54" DEEP WITH (12) #6 VERTICAL BARS AND #3 HOOPS AT 12" O.C. VERT. TOP OF CONCRETE SHALL BE 8" BELOW TO OF GRADE. COLOR OF FABRIC & POST AS SELECTED BY OWNER. INSTALLATION OF ALL ITEMS BY THE GENERAL CONTRACTOR. PROVIDE A 20-YEAR WARRANTY ON THE POST AND STRUCTURAL FRAME. PROVIDE A 10-YEAR WARRANTY ON THE FABRIC. PROVIDE A 1-YEAR WARRANTY ON ALL OTHER ITEMS. COORDINATE LOCATION WITH OWNER & ARCHITECT.
- 32A INFILL FENCE OPENING (6'-0" WIDE) W/ NEW BLACK VINYL CHAINLINK FENCE TO MATCH EXISTING INCLUDING HEIGHT (6'-0"±).
- 32B INFILL FENCE OPENING (10'-0"± WIDE) WITH NEW BLACK VINYL CHAINLINK FENCE TO MATCH EXISTING INCLUDING HEIGHT (4'-0"±).
- 32C INFILL FENCE OPENING (10'-0"± WIDE) WITH NEW BLACK VINYL CHAINLINK FENCE WITH (2) 3'-0"± WIDE GATES TO MATCH EXISTING INCLUDING HEIGHT (4'-0"±).
- 32D REMOVE EXISTING ASPHALT DRIVE INCLUDING ANY ASSOCIATED AGGREGATE BASE. PROVIDE NEW ASPHALT DRIVE TO MATCH EXISTING WIDTH (MINIMUM). NEW DRIVE TO BE:
 1. KDOT ITEM 441,402 2" ASPHALT CONCRETE SURFACE COURSE TYPE 1
 2. KDOT ITEM 407 TACK COAT
 3. KDOT ITEM 401, 403 2" ASPHALT BINDER COURSE TYPE 2
 4. KDOT ITEM 303 8" MIN CRUSHED STONE
- 32E REMOVE TWO SECTIONS OF CONCRETE SIDEWALK AND CURB TO WIDEN CURB CUT. PROVIDE NEW ASPHALT DRIVE PER NOTE 32D. PATCH EXISTING ASPHALT DRIVE AS REQUIRED TO RESTORE TO UNDAMAGED CONDITION.



PICTURE 1



EmbosDesign.com 306 Warrumbeth Street
(659)431-8612 Newport, KY 41071

NOT FOR CONSTRUCTION

ISSUE	NO.	DATE	DESCRIPTION

Renovations to
**TAYLOR MILL
ELEMENTARY SCHOOL**
5907 Taylor Mill Rd.
Covington, KY 41015

ARCHITECTURAL SITE PLAN

2025-073

AS100

THIS DOCUMENT AND THE DATA AND INFORMATION CONTAINED HEREIN ARE THE PROPERTY OF EMBOSSE DESIGN, INC. AND ARE NOT TO BE REPRODUCED OR TRANSMITTED IN ANY FORM OR BY ANY MEANS, ELECTRONIC OR MECHANICAL, INCLUDING PHOTOCOPYING, RECORDING, OR BY ANY INFORMATION STORAGE AND RETRIEVAL SYSTEM, WITHOUT THE WRITTEN PERMISSION OF EMBOSSE DESIGN, INC. ALL RIGHTS RESERVED.

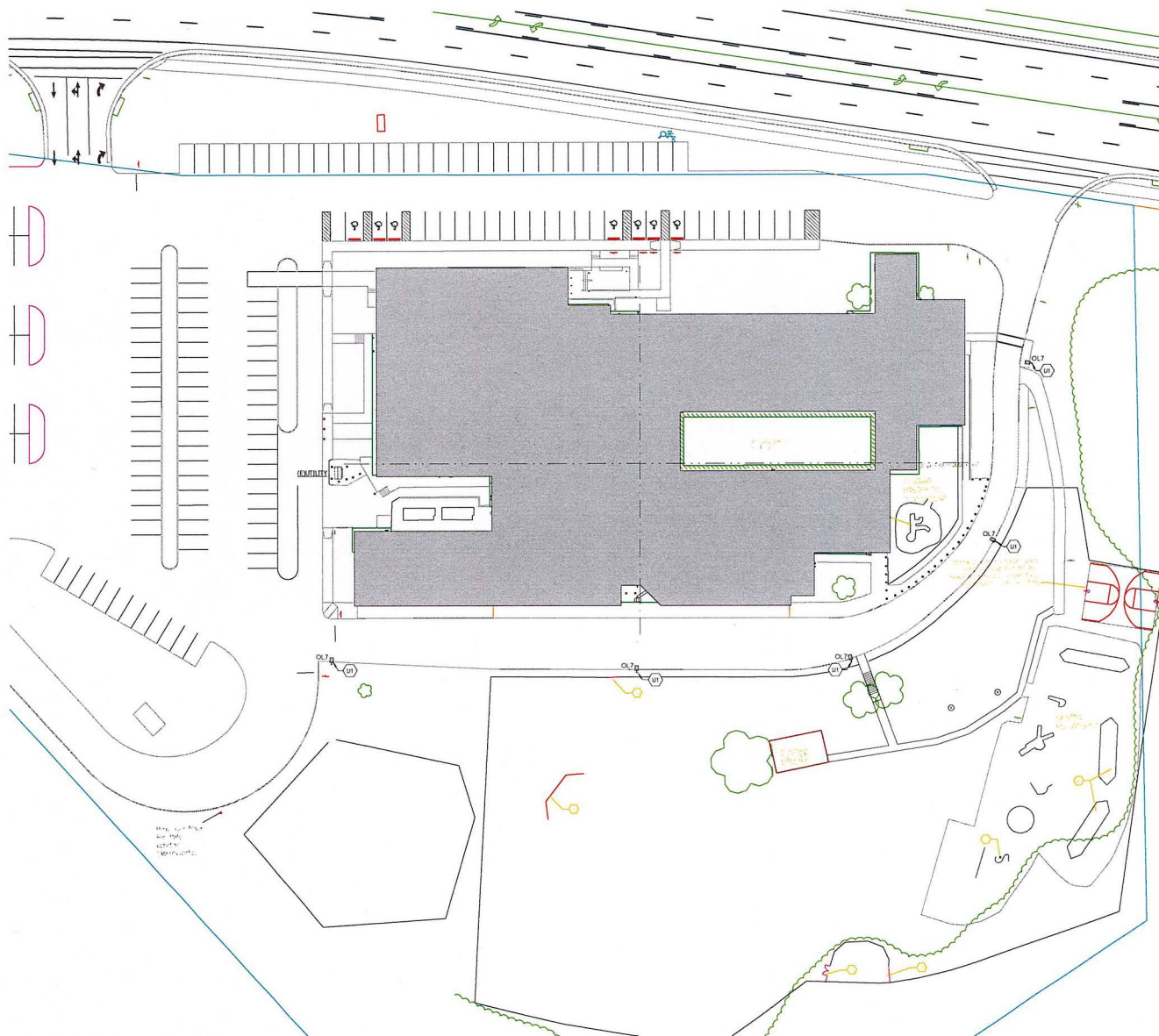

TAGGED NOTES

U1 REPLACE IN PLACE EXISTING POLE-MOUNTED LIGHTING AT BUS LANE. UTILIZE EXISTING BASE. MAINTAIN EXISTING CIRCUITING AND CONTROL. PROVIDE NEW POLE AND LUMINAIRE HEAD AS NOTED IN LUMINAIRE SCHEDULE.



EmbossDesign.com 606 Monmouth Street,
(888)431-8612 Newport, KY 41071

**NOT FOR
CONSTRUCTION**

Taylor Mill Elementary School

5907 Taylor Mill Rd.
Covington, KY 41015

NO.	DESCRIPTION	DATE
	Design Development	01/20/25

ELECTRICAL SITE PLAN

OKCS25-03

ES001



THE CONTRACTOR AND ALL SUBCONTRACTORS SHALL CONTACT "KENTUCKY 811" BEFORE YOU DIG AT 1-800-362-2764 OR 811 TO OBTAIN UNDERGROUND UTILITY LOCATIONS PRIOR TO ANY CONSTRUCTION. ANY CONTRACTOR OR SUBCONTRACTOR PERFORMING ANY TYPE OF EXCAVATION ON THIS PROJECT TO OBTAIN AN AUTHORIZATION NUMBER.

PRINT DATE: 1/16/2025 2:22:24 PM

THIS DOCUMENT AND THE DESIGN INFORMATION CONTAINED HEREIN ARE THE PROPERTY OF EMBOSSE DESIGN, INC. AND ARE NOT TO BE REPRODUCED, COPIED, OR TRANSMITTED IN ANY FORM OR BY ANY MEANS, ELECTRONIC OR MECHANICAL, INCLUDING PHOTOCOPYING, RECORDING, OR BY ANY INFORMATION STORAGE AND RETRIEVAL SYSTEM, WITHOUT THE WRITTEN AUTHORIZATION OF EMBOSSE DESIGN, INC. ALL RIGHTS ARE RESERVED.

PLUMBING FIXTURE SCHEDULE									
TAG	DESCRIPTION	MANUFACTURER	MODEL	FAUCET/VALVE MANUFACTURER	ACTIVATION	CW	HW	SAN	VENT
EW1	ELECTRIC WATER COOLER	ELKAY	L20BWSK	-	-	1/2"	-	1-1/2"	1-1/2"
HB1	RESTROOM HOSE BIBB	-	-	ZURN	1339AL	-	3/4"	-	-
LV1	WALL HUNG LAVATORY	AMERICAN STANDARD	0356.015	AMERICAN STANDARD	1340.119	METERING	1/2"	1/2"	1-1/2"
LV2	WALL HUNG LAVATORY - CHILD HEIGHT	AMERICAN STANDARD	0356.015	AMERICAN STANDARD	1340.119	METERING	1/2"	1/2"	1-1/2"
LV3	LAVATORY ACCESSORIES	-	-	AMERICAN STANDARD	1340.119	METERING	1/2"	1/2"	-
LV4	WALL HUNG LAVATORY	AMERICAN STANDARD	0356.015	AMERICAN STANDARD	5502.175	MANUAL	1/2"	1/2"	1-1/2"
MS1	MOP SINK	FIAT	M582404	FIAT	830AA	MANUAL	3/4"	3/4"	1-1/2"
SK1	STAINLESS STEEL SINK	ELKAY	ELUHAD13165SD	CHICAGO FAUCETS	786-F3805-SABCP	MANUAL	1/2"	1/2"	2"
UR1	WALL HUNG URINAL	AMERICAN STANDARD	6590.001	SLOAN	60455.051	BATTERY	3/4"	-	2"
UR2	WALL HUNG URINAL - ADA	AMERICAN STANDARD	6590.001	SLOAN	60455.051	BATTERY	3/4"	-	2"
WC1	WALL HUNG WATER CLOSET	AMERICAN STANDARD	2257.101	SLOAN	111 SP5N-L6	BATTERY	1-1/4"	-	2"
WC2	WALL HUNG WATER CLOSET - ADA	AMERICAN STANDARD	2257.101	SLOAN	111 SP5N-L6	BATTERY	1-1/4"	-	2"
WC3	WALL MOUNT WATER CLOSET - ADA	AMERICAN STANDARD	2257.101	SLOAN	111-L6	MANUAL	1-1/4"	-	4"

PLUMBING DRAIN SCHEDULE					
TAG	DESCRIPTION	MANUFACTURER	MODEL	SAN	VENT
FD1	RESTROOM FLOOR DRAIN	ZURN	2145N	3"	1-1/2"

WATER HEATER SCHEDULE									
TAG	DESCRIPTION	MANUFACTURER	MODEL	CAPACITY (GAL.)	ELECTRIC	NATURAL GAS	GPH AT 90F RISE	EXPANSION TANK	NOTES
WH1	GAS FIRED TANK WATER HEATER	AO SMITH	B1A-199	100	120V	199 CFH	261	AMTROL	-
WH2	GAS FIRED TANK WATER HEATER	AO SMITH	B1A-199	100	120V	199 CFH	261	-	UNITS SHARE ONE EXPANSION TANK

RECIRCULATION PUMP SCHEDULE				
TAG	DESCRIPTION	MANUFACTURER	MODEL	DESIGN CRITERIA
RPT	-	-	-	-

HAZARDOUS MATERIAL NOTE:

- A. THE CONTRACTOR IT IS HEREBY ADVISED THAT IT IS POSSIBLE THAT ASBESTOS AND/OR OTHER HAZARDOUS MATERIALS MAY BE PRESENT IN THIS BUILDING(S). ANY WORKER, OCCUPANT, VISITOR, ETC., WHO ENCOUNTERS ANY MATERIAL OF WHOM DUBTMENT THEY ARE NOT CERTAIN SHALL IMMEDIATELY REPORT THE EXISTENCE AND LOCATION OF THAT MATERIAL TO THE OWNER. FURTHERMORE, THE CONTRACTOR SHALL INSURE THAT NO ONE COMES NEAR TO OPEN CONTACT WITH ANY SUCH MATERIAL, OR FUMES THEREFROM UNTIL ITS CONTENT CAN BE ASCERTAINED TO BE NON-HAZARDOUS.
- B. CMIA, INC. HAS NO EXPERTISE IN THE DETERMINATION OF THE PRESENCE OF ANY HAZARDOUS MATERIAL. THEREFORE, NO ATTEMPT HAS BEEN MADE BY CMIA TO DETERMINE THE EXISTENCE OR LOCATION OF ANY SUCH HAZARDOUS MATERIAL. FURTHERMORE, CMIA NOR ANY AFFILIATE HEREOF WILL NOT OFFER OR MAKE ANY RECOMMENDATIONS RELATIVE TO THE REMOVAL, HANDLING OR DISPOSAL OF SUCH MATERIAL.
- C. IF THE WORK INVOLVES TO BE PERFORMED INTERFACES, CONNECTIONS OR RELATES IN ANY PHYSICAL WAY WITH OR TO EXISTING COMPONENTS WHICH CONTAIN OR BEAR ANY HAZARDOUS MATERIAL, ASBESTOS BEING ONE, THEN IT SHALL BE THE CONTRACTOR'S SOLE RESPONSIBILITY TO CONTACT THE OWNER AND SO ADVISE HIM/HER IMMEDIATELY.
- D. THE CONTRACTOR BY EXECUTION OF THE CONTRACT FOR ANY WORK, AND/OR BY THE ACCEPTANCE OF ANY WORK THEREBY AGREES TO BRING NO CLAIM RELATIVE TO HAZARDOUS MATERIALS FOR NEGLIGENCE, BREACH OF CONTRACT, NEGLIGENCE, OR ANY OTHER SUCH ITEM AGAINST CMIA, ITS PRINCIPALS, EMPLOYEES, AGENTS OR CONSULTANTS. ALSO, THE CONTRACTOR FURTHER AGREES TO DEFEND, INDEMNIFY AND HOLD CMIA, ITS PRINCIPALS, EMPLOYEES, AGENTS AND CONSULTANTS HARMLESS FROM ANY SUCH RELATED CLAIMS WHICH MAY BE BROUGHT BY ANY SUBCONTRACTORS, SUPPLIERS OR ANY OTHER THIRD PARTIES.
- E. THE CONTRACTOR IS DIRECTED TO THE SPECIFICATIONS FOR FURTHER INFORMATION.

PHASING NOTE:

- A. THIS PROJECT INVOLVES EXTENSIVELY WITH EXISTING BUILDING SERVICES. IT SHALL BE THE CONTRACTOR'S RESPONSIBILITY TO COORDINATE AND PHASE ALL THE WORK AND INTERUPTIONS OF EXISTING SERVICES TO MINIMIZE OR ELIMINATE DOWNTIME. AS AN EXAMPLE, MAIN GAS SERVICE, WATER SERVICE, ELECTRICAL SERVICE, HVAC SERVICES, STEAM GENERATION, ETC. WILL BE AFFECTED AND REPLACED OR MOVED DURING THIS PROJECT. THE CONTRACTOR SHALL INSTALL ALL NEW SERVICES AND EQUIPMENT AND HAVE THEM TESTED AND FULLY AND RELIABLY FUNCTIONAL PRIOR TO INTERRUPTING, RELOCATING OR REMOVING ANY EXISTING SERVICES. IT SHALL BE THE CONTRACTOR'S RESPONSIBILITY TO BARE ANY AND ALL COSTS ASSOCIATED WITH THIS PHASING, INCLUDING TEMPORARY SERVICES, TEMPORARY RELOCATION, PREMIUM TIME WORK, ETC. CONTRACTOR SHALL COORDINATE ALL SMOKE WORK WITH THE OWNER AND APPLICABLE UTILITIES PER THE CONTRACT DOCUMENTS.

PLUMBING DEMOLITION NOTES:

- A. THE CONTRACTOR SHALL REFER TO THE ARCHITECTURAL PLANS FOR AREAS IN WHICH THE CEILING IS REMOVED. THE CONTRACTOR IS RESPONSIBLE FOR REMOVING THE EXISTING CEILING AS REQUIRED AND REINSTALLATION, TEMPORARY SUPPORT LIGHTS, DIFFUSERS, CEILING ETC. REPLACE BROKEN CEILING TILES WITH NEW AT NO ADDITIONAL COST TO OWNER. FIELD VERIFY EXACT REQUIREMENTS.
- B. ALL OUTAGES SHALL BE SCHEDULED THROUGH THE PROJECT REPRESENTATIVE FOR PROPER COORDINATION. A REQUEST FOR AN OUTAGE SHALL BE SUBMITTED IN WRITING A MINIMUM OF TWO WEEKS IN ADVANCE.
- C. DURING SPRINKLER SYSTEM OUTAGES THE CONTRACTORS SHALL PROVIDE FIRE WATCH OF AREAS WITH OUTAGE.
- D. ALL WALLS AND FLOOR SLABS SHALL BE REPAIRED TO MATCH EXISTING AND TO A NEW CONDITION. ALL WATER AND FLOOR SLAB SHALL BE PATCHED AND REPAIRED TO MAINTAIN FINISH.
- E. ALL EXISTING BUILDING FINISHES SHALL BE PROTECTED DURING THE DEMOLITION PHASE.
- F. HEAVY DASHED LINES INDICATE ITEMS FOR REMOVAL (L.O.N) AND LIGHT SOLID LINES INDICATE EXISTING ITEMS TO REMAIN.
- G. COORDINATE DISPOSAL OF ALL FIXTURES, SERVICES, ETC. (INDICATED FOR DEMOLITION) WITH THE OWNER.

SYMBOLS & ABBREVIATIONS

A, AIR	MEDICAL AIR	POINT OF CONNECTION
AFF	ABOVE FINISHED FLOOR	LIMIT OF DEMOLITION
AFR	ABOVE FINISHED ROOF	PIPE ELBOW TURNING UP/TURNING DOWN
C1	CAST IRON	PIPE TEE TURNING UP/TURNING DOWN
CO2	CARBON DIOXIDE	MEDICAL AIR
CW	DOMESTIC COLD WATER	COMPRESSED AIR
DN	DOWN	FORCED MAIN
EV	EVACUATION (WASTE ANESTHETIC GAS DISPOSAL)	FIRE PROTECTION LINE
FHV	FIRE HOSE VALVE WITH CABINET	GAS LINE
FWH	FREEZE PROOF WALL HYDRANT	SANITARY WASTE PIPING TO GREASE TRAP
HB	HOSE BIBB	OXYGEN PIPING
HW	DOMESTIC HOT WATER	OVERFLOW STORM PIPING
HW	IN ACCORDANCE WITH	PRIMARY STORM PIPING
ID	INSIDE DIMENSION	SANITARY WASTE PIPING
IE	INVERT ELEVATION	STORM SEWER PIPING
LPA	LINE PRESSURE ALARM (MEDICAL GAS AREA ALARM)	VACUUM PIPING
MA	MANHOLE	VENT PIPING
MSH	MULTI-SHOCK ALARM (MEDICAL GAS MASTER ALARM)	EXISTING PIPING (THIN LINE)
NTS	NOT TO SCALE	ABANDONED EXISTING PIPING (THIN LINE)
NIC	NOT IN CONTRACT	DOMESTIC COLD WATER PIPING
NO	NORMALLY OPEN	DOMESTIC HOT WATER SUPPLY
NC	NORMALLY CLOSED	DOMESTIC RECIRCULATING HOT WATER
O, OX	OXYGEN	CLEANOUT IN CEILING SPACE
OD	OUTSIDE DIMENSION	FLOOR CLEANOUT
OFCI	OWNER FURNISHED, CONTRACTOR INSTALLED	EXTERIOR CLEANOUT
OFCD	OWNER FURNISHED, OWNER INSTALLED	BALANCING VALVE
OFCC	CONTRACTOR FURNISHED, CONTRACTOR INSTALLED	BALL VALVE
OR	OPEN RECEPTACLE	CIRCULATION PUMP
ORL	OVERFLOW ROOF LEADER	SAFETY RELIEF VALVE
PSI	PRESSURE REDUCING VALVE (STEAM, WATER, OR GAS)	OS&Y (GATE) VALVE
PSI	POUNDS PER SQUARE INCH	PRESSURE REDUCING VALVE (GAS, WATER, ETC.)
RHW	DOMESTIC RECIRCULATING HOT WATER	STRAINER
R	ROOF LEADER	CHECK VALVE
SCW	SOFT DOMESTIC COLD WATER	DOUBLE CHECK VALVE ASSEMBLY
SR	SANITARY RISER	PIPING UNION
TK	THRUST BLOCK	FLOOR DRAIN DESIGNATOR
TE	TOP ELEVATION	ROOF DRAIN DESIGNATOR
TYP	TRAP PRIMER	PLUMBING FIXTURE DESIGNATOR
TYP	TYPICAL	EQUIPMENT TAG DESIGNATOR
UN	UNLESS OTHERWISE NOTED	TAGGED NOTE DESIGNATOR
V, VAC	VACUUM	REVISION DESIGNATOR
VTR	VENT THRU ROOF	

PIPE LEGEND

DOMESTIC COLD WATER	DOMESTIC HOT WATER	DOMESTIC HOT WATER RECIRC	VENT	SANITARY	STORM	STORM OVERFLOW	NATURAL GAS
---------------------	--------------------	---------------------------	------	----------	-------	----------------	-------------

PLUMBING GENERAL NOTES:

- A. COORDINATE THE LOCATION OF DRAINS, GAS OUTLETS, PLUMBING FIXTURES, ETC., WITH ALL CASEWORK EQUIPMENT, MECHANICAL ROOM EQUIPMENT, ETC. PRIOR TO COMMENCING INSTALLATION. WORK NOT SO COORDINATED SHALL BE REMOVED AND PROPERLY INSTALLED AT THE EXPENSE OF THE CONTRACTOR.
- B. THE CONTRACTOR SHALL EXERCISE EXTREME CARE IN THE COURSE OF THEIR WORK SO AS TO ENSURE THAT THEY DO NOT INTERRUPT ANY EXISTING SERVICE. FOR SAFETY PURPOSES, THE CONTRACTOR SHALL PREPARE A PRELIMINARY PLAN TO NATURAL GAS AND ELECTRICAL LINES, VERIFY THE LOCATION, SIZE, TYPE, ETC., OF EACH UNDERGROUND OR OVERHEAD UTILITY. ALL WORK SHALL BE PERFORMED IN ACCORD WITH ALL FEDERAL, STATE AND/OR LOCAL RULES, REGULATIONS, STANDARDS AND SAFETY REQUIREMENTS. UTILITIES SHALL BE INSTALLED IN ACCORD WITH THE APPLICABLE MUNICIPALITY OR UTILITY COMPANY STANDARDS. IN ALL CASES, THE MOST STRINGENT REQUIREMENT SHALL APPLY.
- C. WHERE WORK IS REQUIRED ABOVE EXISTING LAYIN, PLASTER OR GYPSUM BOARD CEILINGS, THE CONTRACTOR SHALL BE RESPONSIBLE FOR REMOVAL AND REINSTALLATION OR REPLACEMENT, IF DAMAGED, OF ALL CEILING OR TILE AND GRID MEMBERS NECESSARY TO PERFORM HIS WORK. NEW TILE AND GRID SHALL MATCH THE SURROUNDING AREAS. ALL PATCHING WORK SHALL MATCH ADJACENT SURFACES.
- D. ALL NEW WORK SHALL BE HUNG FROM STRUCTURE, NOT FROM THE WORK OF OTHER TRADES, WHETHER EXISTING OR NEW.
- E. COORDINATE ALL WORK WITH ALL EXISTING PHASING REQUIREMENTS.
- F. PATCH, REPAIR AND PAINT OR PROVIDE WALL COVERING FOR TO OWNERS' STANDARDS. ALL DAMAGED CEILING, CEILING, ETC. THAT ARE TO REMAIN SHALL BE REPAIRED TO MATCH ADJACENT SURFACES TO THE SATISFACTION OF THE ARCHITECT AND OWNER.
- G. OBSERVE ALL APPLICABLE CODES, RULES AND REGULATIONS THAT MAY APPLY TO THE WORK UNDER THIS CONTRACT. (CITY, COUNTY, LOCAL, FEDERAL, MUNICIPALITY, UTILITY COMPANY, STATE, ETC.)
- H. CONTRACTOR SHALL BE AWARE OF UNSEEN PLUMBING WORK DURING DEMOLITION, IF ITEMS ARE UNCOVERED DURING DEMOLITION THEN FIELD VERIFY THE USE OF THE ITEMS AND PLAN AN ALTERNATE ROUTE TO RUN THESE ITEMS. THEN CONTACT THE ENGINEERS TO REVIEW THE ROUTING.
- I. IF AREA OF CONSTRUCTION HAS A POST TENSION FLOOR SLAB, CONTRACTOR SHALL USE ULTRA SOUND OR OTHER APPROVED METHODS TO DETERMINE THE EXISTING FLOOR STRUCTURE BEFORE MAKING ANY AND ALL FLOOR PENETRATIONS.
- J. WHERE FIRE PROOFING IS SPRIED ON EXISTING STRUCTURE ALL EXISTING CONDUITS, WATER, HYDRONIC, STEAM, CHILLED WATER, FIRE PROTECTION LINES, MED GAS, ETC. SHALL BE COVERED TO BE BELOW PLATE THICKNESS OF FIRE PROOFING WITH NO INTERFERENCE.
- K. ALL PENETRATIONS OF FIRE AND SMOKE RATED ASSEMBLIES SHALL BE APPROPRIATELY FIRE STOPPED PER AN APPROVED U.L. LISTED STANDARD. CONTRACTOR SHALL PAY PARTICULAR ATTENTION TO INSULATED PIPING PENETRATIONS.
- L. ALL WORK REQUIRING DOWNTIME OF ANY AREA IN THE BUILDING SHALL BE SCHEDULED 2 WEEKS IN ADVANCE, AND SHALL COMPLY WITH INTERIM LIFE SAFETY MEASURES.
- M. ALL PIPING IN ROOMS WITH CEILINGS SHALL BE ABOVE CEILING EXCEPT AS NOTED.
- N. LOCATIONS OF PIPING AND EQUIPMENT ARE APPROXIMATE AND SUBJECT TO MINOR ADJUSTMENT IN THE FIELD. DO NOT SCALE THE DRAWINGS.
- O. ALL OFFSETS IN PIPING ARE NOT NECESSARILY SHOWN. PROVIDE ADDITIONAL OFFSETS WHERE NECESSARY.
- P. THE CONTRACTOR IS RESPONSIBLE FOR ALL UTILITY COMPANY FEES OR OTHER COSTS THAT ANY UTILITY COMPANY MAY REQUIRE TO COMPLETE THEIR WORK. (GAS, SEWER, WATER, ETC.)
- Q. WHERE MOUNTING HEIGHTS ARE NOT INDICATED OR ARE IN CONFLICT WITH ANY OTHER BUILDING SYSTEM, CONSULT THE ENGINEERS BEFORE INSTALLATION. REFERENCE TO ARCHITECTURAL WALL INTERIOR AND EXTERIOR WALL ELEVATIONS, CEILING HEIGHTS AND OTHER DETAIL OF THIS DOCUMENT.
- R. ANY VIBRATING, OSCILLATING OR OTHER NOISE OR MOTION PRODUCING EQUIPMENT SHALL BE ISOLATED FROM SURROUNDING SYSTEMS IN AN APPROVED MANNER. NOISE OR STRUCTURALLY DAMAGING INSTALLATIONS SHALL BE SATISFACTORILY REPLACED OR REPAIRED AT THE INSTALLING CONTRACTOR'S EXPENSE. THE FINAL DECISION ON THE SUITABILITY OF A PARTICULAR INSTALLATION'S ACCEPTABILITY SHALL BE THAT OF THE ENGINEER.
- S. DIMENSIONS IN SIZE, CAPACITIES, FIT, FINISH, ETC. FOR EQUIPMENT FROM THAT USED AS BASIS OF DESIGN SHALL BE THE RESPONSIBILITY OF THE PURCHASER OF THAT EQUIPMENT. ANY DIMENSIONS REQUIRED TO ACCOMMODATE A DOWNSTEP, WHETHER APPROVED BY THE ENGINEERS OR NOT, SHALL BE THE RESPONSIBILITY OF THE PURCHASER.
- T. VALVES OR ANY MECHANICAL ACCESS SHALL NOT BE LOCATED ABOVE A HARD CEILING. IF THIS IS NOT POSSIBLE, THEN AN APPROXIMATELY SIZED ACCESS ABOVE THE CEILING. IN GENERAL, ALL SUCH ITEMS UNLESS NOTICED OTHERWISE SHALL BE MOUNTED 8" TO 12" INCHES ABOVE THE CEILING. IF IN DOUBT, CONTACT ENGINEER PRIOR TO INSTALLING.
- U. ALL MANHOLES, WALLS AND SIMILAR UNDERGROUND STRUCTURES SHALL HAVE THE TOP ELEVATION SET FLUSH WITH FINISHED GRADE UNLESS SPECIFICALLY NOTED OTHERWISE. PRIOR TO FOOTING INSTALLATION, WHEN RUNNING ANY TYPE OF PIPING BELOW A FOOTING, OR IN THE ZONE OF INFLUENCE THE PIPING SHALL BE BACKFILLED WITH GEMENTIOUSLY AVAILABLE FILL, WHENEVER POSSIBLE. LOCATE PIPING OUTSIDE OF THE ZONE OF INFLUENCE. THE ZONE OF INFLUENCE IS THE AREA UNDER THE FOOTER WITH A 45 DEGREE ANGLE PROJECTING DOWN FROM THE BOTTOM EDGE OF THE FOOTER OF ALL SIDES OF THE FOOTER. ADDITIONALLY, GREASE TRAPS, MANHOLES, WALLS AND OTHER UNDERGROUND STRUCTURES SHALL BE HELD AWAY FROM BUILDING WALLS FAR ENOUGH TO BE OUTSIDE OF THE ZONE OF INFLUENCE. REFERENCE STRUCTURAL DETAILS FOR ADDITIONAL INFORMATION.
- W. WORK IN CONFINED AREAS SHALL BE IN ACCORDANCE WITH THE OWNER'S SAFETY POLICY REQUIREMENTS.

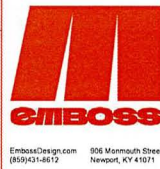

NOT FOR CONSTRUCTION

Taylor Mill Elementary School
5907 Taylor Mill Rd.
Covington, KY 41015

NO.	DESCRIPTION	DATE
Design Development	01/20/25	

PLUMBING LEGEND

OKCS25-03

P001

THIS DOCUMENT AND THE DATA HEREIN ARE THE PROPERTY OF EMBOSS DESIGN, INC. AND ARE NOT TO BE REPRODUCED OR TRANSMITTED IN ANY FORM OR BY ANY MEANS, ELECTRONIC OR MECHANICAL, INCLUDING PHOTOCOPYING, RECORDING, OR BY ANY INFORMATION STORAGE AND RETRIEVAL SYSTEM. ANY UNAUTHORIZED REPRODUCTION OR TRANSMISSION OF THIS DOCUMENT OR THE DATA HEREIN IS STRICTLY PROHIBITED AND WILL BE PROSECUTED TO THE FULL EXTENT OF THE LAW.

GENERAL REQUIREMENTS:

- IT IS THE CONTRACTOR'S RESPONSIBILITY TO PROVIDE APPROPRIATE QUANTITIES, FIELD MEASUREMENTS, DIMENSIONAL STABILITY, INSTALLATION, ANCHORAGE, AND COORDINATION WITH OTHER TRADES.
- THEY SHALL ALSO IDENTIFY AND RESOLVE DEVIATIONS FROM THE REQUIREMENTS OF THE CONTRACT DOCUMENTS AND ALERT DESIGNER TO ERRORS OR OMISSIONS.
- CONTRACTOR SHALL UNLESS THESE DRAWINGS ALONG WITH THE SPECIFICATIONS TO DETERMINE THE FULL SCOPE, INTENT AND REQUIREMENTS OF THE PROJECT. WORK DETAILS ON THE DRAWINGS BUT NOT ENUMERATED IN THE SPECIFICATIONS, AND WORK DESCRIBED IN THE SPECIFICATIONS BUT NOT DETAILED ON THE DRAWINGS SHALL BE INTERPRETED AS THOUGH WORK WERE FULLY DESCRIBED IN BOTH DOCUMENT SETS. THE HIGHER QUALITY, HIGHER QUALITY, MORE LABOR INTENSIVE AND OVERALL MORE STRINGENT AND MORE COSTLY REQUIREMENT SHALL APPLY UNLESS OTHERWISE NOTED PRIOR TO BID.
- THE CONTRACTOR SHALL FIELD VERIFY EXISTING CONDITIONS AND DIMENSIONS SHOWN ON THE DRAWINGS AND DESCRIBED IN THE SPECIFICATIONS. ANY DISCREPANCY DISCOVERED SHALL BE BROUGHT TO THE ATTENTION OF THE DESIGNER PRIOR TO THE COMMENCEMENT OF ANY WORK AFFECTED BY ANY SUCH DISCREPANCY. EACH CONTRACTOR SHALL BE RESPONSIBLE FOR ALL COSTS ASSOCIATED WITH, OR CAUSED BY THEIR FAILURE TO COMPLY WITH THIS REQUIREMENT.
- THE CONTRACTOR SHALL BE RESPONSIBLE FOR JOB CLEANLINESS. PROJECT AREAS SHALL BE THOROUGHLY CLEANED AND ANY WASTE REMOVED AT THE END OF EACH WORK DAY. OWNER'S FACILITIES OR TRASH COLLECTION SHALL NOT BE USED FOR WASTE DISPOSAL.
- EACH CONTRACTOR SHALL BE RESPONSIBLE FOR PROTECTION OF ALL SURFACES AND FINISHES IN THE INTERIOR OR EXTERIOR OF THE FACILITY. DAMAGED SURFACES OR FINISHES RESULTING FROM THE PERFORMANCE OF THE WORK OR NEGLIGENCE SHALL BE REPAIRED AT NO COST TO THE OWNER AND TO MATCH THE EXISTING FINISHES OR SURFACES TO THE SATISFACTION OF THE OWNER.
- FOR ALL FINISHED PROJECTS, THE CONTRACTOR SHALL MAINTAIN ALL EXISTING UTILITY SERVICES AND BUILDING SYSTEMS. THE CONTRACTOR SHALL COORDINATE WITH THE OWNER'S REPRESENTATIVE AS NECESSARY TO ALLOW FOR OPERATION ACCEPTABLE TO THE OWNER DURING CONSTRUCTION. THE CONTRACTOR SHALL PROVIDE TEMPORARY WIRING AS NECESSARY.
- PROVIDE SUST PROTECTION FOR ANY EXISTING EQUIPMENT AFFECTED BY THE CONTRACTORS WORK AND FOR ANY NEW WORK INSTALLED WHICH MAY BE AFFECTED BY CONSTRUCTION DUST.

GENERAL ROUGH-IN AND CABLING PATHWAY REQUIREMENTS:

- PROVIDE PATHWAYS FOR ANY TELECOMMUNICATIONS, AUDIO/VIDEO, SAFETY AND SECURITY SYSTEMS CABLING. REFER TO SPECIFICATIONS FOR ADDITIONAL INSTRUCTIONS.
- ROUGH-IN PATHWAYS SHALL BE REMOVED AND COORDINATED PRIOR TO INSTALLATION.
- WHERE CONDUITS ARE SPECIFIED "TAAC" (TO ABOVE ACCESSIBLE CEILING), CONDUITS SHALL BE STUBBED INTO AN ACCESSIBLE CEILING CAVITY.
- WHERE CONDUITS ARE SPECIFIED "HALL" (TO ABOVE ACCESSIBLE HALLWAY/CORRIDOR CEILING) CONDUITS SHALL BE RUN CONTINUOUS AND STUBBED OUT INTO AN ACCESSIBLE CEILING CAVITY WITHIN THE NEAREST CORRIDOR FEATURING AN ACCESSIBLE CEILING CAVITY.
- CONDUIT INSTALLER SHALL INSTALL PULL STRINGS IN ALL CONDUITS IMMEDIATELY AFTER INSTALLATION.
- CONDUIT INSTALLER SHALL LABEL CONDUITS PER THE DEVICES WHICH THEY ARE INTENDED TO SERVE WITH PERMANENT MARKER AT CONDUIT TERMINATION.
- WHERE CONDUITS ARE SHOWN AND/OR SPECIFIED, PROVIDE PULL BOXES SHOWN ON THE DRAWINGS PLUS ADDITIONAL PULL BOXES FOR EVERY 180 DEGREES OF CONDUIT BEND AND 100 FEET OF CONDUIT.
- PROVIDE COVER PLATES FOR JUNCTION AND PULL BOXES. COORDINATE MATERIAL AND FINISH OF BLANK PLATES TO MATCH SURROUNDING PLATES.
- WHERE A MOUNTING HEIGHT MEASUREMENT IS APPLIED TO A ROUGH-IN, THE MEASUREMENT SHALL BE REFERENCED TO THE CENTER OF THE ROUGH-IN DEVICE.
- PATHWAYS SHALL BE INSTALLED IN A CONCEALED MANNER. EXPOSED CONDUIT SHALL NOT BE PERMITTED IN FINISHED AREAS.
- PROVIDE CODE-COMPLIANT FILL-STOPPING FOR PATHWAYS THROUGH FIRE-RATED WALLS, FLOORS AND CEILINGS.
- PROVIDE CONDUITS WITH NYLON END-BURNING INSTALL, BUR-ROSE AT THE END OF EACH CONDUIT AND EACH ADDITIONAL LOCATION WHERE CABLES COULD BE DAMAGED WHEN PULLING THEM THROUGH THE CONDUIT.
- DEVICES TO BE INSTALLED AT COUNTER HEIGHT, CASEWORK OR FURNITURE SHALL BE CLOSELY COORDINATED IN THE FIELD WITH ARCHITECT, CASEWORK AND FURNITURE VENDORS PRIOR TO ROUGH-IN.
- WHERE FLOORBOXES, POWER POLES AND OTHER DUAL SERVICE PATHWAYS ARE INDICATED ON THE DRAWINGS, PATHWAY DEVICES SHALL BE PROVIDED BY THE DIVISION 26 CONTRACTOR. SEE ELECTRIC DRAWINGS FOR REQUIREMENTS AND ADDITIONAL INFORMATION.
- MANY COMMUNICATIONS DEVICES ARE INTENDED TO HAVE ADJACENT POWER OR INTEGRAL RECEPTACLES (MULTISERVICE) TO SERVE THE SAME EQUIPMENT. COORDINATE THE LOCATION OF SEPARATE DEVICES SO THAT THEY ARE LOCATED ADJACENT AND AT THE SAME ELEVATION. FACILITIES SHALL BE COORDINATED TO THE SAME TYPE AND COLOR.
- LADDER RACK AND OTHER COMMUNICATION TECHNOLOGY CABLING PATHWAYS DEPICTED ON THE ENLARGED FLOOR PLANS SHALL BE PROVIDED AS INDICATED. ADDITIONAL PRODUCTS NECESSARY FOR PROFESSIONAL WIRE MANAGEMENT WITHIN THE MAIN EQUIPMENT ROOM <R8> <R9> AND ALL TELECOMMUNICATIONS ROOMS SHALL BE PROVIDED AS NECESSARY.
- WHERE CABLE TRAYS ARE DEPICTED ON THE FLOORPLANS IT SHALL BE PROVIDED AS INDICATED AND SIZED APPROPRIATELY FOR THE CABLING QUANTITY AND USE TO BE CONVEYED. PROVIDE ALL MOUNTING HARDWARE AND TRANSITIONS REQUIRED TO SECURE TO THE WALLS AND/OR CEILING. COORDINATE WITH ALL TRADES TO ENSURE APPROPRIATE SPACE HAS BEEN ALLOCATED FOR THE CABLE TRAY DIMENSIONS.
- PROVIDE A MINIMUM OF ONE (1) 3/4" I.D. DIAMETER THROUGH-THE-WALL CONDUIT SLEEVES FOR USE AS LOWVOLTAGE CABLE PATHWAYS INTO EACH SPACE CONTAINING LOWVOLTAGE DEVICES. ROUTE CONDUITS FROM ABOVE ACCESSIBLE CEILING TO THE NEAREST HALLWAY/CORRIDOR FEATURING AN ACCESSIBLE CEILING CAVITY.
- IN ALL CASES WHERE CABLING IS NOT INSTALLED IN CONDUIT, IT SHALL BE SUPPORTED BY CABLE TRAY, HOOKS OR OTHER APPROVED PATHWAY SUPPORTS. IT SHALL NEVER BE SUPPORTED BY BUILDING STRUCTURE OR SUSPENDED CEILING INFRASTRUCTURE.
- WHERE CABLING IS NOT INSTALLED WITH CONDUITS, IT SHALL BE INSTALLED IN A CONCEALED MANNER WHEN TRAVELING THROUGH OPEN CEILING TYPE SPACES.
- MAJOR CONDUIT PATHWAYS 3" DIAMETER AND GREATER HAVE BEEN DEPICTED ON THE FLOOR PLANS AND SECTION DETAILS. HOWEVER, ADDITIONAL CONDUIT PATHWAYS AND SLEEVES SHALL BE REQUIRED FOR CABLING TO PASS THROUGH WALLS, FLOORS, EXPOSED OPEN CEILING TYPE SPACES, AND TO COMPLETE PROPER INSTALLATION. FIELD COORDINATE AND PROVIDE AS REQUIRED.

GENERAL CABLING REQUIREMENTS:

- CABLE RATING REQUIREMENTS
- A. ALL CABLE SHALL BE RATED FOR THE ENVIRONMENT IN WHICH IT IS INSTALLED PER NEC REQUIREMENTS.
- B. ANY CABLE INSTALLED WITH A RETURN AIR PLENUM SHALL BE PLENUM RATED (CMP). ANY CABLE DISCOVERED WITH A RETURN AIR PLENUM THAT IS NOT RATED FOR SUCH SHALL BE REMOVED AND REINSTALLED WITH THE PROPER RATING AT THE CONTRACTOR'S EXPENSE.
- C. CABLING INSTALLED WITHIN UNDERGROUND CONDUITS AND/OR DIRECTLY BURIED IN-GROUND SHALL BE RATED FOR SUCH.
- CABLING GAUGE SHALL BE SIZED APPROPRIATELY TO CARRY THE VOLTAGE AND CURRENT RANGES PER NEC AND MANUFACTURER'S REQUIREMENTS.
- ALL INSTALLED CABLING SHALL BE CONTINUOUS AND WITHOUT SPLICES, UNLESS OTHERWISE NOTED.
- COLORS OF CABLE AND TERMINATIONS USED ON ALL TECHNOLOGY WORK SHALL CONFORM TO THE DESIGNER'S AND OWNER'S REQUIREMENTS PRIOR TO PROCUREMENT AND INSTALLATION.

ABBREVIATIONS		
UNLESS OTHERWISE NOTED		
OWNER FURNISHED CONTRACTOR INSTALLED	OWN	
OWNER FURNISHED CONTRACTOR INSTALLED	OFIC	
OWNER FURNISHED CONTRACTOR INSTALLED	OFIC	
CONTRACTOR FURNISHED CONTRACTOR INSTALLED	CFIC	
CONTRACTOR FURNISHED OWNER INSTALLED	CFOR	
ABOVE FINISHED FLOOR	AFF	
ABOVE FINISHED GRADE	AFG	
CEILING MOUNTED DEVICE	CMD	
FLOOR MOUNTED DEVICE	FLR	
COUNTER HEIGHT	CH	
TO ABOVE ACCESSIBLE CEILING	TAAC	
TO ABOVE ACCESSIBLE HALLWAY/CORRIDOR CEILING	HALL	
WIRE GUARD	WG	
WEATHER PROOF EQUIPMENT / FEATURE / DEVICE	WP	
CABLE WITH BARRIERS AND/OR FIRE SHIELDS	SH	
BELOW FINISHED CEILING	BFC	
FURNISHED AND INSTALLED BY	FBI	

CABLE AND CONDUIT COLOR SCHEDULE			
SYSTEM	CABLE COLOR		JACK INSERT
	DATA	BLUE	BLUE
WAP	GREEN	GREEN	
SECURITY	PURPLE	PURPLE	
SECURITY CAMERAS	YELLOW	YELLOW	
AUDIO & VIDEO	ORANGE	ORANGE	

LEGEND GENERAL NOTES:

- BASE SYMBOLS ARE USED TO REFERENCE THE FLOOR PLAN LOCATION AND PROPER ROUGH-IN AND CABLING REQUIREMENTS.
- DIMENSIONS SHOWN IN THE LEGEND ARE TYPICAL AND SHALL BE CONSIDERED UNLESS OTHERWISE NOTED (UNLESS SPECIFIC DIMENSIONS INDICATED ON THE FLOOR PLAN SHALL SUPERSEDE THE TYPICAL).
- DIMENSIONS SHALL BE TO CENTER OF BOX / DEVICE UNLESS OTHERWISE NOTED.

TECHNOLOGY LEGEND, SCHEDULE & NOTES

SYMBOL	DESCRIPTION	DEFAULT ROUGH-IN		CABLING TYPE/QUANTITY/NOTES		MISCELLANEOUS NOTES
		ELEVATION	PATHWAY TYPE/SIZE	TYPE	QUANTITY	
DS	DATA OUTLET. NUMBER INDICATES QUANTITY OF DATA JACKS AND CABLES. MAX = 16. DIMENSIONAL SYSTEMS OUTLET. BEC = SECURITY SYSTEMS OUTLET.	18" AFF UON	6"x4" BOX WITH 1 GANG DEVICE	1" CONDUIT TAAC	CAT 6 (1)'	*MINIMUM (1) DATA
DS1	DATA OUTLET WITH LOCAL INPUT. NUMBER INDICATES QUANTITY OF DATA JACKS AND CABLES. ROUTE (1) CONDUIT TAAC. ROUTE THE OTHER CONDUIT TO THE LOCAL FLAT PANEL OUTLET IN THE SAME SPACE.	18" AFF UON	6"x4" BOX WITH 2 GANG DEVICE	(2) 1" 14" CONDUIT TAAC	CAT 6 (1)'	*MINIMUM (1) DATA
DS10	DATA OUTLET WITH LOCAL OUTPUT. NUMBER INDICATES QUANTITY OF DATA JACKS AND CABLES. ROUTE (1) CONDUIT TAAC. ROUTE THE OTHER CONDUIT TO THE LOCAL INPUT OUTLET IN THE SAME SPACE.	18" AFF UON	6"x4" BOX WITH 2 GANG DEVICE	(2) 1" 14" CONDUIT TAAC	CAT 6 (1)'	*MINIMUM (1) DATA
DSV	VOICE OUTLET. NUMBER INDICATES QUANTITY OF VOICE JACKS AND CABLES. W = WALL. PHONE OUTLET AT 48" AFF. FACP = FIRE ALARM CONTROL PANEL OUTLET. ELEV = ELEVATOR POOR OUTLET.	18" AFF UON	6"x4" BOX WITH 1 GANG DEVICE	1" CONDUIT TAAC	CAT 6 (1)'	*MINIMUM (1) VOICE
WAP	WIRELESS ACCESS POINT. PROVIDE DATA OUTLET AT OR ABOVE CEILING, MOUNTED AT AN ACCESSIBLE HEIGHT NO MORE THAN 2" ABOVE CEILING. EXISTING DEVICES TO BE REMOVED, RE-CABLED, AND REINSTALLED.	ABOVE CEILING	6"x4" BOX WITH 1 GANG DEVICE	1" CONDUIT TAAC WHERE NOT INSTALLED AT ACCESSIBLE CEILING	CAT 6A (1)	PROVIDE A 29" SERVICE LOOP FOR ADJUSTMENT OF FINAL PLACEMENT. COORDINATE LOCATIONS WITH OWNER.
DS	FLOOR DATA OUTLET. NUMBER INDICATES QUANTITY OF DATA JACKS AND CABLES. COORDINATE WITH DIVISION 26 CONTRACTOR.	FLOOR	1 GANG	1" CONDUIT TAAC OF INSTALLED FLOOR	CAT 6 (1)'	*MINIMUM (1) DATA
DS	EQUIPMENT ROOM / MAIN DISTRIBUTION FRAME - REFERENCE DATA SYSTEM SCHEMATICS AND DETAILS 5 FOR ADDITIONAL REQUIREMENTS.	N/A	N/A	N/A	*	*BACKBONE CABLING DETAILS 9
DS	TELECOMMUNICATIONS ROOM / INTERMEDIATE DISTRIBUTION FRAME - REFERENCE DATA SYSTEM SCHEMATICS AND DETAILS FOR ADDITIONAL REQUIREMENTS.	N/A	N/A	N/A	*	*BACKBONE CABLING DETAILS 9
DS	COMMUNICATIONS UTILITY ENTRANCE FACILITY - REFERENCE DATA SYSTEM SCHEMATICS AND DETAILS 5 FOR ADDITIONAL REQUIREMENTS.	N/A	N/A	N/A	*	*BACKBONE CABLING DETAILS 9
DS	TELECOM ROOM LADDER RACK. SIZE AS NOTED. PROVIDE 14 LOCATIONS SHOWN. PROVIDE CABLE WATER FALLS WHERE CABLES EXIT LADDER RACK TO ENTER EQUIPMENT RACKS.	56"	N/A	N/A	*	*BACKBONE CABLING DETAILS 9
DS	LOWVOLTAGE CONDUIT PATHWAY / RISERS. SIZE AS INDICATED. PROVIDE AT LOCATION DEPICTED. PROVIDE WATER FALLS WHERE MULTIPLE CABLES EXIT A CONDUIT IN A DOWNWARD DIRECTION.	N/A	N/A	N/A	*	*SEE DETAILS
DS	CEILING MOUNTED SPEAKER. SEE DETAILS AND DIAGRAMS FOR ADDITIONAL INFORMATION. SUBSCRIPT Y = INTEGRAL. VOLUME CONTROL. ZONE DESCRIPTION.	CEILING	N/A	34" CONDUIT ABOVE NON-ACCESSIBLE CEILINGS	*	*SEE DETAILS
DS	LOCAL SOUND SYSTEM CEILING MOUNTED SPEAKER. SEE DETAILS AND DIAGRAMS FOR ADDITIONAL INFORMATION. SUBSCRIPT Z (X) = SPEAKER ZONE DESCRIPTION.	CEILING	N/A	34" CONDUIT ABOVE NON-ACCESSIBLE CEILINGS	*	*SEE DETAILS
DS	SURFACE MOUNTED SPEAKER. SEE DETAILS AND DIAGRAMS FOR ADDITIONAL INFORMATION. SUBSCRIPT Y = INTEGRAL. VOLUME CONTROL. ZONE DESCRIPTION.	90" AFF	6"x4" BOX WITH 1 GANG DEVICE	34" CONDUIT TAAC	*	*SEE DETAILS
DS	SURFACE MOUNTED HORN SPEAKER. SEE DETAILS AND DIAGRAMS FOR ADDITIONAL INFORMATION. SUBSCRIPT Y = INTEGRAL. VOLUME CONTROL. ZONE DESCRIPTION.	90" AFF	6"x4" BOX WITH 1 GANG DEVICE	34" CONDUIT TAAC	*	*SEE DETAILS
DS	WALL VOLUME CONTROL. SEE DETAILS AND DIAGRAMS FOR ADDITIONAL INFORMATION. R = EXISTING DEVICE TO BE REMOVED, RE-CABLED, AND REINSTALLED.	48" AFF	6"x4" BOX WITH 1 GANG DEVICE	34" CONDUIT TAAC	*	*SEE DETAILS
DS	INTERCOMMUNICATION SYSTEM CALL INITIATION STATION. SEE DETAILS AND DIAGRAMS FOR ADDITIONAL INFORMATION.	48" AFF	6"x4" BOX WITH 1 GANG DEVICE	34" CONDUIT TAAC	*	*SEE DETAILS
DS	WALL MICROPHONE OUTLET. SEE DETAILS AND DIAGRAMS FOR ADDITIONAL INFORMATION.	18" AFF	6"x4" BOX WITH 1 GANG DEVICE	34" CONDUIT TAAC	*	*SEE DETAILS
DS	AUDIO CONNECTION OUTLET. SEE DETAILS AND DIAGRAMS FOR ADDITIONAL INFORMATION.	18" AFF	6"x4" BOX WITH 1 GANG DEVICE	34" CONDUIT TAAC	*	*SEE DETAILS
DS	AUDIO AND VIDEO CONNECTION OUTLET. SEE DETAILS AND DIAGRAMS FOR ADDITIONAL INFORMATION. 40 = A QUANTITY OF ADDITIONAL REQUIRED DATA OUTLETS.	18" AFF	6"x4" BOX WITH 2 GANG DEVICE	(2) 1" 14" CONDUIT TAAC	CAT 6A *	*SEE DETAILS FOR QTY(S)
DS	FLAT PANEL DISPLAY OUTLET (FLAT PANEL, OFD). SEE DETAILS AND DIAGRAMS FOR ADDITIONAL INFORMATION. R = EXISTING DEVICE TO BE REMOVED, RE-CABLED, AND REINSTALLED.	60" AFF	6"x4" BOX WITH 2 GANG DEVICE	(2) 1" 14" CONDUIT TAAC	CAT 6 (1)	
DS	WIRELESS SYNCHRONOUS ANALOG WALL CLOCK. D = DUAL FACE CLOCKS WITH MOUNTING ADAPTERS. R = EXISTING DEVICE TO BE REMOVED, RE-CABLED, AND REINSTALLED.	LOWER OF 12" BFC OR 96" AFF	6"x4" BOX WITH 1 GANG DEVICE	N/A		
DS	SYNCHRONOUS CLOCK HEADING CONTROLLER.	EQUIPMENT RACK	N/A	N/A	CAT 6 (1)	
DS	CARD PROXIMITY / AUTHENTICATION READER. W = MULLION MOUNT VERSION. COORDINATE WITH DOOR HARDWARE SCHEDULE. R = EXISTING DEVICE TO BE REMOVED, RE-CABLED, AND REINSTALLED.	48" AFF	6"x4" BOX WITH 1 GANG DEVICE	34" CONDUIT TAAC	SH 6 COND (1)	IF INTEGRAL TO DOOR HARDWARE, PROVIDE INTERCONNECTION TO DEVICE.
DS	DOOR POSITION SWITCH. DOUBLE PULL DOUBLE THROW (DPDT). PROVIDE DUAL SWITCHES ON DOUBLE LEAF DOORS. R = EXISTING DEVICE TO BE REMOVED, RE-CABLED, AND REINSTALLED.	TOP OF DOOR FRAME	N/A	34" CONDUIT TAAC	2 COND (1)	IF INTEGRAL TO DOOR HARDWARE, PROVIDE INTERCONNECTION TO DEVICE.
DS	ELECTRIFIED HARDWARE. MORTISE LOCK, CYLINDRICAL LOCK, PANIC HARDWARE, MAGNETIC LOCK, PANIC DEVICE, ETC. TYPE. R = EXISTING DEVICE TO BE REMOVED, RE-CABLED, AND REINSTALLED.	HINGE SIDE OF DOOR FRAME	N/A	34" CONDUIT TAAC	2 COND (1)	
DS	ELECTRIC STRIKE TYPE DEVICE. COORDINATE WITH DOOR HARDWARE SCHEDULE. R = EXISTING DEVICE TO BE REMOVED, RE-CABLED, AND REINSTALLED.	STRIKE SIDE OF DOOR FRAME	N/A	34" CONDUIT TAAC	2 COND (1)	
DS	REQUEST TO EXIT DEVICE. MOTION SENSING AIR TYPE OR INTEGRATED WITH EXIT DEVICE HARDWARE. R = EXISTING DEVICE TO BE REMOVED, RE-CABLED, AND REINSTALLED.	CENTERED ABOVE DOOR	6"x4" BOX WITH 1 GANG DEVICE	34" CONDUIT TAAC	6 COND (1)	IF INTEGRAL TO DOOR HARDWARE, PROVIDE INTERCONNECTION TO DEVICE.
DS	SECURE DOOR LOCATION. SHALL INCLUDE THE DEVICE, ROUGH-IN, AND CABLING REQUIREMENTS OF DOOR POSITION SWITCH. ELECTRIC STRIKE (ELECTRIFIED) HARDWARE. A REQUEST TO EXIT DEVICE IS DEPICTED ABOVE.	SEE ABOVE	SEE ABOVE	SEE ABOVE		IF INTEGRAL TO DOOR HARDWARE, PROVIDE INTERCONNECTION TO DEVICES.
DS	DOOR RELEASE PUSH BUTTON. R = EXISTING DEVICE TO BE REMOVED, RE-CABLED, AND REINSTALLED.	UNDER DESK	6"x4" BOX WITH 1 GANG DEVICE	34" CONDUIT TAAC	2 COND (1)	
DS	LOCAL ANNUNCIATOR ALARM / SOUNDER	CEILING / WALL	6"x4" BOX WITH 1 GANG DEVICE	34" CONDUIT TAAC	2 COND (1)	
DS	DURESS ALARM BUTTON / SWITCH	UNDER DESK	6"x4" BOX WITH 1 GANG DEVICE	34" CONDUIT TAAC	4 COND (1)	PROVIDE BLANK PLATE WITH GROMMETED HOLE.
DS	DOOR INTERCOM MASTER STATION. W = WALL MOUNTED. R = EXISTING DEVICE TO BE REMOVED, RE-CABLED, AND REINSTALLED.	DESK MOUNTED	6"x4" BOX WITH 1 GANG DEVICE	34" CONDUIT TAAC	CAT 6 (1)	
DS	AUDIODIRECTED INTERCOM DOOR STATION. R = EXISTING DEVICE TO BE REMOVED, RE-CABLED, AND REINSTALLED.	48"	6"x4" BOX	34" CONDUIT TAAC	CAT 6 (1)	
DS	VIDEO SURVEILLANCE SECURITY CAMERA. CEILING MOUNTED. W = WALL MOUNTED. R = EXISTING DEVICE TO BE REMOVED, RE-CABLED, AND REINSTALLED.	CEILING	6"x4" BOX WITH 1 GANG DEVICE	34" CONDUIT TAAC	CAT 6 (1)	
DS	VIDEO SURVEILLANCE SECURITY CAMERA. WALL OR POLE MOUNTED. W = WALL MOUNTED. R = EXISTING DEVICE TO BE REMOVED, RE-CABLED, AND REINSTALLED.	120" AFF OR AFG	6"x4" BOX WITH 2 GANG DEVICE	34" CONDUIT TAAC	CAT 6 (1)	
DS	ACCESS CONTROL PANEL LOCATION	N/A	N/A	N/A	CAT 6 (1)	PROVIDE HARD WIRED POWER TO POWER SUPPLY.
DS	VIDEO SURVEILLANCE SERVER LOCATION	N/A	N/A	N/A	CAT 6 (1)	



EmbossDesign.com
(800)931-4812

806 Monmouth Street,
Newport, KY 41071

NOT FOR
CONSTRUCTION

Taylor Mill Elementary School

5907 Taylor Mill Rd.
Covington, KY 41015

NO.	DESCRIPTION	DATE
	Design Development	01/20/25

TECHNOLOGY LEGEND SCHEDULE & NOTES

OKCS25-03

T000

PRINT DATE

1/16/2025 3:15 PM