

DANNY CLEMENS, DIRECTOR
TRACY PARSLEY, MAINTENANCE SUPERVISOR
THOMAS STOKES, CUSTODIAL SUPERVISOR
GEORGE BROCK, ENERGY MANAGER

DEPARTMENT OF FACILITIES

MEMO

TO: Dr. Jesse Bacon, Superintendent
FROM: Danny Clemens, Director of Facilities
Date: August 21, 2025
RE: North Bullitt PSC - BG 24-192 - Change Order 13 - Omitted Weight Room
Flooring **DC**

Weight room flooring is being omitted and replaced with an outside vendor's flooring. This change order deducts the cost of installation of the resilient flooring originally specified and documented. There is a separate change order for the omission of flooring materials attached to this change order. NBHS Athletics and BCPS Facilities has been working with Direct Fitness for provision of the flooring with logos. A PO in the amount of \$74,904.60 has been issued directly to Direct Fitness Solutions for provision of branded weight room flooring and installation.

I recommend approval of this request.

.Attached paperwork is listed below with *action items* noted for each:

- BP-2 - G701-2017 - Change Order 13 - Omit Weight Room Flooring - *for Board Signature*
- BP-2 - FACPAC - CO 13 -Weight Room Floor - Install - *for Board Signature*
- BP-2 - G701-2017 - Change Order 13 - DPO 15 - Fishman - Omit Weight Room Flooring - *for Board Signature*
- BP-2 - FACPAC - CO 13 -Weight Room Floor - DPO 15 - Materials - *for Board Signature*
- COR-20 RFP-8 Omit Weight Room Flooring - C0 13 - *for Board Reference – no action required.*

OUR MISSION IS TO INSPIRE AND EQUIP OUR STUDENTS TO SUCCEED IN LIFE

BULLITT COUNTY PUBLIC SCHOOLS IS AN EQUAL EDUCATION AND EMPLOYMENT INSTITUTION



AIA Document G701® - 2017

Change Order

PROJECT: (Name and address)
Phase II Athletics - Bid Package No. 2 -
NB Field House
Bullitt County Public Schools

CONTRACT INFORMATION:
Contract For: Phase II Athletics - Bid
Package No. 2 - NB Field House
Date: 06-12-2025

CHANGE ORDER INFORMATION:
Change Order Number: 013
Date: 07-28-2025

OWNER: (Name and address)
Bullitt County Public Schools Board of
Education
1040 Hwy 44 East
Shepherdsville, KY 40165

ARCHITECT: (Name and address)
Studio Kremer Architects
1231 S Shelby St., Louisville KY

CONTRACTOR: (Name and address)
Calhoun Construction Services, Inc.
7707 National Turnpike
Louisville, KY 40218

THE CONTRACT IS CHANGED AS FOLLOWS:

(Insert a detailed description of the change and, if applicable, attach or reference specific exhibits. Also include agreed upon adjustments attributable to executed Construction Change Directives.)

See COR 20 and RFP.08 for Scope of Work included in this Change Order.

| | | |
|--|----|----------------|
| The original Contract Sum was | \$ | 16,249,774.40 |
| The net change by previously authorized Change Orders | \$ | (1,668,574.00) |
| The Contract Sum prior to this Change Order was | \$ | 14,581,200.40 |
| The Contract Sum will be decreased by this Change Order in the amount of | \$ | (6,498.00) |
| The new Contract Sum including this Change Order will be | \$ | 14,574,702.40 |

The Contract Time will be unchanged by (0) days.

The new date of Substantial Completion will be

NOTE: This Change Order does not include adjustments to the Contract Sum or Guaranteed Maximum Price, or the Contract Time, that have been authorized by Construction Change Directive until the cost and time have been agreed upon by both the Owner and Contractor, in which case a Change Order is executed to supersede the Construction Change Directive.

NOT VALID UNTIL SIGNED BY THE ARCHITECT, CONTRACTOR AND OWNER.

ARCHITECT (Signature)

BY: Catherine Noble Ward, AIA
(Printed name, title, and license number if required)

8-20-2025
Date

CONTRACTOR (Signature)

BY: Joel Pittard, Project Manager
(Printed name and title)

7/24/2025
Date

OWNER (Signature)

BY: Dr. Jesse Bacon, Superintendent
(Printed name and title)

Date

FACPAC Contract Change Order Supplemental Information Form (Ref# 63046)

Form Status: Saved

Tier 1 Project: Phase 2 Athletics and Fieldhouses

BG Number: 24-192

District: Bullitt County (HB678) (071)

Status: Active

Phase: Project Initiation (View Checklist)

Contract: Calhoun Construction Services, 0002, General Construction - North Bullitt Field House

Type: General Contractor

Proposed

| | |
|-----------------------------|-----------|
| Change Order Number | 13 |
| Time Extension Required | No |
| Date Of Change Order | 8/25/2025 |
| Change Order Amount To Date | Decrease |

Construction Contingency

Calculations below are project wide. Remaining negative Construction Contingency may require the submission of a revised BG1.

| | |
|------------------------------|----------------|
| Current Approved Amount | \$2,907,023.76 |
| Net Approved COs | \$246,515.27 |
| Remaining After Approved COs | \$2,660,508.49 |
| Net All COs | \$233,687.27 |
| Remaining After All COs | \$2,673,336.49 |

This Requested Change Order Amount (\$6,498.00)

+/-

Change In A/E Fee This Change Order \$324.90

+/-

Change In CM Fee This Change Order \$0.00

+/-

Remaining Construction Contingency \$2,673,336.49

Balance

Contract Change Requested By BCPS Facilities & NBHS Athletics

Contract Change Reason Code Reduction of Scope

Change Order Description And Justification

Weight room flooring is being omitted and replaced with an outside vendors flooring.

This change order deducts the cost of installation of the resilient flooring originally specified and documented. There is a separate change order for the omission of flooring materials attached to this change order.

NBHS Athletics and BCPS Facilities has been working with Direct Fitness for provision of the flooring with logos.

A PO in the amount of \$74,904.60 has been issued directly to Direct Fitness Solutions for provision of branded weight room flooring and installation.

Cost Benefit To Owner

This is a credit for work omitted and provided by an outside vendor/contractor.

Contract unit prices have been utilized No
to support the cost associated with this
change order.

Detailed Cost Breakdown

Contract unit prices have not been utilized, provide a detailed cost breakdown which separates labor, material, profit and overhead.

| Detail Item | Amount | Percent of Total |
|------------------------------|--------------------|------------------|
| Labor | (\$5,849.00) | 90.01% |
| Materials | | 0.00% |
| Profit and Overhead | (\$585.00) | 9.00% |
| Bond Insurance | (\$64.00) | 0.98% |
| Cost Breakdown Total: | \$-6,498.00 | |

Cost for this Change Order supported No
by an alternate bid or competitive price
quote

Explain Why

This is a credit for work omitted and provided by an outside vendor/contractor.

Change Order Supplemental Information Form Signature Page (Online Form Ref# 63046)

Catherine N. Ward

Architect

8-20-2025

Date

N/A

Construction Manager

Date

Lisa Lennis

Finance Officer

8-22-2025

Date

Local Board of Education Designee

Date



AIA® Document G701® – 2017

Change Order

PROJECT: *(Name and address)*
Phase II Athletics - Bid Package No. 2 -
NB Field House
Bullitt County Public Schools

CONTRACT INFORMATION:
Contract For:

Date: 07-24-2025

CHANGE ORDER INFORMATION:
Change Order Number: CO 13 - PO
25903235
Date: 07-28-2025

OWNER: *(Name and address)*
Bullitt County Public Schools Board of
Education
1040 Hwy 44 East
Shepherdsville, KY 40165

ARCHITECT: *(Name and address)*
Studio Kremer Architects

1231 S Shelby St., Louisville KY

CONTRACTOR: *(Name and address)*
L Fishman and Sons, LLC

Baltimore, MD 21224

THE CONTRACT IS CHANGED AS FOLLOWS:

(Insert a detailed description of the change and, if applicable, attach or reference specific exhibits. Also include agreed upon adjustments attributable to executed Construction Change Directives.)

See COR 20 and RFP 08 for Scope of Work included in this Change Order.

| | | |
|--|----|-------------|
| The original Contract Sum was | \$ | 34,081.01 |
| The net change by previously authorized Change Orders | \$ | 0.00 |
| The Contract Sum prior to this Change Order was | \$ | 34,081.01 |
| The Contract Sum will be decreased by this Change Order in the amount of | \$ | (23,260.00) |
| The new Contract Sum including this Change Order will be | \$ | 10,821.01 |

The Contract Time will be unchanged by () days.
The new date of Substantial Completion will be

NOTE: This Change Order does not include adjustments to the Contract Sum or Guaranteed Maximum Price, or the Contract Time, that have been authorized by Construction Change Directive until the cost and time have been agreed upon by both the Owner and Contractor, in which case a Change Order is executed to supersede the Construction Change Directive.

NOT VALID UNTIL SIGNED BY THE ARCHITECT, CONTRACTOR AND OWNER.

ARCHITECT *(Signature)*

BY: Catherine Noble Ward, AIA
(Printed name, title, and license number if required)

8-20-2025

Date

CONTRACTOR *(Signature)*

BY: Tyler Trick
(Printed name and title)

7/28/25

Date

OWNER *(Signature)*

BY: Dr. Jesse Bacon, Superintendent
(Printed name and title)

Date

FACPAC PO Change Order Supplemental Information Form (Ref# 63047)

Form Status: Saved

Tier 1 Project: Phase 2 Athletics and Fieldhouses

BG Number: 24-192

District: Bullitt County (HB678) (071)

Status: Active

Phase: Project Initiation (View Checklist)

Contract: Calhoun Construction Services, 0002, General Construction - North Bullitt Field House

Type: General Contractor

Proposed

Purchase Order Number: 15 - 25903235

Vendor Name: Fishman Flooring Solutions

| | |
|-----------------------------|--------------------------|
| Change Order Number | DPO 15 - Change Order 13 |
| Time Extension Required | No |
| Date Of Change Order | 8/25/2025 |
| Change Order Amount To Date | Decrease |

Construction Contingency

Calculations below are project wide. Remaining negative Construction Contingency may require the submission of a revised BG1.

| | |
|------------------------------|----------------|
| Current Approved Amount | \$2,907,023.76 |
| Net Approved COs | \$246,515.27 |
| Remaining After Approved COs | \$2,660,508.49 |
| Net All COs | \$210,427.27 |
| Remaining After All COs | \$2,696,596.49 |

This Requested Change Order Amount (\$23,260.00)

+/-

Change In A/E Fee This Change Order \$1,163.00

+/-

Change In CM Fee This Change Order \$0.00

+/-

Remaining Construction Contingency \$2,696,596.49

Balance

Contract Change Requested By BCPS Facilities & NBHS Athletics

Contract Change Reason Code Reduction of Scope

Change Order Description And Justification

Weight room flooring is being omitted and replaced with an outside vendor's flooring.

This change order deducts the cost of resilient flooring materials originally specified and documented. There is a separate change order for the omission of flooring installation attached

to this change order.

NBHS Athletics and BCPS Facilities has been working with Direct Fitness for provision of the flooring with logos.

A PO in the amount of \$74,904.60 has been issued directly to Direct Fitness Solutions for provision of branded weight room flooring and installation.

Cost Benefit To Owner

This is a credit for work omitted and provided by an outside vendor/contractor.

Contract unit prices have been utilized No
to support the cost associated with this
change order.

Detailed Cost Breakdown

Contract unit prices have not been utilized, provide a detailed cost breakdown which separates labor, material, profit and overhead.

| Detail Item | Amount | Percent of Total |
|------------------------------|---------------------|------------------|
| Labor | | 0.00% |
| Materials | (\$23,260.00) | 100.00% |
| Profit and Overhead | | 0.00% |
| Bond Insurance | | 0.00% |
| Cost Breakdown Total: | \$-23,260.00 | |

Cost for this Change Order supported No
by an alternate bid or competitive price
quote

Explain Why

This is a credit for work omitted and provided by an outside vendor/contractor.

Change Order Supplemental Information Form Signature Page (Online Form Ref# 63047)

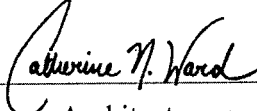
Architect

8-20-2025

Date

N/A

Construction Manager

Date

Finance Officer

Date

Local Board of Education Designee

Date

Change Order Request 20 - PCO #50 - RFP-8 Omit Weight Room Flooring

752-- BCPS Phase II Athletics North Bullitt Field House

7/10/2025



Summary of work

RFP-8 Omit Weight Room Flooring

Change Order Description

(\$5,849.00)

o Flooring - AFS ==> RFP-8 Omit Gym Flooring/Base Installation ==> (\$5,849.00) - See DPO Material Change Summary Attached

Sub Total: (\$5,849.00)

Bond: (\$64.00)

Fee: (\$585.00)

Total (\$6,498.00)

Approved By: _____

Date: _____

Submitted By: Calhoun

Date: 7/10/2025

Lyons, Tonya

From: Rory Pope <rory.pope@afsgroup.com>
Sent: Thursday, July 10, 2025 11:44 AM
To: Lyons, Tonya
Cc: Pittard, Joel
Subject: RE: NBHS Fieldhouse RFP-8 Weight Room Flooring
Attachments: NB Field House DPO - Fishman Flooring - Signed.pdf

Hey Tonya,

Happy Thursday, Apologize for not getting back to you sooner on this.

The rubber gym floor Material was apart of the Fishman DPO. Therefore, the Gym Floor amount will have to be taken out of the DPO which is about \$23,260.00.

Deducted from our contract would just be the labor portion, this amount is \$5,849.25.



Rory Pope, Commercial Market Manager – Kentucky
Mobile: 502-619-8783
Office: (502) 785-2825
americasfloorsource.com
4601 E Indian Trail | Louisville, KY 40213
An AFS Group Company

From: Lyons, Tonya <TonyaLyons@calhounconstructs.com>
Sent: Wednesday, July 09, 2025 10:02 AM
To: Rory Pope <rory.pope@afsgroup.com>
Cc: Pittard, Joel <joelpittard@calhounconstructs.com>; Lyons, Tonya <TonyaLyons@calhounconstructs.com>
Subject: NBHS Fieldhouse RFP-8 Weight Room Flooring
Importance: High

Rory... please see attached and provide the deduct for omitting this flooring. I need by Friday, July 11th.

Thanks,

Tonya Lyons

Assistant Project Manager
CALHOUN CONSTRUCTION
7707 National Turnpike, Suite 400
Louisville, KY 40214
Office (502)493-1332
Cell (770)241-9227

DPO Change Summary - RFP-8 Omit Gym Flooring and Base

752-NBHS Field House

7/10/2025



Summary of Work

RFP-8 Omitting Gym Floor and associated base from DPO; to be provided by Others

| Scope - Subcontractor | Description of Scope | Cost |
|-----------------------|--|---------------|
| 1 NBHS Fieldhouse | | |
| 1.2 Fishman and Sons | DEDUCT Gym Flooring and Base per RFP-8 | (\$23,260.00) |

Revised Total Amount (\$23,260.00)

Bill To

Purchase Order



BULLITT COUNTY BOARD OF ED
1040 HIGHWAY 44 EAST
SHEPHERDSVILLE, KY 40165
Phone: 502-869-8000

PHONE
(502) 869-8000
FAX
(502) 869-8019

HOURS
Monday - Friday
8:00 a.m. - 4:30 p.m.
www.bullittschools.org

Fiscal Year 2025

Page: 1 of 1

THIS NUMBER MUST APPEAR ON ALL INVOICES,
PACKAGES AND SHIPPING PAPERS.

Purchase Order # **25903235**

Delivery must be made within doors of specified destination.

Vendor

L FISHMAN AND SONS, INC
FISHMAN FLOORING SOLUTIONS
FISHMAN FLOORING SOLUTIONS
BALTIMORE, MD 21224

Ship To

BULLITT COUNTY MAINTENANCE
325 E SECOND STREET
SHEPHERDSVILLE, KY 40165

| VENDOR PHONE NUMBER | VENDOR FAX NUMBER | REQUISITION NUMBER | DELIVERY REFERENCE | |
|---------------------|-------------------|--------------------|----------------------|----------------------------|
| | | 3790 | DANNY CLEMENS | |
| DATE ORDERED | VENDOR NUMBER | DATE REQUIRED | FREIGHT METHOD/TERMS | DEPARTMENT/LOCATION |
| 10/15/2024 | 16306 | | | 920 MAINTENANCE DEPARTMENT |
| NOTES | | | | |

The Above Purchase Order Number Must Appear On All Correspondence - Packing Sheets And Bills Of Lading

1. Backorders will not be processed for payment.
 2. Conflicts in billing shall be directed to the location contact person and not the Office of Finance.
- PHASE 2 ATHLETICS AND FIELDHOUSES
BG#23-050

| ITEM # | DESCRIPTION / PART # | QTY | UOM | UNIT PRICE | EXTENDED PRICE |
|-----------------------|--|-------------|------|-------------|----------------|
| 1 | GYM FLOOR BASE, PREP PHASE 2 ATHLETICS AND FIELDHOUSES | 1.0 | EACH | \$34,081.01 | \$34,081.01 |
| GL SUMMARY | | | | | |
| 0003610 - 0450 - 8128 | | \$34,081.01 | | | |

| | |
|-----------------------------|--------------------|
| Total Ext. Price | \$34,081.01 |
| Total Sales Tax | \$0.00 |
| Total Freight | \$0.00 |
| Total Discount | \$0.00 |
| Total Credit | \$0.00 |
| Purchase Order Total | \$34,081.01 |

Lisa Lewis

Authorized Signature

Vendor Copy

REQUEST FOR PROPOSAL

| | | | |
|----------------|--|---------------------------|--|
| PROJECT: | Phase II Athletics - Bid Package No. 2 North Bullitt Field House Bullitt County Public Schools | REQUEST FOR PROPOSAL NO.: | 08 |
| OWNER: | Bullitt County Public Schools 1040 Highway 44 East Shepherdsville, KY 40165 | DATE: | 13-Jun-2025 |
| TO CONTRACTOR: | Calhoun Construction Services, Inc. 7707 National Turnpike Louisville, KY 40218 | ARCHITECT: | Studio Kremer Architects 1231 S Shelby Street Louisville, KY 40203 |
| | | ARCHITECT'S PROJECT NO.: | 2023-50 BG# 24-192 |

Please submit an itemized quotation for changes in the Contract Sum and/or Time incidental to proposed modifications to the Contract Documents described herein.

THIS IS NOT A CHANGE ORDER NOR A DIRECTION TO PROCEED WITH THE WORK DESCRIBED HEREIN

Description:

Provide price proposal for the following:

- Item No.1** Refer to A9.31 NBHS
- Omit flooring material and installation at Weight Room NB-204.
 - Omit rubber wall base material and installation at Weight Room NB-204.
 - Omit floor transitions where required at Weight Room NB-204 door openings.

Attachments:

Revised Drawing: A9.31 NBHS

| | | | |
|-------------|-------------------------------------|------------|--------------------------|
| ISSUED: | 13-Jun-2025 | ARCHITECT: | studio kremer architects |
| CONTRACTOR: | Calhoun Construction Services, Inc. | BY: | Cate Noble Ward, AIA |

100% CONSTRUCTION DOCUMENTS - ISSUED FOR BID

| Room No. | Room Name | Floor | North | South | East | West | Finish Comments |
|----------|---------------------|-------|-------|-------|------|------|-----------------|
| NB-101 | TICKETS | SC 01 | PF-9 | PF-9 | PF-9 | DT-5 | |
| NB-102 | VEHICLE CLOAKING | SC 01 | PF-9 | PF-9 | PF-9 | DT-5 | |
| NB-103 | EQUIPMENT | SC 01 | PF-9 | PF-9 | PF-9 | DT-5 | |
| NB-104 | LAUNDRY | SC 01 | PF-9 | PF-9 | PF-9 | DT-5 | |
| NB-105 | TRACK STORAGE | SC 01 | PF-9 | PF-9 | PF-9 | DT-5 | |
| NB-106 | WEET ROOM | SC 01 | PF-9 | PF-9 | PF-9 | DT-5 | |
| NB-107 | CLASS STAIR | SC 01 | PF-9 | PF-9 | PF-9 | DT-5 | |
| NB-108 | WRESTLING MAT ROOM | SC 01 | PF-9 | PF-9 | PF-9 | DT-5 | |
| NB-109 | WRESTLING OFFICE | SC 01 | PF-9 | PF-9 | PF-9 | DT-5 | |
| NB-110 | WRESTLING LOCKER RM | SC 01 | PF-9 | PF-9 | PF-9 | DT-5 | |
| NB-111 | WRESTLING MEN'S | SC 01 | PF-9 | PF-9 | PF-9 | DT-5 | |
| NB-112 | WRESTLING WOMEN'S | SC 01 | PF-9 | PF-9 | PF-9 | DT-5 | |
| NB-113 | WRESTLING MEN'S | SC 01 | PF-9 | PF-9 | PF-9 | DT-5 | |
| NB-114 | WRESTLING WOMEN'S | SC 01 | PF-9 | PF-9 | PF-9 | DT-5 | |
| NB-115 | WRESTLING MEN'S | SC 01 | PF-9 | PF-9 | PF-9 | DT-5 | |
| NB-116 | WRESTLING WOMEN'S | SC 01 | PF-9 | PF-9 | PF-9 | DT-5 | |
| NB-117 | WRESTLING MEN'S | SC 01 | PF-9 | PF-9 | PF-9 | DT-5 | |
| NB-118 | WRESTLING WOMEN'S | SC 01 | PF-9 | PF-9 | PF-9 | DT-5 | |
| NB-119 | WRESTLING MEN'S | SC 01 | PF-9 | PF-9 | PF-9 | DT-5 | |
| NB-120 | WRESTLING WOMEN'S | SC 01 | PF-9 | PF-9 | PF-9 | DT-5 | |
| NB-121 | WRESTLING MEN'S | SC 01 | PF-9 | PF-9 | PF-9 | DT-5 | |
| NB-122 | WRESTLING WOMEN'S | SC 01 | PF-9 | PF-9 | PF-9 | DT-5 | |
| NB-123 | WRESTLING MEN'S | SC 01 | PF-9 | PF-9 | PF-9 | DT-5 | |
| NB-124 | WRESTLING WOMEN'S | SC 01 | PF-9 | PF-9 | PF-9 | DT-5 | |
| NB-125 | WRESTLING MEN'S | SC 01 | PF-9 | PF-9 | PF-9 | DT-5 | |
| NB-126 | WRESTLING WOMEN'S | SC 01 | PF-9 | PF-9 | PF-9 | DT-5 | |
| NB-127 | WRESTLING MEN'S | SC 01 | PF-9 | PF-9 | PF-9 | DT-5 | |
| NB-128 | WRESTLING WOMEN'S | SC 01 | PF-9 | PF-9 | PF-9 | DT-5 | |
| NB-129 | WRESTLING MEN'S | SC 01 | PF-9 | PF-9 | PF-9 | DT-5 | |
| NB-130 | WRESTLING WOMEN'S | SC 01 | PF-9 | PF-9 | PF-9 | DT-5 | |
| NB-131 | WRESTLING MEN'S | SC 01 | PF-9 | PF-9 | PF-9 | DT-5 | |
| NB-132 | WRESTLING WOMEN'S | SC 01 | PF-9 | PF-9 | PF-9 | DT-5 | |
| NB-133 | WRESTLING MEN'S | SC 01 | PF-9 | PF-9 | PF-9 | DT-5 | |
| NB-134 | WRESTLING WOMEN'S | SC 01 | PF-9 | PF-9 | PF-9 | DT-5 | |
| NB-135 | WRESTLING MEN'S | SC 01 | PF-9 | PF-9 | PF-9 | DT-5 | |
| NB-136 | WRESTLING WOMEN'S | SC 01 | PF-9 | PF-9 | PF-9 | DT-5 | |
| NB-137 | WRESTLING MEN'S | SC 01 | PF-9 | PF-9 | PF-9 | DT-5 | |
| NB-138 | WRESTLING WOMEN'S | SC 01 | PF-9 | PF-9 | PF-9 | DT-5 | |
| NB-139 | WRESTLING MEN'S | SC 01 | PF-9 | PF-9 | PF-9 | DT-5 | |
| NB-140 | WRESTLING WOMEN'S | SC 01 | PF-9 | PF-9 | PF-9 | DT-5 | |
| NB-141 | WRESTLING MEN'S | SC 01 | PF-9 | PF-9 | PF-9 | DT-5 | |
| NB-142 | WRESTLING WOMEN'S | SC 01 | PF-9 | PF-9 | PF-9 | DT-5 | |
| NB-143 | WRESTLING MEN'S | SC 01 | PF-9 | PF-9 | PF-9 | DT-5 | |
| NB-144 | WRESTLING WOMEN'S | SC 01 | PF-9 | PF-9 | PF-9 | DT-5 | |
| NB-145 | WRESTLING MEN'S | SC 01 | PF-9 | PF-9 | PF-9 | DT-5 | |
| NB-146 | WRESTLING WOMEN'S | SC 01 | PF-9 | PF-9 | PF-9 | DT-5 | |
| NB-147 | WRESTLING MEN'S | SC 01 | PF-9 | PF-9 | PF-9 | DT-5 | |
| NB-148 | WRESTLING WOMEN'S | SC 01 | PF-9 | PF-9 | PF-9 | DT-5 | |
| NB-149 | WRESTLING MEN'S | SC 01 | PF-9 | PF-9 | PF-9 | DT-5 | |
| NB-150 | WRESTLING WOMEN'S | SC 01 | PF-9 | PF-9 | PF-9 | DT-5 | |

| Room No. | Room Name | Floor | North | South | East | West | Finish Comments |
|----------|-------------------|-------|-------|-------|------|------|-----------------|
| NB-151 | WRESTLING MEN'S | SC 01 | PF-9 | PF-9 | PF-9 | DT-5 | |
| NB-152 | WRESTLING WOMEN'S | SC 01 | PF-9 | PF-9 | PF-9 | DT-5 | |
| NB-153 | WRESTLING MEN'S | SC 01 | PF-9 | PF-9 | PF-9 | DT-5 | |
| NB-154 | WRESTLING WOMEN'S | SC 01 | PF-9 | PF-9 | PF-9 | DT-5 | |
| NB-155 | WRESTLING MEN'S | SC 01 | PF-9 | PF-9 | PF-9 | DT-5 | |
| NB-156 | WRESTLING WOMEN'S | SC 01 | PF-9 | PF-9 | PF-9 | DT-5 | |
| NB-157 | WRESTLING MEN'S | SC 01 | PF-9 | PF-9 | PF-9 | DT-5 | |
| NB-158 | WRESTLING WOMEN'S | SC 01 | PF-9 | PF-9 | PF-9 | DT-5 | |
| NB-159 | WRESTLING MEN'S | SC 01 | PF-9 | PF-9 | PF-9 | DT-5 | |
| NB-160 | WRESTLING WOMEN'S | SC 01 | PF-9 | PF-9 | PF-9 | DT-5 | |
| NB-161 | WRESTLING MEN'S | SC 01 | PF-9 | PF-9 | PF-9 | DT-5 | |
| NB-162 | WRESTLING WOMEN'S | SC 01 | PF-9 | PF-9 | PF-9 | DT-5 | |
| NB-163 | WRESTLING MEN'S | SC 01 | PF-9 | PF-9 | PF-9 | DT-5 | |
| NB-164 | WRESTLING WOMEN'S | SC 01 | PF-9 | PF-9 | PF-9 | DT-5 | |
| NB-165 | WRESTLING MEN'S | SC 01 | PF-9 | PF-9 | PF-9 | DT-5 | |
| NB-166 | WRESTLING WOMEN'S | SC 01 | PF-9 | PF-9 | PF-9 | DT-5 | |
| NB-167 | WRESTLING MEN'S | SC 01 | PF-9 | PF-9 | PF-9 | DT-5 | |
| NB-168 | WRESTLING WOMEN'S | SC 01 | PF-9 | PF-9 | PF-9 | DT-5 | |
| NB-169 | WRESTLING MEN'S | SC 01 | PF-9 | PF-9 | PF-9 | DT-5 | |
| NB-170 | WRESTLING WOMEN'S | SC 01 | PF-9 | PF-9 | PF-9 | DT-5 | |
| NB-171 | WRESTLING MEN'S | SC 01 | PF-9 | PF-9 | PF-9 | DT-5 | |
| NB-172 | WRESTLING WOMEN'S | SC 01 | PF-9 | PF-9 | PF-9 | DT-5 | |
| NB-173 | WRESTLING MEN'S | SC 01 | PF-9 | PF-9 | PF-9 | DT-5 | |
| NB-174 | WRESTLING WOMEN'S | SC 01 | PF-9 | PF-9 | PF-9 | DT-5 | |
| NB-175 | WRESTLING MEN'S | SC 01 | PF-9 | PF-9 | PF-9 | DT-5 | |
| NB-176 | WRESTLING WOMEN'S | SC 01 | PF-9 | PF-9 | PF-9 | DT-5 | |
| NB-177 | WRESTLING MEN'S | SC 01 | PF-9 | PF-9 | PF-9 | DT-5 | |
| NB-178 | WRESTLING WOMEN'S | SC 01 | PF-9 | PF-9 | PF-9 | DT-5 | |
| NB-179 | WRESTLING MEN'S | SC 01 | PF-9 | PF-9 | PF-9 | DT-5 | |
| NB-180 | WRESTLING WOMEN'S | SC 01 | PF-9 | PF-9 | PF-9 | DT-5 | |
| NB-181 | WRESTLING MEN'S | SC 01 | PF-9 | PF-9 | PF-9 | DT-5 | |
| NB-182 | WRESTLING WOMEN'S | SC 01 | PF-9 | PF-9 | PF-9 | DT-5 | |
| NB-183 | WRESTLING MEN'S | SC 01 | PF-9 | PF-9 | PF-9 | DT-5 | |
| NB-184 | WRESTLING WOMEN'S | SC 01 | PF-9 | PF-9 | PF-9 | DT-5 | |
| NB-185 | WRESTLING MEN'S | SC 01 | PF-9 | PF-9 | PF-9 | DT-5 | |
| NB-186 | WRESTLING WOMEN'S | SC 01 | PF-9 | PF-9 | PF-9 | DT-5 | |
| NB-187 | WRESTLING MEN'S | SC 01 | PF-9 | PF-9 | PF-9 | DT-5 | |
| NB-188 | WRESTLING WOMEN'S | SC 01 | PF-9 | PF-9 | PF-9 | DT-5 | |
| NB-189 | WRESTLING MEN'S | SC 01 | PF-9 | PF-9 | PF-9 | DT-5 | |
| NB-190 | WRESTLING WOMEN'S | SC 01 | PF-9 | PF-9 | PF-9 | DT-5 | |
| NB-191 | WRESTLING MEN'S | SC 01 | PF-9 | PF-9 | PF-9 | DT-5 | |
| NB-192 | WRESTLING WOMEN'S | SC 01 | PF-9 | PF-9 | PF-9 | DT-5 | |
| NB-193 | WRESTLING MEN'S | SC 01 | PF-9 | PF-9 | PF-9 | DT-5 | |
| NB-194 | WRESTLING WOMEN'S | SC 01 | PF-9 | PF-9 | PF-9 | DT-5 | |
| NB-195 | WRESTLING MEN'S | SC 01 | PF-9 | PF-9 | PF-9 | DT-5 | |
| NB-196 | WRESTLING WOMEN'S | SC 01 | PF-9 | PF-9 | PF-9 | DT-5 | |
| NB-197 | WRESTLING MEN'S | SC 01 | PF-9 | PF-9 | PF-9 | DT-5 | |
| NB-198 | WRESTLING WOMEN'S | SC 01 | PF-9 | PF-9 | PF-9 | DT-5 | |
| NB-199 | WRESTLING MEN'S | SC 01 | PF-9 | PF-9 | PF-9 | DT-5 | |
| NB-200 | WRESTLING WOMEN'S | SC 01 | PF-9 | PF-9 | PF-9 | DT-5 | |

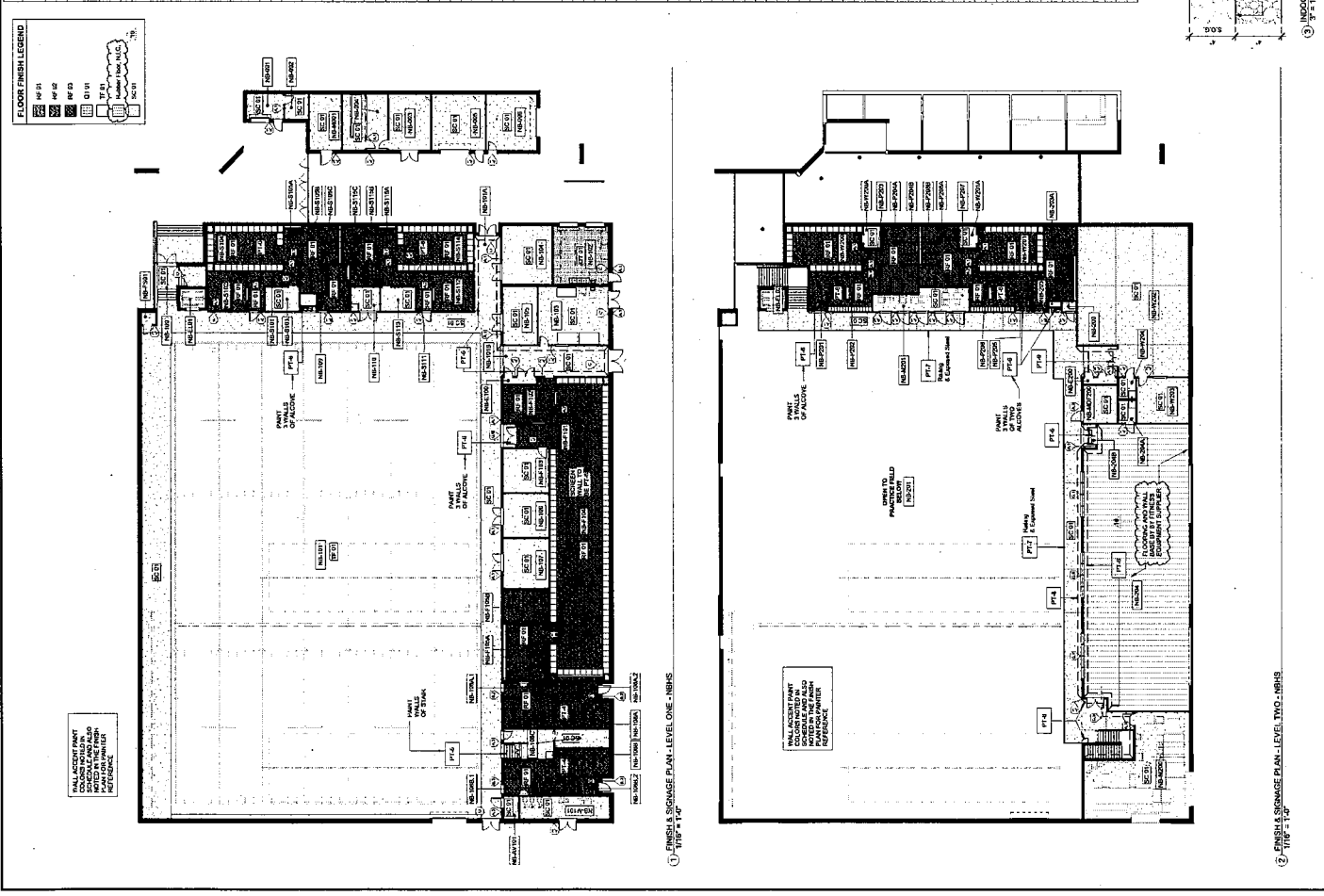

1 FINISH SCHEDULE PLAN - LEVEL ONE - NBHS
2 FINISH SCHEDULE PLAN - LEVEL TWO - NBHS

INTERIOR FINISH GENERAL NOTES
FLOOR FINISH SCHEDULE - NBHS
WALL FINISH SCHEDULE - NBHS
CEILING FINISH SCHEDULE - NBHS
BASE FINISH SCHEDULE - NBHS
CEILING FINISH LEGEND
BASE FINISH LEGEND
EAGLES
SIGN TYPE "02"
SIGN TYPE "03"
INDOOR LIGHT TRANSITION - COOP