

**DANNY CLEMENS, DIRECTOR**  
TRACY PARSLEY, MAINTENANCE SUPERVISOR  
THOMAS STOKES, CUSTODIAL SUPERVISOR  
GEORGE BROCK, ENERGY MANAGER

**DEPARTMENT OF FACILITIES**

**MEMO**

TO: Dr. Jesse Bacon, Superintendent  
FROM: Danny Clemens, Director of Facilities  
Date: May 12, 2025  
RE: LG&E Deed of Easement- North Bullitt Physical Science Center **DC**

Approval is sought for ongoing work at the North Bullitt Physical Science Center with Louisville Gas and Electric. This involves a time-sensitive deed of easement permitting LG&E to install a 145' x 15' underground powerline servicing the center. The easement is under review by Dinsmore & Shoh. Permission is requested to accept the agreement upon Dinsmore & Shoh's approval for BCPS.

**I recommend approval of this request.**

Attached:

- Easement Drawing (Board reference)

**OUR MISSION IS TO INSPIRE AND EQUIP OUR STUDENTS TO SUCCEED IN LIFE**

**BULLITT COUNTY PUBLIC SCHOOLS IS AN EQUAL EDUCATION AND EMPLOYMENT INSTITUTION**

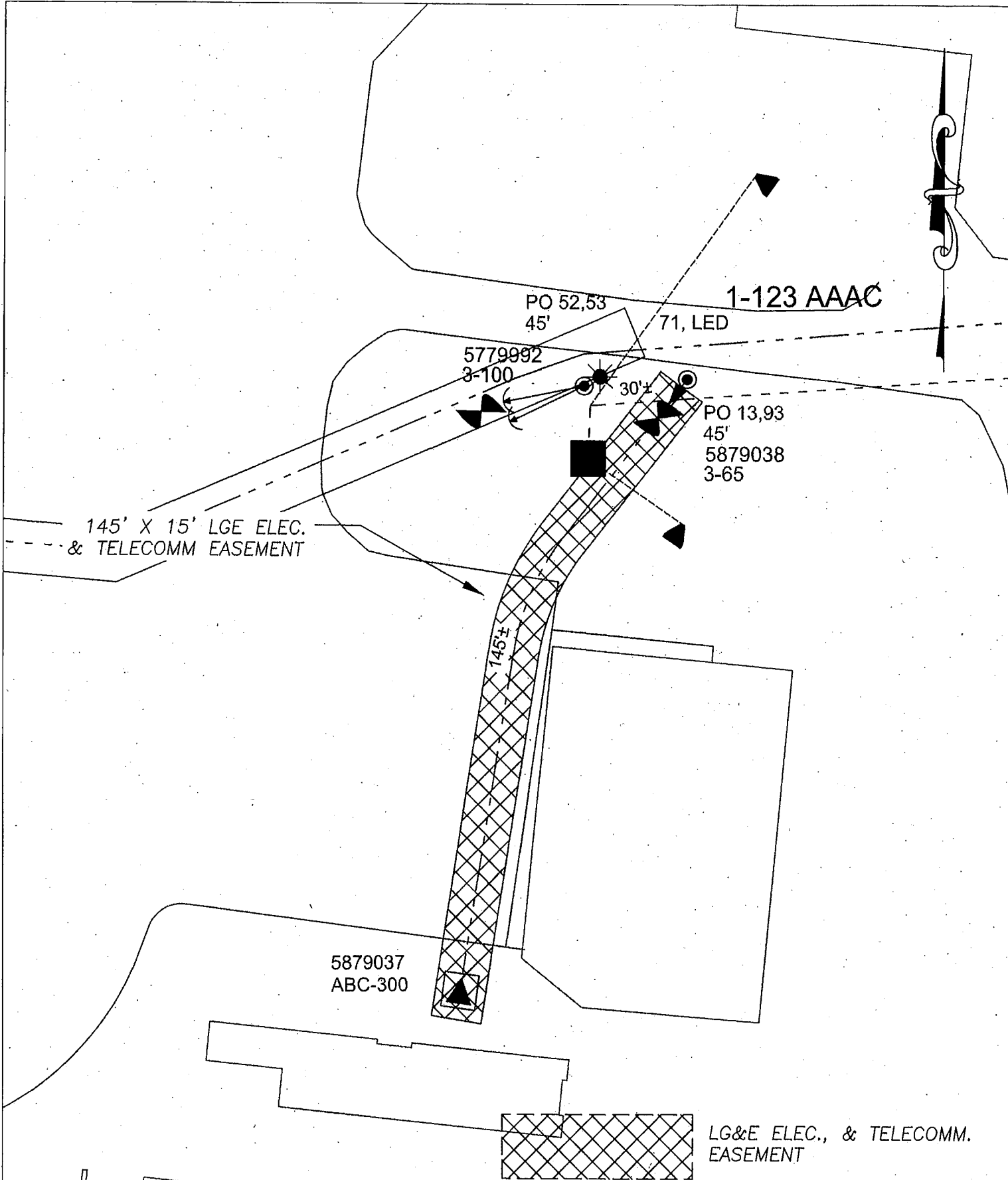

WR#: 7617006  
PROJECT#: ANBCD343U  
TASK#: 7617006101  
SHEET 1 OF 1

NB - UG DESIGN  
3200 E HEBRON LN  
NORTH BULLITT  
FIELD HOUSE

EASEMENT DRAWING	
DRAWN BY: ARNOLD, JEFF	DATE: 2/13/2025
PHONE #: 502-364-8380	SCALE: NTS

**LG&E KU.**  
LOUISVILLE GAS and ELECTRIC COMPANY  
a PPL company  
POWER DELIVERY ENGINEERING