

DANNY CLEMENS, DIRECTOR
TRACY PARSLEY, MAINTENANCE SUPERVISOR
THOMAS STOKES, CUSTODIAL SUPERVISOR
GEORGE BROCK, ENERGY MANAGER

DEPARTMENT OF FACILITIES

MEMO

TO: Dr. Jesse Bacon, Superintendent
FROM: Danny Clemens, Director of Facilities
Date: August 19, 2024
RE: BEHS Fine Arts - Change Order 11 -Added Parking Lot and Softball Field
Demolition **DC**

It was recommended by the Design Team and confirmed by BCPS Leadership that work to construct a new 191 car parking lot and underground storm detention system be shifted to the Bullitt East Fine Arts Contract held by EH Construction. This is recommended due to the parking lot's location above the geothermal field that EH is constructing. Work also includes the demolition of the existing Softball Field. Originally, it was assumed this work would be held by the Phase II Athletics Contractor, however, the parking lot design and construction allowed for this work to be shifted to the BEHS Fine Arts contract which shifted the responsibility of all the work in the area to one contractor. This is a better outcome for the project and Owner in case any work needs to be corrected during construction. EH Construction provided two change order requests for this work, one shows costs based on Contract Unit Prices, the other shows the Bid Cost that can be extended by the Construction team. The cost difference between these two Change Order Requests is \$622,400.48.

I recommend approval of this request.

OUR MISSION IS TO INSPIRE AND EQUIP OUR STUDENTS TO SUCCEED IN LIFE

BULLITT COUNTY PUBLIC SCHOOLS IS AN EQUAL EDUCATION AND EMPLOYMENT INSTITUTION

I recommend approval of this request.

Attached paperwork is listed below with *action items* noted for each:

- AIA G701 - BEHS Fine Arts-CO #11 Added Parking Lot and Softball Field Demolition - for Board Signature
- BEHS-Fine Arts-COR #16-RFP-13-Parking Lot & Storm Revisions (BID COST)- No action – for Board Reference.
- BEHS-Fine Arts-COR #16-RFP-13-Parking Lot & Storm Revisions (UNIT PRICES) – No Action – for Board Reference.
 - Please note, this COR is showing the cost if Contract Unit Prices were utilized. EH/Trademark have extended a Bid Cost for this work per the “Bid Cost” COR listed above resulting in a \$622,400.48 reduction in cost for this Work.
- BEHS FA - RFP 13 - Parking Lot and Storm Revisions (Issued 6-5-2024) – No Action – for Board Reference.



AIA Document G701® – 2017

Change Order

PROJECT: (Name and address)

Bullitt East High School Fine Arts Addition
11450 KY-44, Mt Washington, KY 40047

CONTRACT INFORMATION:

Contract For: General Construction

Date: December 18, 2023

CHANGE ORDER INFORMATION:

Change Order Number: 011

Date: August 12, 2024

OWNER: (Name and address)

Bullitt County Public Schools Board of Education
1040 Hwy 44 East
Shepherdsville, KY 40165

ARCHITECT: (Name and address)

Studio Kremer Architects, Inc.
1231 S. Shelby Street
Louisville, KY 40203

CONTRACTOR: (Name and address)

EH Construction, LLC
1188 E. Bluelick Road
Shepherdsville, KY 40165

THE CONTRACT IS CHANGED AS FOLLOWS:

(Insert a detailed description of the change and, if applicable, attach or reference specific exhibits. Also include agreed upon adjustments attributable to executed Construction Change Directives.)

See COR #16 (BID COST) and RFP #13 for scope of Work included in this Change Order.

The original Contract Sum was	\$	25,486,890.80
The net change by previously authorized Change Orders	\$	601,438.62
The Contract Sum prior to this Change Order was	\$	26,088,329.42
The Contract Sum will be increased by this Change Order in the amount of	\$	1,720,950.41
The new Contract Sum including this Change Order will be	\$	27,809,279.83

The Contract Time will be unchanged by Zero (0) days.

The new date of Substantial Completion will be

NOTE: This Change Order does not include adjustments to the Contract Sum or Guaranteed Maximum Price, or the Contract Time, that have been authorized by Construction Change Directive until the cost and time have been agreed upon by both the Owner and Contractor, in which case a Change Order is executed to supersede the Construction Change Directive.

NOT VALID UNTIL SIGNED BY THE ARCHITECT, CONTRACTOR AND OWNER.

Studio Kremer Architects, Inc.

EH Construction, LLC

Bullitt County Public Schools Board of Education

ARCHITECT (Firm name)

CONTRACTOR (Firm name)

OWNER (Firm name)

SIGNATURE

SIGNATURE

SIGNATURE

Catherine Noble Ward, AIA

PRINTED NAME AND TITLE

Mike Rippy, Project Manager

PRINTED NAME AND TITLE

Dr. Jesse Bacon, Superintendent

PRINTED NAME AND TITLE

DATE

DATE

DATE



EH CONSTRUCTION, LLC

GENERAL CONTRACTORS • CONSTRUCTION MANAGERS

P.O. BOX 910

BROOKS, KY 40109

(502) 957-7471 • FAX (502) 957-3420

July 17, 2024

Studio Kremer Architects
1231 Shelby Street
Louisville, KY 40203

Re: BEHS-Fine Arts Addition/COR #16/RFP-13/Parking Lot and Storm Revisions (BID PRICING)

Trademark Excavating	\$ 1,467,162.00
Uessler Construction (2,500 SF Sidewalk @ 5.80)	\$ 14,500.00
15% OH & Profit	\$ 222,249.30
1% Payment & Performance Bond	\$ 17,039.11

Total Requested Change Order: \$ 1,720,950.41

Sincerely,

Mike Rippy

Mike Rippy
EH Construction, LLC

TRADEMARK EXCAVATING COMPANY, LLC

151 Atkinson Hill Avenue
Bardstown, Kentucky 40004
Office: 502.348.1204 Fax: 502.348.3504
Phillip (c): 502.827.8584 Tyler(c): 502.460.6901
e-mail: tyler@trademarkexcavating.com
e-mail: phillip@trademarkexcavating.com
www.trademarkexcavating.com

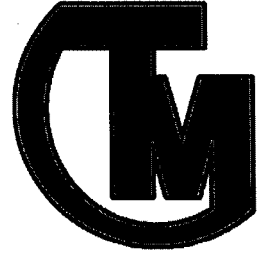

Bullitt East High School - RFP #13 Mt. Washington, Kentucky July 16, 2024

ITEM	UNIT	TAKE OFF QUANTITY	UNIT PRICE	EXTENSION
General Conditions				
Additional Mobilization	L.S.	1		
Additional Construction Staking	L.S.	1		
Vacuum Excavation for Utilities	L.S.	1		
			General Conditions Total:	\$ 41,500.00
Erosion Prevention & Sediment Control				
BMP Maintenance	L.S.	1		
			Erosion Prevention & Sediment Control Total:	\$ 5,200.00
Demolition				
Remove 48" HDPE	L.F.	40		
Remove 48" Headwall	Each	1		
Saw Cut Asphalt	L.F.	160		
Demo Asphalt	C.Y.	10		
Demo Asphalt Stone	C.Y.	19		
Demo Concrete	C.Y.	34		
Demo Concrete DGA	C.Y.	34		
Demo Gravel	C.Y.	6		
Demo Softball Field Sand	C.Y.	250		
Demo Softball Field Fence	L.F.	602		
Demo Tall Fence	L.F.	170		
Demo Retaining Wall	L.F.	190		
Demo Press Box	Each	1		
Demo Block Dugouts	Each	2		
Demo Water Spigot	Each	2		
Demo Existing Lights	Each	4		
Clear Trees	L.S.	1		
			Demolition Total:	\$ 56,082.00
Earthwork				
Strip Topsoil	C.Y.	1,810		
Excavation and Embankment On Site	C.Y.	1,575		
Shape and Roll Asphalt Subgrade	S.Y.	6,653		
Shape and Roll Sidewalk Subgrade	S.Y.	488		
Replace Topsoil	C.Y.	924		
Stage Excess Topsoil Onsite	C.Y.	886		
Export Fill Material	C.Y.	4,031		
Export Spoils from UGB 1	C.Y.	712		
Stage Excess Fill Onsite	C.Y.	1,333		
Export Soild Rock	C.Y.	1,226		
Mass Finish Grade	S.Y.	5,574		
Temporary Seed & Straw	S.Y.	5,574		
			Earthwork Total:	\$ 287,556.00

Site Storm Work

#9 Bedding (4" Below & 12" Above)	Tons	45
#3 Stone to Subgrade	Tons	34
Export Pipe Spoils	C.Y.	50
Tie into Existing CB15 & Core New Hole	Each	1
Tie into Existing Pipes with 4' Dia CI Type G	Each	1
Replace 48" Headwall	Each	1
2' x 2' Outlet Structure	Each	1
4' Diameter Curb Inlet Type G	Each	1
3' x 3' Catch Basin	Each	2
2' x 2' Catch Basin	Each	1
12" HDPE	L.F.	75
18" HDPE	L.F.	81
Concrete Cap	C.Y.	8
Soild Rock Removal	C.Y.	126

Site Storm Work Total: \$ 91,894.00

Underground Detention Basin

Excavate Basin Stage On Site	C.Y.	1,667
4' Diameter Storm Manhole	Each	4
#2 Stone Below (12")	Tons	505
#2 Stone Around (16")	Tons	290
#2 Stone Above (12")	Tons	505
#2 Stone (to Subgrade)	Tons	733
Non-Woven Geotextile Fabric	S.Y.	2,219
Install UGB	L.S.	1
Soild Rock Removal	C.Y.	1,100

Underground Detention Basin Total: \$ 664,298.00

Curb

12" Vertical Curb	L.F.	620
Stone under Curb	Tons	95

Curb Total: \$ 18,244.00

Asphalt

Asphalt Mobilization	Each	2
Asphalt Overlay (1")	Tons	90
Light Duty Asphalt Surface (1.5")	Tons	551
Light Duty Asphalt Base (2.5")	Tons	915
Light Duty Asphalt DGA (8")	Tons	3,062
Striping	L.S.	1
Edge Key	L.S.	1

Asphalt Total: \$ 302,388.00

Project Total

\$1,467,162.00

Exclusions

- Sanitary Sewer
- Domestic Water
- Fire Water
- Permits, bonding, and fees. Our bonding rate is 3% to be added to the above price.
- Allowances.
- Compaction or concrete testing.
- Footer excavation and/or backfill or foundation drainage.
- Stone base under building slab, sidewalk or dumpster pads.
- Undercutting/removal of unsuitable or contaminated material or refill of same.
- Removal or relocation of existing utilities & light poles.
- Utility disconnections. Utility removal will take place when utilities are deemed disconnected by others.
- Any work to be performed by a licensed fire protection contractor.
- Trademark Excavating is NOT a licensed sprinkler contractor.
- Fire protection, telephone, cable, gas, communication or electric work.
- Spoils removal for others or cleanup after others.
- Fencing, retaining walls, bollards or dumpster enclosures.
- Site concrete work
- Landscaping, mulch, or sod.
- As-builts, or PLS services.
- Any signage
- Relocation of existing electric lines
- Cast Iron Downspout Boots
- Addition, removal and/or replacement of stone after initial shape & roll is excluded
- Additional shape and roll(s) to previously prepped areas are excluded
- Prevailing Wages

Notes

- Only the items in the above scope of work are included in this proposal.
- Due to current supply chain disruptions, materials are subject to pricing at time of shipment. Material availability and timeliness of shipments cannot be guaranteed. This term supersedes all other contractual provisions.
- Pricing subject to change as market value fluctuates
- Pricing based off plans RFP 13 by Buzick Construction
- Pricing is based off a normal (5) day/40 hour work week
- Pricing is considered lump sum - therefore any additions or deletions to this quote should be approved by TME
- No Addenda Acknowledged
- Any borrow or waste material to be obtained from open areas on site.
- TME must be notified of plan revisions as soon as possible to minimize construction delays.
- TME reserves the right to revise pricing should revisions be made to plans.
- TME reserves the right to revise pricing if scopes of work are removed from this proposal
- Utility installation will match existing unless plans indicate otherwise
- Not responsible for unmarked utility lines.
- All utilities are to be installed to 5' from building.

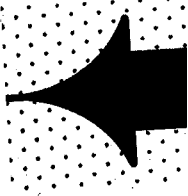

Signature: _____

Printed: _____

Title: _____

Date: _____

Customer

Signature: _____

Printed: _____

Title: _____

Date: _____

Trademark Excavating Co. LLC

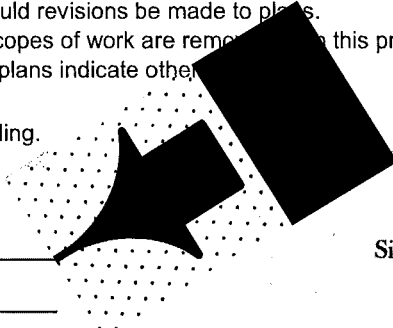



EH CONSTRUCTION, LLC
GENERAL CONTRACTORS • CONSTRUCTION MANAGERS
P.O. BOX 910
BROOKS, KY 40109
(502) 957-7471 • FAX (502) 957-3420

July 17, 2024

Studio Kremer Architects
1231 Shelby Street
Louisville, KY 40203

Re: BEHS-Fine Arts Addition/COR #16/RFP-13/Parking Lot and Storm Revisions (BID PRICING)

Trademark Excavating	\$ 2,227,506.00
Uessler Construction (2,500 SF Sidewalk @ 5.80)	\$ 14,500.00
15% OH & Profit (Non Unit Price Items)	\$ 78,143.40
1% Payment & Performance Bond	\$ 23,201.49

Total Requested Change Order: \$ 2,343,350.89

Sincerely,

Mike Rippy

Mike Rippy
EH Construction, LLC

TRADEMARK EXCAVATING COMPANY, LLC

151 Atkinson Hill Avenue
 Bardstown, Kentucky 40004
 Office: 502.348.1204 Fax: 502.348.3504
 Phillip (c): 502.827.8584 Tyler(c): 502.460.6901
 e-mail: tyler@trademarkexcavating.com
 e-mail: phillip@trademarkexcavating.com
 www.trademarkexcavating.com

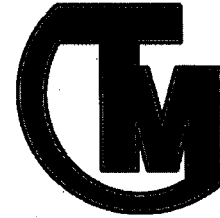

Bullitt East High School - RFP #13 Mt. Washington, Kentucky July 16, 2024

ITEM	UNIT	TAKE OFF QUANTITY	UNIT PRICE	EXTENSION
<u>Unit Rate Pricing</u>				
<u>Earthwork Products</u>				
Excavation and Embankment On Site	C.Y.	1,575	\$ 45.00	\$ 70,875.00
Stage Excess Topsoil Onsite	C.Y.	886	\$ 45.00	\$ 39,870.00
Export Fill Material	C.Y.	4,031	\$ 45.00	\$ 181,395.00
Export Spoils from UGB 1	C.Y.	712	\$ 45.00	\$ 32,040.00
Stage Excess Fill Onsite	C.Y.	1,333	\$ 45.00	\$ 59,985.00
Pipe Spoils	C.Y.	50	\$ 45.00	\$ 2,250.00
Excavate Basin Stage Onsite	C.Y.	1,667	\$ 45.00	\$ 75,015.00
<u>Asphalt Products</u>				
Asphalt Overlay (1")	S.Y.	1,585	\$ 18.00	\$ 28,530.00
Light Duty Asphalt Surface (1.5")	S.Y.	6,653	\$ 27.00	\$ 179,631.00
Light Duty Asphalt Base (2.5")	S.Y.	6,653	\$ 45.00	\$ 299,385.00
<u>DGA Products</u>				
Light Duty Asphalt DGA (8")	Tons	3,062	\$ 46.00	\$ 140,852.00
Stone under Curb	Tons	95	\$ 46.00	\$ 4,352.00
<u>Excavate and Haul Off Rock</u>				
Storm	C.Y.	126	\$ 495.00	\$ 62,370.00
Underground Basin	C.Y.	1,100	\$ 495.00	\$ 544,500.00
Unit Rate Pricing Total:				\$ 1,721,050.00
<u>Additional Work Non Unit Rate</u>				
<u>General Conditions</u>				
Additional Mobilization	L.S.	1		
Additional Construction Staking	L.S.	1		
Vacuum Excavation for Utilities	L.S.	1		
General Conditions Total:				\$ 41,500.00
<u>Erosion Prevention & Sediment Control</u>				
BMP Maintenance	L.S.	1		
Erosion Prevention & Sediment Control Total:				\$ 5,200.00
<u>Demolition</u>				
Remove 48" HDPE	L.F.	40		
Remove 48" Headwall	Each	1		
Saw Cut Asphalt	L.F.	160		
Demo Asphalt	C.Y.	10		
Demo Asphalt Stone	C.Y.	19		
Demo Concrete	C.Y.	34		
Demo Concrete DGA	C.Y.	34		
Demo Gravel	C.Y.	6		
Demo Softball Field Sand	C.Y.	250		
Demo Softball Field Fence	L.F.	602		
Demo Tall Fence	L.F.	170		
Demo Retaining Wall	L.F.	190		
Demo Press Box	Each	1		
Demo Block Dugouts	Each	2		
Demo Water Spigot	Each	2		
Demo Existing Lights	Each	4		
Clear Trees	L.S.	1		
Demolition Total:				\$ 56,082.00

Earthwork

Strip Topsoil	C.Y.	1,810
Shape and Roll Asphalt Subgrade	S.Y.	6,653
Shape and Roll Sidewalk Subgrade	S.Y.	488
Replace Topsoil	C.Y.	924
Mass Finish Grade	S.Y.	5,574
Temporary Seed & Straw	S.Y.	5,574

Earthwork Total: \$ 70,269.00

Site Storm Work

#9 Bedding (4" Below & 12" Above)	Tons	45
#3 Stone to Subgrade	Tons	34
Tie into Existing CB15 & Core New Hole	Each	1
Tie into Existing Pipes with 4' Dia CI Type G	Each	1
Replace 48" Headwall	Each	1
2' x 2' Outlet Structure	Each	1
4' Diameter Curb Inlet Type G	Each	1
3' x 3' Catch Basin	Each	2
2' x 2' Catch Basin	Each	1
12" HDPE	L.F.	75
18" HDPE	L.F.	81
Concrete Cap	C.Y.	8

Site Storm Work Total: \$ 46,344.00

Underground Detention Basin

4' Diameter Storm Manhole	Each	4
#2 Stone Below (12")	Tons	505
#2 Stone Around (16")	Tons	290
#2 Stone Above (12")	Tons	505
#2 Stone (to Subgrade)	Tons	733
Non-Woven Geotextile Fabric	S.Y.	2,219
Install UGB	L.S.	1

Underground Detention Basin Total: \$ 260,961.00

Curb

12" Vertical Curb	L.F.	620
-------------------	------	-----

Curb Total: \$ 15,500.00

Asphalt

Mobilization	Each	2
Striping	L.S.	1
Edge Key	L.S.	1

Asphalt Total: \$ 10,600.00

Project Total

\$ 2,227,506.00

Exclusions

- Sanitary Sewer
- Domestic Water
- Fire Water
- Permits, bonding, and fees. Our bonding rate is 3% to be added to the above price.
- Allowances.
- Rock excavation or blasting.
- Compaction or concrete testing.
- Footer excavation and/or backfill or foundation drainage.
- Stone base under building slab, sidewalk or dumpster pads.
- Undercutting/removal of unsuitable or contaminated material or refill of same.
- Removal or relocation of existing utilities & light poles.
- Utility disconnections. Utility removal will take place when utilities are deemed disconnected by others.
- Any work to be performed by a licensed fire protection contractor.
- Trademark Excavating is NOT a licensed sprinkler contractor.
- Fire protection, telephone, cable, gas, communication or electric work.
- Spoils removal for others or cleanup after others.
- Fencing, retaining walls, bollards or dumpster enclosures.
- Site concrete work other than slip form curb
- Landscaping, mulch, or sod.
- As-builts, or PLS services.
- Any signage
- Existing Building Demolition
- Relocation of existing electric lines
- Cast Iron Downspout Boots
- Addition, removal and/or replacement of stone after initial shape & roll is excluded
- Additional shape and roll(s) to previously prepped areas are excluded
- Prevailing Wages

Notes

- Only the items in the above scope of work are included in this proposal.
- Due to current supply chain disruptions, materials are subject to pricing at time of shipment. Material availability and timeliness of shipments cannot be guaranteed. This term supersedes all other contractual provisions.
- Pricing subject to change as market value fluctuates
- Pricing based off plans RFP 13 by Buzick Construction
- Pricing is based off a normal (5) day/40 hour work week
- Pricing is considered lump sum - therefore any additions or deletions to this quote should be approved by TME
- No Addenda Acknowledged
- Any borrow or waste material to be obtained from open areas on site.
- TME must be notified of plan revisions as soon as possible to minimize construction delays.
- TME reserves the right to revise pricing should revisions be made to plans.
- TME reserves the right to revise pricing if scopes of work are removed from proposal
- Utility installation will match existing unless plans indicate otherwise
- Not responsible for unmarked utility lines.
- All utilities are to be installed to 5' from building.

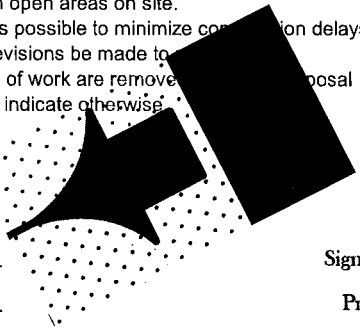
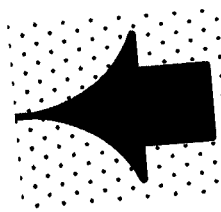

Signature: _____
 Printed: _____
 Title: _____
 Date: _____

Customer

Signature: _____
 Printed: _____
 Title: _____
 Date: _____

Trademark Excavating Co. LLC

REQUEST FOR PROPOSAL

PROJECT:	Bullitt East High School Fine Arts Addition Mt Washington, KY	REQUEST FOR PROPOSAL NO.:	13
OWNER:	Bullitt County Public Schools 1040 Highway 44 East Shepherdsville, KY 40165	DATE:	5-Jun-2024
TO CONTRACTOR:	EH Construction	ARCHITECT:	Studio Kremer Architects 1231 S Shelby Street Louisville, KY 40203
		ARCHITECT'S PROJECT NO.:	2022-35 BG# 23-050

Please submit an itemized quotation for changes in the Contract Sum and/or Time incidental to proposed modifications to the Contract Documents described herein.

THIS IS NOT A CHANGE ORDER NOR A DIRECTION TO PROCEED WITH THE WORK DESCRIBED HEREIN

Description:

Provide price proposal for the following:

- Item 1:** Expand parking lot over existing softball field and proposed geothermal field, as shown, including extension of sidewalk. Include two access points to access road. Proposed contours have been provided.
- Item 2:** Provide storm system for new parking lot including StormTech detention system. Details of StormTech system are included in the second attachment to this RFP.
- Item 3:** Remove 40 lf of 48" storm pipe and place headwall in new location.
- Item 4:** Remove portion of cul-de-sac and create entrance to existing access road. Tie in sidewalk and provide crosswalk. Replace existing catch basin with new curb inlet adjacent to sidewalk. Provide asphalt overlay on access road past entry to existing running track.
- Item 5:** Add new storm box and 12" storm pipe near new access drive adjacent to College and Career Center parking lot.
- Item 6:** Provide Credit for Balance of Track Skirt and Fence that is not yet installed around the Track.

Attachments:

C1.2, C1.3, C1.4, C2.2, C3.2, Storm Tech Details (7-Pages)

ISSUED:	5-Jun-2024	ARCHITECT:	studio kremer architects
CONTRACTOR:	EH Construction	BY:	Robin Mills, PE CMTA

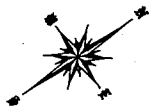

GRAPHIC SCALE 1"=30'
0 7.5 15 30 60

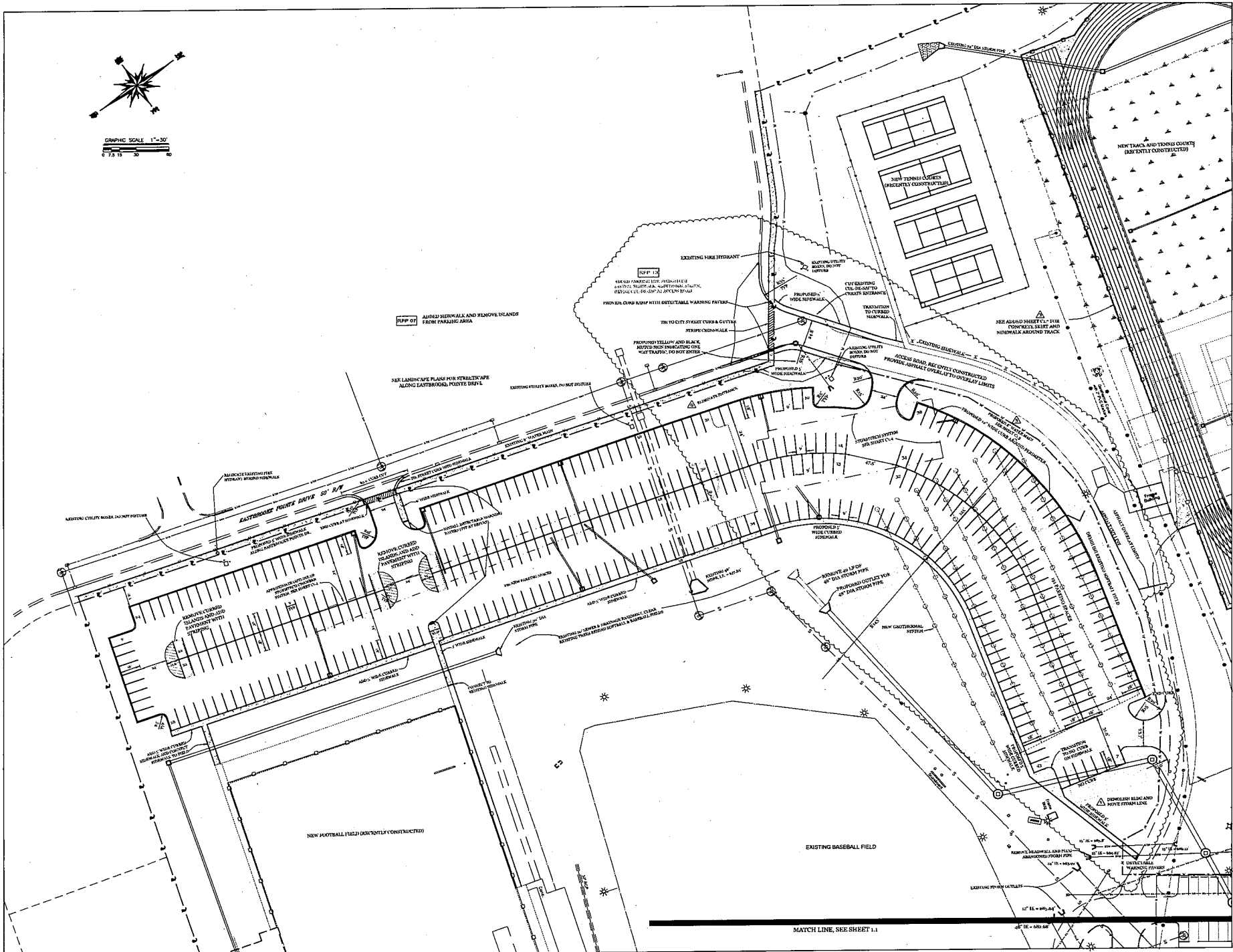

MATCH LINE, SEE SHEET 1.1

CONSTRUCTION DOCUMENTS - BID SET

SITE LAYOUT -
NEW PARKING AREAS
Bullitt East High School - Fine Arts Addition

BCG 23-050
DATE: 10/01/2022
DRAWN BY: RHM
CHECKED BY: SAA
REVISIONS:

2022-35

C1.2

STUDIO KRAMER architects
1311 S. South St., Ithaca, NY 14850
TEL: 607-255-1100 FAX: 607-255-1101



BUZICK
CONSTRUCTION, INC.
1111 Hudson Ave.
Ithaca, NY 14850
Phone: (607) 255-2800



BULLITT
PUBLIC
SCHOOLS
Moving Forward

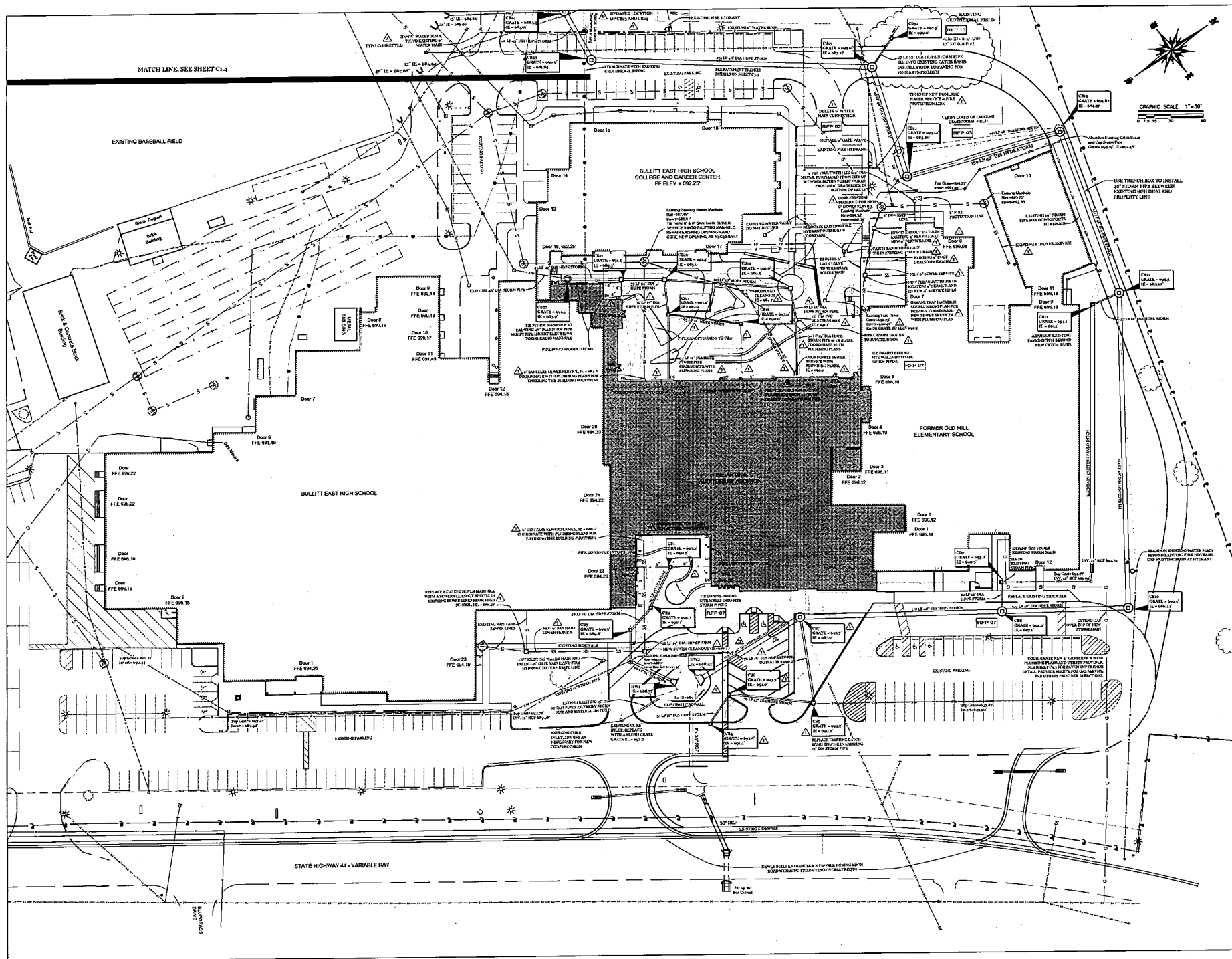

STUDIO KRAMER architects
100 E. 86th St., Glendale, NY 11002
Tel: 516-491-1900 Fax: 516-491-1100

B U I L D I N G

B U I L L I T T
C O N S T R U C T I O N I N C
7411 West 104th Ave.
Denver, CO 80231

B U I L L I T T
C O R P O R A T I O N
S C H O O L S
Moving Forward

CONSTRUCTION DOCUMENTS - BID SET

SITE UTILITY & STORM
FINE ARTS ADDITION
Bullitt East High School - Fine Arts Addition

BC# 23-050
DATE: 11/01/2023
DRAWN BY: KPM
CHECKED BY: MA
REVISIONS

2022-35

C1.3

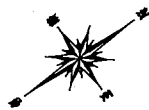

GRAPHIC SCALE 1"=30'
 0 7.5 15 30 60

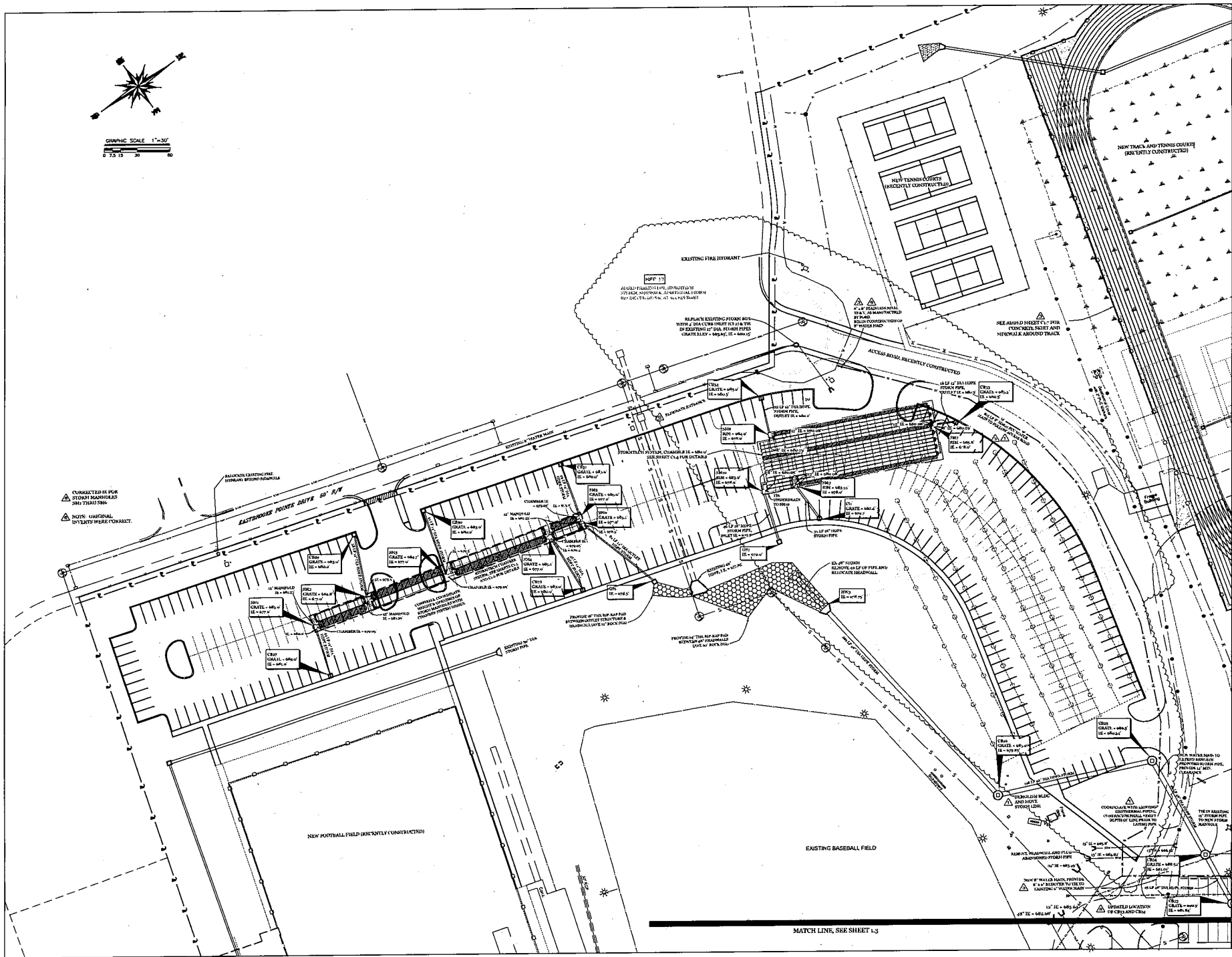

△ CORRECTED IN FOR STORM MANHOLES AND TRENCHING.
 △ NOTE: ORIGINAL DETAILS WERE CORRECT.

WILGOLD INTERIOR ARCHITECTS
 1731 S. 24th Ave., Suite 200
 Seattle, WA 98148
 TEL: 206.461.1100 FAX: 206.461.1101



BUZICK
 CONSTRUCTION, INC.
 10000 1st Ave. N.E.
 Bellevue, WA 98004
 TEL: 206.461.1100 FAX: 206.461.1101



BC
 BULLITT COUNTY
 SCHOOLS
 Moving Forward

CONSTRUCTION DOCUMENTS - BID SET

SITE UTILITY & STORM
 NEW PARKING AREA
 Bullitt East High School - Fine Arts Addition
 11/22/2022
 BY: [Signature]

854-23-050
 DATE: 11/01/2022
 DRAWN BY: KPA
 CHECKED BY: SAA
 REVISIONS

2022-35

C1.4

MATCH LINE, SEE SHEET C-1.3

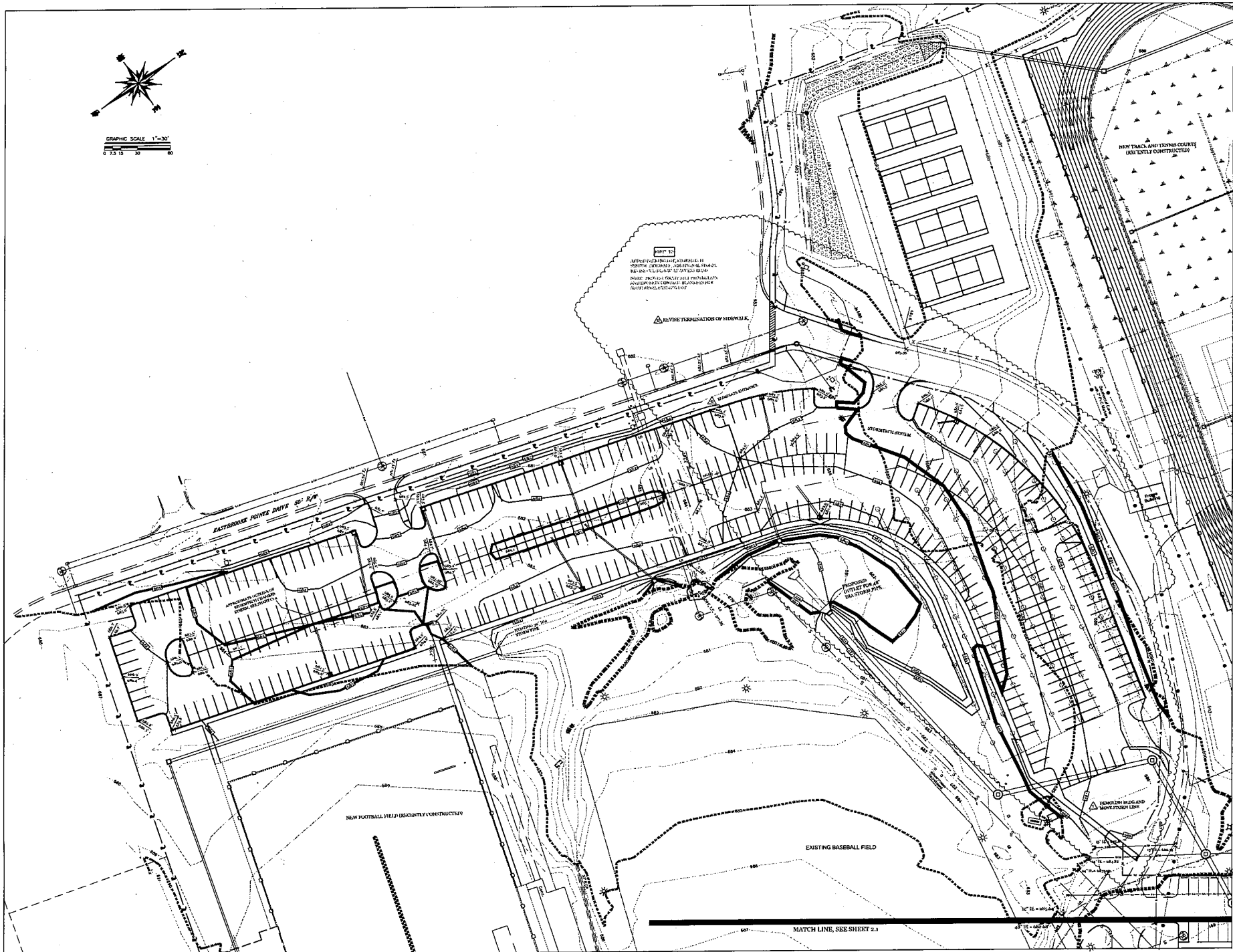

CONSTRUCTION DOCUMENTS - BID SET

GRADING & DRAINAGE
NEW PARKING AREAS
Bullitt East High School - Fine Arts Addition
11408 202
BY: 11/18/2022

EGP 23-050
DATE: 11/18/2022
DRAWN BY: APM
CHECKED BY: MAA
REVISIONS:

2022-35
C2.2



BUZICK CONSTRUCTION, INC.
BULLITT COUNTY, KY
11408 202
BY: 11/18/2022

WILCO Interiors architects
11408 202
BY: 11/18/2022



PROJECT INFORMATION	
ENGINEERED PRODUCT MANAGER:	AUSTIN BROCK 859-300-8778 AUSTIN.BROCK@ADSPIPE.COM
ADS SALES REP:	BRADLEY WESTERFIELD 502-773-1921 BRADLEY.WESTERFIELD@ADSPIPE.COM
PROJECT NO:	S411567



BULLITT EAST HIGH SCHOOL - BASEBALL & SOFTBALL

MT WASHINGTON, KY

SC-310 STORMTECH CHAMBER SPECIFICATIONS

- CHAMBERS SHALL BE STORMTECH SC-310.
- CHAMBERS SHALL BE ARCH-SHAPED AND SHALL BE MANUFACTURED FROM VIRGIN, IMPACT-MODIFIED POLYPROPYLENE OR POLYETHYLENE COPOLYMERS.
- CHAMBERS SHALL MEET THE REQUIREMENTS OF ASTM F2922 (POLETHYLENE) OR ASTM F2418 (POLYPROPYLENE), "STANDARD SPECIFICATION FOR CORRUGATED WALL STORMWATER COLLECTION CHAMBERS".
- CHAMBER ROWS SHALL PROVIDE CONTINUOUS, UNOBSTRUCTED INTERNAL SPACE WITH NO INTERNAL SUPPORTS THAT WOULD IMPEDE FLOW OR LIMIT ACCESS FOR INSPECTION.
- THE STRUCTURAL DESIGN OF THE CHAMBERS, THE STRUCTURAL BACKFILL, AND THE INSTALLATION REQUIREMENTS SHALL ENSURE THAT THE LOAD FACTORS SPECIFIED IN THE AASHTO LRFD BRIDGE DESIGN SPECIFICATIONS, SECTION 12.12, ARE MET FOR: 1) LONG-DURATION DEAD LOADS AND 2) SHORT-DURATION LIVE LOADS, BASED ON THE AASHTO DESIGN TRUCK WITH CONSIDERATION FOR IMPACT AND MULTIPLE VEHICLE PRESENCES.
- CHAMBERS SHALL BE DESIGNED, TESTED AND ALLOWABLE LOAD CONFIGURATIONS DETERMINED IN ACCORDANCE WITH ASTM F2787, "STANDARD PRACTICE FOR STRUCTURAL DESIGN OF THERMOPLASTIC CORRUGATED WALL STORMWATER COLLECTION CHAMBERS". LOAD CONFIGURATIONS SHALL INCLUDE: 1) INSTANTANEOUS (<1 MIN) AASHTO DESIGN TRUCK LIVE LOAD ON MINIMUM COVER 2) MAXIMUM PERMANENT (75-YR) COVER LOAD AND 3) ALLOWABLE COVER WITH PARKED (1-WEEK) AASHTO DESIGN TRUCK.
- REQUIREMENTS FOR HANDLING AND INSTALLATION:
 - TO MAINTAIN THE WIDTH OF CHAMBERS DURING SHIPPING AND HANDLING, CHAMBERS SHALL HAVE INTEGRAL, INTERLOCKING STACKING LUGS.
 - TO ENSURE A SECURE JOINT DURING INSTALLATION AND BACKFILL, THE HEIGHT OF THE CHAMBER JOINT SHALL NOT BE LESS THAN 2".
 - TO ENSURE THE INTEGRITY OF THE ARCH SHAPE DURING INSTALLATION, a) THE ARCH STIFFNESS CONSTANT SHALL BE GREATER THAN OR EQUAL TO 400 LBS/FT³. THE ASC IS DEFINED IN SECTION 6.2.8 OF ASTM F2418. AND b) TO RESIST CHAMBER DEFORMATION DURING INSTALLATION AT ELEVATED TEMPERATURES (ABOVE 73° F / 23° C), CHAMBERS SHALL BE PRODUCED FROM REFLECTIVE GOLD OR YELLOW COLORS.
- ONLY CHAMBERS THAT ARE APPROVED BY THE SITE DESIGN ENGINEER WILL BE ALLOWED. UPON REQUEST BY THE SITE DESIGN ENGINEER OR OWNER, THE CHAMBER MANUFACTURER SHALL SUBMIT A STRUCTURAL EVALUATION FOR APPROVAL BEFORE DELIVERING CHAMBERS TO THE PROJECT SITE AS FOLLOWS:
 - THE STRUCTURAL EVALUATION SHALL BE SEALED BY A REGISTERED PROFESSIONAL ENGINEER.
 - THE STRUCTURAL EVALUATION SHALL DEMONSTRATE THAT THE SAFETY FACTORS ARE GREATER THAN OR EQUAL TO 1.95 FOR DEAD LOAD AND 1.75 FOR LIVE LOAD, THE MINIMUM REQUIRED BY ASTM F2787 AND BY SECTIONS 3 AND 12.12 OF THE AASHTO LRFD BRIDGE DESIGN SPECIFICATIONS FOR THERMOPLASTIC PIPE.
 - THE TEST DERIVED CREEP MODULUS AS SPECIFIED IN ASTM F2922 SHALL BE USED FOR PERMANENT DEAD LOAD DESIGN EXCEPT THAT IT SHALL BE THE 75-YEAR MODULUS USED FOR DESIGN.
- CHAMBERS AND END CAPS SHALL BE PRODUCED AT AN ISO 9001 CERTIFIED MANUFACTURING FACILITY.

IMPORTANT - NOTES FOR THE BIDDING AND INSTALLATION OF THE SC-310 SYSTEM

- STORMTECH SC-310 CHAMBERS SHALL NOT BE INSTALLED UNTIL THE MANUFACTURER'S REPRESENTATIVE HAS COMPLETED A PRE-CONSTRUCTION MEETING WITH THE INSTALLERS.
- STORMTECH SC-310 CHAMBERS SHALL BE INSTALLED IN ACCORDANCE WITH THE "STORMTECH SC-310/SC-740/SC-800/DC-780 CONSTRUCTION GUIDE".
- CHAMBERS ARE NOT TO BE BACKFILLED WITH A DOZER OR AN EXCAVATOR SITUATED OVER THE CHAMBERS. STORMTECH RECOMMENDS 3 BACKFILL METHODS:
 - STONESHOOTER LOCATED OFF THE CHAMBER BED.
 - BACKFILL AS ROWS ARE BUILT USING AN EXCAVATOR ON THE FOUNDATION STONE OR SUBGRADE.
 - BACKFILL FROM OUTSIDE THE EXCAVATION USING A LONG BOOM HOE OR EXCAVATOR.
- THE FOUNDATION STONE SHALL BE LEVELED AND COMPACTED PRIOR TO PLACING CHAMBERS.
- JOINTS BETWEEN CHAMBERS SHALL BE PROPERLY SEATED PRIOR TO PLACING STONE.
- MAINTAIN MINIMUM - 6" (150 mm) SPACING BETWEEN THE CHAMBER ROWS.
- EMBEDMENT STONE SURROUNDING CHAMBERS MUST BE A CLEAN, CRUSHED, ANGULAR STONE 3/4-2" (20-50 mm).
- THE CONTRACTOR MUST REPORT ANY DISCREPANCIES WITH CHAMBER FOUNDATION MATERIALS BEARING CAPACITIES TO THE SITE DESIGN ENGINEER.
- ADS RECOMMENDS THE USE OF "FLEXSTORM CATCH IT" INSERTS DURING CONSTRUCTION FOR ALL INLETS TO PROTECT THE SUBSURFACE STORMWATER MANAGEMENT SYSTEM FROM CONSTRUCTION SITE RUNOFF.

NOTES FOR CONSTRUCTION EQUIPMENT

- STORMTECH SC-310 CHAMBERS SHALL BE INSTALLED IN ACCORDANCE WITH THE "STORMTECH SC-310/SC-740/SC-800/DC-780 CONSTRUCTION GUIDE".
- THE USE OF CONSTRUCTION EQUIPMENT OVER SC-310 & SC-740 CHAMBERS IS LIMITED:
 - NO EQUIPMENT IS ALLOWED ON BARE CHAMBERS.
 - NO RUBBER TIRED LOADERS, DUMP TRUCKS, OR EXCAVATORS ARE ALLOWED UNTIL PROPER FILL DEPTHS ARE REACHED IN ACCORDANCE WITH THE "STORMTECH SC-310/SC-740/SC-800/DC-780 CONSTRUCTION GUIDE".
 - WEIGHT LIMITS FOR CONSTRUCTION EQUIPMENT CAN BE FOUND IN THE "STORMTECH SC-310/SC-740/SC-800/DC-780 CONSTRUCTION GUIDE".
- FULL 36" (900 mm) OF STABILIZED COVER MATERIALS OVER THE CHAMBERS IS REQUIRED FOR DUMP TRUCK TRAVEL OR DUMPING.

USE OF A DOZER TO PUSH EMBEDMENT STONE BETWEEN THE ROWS OF CHAMBERS MAY CAUSE DAMAGE TO THE CHAMBERS AND IS NOT AN ACCEPTABLE BACKFILL METHOD. ANY CHAMBERS DAMAGED BY THE "DUMP AND PUSH" METHOD ARE NOT COVERED UNDER THE STORMTECH STANDARD WARRANTY.

CONTACT STORMTECH AT 1-888-892-2694 WITH ANY QUESTIONS ON INSTALLATION REQUIREMENTS OR WEIGHT LIMITS FOR CONSTRUCTION EQUIPMENT.

PROPOSED LAYOUT (SYSTEM #1)

345	STORMTECH SC-310 CHAMBERS
38	STORMTECH SC-310 END CAPS
12	STONE ABOVE (in)
6	STONE BELOW (in)
40	% STONE VOID
13,363	INSTALLED SYSTEM VOLUME (CF) (PERIMETER STONE INCLUDED)
9095	SYSTEM AREA (ft ²)
448	SYSTEM PERIMETER (ft)

PROPOSED ELEVATIONS (SYSTEM #1)

689.33	MAXIMUM ALLOWABLE GRADE (TOP OF PAVEMENT/UNPAVED)
683.33	MINIMUM ALLOWABLE GRADE (UNPAVED WITH TRAFFIC)
682.83	MINIMUM ALLOWABLE GRADE (UNPAVED NO TRAFFIC)
682.83	MINIMUM ALLOWABLE GRADE (BASE OF FLEXIBLE PAVEMENT)
682.83	MINIMUM ALLOWABLE GRADE (TOP OF RIGID PAVEMENT)
682.33	TOP OF STONE
681.33	TOP OF SC-310 CHAMBER
680.29	8" TOP MANIFOLD/CONNECTION INVERT
680.08	12" ISOLATOR ROW PLUS CONNECTION INVERT
680.080	12" BOTTOM MANIFOLD / CONNECTION INVERT
680.05	8" BOTTOM MANIFOLD/CONNECTION INVERT
680.00	BOTTOM OF SC-310 CHAMBER
679.50	UNDERDRAIN INVERT
679.50	BOTTOM OF STONE

NOTES

- MANIFOLD SIZE TO BE DETERMINED BY SITE DESIGN ENGINEER. SEE TECHNICAL NOTE 6.32 FOR MANIFOLD SIZING GUIDANCE.
- DUE TO THE ADAPTATION OF THIS CHAMBER SYSTEM TO SPECIFIC SITE AND DESIGN CONSTRAINTS, IT MAY BE NECESSARY TO CUT AND COUPLE ADDITIONAL PIPE TO STANDARD MANIFOLD COMPONENTS IN THE FIELD.
- THIS CHAMBER SYSTEM WAS DESIGNED WITHOUT SITE-SPECIFIC INFORMATION ON SOIL CONDITIONS OR BEARING CAPACITY. THE SITE DESIGN ENGINEER IS RESPONSIBLE FOR DETERMINING THE SUITABILITY OF THE SOIL AND PROVIDING THE BEARING CAPACITY OF THE INSITU SOILS. THE BASE STONE DEPTH MAY BE INCREASED OR DECREASED ONCE THIS INFORMATION IS PROVIDED.
- ATTENTION:** THIS DRAWING IS NOT INTENDED FOR USE IN BIDDING OR CONSTRUCTION WITHOUT THE PRIOR APPROVAL OF THE PROJECT'S ENGINEER OF RECORD (EOR). AS WITH ALL PROPOSED ADS LAYOUTS, THE EOR SHOULD REVIEW AND APPROVE THIS DRAWING PRIOR TO USE IN BIDDING AND/OR CONSTRUCTION. IT IS THE ULTIMATE RESPONSIBILITY OF THE EOR TO ENSURE THAT THE PRODUCT(S) DEPICTED AND THE ASSOCIATED DETAILS MEET ALL APPLICABLE LAWS, REGULATIONS, AND PROJECT REQUIREMENTS.

BULLITT EAST HIGH SCHOOL -
BASEBALL & SOFTBALL
MT WASHINGTON, KY

DATE: 05-05-24 DRAWN: SLS
PROJECT #: S411587 CHECKED: SLS

REV	DATE	DESCRIPTION
1		PER ENGINEER'S NOTES
2		DATE
3		DESCRIPTION

StormTech®
Chamber System

886-892-2694 | WWW.STORMTECH.COM

4640 TRUAMAN BLVD
HILLIARD, OH 43026

50'
25'
0'

THIS DRAWING HAS BEEN PREPARED BASED ON INFORMATION PROVIDED TO ADS UNDER THE DIRECTION OF THE SITE DESIGN ENGINEER OR OTHER PROJECT REPRESENTATIVE. THE SITE DESIGN ENGINEER SHALL REVIEW THIS DRAWING PRIOR TO CONSTRUCTION. IT IS THE ULTIMATE RESPONSIBILITY OF THE SITE DESIGN ENGINEER TO ENSURE THAT THE PRODUCTS DEPICTED AND ALL ASSOCIATED DETAILS MEET ALL APPLICABLE LAWS, REGULATIONS, AND PROJECT REQUIREMENTS.

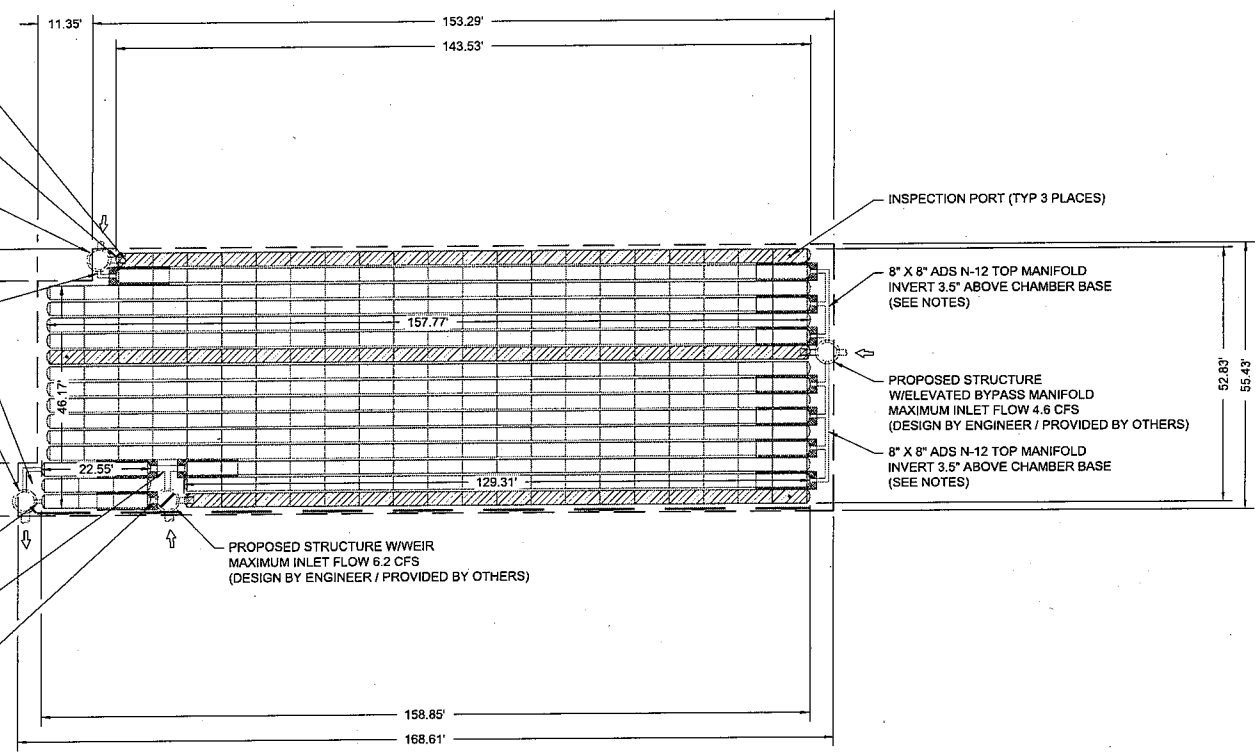

- ISOLATOR ROW PLUS (SEE DETAIL)
- PLACE MINIMUM 12.5' OF ADSPLUS625 WOVEN GEOTEXTILE OVER BEDDING STONE AND UNDERNEATH CHAMBER FEET FOR SCOUR PROTECTION AT ALL CHAMBER INLET ROWS
- BED LIMITS

ACCEPTABLE FILL MATERIALS: STORMTECH SC-310 CHAMBER SYSTEMS

MATERIAL LOCATION	DESCRIPTION	AASHTO MATERIAL CLASSIFICATIONS	COMPACTION / DENSITY REQUIREMENT
D	FINAL FILL: FILL MATERIAL FOR LAYER 'D' STARTS FROM THE TOP OF THE 'C' LAYER TO THE BOTTOM OF FLEXIBLE PAVEMENT OR UNPAVED FINISHED GRADE ABOVE. NOTE THAT PAVEMENT SUBBASE MAY BE PART OF THE 'D' LAYER.	N/A	PREPARE PER SITE DESIGN ENGINEER'S PLANS. PAVED INSTALLATIONS MAY HAVE STRINGENT MATERIAL AND PREPARATION REQUIREMENTS.
C	INITIAL FILL: FILL MATERIAL FOR LAYER 'C' STARTS FROM THE TOP OF THE EMBEDMENT STONE ('B' LAYER) TO 18" (450 mm) ABOVE THE TOP OF THE CHAMBER. NOTE THAT PAVEMENT SUBBASE MAY BE A PART OF THE 'C' LAYER.	AASHTO M145 ¹ A-1, A-2-4, A-3 OR AASHTO M43 ¹ 3, 357, 4, 467, 5, 56, 57, 6, 67, 68, 7, 78, 8, 89, 9, 10	BEGIN COMPACTIONS AFTER 12" (300 mm) OF MATERIAL OVER THE CHAMBERS IS REACHED. COMPACT ADDITIONAL LAYERS IN 6" (150 mm) MAX LIFTS TO A MIN. 95% PROCTOR DENSITY FOR WELL GRADED MATERIAL AND 95% RELATIVE DENSITY FOR PROCESSED AGGREGATE MATERIALS. ROLLER GROSS VEHICLE WEIGHT NOT TO EXCEED 12,000 lbs (53 kN). DYNAMIC FORCE NOT TO EXCEED 20,000 lbs (89 kN).
B	EMBEDMENT STONE: FILL SURROUNDING THE CHAMBERS FROM THE FOUNDATION STONE ('A' LAYER) TO THE 'C' LAYER ABOVE.	AASHTO M43 ¹ 3, 357, 4, 467, 5, 56, 57	NO COMPACTION REQUIRED.
A	FOUNDATION STONE: FILL BELOW CHAMBERS FROM THE SUBGRADE UP TO THE FOOT (BOTTOM) OF THE CHAMBER.	AASHTO M43 ¹ 3, 357, 4, 467, 5, 56, 57	PLATE COMPACT OR ROLL TO ACHIEVE A FLAT SURFACE. ^{2,3}

PLEASE NOTE:

- THE LISTED AASHTO DESIGNATIONS ARE FOR GRADATIONS ONLY. THE STONE MUST ALSO BE CLEAN, CRUSHED, ANGULAR. FOR EXAMPLE, A SPECIFICATION FOR #4 STONE WOULD STATE: "CLEAN, CRUSHED, ANGULAR NO. 4 (AASHTO M43) STONE".
- STORMTECH COMPACTION REQUIREMENTS ARE MET FOR 'A' LOCATION MATERIALS WHEN PLACED AND COMPACTED IN 6" (150 mm) (MAX) LIFTS USING TWO FULL COVERAGES WITH A VIBRATORY COMPACTOR.
- WHERE INFILTRATION SURFACES MAY BE COMPROMISED BY COMPACTION, FOR STANDARD DESIGN LOAD CONDITIONS, A FLAT SURFACE MAY BE ACHIEVED BY RAKING OR DRAGGING WITHOUT COMPACTION EQUIPMENT. FOR SPECIAL LOAD DESIGNS, CONTACT STORMTECH FOR COMPACTION REQUIREMENTS.
- ONCE LAYER 'C' IS PLACED, ANY SOIL/MATERIAL CAN BE PLACED IN LAYER 'D' UP TO THE FINISHED GRADE. MOST PAVEMENT SUBBASE SOILS CAN BE USED TO REPLACE THE MATERIAL REQUIREMENTS OF LAYER 'C' OR 'D' AT THE SITE DESIGN ENGINEER'S DISCRETION.
- WHERE RECYCLED CONCRETE AGGREGATE IS USED IN LAYERS 'A' OR 'B' THE MATERIAL SHOULD ALSO MEET THE ACCEPTABILITY CRITERIA OUTLINED IN TECHNICAL NOTE 6.20 "RECYCLED CONCRETE STRUCTURAL BACKFILL".

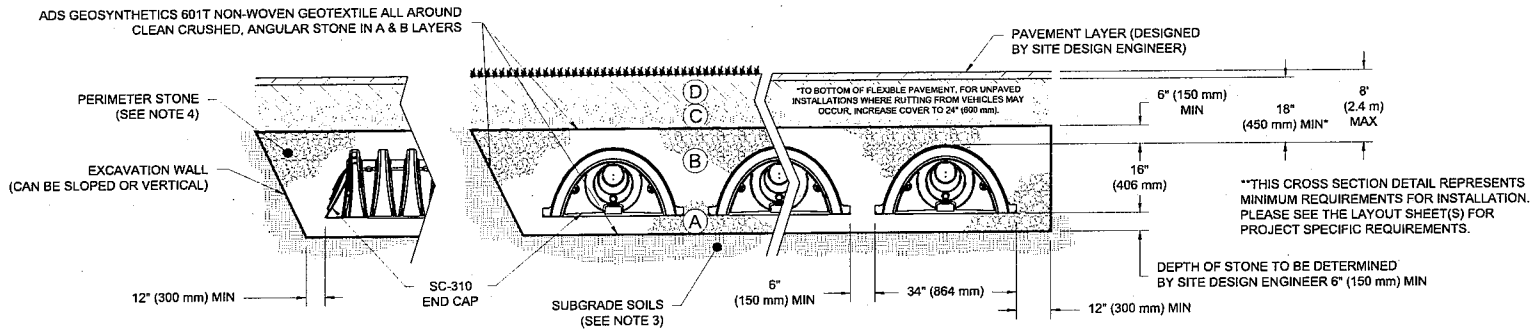

NOTES:

- CHAMBERS SHALL MEET THE REQUIREMENTS OF ASTM F2922 (POLETHYLENE) OR ASTM F2418 (POLYPROPYLENE), "STANDARD SPECIFICATION FOR CORRUGATED WALL STORMWATER COLLECTION CHAMBERS".
- SC-310 CHAMBERS SHALL BE DESIGNED IN ACCORDANCE WITH ASTM F2787 "STANDARD PRACTICE FOR STRUCTURAL DESIGN OF THERMOPLASTIC CORRUGATED WALL STORMWATER COLLECTION CHAMBERS".
- THE SITE DESIGN ENGINEER IS RESPONSIBLE FOR ASSESSING THE BEARING RESISTANCE (ALLOWABLE BEARING CAPACITY) OF THE SUBGRADE SOILS AND THE DEPTH OF FOUNDATION STONE WITH CONSIDERATION FOR THE RANGE OF EXPECTED SOIL MOISTURE CONDITIONS.
- PERIMETER STONE MUST BE EXTENDED HORIZONTALLY TO THE EXCAVATION WALL FOR BOTH VERTICAL AND SLOPED EXCAVATION WALLS.
- REQUIREMENTS FOR HANDLING AND INSTALLATION:
 - TO MAINTAIN THE WIDTH OF CHAMBERS DURING SHIPPING AND HANDLING, CHAMBERS SHALL HAVE INTEGRAL, INTERLOCKING STACKING LUGS.
 - TO ENSURE A SECURE JOINT DURING INSTALLATION AND BACKFILL, THE HEIGHT OF THE CHAMBER JOINT SHALL NOT BE LESS THAN 2".
 - TO ENSURE THE INTEGRITY OF THE ARCH SHAPE DURING INSTALLATION, a) THE ARCH STIFFNESS CONSTANT AS DEFINED IN SECTION 6.2.8 OF ASTM F2922 SHALL BE GREATER THAN OR EQUAL TO 400 LBS/FT²%, AND b) TO RESIST CHAMBER DEFORMATION DURING INSTALLATION AT ELEVATED TEMPERATURES (ABOVE 73° F / 23° C), CHAMBERS SHALL BE PRODUCED FROM REFLECTIVE GOLD OR YELLOW COLORS.

BULLITT EAST HIGH SCHOOL -
BASEBALL & SOFTBALL
MT WASHINGTON, KY

DATE: 05-08-24

PROJECT #: S411567

DRAWN: SLS

CHECKED: SLS

5/1/24

DATE

PER ENGINEER'S NOTES

DESCRIPTION

StormTech®
Chamber System

888-992-2694 | WWW.STORMTECH.COM

4640 TRULEMAN BLVD
HILLIARD, OH 43026

THIS DRAWING HAS BEEN PREPARED BASED ON INFORMATION PROVIDED TO ADS UNDER THE DIRECTION OF THE SITE DESIGN ENGINEER OR OTHER PROJECT REPRESENTATIVE. THE SITE DESIGN ENGINEER SHALL REVIEW THIS DRAWING PRIOR TO CONSTRUCTION. IT IS THE ULTIMATE RESPONSIBILITY OF THE SITE DESIGN ENGINEER TO ENSURE THAT THE PRODUCTS, DEPICTED AND ALL ASSOCIATED DETAILS MEET ALL APPLICABLE LAWS, REGULATIONS, AND PROJECT REQUIREMENTS.

ADS

5 SHEET
OF 10

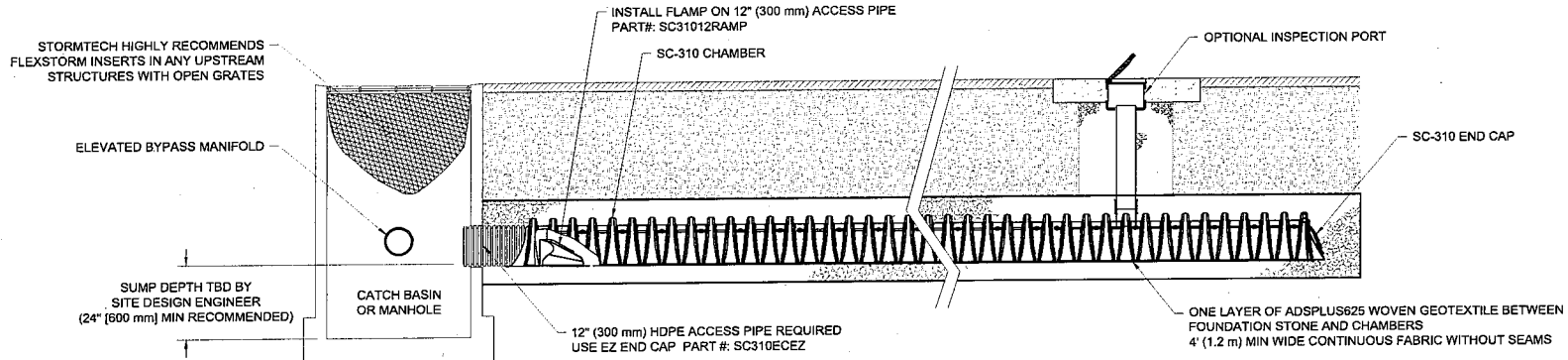

SC-310 ISOLATOR ROW PLUS DETAIL
NTS

INSPECTION & MAINTENANCE

- STEP 1) INSPECT ISOLATOR ROW PLUS FOR SEDIMENT
- A. INSPECTION PORTS (IF PRESENT)
 - A.1. REMOVE/OPEN LID ON NYLOPLAST INLINE DRAIN
 - A.2. REMOVE AND CLEAN FLEXSTORM FILTER IF INSTALLED
 - A.3. USING A FLASHLIGHT AND STADIA ROD, MEASURE DEPTH OF SEDIMENT AND RECORD ON MAINTENANCE LOG
 - A.4. LOWER A CAMERA INTO ISOLATOR ROW PLUS FOR VISUAL INSPECTION OF SEDIMENT LEVELS (OPTIONAL)
 - A.5. IF SEDIMENT IS AT, OR ABOVE, 3" (80 mm) PROCEED TO STEP 2. IF NOT, PROCEED TO STEP 3.
 - B. ALL ISOLATOR PLUS ROWS
 - B.1. REMOVE COVER FROM STRUCTURE AT UPSTREAM END OF ISOLATOR ROW PLUS
 - B.2. USING A FLASHLIGHT, INSPECT DOWN THE ISOLATOR ROW PLUS THROUGH OUTLET PIPE
 - i) MIRRORS ON POLES OR CAMERAS MAY BE USED TO AVOID A CONFINED SPACE ENTRY
 - ii) FOLLOW OSHA REGULATIONS FOR CONFINED SPACE ENTRY IF ENTERING MANHOLE
 - B.3. IF SEDIMENT IS AT, OR ABOVE, 3" (80 mm) PROCEED TO STEP 2. IF NOT, PROCEED TO STEP 3.
- STEP 2) CLEAN OUT ISOLATOR ROW PLUS USING THE JETVAC PROCESS
- A. A FIXED CULVERT CLEANING NOZZLE WITH REAR FACING SPREAD OF 45° (1.1 m) OR MORE IS PREFERRED
 - B. APPLY MULTIPLE PASSES OF JETVAC UNTIL BACKFLUSH WATER IS CLEAN
 - C. VACUUM STRUCTURE SUMP AS REQUIRED
- STEP 3) REPLACE ALL COVERS, GRATES, FILTERS, AND LIDS; RECORD OBSERVATIONS AND ACTIONS.
- STEP 4) INSPECT AND CLEAN BASINS AND MANHOLES UPSTREAM OF THE STORMTECH SYSTEM.

NOTES

1. INSPECT EVERY 6 MONTHS DURING THE FIRST YEAR OF OPERATION. ADJUST THE INSPECTION INTERVAL BASED ON PREVIOUS OBSERVATIONS OF SEDIMENT ACCUMULATION AND HIGH WATER ELEVATIONS.
2. CONDUCT JETTING AND VACTORING ANNUALLY OR WHEN INSPECTION SHOWS THAT MAINTENANCE IS NECESSARY.

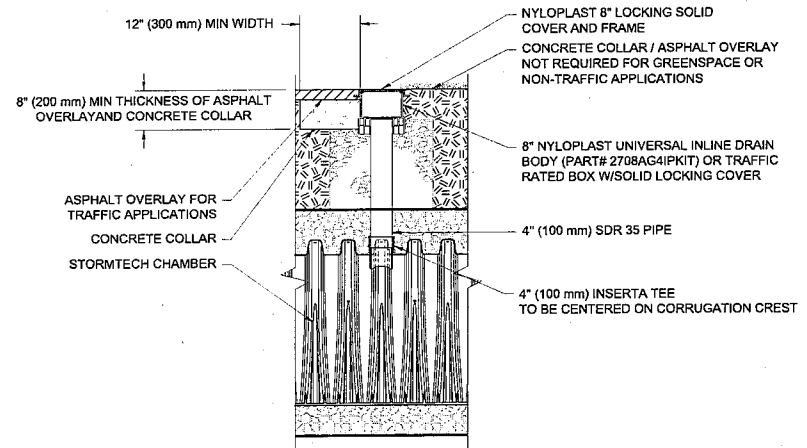

NOTE:
INSPECTION PORTS MAY BE CONNECTED THROUGH ANY CHAMBER CORRUGATION CREST.

4\"/>

BULLITT EAST HIGH SCHOOL - BASEBALL & SOFTBALL MT WASHINGTON, KY	
DATE: 05-06-24 DRAWN: SLS	PROJECT #: S411507 CHECKED: SLS
PER ENGINEERS NOTES DESCRIPTION DATE: 05/06/24 DRAWN: SLS	
THE DRAWING HAS BEEN PREPARED BASED ON INFORMATION PROVIDED TO ADS UNDER THE DIRECTION OF THE SITE DESIGN ENGINEER OR OTHER PROJECT REPRESENTATIVE. THE SITE DESIGN ENGINEER SHALL REVIEW THIS DRAWING PRIOR TO CONSTRUCTION. IT IS THE ULTIMATE RESPONSIBILITY OF THE SITE DESIGN ENGINEER TO ENSURE THAT THE PRODUCTS (DEPICTED AND ALL ASSOCIATED DETAILS) MEET ALL APPLICABLE LAWS, REGULATIONS, AND PROJECT REQUIREMENTS.	
StormTech® Chamber System 4640 TRUEMAN BLVD HILLIARD, OH 43026 888-852-2694 WWW.STORMTECH.COM	

SC-310 TECHNICAL SPECIFICATION

NTS

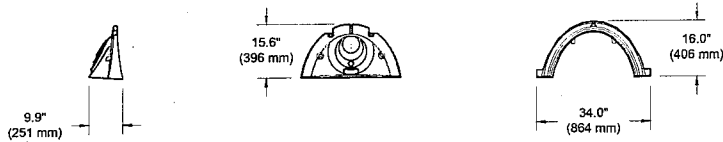
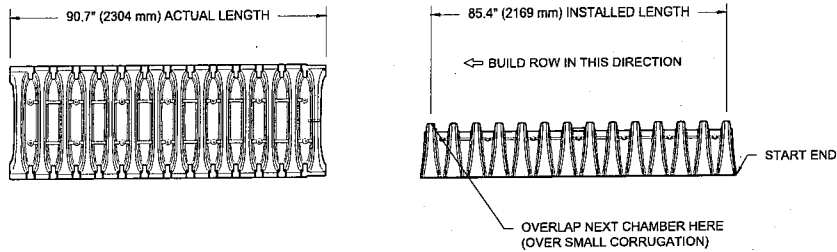

NOMINAL CHAMBER SPECIFICATIONS
 SIZE (W X H X INSTALLED LENGTH)
 CHAMBER STORAGE
 MINIMUM INSTALLED STORAGE*
 WEIGHT

34.0" X 16.0" X 85.4"
 14.7 CUBIC FEET
 31.0 CUBIC FEET
 35.0 lbs.

(864 mm X 406 mm X 2169 mm)
 (0.42 m³)
 (0.88 m³)
 (16.8 kg)

*ASSUMES 6" (152 mm) ABOVE, BELOW, AND BETWEEN CHAMBERS

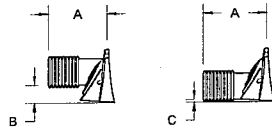

PRE-FAB STUBS AT BOTTOM OF END CAP FOR PART NUMBERS ENDING WITH "B"
 PRE-FAB STUBS AT TOP OF END CAP FOR PART NUMBERS ENDING WITH "T"
 PRE-CORED END CAPS END WITH "PC"

PART #	STUB	A	B	C
SC310EPE06T / SC310EPE06TPC	6" (150 mm)	9.6" (244 mm)	5.8" (147 mm)	—
SC310EPE06B / SC310EPE06BPC	—	—	—	0.5" (13 mm)
SC310EPE08T / SC310EPE08TPC	8" (200 mm)	11.9" (302 mm)	3.5" (89 mm)	—
SC310EPE08B / SC310EPE08BPC	—	—	—	0.6" (15 mm)
SC310EPE10T / SC310EPE10TPC	10" (250 mm)	12.7" (323 mm)	1.4" (36 mm)	—
SC310EPE10B / SC310EPE10BPC	—	—	—	0.7" (18 mm)
SC310ECEZ*	12" (300 mm)	13.5" (343 mm)	—	0.9" (23 mm)

ALL STUBS, EXCEPT FOR THE SC310ECEZ ARE PLACED AT BOTTOM OF END CAP SUCH THAT THE OUTSIDE DIAMETER OF THE STUB IS FLUSH WITH THE BOTTOM OF THE END CAP. FOR ADDITIONAL INFORMATION CONTACT STORMTECH AT 1-888-892-2694.

* FOR THE SC310ECEZ THE 12" (300 mm) STUB LIES BELOW THE BOTTOM OF THE END CAP APPROXIMATELY 0.25" (6 mm). BACKFILL MATERIAL SHOULD BE REMOVED FROM BELOW THE N-12 STUB SO THAT THE FITTING SITS LEVEL.

NOTE: ALL DIMENSIONS ARE NOMINAL

SC-800 TECHNICAL SPECIFICATION

NTS

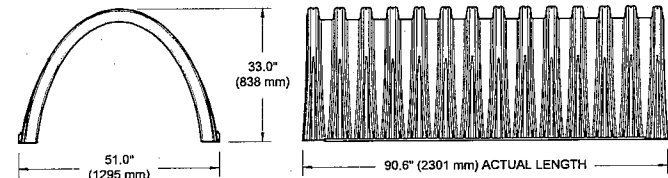
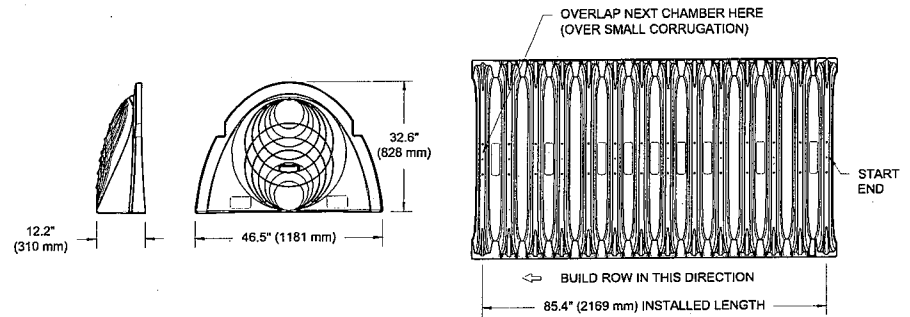

NOMINAL CHAMBER SPECIFICATIONS

SIZE (W X H X INSTALLED LENGTH) 51.0" X 33.0" X 85.4" (1295 mm X 838 mm X 2169 mm)
 CHAMBER STORAGE 50.6 CUBIC FEET (1.43 m³)
 MINIMUM INSTALLED STORAGE* 81.0 CUBIC FEET (2.29 m³)
 WEIGHT 81.8 lbs. (37.1 kg)

*ASSUMES 6" (152 mm) STONE ABOVE, BELOW, AND BETWEEN CHAMBERS

PRE-CORED HOLES AT BOTTOM OF END CAP FOR PART NUMBERS ENDING WITH "B"
 PRE-CORED HOLES AT TOP OF END CAP FOR PART NUMBERS ENDING WITH "T"

PART #	STUB	B	C
SC800EPE06TPC	6" (150 mm)	21.4" (544 mm)	—
SC800EPE06BPC	—	—	0.9" (23 mm)
SC800EPE08TPC	8" (200 mm)	19.2" (488 mm)	—
SC800EPE08BPC	—	—	1.0" (25 mm)
SC800EPE10TPC	10" (250 mm)	17.0" (432 mm)	—
SC800EPE10BPC	—	—	1.2" (30 mm)
SC800EPE12TPC	12" (300 mm)	14.4" (366 mm)	—
SC800EPE12BPC	—	—	1.6" (41 mm)
SC800EPE15TPC	15" (375 mm)	11.3" (287 mm)	—
SC800EPE15BPC	—	—	1.7" (43 mm)
SC800EPE18TPC	18" (450 mm)	8.0" (203 mm)	—
SC800EPE18BPC	—	—	2.0" (51 mm)
SC800EPE24BPC	24" (600 mm)	—	2.3" (58 mm)
SC800EPE	NONE	SOLID END CAP	

NOTE: ALL DIMENSIONS ARE NOMINAL

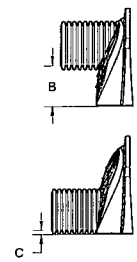

BULLITT EAST HIGH SCHOOL - BASEBALL & SOFTBALL MT WASHINGTON, KY

DATE: 05-08-24 DRAWN: SLS PROJECT #: S411567 CHECKED: SLS

DESIGNER: PER ENGINEER'S NOTES DESCRIPTION DATE: (DRAWN/CHKD)

4640 TRUEMAN BLVD HILLIARD, OH 43026

StormTech
Chamber System
888-892-2694 | WWW.STORMTECH.COM

THE DRAWING HAS BEEN PREPARED BASED ON INFORMATION PROVIDED TO USE UNDER THE DIRECTION OF THE SITE DESIGN ENGINEER. THE SITE DESIGN ENGINEER SHALL BE RESPONSIBLE FOR VERIFYING THE ACCURACY OF THE INFORMATION PROVIDED AND FOR OBTAINING ALL NECESSARY PERMITS AND REGULATIONS. THE USER SHALL BE RESPONSIBLE FOR OBTAINING ALL NECESSARY PERMITS AND REGULATIONS. THE USER SHALL BE RESPONSIBLE FOR OBTAINING ALL NECESSARY PERMITS AND REGULATIONS. THE USER SHALL BE RESPONSIBLE FOR OBTAINING ALL NECESSARY PERMITS AND REGULATIONS.

UNDERDRAIN DETAIL

NTS

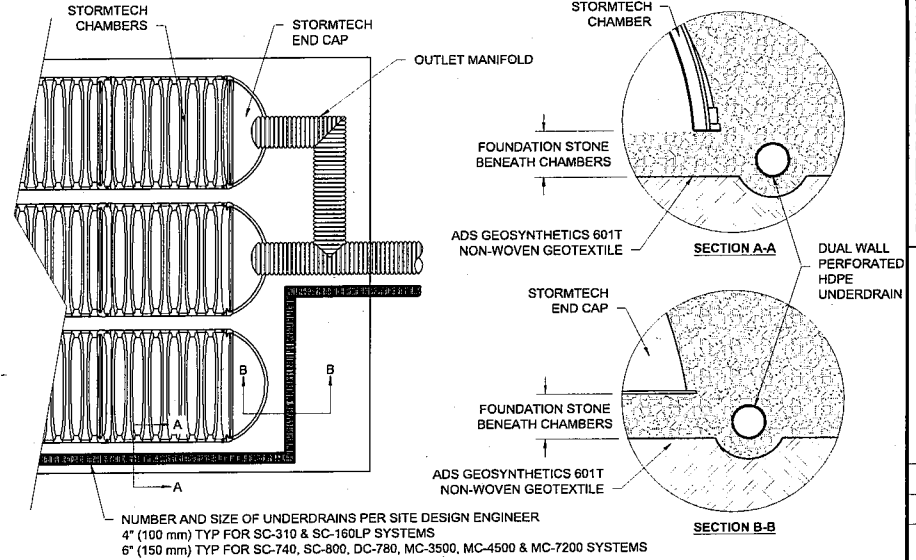

<p>ADS</p> <p>4640 TRUJMAN BLVD HILLIARD, OH 43026</p>		<p>StormTech® Chamber System</p> <p>888-892-2694 WWW.STORMTECH.COM</p>		<p>BULLITT EAST HIGH SCHOOL - BASEBALL & SOFTBALL MT WASHINGTON, KY</p>	
		<p>DATE: 05-08-24</p> <p>DATE: 05-08-24</p>	<p>PER ENGINEER'S NOTES</p> <p>DATE: 05-08-24</p>	<p>DRAWN: SLS</p> <p>CHECKED: SLS</p>	<p>PROJECT #: S411567</p> <p>CHECKED: SLS</p>

THE DRAWING HAS BEEN PREPARED BASED ON INFORMATION PROVIDED TO ADS UNDER THE DIRECTION OF THE SITE DESIGN ENGINEER. NO OTHER ENGINEER OR OTHER PROJECT REPRESENTATIVE. THE SITE DESIGN ENGINEER SHALL REVIEW THIS DRAWING PRIOR TO CONSTRUCTION. IT IS THE ULTIMATE RESPONSIBILITY OF THE SITE DESIGN ENGINEER TO ENSURE THAT THE PRODUCT(S) DEPICTED AND ALL ASSOCIATED DETAILS MEET ALL APPLICABLE LAWS, REGULATIONS, AND PROJECT REQUIREMENTS.

SYSTEM #1

