

# Document G731<sup>®</sup> – 2019

## Change Order, Construction Manager as Adviser Edition

<b>PROJECT:</b> <i>(name and address)</i> Central Hardin High School Addn/Renov Cecilia, KY	<b>CONTRACT INFORMATION:</b> Contract For: BP 260-17 Electrical Date: July 14, 2021	<b>CHANGE ORDER INFORMATION:</b> Change Order Number: 113 Date: June 12, 2024
<b>OWNER:</b> <i>(name and address)</i> Hardin County Board of Education 65 W A Jenkins Road Elizabethtown, KY 42701	<b>ARCHITECT:</b> <i>(name and address)</i> JRA Architects 3225 Summit Square Place, Suite 200 Lexington, KY 40509	<b>CONSTRUCTION MANAGER:</b> <i>(name and address)</i> Alliance Corporation 116 E. College Street Glasgow, KY 42141
<b>CONTRACTOR:</b> <i>(name and address)</i> Advanced Electrical Systems, inc. P. O. Box 36503 Louisville, KY 40233-6503		

### THE CONTRACT IS CHANGED AS FOLLOWS:

*(Insert a detailed description of the change and, if applicable, attach or reference specific exhibits. Also include agreed upon adjustments attributable to executed Construction Change Directives.)*

Cost associated with changing roller shades from manual to power per COP#60.

The original Contract Sum was	\$ 4,432,383.30
Net change by previously authorized Change Orders	\$ -294,243.14
The Contract Sum prior to this Change Order was	\$ 4,138,140.16
The Contract Sum will be increased by this Change Order in the amount of	\$ 1,514.95
The new Contract Sum including this Change Order will be	\$ 4,139,655.11

The Contract Time will be unchanged by Zero (0) days.

The Contractor's Work shall be substantially complete on

**NOTE:** This Change Order does not include adjustments to the Contract Sum or Guaranteed Maximum Price, or the Contract Time, that have been authorized by Construction Change Directive until the cost and time have been agreed upon by both the Owner and Contractor, in which case a Change Order is executed to supersede the Construction Change Directive.

**NOT VALID UNTIL SIGNED BY THE ARCHITECT, CONSTRUCTION MANAGER, CONTRACTOR, AND OWNER.**

*\*\*\*Subcontractor does not waive and expressly reserves its right to assert claims for delay, disruption, compression, acceleration and inefficiency as well as seek payment for any and all pending change order requests that have been submitted to date.\*\*\**

JRA Architects <b>ARCHITECT</b> <i>(Firm name)</i>	Alliance Corporation <b>CONSTRUCTION MANAGER</b> <i>(Firm name)</i>
<b>SIGNATURE</b> D. Robert Deal, President <b>PRINTED NAME AND TITLE</b>	<b>SIGNATURE</b> Ryan Martin, Senior Project Manager <b>PRINTED NAME AND TITLE</b>
<b>DATE:</b>	<b>DATE:</b>
Advanced Electrical Systems, inc. <b>CONTRACTOR</b> <i>(Firm name)</i> Evelyn Strange	Hardin County Board of Education <b>OWNER</b> <i>(Firm name)</i>
<b>SIGNATURE</b> Evelyn Strange <b>PRINTED NAME AND TITLE</b> June 12, 2024 <b>DATE:</b>	<b>SIGNATURE</b> John Stith, COO <b>PRINTED NAME AND TITLE</b> <b>DATE:</b>



# AIA<sup>®</sup> Document G709<sup>™</sup> – 2018

## Proposal Request

**PROJECT:** *(name and address)*  
Hardin County Schools Central Hardin  
High School  
Elizabethtown, KY

**CONTRACT INFORMATION:**  
Contract For: General Construction

Date: September 01, 2021

Architect's Project Number: 2019111  
Proposal Request Number: 060

Proposal Request Date: 2/7/2024

**OWNER:** *(name and address)*  
Hardin County Board of Education  
65 W A Jenkins Rd  
Elizabethtown, KY 42701

**ARCHITECT:** *(name and address)*  
JRA Architects  
3225 Summit Square Place Ste. 200  
Lexington, KY 40509

**CONTRACTOR:** *(name and address)*  
Alliance Corporation  
116 East College Street  
Glasgow, KY 42141

The Owner requests an itemized proposal for changes to the Contract Sum and Contract Time for proposed modifications to the Contract Documents described herein. The Contractor shall submit this proposal within Zero (0) days or notify the Architect in writing of the anticipated date of submission.

*(Insert a detailed description of the proposed modifications to the Contract Documents and, if applicable, attach or reference specific exhibits.)*

Change manual roller shades at window type W1 in E100A Cafe/Commons to motorized. Provide electrical as required.

**THIS IS NOT A CHANGE ORDER, A CONSTRUCTION CHANGE DIRECTIVE, OR A DIRECTION TO PROCEED WITH THE WORK DESCRIBED IN THE PROPOSED MODIFICATIONS.**

**REQUESTED BY THE ARCHITECT:**

D. Robert Deal, AIA, President  
**PRINTED NAME AND TITLE**

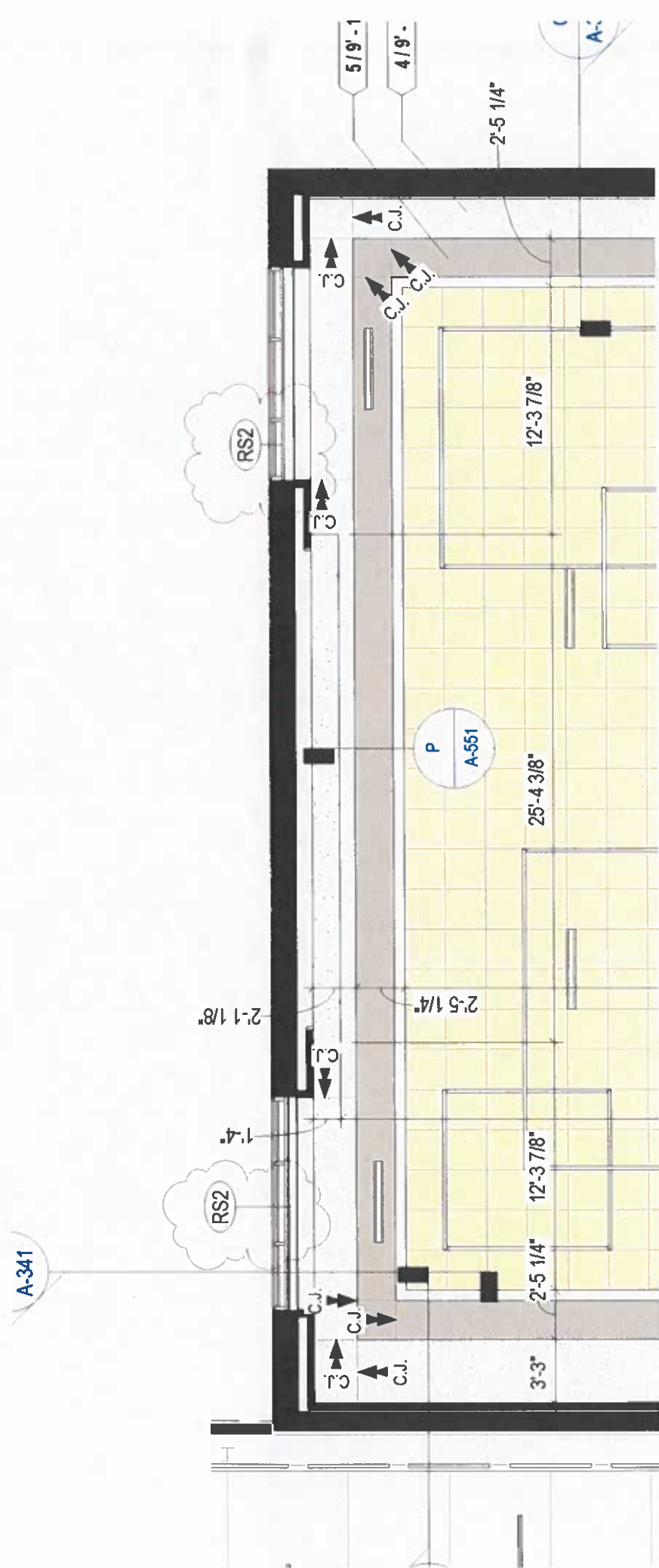



**ADVANCED ELECTRICAL SYSTEMS, INC.**  
**(502) 962-1102 Fax (502) 962-8836 www.aeslou.com**

## POWERING THE FUTURE!

PO Box 36503 Louisville, KY 40233-6503  
 3312 Gilmore Industrial Blvd. Louisville, KY 40213

### Change Order Summary

Time & Material Summary:  
 Lump Sum: X

#### Description of work:

##### CHHS COP 60 Roller Shades

Activity Description	Material	Labor
Misc Material	\$ 178.87	\$ 801.50
	\$ -	\$ -
	\$ -	\$ -
Material delivery - \$125/Fuel \$75	\$ 125.00	\$ -
<b>Subtotal Material &amp; Labor</b>	<b>\$ 303.87</b>	<b>\$ 801.50</b>

DEDUCT	Material	Labor
		\$0.00
<b>Subtotal Deduct</b>	<b>\$0.00</b>	<b>\$0.00</b>

##### Labor Rate Calculations

CLASSIFICATION	HOURS	RATE	LABOR COST
AGF ST	1	\$ 90.50	\$90.50
Gen. F-man ST	0	\$ 87.90	\$0.00
Foreman ST	0	\$ 85.00	\$0.00
Journeyman ST	9	\$ 79.00	\$711.00
Apprentice ST	0	\$ 59.75	\$0.00
AGF TH	0	\$ 121.95	\$0.00
Gen. F-man TH	0	\$ 114.50	\$0.00
Foreman TH	0	\$ 113.75	\$0.00
Journeyman TH	0	\$ 105.90	\$0.00
Apprentice TH	0	\$ 77.90	\$0.00
AGF DT	0	\$ 152.50	\$0.00
Gen. F-man DT	0	\$ 147.75	\$0.00
Foreman DT	0	\$ 143.00	\$0.00
Journeyman DT	0	\$ 132.25	\$0.00
Apprentice DT	0	\$ 96.75	\$0.00
Safety	0	\$ 99.75	\$0.00
Other	0		\$0.00
<b>Subtotal Labor</b>	<b>10</b>		<b>\$801.50</b>

Subcontractors	
	\$ -
	\$ -
<b>Subtotal Subcontractors</b>	<b>\$ -</b>

Equipment Rental (including tax)	
Lift	\$ 250.00
<b>Subtotal Equipment Rental</b>	<b>\$ 250.00</b>

**CUSTOMER ACCEPTANCE & AUTHORIZATION TO PROCEED WITH  
 CHANGE ORDER :**

SIGNATURE TITLE DATE

PRINTED NAME CONTRACT / PO NUMBER

AES Change Order No. **33**  
 Contractor: **Advanced Electrical Systems, Inc.**  
 Date: **February 9, 2024**  
 Revision:  
 AES Job No. **210410**  
 Cust. Contract No. **BG #20-136/Job #20-036**  
 Cust. RFP No.:  
 Additional Days: **0**  
 SWO #:  
 Clarification: **Price Valid for 30 Days**

### BID SUMMARY

Material Cost	\$	303.87
Material Mark-up 15.0%	\$	45.58
Subtotal	\$	349.45
Tax 6%	\$	18.23
<b>Total Material Costs</b>	<b>\$</b>	<b>367.68</b>

Sub Contractor Costs	\$	-
Sub Contractor Mark-up 7.5%	\$	-
<b>Total Sub Contractor Cost</b>	<b>\$</b>	<b>-</b>

Equipment Rental	\$	250.00
Equipment Rental Mark-up 15%	\$	37.50
<b>Total Equipment Cost</b>	<b>\$</b>	<b>287.50</b>

Labor Cost	\$	801.50
Markup on Labor	\$	-
<b>Total Labor Cost</b>	<b>\$</b>	<b>801.50</b>

Subtotal Add Cost	\$	1,456.68
Bond 2%, E-Town Permit 2 % 4.0%	\$	58.27
<b>Total CO Add Cost</b>	<b>\$</b>	<b>1,514.95</b>

Material Deduct	-
Tax on Deduct Material 6.0%	-
Labor Deduct	-
Subcontractor Deduct	-
Equipment Rental Deduct	-
Deduct Subtotal	-
Bond Included 2.0%	-
<b>Total CO Deduct Cost</b>	<b>-</b>

**Change Order Total: \$ 1,514.95**

Subcontractor does not waive and expressly reserves its right to assert claims for delay, disruption, compression, acceleration and inefficiency as well as seek payment for any and all pending change order requests that have been submitted to date.

	A	B	C	D	E	F	G	H
1	Item Name	Quantity	Price	U	Ext Price	...Labor...	U	Ext Labor...
2	Label Set: Combined, Combined, Combined, Combined, Combined				<b>\$178.87</b>			<b>9.50</b>
3	CCode: Quoted Items				<u>\$0.00</u>			<u>1.00</u>
4	Supervision	1.00	\$0.00	E	\$0.00	1.00	E	1.00
5	CCode: Branch Conduit				<u>\$14.12</u>			<u>1.13</u>
6	1/2" EMT Conduit	15.00	\$91.96	C	\$13.79	7.08	C	1.06
7	1/2" EMT/SS Coupling	1.50	\$21.48	C	\$0.32	0.05	E	0.07
8	CCode: Branch Roughin				<u>\$28.54</u>			<u>2.57</u>
9	4" Sq 1-1/2"d Comb / KO	4.00	\$234.17	C	\$9.37	0.35	E	1.42
10	4" Sq Blank Cover	2.00	\$165.18	C	\$3.30	9.44	C	0.19
11	4" Sq 1G 5/8" Plaster Ring	2.00	\$377.99	C	\$7.56	17.70	C	0.35
12	Box G/Screw w#12 Sol	4.00	\$146.59	C	\$5.86	3.54	C	0.14
13	1/2" BX Std Mall/Sqze	4.00	\$61.20	C	\$2.45	11.80	C	0.47
14	CCode: Generic Supports				<u>\$3.12</u>			<u>0.47</u>
15	Outlet Box Gen /Supp	4.00	\$0.78	E	\$3.12	0.12	E	0.47
16	CCode: Devices / Plates				<u>\$9.22</u>			<u>0.71</u>
17	HBL-5352 20a Duplex Recpt	2.00	\$3.59	E	\$7.18	29.50	C	0.59
18	1g 302 SS Duplex Plate	2.00	\$102.00	C	\$2.04	0.06	E	0.12
19	CCode: Lugs / Splices / Tape				<u>\$2.13</u>			<u>0.00</u>
20	3M YELLOW Boxed	6.00	\$17.72	C	\$1.06	0.00	C	0.00
21	3M Tan Boxed	6.00	\$17.72	C	\$1.06	0.00	C	0.00
22	CCode: Caddy				<u>\$0.64</u>			<u>0.07</u>
23	1/2" Caddy Clip	2.10	\$30.35	C	\$0.64	3.54	C	0.07
24	CCode: MC Cable				<u>\$121.11</u>			<u>3.54</u>
25	#12/2 MC Cable	100.00	\$1,211.11	M	\$121.11	35.40	M	3.54
26					<b>\$178.87</b>			<b>9.50</b>
27								
28								

# FACPAC Contract Change Order Supplemental Information Form (Ref# 60151)

Form Status: Saved

Tier 1 Project: CHHS Renovation Phase 1

BG Number: 20-136

Status: Active

District: Hardin County (HB678)

Phase: Project Initiation (View Checklist)

Contract: Advanced Electrical Systems Inc, 0260, Electrical

Type: CM Bid Package

Proposed

Change Order Number	16
Time Extension Required	No
Date Of Change Order	6/12/2024
Change Order Amount To Date	Increase

## Construction Contingency

Calculations below are project wide. Remaining negative Construction Contingency may require the submission of a revised BG1.

Current Approved Amount	\$3,254,314.84
Net Approved COs	\$259,530.10
Remaining After Approved COs	\$2,994,784.74
Net All COs	\$295,691.62
Remaining After All COs	\$2,958,623.22

This Requested Change Order Amount \$1,514.95

+/-

Change In A/E Fee This Change Order \$71.20

+/-

Change In CM Fee This Change Order \$0.00

+/-

Remaining Construction Contingency \$2,991,830.52

Balance

Contract Change Requested By Architect/Engineer

Contract Change Reason Code Expansion of Scope

Change Order Description And Justification

Cost associated with changing roller shades from manual to power per COP#60.

Cost Benefit To Owner

The cost of this change order has been reviewed and determined to be reasonable.

Contract unit prices have been utilized No  
to support the cost associated with this  
change order.

## Detailed Cost Breakdown

Contract unit prices have not been utilized, provide a detailed cost breakdown which separates labor, material, profit and overhead.

Detail Item	Amount	Percent of Total
Labor	\$801.50	52.91%
Materials	\$655.18	43.25%
Profit and Overhead		0.00%
Bond Insurance	\$58.27	3.85%
<b>Cost Breakdown Total:</b>	<b>\$1,514.95</b>	

Cost for this Change Order supported by an alternate bid or competitive price quote

Explain Why

Executed contract with contractor

**Change Order Supplemental Information Form Signature  
Page (Online Form Ref# 60151)**

---

Architect

---

Date

---

Construction Manager

---

Date

---

Finance Officer

---

Date

---

Local Board of Education Designee

---

Date