



# AIA® Document G731™ – 2019

## Change Order, Construction Manager as Adviser Edition

**PROJECT: (name and address)**

Christian County High School  
5185 Fort Campbell Blvd Hopkinsville,  
KY 42240

**OWNER: (name and address)**

Christian County Board of Education  
200 Glass Avenue  
Hopkinsville, KY 42240

**CONTRACTOR: (name and address)**

Herring Construction  
1072 State Route 373 North  
Eddyville, KY 32038

**CONTRACT INFORMATION:**

Contract For: BP 010-02 - Site  
Excavation/Storm Drainage  
Date: September 08, 2023

**ARCHITECT: (name and address)**

Hafer PSC  
21 Southeast Third St, Ste 800  
Evansville, IN 47708

**CHANGE ORDER INFORMATION:**

Change Order Number: 027  
Date: June 10, 2024

**CONSTRUCTION MANAGER: (name and address)**

Alliance Corporation  
116 E. College Street  
Glasgow, KY 42141

**THE CONTRACT IS CHANGED AS FOLLOWS:**

*(Insert a detailed description of the change and, if applicable, attach or reference specific exhibits. Also include agreed upon adjustments attributable to executed Construction Change Directives.)*

Remediation of soil anomaly.

The original Contract Sum was	\$	<u>2,692,390.03</u>
Net change by previously authorized Change Orders	\$	<u>42,078.96</u>
The Contract Sum prior to this Change Order was	\$	<u>2,734,468.99</u>
The Contract Sum will be increased by this Change Order in the amount of	\$	<u>3,453.75</u>
The new Contract Sum including this Change Order will be	\$	<u>2,737,922.74</u>

The Contract Time will be unchanged by Zero (0) days.  
The Contractor's Work shall be substantially complete on

**NOTE:** This Change Order does not include adjustments to the Contract Sum or Guaranteed Maximum Price, or the Contract Time, that have been authorized by Construction Change Directive until the cost and time have been agreed upon by both the Owner and Contractor, in which case a Change Order is executed to supersede the Construction Change Directive.

**NOT VALID UNTIL SIGNED BY THE ARCHITECT, CONSTRUCTION MANAGER, CONTRACTOR, AND OWNER.**

Hafer PSC  
\_\_\_\_\_  
**ARCHITECT (Firm name)**

Alliance Corporation  
\_\_\_\_\_  
**CONSTRUCTION MANAGER (Firm name)**

**SIGNATURE**  
Eric Rang, AIA, Senior Associate  
\_\_\_\_\_  
**PRINTED NAME AND TITLE**

**SIGNATURE**  
Kevin Hitchel, Sr. Project Manager  
\_\_\_\_\_  
**PRINTED NAME AND TITLE**

**DATE:**

**DATE:**

Herring Construction  
\_\_\_\_\_  
**CONTRACTOR (Firm name)**

Christian County Board of Education  
\_\_\_\_\_  
**OWNER (Firm name)**

**SIGNATURE**  
Chris Garner  
\_\_\_\_\_  
**PRINTED NAME AND TITLE**

**SIGNATURE**  
Christopher Bentzel, Superintendent  
\_\_\_\_\_  
**PRINTED NAME AND TITLE**

**DATE:**

**DATE:**



# PROPOSED CHANGE ORDER

**PROJECT** Christian County High School

**CONTRACTOR/SUPPLIER** Herring Construction

**BID PACKAGE** 010

DETAIL ITEM	AMOUNT	
LABOR		
MATERIALS	\$	2,821.00
PROFIT & OVERHEAD	\$	632.75
BOND INSURANCE		
<b>COST BREAKDOWN TOTAL</b>	<b>\$</b>	<b>3,453.75</b>

**DESCRIPTION**  
Remediation of Soil Anomaly  
\_\_\_\_\_  
\_\_\_\_\_  
\_\_\_\_\_  
\_\_\_\_\_

**PR #** N/A (ATTACH PR)

**CHANGE ORDER INITIATED BY:**

- \_\_\_\_\_ ARCHITECT/ENGINEER
- \_\_\_\_\_ OWNER
- \_\_\_\_\_ CONTRACTOR
- CM
- \_\_\_\_\_ CODE OFFICIAL
- \_\_\_\_\_ OTHER \_\_\_\_\_

**PLEASE INCLUDE THIS FORM WITH EVERY CHANGE ORDER.**



IDE # : 16-2-104  
445 FT. CAMPBELL BLVD  
HOPKINSVILLE, KY 42402



U.S. E&E  
**ALLIANCE**  
U.S. E&E  
3310 COMMONWEALTH AVENUE  
HOUSTON, TX 77058  
Telephone: 281-382-1400

**bell**  
COMMUNICATIONS  
137 Fernside  
Hopkinsville, KY 42426  
Telephone: 270-885-9636

**K&S Engineering, PLLC**  
137 Fernside  
Hopkinsville, KY 42426  
Telephone: 270-885-9636

**W&B**  
3400 S. SHILOH ROAD  
MADISON, TN 37117  
Telephone: 615-350-7400

**GM** Design and Equipment Co.  
3400 S. SHILOH ROAD  
MADISON, TN 37117  
Telephone: 615-350-7400

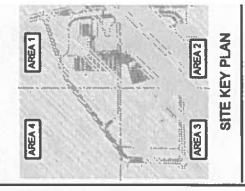

NO.	REVISIONS

Designed By: TTH  
Checked By: TTH  
Drawn By: CED  
Project No: 21-06-201

Major revisions shall include the following: 1. Revisions to the drawings shall be made by the Designer. 2. Revisions to the drawings shall be made by the Designer. 3. Revisions to the drawings shall be made by the Designer. 4. Revisions to the drawings shall be made by the Designer. 5. Revisions to the drawings shall be made by the Designer. 6. Revisions to the drawings shall be made by the Designer. 7. Revisions to the drawings shall be made by the Designer. 8. Revisions to the drawings shall be made by the Designer. 9. Revisions to the drawings shall be made by the Designer. 10. Revisions to the drawings shall be made by the Designer.

Sheet 01B

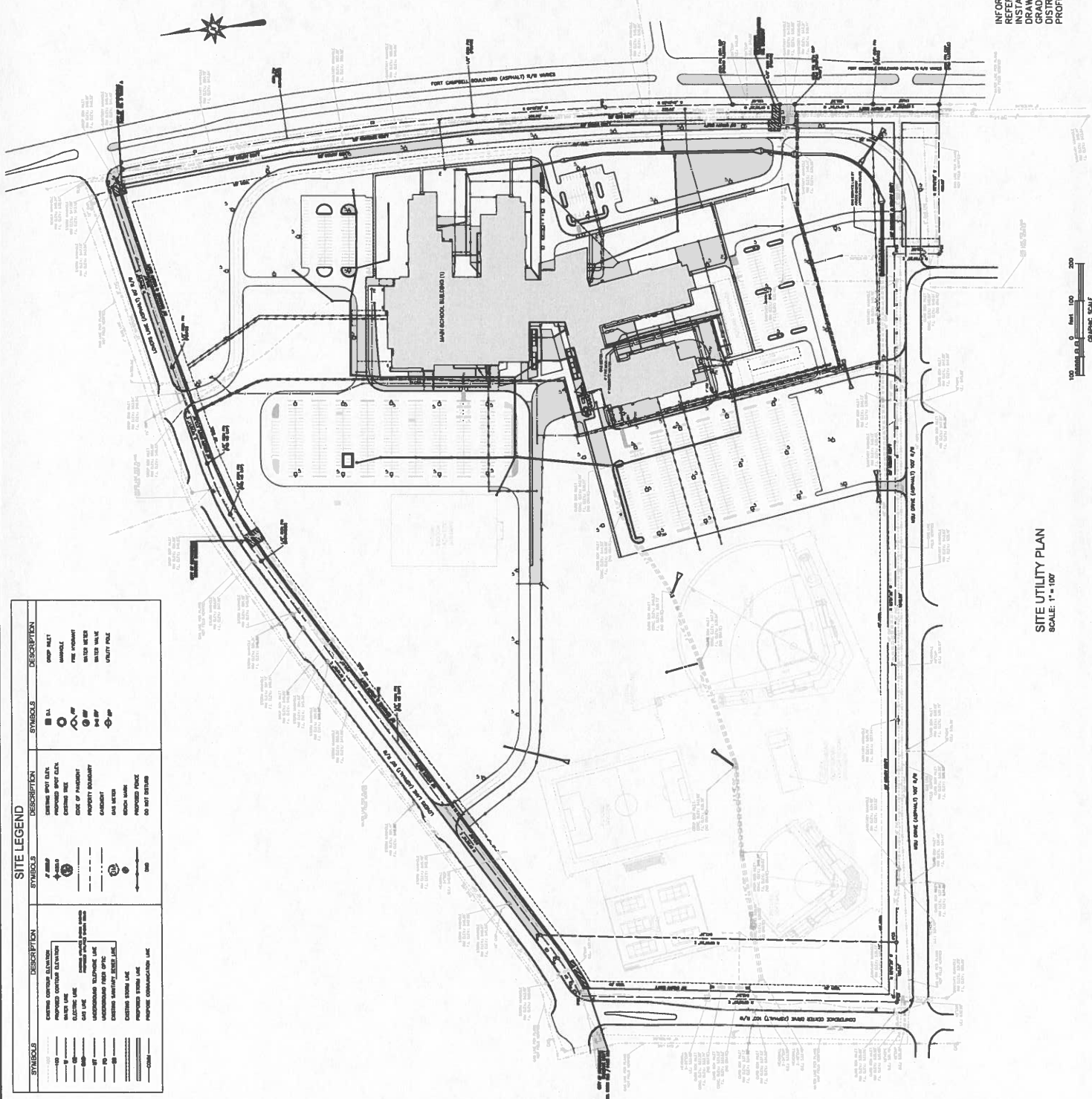

SITE LEGEND	
SYMBOLS	DESCRIPTION
(Symbol)	EXISTING POWER ELECTRICAL
(Symbol)	PROPOSED POWER ELECTRICAL
(Symbol)	EXISTING WATER
(Symbol)	PROPOSED WATER
(Symbol)	EXISTING SANITARY
(Symbol)	PROPOSED SANITARY
(Symbol)	EXISTING TELEPHONE
(Symbol)	PROPOSED TELEPHONE
(Symbol)	EXISTING CABLE TELEVISION
(Symbol)	PROPOSED CABLE TELEVISION
(Symbol)	EXISTING FIBER OPTIC
(Symbol)	PROPOSED FIBER OPTIC
(Symbol)	EXISTING CONDUIT
(Symbol)	PROPOSED CONDUIT
(Symbol)	EXISTING STORM LINE
(Symbol)	PROPOSED STORM LINE
(Symbol)	EXISTING COMMUNICATION LINE
(Symbol)	PROPOSED COMMUNICATION LINE
(Symbol)	EXISTING SIDEWALK
(Symbol)	PROPOSED SIDEWALK
(Symbol)	EXISTING DRIVE
(Symbol)	PROPOSED DRIVE
(Symbol)	EXISTING DRIVEWAY
(Symbol)	PROPOSED DRIVEWAY
(Symbol)	EXISTING DRIVEWAY
(Symbol)	PROPOSED DRIVEWAY
(Symbol)	EXISTING DRIVEWAY
(Symbol)	PROPOSED DRIVEWAY
(Symbol)	EXISTING DRIVEWAY
(Symbol)	PROPOSED DRIVEWAY
(Symbol)	EXISTING DRIVEWAY
(Symbol)	PROPOSED DRIVEWAY
(Symbol)	EXISTING DRIVEWAY
(Symbol)	PROPOSED DRIVEWAY
(Symbol)	EXISTING DRIVEWAY
(Symbol)	PROPOSED DRIVEWAY
(Symbol)	EXISTING DRIVEWAY
(Symbol)	PROPOSED DRIVEWAY
(Symbol)	EXISTING DRIVEWAY
(Symbol)	PROPOSED DRIVEWAY
(Symbol)	EXISTING DRIVEWAY
(Symbol)	PROPOSED DRIVEWAY

INFORMATION SHOWN ON THIS DRAWING IS FOR REFERENCE AND COORDINATION ONLY. DESIGN AND INSTALLATION INFORMATION IS FOUND IN OTHER DRAWINGS IN THESE DOCUMENTS INCLUDING SITE GRADING AND DRAINAGE PLANS, WATER DISTRIBUTION PLANS, SANITARY SEWER PLANS AND PROFILES AND SITE ELECTRICAL PLANS.

<b>CLIENT:</b> Alliance	<b>CONTRACTOR</b> HERRING CONSTRUCTION CO INC					
<b>PROJECT NAME:</b> CCHS						
<b>ADDRESS:</b>	1072 ST RT 373					
<b>CITY:</b>	EDDYVILLE					
<b>STATE:</b>	KY 42038					
<b>DATE:</b> 5/8/2024	<b>DESCRIPTION</b>	Soil Anomaly				
<b>CONTRACT #</b>		<b>SUB CONTRACT #</b>				
<b>CHANGE ORDER PRICING PROPOSAL</b>						
<b>BREAKDOWN OF COSTS</b>						
<b>LABOR</b>	<b>QTY</b>	<b>UNIT</b>	<b>MATERIAL</b>	<b>EQUIP.</b>	<b>LABOR</b>	<b>TOTAL</b>
		HRS	\$UNIT	& UNIT	UNIT \$ PER HR	
					\$ 23.00	\$ -
						\$ -
						\$ -
						\$ -
						\$ -
						\$ -
						\$ -
<b>LABOR TAX BURDEN PERCENT</b>					35%	\$ -
<b>TOTAL \$</b>						\$ -
<b>EQUIPMENT</b>	<b>QTY</b>	<b>UNIT</b>		<b>COST</b>		
		hrs		Per hr.		\$ -
						\$ -
						\$ -
						\$ -
						\$ -
						\$ -
						\$ -
						\$ -
						\$ -
<b>TOTAL \$</b>						\$ -
<b>MATERIALS</b>		<b>QTY</b>		<b>PRICE</b>		
Shot Rock		94cys		\$ 17.50		\$ 1,645.00
#2		19cys		\$ 42.00		\$ 798.00
57 Stone		9cys		\$ 42.00		\$ 378.00
						\$ -
						\$ -
						\$ -
						\$ -
						\$ -
<b>TOTAL \$</b>						\$ 2,821.00
<b>TOTAL DIRECT COSTS LABOR, MATERIAL, EQUIP.</b>						\$ 2,821.00
<b>TAX ON MATERIAL (6%)</b>						\$ 169.26
<b>SUBTOTAL</b>						\$ 2,990.26
<b>OVERHEAD AT 10%</b>						\$ 299.03
<b>SUBTOTAL</b>						\$ 3,289.29
<b>PROFIT AT 5%</b>						\$ 164.46
<b>TOTAL \$</b>						\$ 3,453.75

# FACPAC Contract Change Order Supplemental Information Form (Ref# 60145)

Form Status: Saved

Tier 1 Project: Consolidated High School

BG Number: 22-104

Status: Active

District: Christian County (HB678)

Phase: Project Initiation (View Checklist)

Contract: Herring Construction Co., Inc. , 0010, Site Excavation, Storm Drainage

Type: CM Bid Package

Proposed

Change Order Number	2
Time Extension Required	No
Date Of Change Order	6/10/2024
Change Order Amount To Date	Increase

## Construction Contingency

Calculations below are project wide. Remaining negative Construction Contingency may require the submission of a revised BG1.

Current Approved Amount	\$6,320,436.60
Net Approved COs	\$392,962.39
Remaining After Approved COs	\$5,927,474.21
Net All COs	\$365,699.78
Remaining After All COs	\$5,954,736.82

This Requested Change Order Amount \$3,453.75

+/-

Change In A/E Fee This Change Order

+/-

Change In CM Fee This Change Order \$0.00

+/-

Remaining Construction Contingency \$5,954,736.82

Balance

Contract Change Requested By Construction Manager

Contract Change Reason Code Expansion of Scope

Change Order Description And Justification

Remediation of soil anomaly.

Cost Benefit To Owner

The cost of this change order has been reviewed and determined to be reasonable.

Contract unit prices have been utilized No  
to support the cost associated with this  
change order.

## Detailed Cost Breakdown

Contract unit prices have not been utilized, provide a detailed cost breakdown which separates labor, material, profit and overhead.

---

<b>Detail Item</b>	<b>Amount</b>	<b>Percent of Total</b>
Labor	\$2,821.00	81.68%
Materials	\$632.75	18.32%
Profit and Overhead		0.00%
Bond Insurance		0.00%
<b>Cost Breakdown Total:</b>	<b>\$3,453.75</b>	

Cost for this Change Order supported by an alternate bid or competitive price quote

Explain Why

Executed contract with contractor.

# Change Order Supplemental Information Form Signature Page (Online Form Ref# 60145)

---

Architect

---

Date

---

Construction Manager

---

Date

---

Finance Officer

---

Date

---

Local Board of Education Designee

---

Date