



JUNE 05, 2024 - Athletic Field Design Update









New paving at walks & roadway

New Field Lighting

*New Video
Scoreboard*

*New Bleachers (by
Toadvine COOP)*

New Field Lighting

*New Video
Scoreboard*

*New Turf, Fencing
And Concrete
Edging (by Motz
COOP)*

*New Turf, Fencing
And Concrete
Edging (by Motz
Coop)*

*Existing Dugouts and Press Boxes
Remain - New Paint
New Player Benches and Shelving*

*New Restroom Concessions and
Locker Room Building*

Added Parking

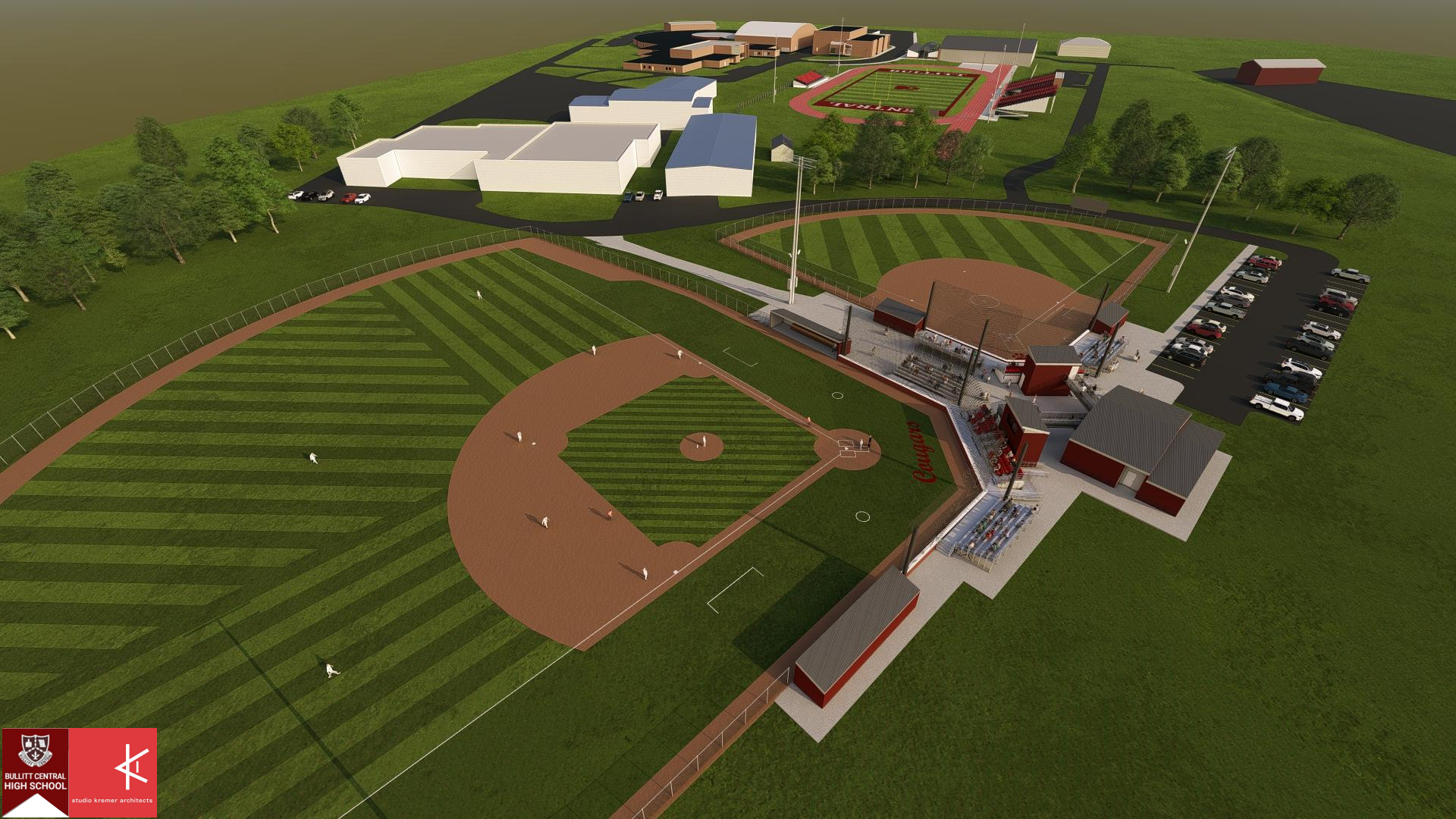

Bullitt Central Softball

Foul Territory Letter Alternate

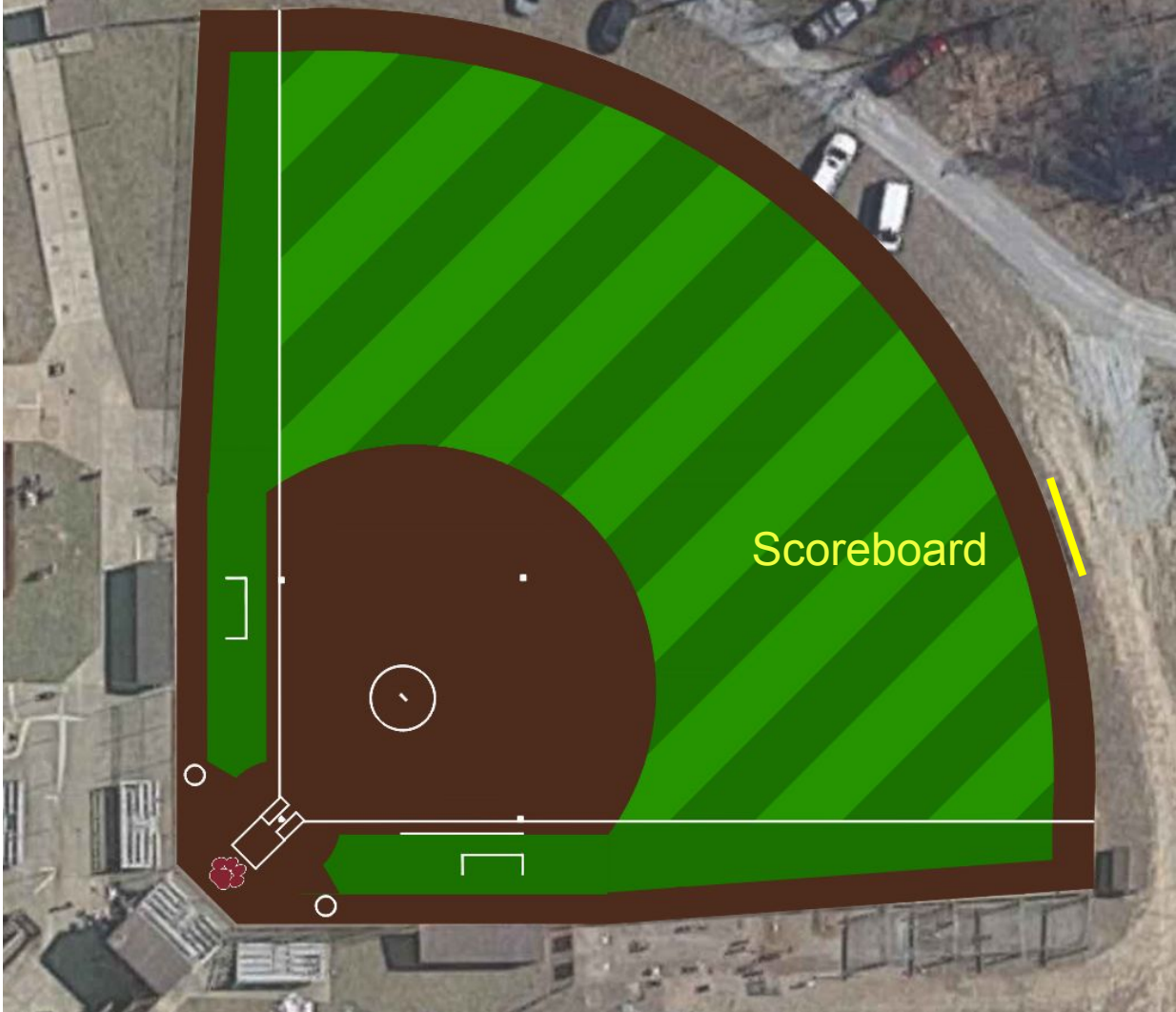
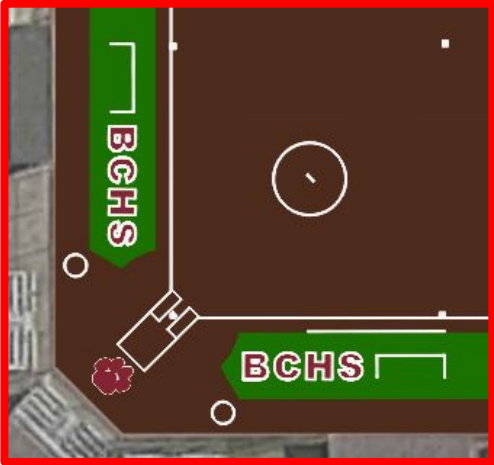

BULLITT CENTRAL
HIGH SCHOOL



studio kremer architects

Bullitt Central Softball

Foul Territory Letter & Logo
Position Alternate



BULLITT CENTRAL
HIGH SCHOOL



studio kremer architects

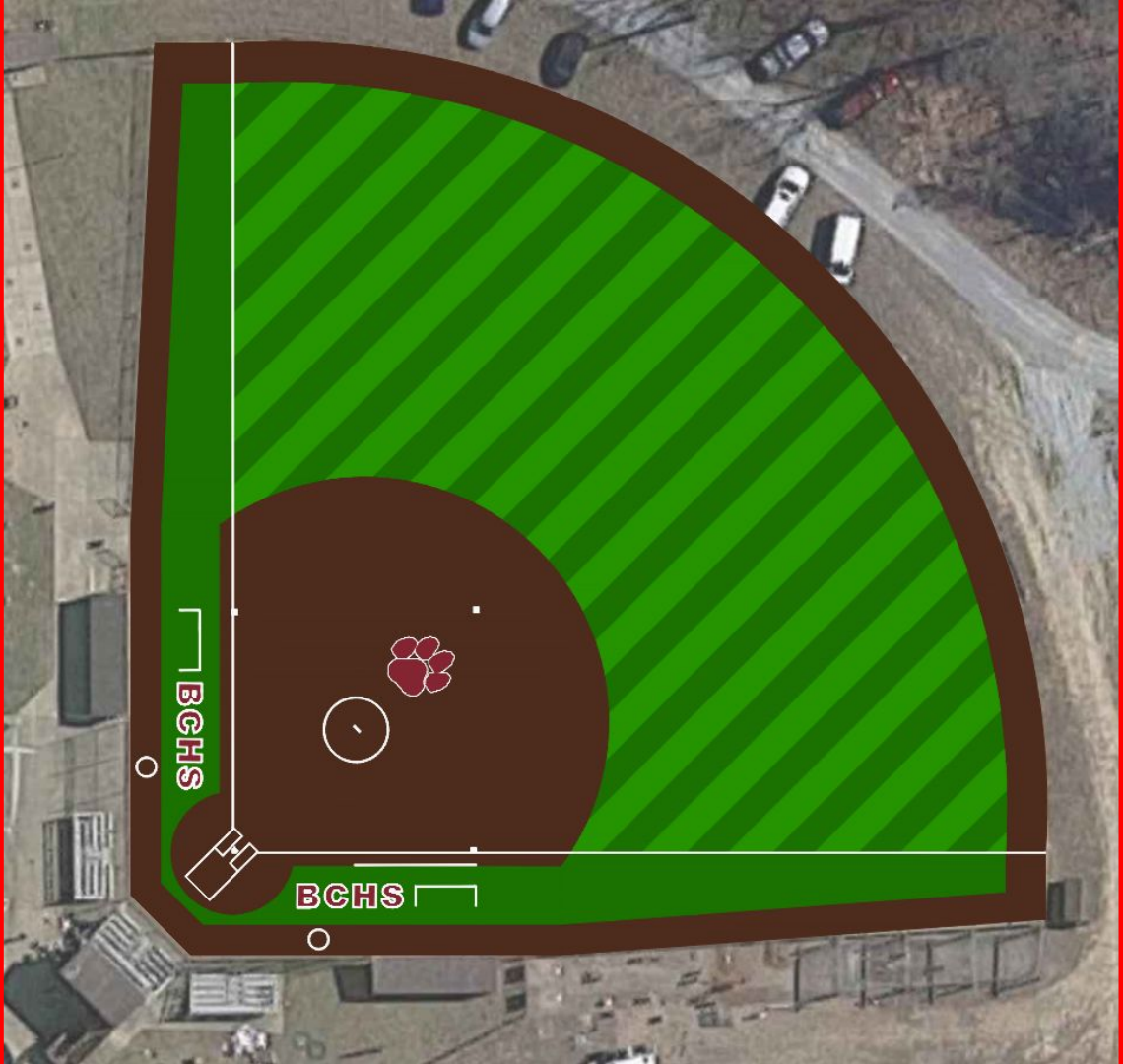

Bullitt Central Baseball

Foul Territory Letter Alternate

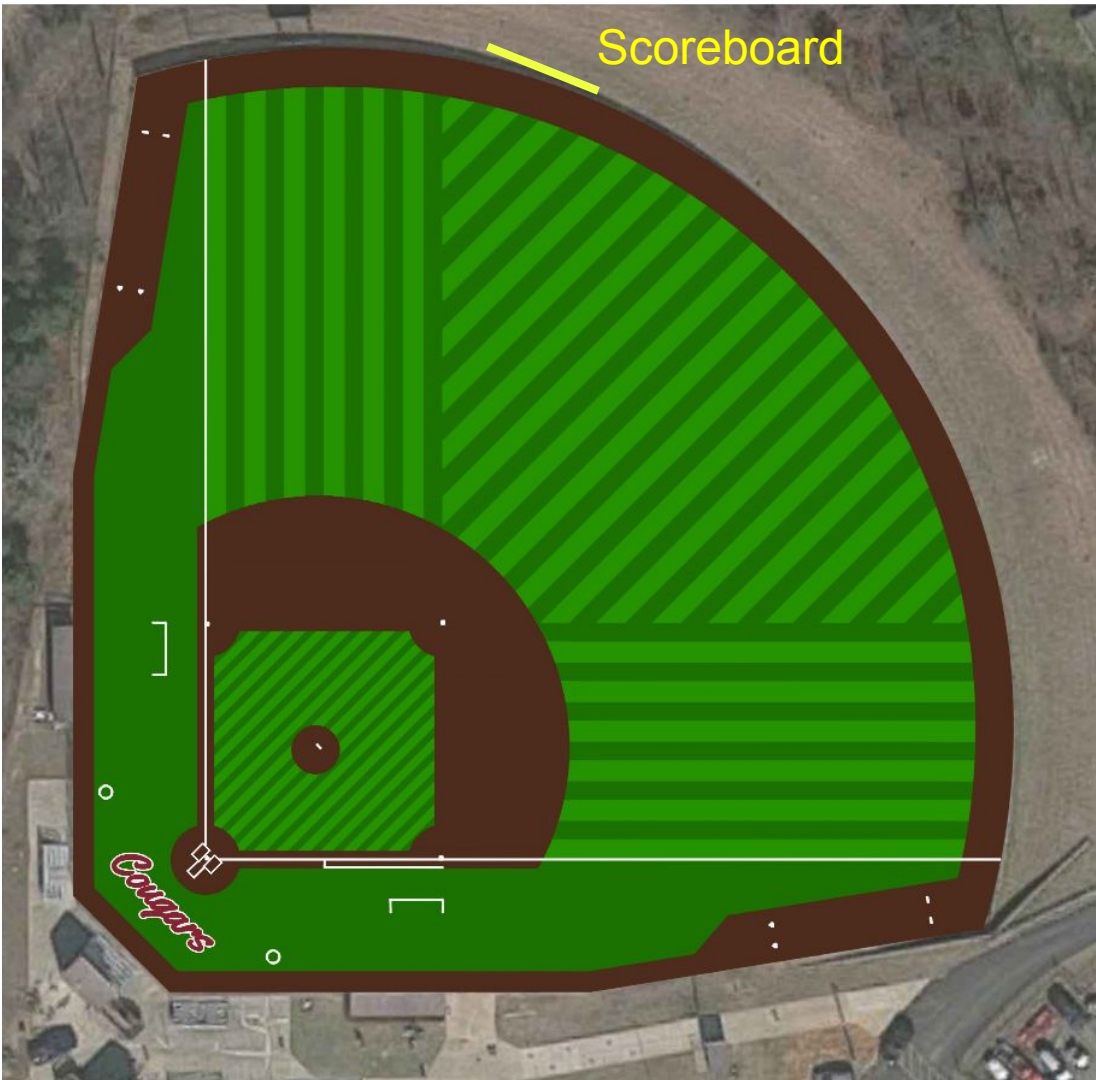

Bullitt Central Baseball

Foul Territory Letter & Logo Alternate

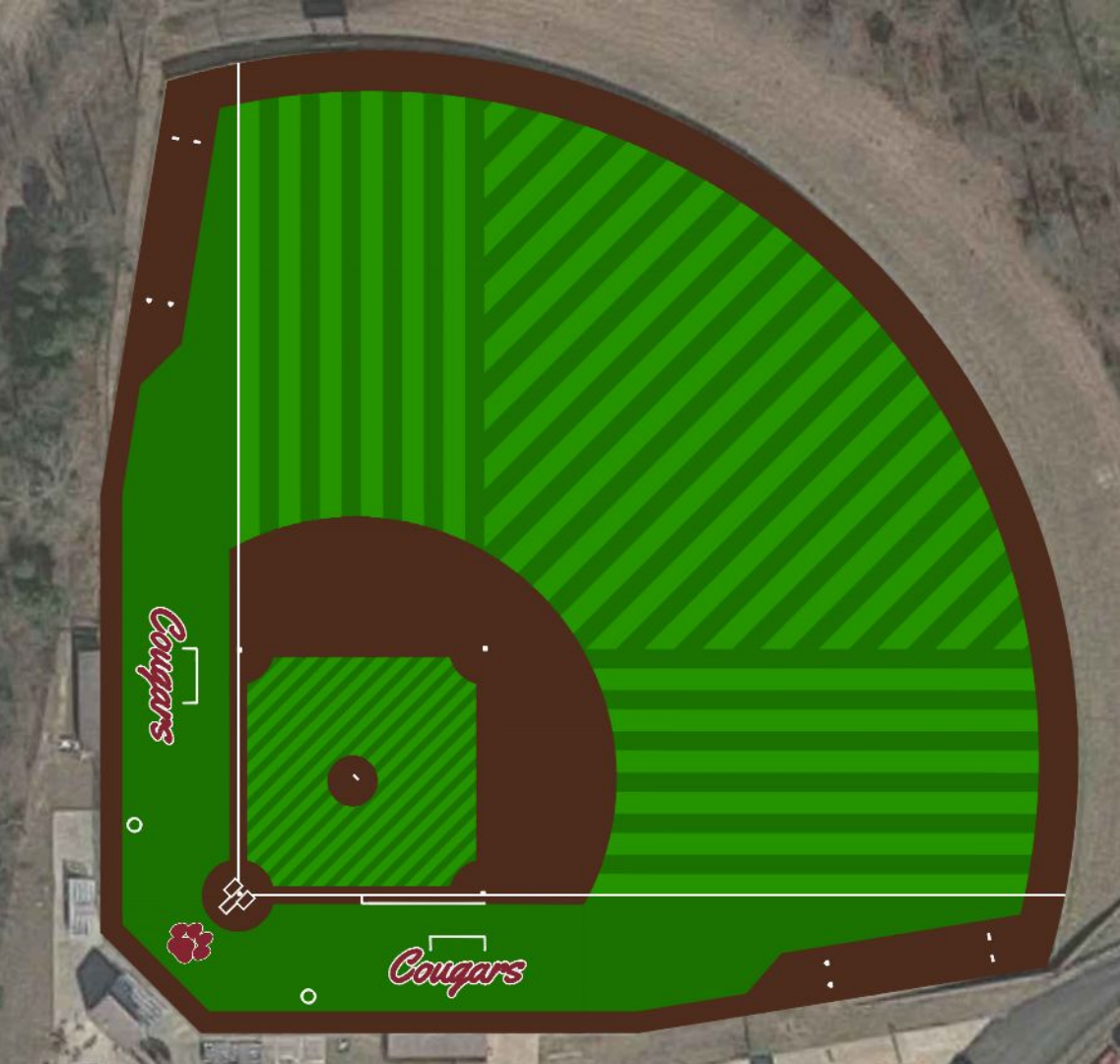

BULLITT CENTRAL
HIGH SCHOOL



studio kremer architects







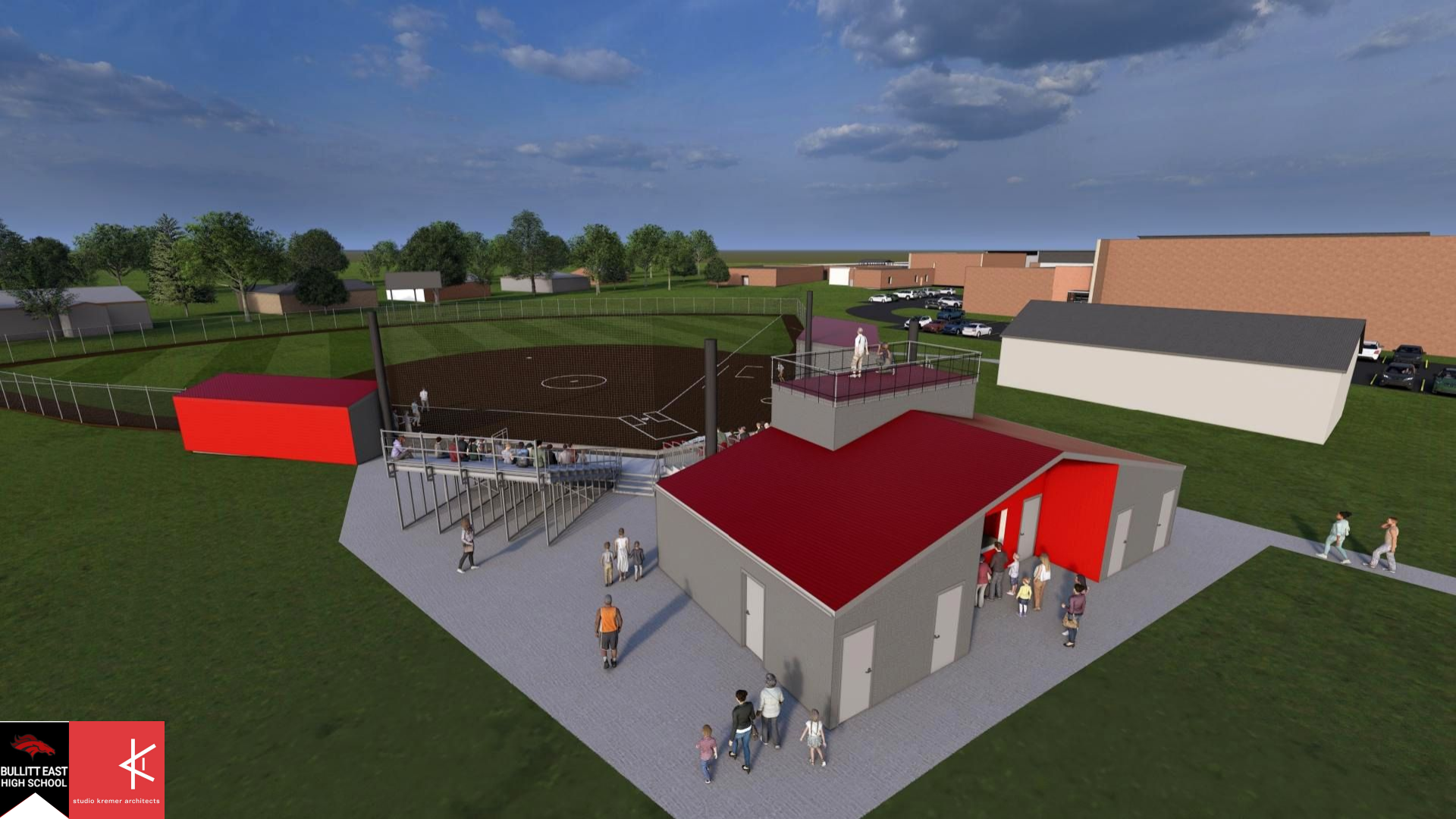

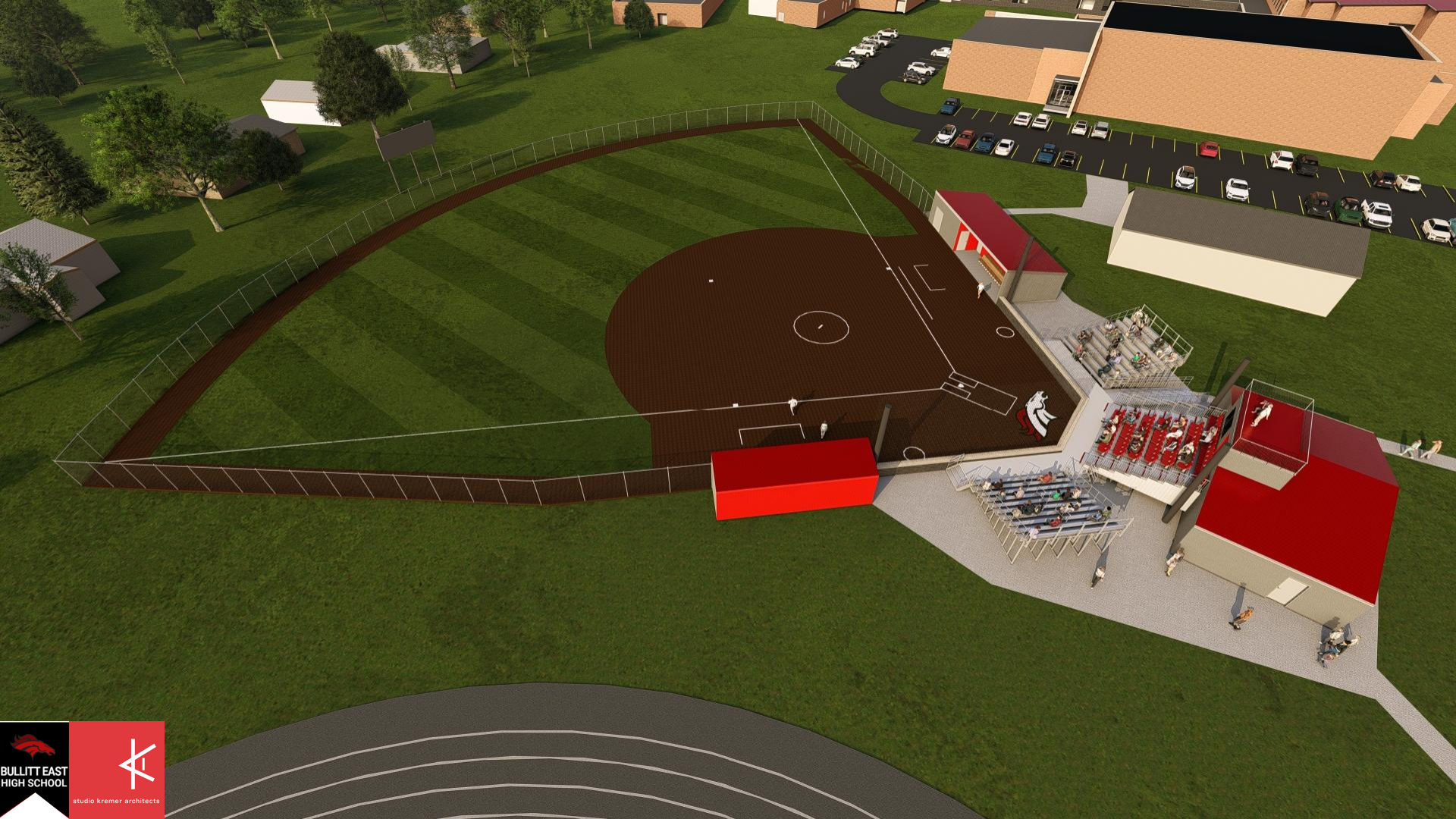

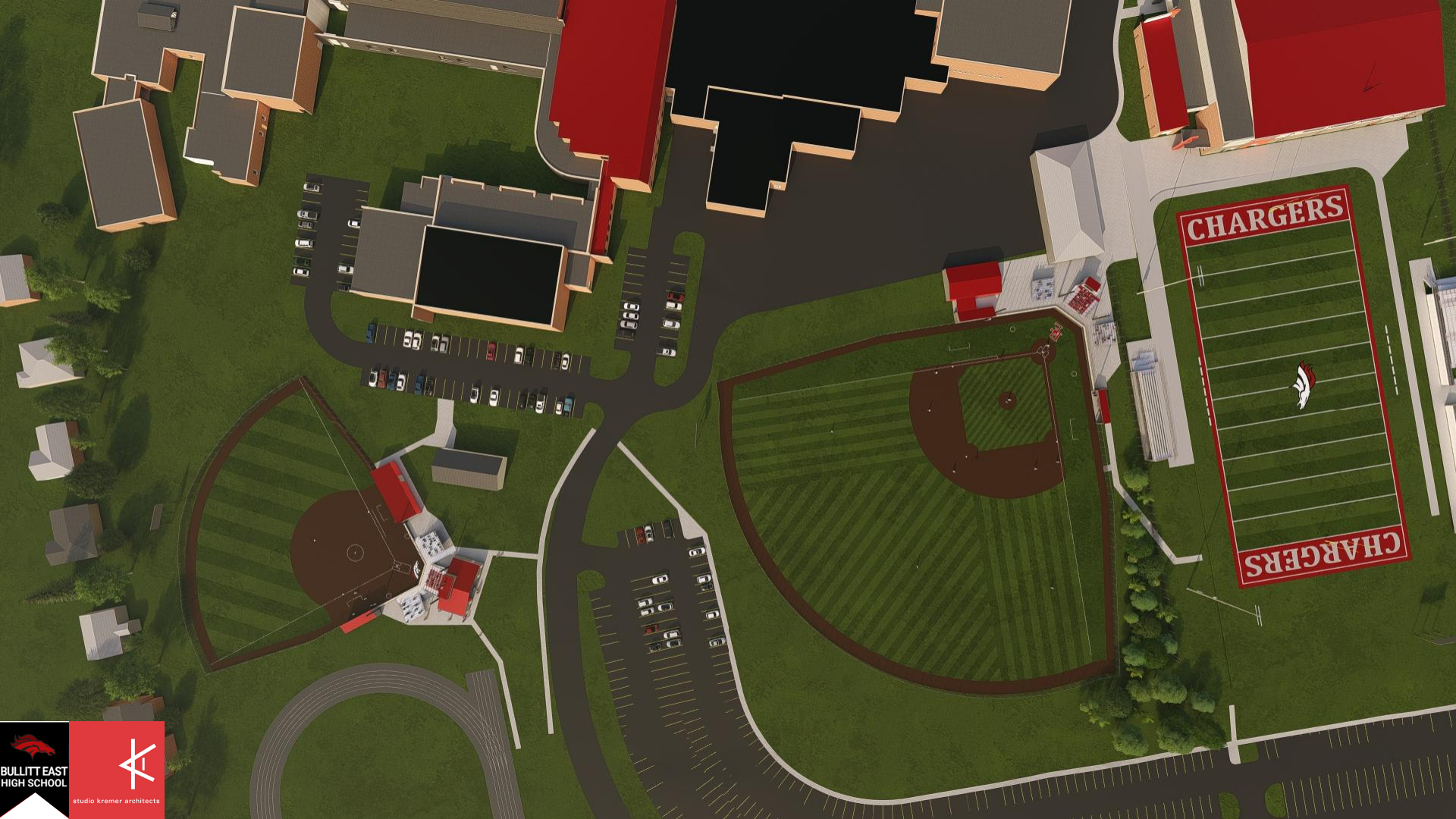

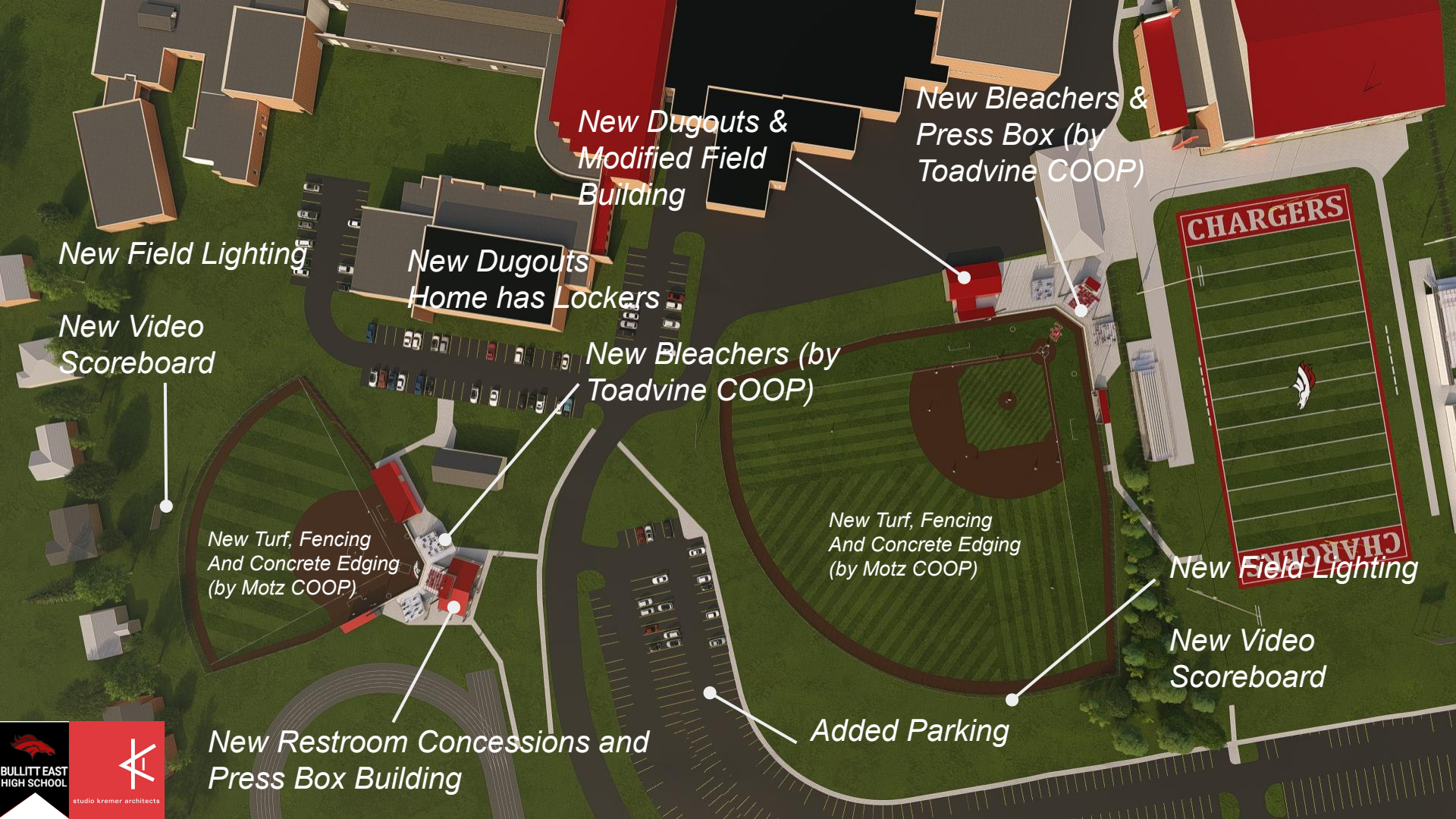

New Dugouts & Modified Field Building

New Bleachers & Press Box (by Toadvine COOP)

New Field Lighting

New Dugouts Home has Lockers

New Video Scoreboard

New Bleachers (by Toadvine COOP)

New Turf, Fencing And Concrete Edging (by Motz COOP)

New Turf, Fencing And Concrete Edging (by Motz COOP)

CHARGERS

CHARGERS

New Field Lighting

New Video Scoreboard

New Restroom Concessions and Press Box Building

Added Parking

Bullitt East Softball

Foul Territory Letter Alternate

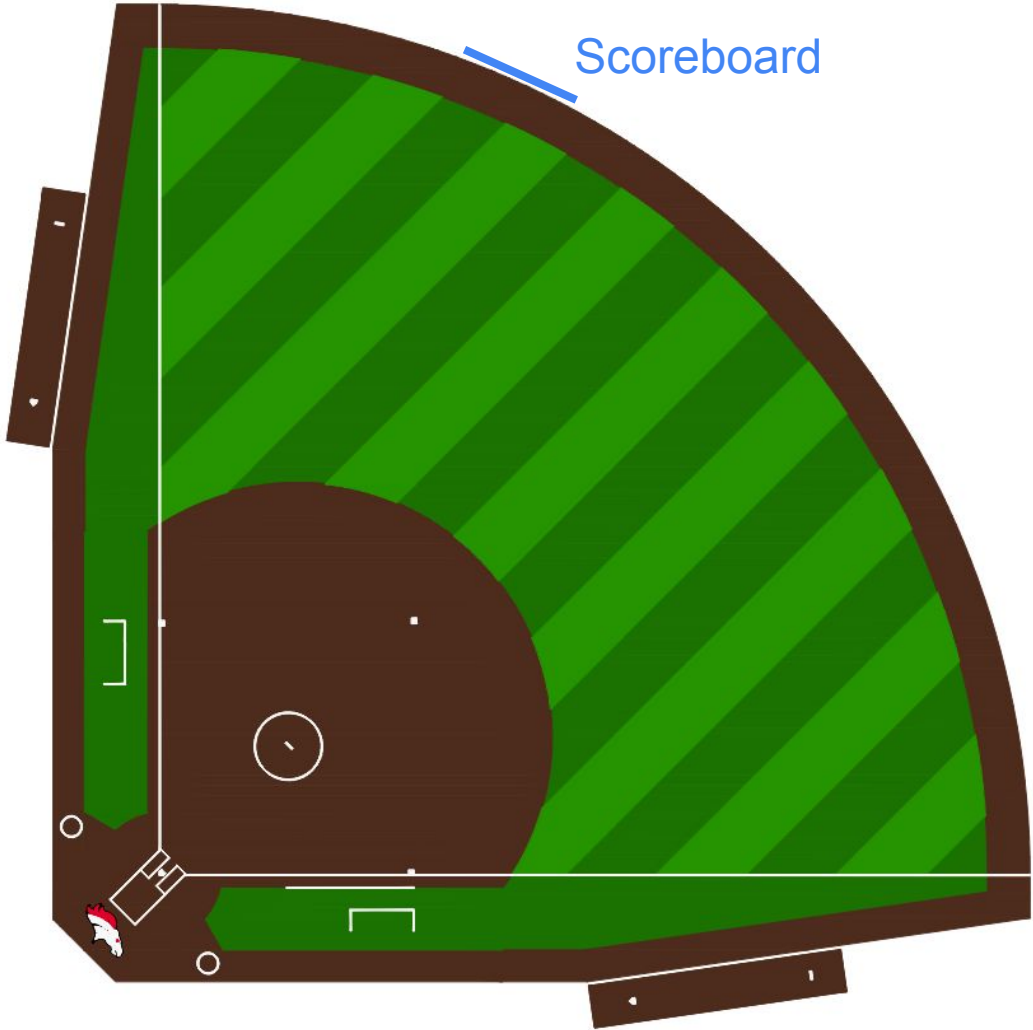
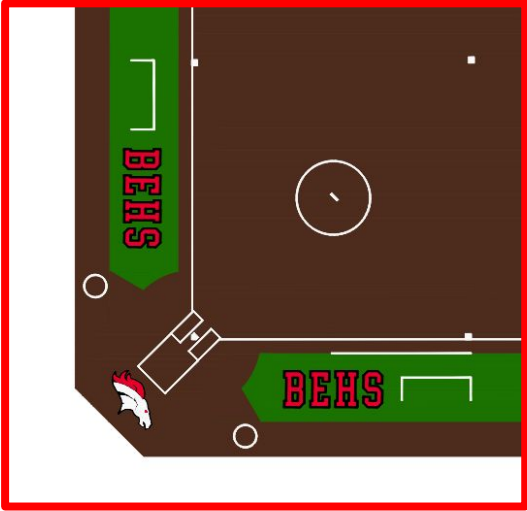

Bullitt East Softball

Foul Territory Letter & Logo
Position Alternate

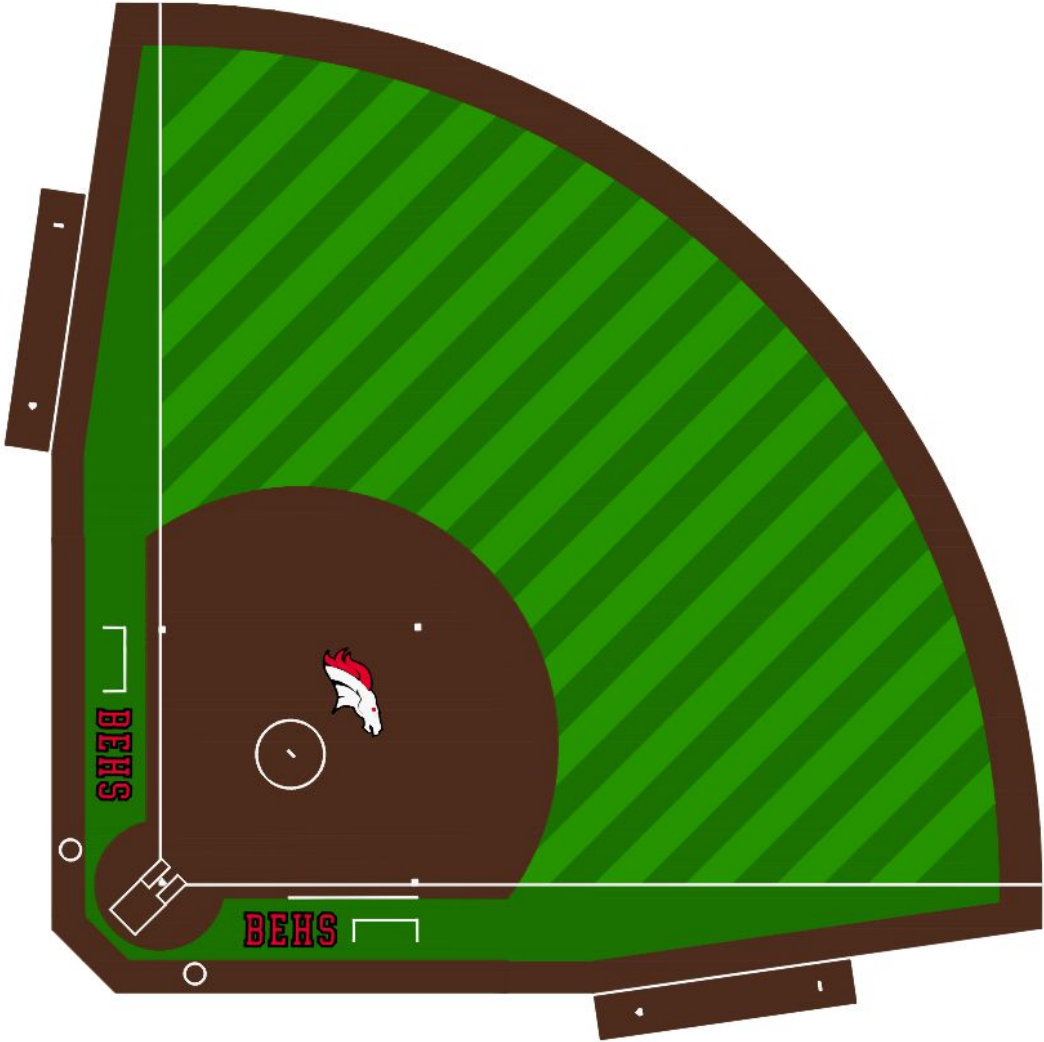

Bullitt East Baseball

Foul Territory Letter Alternate

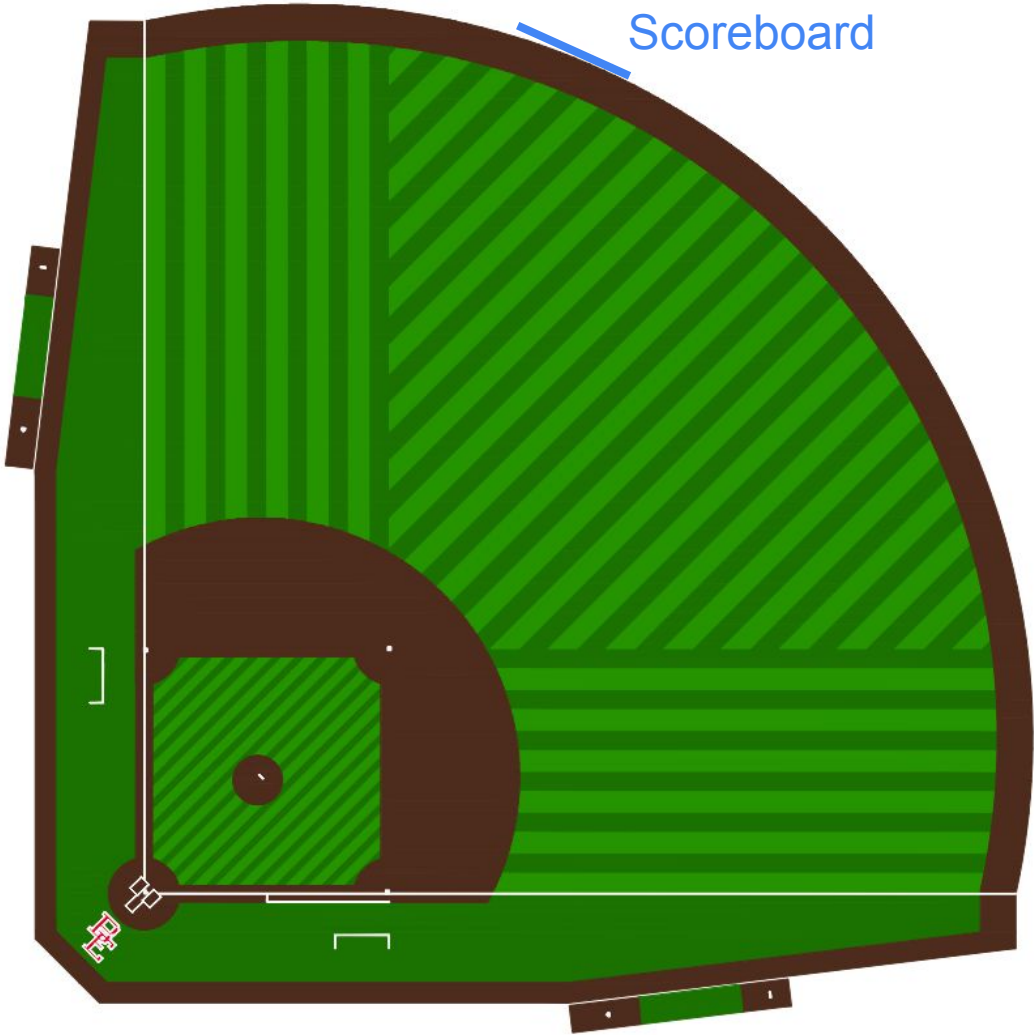
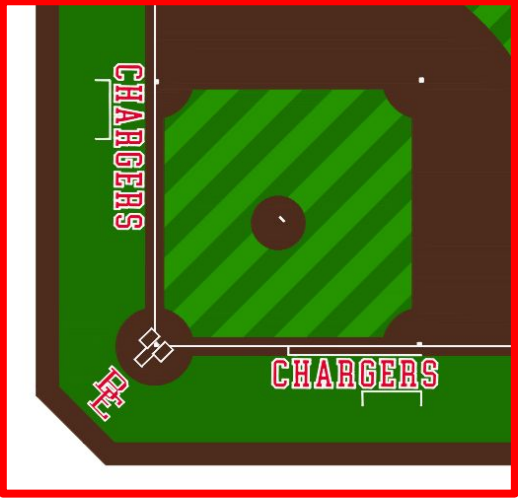

The bottom left corner features two logos. On the left is the Bullitt East High School logo, which includes a red horse head silhouette above the text "BULLITT EAST HIGH SCHOOL" in white. On the right is the Studio Kremer Architects logo, which consists of a white stylized 'A' shape on a red background, with the text "studio kremer architects" in white below it.







NORTH BULLITT
HIGH SCHOOL



studio kramer architects

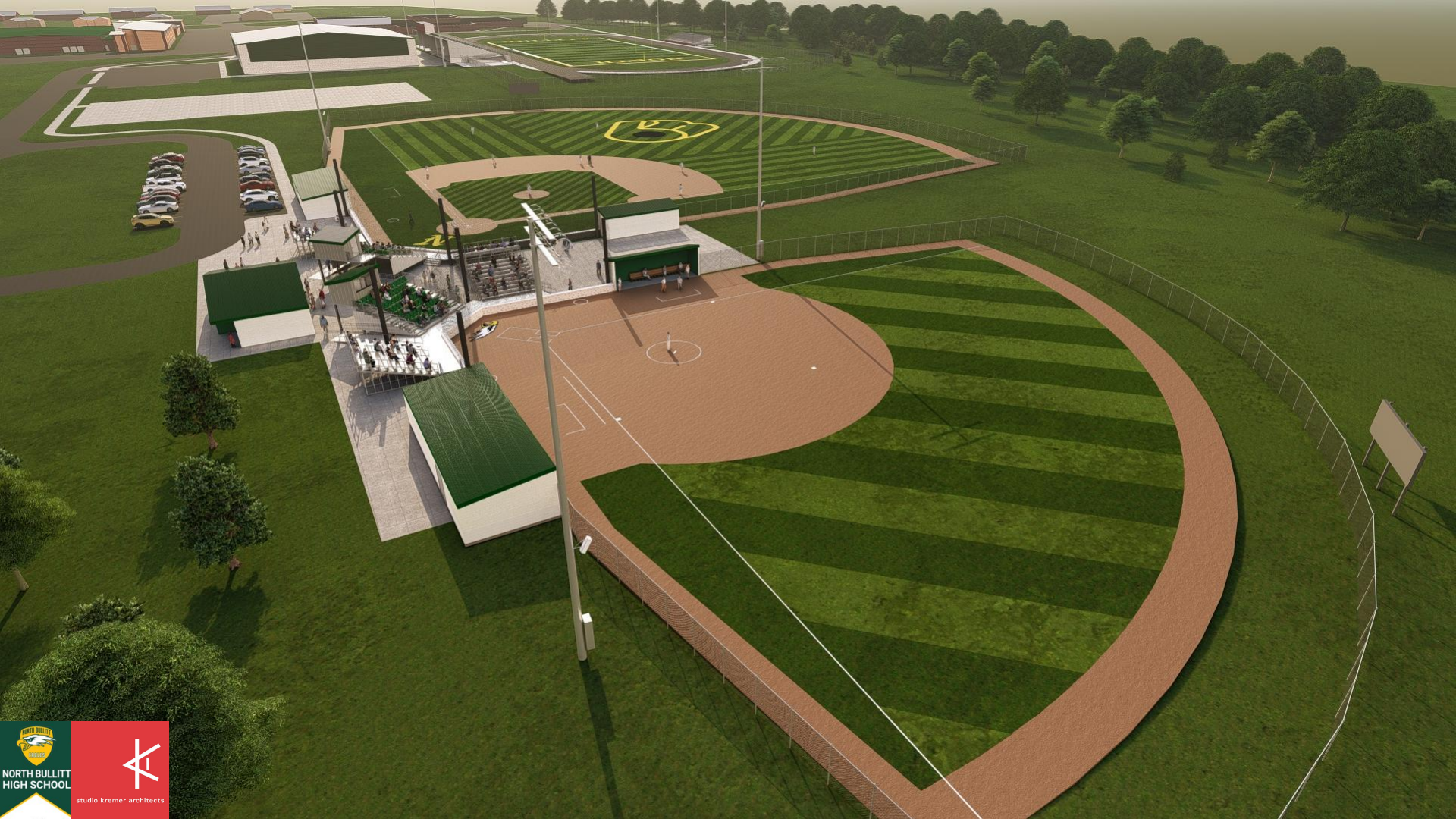

North Bullitt Softball

Foul Territory Letter Alternate

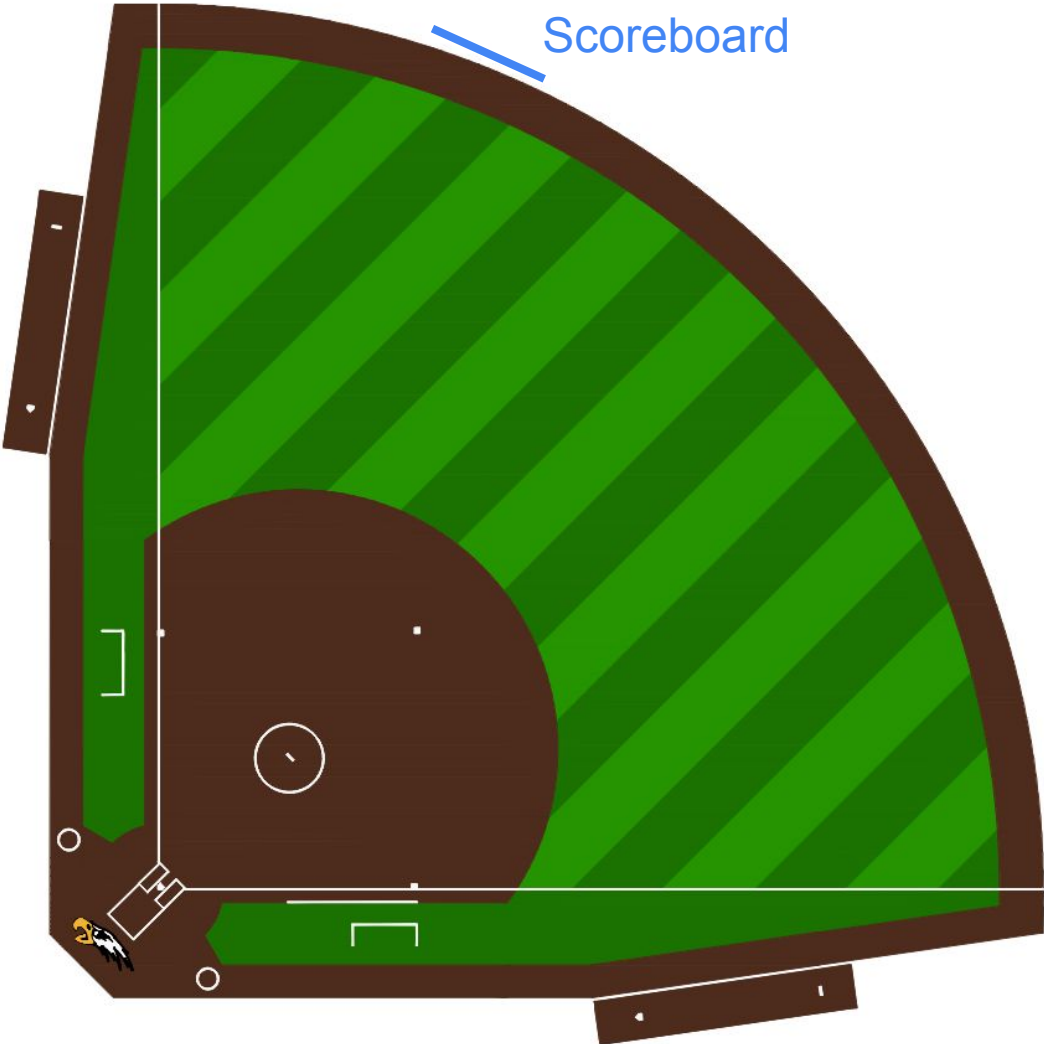
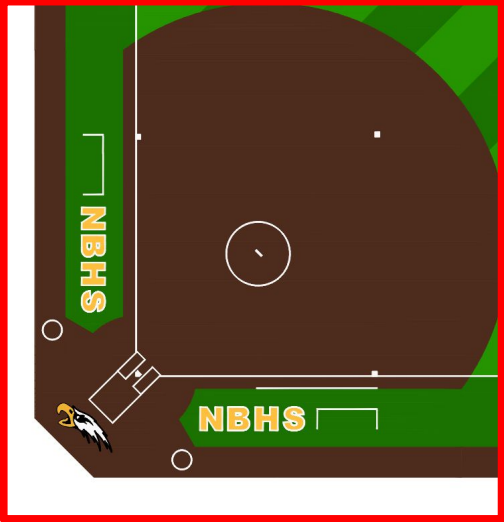

North Bullitt Softball

Foul Territory Letter & Logo
Position Alternate

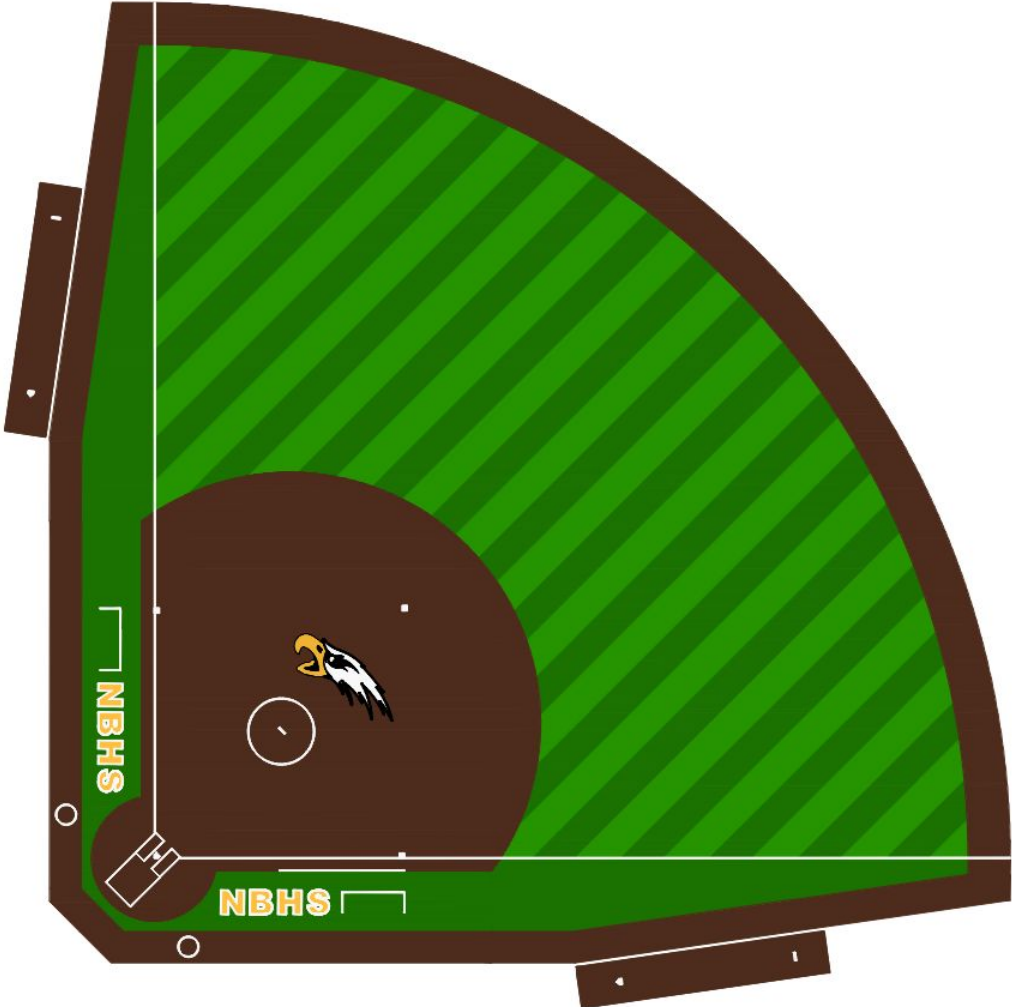

North Bullitt Baseball

Foul Territory Letter Alternate

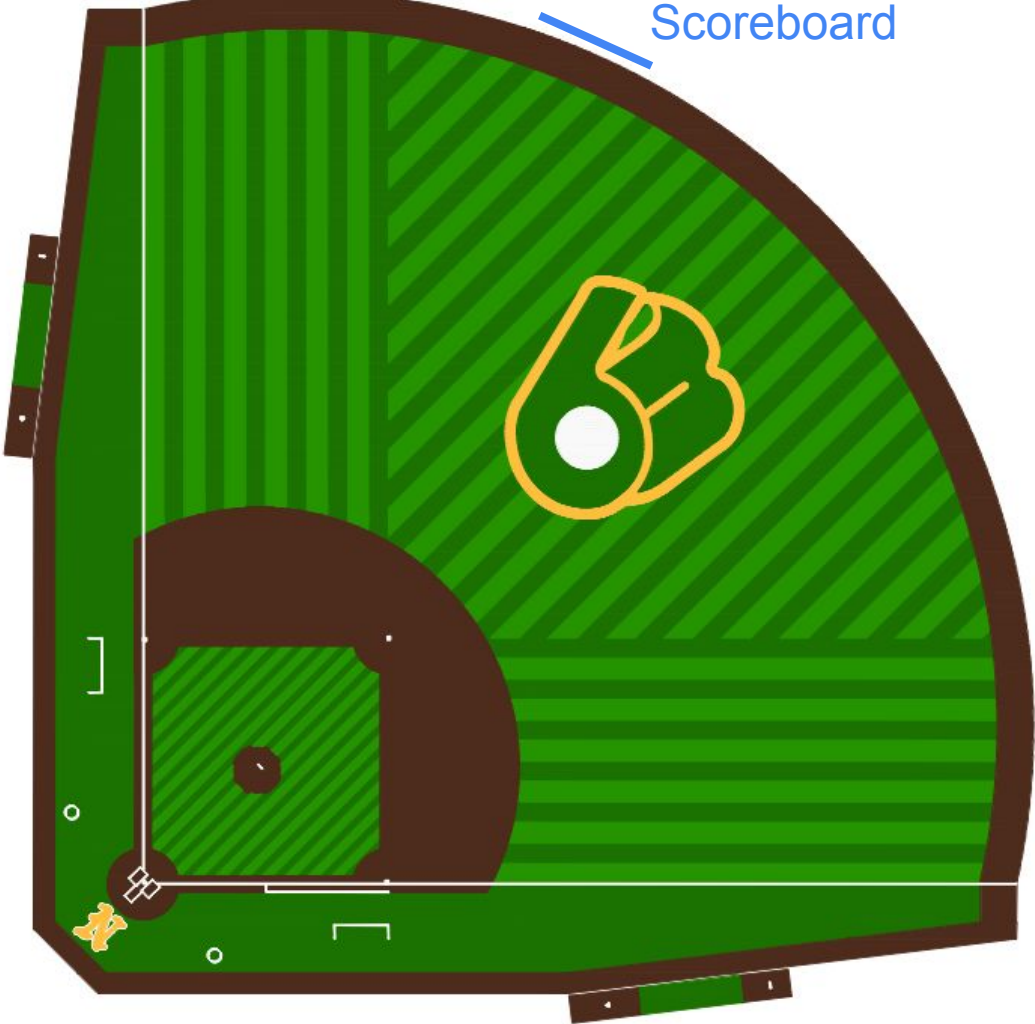

BCPS Field House Due Diligence - Geothermal Test Bores

Three proposals for the test bores were solicited to provide required site due diligence for all of the New fieldhouses (North Bullitt, Central and East). The numbers below reflect (1) test bore at each respective site. Below is a listing of the proposals received:

SKA and CMTA recommends Bluegrass Geothermal for this scope of work. *Cost of three test bores is \$52,000.00.*

Funding for this work is included on the Site Survey line item per the initial BG-1 in the amount of \$200,000.

Billing towards this line item includes the following services performed to date:

- Kapur – Survey Updates \$39,945.00
- Kapur – Survey Updates \$16,970.00
- CSI - Geotechnical Borings at North Bullitt - \$ 4,100.00

Total billed to date: \$61,015

Total Remaining: \$138,985 (Prior to Geothermal Test Bores as noted above).

For reference - Test Bore at BEHS FA cost \$18,100 for one bore. Costs noted here are in line with previous work on other projects.



studio kremer architects

Bullitt Athletics - Field House Due Diligence



MOVING FORWARD