



studio kremer architects

February 26, 2024 Design and Construction Update





Initial Design Discussions

- Design Discussions are continuing - Field House Plans are underway and Baseball and Softball Field Designs have Started - Site Visits were conducted last week and will continue.

Board Consent Item

- **At March 11th Worksession, will request SD Document Approval**



studio kremer architects

Phase 2 Athletics and Field Houses - Schematic Design



MOVING FORWARD

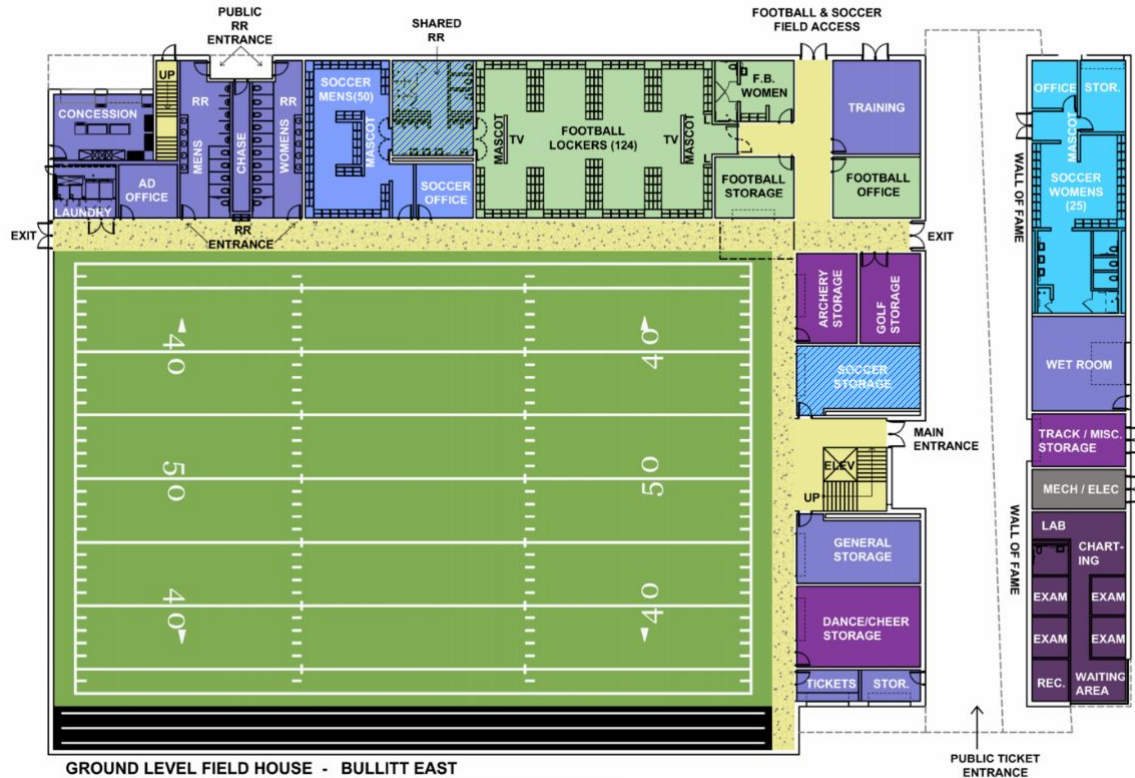

GROUND LEVEL FIELD HOUSE - BULLITT EAST
 SIZE: 33,815 S.F. MAIN BUILDING - 3,811 S.F. ANNEX = Total 37,626 s.f.

PLAN LEGEND

- MEP, JAN. SPACES
- CIRCULATION
- WRESTLING
- FOOTBALL
- SOCCER WOMENS
- SOCCER MENS
- GENERAL USE
- SPORT STORAGE
- MEDICAL OFFICE



Phase 2 Athletics and Field Houses - Schematic Design - Field House Plans



VIEW OUT TO FOOTBALL/SOCCER FIELD

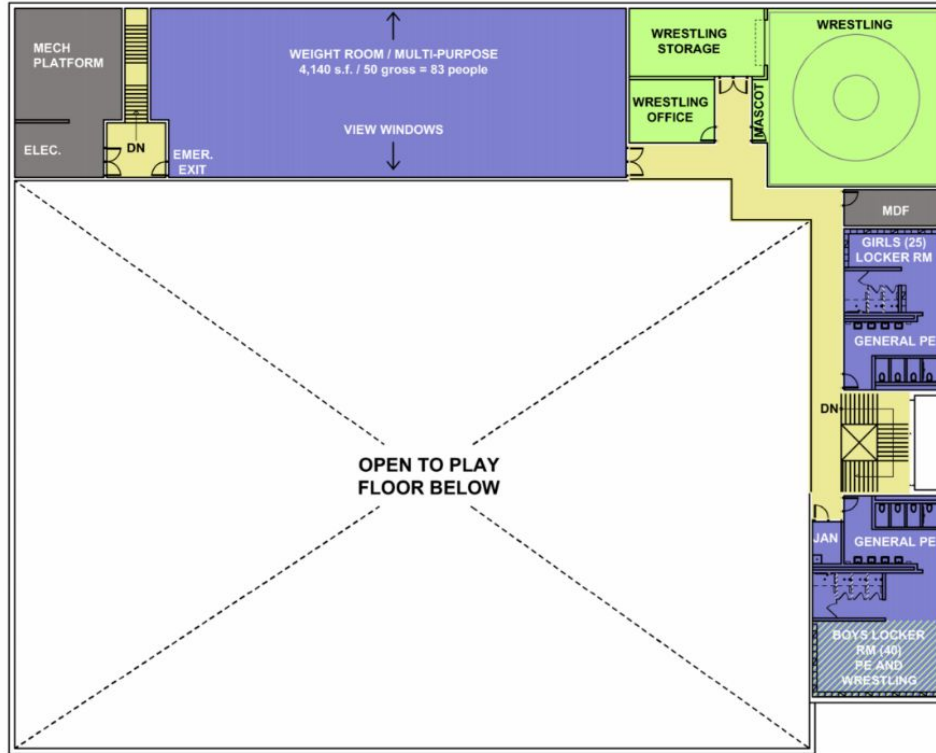

SECOND LEVEL FIELD HOUSE
SIZE: 11,765 S.F.

PLAN LEGEND

- MEP, JAN. SPACES
- CIRCULATION
- WRESTLING
- FOOTBALL
- SOCCER WOMENS
- SOCCER MENS
- GENERAL USE
- SPORT STORAGE
- MEDICAL OFFICE



studio kremer architects

Phase 2 Athletics and Field Houses - Schematic Design - Field House Plans



MOVING FORWARD

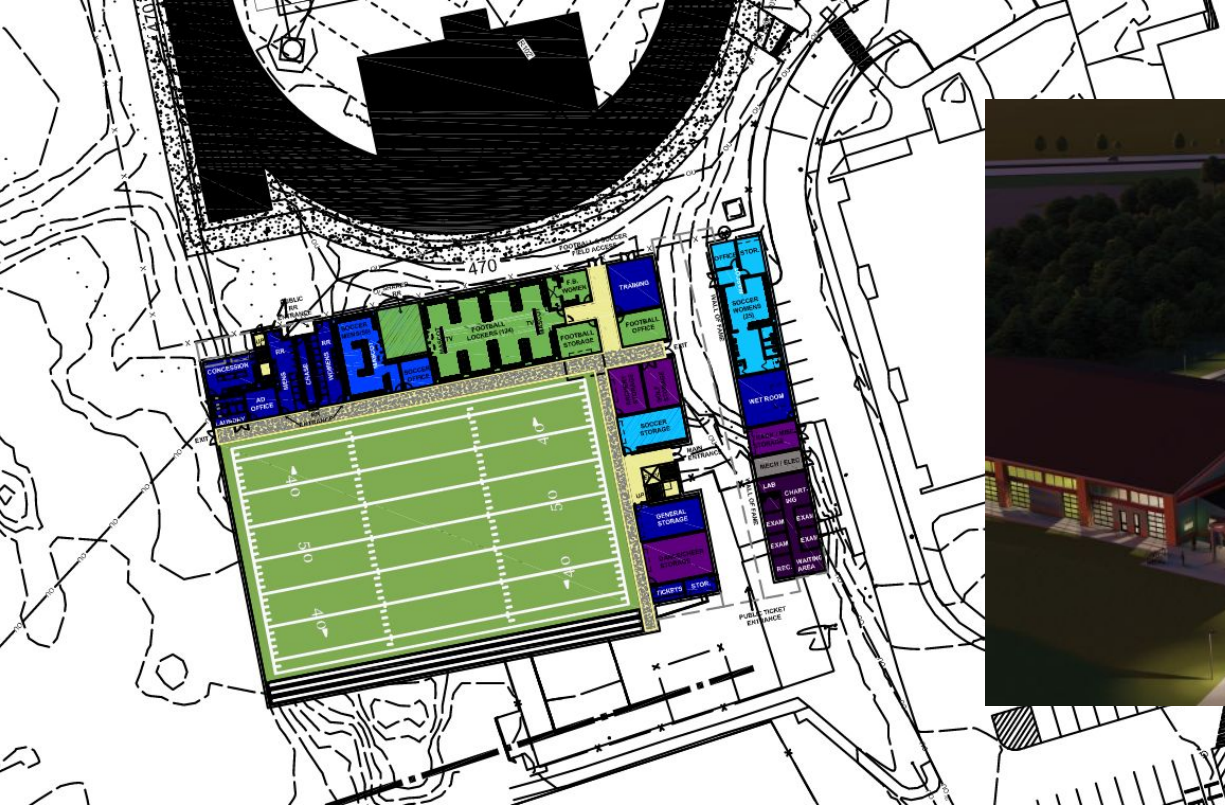

Phase 2 Athletics and Field Houses - Schematic Design - Field House Plans





Bernheim Middle School - Construction



Phase 3

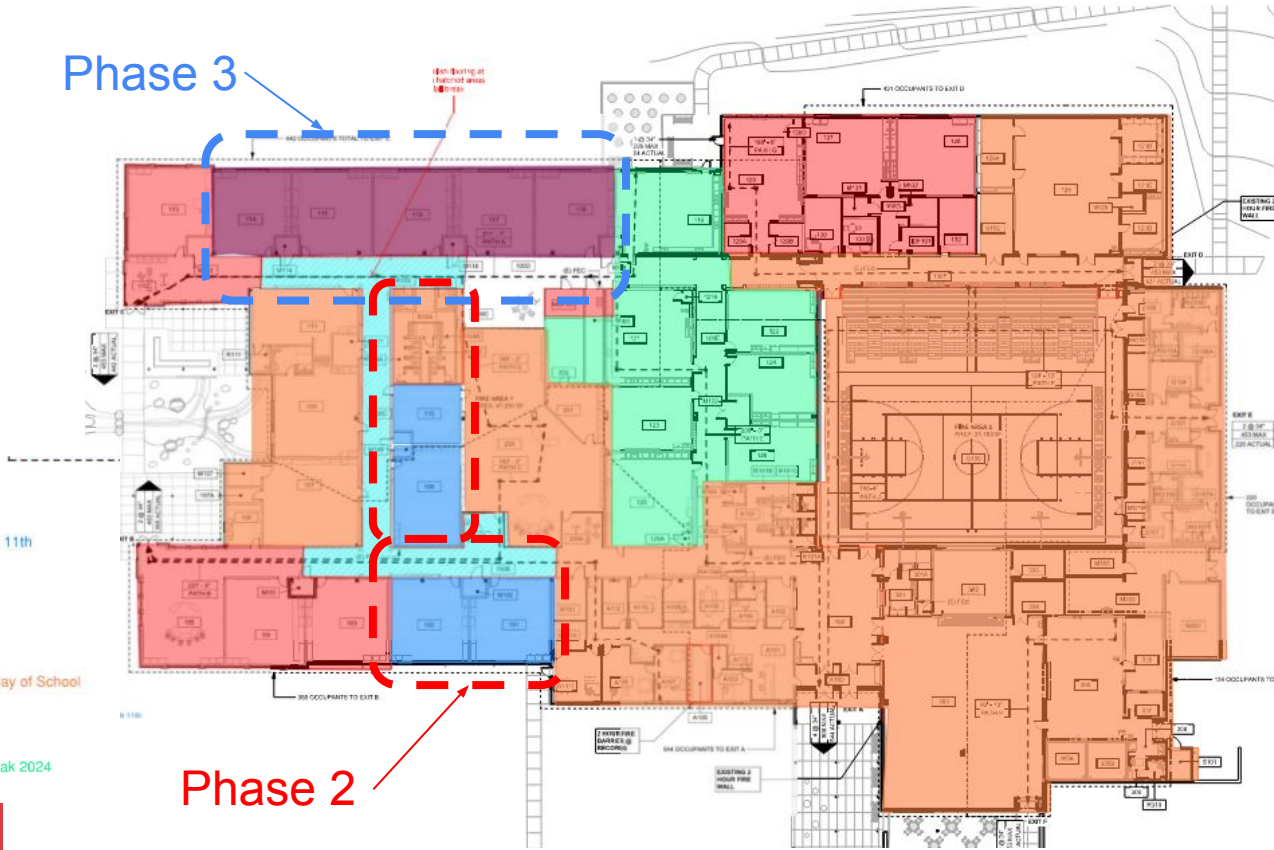

BC

MOVING FORWARD

Bernheim Middle School - Construction

Phase 2 Underway - Phase 3 - Begins Mid-March



studio kremer architects



Bernheim Middle School - Construction Exterior Views



studio kremer architects



MOVING FORWARD



Bernheim Middle School - Construction Exterior Views



studio kremer architects



MOVING FORWARD



Bernheim Middle School - Construction Exterior Views



studio kremer architects



BC

MOVING FORWARD

Board Consent Items

Art Room Sinks - Change Order #06 - Cost: \$19,954.20

Bernheim's administration requested new sinks be added to the Art room in lieu of reusing the two existing wall hung sinks. To match other art room renovations the design team specified stainless steel commercial tub sinks. Work can commence with trades already on site and avoid the added cost of mobilization and general conditions.

Art Room Closet Concrete Pad Removal - Change Order #07 - Cost: \$1,228.00

There is an existing slab that was installed for a demolished heat pump in the mechanical closet within the Art Room. There is no heat pump going back into that closet and it would be a more useful space if the pad is removed to allow shelving for storage.



studio kremer architects

Bernheim Middle School - Construction



MOVING FORWARD

Board Consent Items

Bernheim Middle School - DPO 8 IMI Credit

Calhoun currently has a DPO in place for IMI Concrete. However, over the holidays their plant shut down and Calhoun had to use Ernst to complete their scheduled concrete pours. This is a net zero change to the Contract Value. An alternate concrete vendor was utilized due to plant closures. This Credits the IMI DPO and adds the value to the Ernst Concrete DPO 40.

Bernheim Renovations- Test and Balance Contractor

Three proposals for Test and Balance Services for the Bernheim Middle School renovation were solicited. This scope of work includes testing and balancing the HVAC geothermal and domestic water systems. This work is critical for the proper performance of these systems and will be paid out of construction contingency funds.

The following companies submitted a quote:

Thermal Balance: \$25,530

Kahoe Air Balance: \$47,540

Synergy Test and Balance \$28,813

Scott Balch from CMTA recommends the use of Thermal Balance for the Bernheim Middle School project.



Bernheim Middle School - Construction

Board Consent Items

Upcoming changes at Classrooms

We are adjusting the STEAM Room Furniture Selection and layout to incorporate the Career Lab addition - we will have final cost adjustments for any architectural or furniture changes prepared for an upcoming Board Meeting.

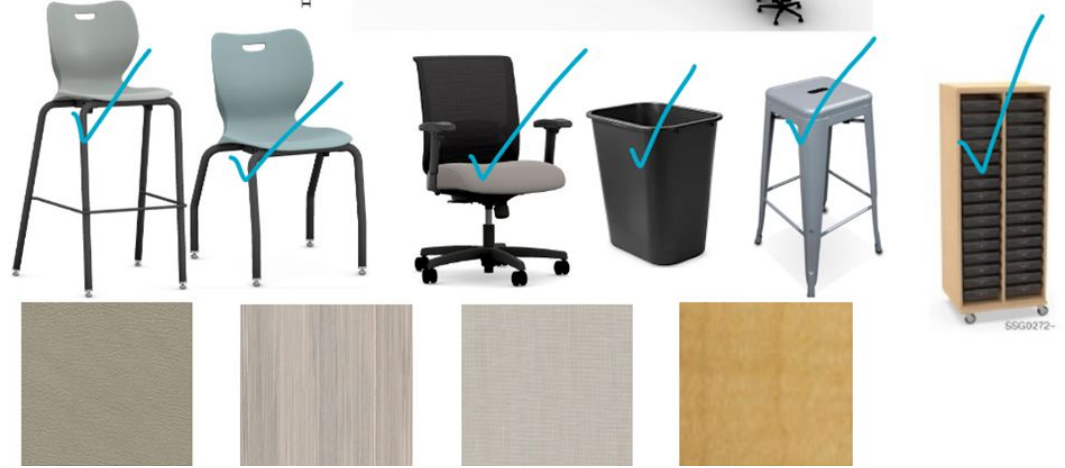
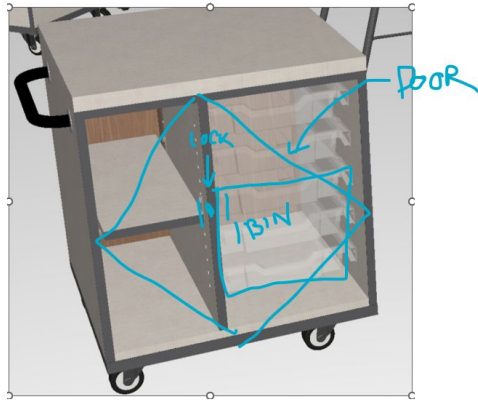
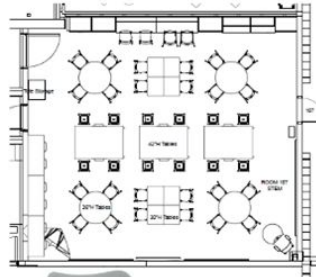

Bernheim Middle School - Construction



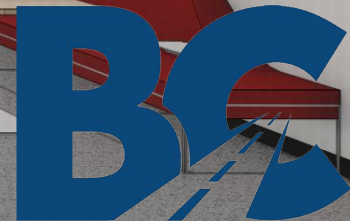

MOVING FORWARD

Bullitt East High School - Construction



studio kremer architects



TRADEMARK WILL NEED THIS FOR ACCESS DURING THE DURATION OF THE STORM INSTALLATION.
 TRADEMARK WOULD LIKE TO DESIGNATE THESE AREAS AS A NO WALKING AREA DURING OUR CONSTRUCTION ACTIVITIES

Temp Parking

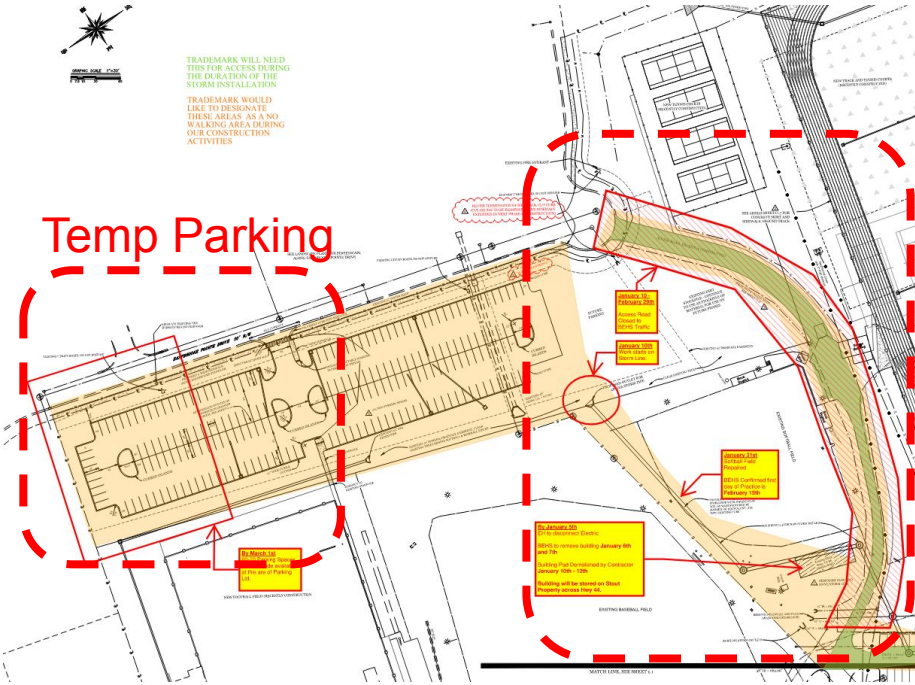

Access Road &
Softball Field Open

Utility Connections

GENERAL DEMOLITION NOTES:
 1. ALL DEMOLITION SHALL BE IN ACCORDANCE WITH THE CITY OF SEASIDE, CALIFORNIA, DEMOLITION ORDINANCE AND THE CALIFORNIA DEMOLITION ACT.
 2. ALL DEMOLITION SHALL BE COMPLETED BY THE DATE SPECIFIED IN THE CONTRACT.
 3. ALL DEMOLITION SHALL BE COMPLETED WITHIN THE SPECIFIED TIME FRAME.
 4. ALL DEMOLITION SHALL BE COMPLETED WITHIN THE SPECIFIED BUDGET.
 5. ALL DEMOLITION SHALL BE COMPLETED WITHIN THE SPECIFIED SAFETY REQUIREMENTS.
 6. ALL DEMOLITION SHALL BE COMPLETED WITHIN THE SPECIFIED ENVIRONMENTAL REQUIREMENTS.
 7. ALL DEMOLITION SHALL BE COMPLETED WITHIN THE SPECIFIED COMMUNITY REQUIREMENTS.
 8. ALL DEMOLITION SHALL BE COMPLETED WITHIN THE SPECIFIED LEGAL REQUIREMENTS.
 9. ALL DEMOLITION SHALL BE COMPLETED WITHIN THE SPECIFIED REGULATORY REQUIREMENTS.
 10. ALL DEMOLITION SHALL BE COMPLETED WITHIN THE SPECIFIED CONTRACT REQUIREMENTS.

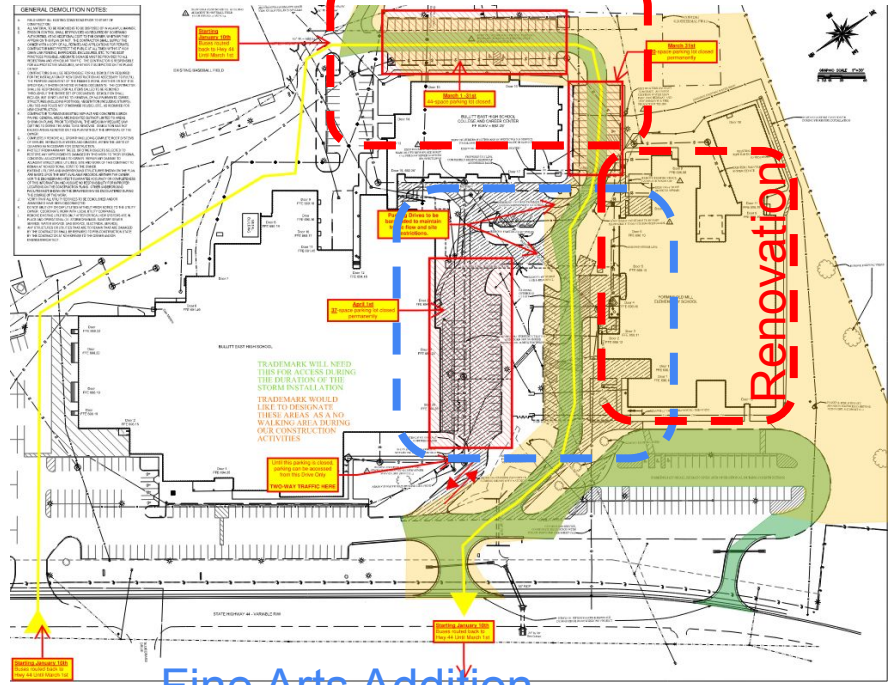

Fine Arts Addition
Starts May 1st



Bullitt East High School
Construction



MOVING FORWARD

Board Consent Items

BEHS Fine Arts Addition- Change Order 1- Technology and AV Bid Package | Cost: \$ 461,336.16

Following discussion with the Board post-bid as well as the discussion at the February 5th Work Session- we are presenting the Technology and AV Change Order with Business Cabling and ADT performing work documented in the Bid Package #3 Construction Documents. This is a change order to the General Construction contract with EH Construction.

This value was added to the Contingency Line Item of the revised BG-1.

BEHS Fine Arts Addition- Change Order 2- Demolition of Existing Utility Pole | Cost: \$ 991.92

An existing utility pole needed to be removed to install the new 8" water main for the Fine Arts project. Work needed to commence ahead of formal board approval to allow the schedule to continue as required for campus traffic and building phasing. Work was approved by District Leadership due to the value being below the \$7,500 threshold. Additional details are reflected in the attached RFI #2.

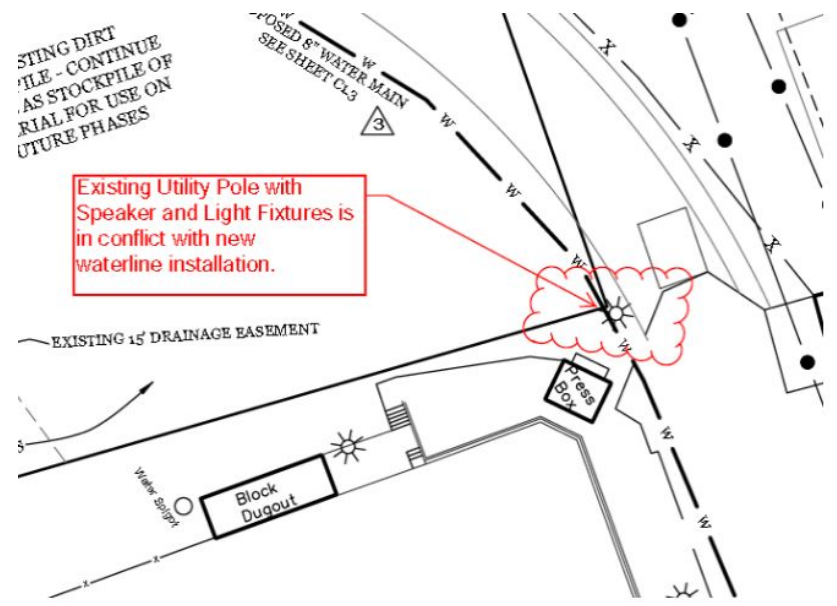

**Bullitt East High School
Construction**





Bullitt East High School
Construction





studio kremer architects

Bullitt East High School Construction



MOVING FORWARD