

ALL RIGHTS RESERVED
THIS DOCUMENT IS THE PROPERTY OF CLOTFELTER-SAMOKAR, INC. IT IS TO BE USED ONLY FOR THE PROJECT AND SITE SPECIFICALLY IDENTIFIED HEREON. NO REPRODUCTION OR TRANSMISSION OF THIS DOCUMENT IS PERMITTED WITHOUT WRITTEN PERMISSION OF CLOTFELTER-SAMOKAR, INC.

Clotfelter-Samokar, Inc.
1000 Progress Road
Bellefonte, Kentucky 40007
606.373.3700

Clotfelter-SAMOKAR
Architecture | Engineering | Interiors | Landscapes | Planning

REVISION SCHEDULE

NO.	DESCRIPTION	DATE
-----	-------------	------

GARRARD CO. HIGH SCHOOL - FINAL PHASE
BIDDING PHASE 2
SITE IMPROVEMENTS
599 INDUSTRY RD., LANCASTER, KY 40444
FOR THE
GARRARD COUNTY BOARD OF EDUCATION

SHEET
C002
DATE: 08/25/22
JOB#: 2113
DRAWN: BRB / RAL
CHECKED: DMS
MASTER SITE PLAN

CONTROL POINT (CP) SCHEDULE

CP #	SURVEY COORDINATES 'X', 'Y' & 'Z'	CP LOCATION
CP #5000	X: 1981807.07 Y: 2105244.76 Z: 967.30	IRON PIN W/ PLASTIC CAP
CP #5018	X: 1981353.04 Y: 2106256.67 Z: 999.07	IRON PIN W/ ALUM. CAP IN CONC.
CP #5019	X: 1981613.64 Y: 2104469.93 Z: 971.90	IRON PIN W/ ALUM. CAP IN CONC.
CP #5020	X: 1982257.04 Y: 2104230.05 Z: 961.24	IRON PIN W/ ALUM. CAP IN CONC.
CP #5021	X: 1982556.56 Y: 2104533.72 Z: 962.74	IRON PIN W/ ALUM. CAP IN CONC.
CP #5022	X: 1982283.91 Y: 2104684.62 Z: 964.46	IRON PIN W/ ALUM. CAP IN CONC.
CP #5023	X: 1981875.94 Y: 2105587.82 Z: 979.51	IRON PIN W/ ALUM. CAP IN CONC.

FINISHED FLOOR ELEVATION (FFE) CHART - F.R.O.

SITE ELEV.	ARCH. PLAN ELEV.	STRUC. PLAN ELEV.	FLOOR DESCRIPTION
956.25	0' - 0"	0' - 0"	GRANDSTAND BUILDING 'A'
956.25	0' - 0"	0' - 0"	GRANDSTAND BUILDING 'B'
957.25	0' - 0"	0' - 0"	BASEBALL LOCKER ROOM
958.15	0' - 0"	0' - 0"	BASEBALL PRESSBOX
953.25	0' - 0"	0' - 0"	SOFTBALL LOCKER ROOM
955.40	0' - 0"	0' - 0"	SOFTBALL PRESSBOX
953.00	0' - 0"	0' - 0"	STORAGE BUILDING

GENERAL NOTES:

- REFER TO C001 FOR GENERAL PROJECT NOTES.
- PROJECT LIMITS SHOWN ARE APPROXIMATE. UTILITY WORK MAY OCCUR OUTSIDE THESE LIMITS. REFER TO PLANS AND SPECIFICATIONS FOR ADDITIONAL INFORMATION.
- ATHLETIC FIELD IMPROVEMENTS ARE SHOWN FOR REFERENCE ONLY AND ARE PART OF FUTURE PHASES OF WORK TO BE BID AT LATER DATE. REFER TO THE SITE STAGING AND SEQUENCING PLAN C003 FOR ADDITIONAL INFORMATION.

SOIL BORROW AND WASTE AREAS:

- BORROW SOILS MAY BE TAKEN FROM THESE AREAS. EXCESS SOILS MAY BE WASTED IN THESE AREAS. MAXIMUM SLOPE OF TIE INS SHALL NOT EXCEED 1V : 4H. ROCK MAY BE WASTED IN THESE AREAS, BUT SHALL BE MORE THAN 24 INCHES BELOW THE FINISHED GRADES OF THE FINISHED LAWN AREAS. WASTED ROCK MUST BE INSTALLED AS SHOT ROCK AS OUTLINED IN THE SPECIFICATIONS. MINIMUM FINISHED GRADE SLOPES SHALL NOT BE LESS THAN 2% OR 1' IN 50'. DO NOT BORROW OR FILL INSIDE THE UTILITY LINE EASEMENTS EXCEPT AS SHOWN ON THE GRADING PLANS. CONTRACTOR SHALL PROVIDE A PLAN INDICATING FINISHED GRADES FOR THESE AREAS. ARCHITECT SHALL REVIEW ALL PROPOSED FINISHED GRADES FOR THE BORROW/WASTE AREAS PRIOR TO USE. DO NOT HAUL IN EARTH FILL TO ACHIEVE SHOWN GRADES IF THERE IS NOT ENOUGH WASTE EARTH FROM MASS EARTH MOVING OPERATIONS.
- SHOT ROCK, IF WASTED IN THIS AREA, SHALL NOT BE PLACED ABOVE ELEVATION 994.00. MAINTAIN A MINIMUM OF 2'-0" OF SOIL COVER.

PHASING NOTES:

- REFER TO THE PLANS FOR SITE IMPROVEMENTS THAT ARE APART OF PHASE 2 WORK.
- REFER TO THE PLANS FOR SITE IMPROVEMENTS THAT ARE SHOWN FOR REFERENCE ONLY (ALSO NOTED AS F.R.O.) TO ASSIST WITH ESTABLISHING SUBGRADE ELEVATIONS.
- STRIP AND STOCKPILE ALL TOPSOIL FROM THE PROJECT AREA. NOT ALL AREAS WILL BE STRIPPED AT THE START OF CONSTRUCTION. DO NOT HAUL OFF SITE. TOPSOIL PLACEMENT WILL NOT BE APART OF PHASE 2 EXCEPT WHERE NOTED ON THE PLANS.

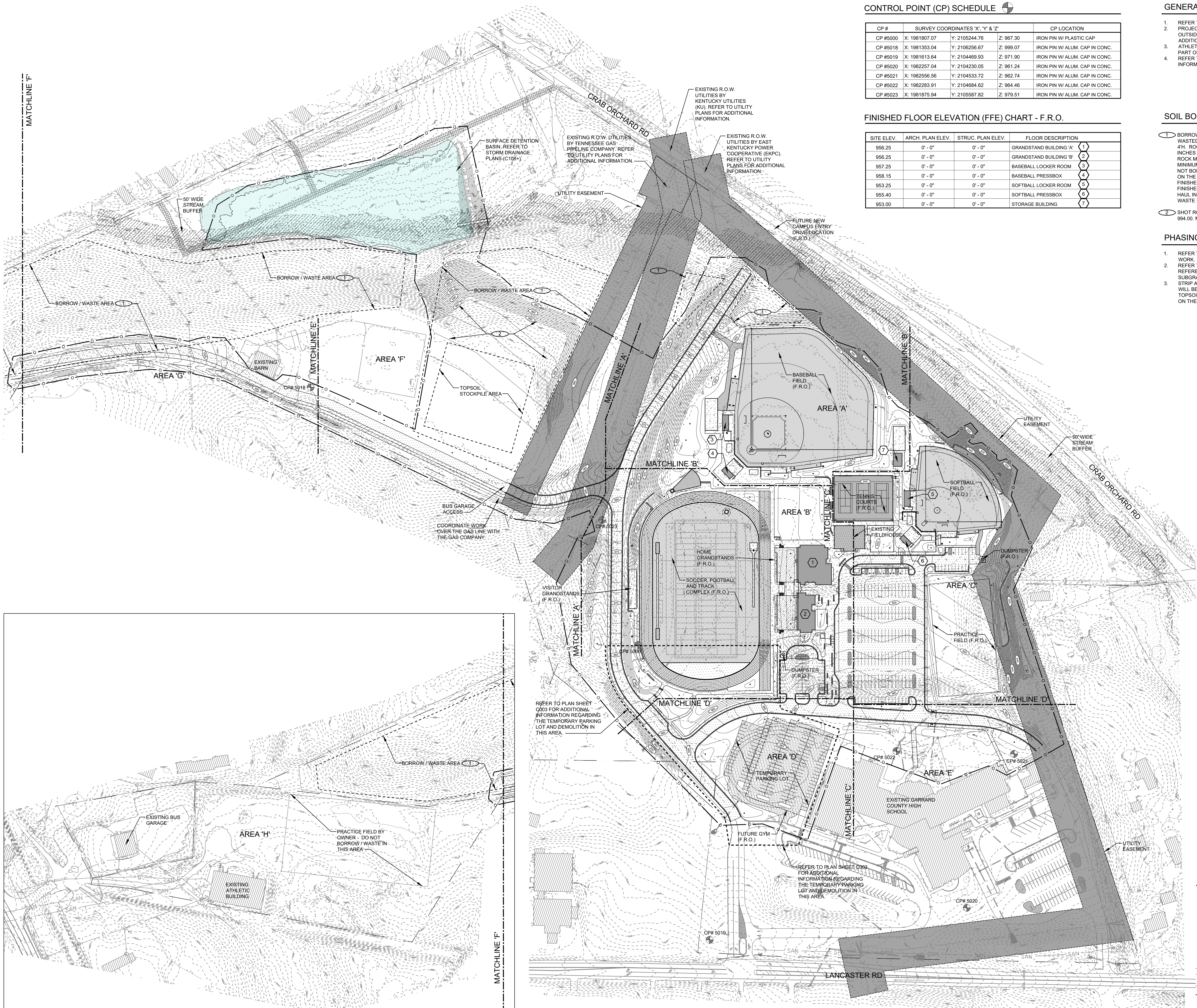

MASTER SITE PLAN
SCALE: 1"=100'-0"

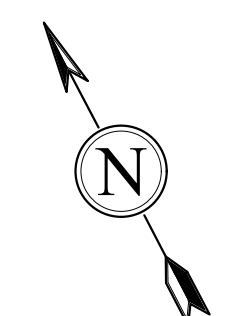
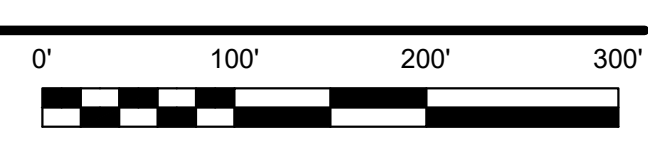

PLAN LEGEND

[Symbol]	NEW BUILDING (F.R.O.)	[Symbol]	ASPHALT PAVEMENT (F.R.O.)
[Symbol]	CONCRETE WALKS/PAVEMENT (F.R.O.)	[Symbol]	GRAVEL (F.R.O.)
[Symbol]	SYNTHETIC TURF (F.R.O.)	[Symbol]	BASEBALL/SOFTBALL FIELD (F.R.O.)
[Symbol]	TEMPORARY PARKING LOT	[Symbol]	SLOPE DIRECTION
[Symbol]	EXISTING CONTOURS	[Symbol]	STORM DRAINAGE STRUCTURES
[Symbol]	PROPOSED CONTOURS	[Symbol]	
[Symbol]	EXISTING SPOT ELEVATIONS	[Symbol]	
[Symbol]	PROPOSED SPOT ELEVATIONS	[Symbol]	