

**WOODFORD COUNTY BOARD OF EDUCATION  
AGENDA ITEM**

**ITEM #:**           **DATE:** September 25, 2023

**TOPIC/TITLE:** Phase 2 Change Order #1

**PRESENTER:** Shane Smith

**ORIGIN:**

- TOPIC PRESENTED FOR INFORMATION ONLY (No board action required.)
  - ACTION REQUESTED AT THIS MEETING
  - ITEM IS ON THE CONSENT AGENDA FOR APPROVAL
  - ACTION REQUESTED AT FUTURE MEETING:            (DATE)
  - BOARD REVIEW REQUIRED BY
- 
- STATE OR FEDERAL LAW OR REGULATION
  - BOARD OF EDUCATION POLICY
  - OTHER:

**PREVIOUS REVIEW, DISCUSSION OR ACTION:**

- NO PREVIOUS BOARD REVIEW, DISCUSSION OR ACTION
  - PREVIOUS REVIEW OR ACTION
- 
- DATE:
  - ACTION:

**BACKGROUND INFORMATION:**

**SUMMARY OF MAJOR ELEMENTS:**

Change order #1 for the phase 2 athletic field and track. This is a change order to move the track/throw events. The change order increases the cost of the project by \$75,493.26. See the WCHS Phase 2 Change Order #01 Summary.

**IMPACT ON RESOURCES:**

**TIMETABLE FOR FURTHER REVIEW OR ACTION:**

**SUPERINTENDENT'S RECOMMENDATION:**  Recommended             Not Recommended

*Danny Adkins Jr.*

---

## WCHS Phase 2: Change Order #01 Summary

### 1.) (60) Additional Days

- (10) additional days for additional work scope.
- (50) additional days for design/quote time.
- Revised Substantial Completion 5/15/2024.
- Allows finishes to take place in Spring 2024, eliminating them from 2023/2024 winter weather exposure.

### 2.) PR #01- Throws and Dzone

#### 01-01: Independent Contractors Distributors, Inc.

- Total Cost Add: \$27,548.05

#### 02-01: Rising Sun Developing

- Total Cost Deduct: -(\$39,556.94)

#### 03-01: Rising Sun Developing

- Total Cost Add: \$87,502.15

**CO#01 TOTAL COST ADD = \$75,493.26**

---

DATE: 06/21/2023 PR #: PR 001  
TO: Clay Ratliff – Trace Greek Construction RE: Woodford County Board of Education  
Versailles, Kentucky  
BG 19-353  
RTA 1916 Phase 2

---

*Please submit an itemized quotation for changes in the Contract Sum and/or Time incidental to proposed modifications to the Contract Documents described therein.*

THIS IS NOT A CHANGE ORDER NOR A DIRECTION TO PROCEED WITH THE WORK DESCRIBED HEREIN.

---

Please provide labor and material pricing breakdown for review.

DESCRIPTION:

1. Sheet SA1.2 – Site Development and Layout Plan
  - a) Modify alignment of jumps, extents of concrete pavement at jumps, and extents of track cushion surface as indicated.
  - b) Relocate throwing events to outside of the track area as indicated.
  - c) Extend synthetic turf surfacing in D-Zone as indicated.
2. Sheet SA1.3 – Site Development and Layout Plan
  - a) Add sheet to construction set.
  - b) Install throws, concrete pads, and athletic equipment as indicated.
3. Sheet SA2.1 – Site Grading and Drainage Plan
  - a) Modify structure schedule as indicated.
  - b) Modify grading drainage in jump area as indicated.
  - c) Modify grading drainage in the plan east D-Zone as indicated.
  - d) Modify grading and drainage in the relocated throw area as indicated.
4. Sheet SA2.2 – Site Grading Plan
  - a) Modify grading in the jump area as indicated. Grading to be coordinated with changes to the track cushion surface extents as illustrated in SA1.2.
  - b) Modify grading in the plan east D-Zone as indicated.
  - c) Modify grading on the plan east side of the track as indicated.
5. Sheet SA2.3 – Site Drainage Plan
  - a) Modify drainage in the jump area as indicated.
  - b) Modify drainage in the plan west D-Zone as indicated.
  - c) Modify drainage in the plan east D-Zone as indicated.
6. Sheet SA2.4 – Site Grading Plan
  - a) Add sheet to the construction set.
  - b) Add sinkhole remediation as indicated.
  - c) Adjust grading for modified throw area as indicated.

Attachments:

SA1.2, SA1.3, SA2.1, SA2.2, SA2.3, SA2.4

---

Prepared By:

Chandler Sergent, AIA Associate

/cs

c: Sarah Lamere, Michael Hughes – RTA  
Clay Ratliff -Trace Creek  
Shane Smith – Woodford County Schools  
File 1916-4B  
PR 001

**GENERAL SITE NOTES**

1. THE PAVING SHALL BE PERFORMED IN ACCORDANCE WITH THE STANDARD SPECIFICATIONS FOR PUBLIC WORKS, EDITION 2003, WITH THE LATEST REVISIONS.
2. THE CONTRACTOR SHALL VERIFY ALL EXISTING UTILITIES AND RECORD THEM ON THE SITE PLAN.
3. THE CONTRACTOR SHALL VERIFY ALL EXISTING ELEVATIONS AND RECORD THEM ON THE SITE PLAN.
4. THE CONTRACTOR SHALL VERIFY ALL EXISTING DIMENSIONS AND RECORD THEM ON THE SITE PLAN.
5. THE CONTRACTOR SHALL VERIFY ALL EXISTING CONDITIONS AND RECORD THEM ON THE SITE PLAN.
6. THE CONTRACTOR SHALL VERIFY ALL EXISTING CONDITIONS AND RECORD THEM ON THE SITE PLAN.
7. THE CONTRACTOR SHALL VERIFY ALL EXISTING CONDITIONS AND RECORD THEM ON THE SITE PLAN.
8. THE CONTRACTOR SHALL VERIFY ALL EXISTING CONDITIONS AND RECORD THEM ON THE SITE PLAN.
9. THE CONTRACTOR SHALL VERIFY ALL EXISTING CONDITIONS AND RECORD THEM ON THE SITE PLAN.
10. THE CONTRACTOR SHALL VERIFY ALL EXISTING CONDITIONS AND RECORD THEM ON THE SITE PLAN.

**LANDSCAPE TAGS**

1. TREE
2. SHRUB
3. PLANT
4. ROCK
5. WATER
6. LIGHT
7. SIGN
8. FURNITURE
9. OTHER

**LEGEND**

CONCRETE PAVEMENT  
 ASPHALT PAVEMENT  
 ASPHALT GRAD  
 GRAVEL  
 SAND  
 SOFT SAND  
 SOFT SAND WITH STABILIZER  
 SOFT SAND WITH STABILIZER AND GEOTEXTILE  
 SOFT SAND WITH STABILIZER AND GEOTEXTILE AND CURB  
 SOFT SAND WITH STABILIZER AND GEOTEXTILE AND CURB AND FINISH

**SITE DEVELOPMENT TAGS**

1. CONCRETE PAVEMENT
2. ASPHALT PAVEMENT
3. ASPHALT GRAD
4. GRAVEL
5. SAND
6. SOFT SAND
7. SOFT SAND WITH STABILIZER
8. SOFT SAND WITH STABILIZER AND GEOTEXTILE
9. SOFT SAND WITH STABILIZER AND GEOTEXTILE AND CURB
10. SOFT SAND WITH STABILIZER AND GEOTEXTILE AND CURB AND FINISH
11. CONCRETE CURB
12. ASPHALT CURB
13. ASPHALT GRAD
14. GRAVEL
15. SAND
16. SOFT SAND
17. SOFT SAND WITH STABILIZER
18. SOFT SAND WITH STABILIZER AND GEOTEXTILE
19. SOFT SAND WITH STABILIZER AND GEOTEXTILE AND CURB
20. SOFT SAND WITH STABILIZER AND GEOTEXTILE AND CURB AND FINISH
21. CONCRETE PAVEMENT
22. ASPHALT PAVEMENT
23. ASPHALT GRAD
24. GRAVEL
25. SAND
26. SOFT SAND
27. SOFT SAND WITH STABILIZER
28. SOFT SAND WITH STABILIZER AND GEOTEXTILE
29. SOFT SAND WITH STABILIZER AND GEOTEXTILE AND CURB
30. SOFT SAND WITH STABILIZER AND GEOTEXTILE AND CURB AND FINISH
31. CONCRETE PAVEMENT
32. ASPHALT PAVEMENT
33. ASPHALT GRAD
34. GRAVEL
35. SAND
36. SOFT SAND
37. SOFT SAND WITH STABILIZER
38. SOFT SAND WITH STABILIZER AND GEOTEXTILE
39. SOFT SAND WITH STABILIZER AND GEOTEXTILE AND CURB
40. SOFT SAND WITH STABILIZER AND GEOTEXTILE AND CURB AND FINISH
41. CONCRETE PAVEMENT
42. ASPHALT PAVEMENT
43. ASPHALT GRAD
44. GRAVEL
45. SAND
46. SOFT SAND
47. SOFT SAND WITH STABILIZER
48. SOFT SAND WITH STABILIZER AND GEOTEXTILE
49. SOFT SAND WITH STABILIZER AND GEOTEXTILE AND CURB
50. SOFT SAND WITH STABILIZER AND GEOTEXTILE AND CURB AND FINISH

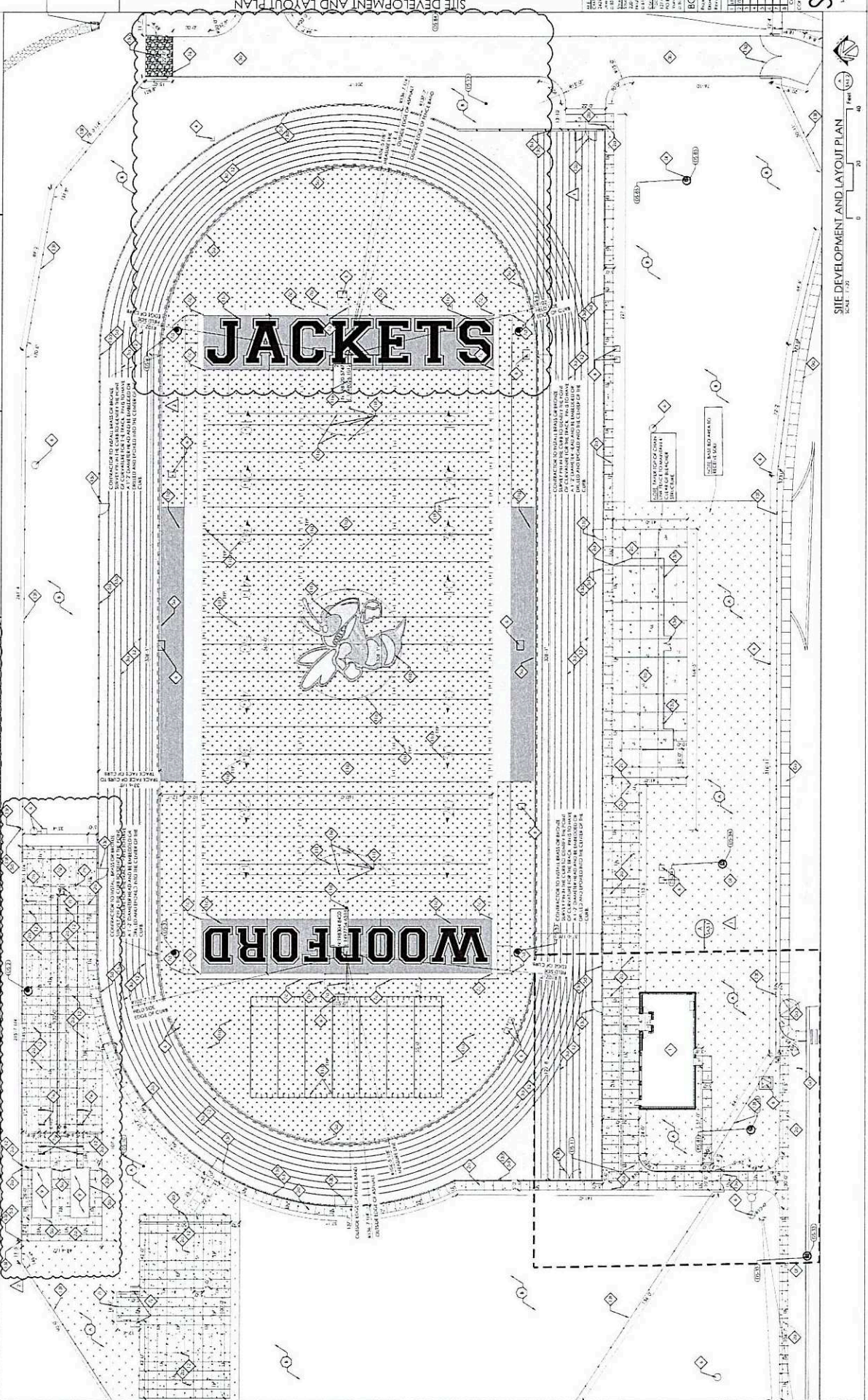

**SAI.2**

DATE: 11/15/2011  
 TIME: 10:00 AM  
 PROJECT: WOODFORD COUNTY HIGH SCHOOL PHASE 2 PRACTICE FIELD & TRACK  
 DRAWING: SITE DEVELOPMENT AND LAYOUT PLAN  
 SHEET: SAI.2  
 TOTAL SHEETS: 20  
 CONTRACTOR: [REDACTED]  
 ARCHITECT: [REDACTED]

NO.	REVISION	DATE
1	ISSUED FOR PERMIT	11/15/2011
2	ISSUED FOR PERMIT	11/15/2011
3	ISSUED FOR PERMIT	11/15/2011
4	ISSUED FOR PERMIT	11/15/2011
5	ISSUED FOR PERMIT	11/15/2011
6	ISSUED FOR PERMIT	11/15/2011
7	ISSUED FOR PERMIT	11/15/2011
8	ISSUED FOR PERMIT	11/15/2011
9	ISSUED FOR PERMIT	11/15/2011
10	ISSUED FOR PERMIT	11/15/2011

WOODFORD COUNTY BOARD OF EDUCATION  
 330 Pison Pike, Kentucky 40383  
 WOODFORD COUNTY HIGH SCHOOL PHASE 2 PRACTICE FIELD & TRACK  
 SITE DEVELOPMENT AND LAYOUT PLAN  
 SCALE: 1/4" = 1'-0"

**GENERAL SITE NOTES**

1. THE SITE SHALL BE PREPARED IN ACCORDANCE WITH THE FOLLOWING REQUIREMENTS:
2. THE CONTRACTOR SHALL BE RESPONSIBLE FOR OBTAINING ALL NECESSARY PERMITS AND APPROVALS FROM THE LOCAL AND STATE AUTHORITIES.
3. THE ARCHITECT AND CONTRACTOR SHALL CONSULT WITH THE LOCAL AND STATE AUTHORITIES TO OBTAIN A COMPLETE UNDERSTANDING OF THE PROJECT'S REGULATORY ENVIRONMENT AND ALL APPLICABLE REGULATIONS AND REQUIREMENTS.
4. THE CONTRACTOR SHALL BE RESPONSIBLE FOR OBTAINING ALL NECESSARY PERMITS AND APPROVALS FROM THE LOCAL AND STATE AUTHORITIES.
5. THE CONTRACTOR SHALL BE RESPONSIBLE FOR OBTAINING ALL NECESSARY PERMITS AND APPROVALS FROM THE LOCAL AND STATE AUTHORITIES.
6. THE CONTRACTOR SHALL BE RESPONSIBLE FOR OBTAINING ALL NECESSARY PERMITS AND APPROVALS FROM THE LOCAL AND STATE AUTHORITIES.

**LANDSCAPE TAGS**

- 1. CONCRETE PAVEMENT
- 2. ASPHALT PAVEMENT
- 3. GRAVEL DRIVEWAY
- 4. GRASS
- 5. MULCH
- 6. SOIL



**SITE DEVELOPMENT TAGS**

1. CONCRETE PAVEMENT
2. ASPHALT PAVEMENT
3. GRAVEL DRIVEWAY
4. GRASS
5. MULCH
6. SOIL

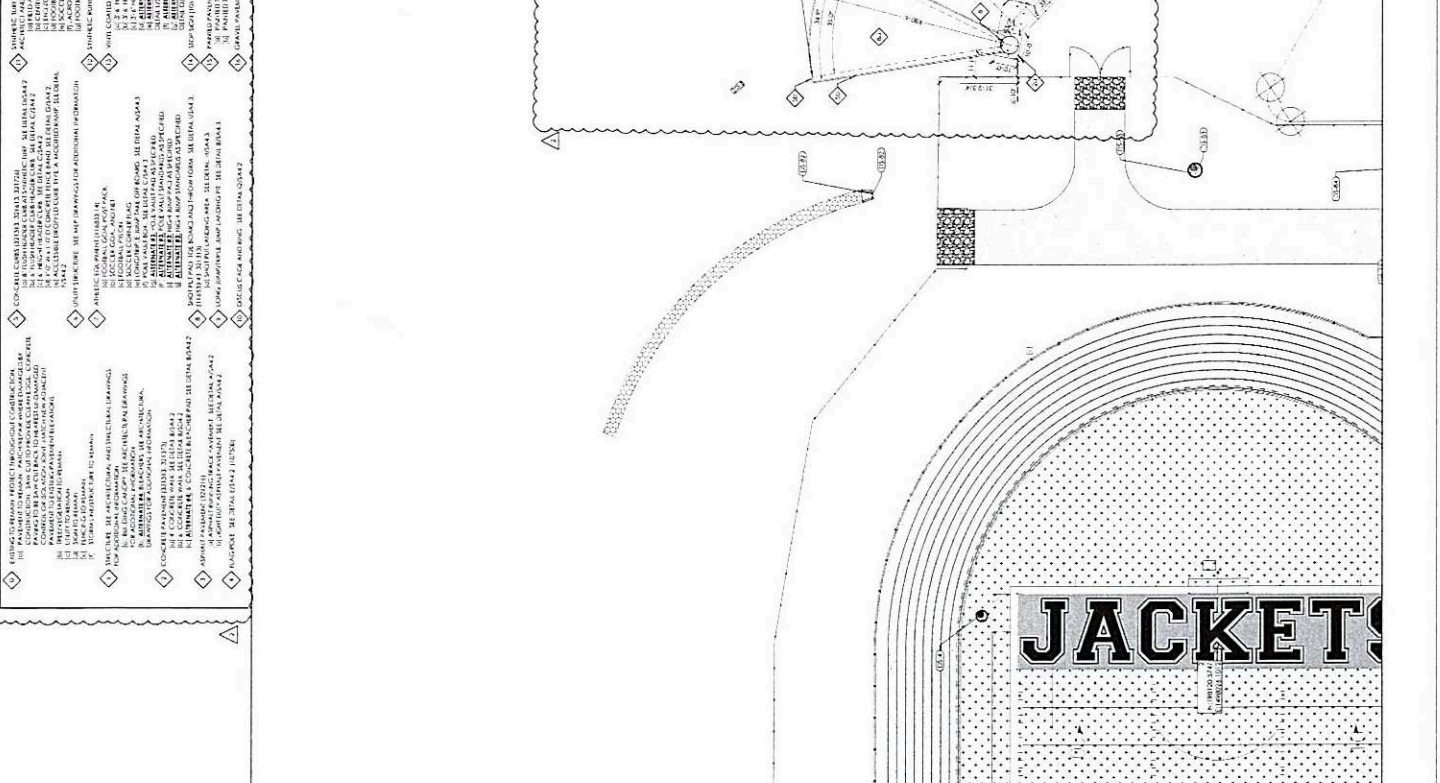

**SITE DEVELOPMENT AND LAYOUT PLAN**  
SCALE: 1" = 20'

**GENERAL SITE NOTES**

1. THE SITE SHALL BE PREPARED AND CONSTRUCTED IN ACCORDANCE WITH THE SPECIFICATIONS AND STANDARDS SET FORTH IN THE URBAN DRAINAGE DESIGN HANDBOOK, 2ND EDITION, CHAPTER 10.
2. THE GENERAL SHALL PROVIDE ALL NECESSARY UTILITY LOCATIONS, INCLUDING BUT NOT LIMITED TO WATER, SANITARY, AND ELECTRICAL.
3. THE ARCHITECT AND ENGINEER SHALL PROVIDE ALL NECESSARY UTILITY LOCATIONS, INCLUDING BUT NOT LIMITED TO WATER, SANITARY, AND ELECTRICAL.
4. THE ARCHITECT AND ENGINEER SHALL PROVIDE ALL NECESSARY UTILITY LOCATIONS, INCLUDING BUT NOT LIMITED TO WATER, SANITARY, AND ELECTRICAL.

**LEGEND**

(S1) REMOVED STRUCTURE

(S2) REMOVED STRUCTURE WITH EXISTING FOUNDATION

(S3) REMOVED STRUCTURE WITH EXISTING FOUNDATION AND REMOVED CONCRETE

(S4) REMOVED STRUCTURE WITH EXISTING FOUNDATION AND REMOVED CONCRETE AND REBAR

**SITE STORM DRAINAGE NOTES**

1. DRAINAGE SWALS SHALL BE LOCATED AT THE OUTER PERIMETER OF THE SITE. ALL SWALS SHALL BE 6' WIDE WITH A 2% SLOPE TOWARD THE STREET. SWALS SHALL BE CONCRETE WITH 18" HIGH CURBS.
2. DRAINAGE SWALS SHALL BE LOCATED AT THE OUTER PERIMETER OF THE SITE. ALL SWALS SHALL BE 6' WIDE WITH A 2% SLOPE TOWARD THE STREET. SWALS SHALL BE CONCRETE WITH 18" HIGH CURBS.
3. DRAINAGE SWALS SHALL BE LOCATED AT THE OUTER PERIMETER OF THE SITE. ALL SWALS SHALL BE 6' WIDE WITH A 2% SLOPE TOWARD THE STREET. SWALS SHALL BE CONCRETE WITH 18" HIGH CURBS.

**GENERAL SITE NOTES**

1. THE GENERAL SHALL PROVIDE ALL NECESSARY UTILITY LOCATIONS, INCLUDING BUT NOT LIMITED TO WATER, SANITARY, AND ELECTRICAL.

2. THE ARCHITECT AND ENGINEER SHALL PROVIDE ALL NECESSARY UTILITY LOCATIONS, INCLUDING BUT NOT LIMITED TO WATER, SANITARY, AND ELECTRICAL.

**WOODFORD COUNTY BOARD OF EDUCATION**

**WOODFORD COUNTY HIGH SCHOOL PHASE 2 PRACTICE FIELD & TRACK**

**SITE GRADING & DRAINAGE PLAN**

**WOODFORD COUNTY BOARD OF EDUCATION**

**WOODFORD COUNTY HIGH SCHOOL PHASE 2 PRACTICE FIELD & TRACK**

**SITE GRADING & DRAINAGE PLAN**

330 PICHON PIKE KENTUCKY 40381

**STRUCTURE SCHEDULE**

ITEM NO.	MARKET TYPE	CONCRETE TYPE	FINISH	REMARKS
001	CONCRETE	CONCRETE	18" HIGH CURB	WOODFORD COUNTY HIGH SCHOOL PHASE 2 PRACTICE FIELD & TRACK
002	CONCRETE	CONCRETE	18" HIGH CURB	WOODFORD COUNTY HIGH SCHOOL PHASE 2 PRACTICE FIELD & TRACK
003	CONCRETE	CONCRETE	18" HIGH CURB	WOODFORD COUNTY HIGH SCHOOL PHASE 2 PRACTICE FIELD & TRACK
004	CONCRETE	CONCRETE	18" HIGH CURB	WOODFORD COUNTY HIGH SCHOOL PHASE 2 PRACTICE FIELD & TRACK
005	CONCRETE	CONCRETE	18" HIGH CURB	WOODFORD COUNTY HIGH SCHOOL PHASE 2 PRACTICE FIELD & TRACK
006	CONCRETE	CONCRETE	18" HIGH CURB	WOODFORD COUNTY HIGH SCHOOL PHASE 2 PRACTICE FIELD & TRACK
007	CONCRETE	CONCRETE	18" HIGH CURB	WOODFORD COUNTY HIGH SCHOOL PHASE 2 PRACTICE FIELD & TRACK
008	CONCRETE	CONCRETE	18" HIGH CURB	WOODFORD COUNTY HIGH SCHOOL PHASE 2 PRACTICE FIELD & TRACK
009	CONCRETE	CONCRETE	18" HIGH CURB	WOODFORD COUNTY HIGH SCHOOL PHASE 2 PRACTICE FIELD & TRACK
010	CONCRETE	CONCRETE	18" HIGH CURB	WOODFORD COUNTY HIGH SCHOOL PHASE 2 PRACTICE FIELD & TRACK
011	CONCRETE	CONCRETE	18" HIGH CURB	WOODFORD COUNTY HIGH SCHOOL PHASE 2 PRACTICE FIELD & TRACK
012	CONCRETE	CONCRETE	18" HIGH CURB	WOODFORD COUNTY HIGH SCHOOL PHASE 2 PRACTICE FIELD & TRACK
013	CONCRETE	CONCRETE	18" HIGH CURB	WOODFORD COUNTY HIGH SCHOOL PHASE 2 PRACTICE FIELD & TRACK
014	CONCRETE	CONCRETE	18" HIGH CURB	WOODFORD COUNTY HIGH SCHOOL PHASE 2 PRACTICE FIELD & TRACK

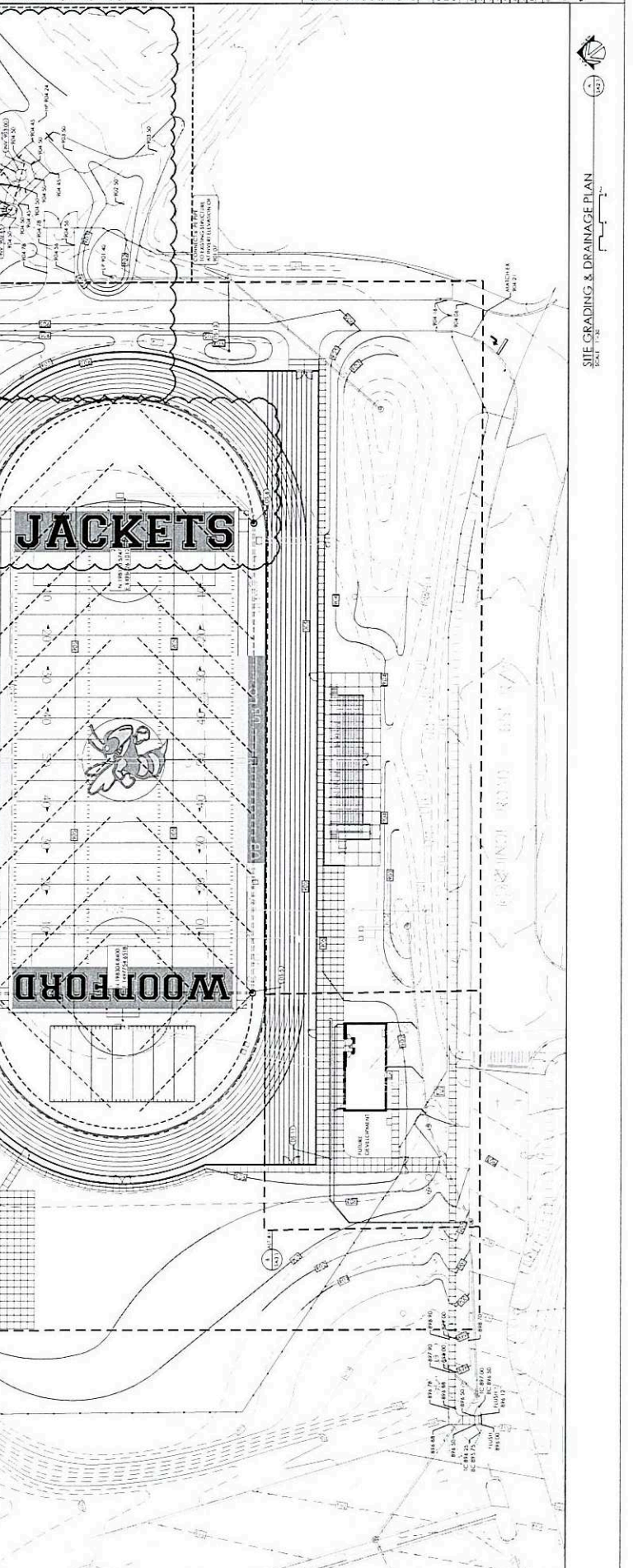

**SITE GRADING NOTES**

1. THE CONTRACTOR SHALL VERIFY ELEVATIONS AND ACTUAL DEPTH OF ALL EXISTING FOUNDATIONS, UTILITIES, AND OTHER STRUCTURES. VERIFY ALL ELEVATIONS AND ACTUAL DEPTHS OF ALL EXISTING FOUNDATIONS, UTILITIES, AND OTHER STRUCTURES.
2. ANY EXISTING FOUNDATIONS SHALL BE REINFORCED AND STRENGTHENED TO SUPPORT THE PROPOSED FOUNDATION. ANY EXISTING FOUNDATIONS SHALL BE REINFORCED AND STRENGTHENED TO SUPPORT THE PROPOSED FOUNDATION.
3. ALL EXISTING FOUNDATIONS SHALL BE REINFORCED AND STRENGTHENED TO SUPPORT THE PROPOSED FOUNDATION. ANY EXISTING FOUNDATIONS SHALL BE REINFORCED AND STRENGTHENED TO SUPPORT THE PROPOSED FOUNDATION.
4. ALL EXISTING FOUNDATIONS SHALL BE REINFORCED AND STRENGTHENED TO SUPPORT THE PROPOSED FOUNDATION. ANY EXISTING FOUNDATIONS SHALL BE REINFORCED AND STRENGTHENED TO SUPPORT THE PROPOSED FOUNDATION.
5. ALL EXISTING FOUNDATIONS SHALL BE REINFORCED AND STRENGTHENED TO SUPPORT THE PROPOSED FOUNDATION. ANY EXISTING FOUNDATIONS SHALL BE REINFORCED AND STRENGTHENED TO SUPPORT THE PROPOSED FOUNDATION.
6. ALL EXISTING FOUNDATIONS SHALL BE REINFORCED AND STRENGTHENED TO SUPPORT THE PROPOSED FOUNDATION. ANY EXISTING FOUNDATIONS SHALL BE REINFORCED AND STRENGTHENED TO SUPPORT THE PROPOSED FOUNDATION.
7. ALL EXISTING FOUNDATIONS SHALL BE REINFORCED AND STRENGTHENED TO SUPPORT THE PROPOSED FOUNDATION. ANY EXISTING FOUNDATIONS SHALL BE REINFORCED AND STRENGTHENED TO SUPPORT THE PROPOSED FOUNDATION.
8. ALL EXISTING FOUNDATIONS SHALL BE REINFORCED AND STRENGTHENED TO SUPPORT THE PROPOSED FOUNDATION. ANY EXISTING FOUNDATIONS SHALL BE REINFORCED AND STRENGTHENED TO SUPPORT THE PROPOSED FOUNDATION.
9. ALL EXISTING FOUNDATIONS SHALL BE REINFORCED AND STRENGTHENED TO SUPPORT THE PROPOSED FOUNDATION. ANY EXISTING FOUNDATIONS SHALL BE REINFORCED AND STRENGTHENED TO SUPPORT THE PROPOSED FOUNDATION.
10. ALL EXISTING FOUNDATIONS SHALL BE REINFORCED AND STRENGTHENED TO SUPPORT THE PROPOSED FOUNDATION. ANY EXISTING FOUNDATIONS SHALL BE REINFORCED AND STRENGTHENED TO SUPPORT THE PROPOSED FOUNDATION.

**SPOT ELEVATION LEGEND**

- 1. SPOT ELEVATION
- 2. FINISHED FLOOR ELEVATION
- 3. FINISHED GRADE ELEVATION
- 4. PROPOSED GRADE ELEVATION
- 5. PROPOSED FINISHED GRADE ELEVATION
- 6. PROPOSED FINISHED FLOOR ELEVATION
- 7. PROPOSED FINISHED GRADE ELEVATION
- 8. PROPOSED FINISHED FLOOR ELEVATION
- 9. PROPOSED FINISHED GRADE ELEVATION
- 10. PROPOSED FINISHED FLOOR ELEVATION

**GENERAL SITE NOTES**

1. THIS PLAN WAS PREPARED BASED ON THE FOLLOWING INFORMATION:
2. THE CONTRACTOR SHALL VERIFY ALL ELEVATIONS, SPOTS, AND OTHER INFORMATION SHOWN ON THIS PLAN.
3. THE CONTRACTOR SHALL VERIFY ALL ELEVATIONS, SPOTS, AND OTHER INFORMATION SHOWN ON THIS PLAN.
4. THE CONTRACTOR SHALL VERIFY ALL ELEVATIONS, SPOTS, AND OTHER INFORMATION SHOWN ON THIS PLAN.
5. THE CONTRACTOR SHALL VERIFY ALL ELEVATIONS, SPOTS, AND OTHER INFORMATION SHOWN ON THIS PLAN.
6. THE CONTRACTOR SHALL VERIFY ALL ELEVATIONS, SPOTS, AND OTHER INFORMATION SHOWN ON THIS PLAN.
7. THE CONTRACTOR SHALL VERIFY ALL ELEVATIONS, SPOTS, AND OTHER INFORMATION SHOWN ON THIS PLAN.
8. THE CONTRACTOR SHALL VERIFY ALL ELEVATIONS, SPOTS, AND OTHER INFORMATION SHOWN ON THIS PLAN.
9. THE CONTRACTOR SHALL VERIFY ALL ELEVATIONS, SPOTS, AND OTHER INFORMATION SHOWN ON THIS PLAN.
10. THE CONTRACTOR SHALL VERIFY ALL ELEVATIONS, SPOTS, AND OTHER INFORMATION SHOWN ON THIS PLAN.

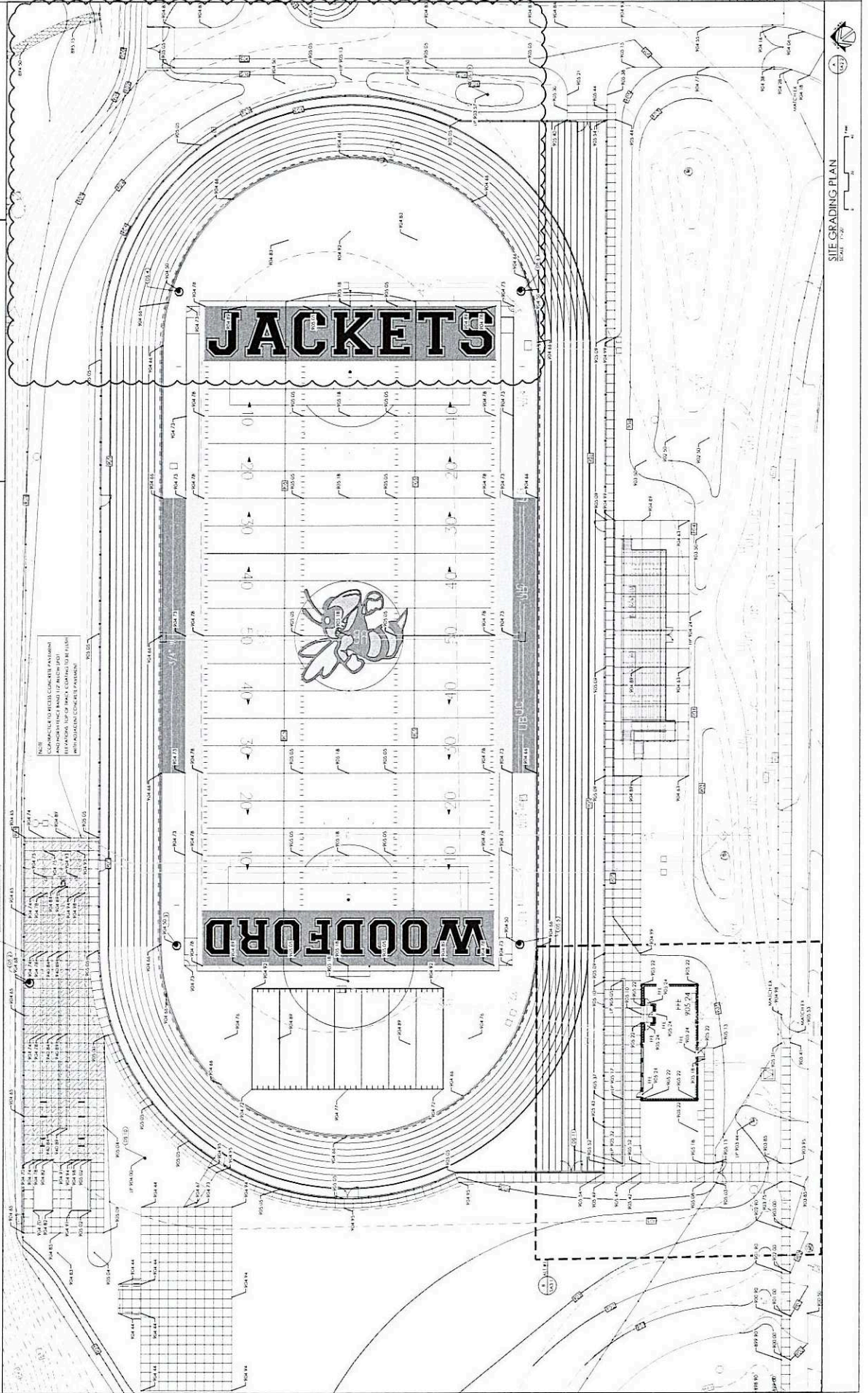

WOODFORD COUNTY HIGH SCHOOL PHASE 2 PRACTICE FIELD & TRACK  
 3333 PLEASANT PINE  
 WOODFORD COUNTY BOARD OF EDUCATION  
 40333

**SA2.2**  
 SITE GRADING PLAN  
 SCALE: 1"=20'  
 DATE: 10/20/2023  
 DRAWN BY: [Name]  
 CHECKED BY: [Name]  
 PROJECT: [Name]  
 SHEET: [Number]

**rosstarrant architects**  
 1000 PLEASANT PINE  
 WOODFORD, KY 40393  
 TEL: 502-222-1111  
 FAX: 502-222-1112  
 WWW.ROSSTARRANT.COM



**GENERAL SITE NOTES**

- THE SITE PLAN SHALL BE PREPARED IN ACCORDANCE WITH THE KENTUCKY PLANNING ACT AND THE KENTUCKY ZONING ACT.
- THE CONTRACTOR SHALL VERIFY ALL EXISTING UTILITIES AND RECORD THEM ON THE SITE PLAN.
- THE ARCHITECT HAS CONDUCTED VISUAL QUALITY ANALYSIS AND HAS PROVIDED A REPORT OF FINDINGS TO THE ARCHITECT OF RECORD.
- THE ARCHITECT HAS CONDUCTED VISUAL QUALITY ANALYSIS AND HAS PROVIDED A REPORT OF FINDINGS TO THE ARCHITECT OF RECORD.
- THE ARCHITECT HAS CONDUCTED VISUAL QUALITY ANALYSIS AND HAS PROVIDED A REPORT OF FINDINGS TO THE ARCHITECT OF RECORD.
- THE ARCHITECT HAS CONDUCTED VISUAL QUALITY ANALYSIS AND HAS PROVIDED A REPORT OF FINDINGS TO THE ARCHITECT OF RECORD.
- THE ARCHITECT HAS CONDUCTED VISUAL QUALITY ANALYSIS AND HAS PROVIDED A REPORT OF FINDINGS TO THE ARCHITECT OF RECORD.
- THE ARCHITECT HAS CONDUCTED VISUAL QUALITY ANALYSIS AND HAS PROVIDED A REPORT OF FINDINGS TO THE ARCHITECT OF RECORD.
- THE ARCHITECT HAS CONDUCTED VISUAL QUALITY ANALYSIS AND HAS PROVIDED A REPORT OF FINDINGS TO THE ARCHITECT OF RECORD.
- THE ARCHITECT HAS CONDUCTED VISUAL QUALITY ANALYSIS AND HAS PROVIDED A REPORT OF FINDINGS TO THE ARCHITECT OF RECORD.

**LEGEND**

(S-1) DRAINAGE STRUCTURE - 18" DIA. 12" DEEP  
(S-2) DRAINAGE STRUCTURE - 24" DIA. 18" DEEP  
(S-3) DRAINAGE STRUCTURE - 36" DIA. 24" DEEP

**SITE STORM DRAINAGE NOTES**

- DRAINAGE PLAN SHALL BE PREPARED IN ACCORDANCE WITH THE KENTUCKY PLANNING ACT AND THE KENTUCKY ZONING ACT.
- THE CONTRACTOR SHALL VERIFY ALL EXISTING UTILITIES AND RECORD THEM ON THE SITE PLAN.
- THE ARCHITECT HAS CONDUCTED VISUAL QUALITY ANALYSIS AND HAS PROVIDED A REPORT OF FINDINGS TO THE ARCHITECT OF RECORD.
- THE ARCHITECT HAS CONDUCTED VISUAL QUALITY ANALYSIS AND HAS PROVIDED A REPORT OF FINDINGS TO THE ARCHITECT OF RECORD.
- THE ARCHITECT HAS CONDUCTED VISUAL QUALITY ANALYSIS AND HAS PROVIDED A REPORT OF FINDINGS TO THE ARCHITECT OF RECORD.
- THE ARCHITECT HAS CONDUCTED VISUAL QUALITY ANALYSIS AND HAS PROVIDED A REPORT OF FINDINGS TO THE ARCHITECT OF RECORD.
- THE ARCHITECT HAS CONDUCTED VISUAL QUALITY ANALYSIS AND HAS PROVIDED A REPORT OF FINDINGS TO THE ARCHITECT OF RECORD.
- THE ARCHITECT HAS CONDUCTED VISUAL QUALITY ANALYSIS AND HAS PROVIDED A REPORT OF FINDINGS TO THE ARCHITECT OF RECORD.
- THE ARCHITECT HAS CONDUCTED VISUAL QUALITY ANALYSIS AND HAS PROVIDED A REPORT OF FINDINGS TO THE ARCHITECT OF RECORD.
- THE ARCHITECT HAS CONDUCTED VISUAL QUALITY ANALYSIS AND HAS PROVIDED A REPORT OF FINDINGS TO THE ARCHITECT OF RECORD.

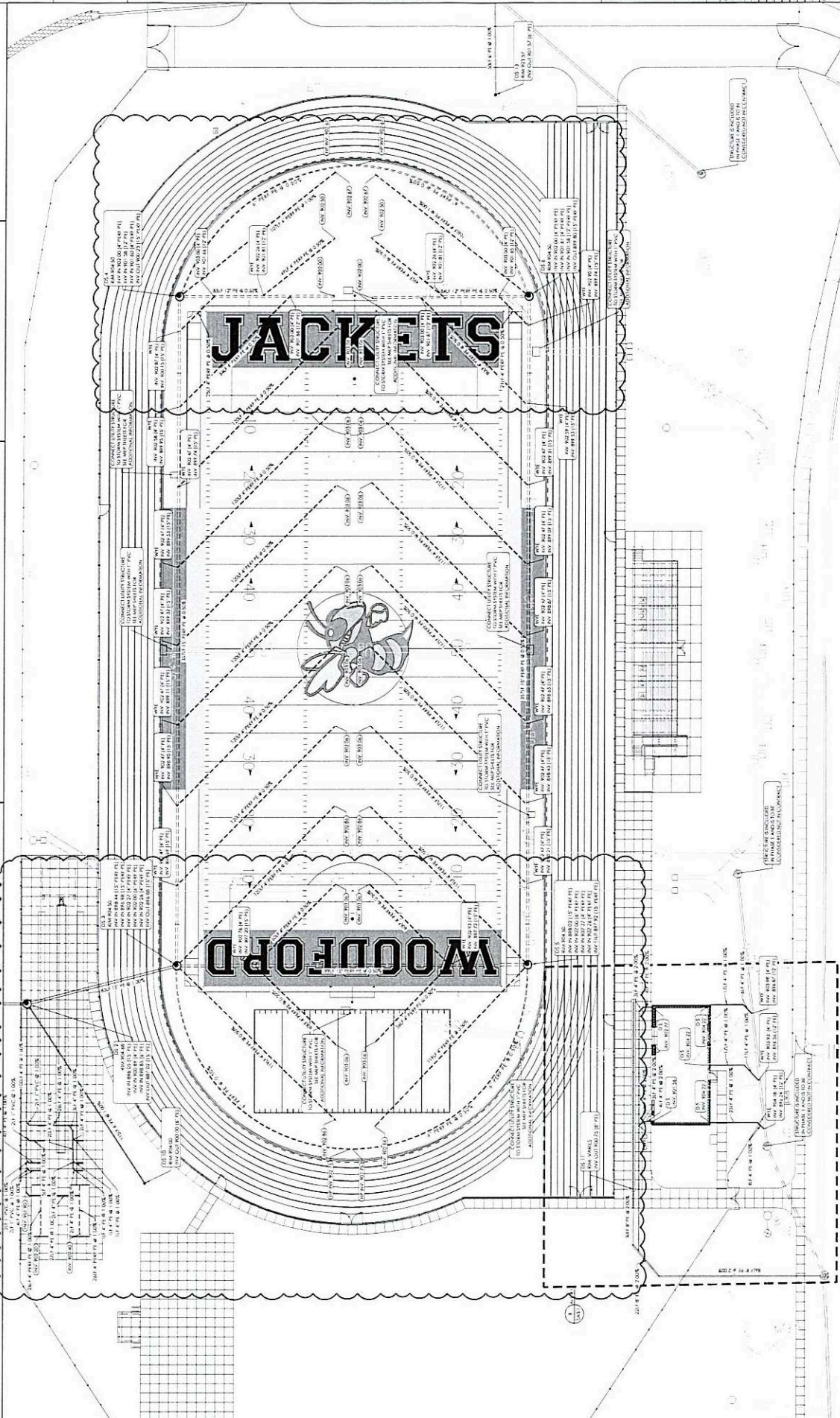

**SITE GRADING NOTES**

1. THE CONTRACTOR SHALL VERIFY ELEVATIONS AND RECORD DEPTHS OF ALL EXISTING CONDITIONS, INCLUDING EXISTING UTILITIES, WATER MAINS, AND SPECIALTY NEW CONDUITS AND SERVICES, PRIOR TO THE START OF CONSTRUCTION. THE CONTRACTOR SHALL BE RESPONSIBLE FOR VERIFYING THE ACCURACY OF ALL RECORDS AND FOR OBTAINING NECESSARY PERMITS FOR ANY EXISTING UTILITIES TO BE MAINTAINED OR DELETED. THE CONTRACTOR SHALL BE RESPONSIBLE FOR OBTAINING NECESSARY PERMITS FOR ANY EXISTING UTILITIES TO BE MAINTAINED OR DELETED.
2. ANY EXISTING UTILITIES, WATER MAINS, AND SPECIALTY NEW CONDUITS AND SERVICES, SHALL BE MAINTAINED OR DELETED AS SHOWN ON THE GRADING PLAN. THE CONTRACTOR SHALL BE RESPONSIBLE FOR OBTAINING NECESSARY PERMITS FOR ANY EXISTING UTILITIES TO BE MAINTAINED OR DELETED.
3. THE CONTRACTOR SHALL BE RESPONSIBLE FOR OBTAINING NECESSARY PERMITS FOR ANY EXISTING UTILITIES TO BE MAINTAINED OR DELETED.
4. THE CONTRACTOR SHALL BE RESPONSIBLE FOR OBTAINING NECESSARY PERMITS FOR ANY EXISTING UTILITIES TO BE MAINTAINED OR DELETED.
5. THE CONTRACTOR SHALL BE RESPONSIBLE FOR OBTAINING NECESSARY PERMITS FOR ANY EXISTING UTILITIES TO BE MAINTAINED OR DELETED.
6. THE CONTRACTOR SHALL BE RESPONSIBLE FOR OBTAINING NECESSARY PERMITS FOR ANY EXISTING UTILITIES TO BE MAINTAINED OR DELETED.
7. THE CONTRACTOR SHALL BE RESPONSIBLE FOR OBTAINING NECESSARY PERMITS FOR ANY EXISTING UTILITIES TO BE MAINTAINED OR DELETED.
8. THE CONTRACTOR SHALL BE RESPONSIBLE FOR OBTAINING NECESSARY PERMITS FOR ANY EXISTING UTILITIES TO BE MAINTAINED OR DELETED.
9. THE CONTRACTOR SHALL BE RESPONSIBLE FOR OBTAINING NECESSARY PERMITS FOR ANY EXISTING UTILITIES TO BE MAINTAINED OR DELETED.
10. THE CONTRACTOR SHALL BE RESPONSIBLE FOR OBTAINING NECESSARY PERMITS FOR ANY EXISTING UTILITIES TO BE MAINTAINED OR DELETED.

**SPOT ELEVATION LEGEND**

- 10. SPOT ELEVATION
- 11. FINISHED FLOOR ELEVATION
- 12. FINISHED GRADE ELEVATION
- 13. FINISHED GRADE ELEVATION
- 14. FINISHED GRADE ELEVATION
- 15. FINISHED GRADE ELEVATION
- 16. FINISHED GRADE ELEVATION
- 17. FINISHED GRADE ELEVATION
- 18. FINISHED GRADE ELEVATION
- 19. FINISHED GRADE ELEVATION
- 20. FINISHED GRADE ELEVATION
- 21. FINISHED GRADE ELEVATION
- 22. FINISHED GRADE ELEVATION
- 23. FINISHED GRADE ELEVATION
- 24. FINISHED GRADE ELEVATION
- 25. FINISHED GRADE ELEVATION
- 26. FINISHED GRADE ELEVATION
- 27. FINISHED GRADE ELEVATION
- 28. FINISHED GRADE ELEVATION
- 29. FINISHED GRADE ELEVATION
- 30. FINISHED GRADE ELEVATION
- 31. FINISHED GRADE ELEVATION
- 32. FINISHED GRADE ELEVATION
- 33. FINISHED GRADE ELEVATION
- 34. FINISHED GRADE ELEVATION
- 35. FINISHED GRADE ELEVATION
- 36. FINISHED GRADE ELEVATION
- 37. FINISHED GRADE ELEVATION
- 38. FINISHED GRADE ELEVATION
- 39. FINISHED GRADE ELEVATION
- 40. FINISHED GRADE ELEVATION
- 41. FINISHED GRADE ELEVATION
- 42. FINISHED GRADE ELEVATION
- 43. FINISHED GRADE ELEVATION
- 44. FINISHED GRADE ELEVATION
- 45. FINISHED GRADE ELEVATION
- 46. FINISHED GRADE ELEVATION
- 47. FINISHED GRADE ELEVATION
- 48. FINISHED GRADE ELEVATION
- 49. FINISHED GRADE ELEVATION
- 50. FINISHED GRADE ELEVATION
- 51. FINISHED GRADE ELEVATION
- 52. FINISHED GRADE ELEVATION
- 53. FINISHED GRADE ELEVATION
- 54. FINISHED GRADE ELEVATION
- 55. FINISHED GRADE ELEVATION
- 56. FINISHED GRADE ELEVATION
- 57. FINISHED GRADE ELEVATION
- 58. FINISHED GRADE ELEVATION
- 59. FINISHED GRADE ELEVATION
- 60. FINISHED GRADE ELEVATION
- 61. FINISHED GRADE ELEVATION
- 62. FINISHED GRADE ELEVATION
- 63. FINISHED GRADE ELEVATION
- 64. FINISHED GRADE ELEVATION
- 65. FINISHED GRADE ELEVATION
- 66. FINISHED GRADE ELEVATION
- 67. FINISHED GRADE ELEVATION
- 68. FINISHED GRADE ELEVATION
- 69. FINISHED GRADE ELEVATION
- 70. FINISHED GRADE ELEVATION
- 71. FINISHED GRADE ELEVATION
- 72. FINISHED GRADE ELEVATION
- 73. FINISHED GRADE ELEVATION
- 74. FINISHED GRADE ELEVATION
- 75. FINISHED GRADE ELEVATION
- 76. FINISHED GRADE ELEVATION
- 77. FINISHED GRADE ELEVATION
- 78. FINISHED GRADE ELEVATION
- 79. FINISHED GRADE ELEVATION
- 80. FINISHED GRADE ELEVATION
- 81. FINISHED GRADE ELEVATION
- 82. FINISHED GRADE ELEVATION
- 83. FINISHED GRADE ELEVATION
- 84. FINISHED GRADE ELEVATION
- 85. FINISHED GRADE ELEVATION
- 86. FINISHED GRADE ELEVATION
- 87. FINISHED GRADE ELEVATION
- 88. FINISHED GRADE ELEVATION
- 89. FINISHED GRADE ELEVATION
- 90. FINISHED GRADE ELEVATION
- 91. FINISHED GRADE ELEVATION
- 92. FINISHED GRADE ELEVATION
- 93. FINISHED GRADE ELEVATION
- 94. FINISHED GRADE ELEVATION
- 95. FINISHED GRADE ELEVATION
- 96. FINISHED GRADE ELEVATION
- 97. FINISHED GRADE ELEVATION
- 98. FINISHED GRADE ELEVATION
- 99. FINISHED GRADE ELEVATION
- 100. FINISHED GRADE ELEVATION

**GENERAL SITE NOTES**

1. THE CONTRACTOR SHALL VERIFY THE EXISTING CONDITIONS AND RECORD DEPTHS OF ALL EXISTING UTILITIES, WATER MAINS, AND SPECIALTY NEW CONDUITS AND SERVICES, PRIOR TO THE START OF CONSTRUCTION. THE CONTRACTOR SHALL BE RESPONSIBLE FOR VERIFYING THE ACCURACY OF ALL RECORDS AND FOR OBTAINING NECESSARY PERMITS FOR ANY EXISTING UTILITIES TO BE MAINTAINED OR DELETED.
2. ANY EXISTING UTILITIES, WATER MAINS, AND SPECIALTY NEW CONDUITS AND SERVICES, SHALL BE MAINTAINED OR DELETED AS SHOWN ON THE GRADING PLAN. THE CONTRACTOR SHALL BE RESPONSIBLE FOR OBTAINING NECESSARY PERMITS FOR ANY EXISTING UTILITIES TO BE MAINTAINED OR DELETED.
3. THE CONTRACTOR SHALL BE RESPONSIBLE FOR OBTAINING NECESSARY PERMITS FOR ANY EXISTING UTILITIES TO BE MAINTAINED OR DELETED.
4. THE CONTRACTOR SHALL BE RESPONSIBLE FOR OBTAINING NECESSARY PERMITS FOR ANY EXISTING UTILITIES TO BE MAINTAINED OR DELETED.
5. THE CONTRACTOR SHALL BE RESPONSIBLE FOR OBTAINING NECESSARY PERMITS FOR ANY EXISTING UTILITIES TO BE MAINTAINED OR DELETED.
6. THE CONTRACTOR SHALL BE RESPONSIBLE FOR OBTAINING NECESSARY PERMITS FOR ANY EXISTING UTILITIES TO BE MAINTAINED OR DELETED.
7. THE CONTRACTOR SHALL BE RESPONSIBLE FOR OBTAINING NECESSARY PERMITS FOR ANY EXISTING UTILITIES TO BE MAINTAINED OR DELETED.
8. THE CONTRACTOR SHALL BE RESPONSIBLE FOR OBTAINING NECESSARY PERMITS FOR ANY EXISTING UTILITIES TO BE MAINTAINED OR DELETED.
9. THE CONTRACTOR SHALL BE RESPONSIBLE FOR OBTAINING NECESSARY PERMITS FOR ANY EXISTING UTILITIES TO BE MAINTAINED OR DELETED.
10. THE CONTRACTOR SHALL BE RESPONSIBLE FOR OBTAINING NECESSARY PERMITS FOR ANY EXISTING UTILITIES TO BE MAINTAINED OR DELETED.

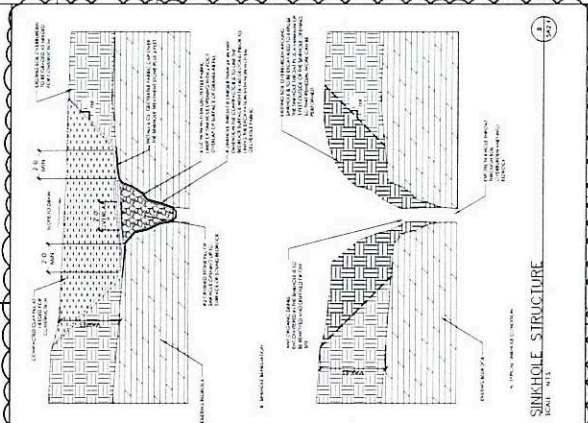
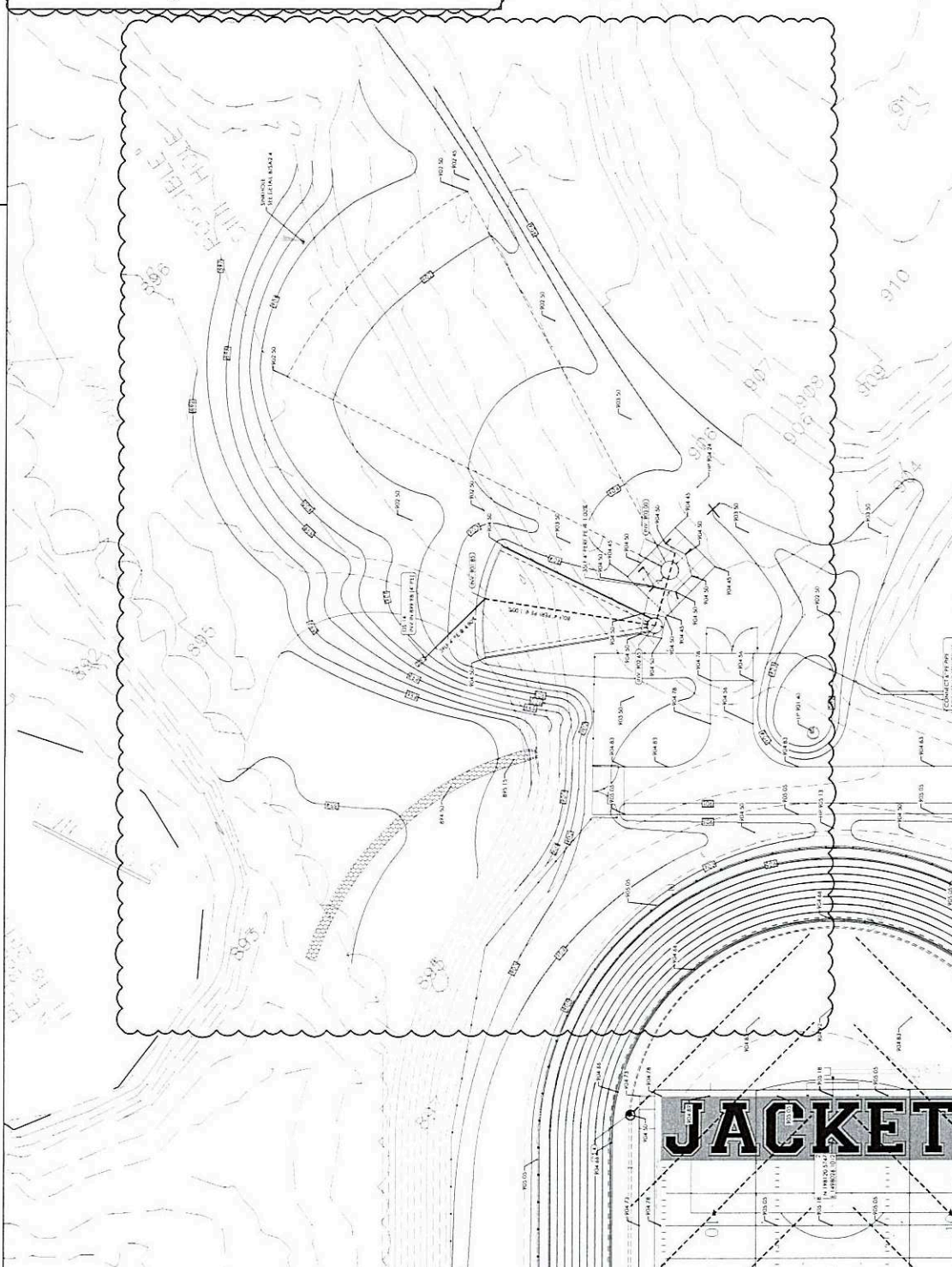

**JACKET**

DATE: 08/14/2023	PROJECT: WOODFORD COUNTY HIGH SCHOOL PHASE 2 PRACTICE FIELD & TRACK
DESIGNER: [Firm Name]	CLIENT: WOODFORD COUNTY BOARD OF EDUCATION
SCALE: AS SHOWN	PROJECT NO: [Project Number]
DATE: 08/14/2023	PROJECT: WOODFORD COUNTY HIGH SCHOOL PHASE 2 PRACTICE FIELD & TRACK
DESIGNER: [Firm Name]	CLIENT: WOODFORD COUNTY BOARD OF EDUCATION
SCALE: AS SHOWN	PROJECT NO: [Project Number]



**GENERAL SITE NOTES**

1. ALL UTILITIES SHOWN ARE BASED ON RECORD DRAWINGS AND FIELD SURVEY. VERIFY ALL UTILITIES BEFORE CONSTRUCTION.
2. THE CONTRACTOR SHALL VERIFY ALL ELEVATIONS, GRADES AND DIMENSIONS SHOWN ON THIS PLAN AND REFER TO THE ARCHITECTURAL DRAWINGS FOR VERIFICATION.
3. THE ARCHITECT HAS PROVIDED GENERAL NOTES AND SPECIFICATIONS FOR THE CONSTRUCTION OF THIS PROJECT. THE CONTRACTOR SHALL VERIFY ALL DIMENSIONS AND ELEVATIONS SHOWN ON THIS PLAN AND REFER TO THE ARCHITECTURAL DRAWINGS FOR VERIFICATION.
4. THE CONTRACTOR SHALL VERIFY ALL DIMENSIONS AND ELEVATIONS SHOWN ON THIS PLAN AND REFER TO THE ARCHITECTURAL DRAWINGS FOR VERIFICATION.
5. THE CONTRACTOR SHALL VERIFY ALL DIMENSIONS AND ELEVATIONS SHOWN ON THIS PLAN AND REFER TO THE ARCHITECTURAL DRAWINGS FOR VERIFICATION.

**LANDSCAPE TAGS**

- 1. CONCRETE PAVEMENT
- 2. ASPHALT PAVEMENT
- 3. GRASS
- 4. SOFTSCAPE
- 5. IRONSTONE ASPHALT PAVEMENT
- 6. STONE
- 7. BRICK
- 8. METAL
- 9. GLASS
- 10. WOOD
- 11. PLASTER
- 12. STAINLESS STEEL
- 13. ALUMINUM
- 14. COPPER
- 15. BRASS
- 16. SILVER
- 17. GOLD
- 18. BLACK
- 19. WHITE
- 20. GREY
- 21. RED
- 22. BLUE
- 23. GREEN
- 24. BROWN
- 25. PINK
- 26. PURPLE
- 27. ORANGE
- 28. YELLOW
- 29. LIGHT BLUE
- 30. LIGHT GREEN
- 31. LIGHT BROWN
- 32. LIGHT PINK
- 33. LIGHT PURPLE
- 34. LIGHT ORANGE
- 35. LIGHT YELLOW
- 36. LIGHT LIGHT BLUE
- 37. LIGHT LIGHT GREEN
- 38. LIGHT LIGHT BROWN
- 39. LIGHT LIGHT PINK
- 40. LIGHT LIGHT PURPLE
- 41. LIGHT LIGHT ORANGE
- 42. LIGHT LIGHT YELLOW

**LEGEND**

- 1. CONCRETE PAVEMENT
- 2. ASPHALT PAVEMENT
- 3. GRASS
- 4. SOFTSCAPE
- 5. IRONSTONE ASPHALT PAVEMENT
- 6. STONE
- 7. BRICK
- 8. METAL
- 9. GLASS
- 10. WOOD
- 11. PLASTER
- 12. STAINLESS STEEL
- 13. ALUMINUM
- 14. COPPER
- 15. BRASS
- 16. SILVER
- 17. GOLD
- 18. BLACK
- 19. WHITE
- 20. GREY
- 21. RED
- 22. BLUE
- 23. GREEN
- 24. BROWN
- 25. PINK
- 26. PURPLE
- 27. ORANGE
- 28. YELLOW
- 29. LIGHT BLUE
- 30. LIGHT GREEN
- 31. LIGHT BROWN
- 32. LIGHT PINK
- 33. LIGHT PURPLE
- 34. LIGHT ORANGE
- 35. LIGHT YELLOW

**SITE DEVELOPMENT TAGS**

- 1. CONCRETE PAVEMENT
- 2. ASPHALT PAVEMENT
- 3. GRASS
- 4. SOFTSCAPE
- 5. IRONSTONE ASPHALT PAVEMENT
- 6. STONE
- 7. BRICK
- 8. METAL
- 9. GLASS
- 10. WOOD
- 11. PLASTER
- 12. STAINLESS STEEL
- 13. ALUMINUM
- 14. COPPER
- 15. BRASS
- 16. SILVER
- 17. GOLD
- 18. BLACK
- 19. WHITE
- 20. GREY
- 21. RED
- 22. BLUE
- 23. GREEN
- 24. BROWN
- 25. PINK
- 26. PURPLE
- 27. ORANGE
- 28. YELLOW
- 29. LIGHT BLUE
- 30. LIGHT GREEN
- 31. LIGHT BROWN
- 32. LIGHT PINK
- 33. LIGHT PURPLE
- 34. LIGHT ORANGE
- 35. LIGHT YELLOW

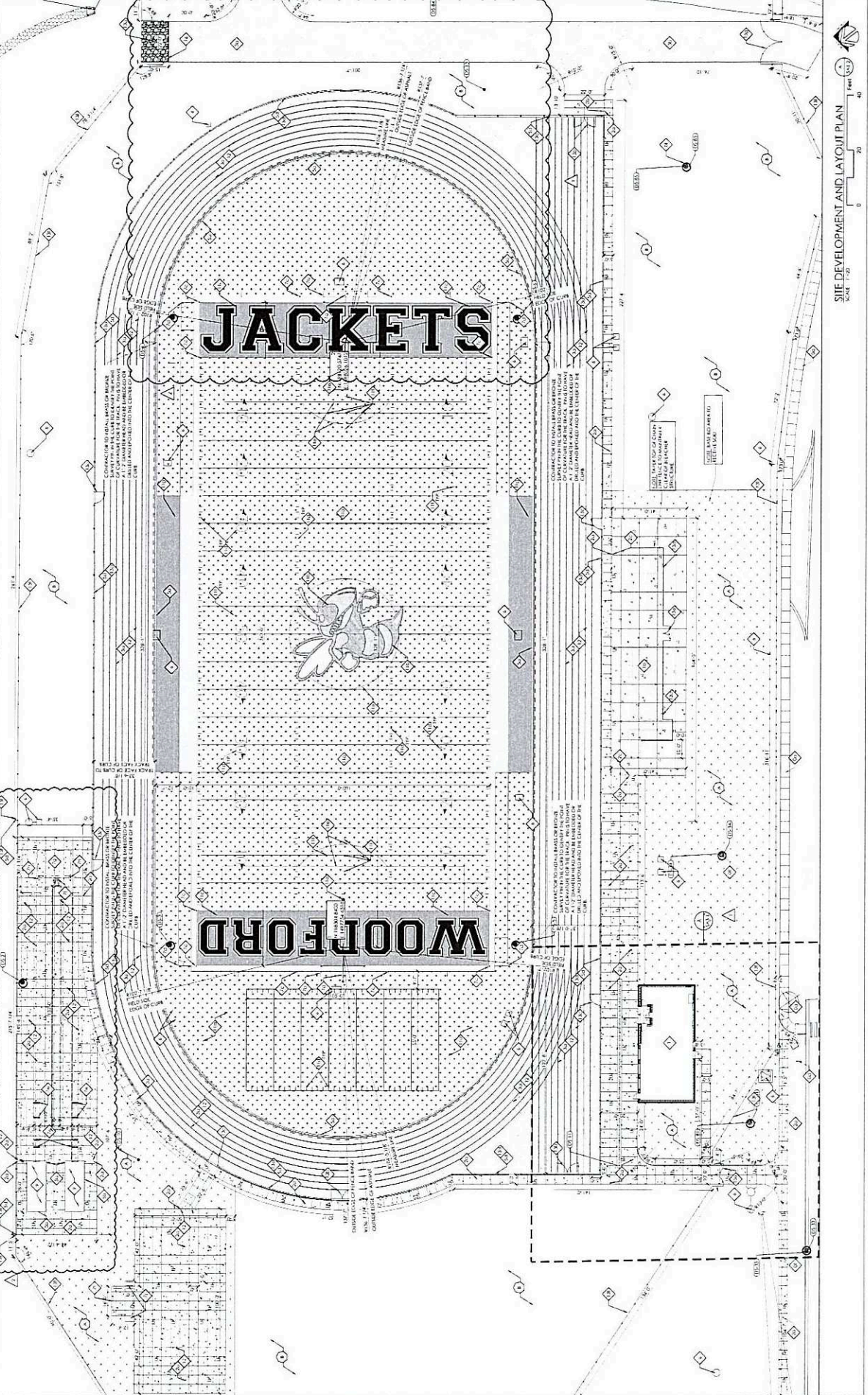

### GENERAL SITE NOTES

1. ALL PROPOSED CONSTRUCTION SHALL BE IN ACCORDANCE WITH THE LATEST EDITIONS OF THE INTERNATIONAL RESIDENTIAL CODE BOOK, IBC.
2. THE CONTRACTOR SHALL BE RESPONSIBLE FOR OBTAINING ALL NECESSARY PERMITS AND APPROVALS FROM THE APPROPRIATE AGENCIES AND OFFICIALS.
3. THE CONTRACTOR SHALL BE RESPONSIBLE FOR OBTAINING ALL NECESSARY PERMITS AND APPROVALS FROM THE APPROPRIATE AGENCIES AND OFFICIALS.
4. THE CONTRACTOR SHALL BE RESPONSIBLE FOR OBTAINING ALL NECESSARY PERMITS AND APPROVALS FROM THE APPROPRIATE AGENCIES AND OFFICIALS.
5. THE CONTRACTOR SHALL BE RESPONSIBLE FOR OBTAINING ALL NECESSARY PERMITS AND APPROVALS FROM THE APPROPRIATE AGENCIES AND OFFICIALS.

### LANDSCAPE TAGS

CONCRETE PAVEMENT  
 ASPHALT PAVEMENT  
 GRASS  
 SYNTHETIC TURF  
 SOFT-SCAPE

### LEGEND

CONCRETE PAVEMENT  
 ASPHALT PAVEMENT  
 GRASS  
 SYNTHETIC TURF  
 SOFT-SCAPE

### SITE DEVELOPMENT TAGS

CONCRETE PAVEMENT  
 ASPHALT PAVEMENT  
 GRASS  
 SYNTHETIC TURF  
 SOFT-SCAPE

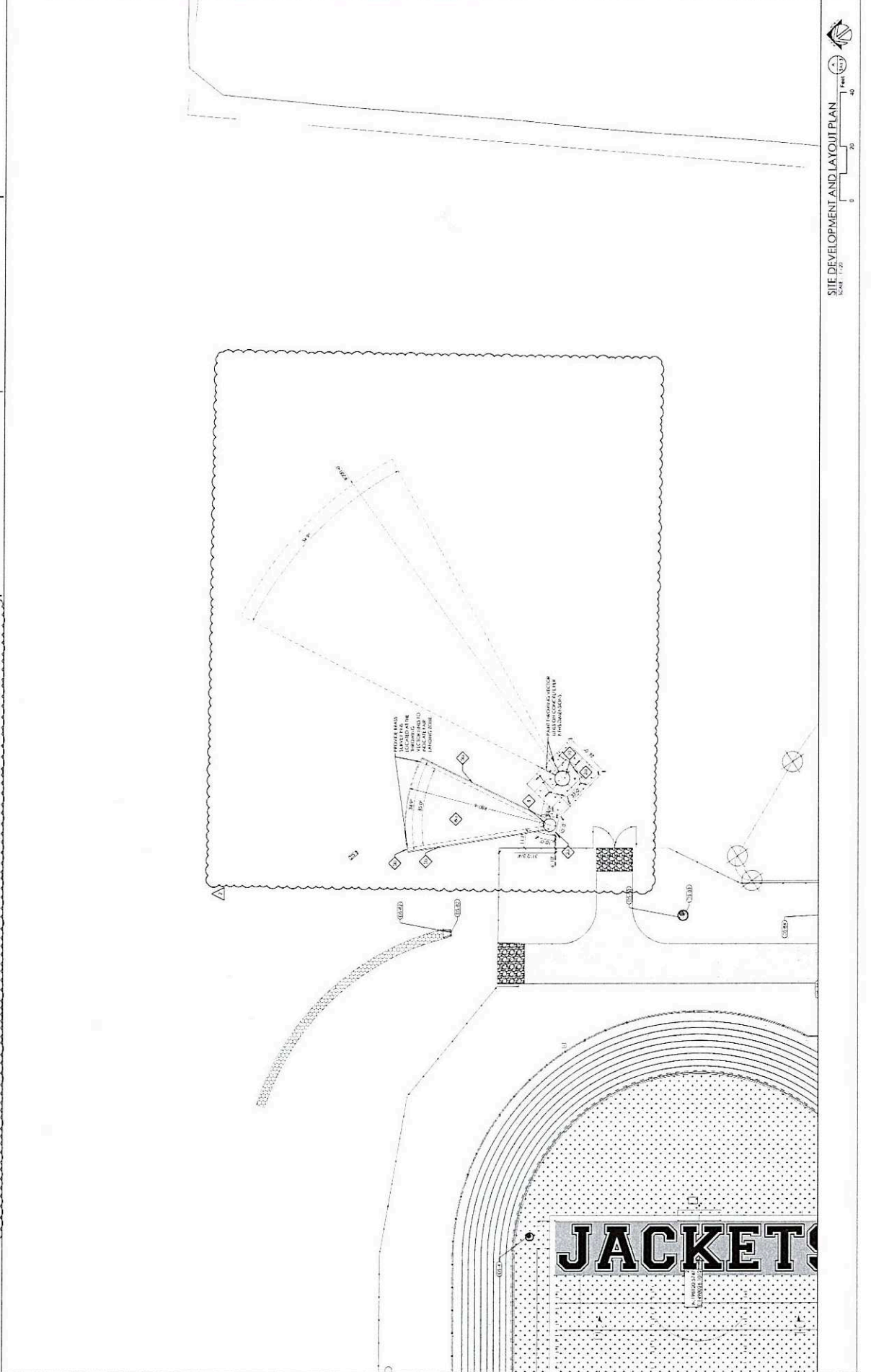



WOODFORD COUNTY HIGH SCHOOL PHASE 2 PRACTICE FIELD & TRACK  
SITING GRADING PLAN  
BGF 73-120

DATE: 08/08/18  
PROJECT: WOODFORD COUNTY HIGH SCHOOL PHASE 2 PRACTICE FIELD & TRACK  
SHEET: SA2.2

1. THE CONTRACTOR SHALL VERIFY THE LOCATION AND ADEQUACY OF ALL UTILITIES (SINKS, GAS MAINS, WATER MAINS AND PIPES) TO ALL NEW CONSTRUCTION...  
2. THE CONTRACTOR SHALL VERIFY THE LOCATION AND ADEQUACY OF ALL UTILITIES (SINKS, GAS MAINS, WATER MAINS AND PIPES) TO ALL NEW CONSTRUCTION...  
3. THE CONTRACTOR SHALL VERIFY THE LOCATION AND ADEQUACY OF ALL UTILITIES (SINKS, GAS MAINS, WATER MAINS AND PIPES) TO ALL NEW CONSTRUCTION...  
4. THE CONTRACTOR SHALL VERIFY THE LOCATION AND ADEQUACY OF ALL UTILITIES (SINKS, GAS MAINS, WATER MAINS AND PIPES) TO ALL NEW CONSTRUCTION...

1. THE CONTRACTOR SHALL VERIFY THE LOCATION AND ADEQUACY OF ALL UTILITIES (SINKS, GAS MAINS, WATER MAINS AND PIPES) TO ALL NEW CONSTRUCTION...  
2. THE CONTRACTOR SHALL VERIFY THE LOCATION AND ADEQUACY OF ALL UTILITIES (SINKS, GAS MAINS, WATER MAINS AND PIPES) TO ALL NEW CONSTRUCTION...  
3. THE CONTRACTOR SHALL VERIFY THE LOCATION AND ADEQUACY OF ALL UTILITIES (SINKS, GAS MAINS, WATER MAINS AND PIPES) TO ALL NEW CONSTRUCTION...  
4. THE CONTRACTOR SHALL VERIFY THE LOCATION AND ADEQUACY OF ALL UTILITIES (SINKS, GAS MAINS, WATER MAINS AND PIPES) TO ALL NEW CONSTRUCTION...

1. THE CONTRACTOR SHALL VERIFY THE LOCATION AND ADEQUACY OF ALL UTILITIES (SINKS, GAS MAINS, WATER MAINS AND PIPES) TO ALL NEW CONSTRUCTION...  
2. THE CONTRACTOR SHALL VERIFY THE LOCATION AND ADEQUACY OF ALL UTILITIES (SINKS, GAS MAINS, WATER MAINS AND PIPES) TO ALL NEW CONSTRUCTION...  
3. THE CONTRACTOR SHALL VERIFY THE LOCATION AND ADEQUACY OF ALL UTILITIES (SINKS, GAS MAINS, WATER MAINS AND PIPES) TO ALL NEW CONSTRUCTION...  
4. THE CONTRACTOR SHALL VERIFY THE LOCATION AND ADEQUACY OF ALL UTILITIES (SINKS, GAS MAINS, WATER MAINS AND PIPES) TO ALL NEW CONSTRUCTION...

1. THE CONTRACTOR SHALL VERIFY THE LOCATION AND ADEQUACY OF ALL UTILITIES (SINKS, GAS MAINS, WATER MAINS AND PIPES) TO ALL NEW CONSTRUCTION...  
2. THE CONTRACTOR SHALL VERIFY THE LOCATION AND ADEQUACY OF ALL UTILITIES (SINKS, GAS MAINS, WATER MAINS AND PIPES) TO ALL NEW CONSTRUCTION...  
3. THE CONTRACTOR SHALL VERIFY THE LOCATION AND ADEQUACY OF ALL UTILITIES (SINKS, GAS MAINS, WATER MAINS AND PIPES) TO ALL NEW CONSTRUCTION...  
4. THE CONTRACTOR SHALL VERIFY THE LOCATION AND ADEQUACY OF ALL UTILITIES (SINKS, GAS MAINS, WATER MAINS AND PIPES) TO ALL NEW CONSTRUCTION...

1. THE CONTRACTOR SHALL VERIFY THE LOCATION AND ADEQUACY OF ALL UTILITIES (SINKS, GAS MAINS, WATER MAINS AND PIPES) TO ALL NEW CONSTRUCTION...  
2. THE CONTRACTOR SHALL VERIFY THE LOCATION AND ADEQUACY OF ALL UTILITIES (SINKS, GAS MAINS, WATER MAINS AND PIPES) TO ALL NEW CONSTRUCTION...  
3. THE CONTRACTOR SHALL VERIFY THE LOCATION AND ADEQUACY OF ALL UTILITIES (SINKS, GAS MAINS, WATER MAINS AND PIPES) TO ALL NEW CONSTRUCTION...  
4. THE CONTRACTOR SHALL VERIFY THE LOCATION AND ADEQUACY OF ALL UTILITIES (SINKS, GAS MAINS, WATER MAINS AND PIPES) TO ALL NEW CONSTRUCTION...

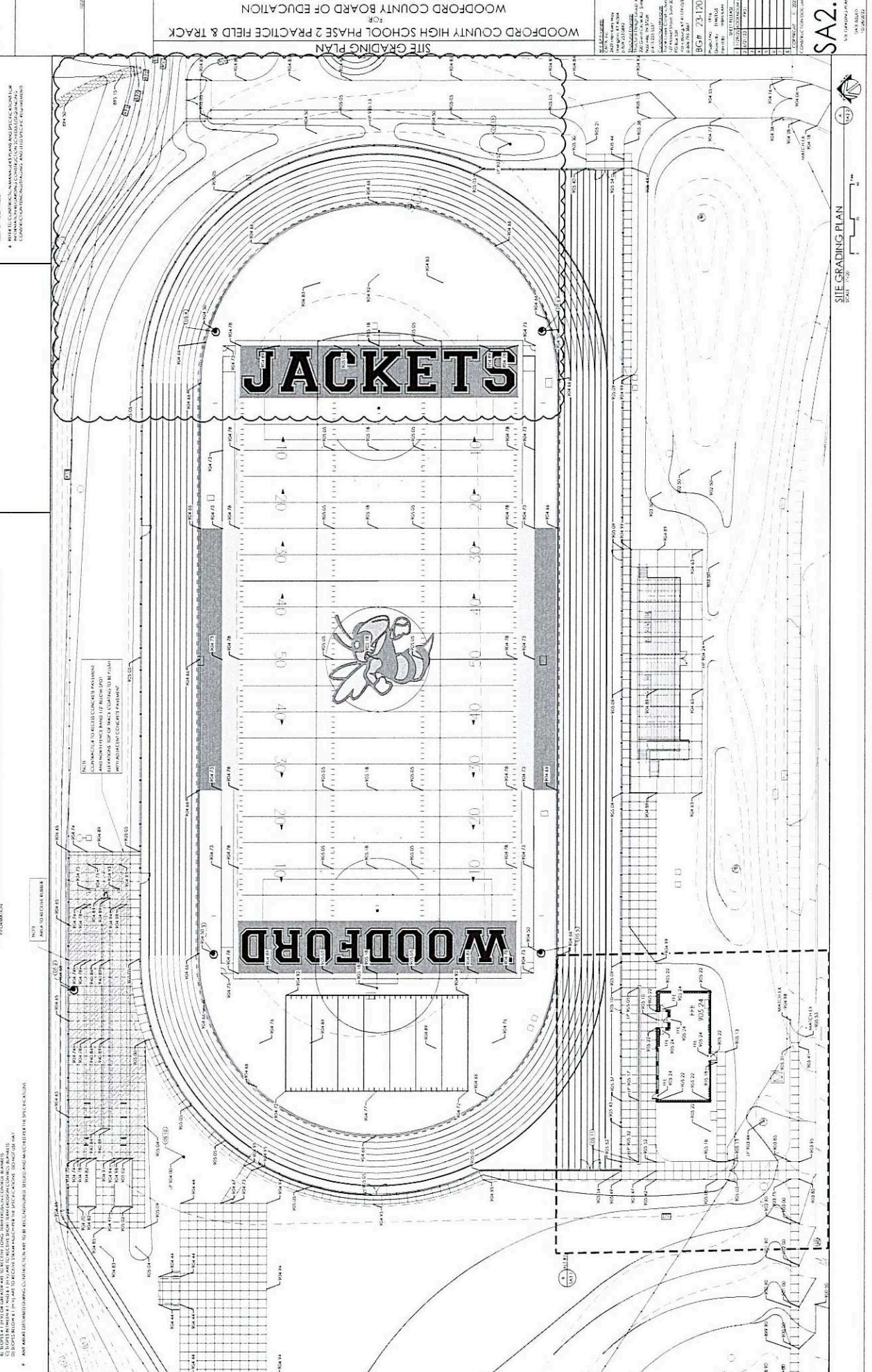

WOODFORD COUNTY HIGH SCHOOL PHASE 2 PRACTICE FIELD & TRACK  
SITING GRADING PLAN  
BGF 73-120

DATE: 08/08/18  
PROJECT: WOODFORD COUNTY HIGH SCHOOL PHASE 2 PRACTICE FIELD & TRACK  
SHEET: SA2.2

WOODFORD COUNTY HIGH SCHOOL BOARD OF EDUCATION  
330 Pinesh Pike Kentucky 40383







# AIA<sup>®</sup> Document G731™ – 2019

## Change Order, Construction Manager as Adviser Edition

<b>PROJECT:</b> <i>(name and address)</i> Woodford County High School Phase 2 145 School House Road, Versailles, KY 40383	<b>CONTRACT INFORMATION:</b> Contract For: General Construction Date: February 27, 2023	<b>CHANGE ORDER INFORMATION:</b> Change Order Number: 01-01 Date: 9/18 2023
<b>OWNER:</b> <i>(name and address)</i> Woodford County Board of Education 330 Pisgah Pike, Versailles, KY 40383	<b>ARCHITECT:</b> <i>(name and address)</i> RossTarrant Architects 101 Old Lafayette Avenue, Lexington, KY 40502	<b>CONSTRUCTION MANAGER:</b> <i>(name and address)</i> Trace Creek Construction, Inc. 127 Market St., Vanceburg, KY 41179
<b>CONTRACTOR:</b> <i>(name and address)</i> Independent Contractors Distributors, Inc. P.O. Box 2587, Ashland, KY 41105		

**THE CONTRACT IS CHANGED AS FOLLOWS:**

*(Insert a detailed description of the change and, if applicable, attach or reference specific exhibits. Also include agreed upon adjustments attributable to executed Construction Change Directives.)*

- \* Revise site grading and drainage per PR #01.
- \* (60) Days have been added to the construction schedule. 10 days for additional scope, and 50 for design/approval time. This 60 days also eliminates finish exposure to the 2023/2024 winter elements.

The original Contract Sum was	\$	394,368.00
Net change by previously authorized Change Orders	\$	0.00
The Contract Sum prior to this Change Order was	\$	394,368.00
The Contract Sum will be increased by this Change Order in the amount of	\$	27,548.05
The new Contract Sum including this Change Order will be	\$	421,916.05

The Contract Time will be increased by Sixty (60) days.  
The Contractor's Work shall be substantially complete on 5/15/2024.

**NOTE:** This Change Order does not include adjustments to the Contract Sum or Guaranteed Maximum Price, or the Contract Time, that have been authorized by Construction Change Directive until the cost and time have been agreed upon by both the Owner and Contractor, in which case a Change Order is executed to supersede the Construction Change Directive.

**NOT VALID UNTIL SIGNED BY THE ARCHITECT, CONSTRUCTION MANAGER, CONTRACTOR, AND OWNER.**

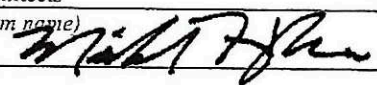
RossTarrant Architects  
**ARCHITECT** *(Firm name)*  
  
**SIGNATURE**  
 Michael Hughes, Project Manager  
**PRINTED NAME AND TITLE**  
 09/19/2023  
**DATE:**

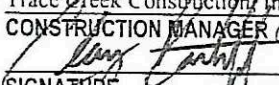
Trace Creek Construction, Inc.  
**CONSTRUCTION MANAGER** *(Firm name)*  
  
**SIGNATURE**  
 Clay Ratliff, Vice President  
**PRINTED NAME AND TITLE**  
 9/18/2023  
**DATE:**

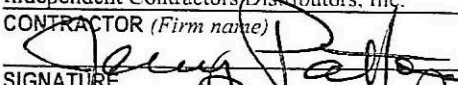
Independent Contractors Distributors, Inc.  
**CONTRACTOR** *(Firm name)*  
  
**SIGNATURE**  
 Jerry Patton, President  
**PRINTED NAME AND TITLE**  
 9-18-23  
**DATE:**

Woodford County Board of Education  
**OWNER** *(Firm name)*  
**SIGNATURE**  
**PRINTED NAME AND TITLE**  
**DATE:**

Woodford County - PR 001  
 ICD Inc.  
 Proposal Request #1

Addition

Item	Unit	Quantity	Labor & Equipment Rate	Material Rate	Total
4" perf pipe	LF	154	\$ 19.00	\$ 11.57	\$ 4,707.78
Site Grading	CY	2200	\$ 12.00	\$ -	\$ 26,400.00
Sink Hole	CY	1	\$ 15.00	\$ 47.27	\$ 62.27
Seeding	AC	1.67	\$ 4,300.00	\$ 4,200.00	\$ 14,195.00
Total					\$ 45,365.05
OH & Profit				15%	\$ 6,804.75
Grand Total					\$ 52,169.80

← The perf pipe provided by ICD is for the new location of the throw area. RSD's 4" perf pipe is only for the addition inside the track.

Credit

4" perf pipe	LF	128	\$ 19.00	\$ 11.57	\$ 3,912.96
12" PE	LF	202	\$ 19.00	\$ 16.63	\$ 7,197.26
Str. 7, 8, 9, 14	EA	4	\$ 500.00	\$ 2,075.00	\$ 10,300.00
Total					\$ 21,410.22
OH & Profit				15%	\$ 3,211.53
Grand Total					\$ 24,621.75

Total ChangeOrder \$ 27,548.05



# AIA<sup>®</sup>

# Document G731™ – 2019

## Change Order, Construction Manager as Adviser Edition

**PROJECT:** *(name and address)*  
 Woodford County High School Phase 2  
 145 School House Road, Versailles, KY  
 40383

**OWNER:** *(name and address)*  
 Woodford County Board of Education  
 330 Pisgah Pike, Versailles, KY 40383

**CONTRACTOR:** *(name and address)*  
 Rising Sun Developing  
 2555 Palumbo Drive, Ste 110, Lexington,  
 KY 40509

**CONTRACT INFORMATION:**  
 Contract For: BP 02 GT  
 Date: February 27, 2023

**ARCHITECT:** *(name and address)*  
 RossTarrant Architects  
 101 Old Lafayette Avenue,  
 Lexington, KY 40502

**CHANGE ORDER INFORMATION:**  
 Change Order Number: 02-01  
 Date: 9/19/2023

**CONSTRUCTION MANAGER:** *(name and address)*  
 Trace Creek Construction, Inc.  
 127 Market St., Vanceburg, KY 41179

**THE CONTRACT IS CHANGED AS FOLLOWS:**

*(Insert a detailed description of the change and, if applicable, attach or reference specific exhibits. Also include agreed upon adjustments attributable to executed Construction Change Directives.)*

- \* Relocate throwing events and modify existing layout per PR #01.
- \* (60) Days have been added to the construction schedule. 10 days for additional scope, and 50 for design/approval time. This 60 days also eliminates finish exposure to the 2023/2024 winter elements.

The original Contract Sum was	\$ 1,645,014.00
Net change by previously authorized Change Orders	\$ 0.00
The Contract Sum prior to this Change Order was	\$ 1,645,014.00
The Contract Sum will be decreased by this Change Order in the amount of	\$ 39,556.94
The new Contract Sum including this Change Order will be	\$ 1,605,457.06

The Contract Time will be increased by Sixty (60) days.  
 The Contractor's Work shall be substantially complete on 5/15/2024.

**NOTE:** This Change Order does not include adjustments to the Contract Sum or Guaranteed Maximum Price, or the Contract Time, that have been authorized by Construction Change Directive until the cost and time have been agreed upon by both the Owner and Contractor, in which case a Change Order is executed to supersede the Construction Change Directive.

**NOT VALID UNTIL SIGNED BY THE ARCHITECT, CONSTRUCTION MANAGER, CONTRACTOR, AND OWNER.**

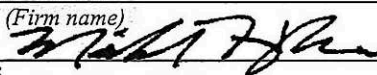
RossTarrant Architects  
 ARCHITECT *(Firm name)*  
 \_\_\_\_\_  
 SIGNATURE   
 Michael Hughes, Project Manager  
 PRINTED NAME AND TITLE  
 09/19/2023  
 DATE:

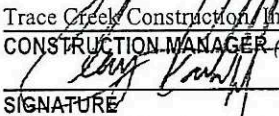
Trace Creek Construction, Inc.  
 CONSTRUCTION MANAGER *(Firm name)*  
 \_\_\_\_\_  
 SIGNATURE   
 Clay Ratliff, Vice President  
 PRINTED NAME AND TITLE  
 9/19/2023  
 DATE:

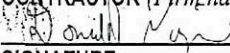
Rising Sun Developing  
 CONTRACTOR *(Firm name)*  
 \_\_\_\_\_  
 SIGNATURE   
 Donald Napier, PM  
 PRINTED NAME AND TITLE  
 9/19/23  
 DATE:

Woodford County Board of Education  
 OWNER *(Firm name)*  
 \_\_\_\_\_  
 SIGNATURE  
 PRINTED NAME AND TITLE  
 DATE:

**WCHS Phase #2 PR001 field changes-BP #02 GT**

Proposal To:

8.8.2023

**Trace Creek Construction**  
**Woodford County High School Phase #2**  
**Versailles, KY 40383**

Description:

*PR001 field changes*

Item	QTY	Unit	Unit \$	Cost
reduce concrete pad at shot-put & discuss ring	-180.55	sqyd	\$81.25	(\$14,669.69)
reduce synthetic surfacing for the "D" zone area	-787	sqyd	\$19.00	(\$14,953.00)
reduce asphalt paving for the "D" zone area	-503	sqyd	\$19.75	(\$9,934.25)

OHP @ 15% \$0.00

**Total Change Request** **(\$39,556.94)**

(RSD project mgr) Donnie Napier

Rising Sun Developing, Inc.  
 2555 Palumbo Drive, Ste 110  
 Lexington, KY 40509  
 859-543-0205 Ph/859-543-0230 Fax





# AIA Document G731™ – 2019

## Change Order, Construction Manager as Adviser Edition

**PROJECT:** *(name and address)*  
Woodford County High School Phase 2  
145 School House Road, Versailles, KY  
40383

**CONTRACT INFORMATION:**  
Contract For: BP03  
Date: February 27, 2023

**CHANGE ORDER INFORMATION:**  
Change Order Number: 03-01  
Date: 9/19/2023

**OWNER:** *(name and address)*  
Woodford County Board of Education  
330 Pisgah Pike, Versailles, KY 40383

**ARCHITECT:** *(name and address)*  
RossTarrant Architects  
101 Old Lafayette Avenue,  
Lexington, KY 40502

**CONSTRUCTION MANAGER:** *(name and address)*  
Trace Creek Construction, Inc.  
127 Market St., Vanceburg, KY 41179

**CONTRACTOR:** *(name and address)*  
Rising Sun Developing  
2555 Palumbo Drive, Ste 110, Lexington,  
KY 40509

**THE CONTRACT IS CHANGED AS FOLLOWS:**

*(Insert a detailed description of the change and, if applicable, attach or reference specific exhibits. Also include agreed upon adjustments attributable to executed Construction Change Directives.)*

- \* Relocate throwing events and modify existing layout per PR #01.
- \* (60) Days have been added to the construction schedule. 10 days for additional scope, and 50 for design/approval time. This 60 days also eliminates finish exposure to the 2023/2024 winter elements.

The original Contract Sum was	\$	527,920.58
Net change by previously authorized Change Orders	\$	0.00
The Contract Sum prior to this Change Order was	\$	527,920.58
The Contract Sum will be increased by this Change Order in the amount of	\$	87,502.15
The new Contract Sum including this Change Order will be	\$	615,422.73

The Contract Time will be increased by Sixty (60) days.  
The Contractor's Work shall be substantially complete on 5/15/2024.

**NOTE:** This Change Order does not include adjustments to the Contract Sum or Guaranteed Maximum Price, or the Contract Time, that have been authorized by Construction Change Directive until the cost and time have been agreed upon by both the Owner and Contractor, in which case a Change Order is executed to supersede the Construction Change Directive.

**NOT VALID UNTIL SIGNED BY THE ARCHITECT, CONSTRUCTION MANAGER, CONTRACTOR, AND OWNER.**

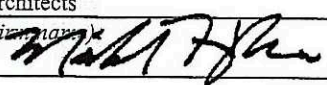
RossTarrant Architects  
 ARCHITECT *(Firm name)*  
  
 SIGNATURE Michael Hughes, Project Manager  
 PRINTED NAME AND TITLE  
 09/19/2023  
 DATE:

Trace Creek Construction, Inc.  
 CONSTRUCTION MANAGER *(Firm name)*  
  
 SIGNATURE Clay Ratliff, Vice President  
 PRINTED NAME AND TITLE  
 9/19/2023  
 DATE:

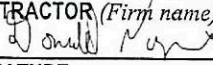
Rising Sun Developing  
 CONTRACTOR *(Firm name)*  
  
 SIGNATURE Donald Napier PM  
 PRINTED NAME AND TITLE  
 9/19/23  
 DATE:

Woodford County Board of Education  
 OWNER *(Firm name)*  
 SIGNATURE  
 PRINTED NAME AND TITLE  
 DATE:

**WCHS Phase #2 PR001 field changes-BP #03 Sports**

Proposal To: 8.8.2023  
**Trace Creek Construction**  
**Woodford County High School Phase #2**  
**Versailles, KY 40383**

Description:  
*PR001 field changes*

Item	QTY	Unit	Unit \$	Cost
added field curb on radius-materials	60	lf	\$22.50	\$1,350.00
added field curb on radius-labor	60	lf	\$15.83	\$949.80
added synthetic field stone, synthetic turf, shock pad, infill-materials	10,220	sqft	\$6.50	\$66,430.00
added synthetic field fabric-materials	9,291	sqft	\$0.17	\$1,570.18
added synthetic field fabric-labor	9,291	sqft	\$0.10	\$929.10
added synthetic field 4" drainage-materials	500	lf	\$2.29	\$1,145.00
added synthetic field 4" drainage-labor	500	lf	\$7.25	\$3,625.00
added synthetic field 6" drainage-materials	300	lf	\$3.82	\$1,146.00
added synthetic field 6" drainage-labor	300	lf	\$10.88	\$3,264.00
added synthetic field laser grade	9,291	sqft	\$0.25	\$2,322.75
added synthetic field stone, synthetic turf, shock pad, infill-materials-reduce OHP for above	66,430	dollars	-\$0.10	(\$6,643.00)
OHP @ 15%				\$11,413.32
<b>Total Change Request</b>				\$87,502.15

(RSD project mgr) Donnie Napier

Rising Sun Developing, Inc.  
 2555 Palumbo Drive, Ste 110  
 Lexington, KY 40509  
 859-543-0205 Ph/859-543-0230 Fax

