

FACPAC Contract Change Order

Supplemental Information Form (Ref# 58365)

Form Status: Saved

Tier 1 Project: Estill Springs Elementary Phase 2 Renovations & Addition - ESSER III
 BG Number: 22-207 District: Estill County (HB678)
 Status: Active Phase: Project Initiation (View Checklist)

Contract: Rising Sun Developing, Inc, 0002, General Trades
 Type: CM Bid Package Proposed

Change Order Number 2-9
 Time Extension Required No
 Date Of Change Order 8/2/2023
 Change Order Amount To Date Increase

Construction Contingency

Calculations below are project wide. Remaining negative Construction Contingency may require the submission of a revised BG1.

Current Approved Amount	\$264,164.35
Net Approved COs	\$270,992.17
Remaining After Approved COs	\$-6,827.82
Net All COs	\$316,926.69
Remaining After All COs	\$-52,762.34

This Requested Change Order Amount \$1,333.66

+/-

Change In A/E Fee This Change Order \$76.02

+/-

Change In CM Fee This Change Order \$52.01

+/-

Remaining Construction Contingency
 Balance

Contract Change Requested By Architect/Engineer

Contract Change Reason Code Improved Plans/Specs

Change Order Description And Justification

PR #14 - Provide and install break metal material to close cavity at exterior door location.

Cost Benefit To Owner

Improved condition

Contract unit prices have been utilized No
 to support the cost associated with this
 change order.

Detailed Cost Breakdown

Contract unit prices have not been utilized, provide a detailed cost breakdown which separates labor, material, profit and overhead.

Detail Item	Amount	Percent of Total
Labor	\$900.00	67.48%
Materials	\$259.70	19.47%
Profit and Overhead	\$173.96	13.04%
Bond Insurance		0.00%
Cost Breakdown Total:	\$1,333.66	
Cost for this Change Order supported by an alternate bid or competitive price quote	No	
Explain Why		

**Change Order Supplemental Information Form Signature
Page (Online Form Ref# 58365)**

Architect

Date

Construction Manager

Date

Finance Officer

Date

Local Board of Education Designee

Date

AIA[®] Document G701/CMa[™] – 1992

Change Order - Construction Manager-Adviser Edition

OWNER ☒
CONSTRUCTION MANAGER ☐
ARCHITECT ☐
CONTRACTOR ☐
FIELD ☐
OTHER ☐

PROJECT (Name and Address)
ESTILL SPRINGS ELEMENTARY SCHOOL
314 MAIN STREET
IRVINE, KY 40336

CHANGE ORDER NUMBER: 02-09
INITIATION DATE: 8/2/2023

TO CONTRACTOR (Name and Address)
RISING SUN DEVELOPING, INC.
2555 PALUMBO DRIVE
SUITE 110

PROJECT NUMBERS: 000778
CONTRACT DATE: 8/15/2022
CONTRACT FOR: BID PACKAGE #02 GENERAL TRADES

THE CONTRACT IS CHANGED AS FOLLOWS: PR #14 - Provide break metal cover at open cavity at Exterior Door.

The original Contract Sum was	1,449,703.00
Net change by previously authorized Change Orders	218,086.39
The Contract Sum prior to this Change Order was	1,667,789.39
The Contract Sum will be Increased by this Change Order in the amount of	1,333.66
The new Contract Sum including this Change Order will be	1,669,123.05

The Contract Time will be adjusted by 0 days.
The date of Substantial Completion as of the date of this Change Order therefore is 6/2/2023.

NOT VALID UNTIL SIGNED BY THE CONSTRUCTION MANAGER, ARCHITECT, CONTRACTOR AND OWNER.

CODELL CONSTRUCTION COMPANY

CONSTRUCTION MANAGER (Firm Name)
4475 ROCKWELL ROAD WINCHESTER, KY 40391

ADDRESS

BY (Signature)

(Typed Name)

DATE:

RISING SUN DEVELOPING, INC.

CONTRACTOR (Firm Name)
2555 PALUMBO DRIVE*SUITE 110*LEXINGTON, KY 40509

ADDRESS

BY (Signature)

(Typed Name)

DATE:

ROSS-TARRANT ARCHITECTS INC.

ARCHITECT (Firm Name)
101 OLD LAFAYETTE AVE LEXINGTON, KY 40502

ADDRESS

BY (Signature)

(Typed Name)

DATE:

ESTILL COUNTY BOARD OF EDUCATION

OWNER (Firm Name)
253 MAIN STREET IRVINE, KY 40336

ADDRESS

BY (Signature)

(Typed Name)

DATE:

AIA Document G701/CMa[™] – 1992. Copyright © 1992 by The American Institute of Architects. All rights reserved. **WARNING: This AIA[®] Document is protected by U.S. Copyright Law and International Treaties. Unauthorized reproduction or distribution of this AIA[®] Document, or any portion of it, may result in severe civil and criminal penalties, and will be prosecuted to the maximum extent possible under the law.**

User Notes:

(1884033357)

PR#14 --

Proposal To: Codell Construction

7/12/2023

Estill Springs Elementary

Attn- Kenny Davis

Irvine, KY

Description: PR#14

Provide Material and Labor per direction in PR #14

See Deduct line to go to painted steel

Item	QTY	Unit	Unit \$	Cost
Material				
Material				\$ -
Brake Metal	1	lot	\$190.00	\$ 190.00
Plywood	1	lot	\$55.00	\$ 55.00
				\$ -
				\$ -
Excludes Paint and Joint Sealant				
				\$ -
Labor				
2 Men 6 hrs each	12	per	\$75.00	\$ 900.00
				\$ -
				\$ -
				\$ -
Summary				
				\$ -
Material	1	ea	\$245.00	\$ 245.00
Labor	1	ea	\$900.00	\$ 900.00
Tx On Material	0.06	\$	\$245.00	\$ 14.70
OHP @ 15%	0.15	\$	\$ 1,159.70	\$ 173.96

Add**\$1,333.66**

Shane Carpenter

OPS Manager

Rising Sun Developing, Inc.

2555 Palumbo Drive, Ste 110

Lexington, KY 40509

Phone: 859-543-0205 / Fax: 859-543-0230



Kenny Davis

From: Jonathan Ruiz <jruiz@rosstarrant.com>
Sent: Wednesday, July 19, 2023 9:41 AM
To: Kenny Davis; Reva Traugott
Cc: Shauna Taylor
Subject: RE: Estill Co Elem - PR 14 Pricing

Yes, pricing on the lintel PR has been reviewed and found acceptable to recommend to the Owner. Ill check on the status of the Undercutting Pavement PR.

Thanks,



JONATHAN RUIZ AIA, LEED Green Associate, NCARB, NOMA
project architect

rosstarrant architects
101 old lafayette avenue lexington, kentucky 40502
p 859.254.4018 x1394 | www.rosstarrant.com | [facebook](https://www.facebook.com/rostartarrant)

From: Kenny Davis <KDavis@codellconstruction.com>
Sent: Wednesday, July 19, 2023 8:43 AM
To: Reva Traugott <rtraugott@codellconstruction.com>; Jonathan Ruiz <jruiz@rosstarrant.com>
Subject: RE: Estill Co Elem - PR 14 Pricing

Jonathan,

Need both pricing for the Brake Metal and the undercutting of parking lots and roads. I have to write change orders to get on board agenda soon.

Thanks
Kenny

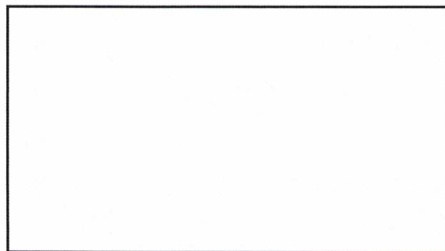

Kenny Davis

Project Manager | **Codell Construction Company**

A: 4475 Rockwell Road Winchester, KY 40391

P: 859.744.2222 ext. 220 **C:** 606.794.6217

E: kdavis@codellconstruction.com **W:** codellconstruction.com



Codell Construction Company will never request or provide proprietary information (checking, credit card, security codes, etc.) via email. Please contact your Codell representative directly to confirm or provide such information. Do not open attachments or forward this email unless you recognize the sender, the sender's email domain and you know the content is safe.

From: Reva Traugott <rtraugott@codellconstruction.com>
Sent: Wednesday, July 19, 2023 8:40 AM



Proposal Request Transmittal

RossTarrant Architects | 101 Old Lafayette Ave Lexington KY 40502 United States

PROJECT: Estill Springs ES Phase 2 Ren-Add 2148 DATE SENT: 6/27/2023
RETURN BY: 7/11/2023
SUBJECT: PR 14 - Revised Masonry Section Detail PROPOSAL REQUEST ID: PR 14
TYPE: Proposal Request TRANSMITTAL ID: 00546
PURPOSE: For Contractor's Pricing VIA: Info Exchange

FROM

NAME	COMPANY	EMAIL	PHONE
Shauna Wietzki	RossTarrant Architects	swietzki@rosstarrant.com	859-254-4018

TO

NAME	COMPANY	EMAIL	PHONE
rtraugott@codellconstruction.com		rtraugott@codellconstruction.com	

REMARKS: See attached.

DESCRIPTION OF CONTENTS

QTY	DATED	TITLE	NUMBER	SCALE	SIZE	NOTES
1	6/27/2023	PR 14 - Revised Masonry Section Detail.pdf				

DATE:	June 27 th , 2023	PR #:	14
TO:	Codell Construction Company 4475 Rockwell Rd Winchester, KY 40391 859.744.2222 Codellconstruction.com	RE:	Estill Springs Elementary Phase 2 Renovation & Addition Estill County, Kentucky BG 22-207 RTA 2148

Please submit an itemized quotation for changes in the Contract Sum and/or Time incidental to proposed modifications to the Contract Documents described therein.

THIS IS NOT A CHANGE ORDER NOR A DIRECTION TO PROCEED WITH THE WORK DESCRIBED HEREIN.

DESCRIPTION:

Contractor to provide a detailed price breakdown for all labor, material, and equipment costs per the following and attached sketch to correct an observed site condition.

- Revise detail H/A5.1 per attached sketch to close cavity in masonry wall.
- Proposal to price substrate/plywood, brake metal, paint, and joint sealant.

ATTACHMENTS:

Site Photos

PR14.1 – REVISED MASONRY SECTION DETAIL

BY: Jonathan Ruiz, AIA, LEED Green Associate,
NCARB, NOMA

c: Shauna Wietzki - RTA
File 2148-
PR-14-2148



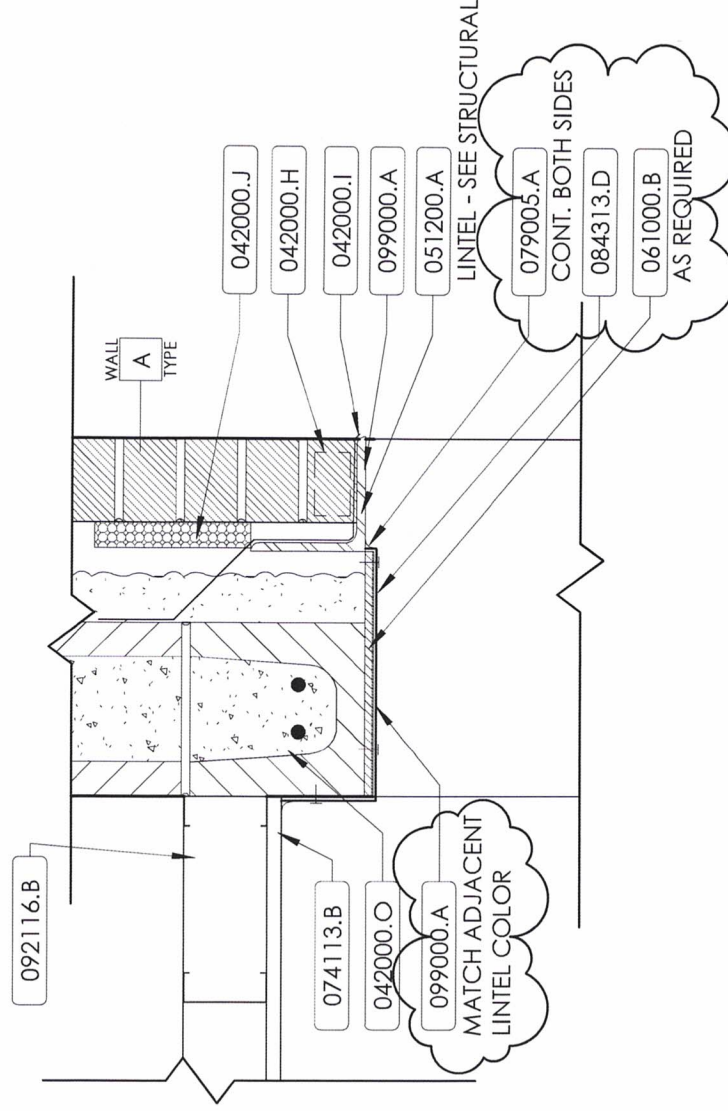

SECTION DETAIL

1 1/2" = 1'-0"

A
PR14