

DATE:

6/16/2023

AGENDA ITEM (ACTION ITEM):

Consider / Approve the proposed change to the District's boundary for 5012 Sandman Drive, Covington, Kentucky 41017.

APPLICABLE BOARD POLICY:

702 KAR 4:160

HISTORY/BACKGROUND:

It is necessary to change the boundary of 5012 Sandman Drive, Covington, Kentucky 41017 due to transportation routes. This residence is the last house on a small street that is only accessible from Pride Parkway. The residence is currently districted to Summit View Elementary School, Summit View Middle School, and Scott High School. All other residences on that street and the surrounding streets/neighborhoods are districted to go to Fort Wright Elementary, Woodland Middle School, and Scott High School.

FISCAL/BUDGETARY IMPACT:

None

RECOMMENDATION:

Approve the proposed change to the District's Boundary for 5012 Sandman Drive, Covington, Kentucky 41017.

CONTACT PERSON:

Matt Rigg, Chief Operations Officer

Principal/Administrator

Matt Rigg
District Administrator

Superintendent

Use this form to submit your request to the Superintendent for items to be added to the Board Meeting Agenda

Principal – Complete, print, sign and send to your Director. Director – if approved, sign and put in the Superintendent's mailbox

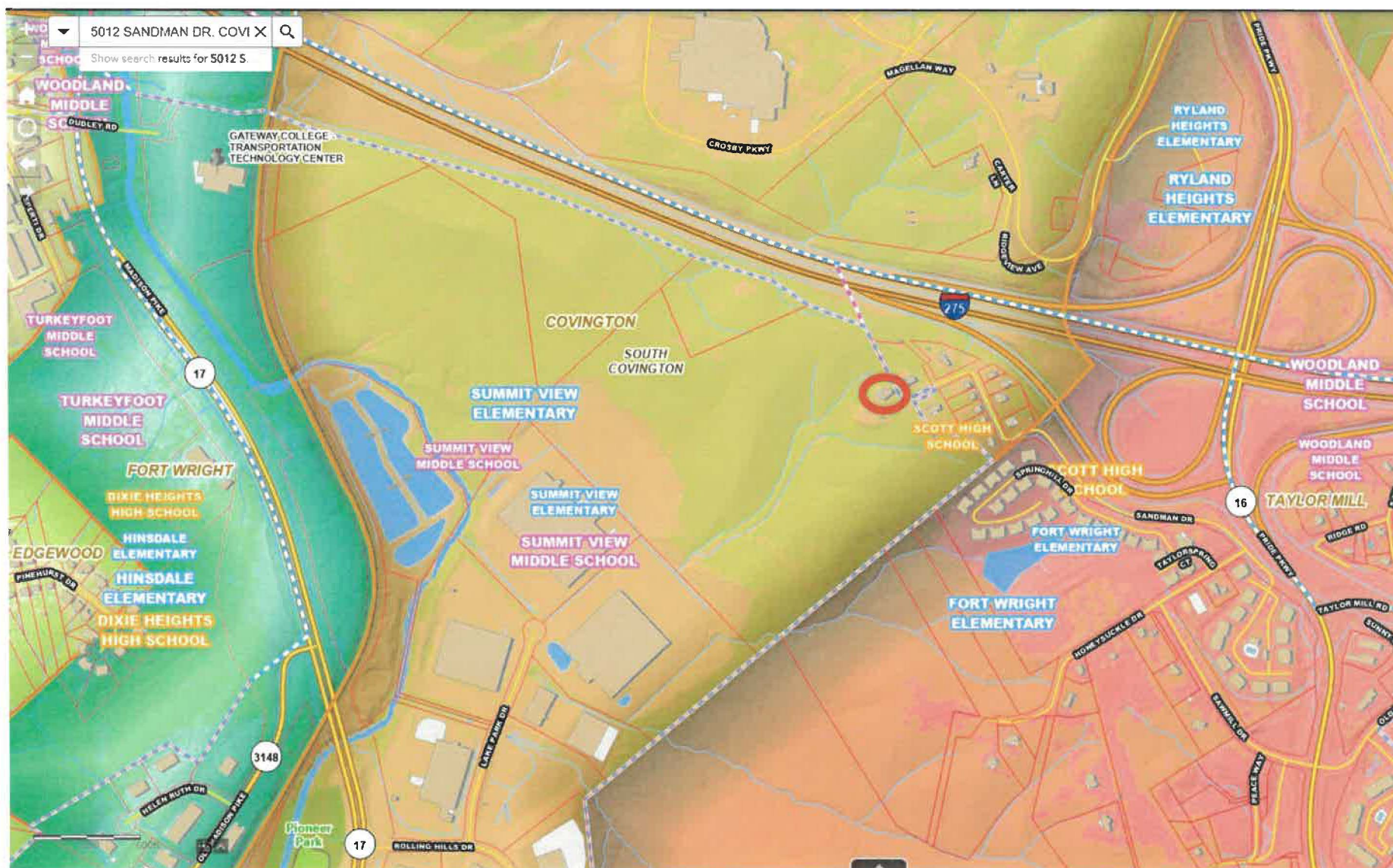

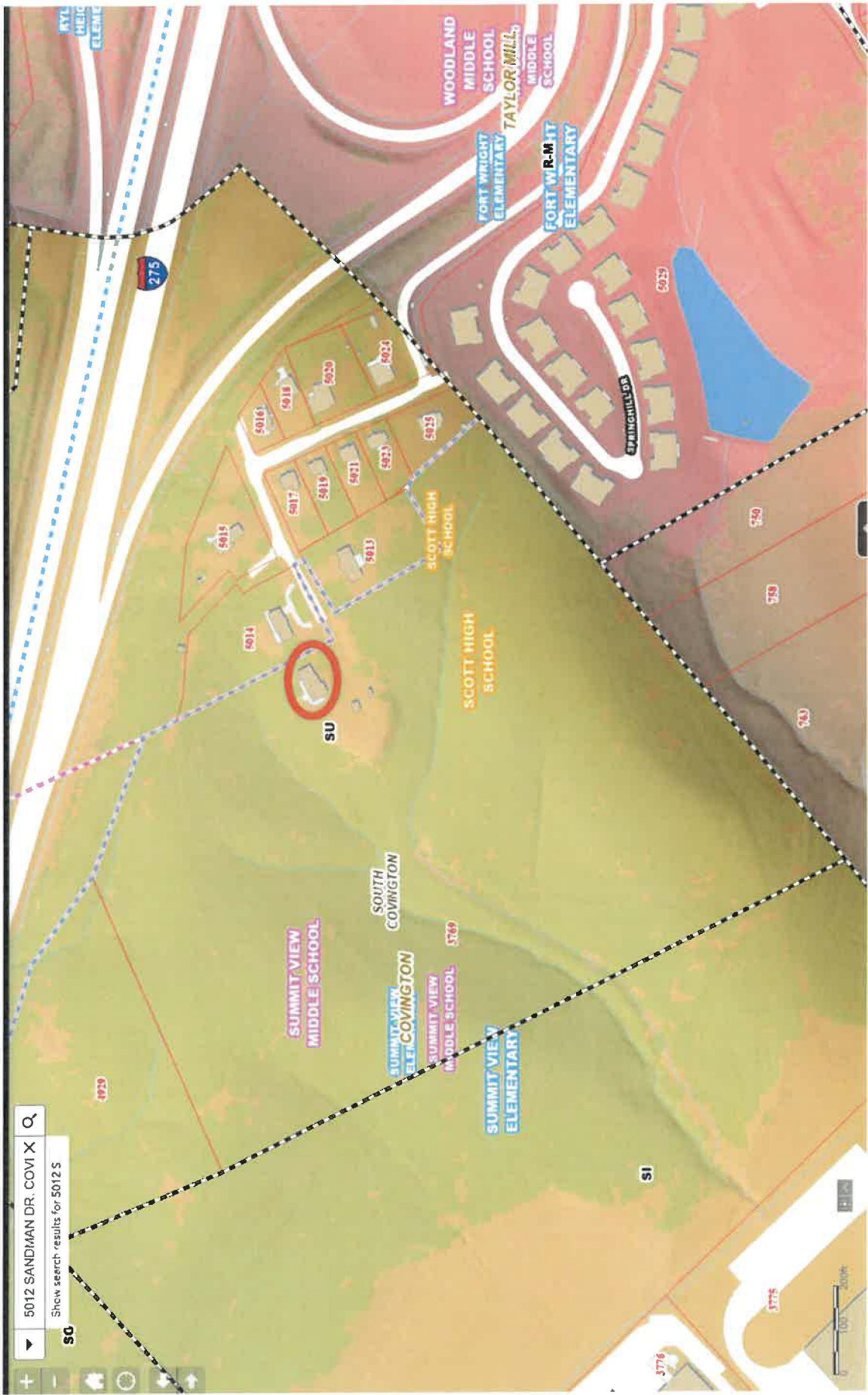



A map showing school district boundaries. A large blue area on the left is labeled 'RC HISNDALE LEMEN-TARY SCHOOL'. A large yellow area on the right is labeled 'FORT WRIGHT ELEMEN-TARY SCHOOL'. A pink area in the center is labeled 'SUMMIT VIEW ELEMEN-TARY SCHOOL'. Within the pink area, there is a hatched green parcel. A red box next to this parcel contains the text: 'PIDN: 043-00-00-100.00' and 'WAS SUMMIT VIEW ELEMENTARY, SUMMIT VIEW MIDDLE, AND SCOTT HIGH SCHOOLS'. The map also shows some roads and a highway shield for I-75.

RC HISNDALE LEMEN-TARY SCHOOL

FORT WRIGHT ELEMEN-TARY SCHOOL

PIDN: 043-00-00-100.00

WAS SUMMIT VIEW
ELEMENTARY, SUMMIT
VIEW MIDDLE, AND
SCOTT HIGH SCHOOLS

SUMMIT VIEW ELEMEN-TARY SCHOOL