

DATE:	February 13, 2023	CO #: 01	One (1)
TO:	Jarboe Construction, Inc. 1017 South Broadway Lexington, KY 40504	PROJECT:	ESTILL COUNTY SAFETY AND ADA UPGRADES Irvine, Kentucky BG# 23-087 RTA 2253
CONTRACT DATE:	December 15, 2022	CONTRACT FOR:	General Construction

THE CONTRACT IS CHANGED AS FOLLOWS:

Demo / replacement of door CB's existing metal frame.  
Reinstalling door panel and door hardware into new frame. \$1775.60

Lock / key cylinder type change on doors 135.1, 135.2, 136, 137. (\$2,029.75)

TOTAL AMOUNT OF THIS CHANGE ORDER: **(\$254.15)**

The original Contract Sum was \$252,000.00

The net change by previously authorized Change Orders \$0.00

The Contract Sum prior to this Change Order was \$252,000.00

The Contract Sum will be **decreased** by this Change Order in the amount of (\$254.14)

The new Contract Sum including this Change Order will be \$251,745.86

The Contract Time will be Increased 0 days

The Date of Substantial Completion as of the date of this Change Order is therefore April 10, 2023

NOTE: This Change Order does not include changes in the Contract Sum, Contract Time or Guaranteed Maximum Price which have been authorized by Construction Change Directive until the cost and time have been agreed upon by both the Owner and Contractor, in which case a Change Order is executed to supersede the Construction Change Directive.

Rosstarrant Architects, Inc.  
101 Old Lafayette Avenue  
Lexington, Kentucky 40502

**ARCHITECT** (Firm name and address)

**BY** (Signature)

(Typed or printed name)

**DATE**

Jarboe Construction, Inc.  
1017 South Broadway  
Lexington, KY 40504

**CONTRACTOR** (Firm name and address)

**BY** (Signature)

**John L Haddix**

(Typed or printed name)

**DATE**

02-14-2023

Estill County Board of Education  
253 Main Street  
Irvine, Kentucky 40336

**OWNER** (Firm name and address)

**BY** (Signature)

(Typed or printed name)

**DATE**



January 25, 2023

Ross Tarrant Architects, Inc.  
101 Old Lafayette Avenue  
Lexington, KY 40502

Owner: Estill County Board of Education  
253 Main Street  
Irvine, KY 40336

Project: Estill County Safety and ADA Upgrades, BG-23-087, RTA 2146  
Request: PR01 Issued on Dated 01/24/2023

Response to the PR01 New Exterior Hollow Metal Frame @ Door CB

Per the request for demo of one existing metal frame and replacing it with a new frame.  
Reinstall existing door hardware as necessary for electrical strike function.

PRICE:-----\$1,775.60

Deduct to change locks and cylinders on doors 135.1, 135.2 136 & 137.1

Deduct Amount:-----\$2,029.75

Deduct Amount to Contract PR1 - \$254.15

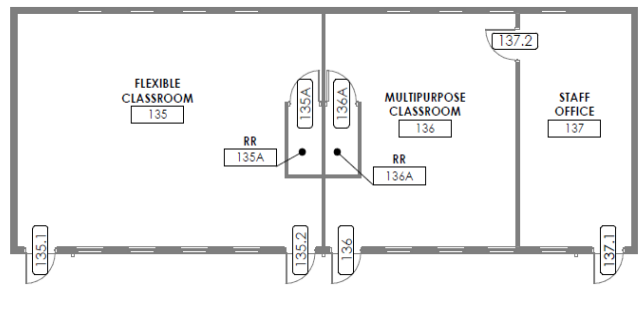
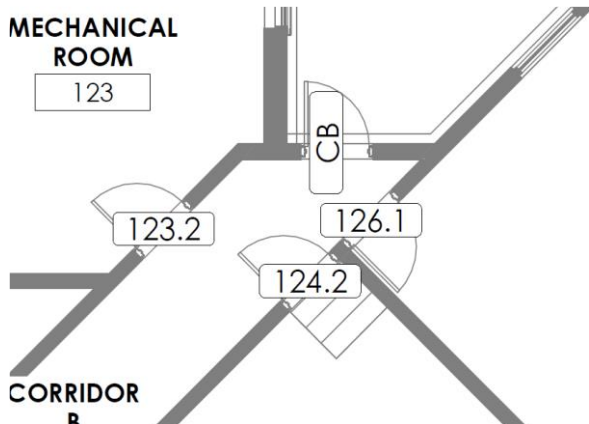

John L. Haddix, Project Manager, Designer

1017 South Broadway Lexington, Kentucky 40504 (859) 277-2403 Fax: (859) 277-9109

**CONTRACTORS CHOICE, INC.**  
420 Fairman Court  
Lexington, KY 40511  
Phone: 859-255-5637  
Fax: 859-233-9561

QUOTATION NO. EQ-013-4132

Page: 1 of 1  
Project: Estill Middle School

Date: January 25, 2023

TO: Estill County School  
Attn: John Haddix

<u>QUANTITY</u>	<u>DESCRIPTION OF WORK</u>	<u>PRICE</u>
	<b>Frame for Opening CB</b>	
1 ea.	Hollow Metal Frame – 3070 – 5 3/4” – Knocked Down EO Anchors	
1 ea.	Labor to Tear out and Install	
	<b>Add for the sum of</b>	<b>\$ 1,544.00</b>
<hr/>		
	<b>Deduct to change locks and cylinder on doors 135.1,135.2,136 &amp; 137.1</b>	
1 lot	Deduct Hardware	
	4 ea. Mortise Lockset ML2067 PSR 626	
	4 ea. Wrap Around Plate 514-S-CW	
	4 ea. High Security Cylinder 5153-6 x 626	
	Added Hardware	
	4 ea. Cylindrical Lockset PB5405LN X 626	
	<b>Deduct the sum of</b>	<b>\$ 1,765.00</b>

Notes:

1. All materials are FOB TRUCKS JOBSITE.
2. Prices quoted shall be valid for 30 days from date of this quotation.

Quotation by: Eddie Wagoner

**GENERAL DEMOLITION NOTES**

1. THE CONTRACTOR SHALL BE RESPONSIBLE FOR ALL DEMOLITION WORK. THE CONTRACTOR SHALL BE RESPONSIBLE FOR OBTAINING ALL NECESSARY PERMITS AND APPROVALS FROM THE LOCAL AUTHORITIES.
2. THE CONTRACTOR SHALL BE RESPONSIBLE FOR OBTAINING ALL NECESSARY PERMITS AND APPROVALS FROM THE LOCAL AUTHORITIES.
3. THE CONTRACTOR SHALL BE RESPONSIBLE FOR OBTAINING ALL NECESSARY PERMITS AND APPROVALS FROM THE LOCAL AUTHORITIES.
4. THE CONTRACTOR SHALL BE RESPONSIBLE FOR OBTAINING ALL NECESSARY PERMITS AND APPROVALS FROM THE LOCAL AUTHORITIES.
5. THE CONTRACTOR SHALL BE RESPONSIBLE FOR OBTAINING ALL NECESSARY PERMITS AND APPROVALS FROM THE LOCAL AUTHORITIES.
6. THE CONTRACTOR SHALL BE RESPONSIBLE FOR OBTAINING ALL NECESSARY PERMITS AND APPROVALS FROM THE LOCAL AUTHORITIES.
7. THE CONTRACTOR SHALL BE RESPONSIBLE FOR OBTAINING ALL NECESSARY PERMITS AND APPROVALS FROM THE LOCAL AUTHORITIES.
8. THE CONTRACTOR SHALL BE RESPONSIBLE FOR OBTAINING ALL NECESSARY PERMITS AND APPROVALS FROM THE LOCAL AUTHORITIES.
9. THE CONTRACTOR SHALL BE RESPONSIBLE FOR OBTAINING ALL NECESSARY PERMITS AND APPROVALS FROM THE LOCAL AUTHORITIES.
10. THE CONTRACTOR SHALL BE RESPONSIBLE FOR OBTAINING ALL NECESSARY PERMITS AND APPROVALS FROM THE LOCAL AUTHORITIES.

**DEMOLITION NOTES PR 4**

1. DEMOLISH EXISTING CONCRETE WALLS AND FOUNDATIONS AS SHOWN ON DRAWING.
2. DEMOLISH EXISTING CONCRETE WALLS AND FOUNDATIONS AS SHOWN ON DRAWING.
3. DEMOLISH EXISTING CONCRETE WALLS AND FOUNDATIONS AS SHOWN ON DRAWING.
4. DEMOLISH EXISTING CONCRETE WALLS AND FOUNDATIONS AS SHOWN ON DRAWING.
5. DEMOLISH EXISTING CONCRETE WALLS AND FOUNDATIONS AS SHOWN ON DRAWING.
6. DEMOLISH EXISTING CONCRETE WALLS AND FOUNDATIONS AS SHOWN ON DRAWING.
7. DEMOLISH EXISTING CONCRETE WALLS AND FOUNDATIONS AS SHOWN ON DRAWING.
8. DEMOLISH EXISTING CONCRETE WALLS AND FOUNDATIONS AS SHOWN ON DRAWING.
9. DEMOLISH EXISTING CONCRETE WALLS AND FOUNDATIONS AS SHOWN ON DRAWING.
10. DEMOLISH EXISTING CONCRETE WALLS AND FOUNDATIONS AS SHOWN ON DRAWING.

**DEMOLITION NOTES PR 4**

1. DEMOLISH EXISTING CONCRETE WALLS AND FOUNDATIONS AS SHOWN ON DRAWING.
2. DEMOLISH EXISTING CONCRETE WALLS AND FOUNDATIONS AS SHOWN ON DRAWING.
3. DEMOLISH EXISTING CONCRETE WALLS AND FOUNDATIONS AS SHOWN ON DRAWING.
4. DEMOLISH EXISTING CONCRETE WALLS AND FOUNDATIONS AS SHOWN ON DRAWING.
5. DEMOLISH EXISTING CONCRETE WALLS AND FOUNDATIONS AS SHOWN ON DRAWING.
6. DEMOLISH EXISTING CONCRETE WALLS AND FOUNDATIONS AS SHOWN ON DRAWING.
7. DEMOLISH EXISTING CONCRETE WALLS AND FOUNDATIONS AS SHOWN ON DRAWING.
8. DEMOLISH EXISTING CONCRETE WALLS AND FOUNDATIONS AS SHOWN ON DRAWING.
9. DEMOLISH EXISTING CONCRETE WALLS AND FOUNDATIONS AS SHOWN ON DRAWING.
10. DEMOLISH EXISTING CONCRETE WALLS AND FOUNDATIONS AS SHOWN ON DRAWING.

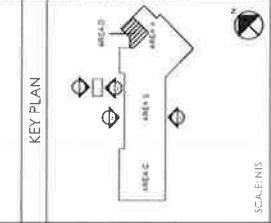

**DOOR AND FRAME SCHEDULE - PR 4**

DOOR NUMBER	TYPE	FINISH	GLASS	GLASS TYPE	GLASS COLOR	GLASS PATTERN	GLASS TREATMENT	GLASS COLOR	GLASS PATTERN	GLASS TREATMENT	COMMENTS
101	SWING	WOOD	GLASS	GLASS	GLASS	GLASS	GLASS	GLASS	GLASS	GLASS	
102	SWING	WOOD	GLASS	GLASS	GLASS	GLASS	GLASS	GLASS	GLASS	GLASS	
103	SWING	WOOD	GLASS	GLASS	GLASS	GLASS	GLASS	GLASS	GLASS	GLASS	
104	SWING	WOOD	GLASS	GLASS	GLASS	GLASS	GLASS	GLASS	GLASS	GLASS	
105	SWING	WOOD	GLASS	GLASS	GLASS	GLASS	GLASS	GLASS	GLASS	GLASS	
106	SWING	WOOD	GLASS	GLASS	GLASS	GLASS	GLASS	GLASS	GLASS	GLASS	
107	SWING	WOOD	GLASS	GLASS	GLASS	GLASS	GLASS	GLASS	GLASS	GLASS	
108	SWING	WOOD	GLASS	GLASS	GLASS	GLASS	GLASS	GLASS	GLASS	GLASS	
109	SWING	WOOD	GLASS	GLASS	GLASS	GLASS	GLASS	GLASS	GLASS	GLASS	
110	SWING	WOOD	GLASS	GLASS	GLASS	GLASS	GLASS	GLASS	GLASS	GLASS	

