



July 29, 2022

**Clearfield Elementary School Renovation & Addition  
BG 21-048  
Change Order Request  
CO 300-02**

**To: Peter Fischer**

**From: Bob Rose**

**Re: Clearfield Elementary**

**Peter,**

**Please review and advise upon the recommendation to the Owner to consider or reject this proposal as outlined below and on accompanying information.**

**Provide pricing to remove and replace floor slab per PR13**

**Labor and Material = \$2,157.00**

---

**Total this change = Add \$2,157.00**

# Frederick & May Construction Company, Inc.

## CHANGE ORDER REQUEST

**REQUEST #:** PR #13  
**DESCRIPTION:** Floor Slab Replacement

**PROJECT:** Clearfield Elementary Renovation and Addition  
**ADDRESS:** 460 McBrayer Road  
 Clearfield, Kentucky 40313

**TO:** Packs + Walker  
**ATTN:** Bob Rose  
**ADDRESS:** 75 Baldrige Road  
 Morehead, Kentucky 40351

**DATE:** 5/25/2022

	ITEM DESCRIPTION	QUAN.	UNIT	MATERIAL		SUB/LABOR AND OR EQUIPMENT		
				PER	DOLLARS	UNIT	PER	DOLLARS
1				\$ -	\$ -		\$ -	\$ -
2	Demolition (2 Men // 5 Hours)	10	HRS	\$ -	\$ -	HRS	\$ 44.25	\$ 442.50
3				\$ -	\$ -		\$ -	\$ -
4	Concrete Replacement Labor	24	HRS	\$ -	\$ -	HRS	\$ 44.25	\$ 1,062.00
5	(3 Men // 8 Hours)			\$ -	\$ -		\$ -	\$ -
6				\$ -	\$ -		\$ -	\$ -
7	Materials	1	LS	\$ 350.00	\$ 350.00		\$ -	\$ -
8				\$ -	\$ -		\$ -	\$ -
9				\$ -	\$ -		\$ -	\$ -
10				\$ -	\$ -		\$ -	\$ -
11				\$ -	\$ -		\$ -	\$ -
12				\$ -	\$ -		\$ -	\$ -
13				\$ -	\$ -		\$ -	\$ -
14				\$ -	\$ -		\$ -	\$ -
15				\$ -	\$ -		\$ -	\$ -
16				\$ -	\$ -		\$ -	\$ -
17				\$ -	\$ -		\$ -	\$ -
SUBTOTALS					\$ 350			\$ 1,504.50

SUMMARY		
MATERIALS	\$	350.00
TAX	\$	21.00
SUB/LABOR	\$	1,504.50
SUBTOTALS	\$	1,875.50
OVERHEAD 10%	\$	187.55
PROFIT 5%	\$	93.78
TOTAL COST	\$	2,157

Additional time Requested 1 Calendar Days

### QUALIFICATIONS

- 1) Pricing base on F&M wages with burden.
- 2)
- 3)

DATE:	May 19, 2022	PR #:	13
TO:	Packs + Walker Construction Co. 75 Baldrige Road Morehead, KY 40351	RE:	Clearfield Elementary Renovations & Additions Rowan County, Kentucky BG 21-048 RTA 2037

---

*Please submit an itemized quotation for changes in the Contract Sum and/or Time incidental to proposed modifications to the Contract Documents described therein.*

THIS IS NOT A CHANGE ORDER NOR A DIRECTION TO PROCEED WITH THE WORK DESCRIBED HEREIN.

---

DESCRIPTION:

Refer to sheets D1.1 & A1.1.

Provide a detailed pricing breakdown for all labor, material, and equipment costs associated with replacing the existing portion of concrete slab within FRC 101 to provide a new level floor condition as shown on the attached sketches.

- Extent of slab removal shall coordinate with the new door frame and the adjacent underslab trenching area indicated in RFI 40.
- Contractor to feather the new slab edge as needed to transition to the existing slab @ a 2% maximum slope. Feathering product to be comparable to a high strength cement self-leveling underlayment to achieve the transition.

This is not a change order nor a direction to proceed with the work described herein.

ATTACHMENTS:

PR 13.1

---

BY: Jonathan Ruiz AIA, LEED Green Associate, NCARB, NoMA

c: Peter Fisher – RTA  
Katie Mitchell – RTA  
File 2037-4b1  
PR-13-2037

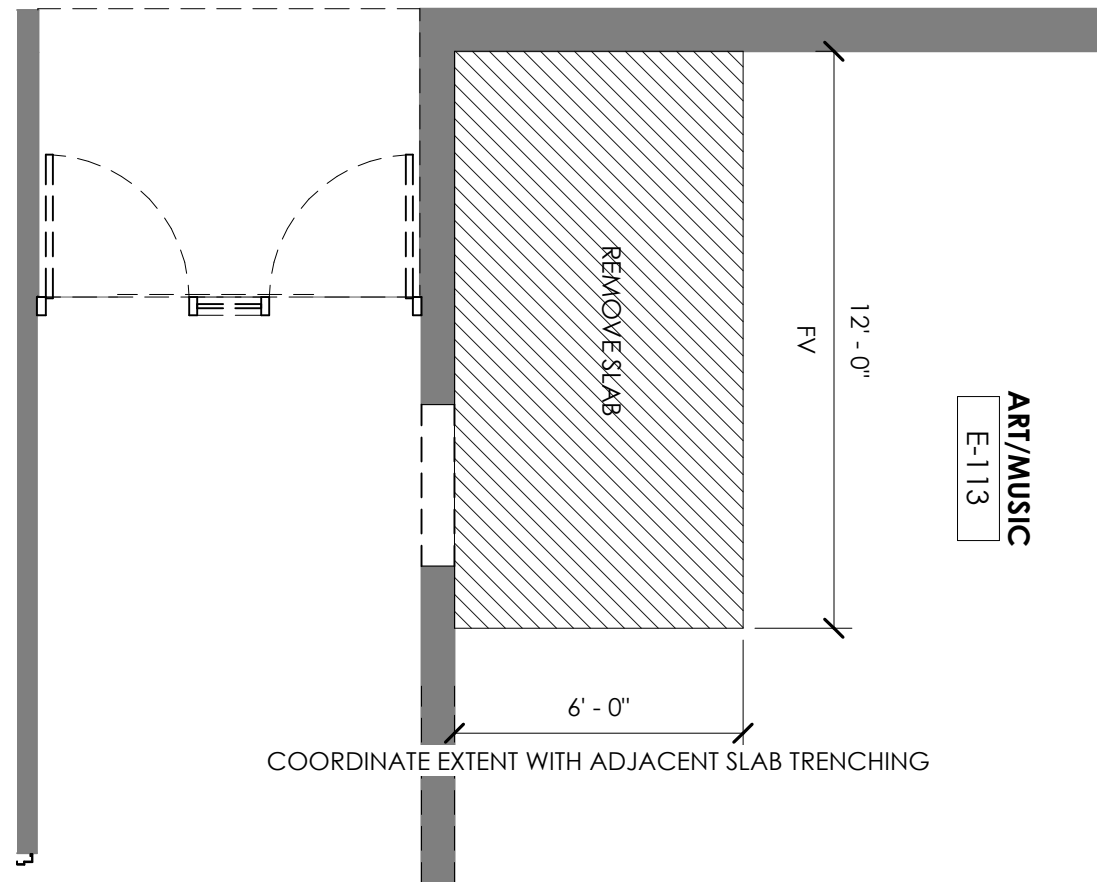

FLOOR DEMOLITION PLAN

1/4" = 1'-0"

A  
PR13.1

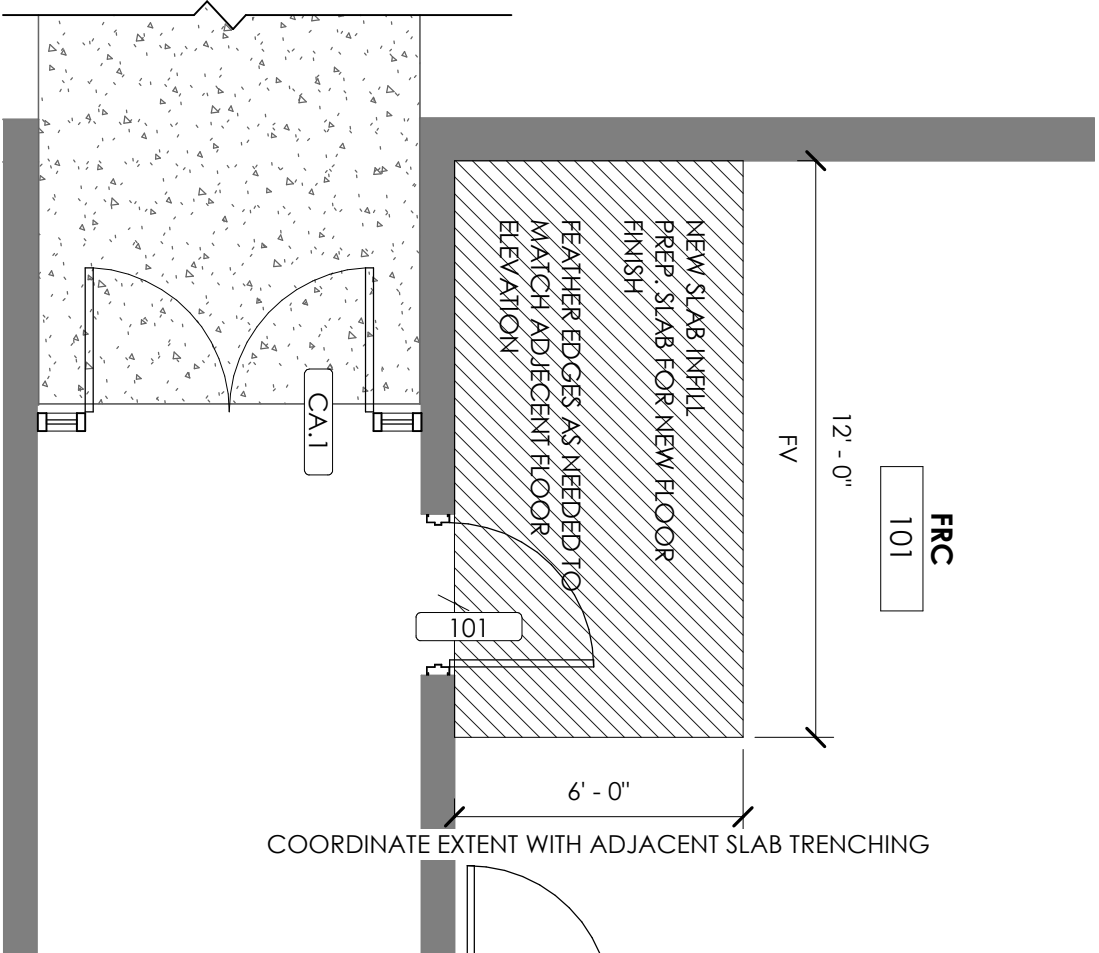

FLOOR PLAN

1/4" = 1'-0"

B  
PR13.1

PR#13 - FLOOR SLAB REPLACEMENT  
 CLEARFIELD ELEMENTARY SCHOOL RENOVATION & ADD.  
 FOR:  
 ROWAN COUNTY BOARD OF EDUCATION  
 460 McBrayer Road, Clearfield, Kentucky 40313

**rosstarrant**  
 architects

101 old lafayette avenue lexington, kentucky 40502 p 859.254.4018

Date	05/11/22
Project	2037
Drawn	Author
Checked	Checker
SHEET REF.	D1.1 , A1.1
Revisions	
COPYRIGHT	© 2020

PR13.1

05/11/22