



February 2, 2022

John Gilbert, AIA
Facilities Branch – Division of District Support
Kentucky Department of Education
Office of Finance and Operations
300 Sower Blvd, 4th Floor
Frankfort, KY 40601

**Re: Waiver Request to Decentralize Media Center
Christian Co. - New Consolidated High School
Schematic Design Review - Response
BG 22-104**

Dear John:

We are writing on behalf of the Christian County School District to petition a waiver in accordance with 702 KAR 4:170, Part b, waivers:

Decentralized Media Center

The Christian County Board of Education has approved Schematic and Design Development plans for the above referenced project, based on a program that was achieved through multiple meetings with school district personnel. The KDE program for a 2500-student elementary school requires one (1) 11,000s.f. media center. The school's program has been developed around Academies related to certain areas of study, and each academy is planned to function as a 'school within a school'. The related curriculum places an emphasis on integrating centralized activities traditionally contained within a larger centralized media center into each academy.

The plans for the new high school has broken out the media centers as follows:

- 1) All School Media Center - This media center is approximately 2775 SF. This media center is centrally located and will be shared between all academies and to allow for cross-academy project collaboration. It houses the school's AV Storage and has two student conference rooms. At this time, the librarian has requested that she not have an office but would rather be stationed at a mobile circulation desk in the main library room. In the future, if this an office is desired, one of the conference rooms can be converted to an office as it contains the KDE required sink and base cabinet.
- 2) Academy Media Centers - Six (6) total, approximately 1,500 SF each. Each academy has its own media center, with the freshman academy containing two media centers. These media centers will contain media, publications and periodicals related to each academy's focus of study in the media storage room, and will house periodical carousels, study areas and collaboration areas in the main portion. Also in these media centers is a work room for use of the academy teachers for use of copying, scanning, and preparing documents from the media center's volumes for use in lessons.

Thank you,

A handwritten signature in black ink, appearing to read 'E. Rang' with a stylized flourish at the end.

Eric Rang, AIA
HAFER

CC: Christopher Bentzel, Christian County Public Schools
Josh Hunt, Christian County Public Schools
Jack Faber, Hafer

Attachment: Plan showing location of media center in building & enlarged media plans.

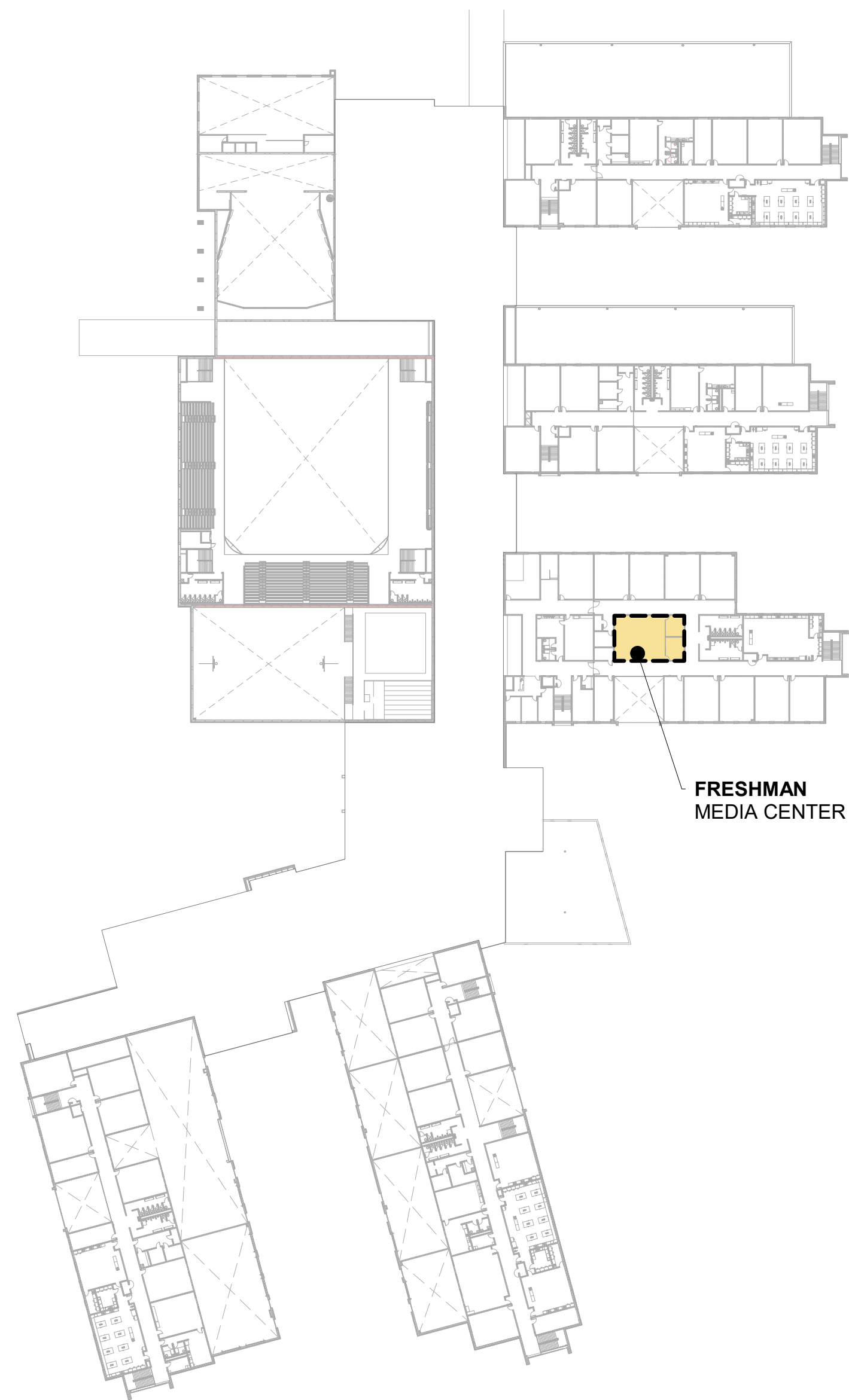

SECOND FLOOR PLAN

1" = 80'-0"

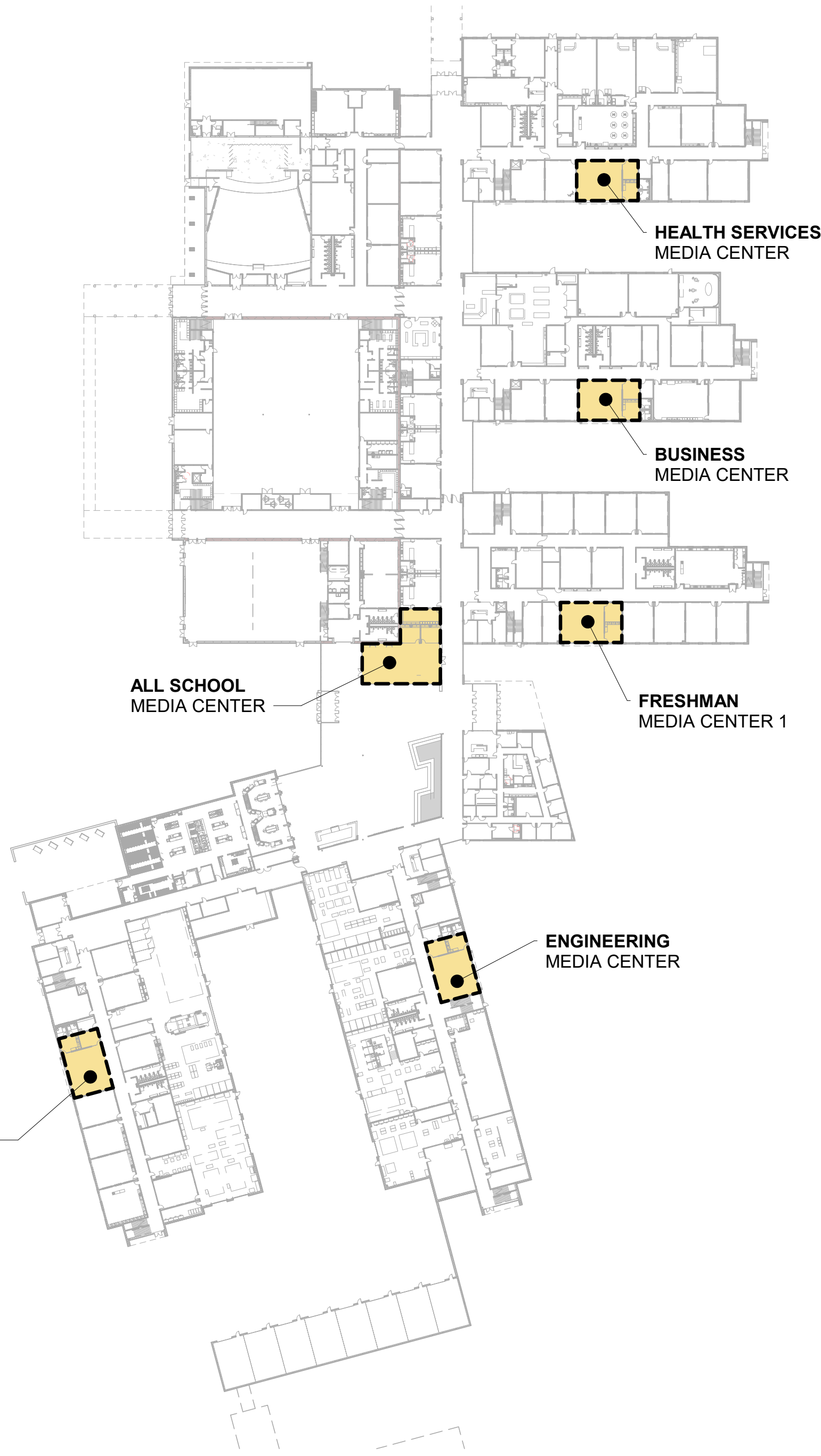

FIRST FLOOR PLAN

1" = 80'-0"

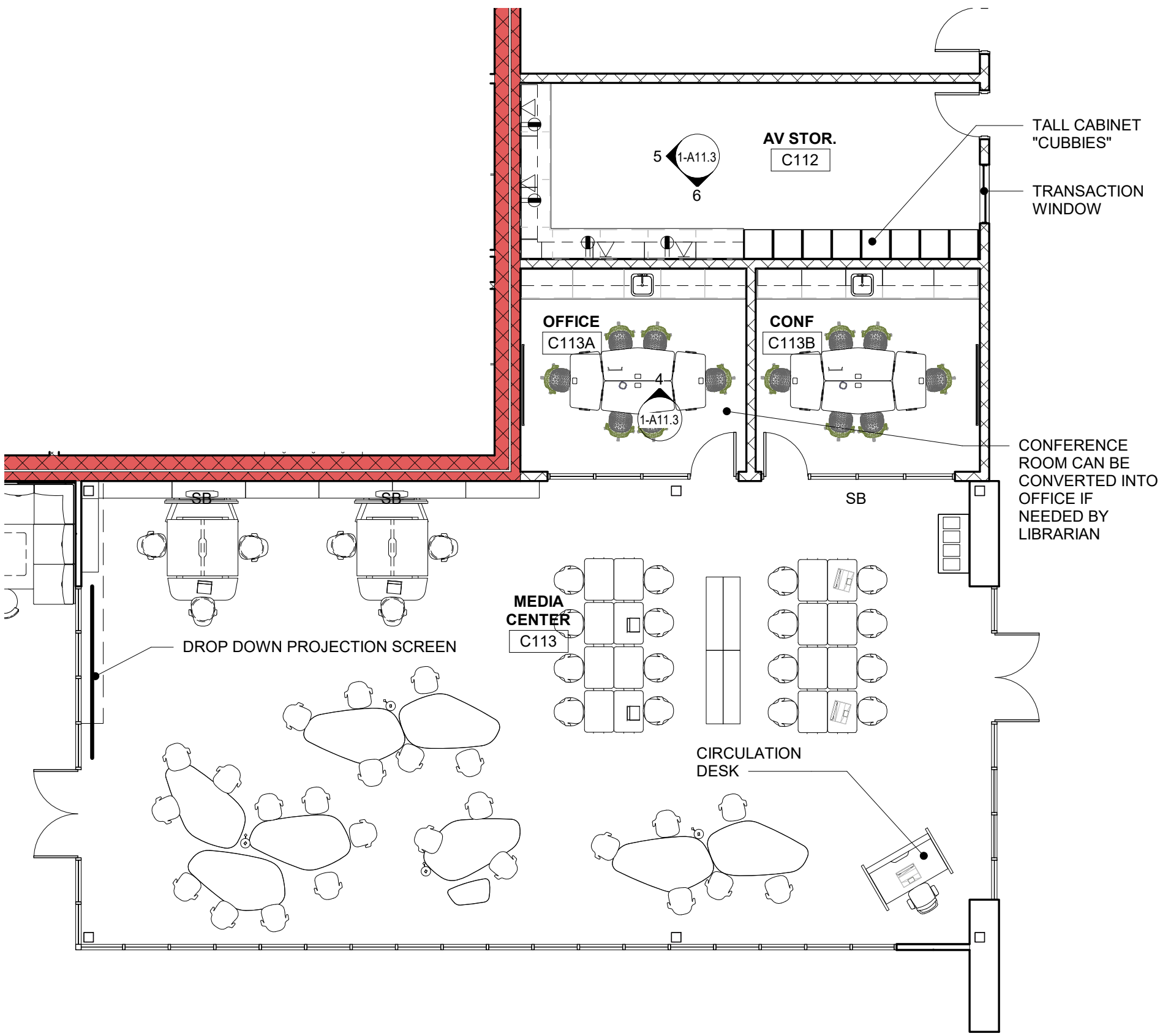

ALL SCHOOL MEDIA CENTER

1/8" = 1'-0"

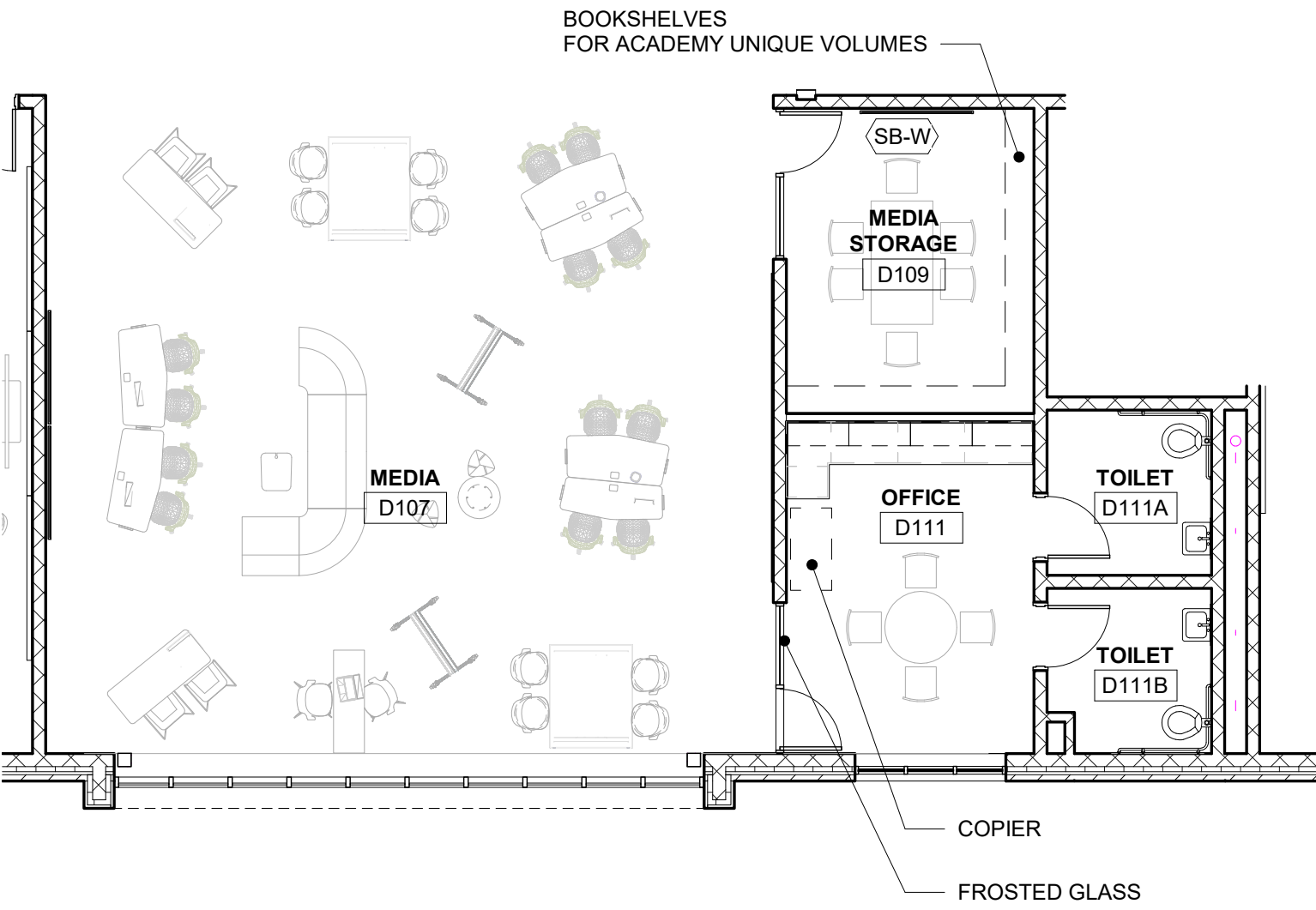

ACADMEY MEDIA CENTERS

1/8" = 1'-0"