

# FACPAC Contract Change Order Supplemental Information Form (Ref# 55818)

Form Status: Saved

Tier 1 Project: ECHS Renovation Phase #7

BG Number: 21-055

District: Estill County (161)

Status: Active

Phase: Project Initiation (View Checklist)

Contract: RISING SUN DEVELOPING, INC., 0015, COMBO OF BP2-GENERAL TRADES  
& BP6-DRYWALL/CEILINGS

Type: CM Bid Package

Proposed

Change Order Number	15-1
Time Extension Required	No
Date Of Change Order	11/30/2021
Change Order Amount To Date	Increase

## Construction Contingency

Calculations below are project wide. Remaining negative Construction Contingency may require the submission of a revised BG1.

Current Approved Amount	\$587,488.70
Net Approved COs	\$0.00
Remaining After Approved COs	\$587,488.70
Net All COs	\$246,750.07
Remaining After All COs	\$340,738.63

This Requested Change Order Amount \$184,778.93

+/-

Change In A/E Fee This Change Order \$10,162.84

+/-

Change In CM Fee This Change Order \$3,695.58

+/-

Remaining Construction Contingency

Balance

Contract Change Requested By Local Board of Education

Contract Change Reason Code Improved Plans/Specs

Change Order Description And Justification

PR #1 - Provide flying "E" graphics on backstop wall pads. \$3,225.75

PR #3 - Install flexible concrete erosion control matt as shown on sheet PR3.1. \$44,380.90

PR #4 - Provide and install 8-foot height vinyl coated chain link enclosure with gate to the chiller as shown on PR4.1 and PR 4.2. \$10,513.81

PR #5 - Provide and install modular lean rail in front of the home and visitor dugouts at Baseball Field. \$37,662.50

PR #7 - Provide and install proplay shock pad with pile height and infill modifications per specs. \$88,995.97

Cost Benefit To Owner  
Improved Plans

Contract unit prices have been utilized No  
to support the cost associated with this  
change order.

Detailed Cost Breakdown

Contract unit prices have not been utilized, provide a detailed cost breakdown which  
separates labor, material, profit and overhead.

Detail Item	Amount	Percent of Total
Labor	\$14,891.00	8.06%
Materials	\$145,786.34	78.90%
Profit and Overhead	\$24,101.59	13.04%
Bond Insurance		0.00%
Cost Breakdown Total:	\$184,778.93	
Cost for this Change Order supported by an alternate bid or competitive price quote	No	
Explain Why		

**Change Order Supplemental Information Form Signature  
Page (Online Form Ref# 55818)**

_____ Architect	_____ Date
_____ Construction Manager	_____ Date
_____ Finance Officer	_____ Date
_____ Local Board of Education Designee	_____ Date

# AIA<sup>®</sup> Document G701/CMa<sup>™</sup> – 1992

## Change Order - Construction Manager-Adviser Edition

OWNER ☒  
CONSTRUCTION MANAGER ☐  
ARCHITECT ☐  
CONTRACTOR ☐  
FIELD ☐  
OTHER ☐

**PROJECT** (Name and address):  
ESTILL COUNTY HIGH SCHOOL PHASE 7  
RENOVATIONS  
495 ENGINEER DRIVE  
IRVINE KY 40336

**CHANGE ORDER NUMBER:** 15-1  
**INITIATION DATE:** 11/30/2021

**TO CONTRACTOR** (Name and address):  
RISING SUN DEVELOPING, INC.  
2555 PALUMBO DRIVE, SUITE 110  
LEXINGTON KY 40509

**PROJECT NUMBERS:** CMA-KDE-000742 / 21-055  
**CONTRACT DATE:** 7/26/2021  
**CONTRACT FOR:** BID PACKAGE #015 COMBINATION OF BP2-  
GENERAL TRADES & BP6-DRYWALL/CEILINGS

### THE CONTRACT IS CHANGED AS FOLLOWS:

PR #1 - PROVIDE FLYING "E" GRAPHICS ON BACKSTOP WALL PADS. \$3,225.75  
PR #3 - INSTALL FLEXIBLE CONCRETE EROSION CONTROL MATT AS SHOWN ON SHEET PR3.1. \$44,380.90  
PR #4 - PROVIDE AND INSTALL 8-FOOT HEIGHT VINYL COATED CHAIN LINK ENCLOSURE WITH GATE TO THE CHILLER  
AS SHOWN ON PR4.1 AND PR 4.2. \$10,513.81  
PR #5 - PROVIDE AND INSTALL MODULAR LEAN RAIL IN FRONT OF THE HOME AND VISITOR DUGOUTS AT BASEBALL  
FIELD. \$37,662.50  
PR #7 - PROVIDE AND INSTALL PROPLAY SHOCK PAD WITH PILE HEIGHT AND INFILL MODIFICATIONS PER  
SPECS. \$88,995.97

The original Contract Sum was	\$4,178,268.95
Net change by previously authorized Change Orders	\$0.00
The Contract Sum prior to this Change Order was	\$4,178,268.95
The Contract Sum will be increased by this Change Order in the amount of	\$184,778.93
The new Contract Sum including this Change Order will be	\$4,363,047.88

The Contract Time will not be affected.  
The date of Substantial Completion as of the date of this Change Order therefore is 8/26/2022

### NOT VALID UNTIL SIGNED BY THE CONTRACTOR AND CONSTRUCTION MANAGER.

Codell Construction

**CONSTRUCTION MANAGER** (Firm Name)

4475 Rockwell Rd., Winchester, KY 40392

**ADDRESS**

**BY** (Signature)

(Typed Name)

**DATE:**

RISING SUN DEVELOPING, INC.

**CONTRACTOR** (Firm Name)

2555 PALUMBO DRIVE, SUITE 110 LEXINGTON, KY 40509

**ADDRESS**

ROSS-TARRANT ARCHITECTS INC

**ARCHITECT** (Firm Name)

101 OLD LAFAYETTE AVE LEXINGTON, KY 40502

**ADDRESS**

**BY** (Signature)

(Typed Name)

**DATE:**

ESTILL COUNTY BOARD OF EDUCATION

**OWNER** (Firm Name)

253 MAIN STREET IRVINE, KY 40336

**ADDRESS**

\_\_\_\_\_  
**BY** *(Signature)*

\_\_\_\_\_  
*(Typed Name)*

**DATE:**

\_\_\_\_\_  
**BY** *(Signature)*

\_\_\_\_\_  
*(Typed Name)*

**DATE:**



## Proposal Request

PROJECT NAME: Estill County HS Phase 7 Renovations  
PROJECT NUMBER: 2025  
SUBJECT: Owner Requested Backstop Wall Pad Graphics  
DUE DATE:  
ID: PR 01  
SENDER ID:  
INITIATED BY: Jonathan Ruiz  
REASONS: Owner's Request  
DISCIPLINE: Landscape  
STATUS: Closed  
COP STATUS: Not Received  
CONTRACT:  
DESCRIPTION: Contractor to provide all material, labor, and equipment costs associated with providing graphics on backstop wall pads. Owner provided graphic to be the same flying "E" graphic provided for the goal post pads and place on every other pad. Provide visual rendering of the pad layout with the flying E and cost to apply the graphic.

### ACTIONS

#### Sent

DATE:	9/2/2021	DUE BACK:	--
FROM:	Jonathan Ruiz (RossTarrant Architects)		
RECIPIENTS:	Jeremy Faulkner (Codell Construction Company)		
REMARKS:	<p>Contractor to provide all material, labor, and equipment costs associated with providing graphics on backstop wall pads. Owner provided graphic to be the same flying "E" graphic provided for the goal post pads and place on every other pad. Provide visual rendering of the pad layout with the flying E and cost to apply the graphic.</p> <p>Please submit an itemized quotation for changes in the Contract Sum and/or Time incidental to proposed modifications to the Contract Documents describes therein.</p> <p>This is not a change order nor a direction to proceed with the work described herein.</p>		

#### Closed

DATE:	9/14/2021	DUE BACK:	--
FROM:	Jonathan Ruiz (RossTarrant Architects)		
RECIPIENTS:			
REMARKS:	See COP 1		

**PR#1***Proposal To:***Codell Construction****Estill County High School Phase 7**

Irvine, Ky

*Description:**Pricing per direction in PR#1*

Item	QTY	Unit	Unit \$	Cost
Backstop Pads with Flying "E": \$352 each	33	lot		\$11,616.00
Credit for original pads: \$267 each	33	lot		(\$8,811.00)
OHP @ 15%				\$420.75
Total Change Request				\$3,225.75

(RSD project mgr) Donnie Napier

Rising Sun Developing, Inc.  
2555 Palumbo Drive, Ste 110  
Lexington, KY 40509  
859-543-0205 Ph/859-543-0230 Fax





# Change Order Proposal Transmittal

RossTarrant Architects | 101 Old Lafayette Ave Lexington KY 40502 United States

PROJECT: Estill County HS Phase 7 Renovations 2025 DATE SENT: 11/30/2021

SUBJECT: Concrete Erosion Control Mat (Revised) CHANGE ORDER PROPOSAL ID: COP 04 (PR 03)r01

TYPE: Change Order Proposal TRANSMITTAL ID: 00497

PURPOSE: Reviewed VIA: Info Exchange

TOTAL AMOUNT: \$44,380.90

TOTAL DAYS: 0

## FROM

NAME	COMPANY	EMAIL	PHONE
Jonathan Ruiz	RossTarrant Architects	jruiz@rosstarrant.com	859-254-4018

## TO

NAME	COMPANY	EMAIL	PHONE
David Robinette	Codell Construction Company	drobinette@codellconstruction.com	

REMARKS: See attached.

## DESCRIPTION OF CONTENTS

QTY	DATED	TITLE	NUMBER	SCALE	SIZE	NOTES
1	11/29/2021	COP 04 (PR 03)r01.pdf				

## COPIES:

Peter Fisher  
Kenny Davis

(RossTarrant Architects)  
(Codell Construction Company)



10-20-21

To: Codell Construction

Estill Phase 7

Attn: Kenny Davis

Pr. 3

Material:

Erosion mat 6079 sf. @ \$3.81 per sf.	\$23,160.99
---------------------------------------	-------------

Anchors	\$2,107.10
---------	------------

Freight	\$2,224.00
---------	------------

Labor and Equipment:

Excavator and operator 60 hrs. @ 125.00 per hr.	\$7500.00
---	-----------

2 men 40 hrs. @ \$45.00 per hr.	\$3,600.00
---------------------------------	------------

Overhead and profit 15%	\$5,788.81
-------------------------	------------

Total:	\$44,380.90
--------	-------------

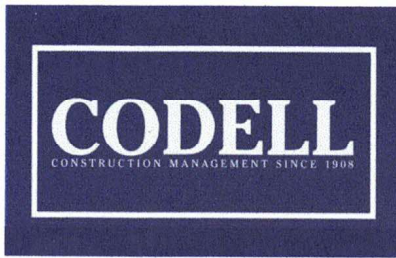

## ESTILL COUNTY HIGH SCHOOL PHASE 7 RENOVATIONS CHANGE ORDER REVIEW

**To:** ROSS-TARRANT ARCHITECTS **From:** Jeremy L. Faulkner  
INC

**Attn:** ROSS-TARRANT ARCHITECTS INC **CC:** Kenny G. Davis Jr.

**Re:** 0003 **Date:** 9/16/2021

**Attachments:**

- Transmittal\_ProposalRequest - PR-003 (Sent).pdf
- CMA-KDE-000742 Change Order Review Form 0003.docx
- BID PACKAGE #015 COMBINATION OF BP2-GENERAL TRADES & BP6-DRYWALL/CEILINGS RFQ

I have reviewed and approved the attached pricing. Your approval and signature is required in order to process this change order. Please review the pricing and sign below if it is acceptable.

0003

Contractor	BP#	Pricing
		\$0.00
RISING SUN DEVELOPING, INC.	015	\$44,380.90

**Total Amount:** \$44,380.90 days

\_\_\_\_\_  
ROSS-TARRANT ARCHITECTS INC

\_\_\_\_\_  
Date

Codell Construction Company,



# Proposal Request Transmittal

RossTarrant Architects | 101 Old Lafayette Ave Lexington KY 40502 United States

PROJECT: Estill County HS Phase 7 Renovations 2025      DATE SENT: 9/15/2021

SUBJECT: PR-003 Flexible Concrete Erosion Control Mat      PROPOSAL REQUEST ID: PR-003

TYPE: Proposal Request      TRANSMITTAL ID: 00271

PURPOSE: For Contractor's Pricing      VIA: Info Exchange

---

FROM

NAME	COMPANY	EMAIL	PHONE
Jonathan Ruiz	RossTarrant Architects	jruiz@rosstarrant.com	859-254-4018

TO

NAME	COMPANY	EMAIL	PHONE
Jeremy Faulkner	Codell Construction Company	jfaulkner@codellconstruction.com	859.744.2222

REMARKS: Refer to sheet SD2.3 and attached sketch PR3.1

Provide detailed pricing breakdown for all material, labor, and equipment costs to install flexible concrete erosion control mat as shown on the attached sketch. Refer to detail F/SD4.1 for installation detail.

Please submit an itemized quotation for changes in the Contract Sum and/or Time incidental to the proposed modifications to the Contract Documents as described.

This is not a change order nor a direction to proceed with the work described herein.

DESCRIPTION OF CONTENTS

QTY	DATED	TITLE	NUMBER	SCALE	SIZE	NOTES
1	9/15/2021	Sketch_PR3.1.pdf				

---

COPIES:

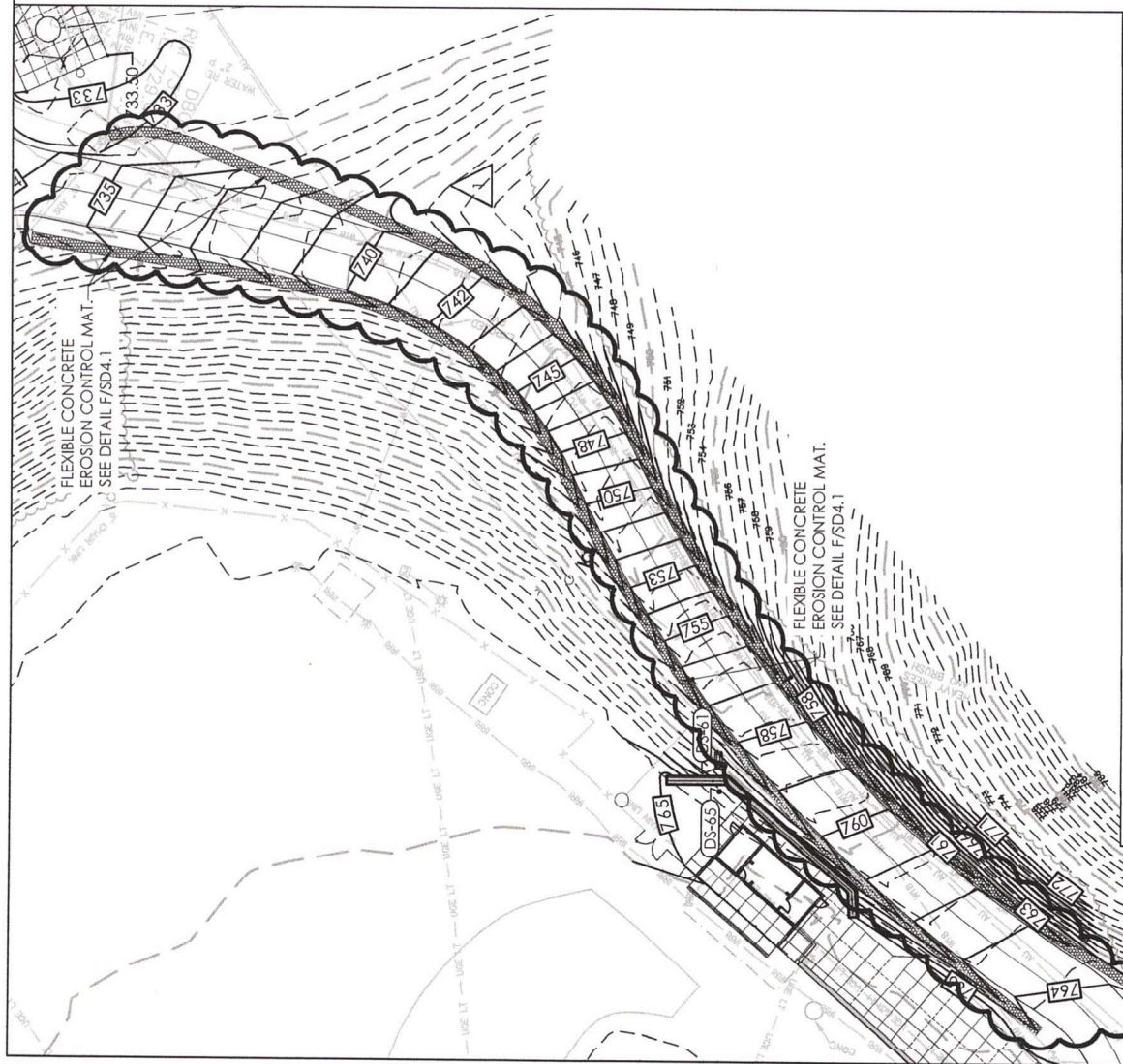

PROPOSAL REQUEST #3  
SCALE: 1" = 40'  
Feet  
0 10 20  
A  
SD2.3  
PLAN NORTH

# ABBREVIATIONS LEGEND

- FFE - FINISHED FLOOR ELEVATION
- TC - TOP OF CURB
- 3C - BOTTOM OF CURB
- TW - TOP OF WALL AT FINISH GRADE
- 3W - BOTTOM OF WALL AT FINISH GRADE
- BWL - BOTTOM OF WALL AT FINISHED GRADE, HIGH SIDE OF WALL.
- BWL - BOTTOM OF WALL AT FINISHED GRADE, LOW SIDE OF WALL
- TF - TOP OF FOOTING (BELOW GRADE)
- TR - TOP OF RISER
- BR - BOTTOM OF RISER

# LEGEND

- DS-# DRAINAGE STRUCTURE. REFER TO STORM DRAINAGE STRUCTURE SCHEDULE.
- D.S. DOWNSPOUT BOOT (334993). SEE DETAIL D/SD4.1
- FLEXIBLE CONCRETE EROSION CONTROL MAT. SEE DETAIL F/SD4.1

1 PROVIDE AND INSTALL FLEX MAT EROSION CONTROL IN SWALES AS SHOWN.  
2 ADJUST DRAWING LEGEND AS SHOWN.



# Change Order Proposal Transmittal

RossTarrant Architects | 101 Old Lafayette Ave Lexington KY 40502 United States

PROJECT: Estill County HS Phase 7 Renovations 2025      DATE SENT: 11/17/2021

SUBJECT: Chiller Fence Enclosure      CHANGE ORDER PROPOSAL ID: COP 08 (PR 04)

TYPE: Change Order Proposal      TRANSMITTAL ID: 00477

PURPOSE: Reviewed      VIA: Info Exchange

TOTAL AMOUNT: \$10,513.81

TOTAL DAYS: 0

## FROM

NAME	COMPANY	EMAIL	PHONE
Jonathan Ruiz	RossTarrant Architects	jruiz@rosstarrant.com	859-254-4018

## TO

NAME	COMPANY	EMAIL	PHONE
David Robinette	Codell Construction Company	drobinette@codellconstruction.com	

REMARKS: No Comments on pricing. Please forward to Owner for approval.

## DESCRIPTION OF CONTENTS

QTY	DATED	TITLE	NUMBER	SCALE	SIZE	NOTES
1	11/17/2021	Proposal Request- PR#4 Chiller CL Fence (CMAKDE000742, #0004).pdf				

## COPIES:

Peter Fisher (RossTarrant Architects)

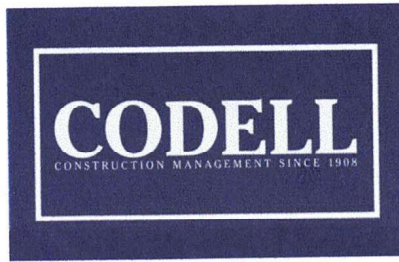

## ESTILL COUNTY HIGH SCHOOL PHASE 7 RENOVATIONS CHANGE ORDER REVIEW

**To:** ROSS-TARRANT ARCHITECTS **From:** Jeremy L. Faulkner  
INC

**Attn:** ROSS-TARRANT ARCHITECTS INC **CC:** Kenny G. Davis Jr.

**Re:** PR#4 **Date:** 9/16/2021

**Attachments:**

- Transmittal\_ProposalRequest - PR-004 (Sent).pdf
- BID PACKAGE #015 COMBINATION OF BP2-GENERAL TRADES & BP6-DRYWALL/CEILINGS RFQ
- CMA-KDE-000742 Change Order Review Form 0004.docx

I have reviewed and approved the attached pricing. Your approval and signature is required in order to process this change order. Please review the pricing and sign below if it is acceptable.

PR#4

Contractor	BP#	Pricing
		\$0.00
RISING SUN DEVELOPING, INC.	015	\$10,513.81

**Total Amount:** \$10,513.81 days

\_\_\_\_\_  
ROSS-TARRANT ARCHITECTS INC

\_\_\_\_\_  
Date

Codell Construction Company,



11/9/2021

To: Codell Construction

Estill Phase 7

Attn: Kenny Davis

Pr. 4

Fence and gate	\$4,105.00
Decorative stone	\$806.45
Edging	\$440.00

Fence labor	\$1,906.00
Stone labor	\$589.00
Edging labor	\$440.00
Grading labor	\$856.00

Overhead and profit 15%	\$1371.36
-------------------------	-----------

Total:	\$10,513.81
--------	-------------



## Proposal Request Transmittal

RossTarrant Architects | 101 Old Lafayette Ave Lexington KY 40502 United States

PROJECT: Estill County HS Phase 7 Renovations 2025      DATE SENT: 9/15/2021

SUBJECT: PR-004 Chiller Fence Enclosure      PROPOSAL REQUEST ID: PR-004

TYPE: Proposal Request      TRANSMITTAL ID: 00272

PURPOSE: For Contractor's Pricing      VIA: Info Exchange

### FROM

NAME	COMPANY	EMAIL	PHONE
Jonathan Ruiz	RossTarrant Architects	jruiz@rosstarrant.com	859-254-4018

### TO

NAME	COMPANY	EMAIL	PHONE
Jeremy Faulkner	Codell Construction Company	jfaulkner@codellconstruction.com	859.744.2222

REMARKS: Refer to attached sketch PR4.1 and PR4.1

Provide detailed pricing breakdown for all material, labor, and equipment costs to install an 8-foot height vinyl coated chain link enclosure with gate to the chiller at the ATC as shown on sketch PR4.1. Provide and install stone mulch as shown on PR4.1 and PR4.2.

Please submit an itemized quotation for changes in the Contract Sum and/or Time incidental to the proposed modifications to the Contract Documents as described.

This is not a change order nor a direction to proceed with the work described herein.

### DESCRIPTION OF CONTENTS

QTY	DATED	TITLE	NUMBER	SCALE	SIZE	NOTES
1	9/15/2021	Sketch_PR4.1.pdf				
1	9/15/2021	Sketch_PR4.2.pdf				

1

ADD CHAIN LINK FENCING AND GATE AS SHOWN

2

ADD DEVELOPMENT TAG AND HATCH AS SHOWN.

28

DECORATIVE STONE MULCH, SEE DETAIL B/SD4.7

2

DECORATIVE STONE MULCH

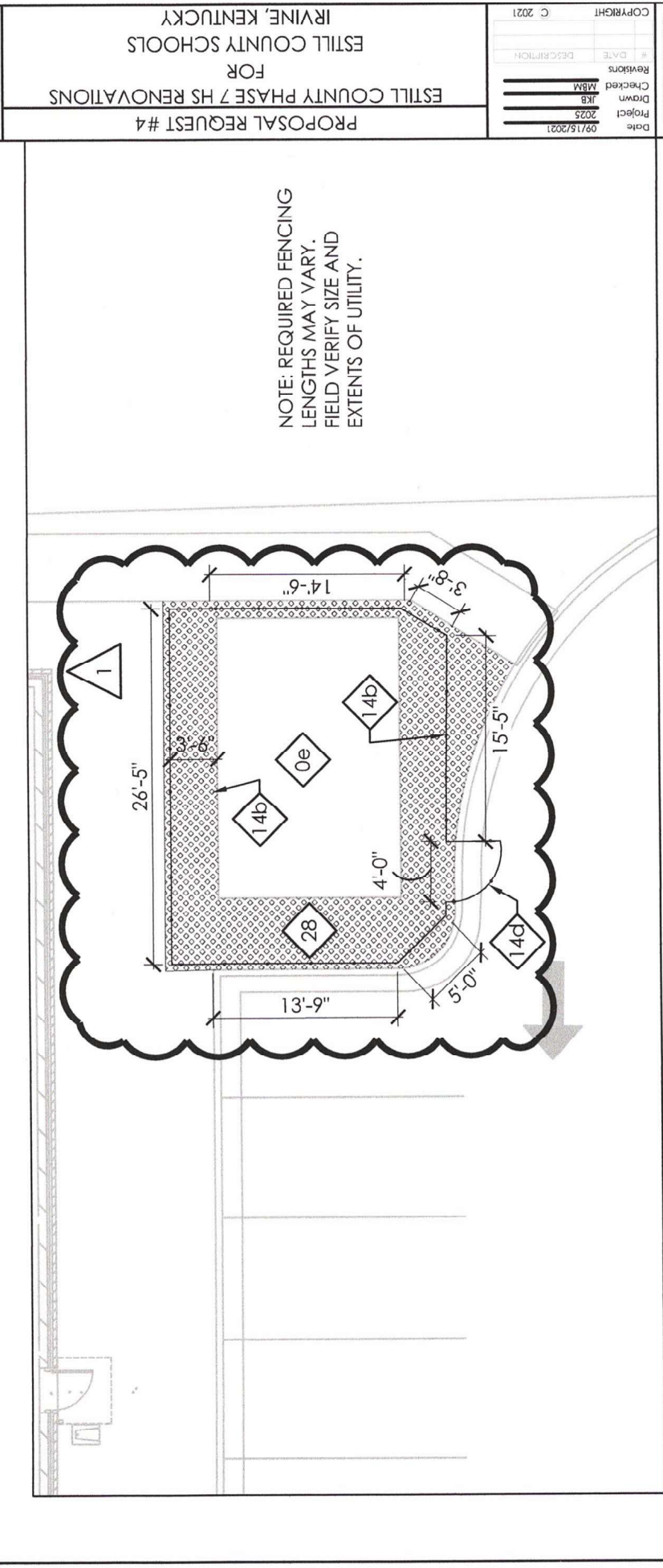

B

SD4.7

DECORATIVE STONE MULCH

SCALE : 1/2" = 1'-0"

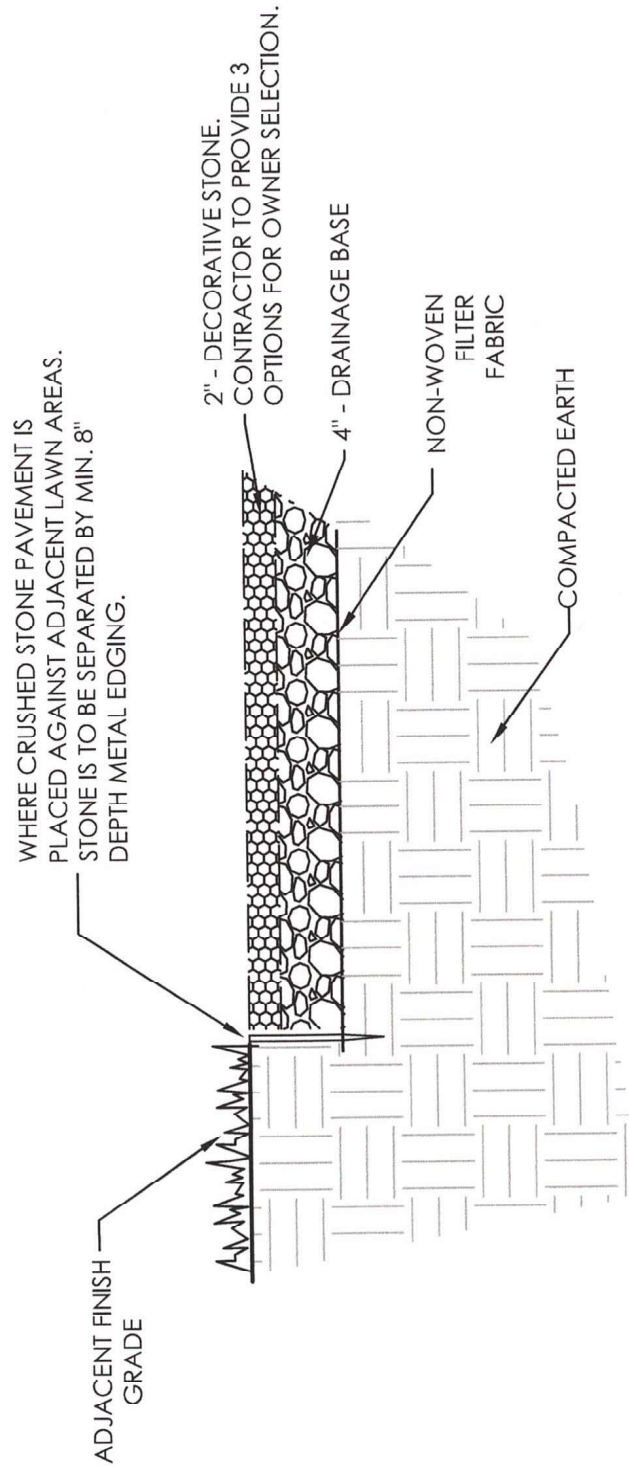

Date	09/15/2021	
Project	2025	
Drawn	JKB	
Checked	MBM	
Revisions		
#	DATE	DESCRIPTION
COPYRIGHT (C) 2021		

1

ADD DETAIL AS SHOWN.



# Change Order Proposal Transmittal

RossTarrant Architects | 101 Old Lafayette Ave Lexington KY 40502 United States

PROJECT: Estill County HS Phase 7 Renovations 2025 DATE SENT: 11/30/2021

SUBJECT: Baseball Lean Rails CHANGE ORDER PROPOSAL ID: COP 05 (PR 05)r01

TYPE: Change Order Proposal TRANSMITTAL ID: 00496

PURPOSE: Reviewed VIA: Info Exchange

TOTAL AMOUNT: \$37,662.50

TOTAL DAYS: 0

## FROM

NAME	COMPANY	EMAIL	PHONE
Jonathan Ruiz	RossTarrant Architects	jruiz@rosstarrant.com	859-254-4018

## TO

NAME	COMPANY	EMAIL	PHONE
David Robinette	Codell Construction Company	drobinette@codellconstruction.com	

REMARKS: See attached.

## DESCRIPTION OF CONTENTS

QTY	DATED	TITLE	NUMBER	SCALE	SIZE	NOTES
1	11/8/2021	COP - PR#05 Baseball Lean Rails (CMAKDE000742, #0005).pdf				

## COPIES:

Kenny Davis  
Peter Fisher

(Codell Construction Company)  
(RossTarrant Architects)



10-20-21

To: Codell Construction

Estill Phase 7

Attn: Kenny Davis

Pr. 5

Credit for fence	-\$4,500.00
Lean rail	\$37,250.00]
See attached quote	
Overhead and profit 15%	\$4,912.00
Total:	\$37,662.50

**ODC of Eastern Ky. (Fence Division)**

389 Tollage Creek Road  
Pikeville, KY 41501  
Telephone: (606) 874-4262  
Fax: (606) 874-4265  
Email: matt@odeky.com

Shipping Address  
389 Tollage Creek Road  
Pikeville, KY 41501  
Telephone: (606) 874-4262  
Fax: (606) 874-4265

The Genuine. The Original.



Proposal #: 2-2944

PROPOSAL SUBMITTED TO: RISING SUN DEVELOPMENT			Date 10/20/2021	Attention JASON
STREET			Job Name ESTILL CO. PH. 7 PR-005 BASEBALL LEAN RAIL	
City	State	Zip Code	Job Location	
Phone Number	Fax Number		Job Phone	

FURNISH AND INSTALL:

CREDIT FOR REMOVAL OF 8' FENCE FROM CONTRACT:

71' LN FT 8' X 9C/6F X 2" BLACK VINYL COATED FENCE  
\*IN FRONT OF HOME AND VISITOR DUGOUT BASEBALL FIELD

CREDIT FOR CHAIN LINK: \$4500.00

PRICE TO INSTALL LEAN RAILS INSTEAD OF 8' FENCE:

(2) 35' 4" L GRS42 SPORTSFIELD SPECIALTIES 3' 6" TALL GUARD RAIL SYSTEM

\*PLATED

\*2" X 2" 11GA

\*POWDERCOATED BLACK

\*BLACK CHAIN LINK INFILL 9C/6F BLK

\*WITH PADDING (COLOR TBD)

TOTAL TO INSTALL GUARD RAILS: \$37,250.00

\*\*\*ALLOW 2-8 WEEKS FOR DELIVERY FROM SPORTSFIELD SPECIALTIES\*\*\*

\*\*\*NO SALES TAX INCLUDED

We hereby propose to complete in accordance with above specification, for the sum of:

Signature

Matt Thacker - Service Tech / Estimator

Direct Dial: 606.874.4262

**TERMS AND CONDITIONS**

Payment to be made as follows:

Prices subject to change if not accepted in 30 days.

Upon Completion



## Proposal Request Transmittal

RossTarrant Architects | 101 Old Lafayette Ave Lexington KY 40502 United States

PROJECT: Estill County HS Phase 7 Renovations 2025      DATE SENT: 9/15/2021

SUBJECT: PR-005 Baseball Field Lean Rail      PROPOSAL REQUEST ID: PR-005

TYPE: Proposal Request      TRANSMITTAL ID: 00273

PURPOSE: For Contractor's Pricing      VIA: Info Exchange

---

FROM

NAME	COMPANY	EMAIL	PHONE
Jonathan Ruiz	RossTarrant Architects	jruiz@rosstarrant.com	859-254-4018

TO

NAME	COMPANY	EMAIL	PHONE
Jeremy Faulkner	Codell Construction Company	jfaulkner@codellconstruction.com	859.744.2222

REMARKS: Refer to sheet SD3.7 and attached sketch PR5.1 and PR5.2

Provide detailed pricing breakdown for all material, labor, and equipment costs for the following:

1. Provide a credit for labor and installation of 8-foot height vinyl coated chain link fencing and gates shown in front of the home and visitor dugouts for the baseball field.

1. Provide and install additional sidewalk and fence band as shown on Sketch PR5.1 in front of the home and visitor dugouts for the baseball field.

2. Provide and install modular lean rail as shown on sketch PR5.1 and PR5.2. Modular lean rail is to meet the following specifications:

A. Basis of Design: 3'-6" Height Guard Rail System, Model # GRS42 as manufactured by: Sportsfield Specialties Inc., P.O. Box 231, 41155 State Highway 10, Delhi, NY 13753, p. 888-975-3343, f. 607-746-8481, [www.sportsfieldspecialties.com](http://www.sportsfieldspecialties.com)

B. Components:

1. Modular Steel Structure:

a. 2" x 2", 11 Gage Steel Tube Frame

b. 7"x7", 3/8" thick base plate.

c. Stainless Steel Assembly Hardware

d. Finish to be powder coated black.

# Proposal Request Transmittal

DATE: 9/15/2021

ID: 00273

## 2.Chain Link Panel Infill:

- a.Fabric: 2 inch diamond mesh interwoven wire, 6 gage thick, top selvage knuckle end closed, bottom selvage knuckle end closed. All fabric to be Aluminum - Coated Steel Fabric (Aluminized): ASTM A491.
- b.Finish to be Black Vinyl Coating.
- c.Post bracket attachments to be manufactured and have same finishing as vinyl coated fencing.
- d.Accessories and Hardware to be same as framing and finish.

## 3.Guard Rail Top, Mid and Bottom Rail Padding:

- a.Guard Rail Top Rail High Profile Padding Overall Dimensions: 6-1/8" x 6-3/4" (WxH), Length as required.
- b.Guard Rail Mid and Bottom Rail Padding Overall Dimensions: 6"x2" (WxH), Length as required.
- c.1-1/4" Thick High Impact Polyurethane Foam.
- d.3/4" Water Resistant Composite Wood Panel, Primed, Stained and Sealed on all sides.
- e.18 oz. High UV Vinyl, 5-year limited Fade Warranty.
- 1) 1000 Denier Polyester Basic Fabric
  - 2) Tear Strength Test: Warp 78lbs; Fill 65 lbs.
  - 3) Tensile Strength: Warp 224 lbs., Fill 220 lbs.
  - 4) Weft Insertion: 9 x 9, Superior UV Inhibitors
  - 5) Cold Crack: Minus 20° Fahrenheit
  - 6) Vinyl Seams Double Stitched Using 6 lb. Bonded Polyester Black Thread
  - 7) Vinyl Color to be selected from Manufacturer's full range of colors.

Please submit an itemized quotation for changes in the Contract Sum and/or Time incidental to the proposed modifications to the Contract Documents as described.

This is not a change order nor a direction to proceed with the work described herein.

## DESCRIPTION OF CONTENTS

QTY	DATED	TITLE	NUMBER	SCALE	SIZE	NOTES
1	9/15/2021	Sketch_PR5.1.pdf				
1	9/15/2021	Sketch_PR5.2.pdf				

## COPIES:

Peter Fisher

(RossTarrant Architects)

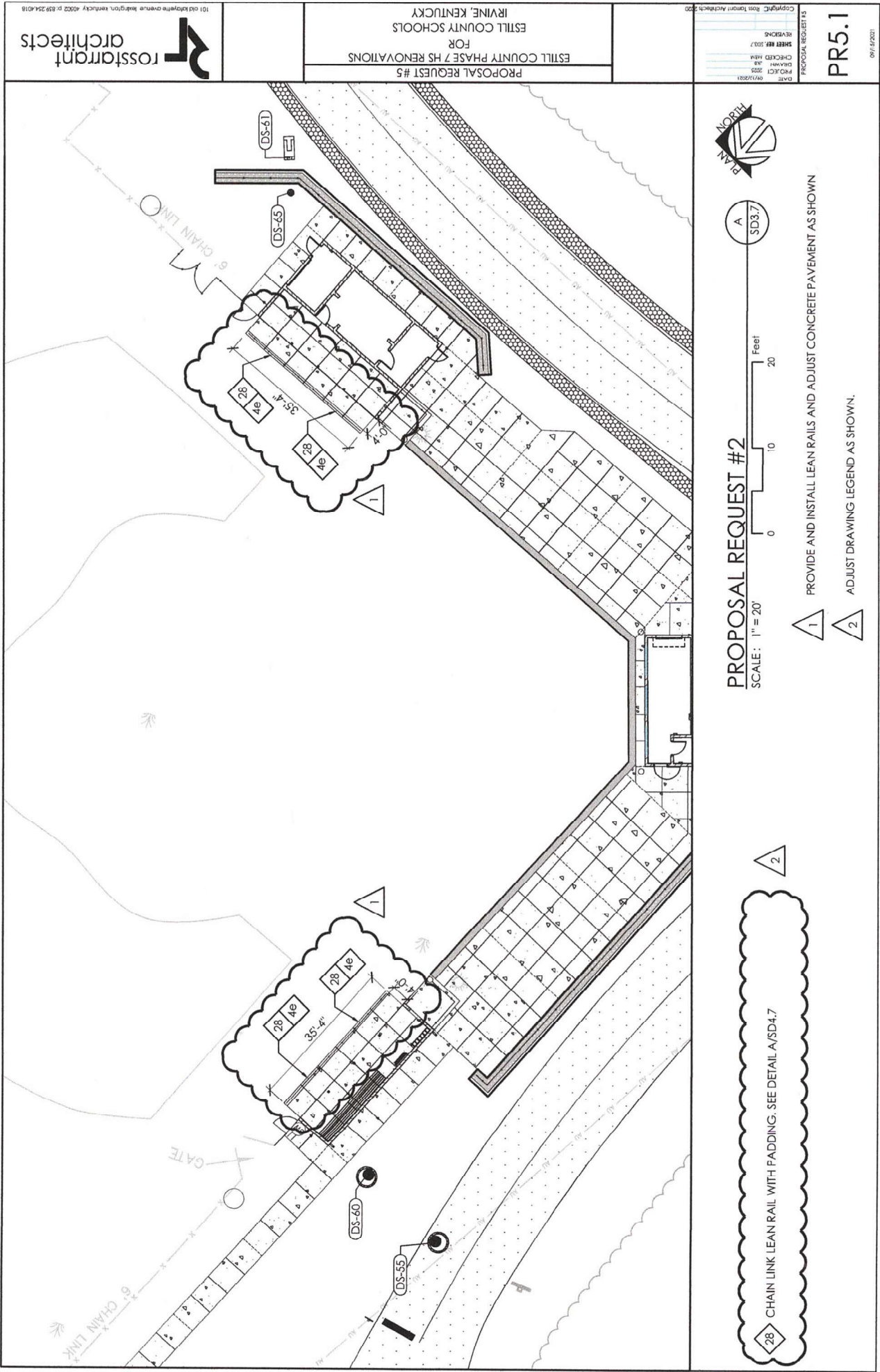

NOTE:  
CHAIN LINK FABRIC IS TO  
HAVE TOP AND BOTTOM  
SELVAGE KNUCKLE END  
CLOSED.

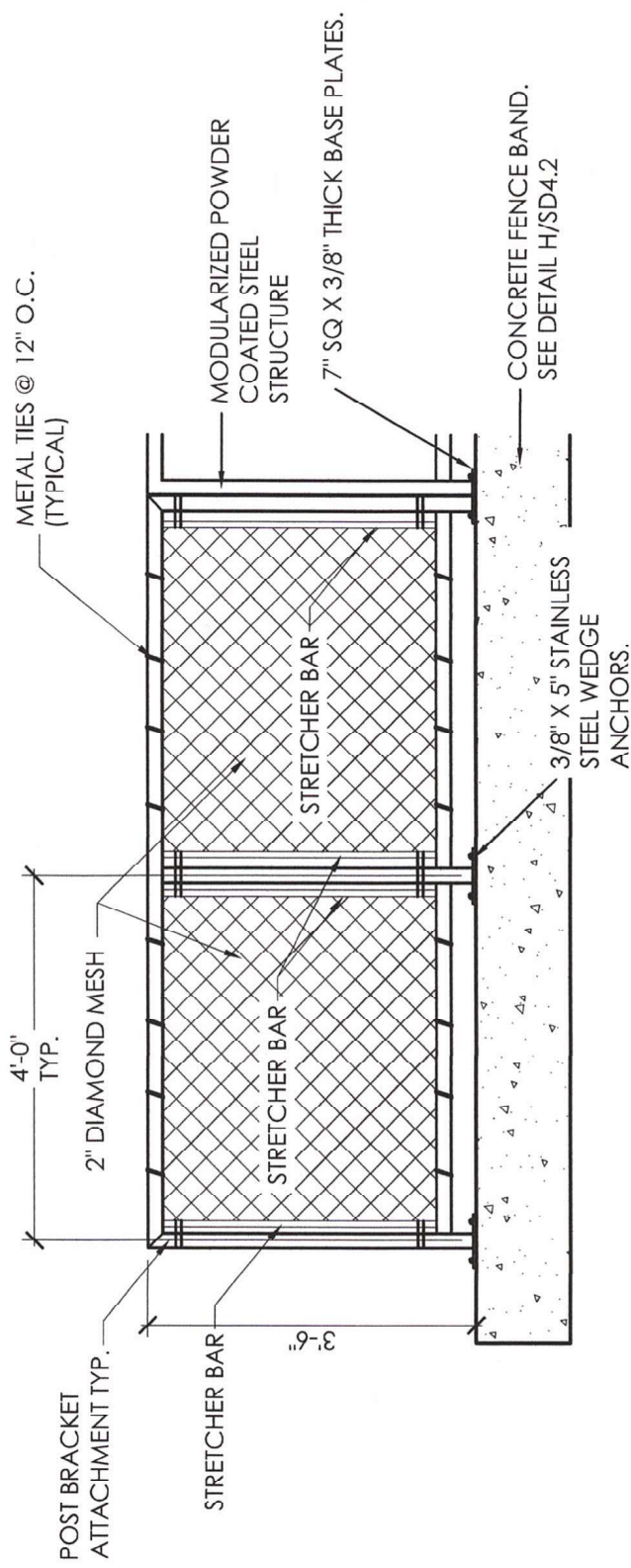
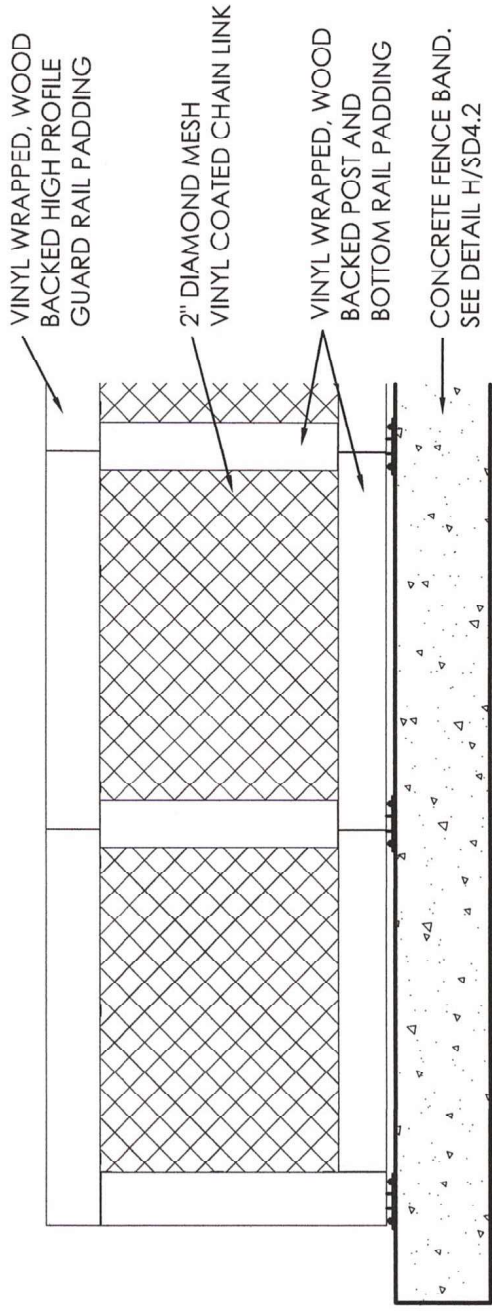

A  
SD4.7

# CHAIN LINK LEAN RAIL WITH PADDING (116833.23)

SCALE: 3/4"=1'-0"

1 ADD DETAIL AS SHOWN.

DATE	DESCRIPTION
09/15/2021	Project
2023	Drawn
JLB	Checked
MEM	Revisions
09/15/2021	Copyright

PROPOSAL REQUEST #5  
**PR5.2**

09/15/2021

PROPOSAL REQUEST #5  
FOR  
ESTILL COUNTY PHASE 7 HS RENOVATIONS  
ESTILL COUNTY SCHOOLS  
IRVINE, KENTUCKY



# Change Order Proposal Transmittal

RossTarrant Architects | 101 Old Lafayette Ave Lexington KY 40502 United States

PROJECT: Estill County HS Phase 7 Renovations 2025 DATE SENT: 11/16/2021

SUBJECT: Synthetic Turf Pad CHANGE ORDER PROPOSAL ID: COP 06 (PR 07)

TYPE: Change Order Proposal TRANSMITTAL ID: 00469

PURPOSE: Reviewed VIA: Info Exchange

TOTAL AMOUNT: \$88,995.97

TOTAL DAYS: 0

## FROM

NAME	COMPANY	EMAIL	PHONE
Jonathan Ruiz	RossTarrant Architects	jruiz@rosstarrant.com	859-254-4018

## TO

NAME	COMPANY	EMAIL	PHONE
David Robinette	Codell Construction Company	drobinette@codellconstruction.com	

REMARKS: Pending Owner Approval, Submit revised shop drawings for synthetic turf system for revisions contained in the Change Order Proposal.

## DESCRIPTION OF CONTENTS

QTY	DATED	TITLE	NUMBER	SCALE	SIZE	NOTES
1	11/8/2021	COP- PR#7 Synthetic Turf Pad (CMAKDE000742, #0006).pdf				

## COPIES:

Peter Fisher (RossTarrant Architects)

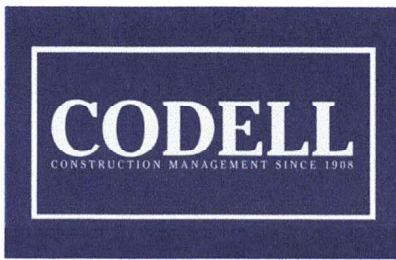

## ESTILL COUNTY HIGH SCHOOL PHASE 7 RENOVATIONS CHANGE ORDER REVIEW

**To:** ROSS-TARRANT ARCHITECTS **From:** David G. Robinette  
INC

**Attn:** ROSS-TARRANT ARCHITECTS INC **CC:** Kenny G. Davis Jr.

**Re:** PR#7 **Date:** 10/20/2021

**Attachments:**

- CMA-KDE-000742 Change Order Review Form 0006.docx
- BID PACKAGE #015 COMBINATION OF BP2-GENERAL TRADES & BP6-DRYWALL/CEILINGS RFQ

I have reviewed and approved the attached pricing. Your approval and signature is required in order to process this change order. Please review the pricing and sign below if it is acceptable.

**PR#7**

Contractor	BP#	Pricing
		\$0.00
STANDAFER BUILDERS, INC.	001	\$0.00
CARMICLE MASONRY	003	\$0.00
KALKREUTH ROOFING & SHEET METAL	005	\$0.00
LAKE CUMBERLAND GLASS	007	\$0.00
BASTIN PAINTING, INC.	008	\$0.00
CDI FLOORING	009	\$0.00
AMERICAN TILE COMPANY, INC.	010	\$0.00
TOADVINE ENTERPRISES	011	\$0.00
C&C INDUSTRIAL, LLC	012	\$0.00
BABCON, INC.	013	\$0.00
RISING SUN DEVELOPING, INC.	015	\$88,995.97

**Total Amount: \$88,995.97 0 days**



10-27-21

To: Codell Construction

Estill Phase 7

Attn: Kenny Davis

Pr. 7

Proplay shock pad with pile height and infill modifications per specs. with 2" pile ht.	\$73,007.36
---	-------------

Tax	\$4,380.44
-----	------------

Overhead and profit 15%	\$11,608.17
-------------------------	-------------

Total:	<u>\$88,995.97</u>
--------	--------------------



# SPRINTURF



PRICING PROPOSAL FOR ESTILL COUNTY HIGH SCHOOL REV 2  
495 Engineer Drive, Irvine, KY 40336

Date: 6/2/2021

Field Name	Stadium Field
Square Footage	79,800 SF
Field Markings - Graphics	Center Logo & End Zone Letters
Field Markings - Sports	Football & Soccer
Turf System	Dual Fiber (Monofilament & Slit Film)
Base Bid – Perform Sub-Grade Up Base Work, Furnish & Install New Infilled Synthetic Turf System	\$470,800.00
Alternate #7 – Furnish & Install Proplay 20D Shock Pad by Schmitz	ADD: \$105,800.00
Voluntary Alternate #1 – Provide Football Goal Posts & Soccer Goals (Installation by Others)	ADD: \$33,400.00
Breakout Price 1 – Stone (Included in Base Bid)	Hinkle - \$53,778.55
Breakout Price 2 – Rubber Infill (Included in Base Bid)	CRM - \$37,184.50
Breakout Price 3 – Sand Infill (Included in Base Bid)	TTI - \$13,794.25
Breakout Price 4 – Geofabric (Included in Base Bid)	Kinder Brothers Supply - \$11,250.00
Breakout Price 5 – Turf (Included in Base Bid)	ITS - \$159,105.80
Breakout Price 6 – Tape&Glue (Included in Base Bid)	Mapei- \$9,790.00

\*Sales Tax is INCLUDED in the above pricing\*

\*\*Payment & Performance Bonds can be provided for 1.5% of the total contract value\*\*

## Product Details

Sprinturf is pleased to offer:

Product Detail	Ultrablade DFE Extreme (Dual Fiber)
Color	Field Green/Lime Green w/ Alternating Panels
Pile Height	2.25"
In-fill Type	SBR Ambient Crumb Rubber & Silica Sand
Face Weight	46 oz/yd <sup>2</sup>
Backing/Urethane Weight	22 oz/yd <sup>2</sup>

## The Sprinturf Difference

In order to provide the highest quality product and service, one hundred percent of Sprinturf products are manufactured in house and in America creating American jobs and investments. Sprinturf installations are executed to a uniform, national quality standard and Sprintcare, our after-sales maintenance program is one of the best in the industry.



P: (843) 936.6023 | F: (843) 410.5712 | 146 Fairchild Street, Suite 150 | Daniel Island, SC | 29492



The price is valid for the period of 60 days. The price is subject to increase if affected by an increase in raw materials, freight, or levies. Please feel free to reach out to any member of our team with questions about our offer:

**Randy Hammond**  
Regional Sales Manager  
765.437.4385  
[rhammond@sprinturf.com](mailto:rhammond@sprinturf.com)

**Marc Belluomini**  
National Sales manager  
559.260.2344  
[mbelluomini@sprinturf.com](mailto:mbelluomini@sprinturf.com)

**Bruce Cheskin**  
Executive Vice President  
610.316.8020  
[brucecheskin@sprinturf.com](mailto:brucecheskin@sprinturf.com)

Thank you again for your interest in Sprinturf, we look forward to working with you.

Per:

Bruce Cheskin  
Executive Vice President  
Sprinturf LLC

**ESTILL COUNTY HIGH SCHOOL, KY REV 2**  
**SPRINTURF PRICING PROPOSAL DATED 6/2/2021**

**ACCEPTED BY:**

---

**By:**

**Date:**

### Conditions

Notwithstanding any other document or agreement entered into by Sprinturf in connection with the supply and installation only of its product pursuant to the present bid proposal, the following shall apply:

1. This bid proposal and its acceptance is subject to strikes, accidents, acts of god and *force majeure*;
2. Sprinturf requires a minimum of 15 days after receiving final approvals on shop drawings to manufacture and deliver turf;
3. This proposal is based on a single mobilization. If additional mobilizations are necessary, additional charges will apply;
4. Final Payment shall be upon the substantial completion of Sprinturf obligations. Sprinturf is entitled to cost recovery associated with collecting delinquent receivables;
5. Accounts overdue beyond 30 days of invoice date will be charged at an interest rate of 2% per month;
6. Sprinturf shall be accountable for its negligence but shall not be bound by any penalty clauses.



P: (843) 936.6023 | F: (843) 410.5712 | 146 Fairchild Street, Suite 150 | Daniel Island, SC | 29492