



Kenton County School District | *It's about ALL kids.*

**THE KENTON COUNTY BOARD OF EDUCATION**

1055 EATON DRIVE, FORT WRIGHT, KENTUCKY 41017

TELEPHONE: (859) 344-8888 / FAX: (859) 344-1531

WEBSITE: [www.kenton.kyschools.us](http://www.kenton.kyschools.us)

Dr. Henry Webb, Superintendent of Schools

## **Scott High School – BG 18-038 Schematic Design & Design Development for Phase IV Renovation**

The scope of work associated with Phase IV renovation at Scott is fairly consistent with the original master renovation design prepared for the school. The original section of the school that includes the kitchen, cafeteria, and science classrooms will be renovated into special education classrooms, English classrooms, and fine arts department. The fine arts department shall include a new band room and choral classroom in the former kitchen space. The former cafeteria will be renovated into a multiple purpose classroom and special needs department. The exterior space now enclosed by the previously constructed phase II-B classroom addition shall be developed into a courtyard with an emphasis on learning spaces for special needs students, art classes, media center, and new multiple purpose classroom.

Schematic floor plans for the first floor, second floor, and the entire footprint of the facility is enclosed. A site plan for the building is also enclosed to provide a reference point for the work to be included in the next phase of renovation. The site plan depicts the proposed geothermal well field to be constructed on two of the recently purchased parcels of property.

A project narrative reflecting all design development objectives is enclosed.

### **Kenton County Board of Education**

Board Members: Carl Wicklund, Chairperson Karen L. Collins, Vice Chairperson Joshua Crabtree, Esq. Carla Egan Jessica Jehn  
"The Kenton County Board of Education provides *Equal Education & Employment Opportunities*."

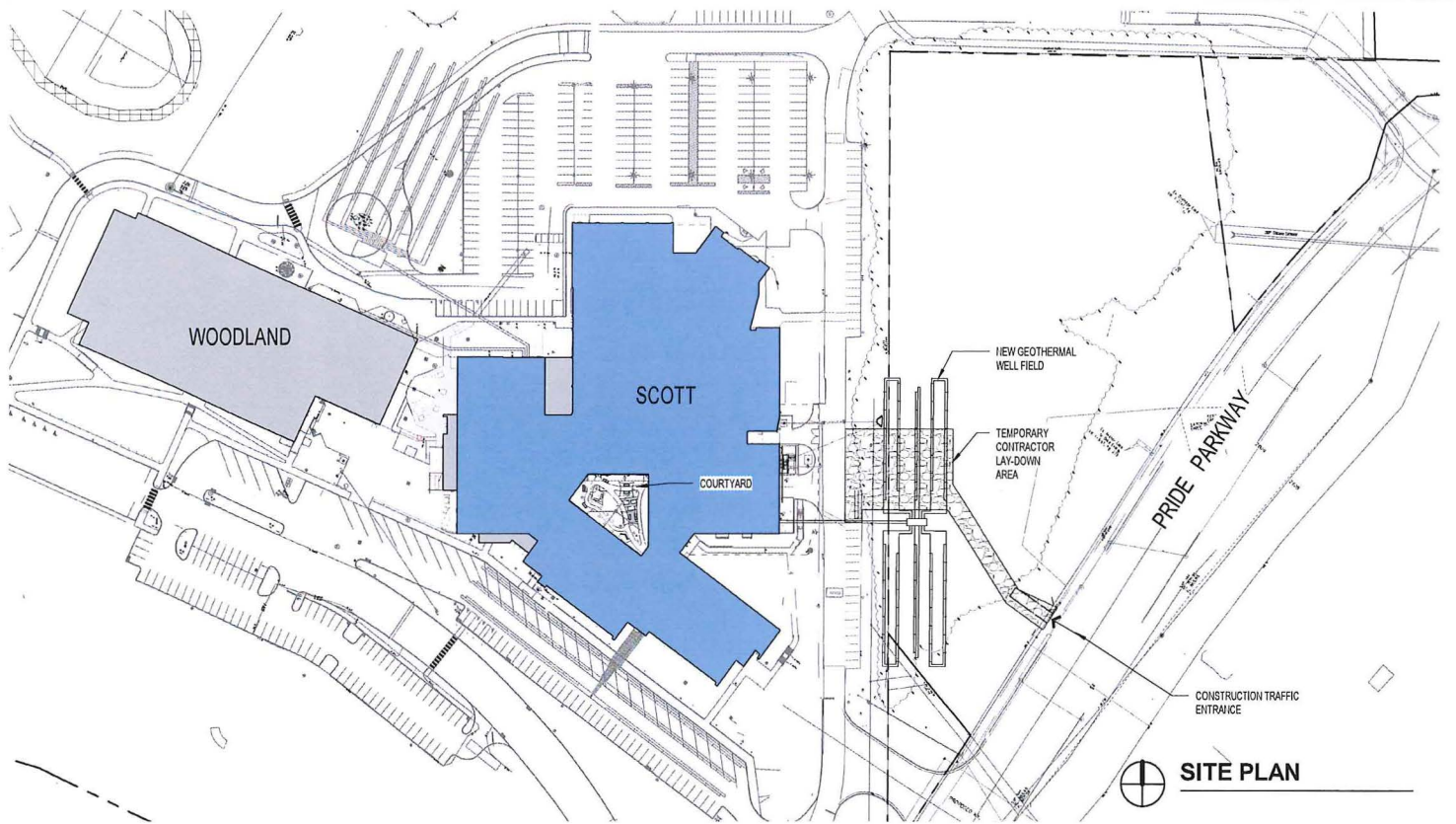

1881 DIXIE HWY. - SUITE 130  
 FT. WRIGHT, KY 41011  
 P: 859.431.8612  
 F: 859.431.8611

# **SCOTT HIGH SCHOOL**

5400 Old Taylor Mill Road  
 Taylor Mill, KY 41015  
 BG#18-038  
 KENTON COUNTY SCHOOLS

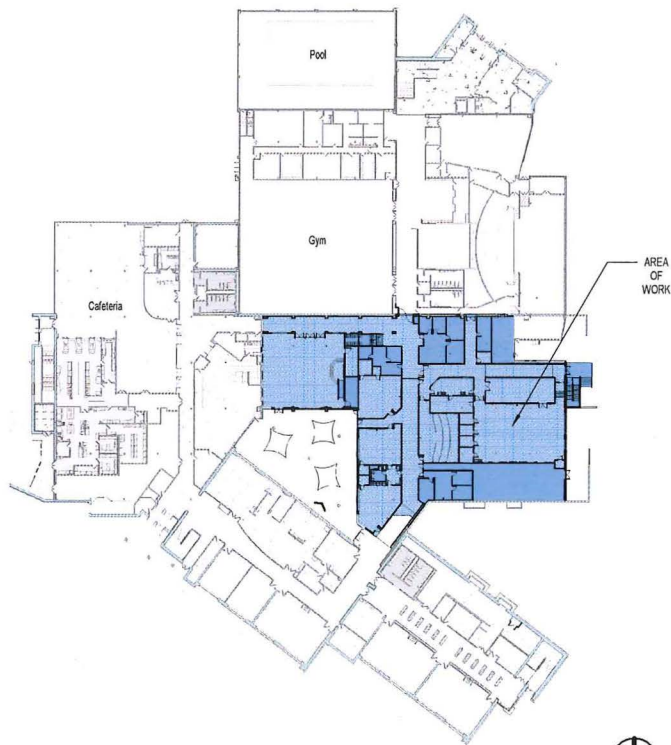

KEY PLAN



1881 DIXIE HWY. - SUITE 130  
FT. WRIGHT, KY 41011  
P: 859.431.8612  
F: 859.431.8611

### SCOTT HIGH SCHOOL

5400 Old Taylor Mill Road  
Taylor Mill, KY 41015  
BG#18-038  
KENTON COUNTY SCHOOLS

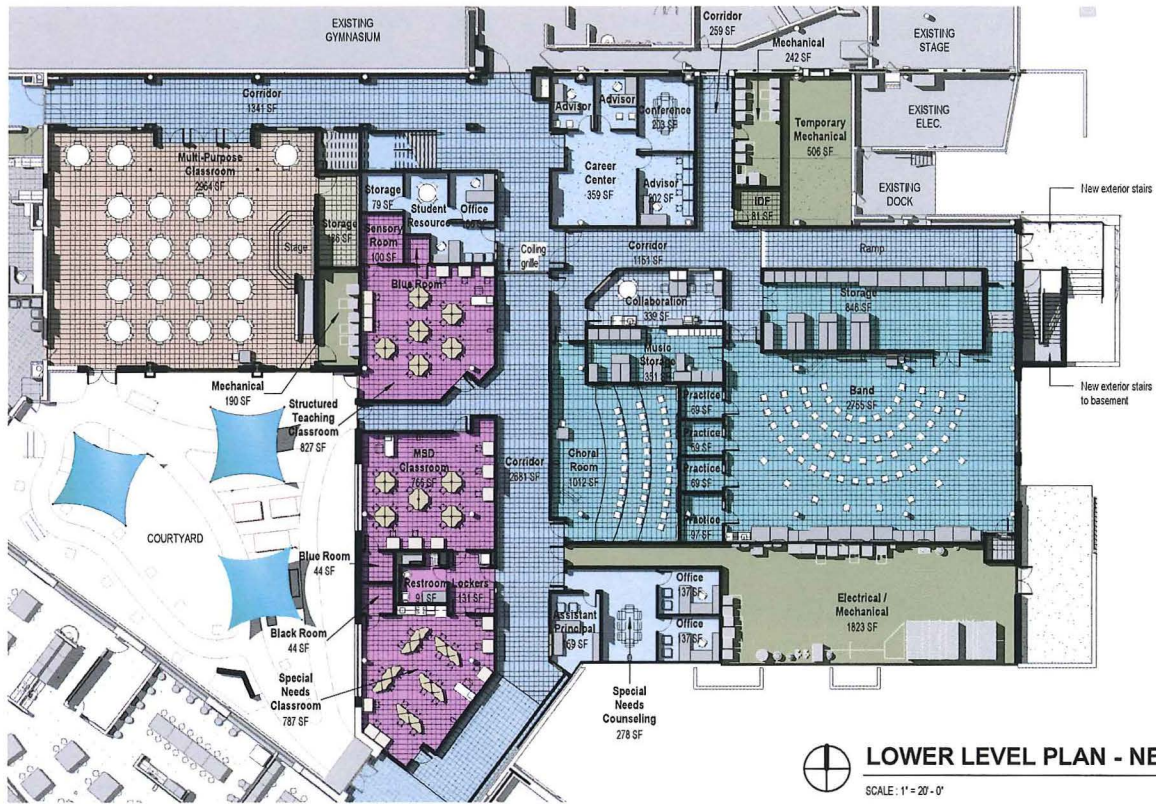

1881 DIXIE HWY. - SUITE 130  
FT. WRIGHT, KY 41011  
P: 859.431.8612  
F: 859.431.8611

**SCOTT HIGH SCHOOL**  
5400 Old Taylor Mill Road  
Taylor Mill, KY 41015  
BG#18-036  
KENTON COUNTY SCHOOLS





**EAST ELEVATION**



1881 DIXIE HWY. - SUITE 130  
FT. WRIGHT, KY 41011  
P: 859.431.8612  
F: 859.431.8611

**SCOTT HIGH SCHOOL**

5400 Old Taylor Mill Road  
Taylor Mill, KY 41015  
BG#18-038  
KENTON COUNTY SCHOOLS

**Kenton County School District**

**Design Development Narrative – Phase IV Renovation Scott High School**

**As of November 6, 2017**

The next phase of renovation at Scott will remain consistent with previous phases of construction. The overall design objective is to complete each phase of construction as though the entire renovation was accomplished at one time. Each section of renovation shall provide a seamless transition between the various phases of construction.

All exterior finishes will continue with the same brick manufacturer and color selection along with the door and window finishes. The specifications are prepared to render the same building systems utilized in previous phases of construction. The existing exterior and interior wall systems will be removed and replaced with an insulated concrete form system. The new insulated concrete wall sections will provide the same insulation values established with previous phases of construction.

The mechanical system for Phase IV shall include a geothermal heating and cooling design. The next phase of construction will include a new geothermal well field to be constructed on property recently purchased and adjacent to the new Pride Parkway. The new well field will serve the spaces being renovated in this phase of construction only. Each phase of construction included a separate geothermal well field to service each section of the facility in lieu of a centralized well field for the entire campus. This strategy facilitated the sequence of the work more effectively and efficiently managed District resources for each phase of work.

The interior spaces will be constructed with new LED lighting systems and all fixtures will be managed with a lighting control system that has an interface with the building automation control system. All exterior lighting fixtures included with Phase IV will also be an LED system.

Phase IV will also include the following finishes that were utilized in the previous phases of renovation:

- Marmoleum flooring tiles will be installed in classrooms with the top shield system which is a no-wax floor
- Terrazzo flooring will continue in the main circulation hallways and connect with the previous phases of construction; flooring colors and patterns will continue and provide a seamless transition between each corridor
- The color palette established for the wall systems will continue into Phase IV design

**Lower Level:**

The multi-purpose classroom was designed to offer a flexible learning space and include a small stage and multimedia projection system. This area is adjacent to the new courtyard and will provide excellent opportunities for group collaboration in an exterior setting that is controlled with direct access to the classroom. This space shall serve as staff development and training when not in use as a classroom. The room will have new windows facing the courtyard and the space will have a new roofing system.

Phase IV also includes the development of a three classroom suite and teacher office area for the special education department. The rooms will contain a restroom, shower facility, and locker room. The ceiling is being designed to include a Hoyer lift rail system directly mounted to the deck structure. This system will assist staff with a safe method to transfer students from wheelchairs to other devices and with toileting. The classroom suite will also include a classroom built with a calming music system, projection system, and lighting system which is designed to eliminate stress for students when they are agitated and upset. The special education classrooms also have direct access to the exterior courtyard and the new space will provide opportunities for students to plant and maintain a flower garden.

The lower level also includes the conversion of the former kitchen into a band and choral department. The spaces were designed to foster collaboration and shared work areas much as other disciplines which were prepared in previous phases of renovation. Practice rooms are proposed for band and choral along with a large music storage room. The band room will be constructed with a large instrument storage space and uniform storage area. The entire fine arts department is located adjacent to an exterior loading dock. Use of the dock is available at the end of this phase of construction with certain limitations. The next phase of construction will include a more comprehensive renovation of the dock loading area. The band and choral department is adjacent to the stage in the auditorium and will have direct connectivity for ease of use. This connection will also be enhanced during a future phase of renovation that includes the auditorium.

The lower level will also include the build out of a new career pathway and guidance space which is located on the main corridor and situated at a prominent intersection for student circulation. The lower level will also feature a new assistant principal office and continue the strategy of providing distributed administration throughout the facility.

The second floor includes the complete renovation of the former science classrooms. These spaces will be reshaped to include eleven English classrooms and two "school within a school" classrooms. The classroom design will reflect the next generation learning concepts established during the master planning design process and successfully implemented by the school administration and staff. The individual classrooms will maintain the open and transparent learning strategies employed in previous phases of renovation. The English department will secure an office suite similar to all other educational disciplines. The shared office environment will allow the individual classrooms to remain open and flexible for use throughout the school day. The corridor serving this department will include student locker units which are low and are constructed with a concrete counter top which fosters student collaboration throughout the day.

The lower level will provide connectivity to the second floor with a new stair case. The old stairwell is being eliminated in order to facilitate the construction of the new special education departmental space.