



Kenion County School District | It's about ALL kids.

# Issue Paper

**DATE:**

1/20/2021

**AGENDA ITEM (ACTION ITEM):**

Consider/Approve the schematic design and design development plan for the RC Hinsdale Elementary Addition and Renovation Project (BG 21-142) from PCA Architectural Firm.

**APPLICABLE BOARD POLICY:**

01.1 Legal Status of the Board

**HISTORY/BACKGROUND:**

PCA Architectural Firm has prepared schematic designs associated with the RC Hinsdale Addition and Renovation Project. The schematic design reflects the proposed construction floor plan, site development plan, and building elevation. The plan demonstrates the desired improvements for the school.

**FISCAL/BUDGETARY IMPACT:**

None

**RECOMMENDATION:**

Approve the schematic design and design development plan for the RC Hinsdale Elementary Addition and Renovation Project (BG 21-142) from PCA Architectural Firm.

**CONTACT PERSON:**

Rob Haney, Chief Operations Officer

\_\_\_\_\_  
Principal/Administrator

*Rob Haney*  
\_\_\_\_\_  
District Administrator

*[Signature]*  
\_\_\_\_\_  
Superintendent

*Use this form to submit your request to the Superintendent for items to be added to the Board Meeting Agenda*

*Principal – Complete, print, sign and send to your Director. Director – if approved, sign and put in the Superintendent's mailbox*

File Path



File Path

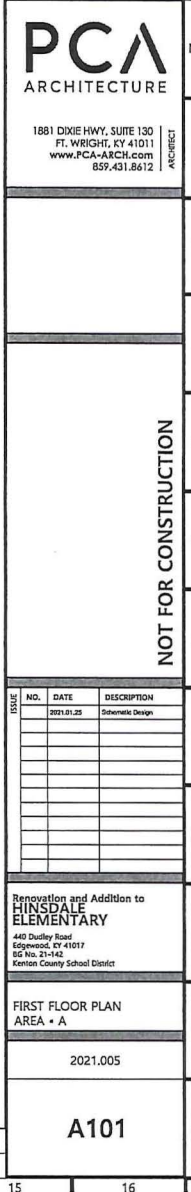

THIS DOCUMENT, AND THE IDEAS AND DESIGNS INCORPORATED HEREIN, AS AN INSTRUMENT OF PROFESSIONAL SERVICE, IS THE PROPERTY OF PCA ARCHITECTURE, P.C.A., AND IS NOT TO BE USED IN WHOLE OR IN PART FOR ANY OTHER PROJECT WITHOUT THE WRITTEN AUTHORIZATION OF PCA ARCHITECTURE, P.C.A. COPYRIGHT 1989-2021 PCA ARCHITECTURE, P.C.A. ALL RIGHTS RESERVED.

File Path

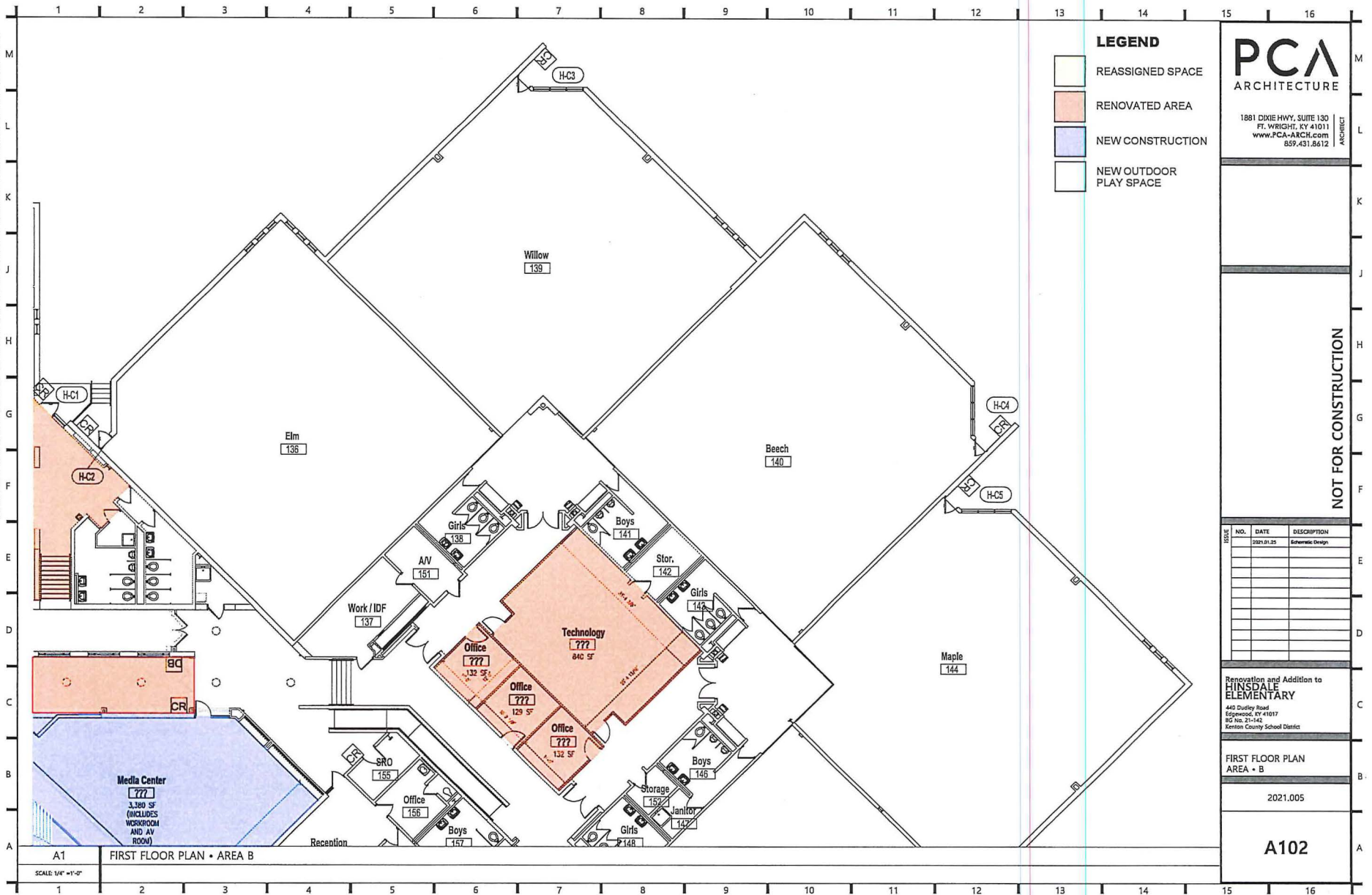

THIS DOCUMENT, AND THE IDEAS AND DESIGNS INCORPORATED HEREIN, AS AN INSTRUMENT OF PROFESSIONAL SERVICE, IS THE PROPERTY OF PCA ARCHITECTURE, P.C. AND IS NOT TO BE USED IN WHOLE OR IN PART FOR ANY OTHER PROJECT WITHOUT THE WRITTEN AUTHORIZATION OF PCA ARCHITECTURE, P.C. COPYRIGHT 1989-2021 PCA ARCHITECTURE, P.C. ALL RIGHTS RESERVED.

File Path

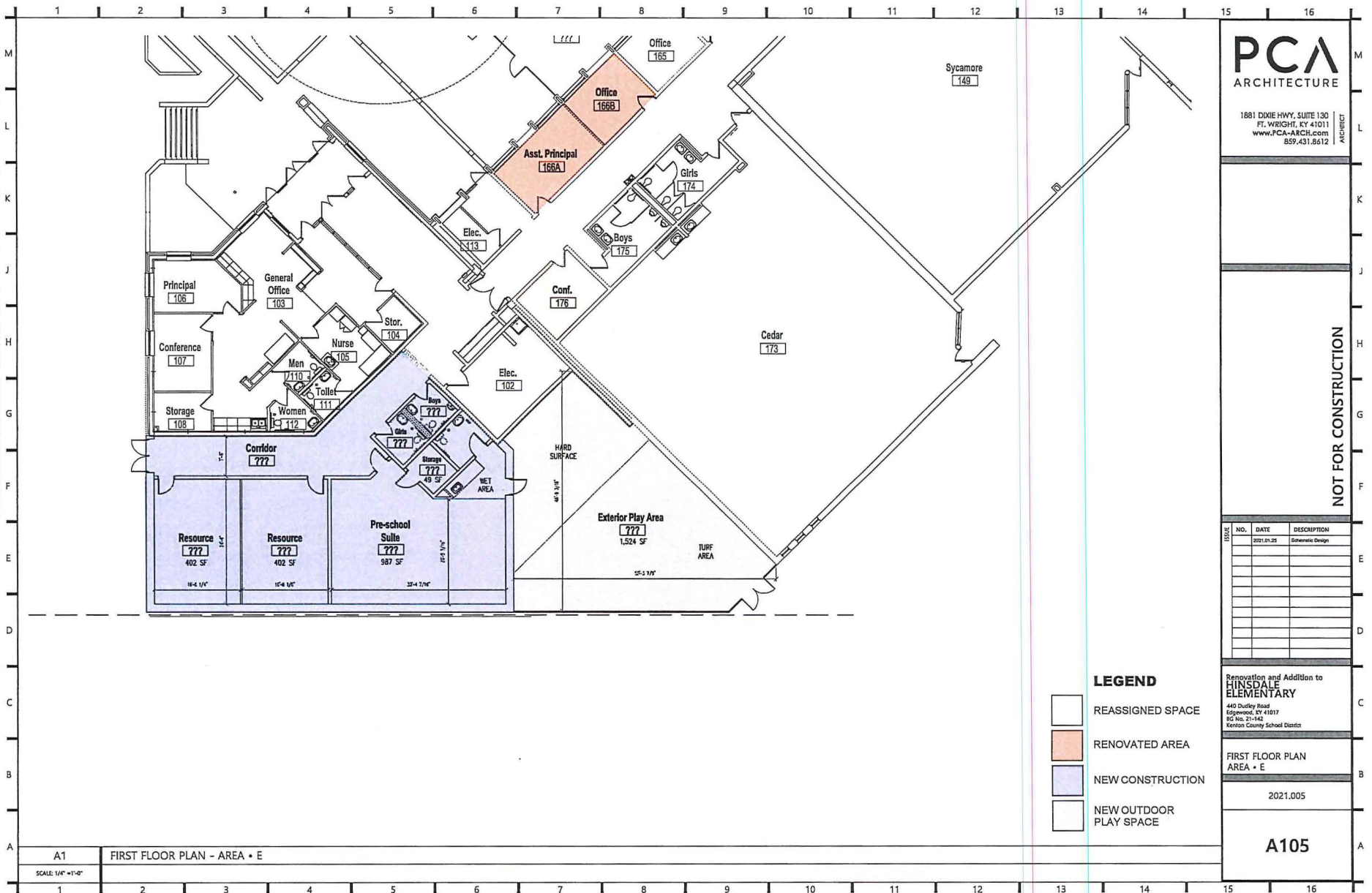

THIS DOCUMENT AND THE IDEAS AND DESIGNS INCORPORATED HEREIN, AS AN INSTRUMENT OF PROFESSIONAL SERVICE, IS THE PROPERTY OF PCA ARCHITECTURE, P.C. AND IS NOT TO BE USED IN WHOLE OR IN PART FOR ANY OTHER PROJECT, WITHOUT THE WRITTEN AUTHORIZATION OF PCA ARCHITECTURE, P.C. COPYRIGHT 1999-2021 PCA ARCHITECTURE, P.C. ALL RIGHTS RESERVED.

File Path

