



fence industries, inc.

Certified SBA 8(a), DBE, MBE & KY MWBE

Attachment "A"

Commercial Fence

4521 Bishop Lane
Louisville, KY 40218

Phone: 502.458.8701

Fax: 502.458.8703

email: mary@metrofenceinc.com

RESIDENTIAL

*

COMMERCIAL

*

INDUSTRIAL

Proposal Submitted To

Name: Ulliman Schutte
Attn: Eric Meister
Street: 9111 Springboro Pike
City: Miamisburg, OH 45342
Date: 9-23-20
Telephone Number: 937-910-9900

Work To Be Performed At

Site: Young Elementary School
Street: 3526 W. Muhammad Ali Blvd.
City: Louisville, KY 40212
Date of Plans: Upcoming
Email: emeister@ullimanschutte.com
Email 2: mbailey@ullimanschutte.com

We hereby propose to furnish all the materials and perform all the labor necessary for the completion of the following:
Remove, haul away, and dispose of existing 72" h chainlink fence and section of 120" h chainlink fence
Pull posts and concrete plugs on gate/end/corner posts – Line posts to be cut off at grade
Fence line on east side of building to be moved in towards parking lot to miss existing concrete within existing fence line
No fence installed where existing 12" h fence is located

EXTERIOR FENCE:

Install 902' of 72" h x 9-gauge black vinyl-coated chainlink fence
Terminal posts are 3" x 9' h x schedule 40 black vinyl-coated steel pipe
Terminal posts are braced with 1-5/8" x schedule 40 black vinyl-coated steel pipe and trussed
Line posts are 2 1/2" x 8' h x schedule 40 black vinyl-coated steel pipe
Fence is framed with 1-5/8" x 21' x schedule 40 black vinyl-coated steel top-rail and 9-gauge black smooth tension wire
Install one (1) 72" h x 48" w single swing, black vinyl-coated chainlink walk gate
Gate posts are 3" x 9' h x schedule 40 black vinyl-coated steel pipe
Install one (1) 72" h x 30' w double drive, black vinyl-coated chainlink gate with strong-arm latch
Gate posts are 6-5/8" x 10' h x schedule 40 black vinyl-coated steel pipe
Install one (1) 72" h x 40' w double drive, black vinyl-coated chainlink gate with strong-arm latch
Gate posts are 8-5/8" x 10' h x schedule 40 black vinyl-coated steel pipe

INTERIOR FENCE:

Install 358' of 48" h Ideal Commercial Ornamental Aluminum fence panels – Style: #300, Color: Black
Line/End/Corner posts are 2 1/2" sq. x 72" h x .093" wall thickness
Install three (3) 72" h x 36" w single swing gates with self-closing hinges and top-pull, key-locked, magna latch
ADD: \$2,189.00 to total below – New Backstop

* All posts priced to be dug through asphalt/dirt and set in concrete

* All spoils from holes to be removed from site

Price Assumptions/ Conditions

* Customer assumes full responsibility for location of fence.

* Price is based on equipment accessibility.

* Owner to mark and identify all private utilities.

* Owner to grade, stake and clear fence lines.

* All prices valid 30 days from date of estimate.

Dollars \$70,567.00

Tax Included

Total \$70,567.00

Continued On Next Page...

Terms are as follows: **Net 30 days.**

Effective 1/1/2018 – We will be charging a 3% fee for using a credit card. This includes all credit cards. No exceptions. Failure to pay in full within 30 days from completion, will entitle Metro Fence to the recovery of interest at 18% per annum and placing a lien on the property based on the value of the balance due. All material is guaranteed to be as specified, and the above work to be performed in accordance with the drawings and specifications submitted for above work and completed in a substantial workmanlike manner. Any underlying obstructions necessitating drilling will be charged for additional labor involved. Any alteration or deviation from above specifications involving extra costs, will be executed only upon written orders, and will become an extra charge over and above the estimate. All agreements are contingent upon strikes, accidents, or delays beyond our control.

Respectfully submitted David G. Johnson / MFL
David G. Johnson

Acceptance of Proposal

Prices, specifications, and conditions are satisfactory and are hereby accepted. You are authorized to do the work as specified. Payment will be made as outlined above. **General Contractor/Buyer/Owner is responsible for identifying and marking all private utilities. General Contractor/Buyer/Owner is responsible for building and zoning codes.**

Date Accepted _____ Signature _____

Fence Materials

residential

commercial

industrial

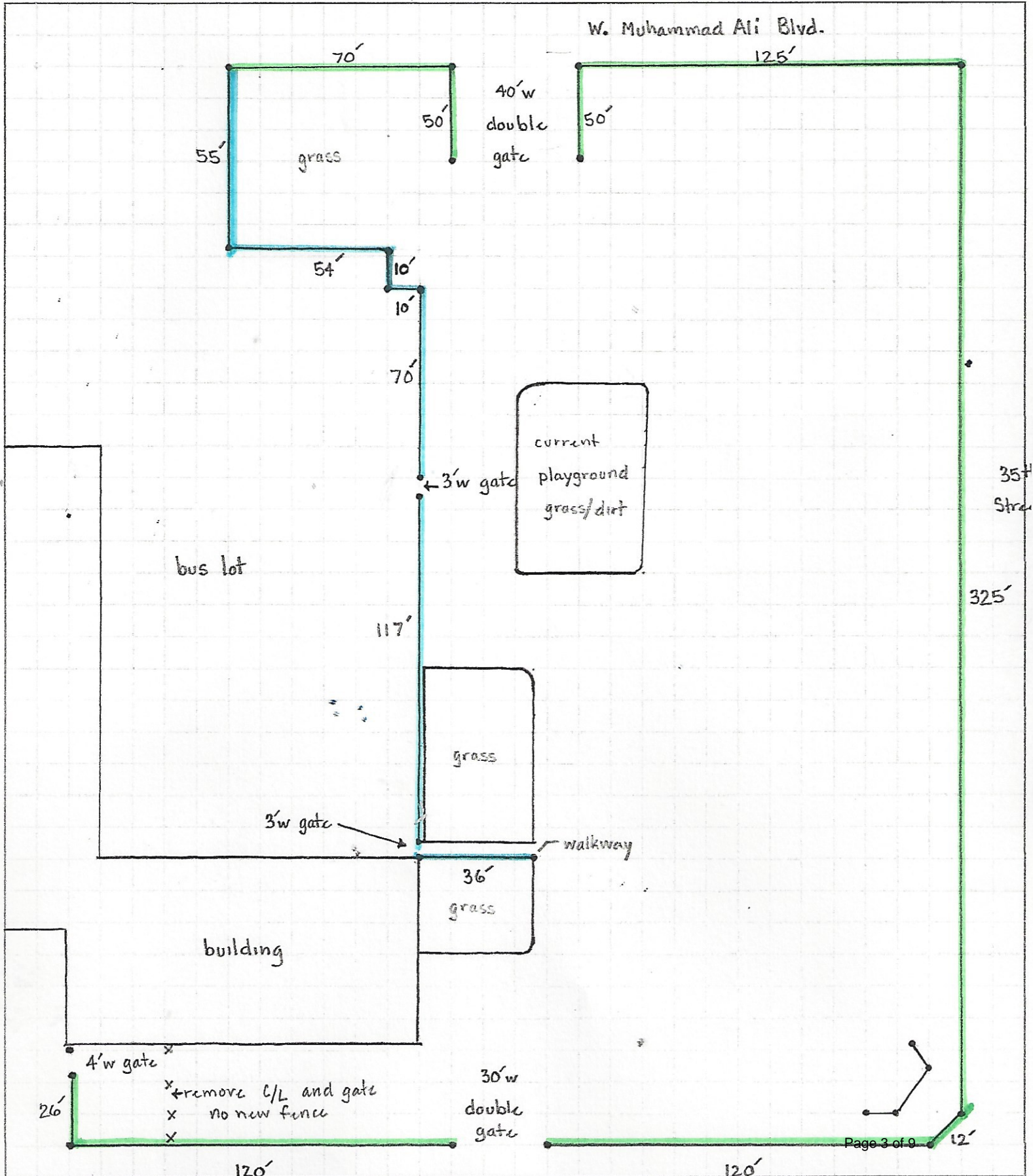

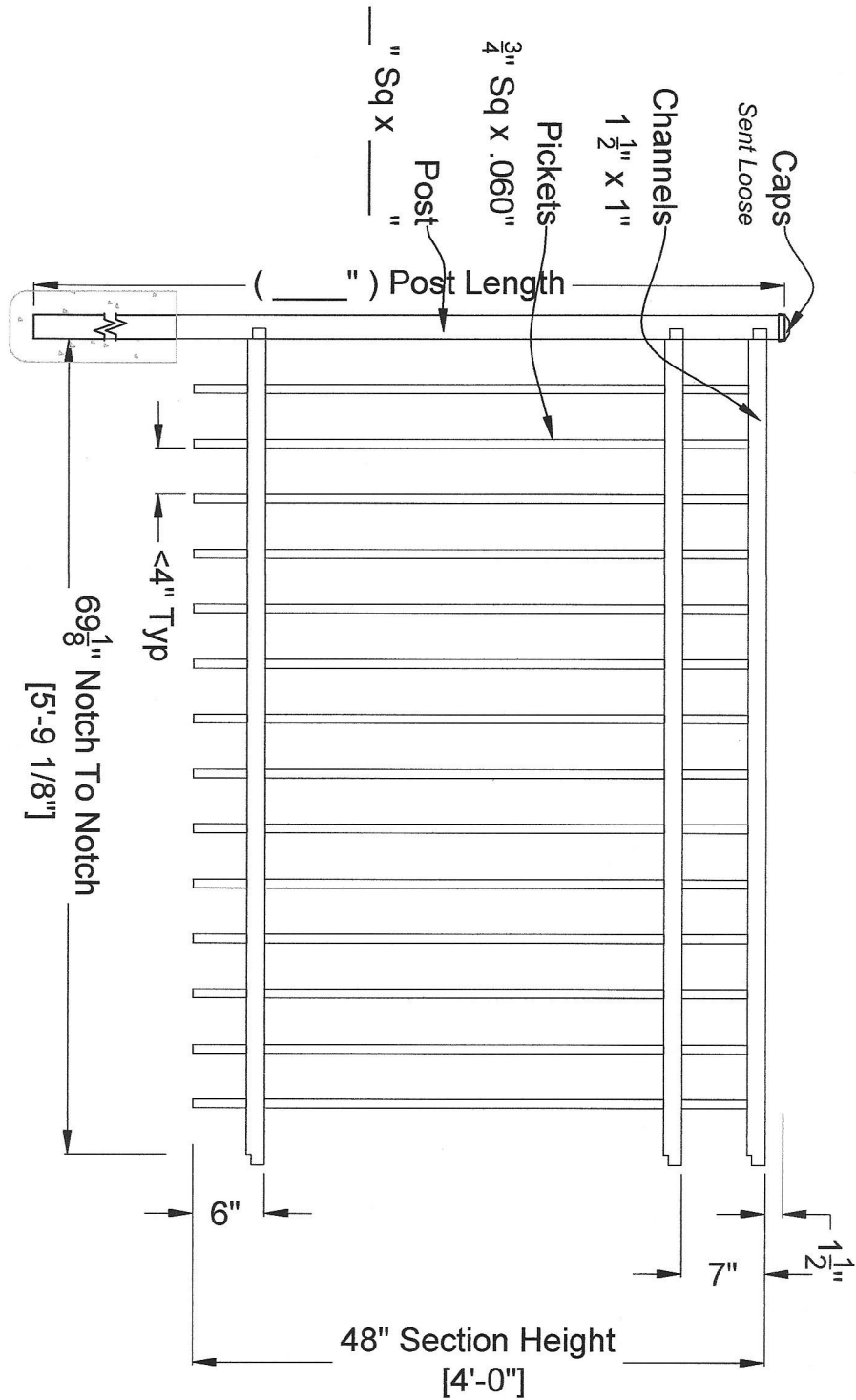

300 COMMERCIAL

Fence Section

Item #: 300S7248C

NOTICE:
All drawings, specifications and copies thereof are the property of Ideal Aluminum Products. The reproduction or unauthorized use of these documents on any other project without the written consent of Ideal Aluminum Products is strictly prohibited. The design is protected by federal copyright laws.



DO NOT SCALE DRAWING.
FOR DIMENSIONS NOT SHOWN
CONTACT PLAIN COORDINATOR FOR
CLASSIFICATION

COPYRIGHT 2013
Ideal Aluminum Products

fence gates rolling

Checked By:

Drawn By:

Quote / MST #: CAD Resource

Drawn Date: 4-Apr-18

St Augustine, FL 32084 Fax: 877.226.4469

Customer Signature:

3000 COMMERCIAL
Single Swing Walk Gate
Item #: 3000C3648

Checked By: _____

Drawn By: _____

Quote / MST #: CAD Resource

Drawn Date: 26-Feb-19

NOTE:
 All drawings, specifications and copies
 hereof are the property of IDEAL ALUMINUM
 PRODUCTS, INC. and are not to be
 reproduced or used in any other project without
 the written consent of IDEAL ALUMINUM
 PRODUCTS, INC. design is protected by federal copyright laws.



DO NOT SCALE DRAWING.
 FOR DIMENSIONS NOT SHOWN
 CONTACT IDEAL ALUMINUM FOR
 CLARIFICATION

COPYRIGHT 2013
 Ideal Aluminum Products

3200 Parker Drive Phone: 904.417.6400
 St Augustine, FL 32084 Fax: 877.226.4469

C:\Users\kleszek\Google Drive\Standard Product Library 201\SWalk Gates - Single Swing\Mechanical\Commercial\3000 Long Island\3000C3648.dwg

Customer Signature: _____

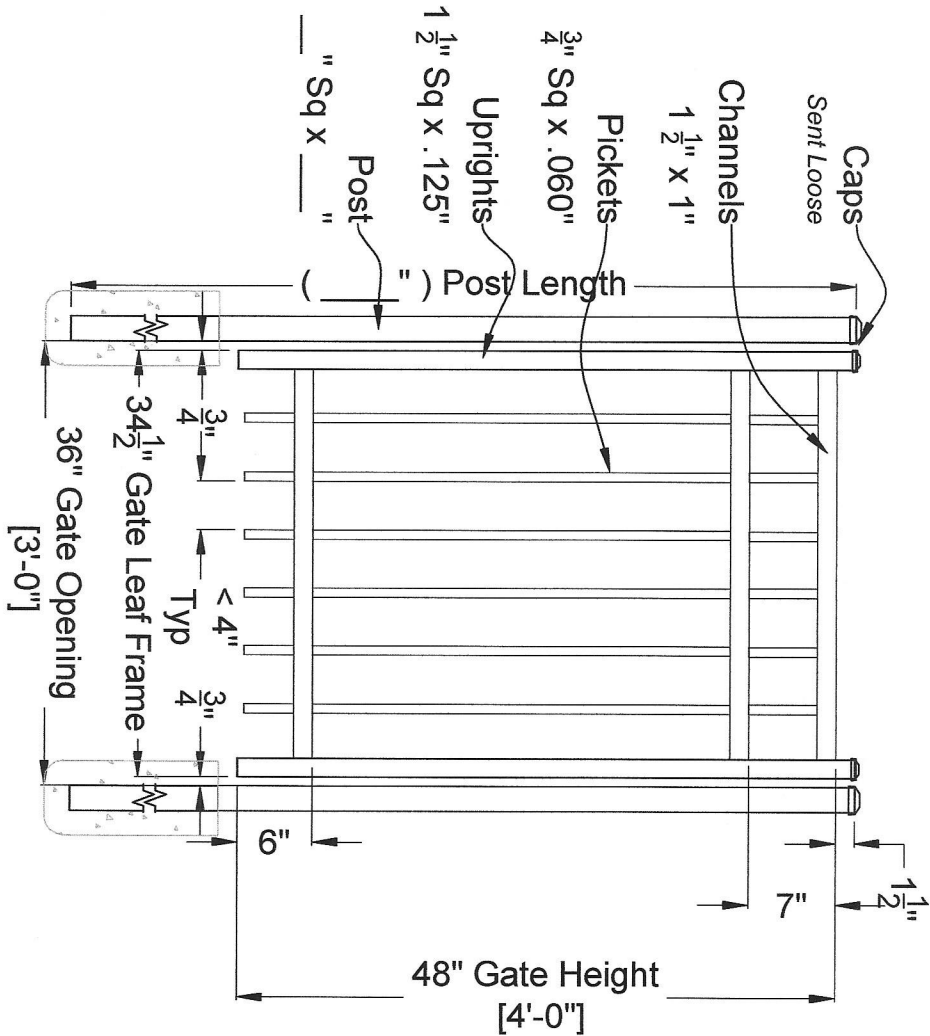

Chainlink Fence Detail

72" High Chain Link Fence

Gate Details assembled with connections

72" high x 48" wide black single walk gate - gate posts to be dug through dirt/asphalt and set with concrete

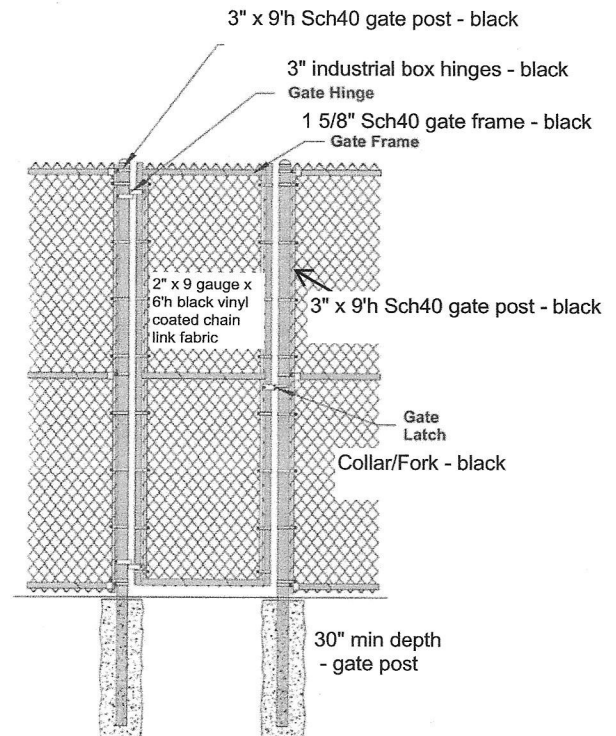

Notes:

1. If gate frame is not welded, a diagonal truss can be added



Project: Young Elementary School	
Site Location: 3526 W. Muhammad Ali Blvd.	Date: 9/10/2020
Louisville, KY 40212	Drawing # CL-17

Chainlink Fence Detail

72"H - Blk Chain Link with toprail

72" high 9ga black vinyl chain link fence dug through dirt/ asphalt and set with concrete

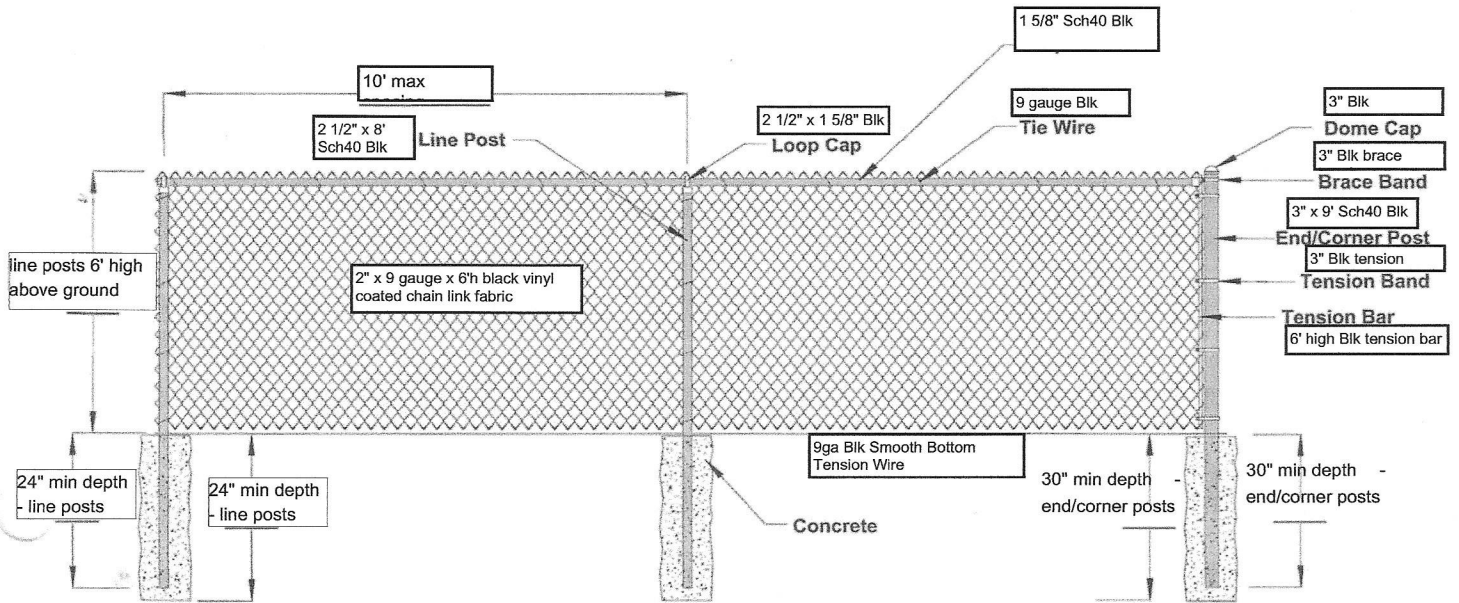

Project: Young Elementary School		
Site Location:	3526 W. Muhammad Ali Blvd.	Date: 9/10/2020
	Louisville, KY 40212	Drawing # CL-01

Chainlink Fence Detail

72" High Chain Link Fence

Gate Details assembled with connections

72" high x 40' wide black double drive gate - gate posts to be dug through dirt/asphalt and set with concrete

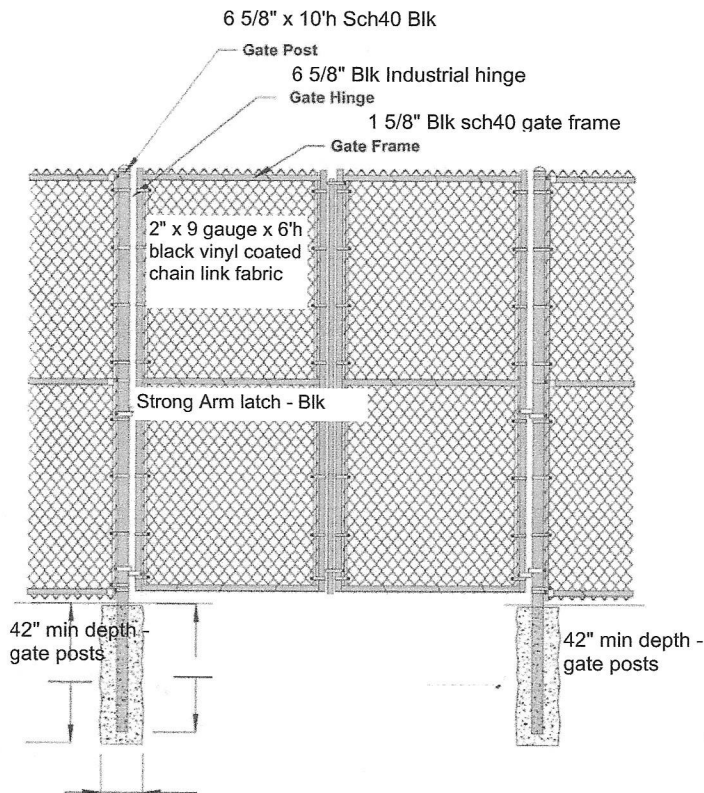

Project: Young Elementary School		
Site Location: 3526 W. Muhammad Ali Blvd.		Date: 09/10/2020
Louisville, KY 40212		Drawing # CL-17

Chainlink Fence Detail

72" High Chain Link Fence

Gate Details assembled with connections

72" high x 40' wide black double drive gate - gate posts to be dug through dirt/asphalt and set with concrete

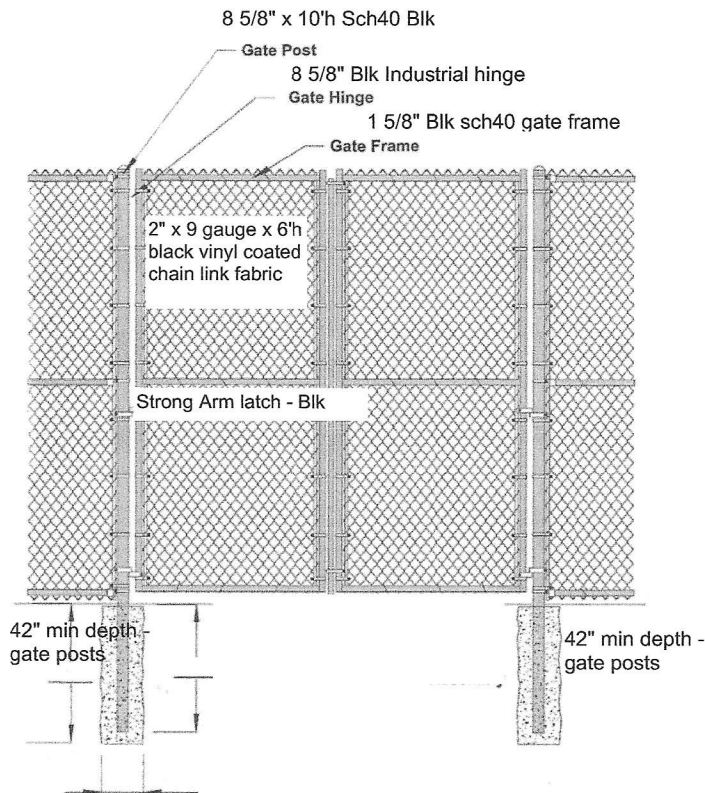

Project: Young Elementary School		
Site Location: 3526 W. Muhammad Ali Blvd.		Date: 09/10/2020
Louisville, KY 40212		Drawing # CL-17