



AIA[®] Document G701/CMa[™] – 1992

Change Order - Construction Manager-Adviser Edition

OWNER ☒
 CONSTRUCTION MANAGER ☐
 ARCHITECT ☐
 CONTRACTOR ☐
 FIELD ☐
 OTHER ☐

PROJECT (Name and address):
 JEFFERSON ELEMENTARY SCHOOL
 800 SOUTH ALVES STREET
 HENDERSON KY 42420

CHANGE ORDER NUMBER: 21-2
INITIATION DATE: 7/15/2020

TO CONTRACTOR (Name and address):
 KOBERSTEIN CONTRACTING
 12600 WARRICK COUNTY LINE ROAD
 EVANSVILLE IN 47725

PROJECT NUMBERS: CMA-KDE-000707 / 19-068
CONTRACT DATE: 5/4/2020
CONTRACT FOR: BP#021 COMBO OF BP#1-SITWORK &
 BP#2-PAVING

THE CONTRACT IS CHANGED AS FOLLOWS:

ADDITIONAL COST TO RAISE THE ENTRANCE DRIVE APPROXIMATELY 2' TO AVOID CONFLICT WITH EXISTING HENDERSON CITY WATER MAIN. ALSO INCLUDED ARE ADDING RISER RINGS TO NEWLY INSTALLED STORM STRUCTURES AND PROVIDING ADDITIONAL CONCRETE STORM STRUCTURES AS NEEDED TO REVISE THE STORM SYSTEM TO AVOID THE CONFLICT. THIS WORK REQUIRED AS CITY LINE IS NOT LOCATED AT DEPTH INDICATED BY THE UTILITY COMPANY.

The original Contract Sum was	\$2,326,115.00
Net change by previously authorized Change Orders	\$255,340.33
The Contract Sum prior to this Change Order was	\$2,581,455.33
The Contract Sum will be increased by this Change Order in the amount of	\$40,013.00
The new Contract Sum including this Change Order will be	\$2,621,468.33

The Contract Time will not be effected.

The date of Substantial Completion as of the date of this Change Order therefore is 8/5/2021

NOT VALID UNTIL SIGNED BY THE CONTRACTOR AND CONSTRUCTION MANAGER.

Codell Construction

CONSTRUCTION MANAGER (Firm Name)

4475 Rockwell Rd., Winchester, KY 40392

ADDRESS

BY (Signature)

(Typed Name)

DATE:

KOBERSTEIN CONTRACTING

CONTRACTOR (Firm Name)

12600 WARRICK COUNTY LINE ROAD EVANSVILLE, IN
 47725

ADDRESS

BY (Signature)

(Typed Name)

DATE:

HAFER DESIGN

ARCHITECT (Firm Name)

21 SE THIRD STREET, SUITE 800 EVANSVILLE, IN 47708

ADDRESS

BY (Signature)

(Typed Name)

DATE:

HENDERSON COUNTY BOARD OF EDUCATION

OWNER (Firm Name)

1805 SECOND STREET HENDERSON, KY 42420

ADDRESS

BY (Signature)

(Typed Name)

DATE:

ARCHITECT'S SUPPLEMENTAL INSTRUCTIONS

Project:	Jefferson Elementary School 800 S Alves St. Henderson KY 42420	ASI No.:	003
		Date:	June 22, 2020
Owner:	Henderson County School 1805 2nd St. Henderson KY 42420	Project Number:	1807-244
		Contract for:	Civil
To:	John Hagan Codell Codell Construction 4475 Rockwell Road Winchester KY 40392		
RE:	Road Grading Changes		

Description:

See attached revised civil sheets for adjustments to roadway grading to avoid waterline and conflict with stadium lights.

Attachments: Revised C4.2, C4.3

By: Eric Rang

CC: Keith Holz

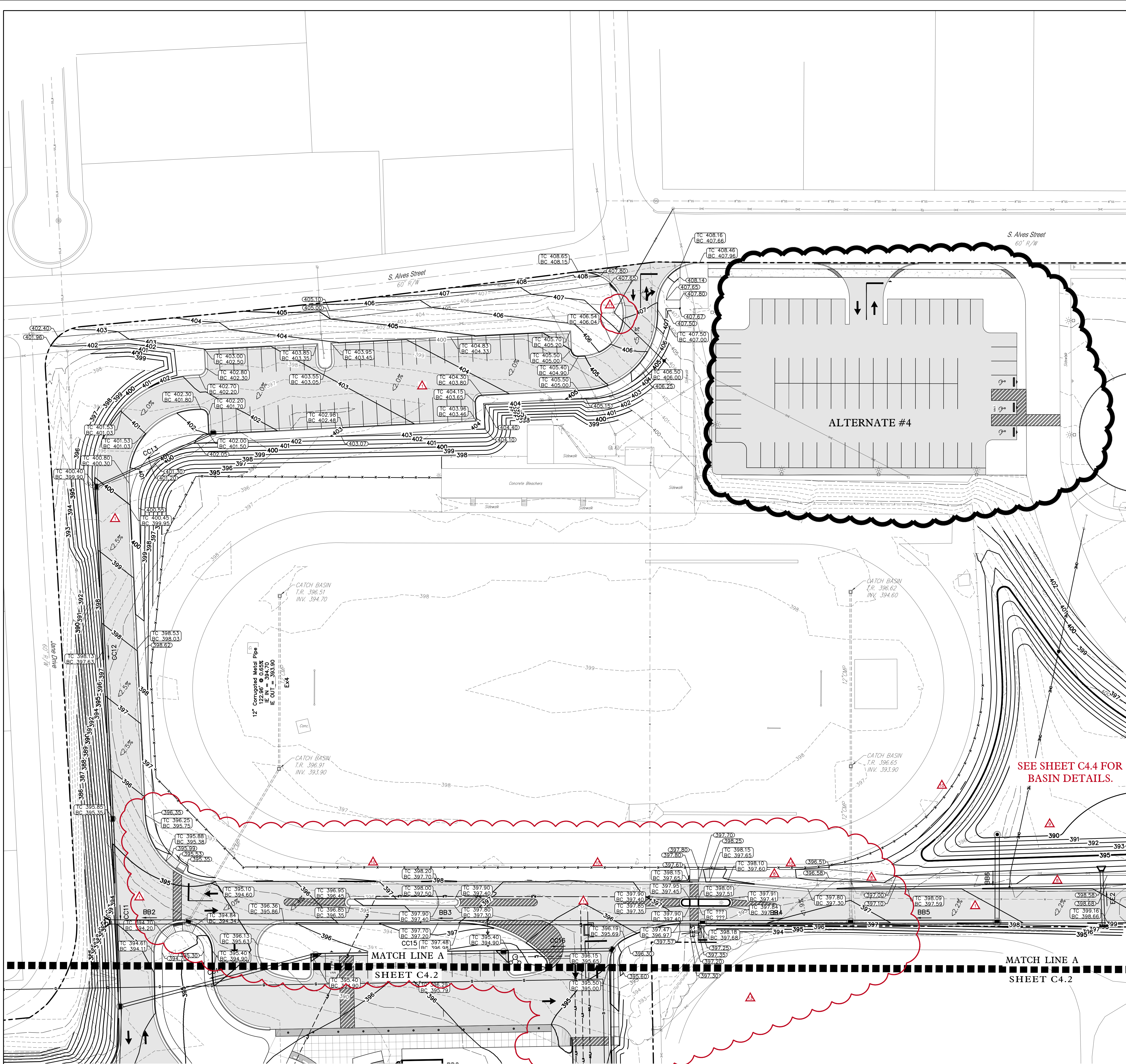

- ADDENDUM #1 (2/10/2020)**
1. MODIFIED PAVEMENT HATCHES TO DENOTE HEAVY DUTY VS LIGHT DUTY.
 2. MODIFIED STORM SYSTEM LAYOUT & PIPE SIZES.
- ADDENDUM #4 (3/02/2020)**
3. MODIFIED STORM SYSTEM LAYOUT & PIPE SIZES. UPDATED PIPE SCHEDULE TABLE ACCORDINGLY.
 4. RELOCATED STORM STRUCTURE SCHEDULE TO THIS SHEET.

- ARCHITECT'S SUPPLEMENTAL INFORMATION (5/5/2020)**
5. ADDED INVERT TO STRUCTURE SCHEDULE FOR DD-2.
 6. REVISED ELEVATIONS IN STRUCTURE SCHEDULE FOR OUTLET STRUCTURE BB-6.
 7. REVISED OUTLET STRUCTURES & PIPES FOR BASIN 3 (DD SERIES).

- ARCHITECT'S SUPPLEMENTAL INFORMATION (6/4/2020)**
8. REVISED SIDEWALK ALIGNMENT & GRADING ALONG DETENTION BASIN 2 TO AVOID POWERPOLES AND GUYS..
 9. REVISED BASIN 2 GRADING TO ACCOMMODATE REVISED SIDEWALK.
 10. REVISED ALIGNMENT OF NEW CHAIN LINK FENCE TO ACCOMMODATE REVISED SIDEWALK.
 11. ADDED UNSURVEYED STEEL POWER POLE AND GUYS TO PLAN.

- ARCHITECT'S SUPPLEMENTAL INFORMATION (6/12/2020)**
12. REVISED (RAISED) F.L. ELEVATION OF STRUCTURES BB-2, BB-3 AND CC-16 DUE TO REVISED GRADING.
 13. REVISED GRADING TO AVOID CONFLICT WITH EXISTING WATERLINE & LIGHT POLES.

STRUCTURE SCHEDULE				
NAME	TYPE	RIM/TW EL.	I.E. IN	I.E. OUT
BB-1	36" Sloped & Flared Headwall	392.55'	(BB2) 384.35	
BB-2	60" Dia. Curb Inlet	394.25'	(Ex3) 387.22 (BB3) 385.55	(BB2) 384.65
BB-3	60" Dia. Curb Inlet	397.25'	(EE3) 391.30 (BB4) 387.50	(BB3) 387.40
BB-4	60" Dia. Curb Inlet	396.70'	(Ex1) 393.25 (BB5) 388.15	(BB4) 388.05
BB-5	48" Dia. Curb Inlet	397.80'	(BB6) 388.80	(BB5) 388.70
BB-6	48" Dia. Outlet Structure	396.00'		(BB6) 389.00
CC-1	36" Sloped & Flared Headwall	388.05'	(CC2) 383.15	
CC-2	60" Dia. Curb Inlet	392.25'	(CC3) 383.25 (CC5) 385.00 (CC6) 384.80	(CC2) 383.15
CC-3	60" Dia. Curb Inlet	394.00'	(CC4) 389.95 (CC8) 388.55 (CC10) 385.00	(CC3) 384.60
CC-4	48" Dia. Curb Inlet	395.25'	(RD10) 391.40	(CC4) 390.90
CC-5	48" Dia. Curb Inlet	392.25'	(CC5) 387.90	
CC-6	48" Dia. Curb Inlet	392.25'	(CC7) 386.15	(CC6) 385.95
CC-7	48" Dia. Curb Inlet	392.19'		(CC7) 387.85
CC-8	48" Dia. Curb Inlet	393.90'	(CC9) 389.90	(CC8) 389.70
CC-9	48" Dia. Curb Inlet	395.15'	(RD29) 391.40	(CC9) 390.90
CC-10	48" Dia. Curb Inlet	393.57'	(CC14) 387.45 (CC11) 390.80	(CC10) 386.95
CC-11	48" Dia. Curb Inlet	395.30'	(CC12) 392.90	(CC11) 392.80
CC-12	48" Dia. Curb Inlet	399.80'	(CC13) 397.80	(CC12) 397.40
CC-13	48" Dia. Curb Inlet	401.50'		(CC13) 399.00
CC-14	48" Dia. Curb Inlet	394.90'	(CC15) 388.30	(CC14) 388.20
CC-15	48" Dia. Curb Inlet	394.90'	(CC16) 389.10	(CC15) 389.00
CC-16	48" Dia. Curb Inlet	395.30'	(CC17) 389.60	(CC16) 389.50
CC-17	48" Dia. Curb Inlet	393.70'	(RD1) 390.75	(CC17) 390.50
DD-1	48" Dia. Outlet Structure	388.85'		(DD2) 380.50
DD-2	24" Sloped & Flared Headwall	382.96'	(DD2) 380.05	
DD-3	24" Sloped & Flared Headwall	388.42'		(DD3-A) 385.85
DD-4	24" Sloped & Flared Headwall	388.22'	(DD3-A) 385.65	
DD-5	24" Sloped & Flared Headwall	388.22'	(DD3-B) 385.65	
DD-6	24" Sloped & Flared Headwall	388.42'		(DD3-B) 385.85
EE-1	24" Sloped & Flared Headwall	397.40'		(EE1) 394.25
EE-2	24" Sloped & Flared Headwall	396.70'	(EE1) 393.55	
EE-3	24" Straight Headwall	398.40'		(EE2) 394.00
EE-4	24" Sloped & Flared Headwall	398.00'	(EE2) 393.60	
EE-5	24" Straight Headwall	394.65'		(EE3) 391.50
EX CB 1	Rectangular Junction Structure NF	396.65'	(Ex2) 393.90	(Ex1) 393.90
EX CB 2	Existing Catch Basin	396.62'		(Ex2) 394.60
EX CB 3	Rectangular Junction Structure NF	396.91'	(Ex4) 393.90	(Ex3) 393.90
EX CB 4	Rectangular Junction Structure NF	396.51'		(Ex4) 394.70

PIPE SCHEDULE				
NAME	SIZE	TYPE	LENGTH	SLOPE
BB2	36"	HDPE Pipe	55.36'	0.54%
BB3	36"	HDPE Pipe	365.57'	0.51%
BB4	36"	HDPE Pipe	105.30'	0.52%
BB5	36"	HDPE Pipe	104.11'	0.53%
BB6	36"	HDPE Pipe	62.24'	0.32%
CC2	36"	HDPE Pipe	15.20'	0.99%
CC3	36"	HDPE Pipe	131.42'	1.03%
CC4	15"	HDPE Pipe	45.90'	2.07%
CC5	12"	HDPE Pipe	124.77'	2.32%
CC6	15"	HDPE Pipe	114.02'	1.01%
CC7	12"	HDPE Pipe	168.19'	1.01%
CC8	18"	HDPE Pipe	114.02'	1.01%
CC9	15"	HDPE Pipe	48.80'	2.05%
CC10	30"	HDPE Pipe	194.31'	1.00%
CC11	18"	HDPE Pipe	133.40'	1.50%
CC12	15"	HDPE Pipe	236.28'	1.90%
CC13	15"	HDPE Pipe	91.66'	1.31%
CC14	24"	HDPE Pipe	143.96'	0.52%
CC15	24"	HDPE Pipe	133.67'	0.52%
CC16	24"	HDPE Pipe	77.23'	0.52%
CC17	24"	HDPE Pipe	175.82'	0.51%
DD2	24"	HDPE Pipe	42.53'	1.06%
DD3-A	24"	HDPE Pipe	20.00'	1.00%
DD3-B	24"	HDPE Pipe	20.00'	1.00%
EE1	24"	HDPE Pipe	68.39'	1.02%
EE2	24"	HDPE Pipe	39.12'	1.02%
EE3	24"	HDPE Pipe	12.00'	1.67%
EX1	12"	Corrugated Metal Pipe	110.78'	0.59%
EX2	12"	Corrugated Metal Pipe	124.01'	0.56%
EX3	12"	Corrugated Metal Pipe	126.52'	0.58%
EX4	12"	Corrugated Metal Pipe	122.96'	0.65%
RD1	12"	PVC Pipe	105.68'	1.01%
RD2	12"	PVC Pipe	56.13'	1.50%
RD3	12"	PVC Pipe	52.63'	1.50%
RD4	12"	PVC Pipe	34.40'	1.50%

PIPE SCHEDULE				
NAME	SIZE	TYPE	LENGTH	SLOPE
RD5	12"	PVC Pipe	16.81'	1.50%
RD6	12"	PVC Pipe	55.67'	1.13%
RD7	12"	PVC Pipe	28.36'	2.00%
RD8	12"	PVC Pipe	4.66'	2.00%
RD9	12"	PVC Pipe	12.86'	2.00%
RD10	12"	PVC Pipe	39.31'	1.50%
RD11	12"	PVC Pipe	13.40'	1.50%
RD12	12"	PVC Pipe	25.37'	1.50%
RD13	12"	PVC Pipe	13.56'	1.50%
RD14	12"	PVC Pipe	11.88'	1.50%
RD15	12"	PVC Pipe	23.39'	1.50%
RD16	12"	PVC Pipe	18.01'	1.50%
RD17	12"	PVC Pipe	30.42'	1.50%
RD18	12"	PVC Pipe	47.89'	1.50%
RD19	12"	PVC Pipe	8.65'	1.50%
RD20	12"	PVC Pipe	26.78'	1.50%
RD21	12"	PVC Pipe	11.90'	1.50%
RD22	12"	PVC Pipe	25.39'	1.50%
RD23	12"	PVC Pipe	14.50'	1.50%
RD24	12"	PVC Pipe	10.82'	1.50%
RD25	12"	PVC Pipe	10.81'	1.50%
RD26	12"	PVC Pipe	21.02'	1.50%
RD27	12"	PVC Pipe	21.06'	1.50%
RD28	12"	PVC Pipe	44.57'	1.50%
RD29	12"	PVC Pipe	57.76'	1.00%
RD30	10"	PVC Pipe	45.57'	1.00%
RD31	10"	PVC Pipe	104.99'	1.00%
RD32	8"	PVC Pipe	42.47'	1.00%
RD33	8"	PVC Pipe	34.72'	1.00%
RD34	8"	PVC Pipe	12.95'	1.00%
RD35	8"	PVC Pipe	33.82'	1.00%
RD36	12"	PVC Pipe	19.94'	1.50%
RD37	12"	PVC Pipe	30.03'	1.50%

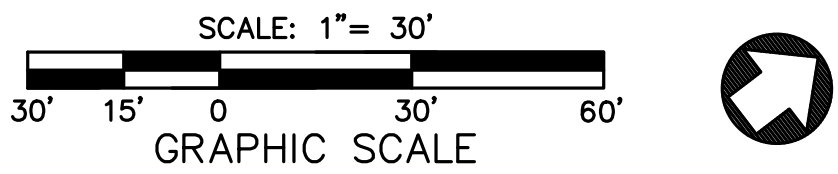

NEW ELEMENTARY SCHOOL



800 S. Alves Street
Henderson, Kentucky 42420

HAFER
architects • designers • engineers
21 SE Third Street,
Suite 600
Evansville, IN 47708
T: 812.422.4187
F: 812.421.6776
www.hafersdesign.com

In association with:

Q4
Civil Engineer
110 North Water Street, Suite B
Henderson, KY 42420
Telephone: 270.212.2177
Facsimile: 612.581.0406

HODGE
Structural Engineer
Hodge Structural Engineers
22 Chestnut Street
Evansville, IN 47713
Telephone: 812.422.2558
Facsimile: 812.422.3337

SKINNER DESIGN ASSOCIATES
Architect
101 Second Street
Henderson, KY 42420
Telephone: 270.826.8476

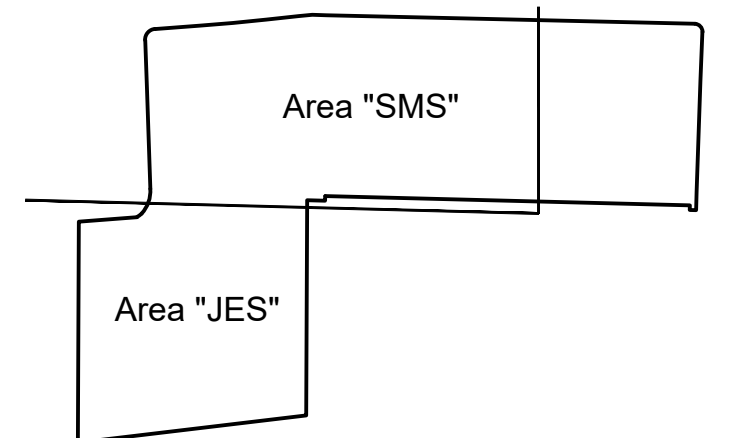
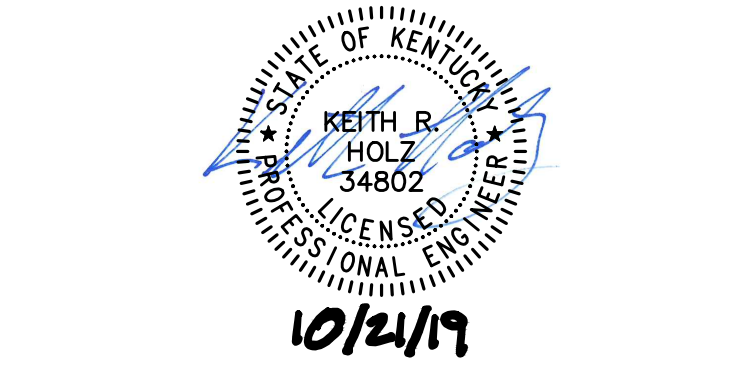

Key Plan		
Revisions:		
#	Description	Date
1	Addendum #1 (see notes)	2/10/2020
2	Addendum #4 (see notes)	3/02/2020
3	ASI #1 (see notes)	5/5/2020
4	ASI #2 (see notes)	6/8/2020
5	ASI #3 (see notes)	6/12/2020

Designed By: L. Shelton
Drawn By: K. Holz
Checked By: K. Holz

The drawings, specifications and other documents, including those in electronic form prepared by Hafer for this project are instruments of Service, and may be used solely with respect to this project. The documents may not be reproduced or modified by a third party without first obtaining the express written consent of Hafer. Authorized use of electronic media or file does not guarantee that these files contain complete and accurate information. In order to insure the accuracy of the information contained and that no changes or modifications have been made, these files must be compared to the project's contract documents with stamped and sealed certification and applicable approved modifications.

Sheet title:
**GRADING PLAN
AREA 'SMS1'**

Architect's Project No: 1807-244
Date: October, 2019

Drawing No:

C4.3

ARCHITECT'S SUPPLEMENTAL INSTRUCTIONS

Project:	Jefferson Elementary School 800 S Alves St. Henderson KY 42420	ASI No.:	005
		Date:	July 6, 2020
Owner:	Henderson County School 1805 2nd St. Henderson KY 42420	Project Number:	1807-244
		Contract for:	Civil
To:	John Hagan Codell Codell Construction 4475 Rockwell Road Winchester KY 40392		
RE:	Storm Conflict with 12" Water Main		

Description:

Please find the attached ASI 004 plans which changes pipe B5 from a single 36" diameter pipe to dual 24" pipes, changes storm structure BB-5 (48" diameter structure) to BB-5A (4'x6' structure), and adds structure BB-5B (4'x6' structure).

Attachments: Revised C4.3, C4.4

By: Eric Rang

CC: Keith Holz

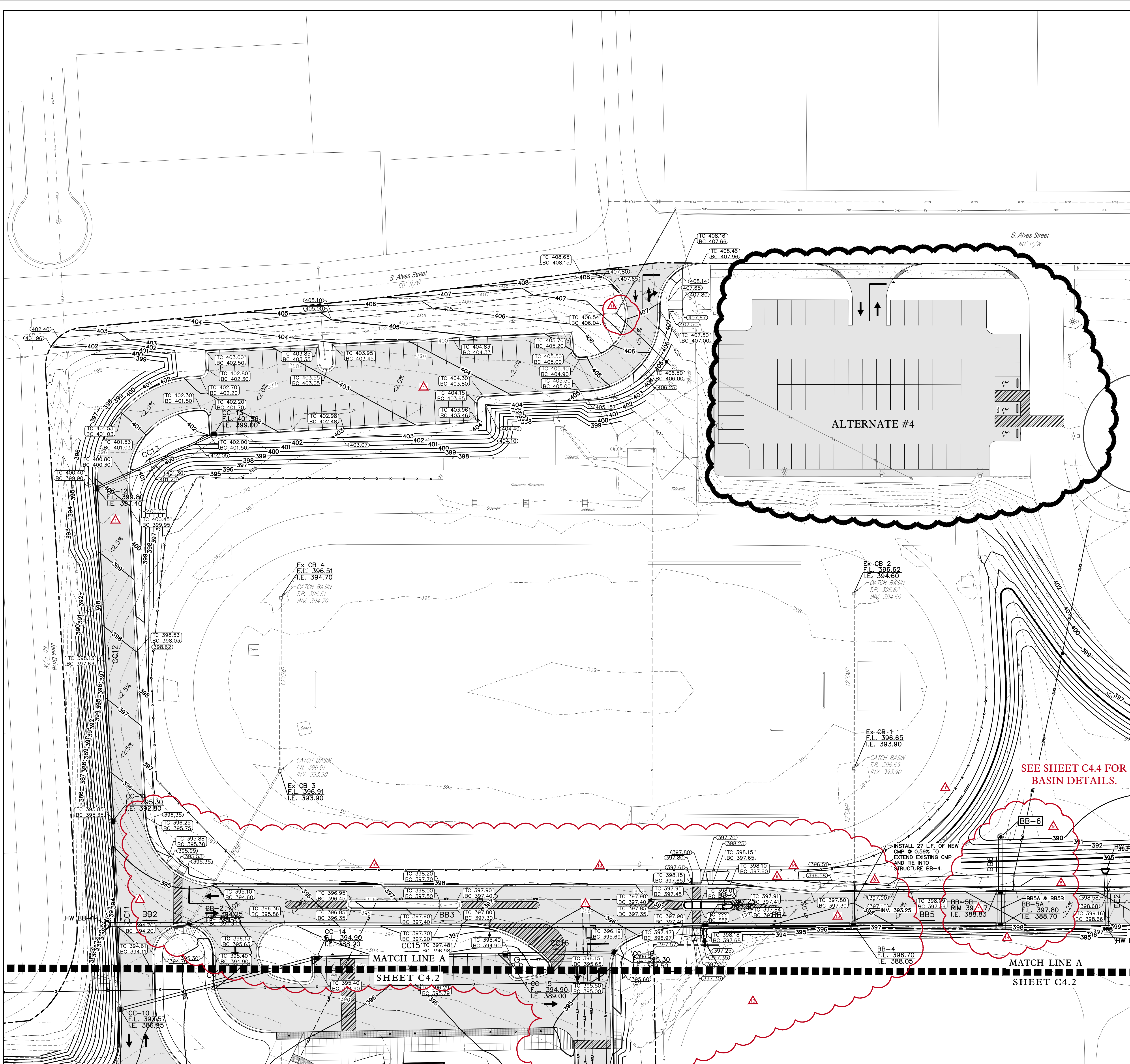

ADDENDUM #1 (2/10/2020)

1. MODIFIED PAVEMENT HATCHES TO DENOTE HEAVY DUTY VS LIGHT DUTY.
2. MODIFIED STORM SYSTEM LAYOUT & PIPE SIZES.

ADDENDUM #4 (3/02/2020)

3. MODIFIED STORM SYSTEM LAYOUT & PIPE SIZES. UPDATED PIPE SCHEDULE TABLE ACCORDINGLY.
4. RELOCATED STORM STRUCTURE SCHEDULE TO THIS SHEET.

ARCHITECTS SUPPLEMENTAL INFORMATION (5/5/2020)

5. ADDED INVERT TO STRUCTURE SCHEDULE FOR DD-2.
6. REVISED ELEVATIONS IN STRUCTURE SCHEDULE FOR OUTLET STRUCTURE BB-6.
7. REVISED OUTLET STRUCTURES & PIPES FOR BASIN 3 (DD SERIES).

ARCHITECTS SUPPLEMENTAL INFORMATION (6/4/2020)

8. REVISED SIDEWALK ALIGNMENT & GRADING ALONG DETENTION BASIN 2

TO AVOID POWERPOLES AND GUYS.

9. REVISED BASIN 2 GRADING TO ACCOMMODATE REVISED SIDEWALK.
10. REVISED ALIGNMENT OF NEW CHAIN LINK FENCE TO ACCOMMODATE REVISED SIDEWALK.
11. ADDED UNSURVEYED STEEL POWER POLE AND GUYS TO PLAN.

ARCHITECT'S SUPPLEMENTAL INFORMATION (6/12/2020)

12. REVISED (RAISED) F.L. ELEVATION OF STRUCTURES BB-2, BB-3 AND CC-16 DUE TO REVISED GRADING.

13. REVISED GRADING TO AVOID CONFLICT WITH EXISTING WATERLINE & LIGHT POLES.

ARCHITECTS SUPPLEMENTAL INFORMATION (7/6/2020)

14. ADDED STORM STRUCTURE BB-5B. REVISED STORM STRUCTURE BB-5 TO 4'x6' DOUBLE CURB INLET B-5A. REVISED STORM PIPE B5 TO TWIN 24" PIPES BB5A & BB5B.
15. REVISED STORM PIPE EX1 TO BE EXTENDED INTO STRUCTURE BB-4.

STRUCTURE SCHEDULE				
NAME	TYPE	RIM/TW EL.	I.E. IN	I.E. OUT
BB-1	36" Sloped & Flared Headwall	392.55'	(BB2) 384.35	
BB-2	60" Dia. Curb Inlet	394.25'	(Ex3) 387.22 (BB3) 385.55	(BB2) 384.65
BB-3	60" Dia. Curb Inlet	397.25'	(BB4) 387.50	(BB3) 387.40
BB-4	60" Dia. Curb Inlet	396.70'	(Ex1) 393.25 (BB5) 388.15	(BB5) 388.70
BB-5A	4'x6' Double Curb Inlet	397.80'		(BB5) 388.70
BB-5B	4'x6' Double Curb Inlet	398.27'	(BB6) 388.88	(BB5A & BB5B) 388.83
BB-6	48" Dia. Outlet Structure	396.00'	(BB6) 388.88	
CC-1	36" Sloped & Flared Headwall	388.00'	(CC2) 383.00	
CC-2	60" Dia. Curb Inlet	392.25'	(CC3) 383.25 (CC5) 385.00 (CC6) 384.80	(CC2) 383.15
CC-3	60" Dia. Curb Inlet	394.00'	(CC4) 389.95 (CC8) 388.55 (CC10) 385.00	(CC3) 384.60
CC-4	48" Dia. Curb Inlet	395.25'	(RD10) 391.40	(CC4) 390.90
CC-5	48" Dia. Curb Inlet	392.25'		(CC5) 387.90
CC-6	48" Dia. Curb Inlet	392.25'	(CC7) 386.15	(CC6) 385.95
CC-7	48" Dia. Curb Inlet	392.19'		(CC7) 387.85
CC-8	48" Dia. Curb Inlet	393.90'	(CC9) 389.90	(CC8) 389.70
CC-9	48" Dia. Curb Inlet	395.15'	(RD29) 391.40	(CC9) 390.90
CC-10	48" Dia. Curb Inlet	393.57'	(CC14) 387.45 (CC11) 390.80	(CC10) 386.95
CC-11	48" Dia. Curb Inlet	395.30'	(CC12) 392.90	(CC11) 392.80
CC-12	48" Dia. Curb Inlet	399.80'	(CC13) 397.80	(CC12) 397.40
CC-13	48" Dia. Curb Inlet	401.50'		(CC13) 399.00
CC-14	48" Dia. Curb Inlet	394.90'	(CC15) 388.30	(CC14) 388.20
CC-15	48" Dia. Curb Inlet	394.90'	(CC16) 389.10	(CC15) 389.00
CC-16	48" Dia. Curb Inlet	395.30'	(CC17) 389.60	(CC16) 389.50
CC-17	48" Dia. Curb Inlet	393.70'	(RD1) 390.75	(CC17) 390.50
DD-1	48" Dia. Outlet Structure	385.85'		(DD2) 380.50
DD-2	24" Sloped & Flared Headwall	382.96'	(DD2) 380.05	
DD-3	24" Sloped & Flared Headwall	388.42'		(DD3-A) 385.85
DD-4	24" Sloped & Flared Headwall	388.22'	(DD3-A) 385.65	
DD-5	24" Sloped & Flared Headwall	388.22'	(DD3-B) 385.65	
DD-6	24" Sloped & Flared Headwall	388.42'		(DD3-B) 385.85
EE-1	24" Sloped & Flared Headwall	397.40'		(EE1) 394.25
EE-2	24" Sloped & Flared Headwall	396.70'	(EE1) 393.55	
EE-3	24" Straight Headwall	398.40'		(EE2) 394.00
EE-4	24" Sloped & Flared Headwall	398.00'	(EE2) 393.60	
EE-5	24" Straight Headwall	394.65'		(EE3) 391.50
EX CB 1	Rectangular Junction Structure NF	396.65'	(Ex2) 393.90	(Ex1) 393.90
EX CB 2	Existing Catch Basin	396.62'		(Ex2) 394.60
EX CB 3	Rectangular Junction Structure NF	396.91'	(Ex4) 393.90	(Ex3) 393.90

PIPE SCHEDULE					PIPE SCHEDULE				
NAME	SIZE	TYPE	LENGTH	SLOPE	NAME	SIZE	TYPE	LENGTH	SLOPE
BB2	36"	HDPE Pipe	55.36'	0.54%	RD4	12"	PVC Pipe	34.40'	1.50%
BB3	36"	HDPE Pipe	365.57'	0.51%	RD5	12"	PVC Pipe	16.81'	1.50%
BB4	36"	HDPE Pipe	105.30'	0.52%	RD6	12"	PVC Pipe	55.67'	1.13%
BB5	36"	HDPE Pipe	104.11'	0.33%	RD7	12"	PVC Pipe	28.36'	2.00%
BB5A & BB5B	24"	Twin HDPE Pipes	24.00'	0.33%	RD8	12"	PVC Pipe	4.66'	2.00%
BB6	36"	HDPE Pipe	38.74'	0.31%	RD9	12"	PVC Pipe	12.86'	2.00%
CC2	36"	HDPE Pipe	15.20'	0.99%	RD10	12"	PVC Pipe	39.31'	1.50%
CC3	36"	HDPE Pipe	131.42'	1.03%	RD11	12"	PVC Pipe	13.40'	1.50%
CC4	15"	HDPE Pipe	45.90'	2.07%	RD12	12"	PVC Pipe	25.37'	1.50%
CC5	12"	HDPE Pipe	124.77'	2.32%	RD13	12"	PVC Pipe	13.56'	1.50%
CC6	15"	HDPE Pipe	114.02'	1.01%	RD14	12"	PVC Pipe	11.88'	1.50%
CC7	12"	HDPE Pipe	168.19'	1.01%	RD15	12"	PVC Pipe	23.39'	1.50%
CC8	18"	HDPE Pipe	114.02'	1.01%	RD16	12"	PVC Pipe	18.01'	1.50%
CC9	15"	HDPE Pipe	48.80'	2.05%	RD17	12"	PVC Pipe	30.42'	1.50%
CC10	30"	HDPE Pipe	194.31'	1.00%	RD18	12"	PVC Pipe	47.89'	1.50%
CC11	18"	HDPE Pipe	133.40'	1.50%	RD19	12"	PVC Pipe	8.65'	1.50%
CC12	15"	HDPE Pipe	236.28'	1.90%	RD20	12"	PVC Pipe	26.78'	1.50%
CC13	15"	HDPE Pipe	91.66'	1.31%	RD21	12"	PVC Pipe	11.90'	1.50%
CC14	24"	HDPE Pipe	143.96'	0.52%	RD22	12"	PVC Pipe	25.39'	1.50%
CC15	24"	HDPE Pipe	133.67'	0.52%	RD23	12"	PVC Pipe	14.50'	1.50%
CC16	24"	HDPE Pipe	77.23'	0.52%	RD24	12"	PVC Pipe	10.82'	1.50%
CC17	24"	HDPE Pipe	175.82'	0.51%	RD25	12"	PVC Pipe	10.81'	1.50%
DD2	24"	HDPE Pipe	42.53'	1.06%	RD26	12"	PVC Pipe	21.02'	1.50%
DD3-A	24"	HDPE Pipe	20.00'	1.00%	RD27	12"	PVC Pipe	21.06'	1.50%
DD3-B	24"	HDPE Pipe	20.00'	1.00%	RD28	12"	PVC Pipe	44.57'	1.50%
EE1	24"	HDPE Pipe	68.39'	1.02%	RD29	12"	PVC Pipe	57.76'	1.00%
EE2	24"	HDPE Pipe	39.12'	1.02%	RD30	10"	PVC Pipe	45.57'	1.00%
EE3	24"	HDPE Pipe	12.00'	1.67%	RD31	10"	PVC Pipe	104.99'	1.00%
EX1	12"	Corrugated Metal Pipe	110.78'	0.59%	RD32	8"	PVC Pipe	42.47'	1.00%
EX2	12"	Corrugated Metal Pipe	124.01'	0.56%	RD33	8"	PVC Pipe	34.72'	1.00%
EX3	12"	Corrugated Metal Pipe	126.52'	5.28%	RD34	8"	PVC Pipe	12.95'	1.00%
EX4	12"	Corrugated Metal Pipe	122.96'	0.65%	RD35	8"	PVC Pipe	33.82'	1.00%
RD1	12"	PVC Pipe	105.68'	1.01%	RD36	12"	PVC Pipe	19.94'	1.50%
RD2	12"	PVC Pipe	56.13'	1.50%	RD37	12"	PVC Pipe	30.03'	1.50%
RD3	12"	PVC Pipe	52.63'	1.50%					

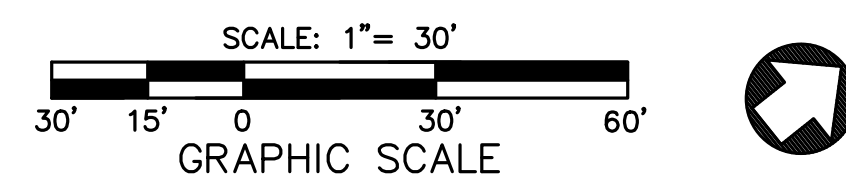

NEW ELEMENTARY SCHOOL



800 S. Alves Street
Henderson, Kentucky 42420

HAFFER
architects • designers • engineers
21 SE Third Street,
Suite 600
Evansville, IN 47708
T: 812.422.4187
F: 812.421.6776
www.hafferdesign.com

In association with:

QK4
Civil Engineer
110 North Water Street, Suite B
Henderson, KY 42420
Telephone: 270.212.2177
Facsimile: 502.581.0406

HODGE
Structural Engineer
Hodge Structural Engineers
22 Chestnut Street
Evansville, IN 47713
Telephone: 812.422.2558
Facsimile: 812.422.3337

SKINNER DESIGN ASSOCIATES
Architect
Skinner Design Associates
101 Second Street
Henderson, KY 42420
Telephone: 270.826.8476

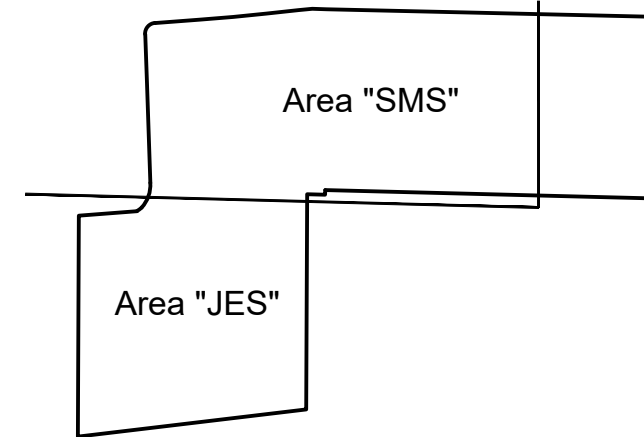
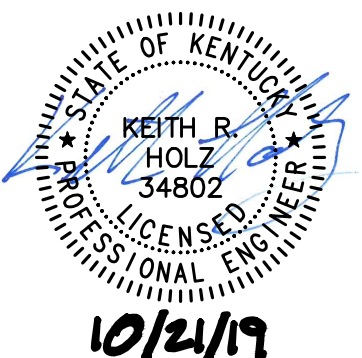

Key Plan

Revisions:		
#	Description	Date
1	Addendum #1 (see notes)	2/10/2020
2	Addendum #4 (see notes)	3/02/2020
3	ASI #1 (see notes)	5/5/2020
4	ASI #2 (see notes)	6/8/2020
5	ASI #3 (see notes)	6/12/2020
6	ASI #5 (see notes)	7/6/2020

The drawings, specifications and other documents, including those in electronic form prepared by Haffer for this project are instruments of Service, and may be used solely with respect to this project. The documents may not be reproduced or modified by a third party without first obtaining the express written consent of Haffer. Authorized use of electronic media or file does not guarantee that these files contain complete and accurate information. In order to insure the accuracy of the information contained and that no changes or modifications have been made, these files must be compared to the project's contract documents with stamped and sealed certification and applicable approved modifications.

Sheet title:

GRADING PLAN AREA 'SMS1'

Architect's Project No:

Date:

1807-244

October, 2019

Drawing No:

C4.3

In association with:

QK4
Civil Engineer
110 North Water Street, Suite B
Henderson, KY 42420
Telephone: 270.212.2177
Facsimile: 502.581.0406

HODGE
Structural Engineer
Hodge Structural Engineers
22 Chestnut Street
Evansville, IN 47713
Telephone: 812.422.2558
Facsimile: 812.422.3337

SKINNER DESIGN ASSOCIATES
Architect
101 Second Street
Henderson, KY 42420
Telephone: 270.826.8476

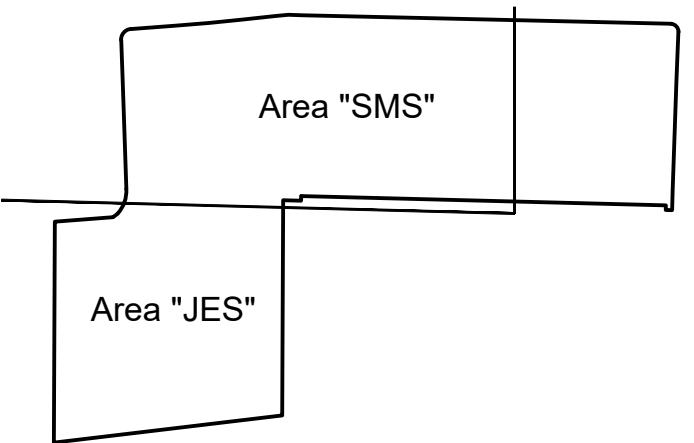
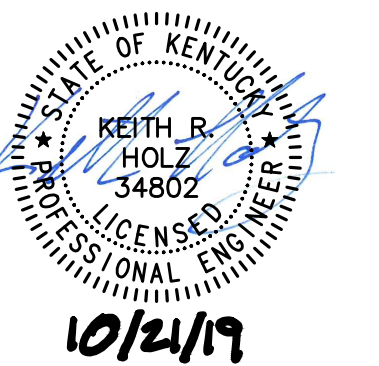

Key Plan

#	Description	Date
1	Addendum #1 (see notes)	2/10/2020
2	Addendum #4 (see notes)	3/02/2020
3	ASI #1 (see notes)	5/05/2020
4	ASI #2 (see notes)	6/06/2020
4	ASI #5 (see notes)	7/06/2020

Designed By: L. Shelton
Drawn By: L. Shelton
Checked By: K. Holz

The drawings, specifications and other documents, including those in electronic form prepared by Hafer for this project are instruments of Service, and may be used solely with respect to this project. The documents may not be reproduced or modified by a third party without first obtaining the express written consent of Hafer. Authorized use of electronic media or file does not guarantee that these files contain complete and accurate information. In order to insure the accuracy of the information contained and that no changes or modifications have been made, these files must be compared to the project's contract documents with stamped and sealed certification and applicable approved modifications.

Sheet title:

**DRAINAGE PLAN
AREA 'SMS2'**

Architect's Project No: 1807-244
Date: October, 2019

Drawing No:

C4.4

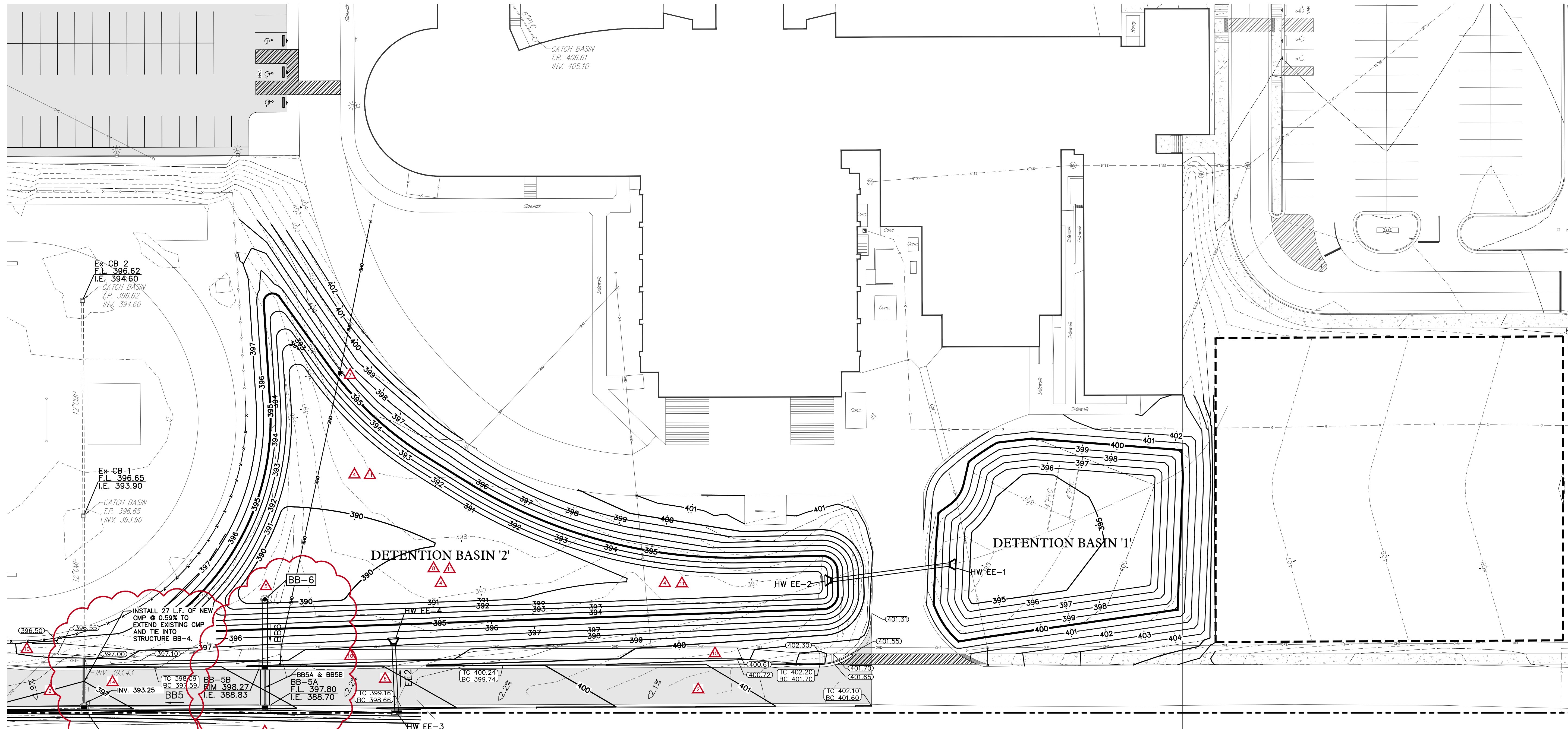

ADDENDUM #1 (2/10/2020)

1. ADDED SHEET C4.4 TO PLAN SET TO SHOW ENLARGED BASIN 1 & BASIN 2 AREAS WITH MODIFIED GRADING, OUTLET STRUCTURES & DETAILS.
2. MODIFIED PAVEMENT HATCHES TO DENOTE HEAVY DUTY VS LIGHT DUTY.
3. MODIFIED STORM SYSTEM LAYOUT & PIPE SIZES.

ADDENDUM #4 (3/02/2020)

4. REVISED BASIN 2 GRADING.
5. REVISED BASIN 2 OUTLET STRUCTURE BB-6. REVISED DETAIL 1 ACCORDINGLY.
6. ADDED CULVERT EE2 TO PLAN.
7. ADDED RELOCATED POWER POLE TO PLAN. ADDED KEYNOTE #25 CONCERNING POWER POLE RELOCATION.

ARCHITECT'S SUPPLEMENTAL INFORMATION (5/5/2020)

8. REFINED CONTOURS FOR DETENTION BASIN #2.
9. REVISED OUTLET STRUCTURE BB-6 DETAIL.

ARCHITECT'S SUPPLEMENTAL INFORMATION (6/4/2020)

10. REVISED SIDEWALK ALIGNMENT ALONG DETENTION BASIN 2 TO AVOID POWERPOLES AND GUYS..
11. REVISED BASIN 2 TO ACCOMODATE REVISED SIDEWALK.
12. REVISED OUTLET STRUCTURE B-6 DETAIL TO REFLECT MODIFIED BASIN 2 CALCULATIONS.

ARCHITECT'S SUPPLEMENTAL INFORMATION (7/6/2020)

13. ADDED STORM STRUCTURE BB-5B. REVISED STORM STRUCTURE BB-5 TO 4'x6' DOUBLE CURB INLET B-5A. REVISED STORM PIPE B5 TO TWIN 24" PIPES BB5A & BB5B.
14. REVISED STORM PIPE EX1 TO BE EXTENDED INTO STRUCTURE BB-4.

SEE SHEET C4.3 FOR STORM PIPE
& STRUCTURE SCHEDULES.

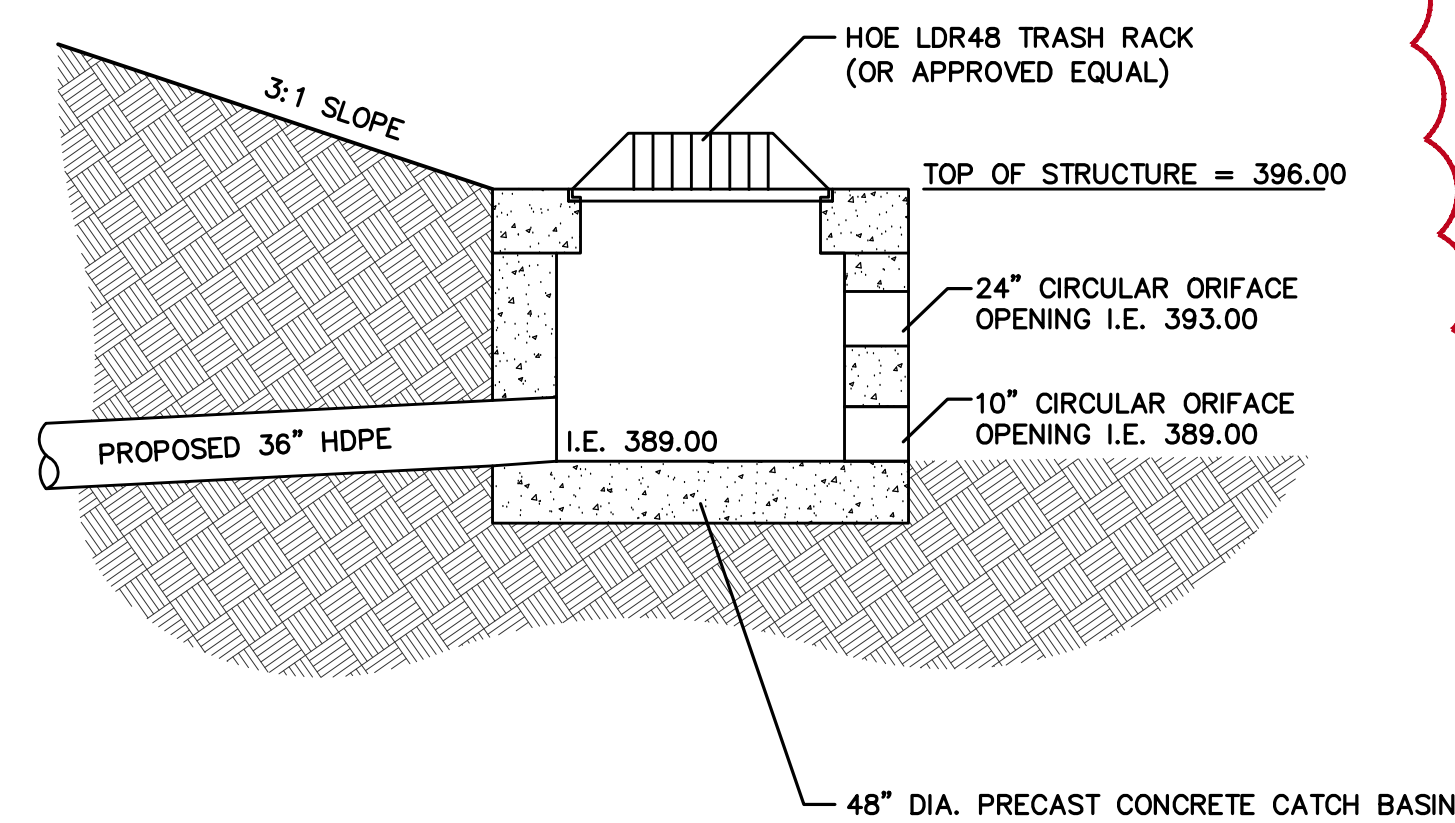

- A. PRECAST SECTIONS SHALL BE PER ASTM C-478 (LATEST REVISION)
- B. CONCRETE STRENGTH PER ASTM C-478
- C. PRECAST OR CAST IN PLACE AT CONTRACTOR'S OPTION.

OUTLET STRUCTURE BB-6
SCALE: N.T.S.

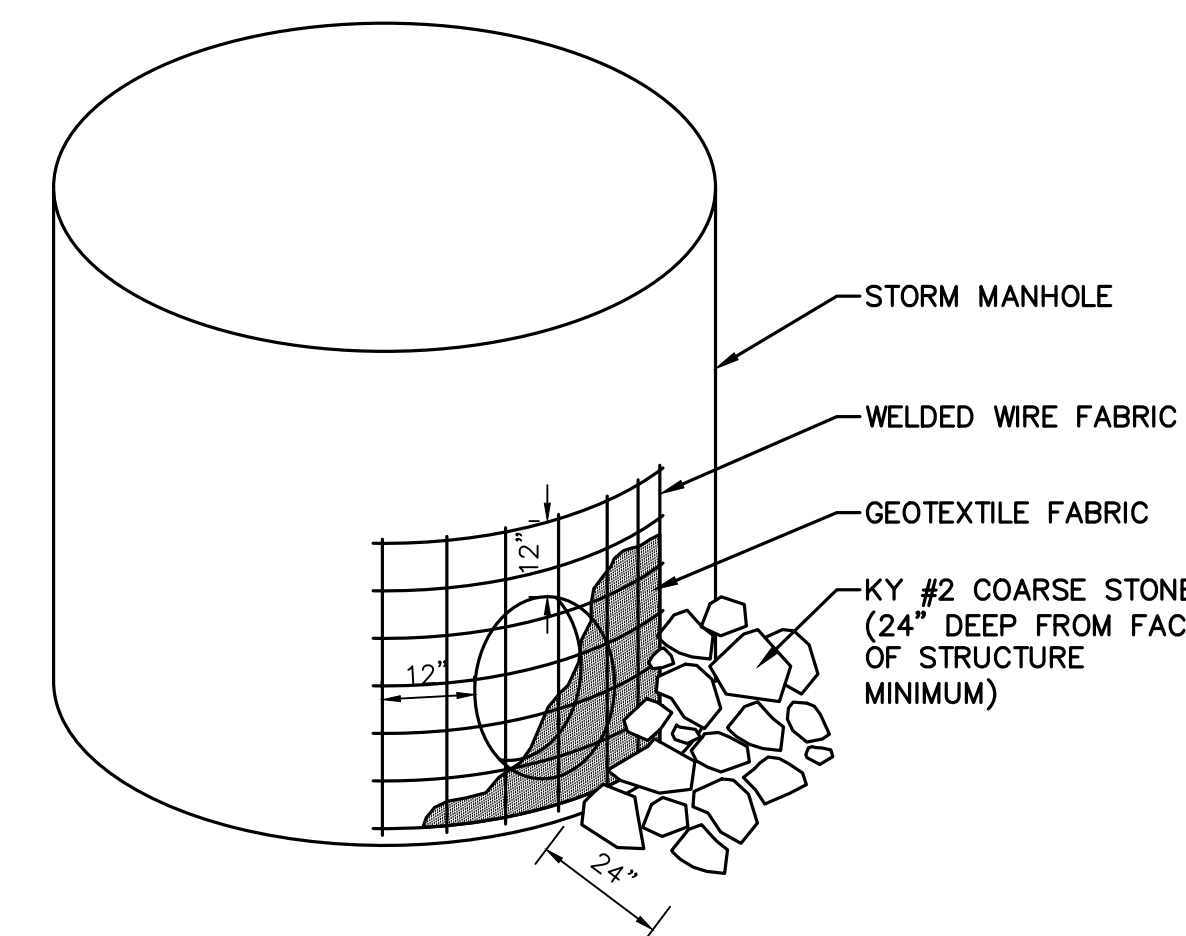

ORIFICE PROTECTION
SCALE: NONE

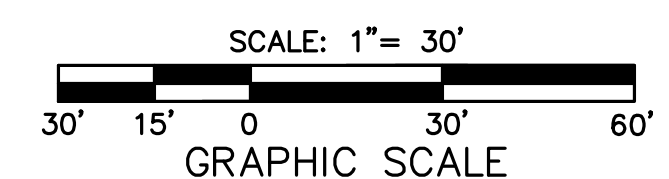



KCI CHANGE ORDER / EXTRA WORK COSTS

Project: Jefferson Elementary School

ORDER NO. S: **ASI 003**

Submit To: Codell Construction

Change Order: **TBD**

Date: **7/8/2020**

ASI 003 - Raise Road

Per ASI 003 dated 6/12/2020, raise road approximately 2' to avoid conflict with existing water line and light poles. Includes placing, aerating, and compacting (3) lifts of fill material from on site, adding riser rings to BB-3 and CI-16, and repouring CI-15 base.

Total	\$	15,764
Schedule Delay		5 days

ASI 003:

Labor: \$5,782

Equipment: \$8,631

Material: \$1,351

Total: \$15,764 - Per Matt Blyth



KCI CHANGE ORDER / EXTRA WORK COSTS

Project: Jefferson Elementary School

ORDER NO. S: ~~ASI 004~~ ASI #5

Submit To: Codell Construction

Change Order: **TBD**

Date: **7/8/2020**

~~ASI 004~~ - Storm Water Conflict and Extend Existing 12" CMP

Per ASI 004 dated 7/6/2020, remove and haul off installed structure BB5, install (2) 4x6' double curb inlets and castings (BB5A and BB5B), add 48' 24" HDPE pipe, deduct 24' 36" HDPE pipe, and add 27 lf 12" CMP.

Total	\$	30,249
Schedule Delay		3 days

Labor = \$7,217

Material = \$16,167

Equipment = \$6,865 - JHC per Matt Byth Email attached

From: [Matt Blythe](#)
To: [John Hagan Codell](#)
Cc: [Asher Alden](#)
Subject: RE: ASI # 004 - Jefferson Elementary Storm conflict with 12" water main
Date: Friday, July 10, 2020 3:36:44 PM

Labor: \$7,217
Equipment: \$6,865
Material: \$16,167
Total: \$30,249

Thanks,

Matt Blythe
Project Manager
Koberstein Contracting, Inc.
12600 Warrick County Line Rd
Evansville, IN 47725
Office: 812-214-7369
Mobile: 812-664-9929

From: John Hagan Codell <JHCodell@codellconstruction.com>
Sent: Friday, July 10, 2020 2:19 PM
To: Matt Blythe <mblythe@kobersteins.com>
Cc: Asher Alden <aalden@kobersteins.com>
Subject: RE: ASI # 004 - Jefferson Elementary Storm conflict with 12" water main

Can you break these down into labor and material? thanks

John Hagan Codell
jhcodell@codellconstruction.com
Cell: (859) 576-7625
Office: (859) 744-2222

From: Matt Blythe [<mailto:mblythe@kobersteins.com>]
Sent: Wednesday, July 8, 2020 8:02 AM
To: John Hagan Codell <JHCodell@codellconstruction.com>
Cc: Asher Alden <aalden@kobersteins.com>
Subject: RE: ASI # 004 - Jefferson Elementary Storm conflict with 12" water main

John,

See attached pricing for ASI 003 and ASI 004. Please ask QK4/Hafer if they need submittals on the new structures BB5A and BB5B. Our supplier is running about 3 weeks out on new structures, and if submittals are required that could add another couple weeks to push approvals through.