



CHANGE ORDER

DATE: 8/8/19 CO #: Three (03)
TO: BCD, Inc. PROJECT: Mercer County District
1962 Filiatreau Lane Improvements
Bardstown, Kentucky 40004 Harrodsburg, Kentucky
RTA 1832
BG 19-065
CONTRACT DATE: February 14, 2019 CONTRACT FOR: General Construction

THE CONTRACT IS CHANGED AS FOLLOWS:

(Include, where applicable, any undisputed amount attributable to previously executed Construction Change Directives.)

PR-06: \$8,906.18: Hardware at Vestibule A at MCIS; PR-07: \$6,440.00: exterior handrail at KMS; PR-09: \$1,736.50: exterior site wall repair at KMS; and COP-09: \$1,988.72: MCIS sidewalk and KMS conduit.

TOTAL AMOUNT OF THIS CHANGE ORDER: \$19,071.40

The original Contract Sum was	\$555,500.00
The net change by previously authorized Change Orders	-\$6,841.00
The Contract Sum prior to this Change Order was	\$548,659.00
The Contract Sum will be Increased by this Change Order in the amount of	\$19,071.40
The new Contract Sum including this Change Order will be	\$567,730.40

The Date of Substantial Completion as of the date of this Change Order is therefore October 1, 2019

NOTE: This Change Order does not include changes in the Contract Sum, Contract Time or Guaranteed Maximum Price which have been authorized by Construction Change Directive until the cost and time have been agreed upon by both the Owner and Contractor, in which case a Change Order is executed to supersede the Construction Change Directive.

NOT VALID UNTIL SIGNED BY THE ARCHITECT, CONTRACTOR AND OWNER.

Rosstarrant Architects, Inc.
101 Old Lafayette Avenue
Lexington, Kentucky 40502
ARCHITECT *(Firm name and address)*

Beth Bauer
BY *(Signature)*

Beth Bauer
(Typed or printed name)

8/8/19
DATE

BCD, Inc.
1962 Filiatreau Lane
Bardstown, Kentucky 40004
CONTRACTOR *(Firm name and address)*

Jason Harrod
BY *(Signature)*

JASON HARROD
(Typed or printed name)

8/8/19
DATE

Mercer Co. Board of Education
530 Perryville Rd.
Harrodsburg, Kentucky 40330
OWNER *(Firm name and address)*

BY *(Signature)*

(Typed or printed name)

DATE

FACPAC Contract Change Order Supplemental Information Form (Ref# 51726)

Form Status: Saved

Tier 3 Project: District Improvements FY19

BG Number: 19-065

Status: Active

District: Mercer County (421)

Phase: Project Initiation (View Checklist)

Contract: BCD, Inc., 0001, General Contractor

Type: General Contractor

Proposed

Change Order Number	3
Time Extension Required	Yes
If Yes Number Of Days	60
Date Of Change Order	8/8/2019
Change Order Amount To Date	Increase

Construction Contingency

Calculations below are project wide. Remaining negative Construction Contingency may require the submission of a revised BG1.

Current Approved Amount	\$32,462.00
Net Approved COs	\$-8,193.00
Remaining After Approved COs	\$40,655.00
Net All COs	\$12,230.40
Remaining After All COs	\$20,231.60

This Requested Change Order Amount +/-	\$19,071.40
Change In A/E Fee This Change Order +/-	\$1,589.94
Change In CM Fee This Change Order +/-	
Remaining Construction Contingency Balance	\$20,231.60
Contract Change Requested By	General Contractor; Local Board of Education
Contract Change Reason Code	Expansion of Scope; Found Condition

Change Order Description And Justification

PR-06: \$8,906.18: Hardware at Vestibule A at MCIS; PR-07: \$6,440.00: exterior handrail at KMS; PR-09: \$1,736.50: exterior site wall repair at KMS; and COP-09: \$1,988.72: MCIS sidewalk and KMS conduit.

Cost Benefit To Owner

Owner requested changes and found conditions. Pricing has been reviewed and is acceptable.

Contract unit prices have been utilized to support No
the cost associated with this change order.

Detailed Cost Breakdown

Contract unit prices have not been utilized, provide a detailed cost breakdown which separates labor, material, profit and overhead.

Detail Item	Amount	Percent of Total
Labor	\$2,916.00	15.29 %
Materials	\$13,927.22	73.03 %
Profit and Overhead	\$2,228.18	11.68 %
Bond Insurance		0.00 %
Cost Breakdown Total:	\$19,071.40	

Cost for this Change Order supported by an No
alternate bid or competitive price quote

Explain Why

**Change Order Supplemental Information Form Signature
Page (Online Form Ref# 51726)**

Beth Bawer

Architect

8/8/19

Date

Construction Manager

Date

Finance Officer

Date

Local Board of Education Designee

Date

1962 Filiatreau Lane
Bardstown, Kentucky 40004

Phone: 502-348-2305
Fax: 502-348-2008
www.bcdinc.us



May 23, 2019

Ross Tarrant Architects
101 Old Lafayette Avenue
Lexington, KY 40502
Attn: Beth Bauer

RE: Mercer County District
Improvements – Proposal Request 06
Change Order Request 5 – Revised 7/23/19

Dear Beth:

In response to PR-06, BCD, Inc. proposes the following:

Material	\$7,234.50
Labor -	
Supervisor \$30.00 x 8 hours =	\$240.00
Laborer \$25.00 x 8 hours =	\$200.00
Proj. Manager \$70.00 x 1 hour =	<u>\$ 70.00</u>
Total	\$ 510.00
Overhead/Profit	<u>\$1,161.68</u>
Total	\$8,906.18

Please advise if BCD is to proceed.

Please note contract extension will be required once material is ordered. Lead time is 5 weeks.

Very truly yours,

BCD, Inc.

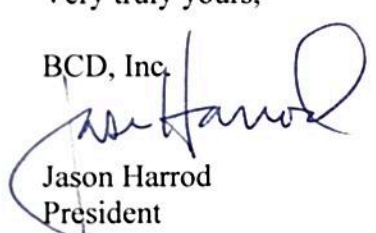

Jason Harrod
President

JH/bcl



Proposal Request Transmittal

RossTarrant Architects | 101 Old Lafayette Ave Lexington KY 40502 United States

PROJECT: Mercer County District Improvements 1832 DATE SENT: 7/2/2019

SUBJECT: PR-06 MCIS Hardware at Vestibule A PROPOSAL REQUEST ID: PR-06

TYPE: Proposal Request TRANSMITTAL ID: 00106

PURPOSE: For Contractor's Pricing VIA: Info Exchange

FROM

NAME	COMPANY	EMAIL	PHONE
Beth Bauer	RossTarrant Architects	bbauer@rosstarrant.com	859-254-4018

TO

NAME	COMPANY	EMAIL	PHONE
Jason Harrod	BCD, Inc.	jharrod@bardstown.com	

REMARKS: Please provide pricing for labor and materials for the following:
Refer to B/B1.3 for enlarged plan at Vestibule A in the Intermediate School.
See attached plan indicating doors VA.1 and VA.2. Provide new hardware as listed in attachment.

Attachments:
Mercer Vestibule A Door Hardware Changes V1.pdf

DESCRIPTION OF CONTENTS

QTY	DATED	TITLE	NUMBER	SCALE	SIZE	NOTES
1	7/2/2019	Mercer Vestibule A Door Hardware Changes V1.pdf				

COPIES:

Ron Murrell (RossTarrant Architects)

Mercer Vestibule VA Hardware Changes V1
July 2nd, 2019

For Doors VA1. And VA.2 provide the following:

1. Remove existing non-latching push bars. Turn over to owner for stock.
2. Furnish and install the following:

Hardware Set 01 – Door VA.1

(2)	NS Panic Device, Rim, 01	16-43-AD8510 x Less Pull	630	SAR
(1)	Key Removable Mullion	L980A x 507 x 651 x 980C1	628	SAR
(3)	Mortise Cylinder	RN Keyway	626	SAR
(1)	Cat H Adhesive Mullion Seal/Mute 5100N		Black	NGP

Hardware Set 02 – Door VA.2

(1)	NS Panic Device, Rim, 01	16-43-AD8510 x Less Pull	630	SAR
(1)	NS Panic Device, Rim, 03	16-43-AD8504 x Less Pull	630	SAR
(1)	Key Removable Mullion	L980A x 507 x 651 x 980C1	628	SAR
(1)	Rim Cylinder	RN Keyway	626	SAR
(3)	Mortise Cylinder	RN Keyway	626	SAR
(1)	Cat H Adhesive Mullion Seal/Mute 5100N		Black	NGP

Note: Prior to ordering materials, coordinate with Owner to provide key cylinders with proper keyway and number of pins, keyed as directed by Owner.

END OF DOCUMENT

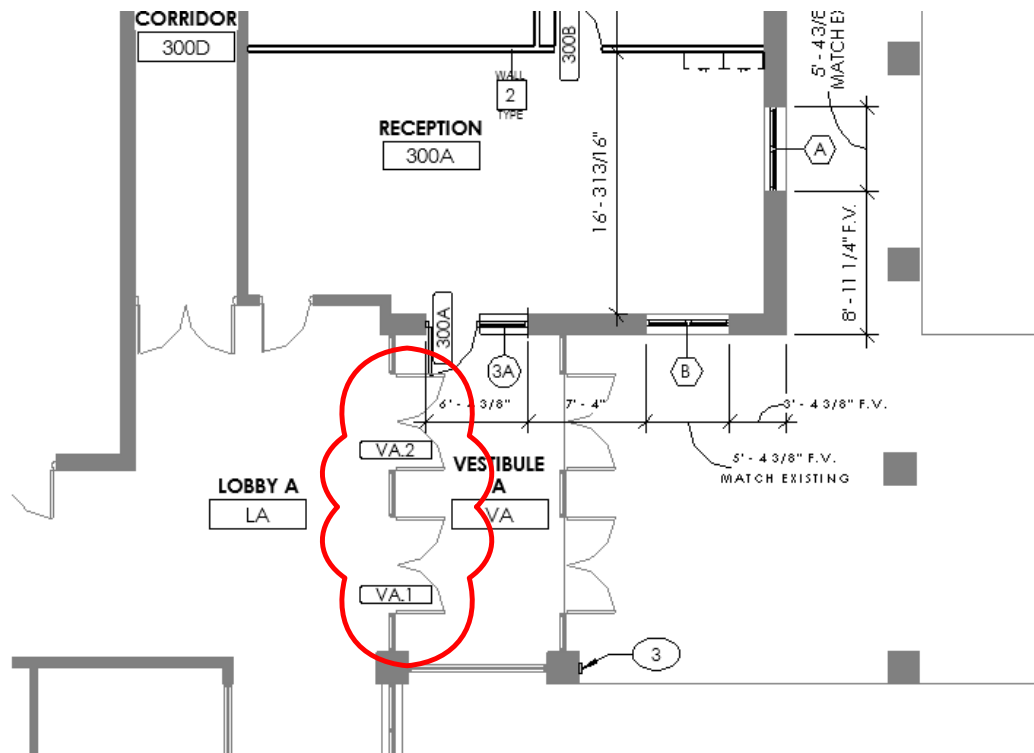

RECEPTION PLAN

1/8" = 1'-0"

B
B1.3

1962 Filiatreau Lane
Bardstown, Kentucky 40004



Phone: 502-348-2305
Fax: 502-348-2008
www.bcdinc.us

July 30, 2019

Ross Tarrant Architects
101 Old Lafayette Avenue
Lexington, KY 40502
Attn: Beth Bauer

RE: Mercer County District
Improvements – Proposal Request 07
Change Order Request 8

Dear Beth:

Provide and install handrail as shown in the attached drawing. Field verify all existing dimensions.
Provided with powder coat black finish

Material	\$4,800.00
Labor	<u>\$ 800.00</u>
Subtotal	\$5,600.00
Overhead/Profit	<u>\$ 840.00</u>
Total	\$6,440.00

Contract time to be determined w hen accepted.

Very truly yours,

BCD, Inc.

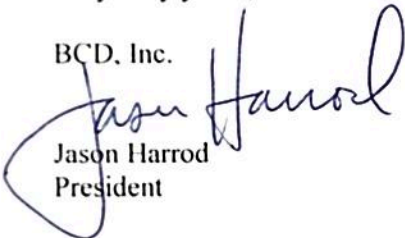
Jason Harrod
President

JH/bcl

J:\wpdata\mercerc\coreq8.doc



Proposal Request Transmittal

RossTarrant Architects | 101 Old Lafayette Ave Lexington KY 40502 United States

PROJECT: Mercer County District Improvements 1832 DATE SENT: 7/26/2019

SUBJECT: PR-07 KMS Handrail PROPOSAL REQUEST ID: PR-07

TYPE: Proposal Request TRANSMITTAL ID: 00121

PURPOSE: For Contractor's Pricing VIA: Info Exchange

FROM

NAME	COMPANY	EMAIL	PHONE
Beth Bauer	RossTarrant Architects	bbauer@rosstarrant.com	859-254-4018

TO

NAME	COMPANY	EMAIL	PHONE
Brenda Leake	BCD, Inc.	bleake@bardstown.com	
Jason Harrod	BCD, Inc.	jharrod@bardstown.com	

REMARKS: Please provide pricing for labor and materials for the following:

Provide and install handrail as shown in the attached drawing. Field verify all existing dimensions.

Attachment:
1832-SD1-PR07.pdf

DESCRIPTION OF CONTENTS

QTY	DATED	TITLE	NUMBER	SCALE	SIZE	NOTES
1	7/26/2019	1832-SD1-PR07.pdf				

COPIES:

Ron Murrell (RossTarrant Architects)
Michael Mays (RossTarrant Architects)

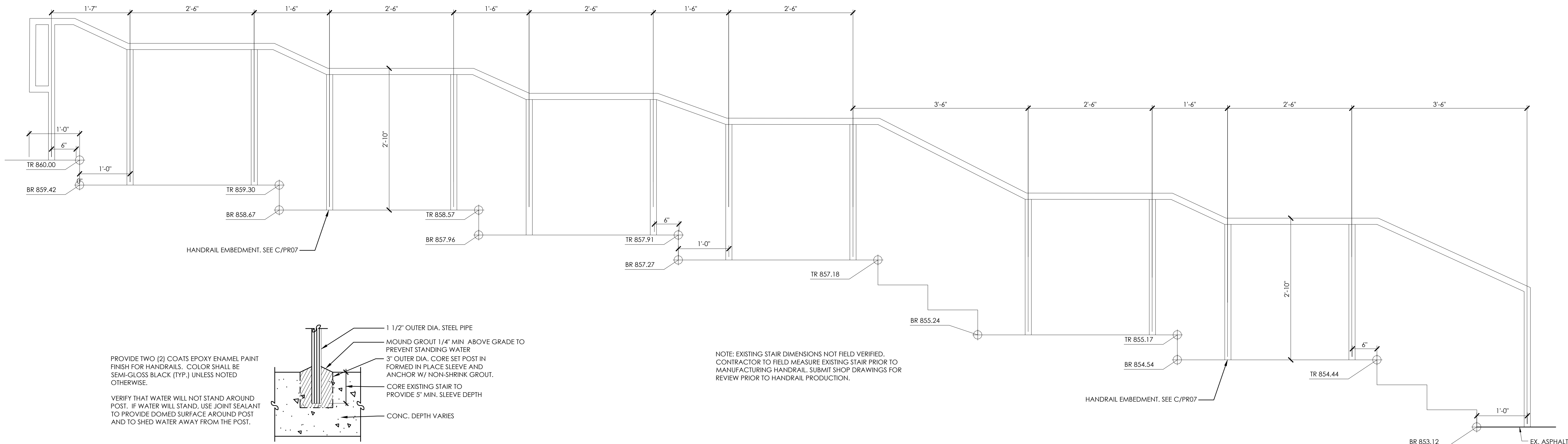

PROVIDE TWO (2) COATS EPOXY ENAMEL PAINT FINISH FOR HANDRAILS. COLOR SHALL BE SEMI-GLOSS BLACK (TYP.) UNLESS NOTED OTHERWISE.

VERIFY THAT WATER WILL NOT STAND AROUND POST. IF WATER WILL STAND, USE JOINT SEALANT TO PROVIDE DOMED SURFACE AROUND POST AND TO SHED WATER AWAY FROM THE POST.

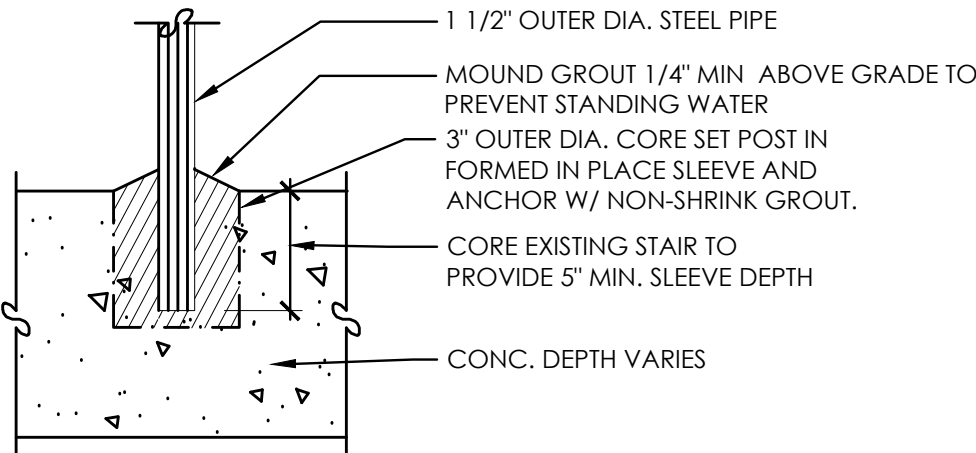

EMBEDDED HANDRAIL POST
SCALE: 1"=1'

C
PRO7

EMBEDDED HANDRAIL ON EXISTING STAIR
SCALE: 1"=1'

B
PRO7

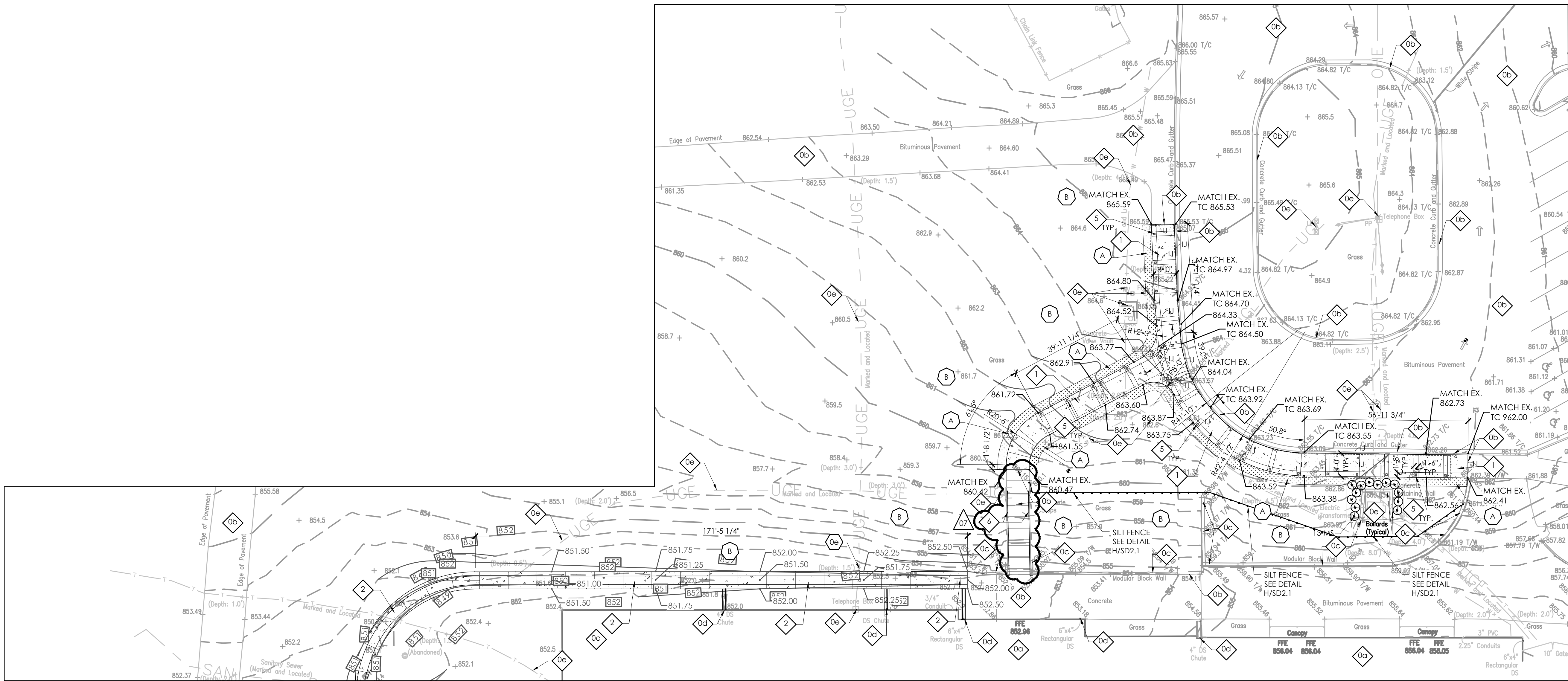

KING MIDDLE SCHOOL SITE DEVELOPMENT PLAN
SCALE: 1"=20'

A
PRO7

GENERAL SITE NOTES

1. THE SITE PLANS WERE PREPARED BASED UPON TOPOGRAPHIC SURVEYS BY ENDORS ENGINEERING, 771 ENTERPRISE DRIVE, LEXINGTON KENTUCKY. REFER TO SITE SURVEY SHEETS.
2. THE CONTRACTOR SHALL FIELD VERIFY ALL EXISTING SITE FEATURES AND CONDITIONS. REPORT ANY DISCREPANCIES TO THE ARCHITECT PRIOR TO THE START OF CONSTRUCTION.
3. THE ARCHITECT AND ARCHITECTS CONSULTANTS SHALL HAVE NO RESPONSIBILITY FOR THE DISCOVERY, PRESENCE, HANDLING, REMOVAL OR DISPOSAL OF, OR EXPOSURE OF PERSONS TO HAZARDOUS MATERIALS IN ANY FORM AT THE PROJECT SITE, INCLUDING BUT NOT LIMITED TO ASBESTOS, ASBESTOS PRODUCTS, POLYCHLORINATED BIPHENYL (PCB) OR OTHER TOXIC SUBSTANCES.
4. THE CONTRACTOR SHALL USE EXTREME CARE IN WORKING AROUND EXISTING OVERHEAD AND UNDERGROUND UTILITIES. MEASURES SHOULD BE TAKEN TO PROTECT ALL UTILITIES FROM DAMAGE DURING CONSTRUCTION.
5. SEE EROSION POLLUTION AND SEDIMENT CONTROL PLAN FOR RECOMMENDED BEST MANAGEMENT PRACTICES INFORMATION AND SEDIMENT CONTROLS.

SITE DEVELOPMENT TAGS

- [D] EXISTING TO REMAIN. PROTECT THROUGHOUT CONSTRUCTION.
 - [a] DENOTES BUILDING TO REMAIN. NO UTILITIES TO THESE FACILITIES ARE TO BE REMOVED UNLESS NEW PERMANENT UTILITY IS PROVIDED PRIOR TO DEMOLITION.
 - [b] DENOTES PAVEMENT, CURBS AND GUTTER TO REMAIN - PATCH/REPAIR WHERE DAMAGED BY CONSTRUCTION. SAW-CUT TO PROVIDE CLEAN EDGE. CONCRETE PAVING TO BE SAW-CUT BACK TO NEAREST UNDAUNAGED CONTROL OR ISOLATION JOINT. MATCH NEW ADJACENT PAVEMENT TO EXISTING PAVEMENT ELEVATIONS.
 - [c] DENOTES SEGMENTAL WALL TO REMAIN.
 - [d] DENOTES STORM STRUCTURE/UTILITY TO REMAIN.
 - [e] DENOTES UTILITY TO REMAIN.
- 4" DEPTH CONCRETE PAVEMENT- SEE DETAIL A/SD2.1 (321313, 321373)
- CONCRETE DRAINAGE FLUME (321313, 321373)-SEE DETAIL B/SD2.1
- CONCRETE CHANNEL DRAIN (321313, 321373)-SEE DETAIL C/SD2.1
- CONCRETE DRAINAGE FLUME TRANSITION (321313, 321373)-SEE DETAIL F/SD2.1
- CANOPY COLUMN. SEE DETAIL G/SD2.1 AND REFER TO ARCHITECTURAL & STRUCTURAL DRAWINGS FOR ADDITIONAL INFORMATION

EMBEDDED HANDRAILS. CORE DRILL AND EPOXY SET. SEE B&C/PRO7

SITE GRADING NOTES

1. THE CONTRACTOR SHALL VERIFY LOCATIONS AND ACTUAL DEPTHS OF ALL EXISTING STORM DRAINS, GAS MAINS, WATER MAINS, AND PIPES TO ALL NEW CONNECTIONS AND CROSSINGS. CONTRACTOR SHALL PAY PARTICULAR ATTENTION TO AREAS WHERE CONSTRUCTION OR GRADING MAY INTERFERE WITH SUCH LINES.
2. ANY DISCREPANCIES BETWEEN THIS GRADING PLAN AND ACTUAL FIELD CONDITIONS SHALL BE BROUGHT TO THE ATTENTION OF THE ARCHITECT IN WRITING PRIOR TO EXCAVATION, GRADING, TRENCHING, OR OTHER CONSTRUCTION OF ANY SORT. FAILURE TO NOTIFY THE ARCHITECT IN WRITING PRIOR TO COMMENCEMENT OF EXCAVATION, GRADING, TRENCHING, OR OTHER CONSTRUCTION SHALL IMPLY THE CONTRACTOR'S VERIFICATION OF AND ACCEPTANCE OF EXISTING SITE CONDITIONS. SAID FAILURE TO NOTIFY THE ARCHITECT IN WRITING SHALL IDENTIFY AND HOLD HARMLESS THE OWNER FROM ANY ADDITIONAL COSTS INCURRED BY THE CONTRACTOR DUE TO DISCREPANCIES NOT REPORTED WHICH COULD HAVE BEEN DETECTED BY PRUDENT AND REASONABLE OBSERVATION AND VERIFICATION BY THE CONTRACTOR.
3. ALL IMPERVIOUS SURFACES SHALL BE GRADED AND INSTALLED WITH A MINIMUM SLOPE OF ONE PERCENT (1%) AND A MAXIMUM SLOPE OF SEVEN PERCENT (7%).
4. ALL PERVIOUS SURFACES SHALL BE GRADED AND INSTALLED WITH A MINIMUM SLOPE OF TWO PERCENT (2%) AND A MAXIMUM SLOPE OF THIRTY-THREE PERCENT (33%) EXCEPT WHERE SHOWN.
5. SLOPE PERVIOUS SURFACES MIN. 5% AND IMPERVIOUS SURFACES MIN. 1% AWAY FROM BUILDING FOUNDATIONS.
6. MAINTAIN GRADING TO PROMOTE POSITIVE DRAINAGE AT ALL TIMES. DO NOT ALLOW WATER TO POND IN CONSTRUCTION AREAS.
7. RELOCATE ALL BURIED UTILITIES THAT ARE IMPACTED BY ANY EARTHWORK. RELOCATED UTILITY LOCATIONS ARE TO BE APPROVED BY THE ARCHITECT PRIOR TO STARTING WORK.
8. PROTECT AREAS TO BE SEEDED AS FOLLOWS:
 - A) DITCHES AND DRAINAGE SWALES ARE TO RECEIVE HIGH-VELOCITY EROSION-CONTROL BLANKETS.
 - B) SLOPES 4:1 (H:V) OR GREATER ARE TO RECEIVE LONG-TERM EROSION-CONTROL BLANKETS.
 - C) SLOPES BETWEEN 4:1 AND 6:1 (H:V) ARE TO RECEIVE SHORT-TERM EROSION CONTROL BLANKETS.
 - D) SLOPES BELOW 4:1 (H:V) ARE TO RECEIVE STRAW MULCH PER THE SPECIFICATIONS. DO NOT USE HAY.
9. ANY AREAS DISTURBED DURING CONSTRUCTION ARE TO BE RECONDITIONED, SEEDED AND MULCHED PER THE SPECIFICATIONS.
10. COMPACT SOIL TO NOT LESS THAN THE FOLLOWING PERCENTAGES OF THEIR STANDARD PROCTOR MAXIMUM DRY DENSITY AT PLUS OR MINUS TWO (2) PERCENT OF OPTIMUM MOISTURE CONTENT:
 - A) UNDER FLOOR SLABS AND FOUNDATIONS ON STRUCTURAL FILL - 97%
 - B) FILLS ON EXISTING SOILS, ROCK CUTS OR SHOT-ROCK FILL - 97%
 - C) PAVED AREAS AND WALKS - 95%
 - D) LANDSCAPE AREAS OUTSIDE MASS FILL AREAS - 85%
11. ALL TREES THAT ARE IDENTIFIED BY THE ARCHITECT TO REMAIN, EITHER ON THE DRAWING OR IN THE FIELD, ARE TO BE PROTECTED IN ACCORDANCE WITH THE SPECIFICATIONS. ALL TREES LOCATED OUTSIDE OF AREAS IDENTIFIED TO BE RE-GRADED ARE TO BE PROTECTED IN ACCORDANCE WITH THE SPECIFICATIONS.
12. THE CONTRACTOR SHALL ENSURE THAT CONSTRUCTION DEBRIS AND SEDIMENT ARE REMOVED DAILY FROM SITE DRIVEWAYS, PARKING AREAS, WALKWAYS AND SURROUNDING ROADWAYS AND WALKWAYS.
13. EXCESS SATISFACTORY SOILS ARE TO BE DISPOSED OF OFF SITE.
14. THE NEW PARKING, ROADS AND ROAD BASE ARE NOT DESIGNED TO ACCOMMODATE CONSTRUCTION TRAFFIC AND SHOULD NOT BE USED FOR SUCH UNLESS STABILIZED USING #2 CRUSHED STONE AND/OR GEO-GRID IN ADDITION TO THE PAVEMENT DESIGN SECTION SHOWN. IF THE CONTRACTOR WISHES TO USE THE NEW ROAD ALIGNMENTS DURING CONSTRUCTION, IT IS THE CONTRACTORS RESPONSIBILITY TO STABILIZE THE ROAD ALIGNMENT SUBGRADES AND PREVENT THEM FROM BEING DAMAGED DURING CONSTRUCTION.

SPOT ELEVATION LEGEND

- TC - TOP OF CURB
BC - BOTTOM OF CURB

LANDSCAPE TAGS

- A PROVIDE 3'-0" SOD STRIP AT PERIMETER OF ALL NEW PAVEMENT AND BUILDING EDGES. (329223) SEED ALL OTHER AREAS DISTURBED BY CONSTRUCTION (329219). INSTALL EROSION CONTROL BLANKETS AND MATS ON SLOPES PER THE SPECIFICATIONS (312200)
- B SEED AND MULCH PER SPECIFICATIONS. PROVIDE EROSION CONTROL MULCH PER SPECIFICATIONS.

LEGEND

- CONCRETE PAVEMENT
- SODDED AREA

PROPOSAL REQUEST #07

MERCER COUNTY DISTRICT IMPROVEMENTS

FOR:

MERCER COUNTY BOARD OF EDUCATION

HARRODSBURG, KENTUCKY

Project No: 1832
Drawn By: MBM
Rev'd By: LMR/DPS

SHEET RELEASE

1	
2	
3	
4	
5	
6	
7	
8	

COPYRIGHT © 2018

PR07

PROPOSAL REQUEST #07

DATE ISSUED:
JULY 26TH, 2019

rostarant
architects

101 old doyle avenue lexington, kentucky 40502 p.859.254.4018 f.859.231.5046

1962 Filiatreau Lane
Bardstown, Kentucky 40004



Phone: 502-348-2305
Fax: 502-348-2008
www.bcdinc.us

July 29, 2019

Ross Tarrant Architects
101 Old Lafayette Avenue
Lexington, KY 40502
Attn: Beth Bauer

RE: Mercer County District
Improvements – Proposal Request 09
Change Order Request 7

Dear Beth:

In response to PR-09 for King Middle School wall repairs, BCD, Inc. proposes to provide material and labor to demo and reinstall existing block at segmented wall as follows:

Supervisor 16 hrs @ \$30.00/hr	\$ 480.00
Field Employee 32 hrs @ \$25.00/hr	\$ 800.00
Stone	<u>\$ 230.00</u>
Subtotal	\$1,510.00
Overhead/Profit	<u>\$ 226.50</u>
Total	\$1,736.50

Contract time to be extended 4 days.

Very truly yours,

BCD, Inc.

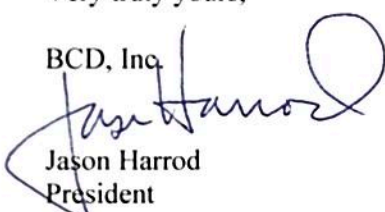

Jason Harrod
President

JH/bcl

J:\wpdata\mercerc\coreq7.doc



Proposal Request Transmittal

RossTarrant Architects | 101 Old Lafayette Ave Lexington KY 40502 United States

PROJECT: Mercer County District Improvements 1832 DATE SENT: 7/26/2019

SUBJECT: PR-09 KMS existing site wall repair PROPOSAL REQUEST ID: PR-09

TYPE: Proposal Request TRANSMITTAL ID: 00123

PURPOSE: For Contractor's Pricing VIA: Info Exchange

FROM

NAME	COMPANY	EMAIL	PHONE
Beth Bauer	RossTarrant Architects	bbauer@rosstarrant.com	859-254-4018

TO

NAME	COMPANY	EMAIL	PHONE
Brenda Leake	BCD, Inc.	bleake@bardstown.com	
Jason Harrod	BCD, Inc.	jharrod@bardstown.com	

REMARKS: Please provide pricing for labor and materials for the following:

At King Middle School, remove and reinstall portion of existing segmental block wall that was disturbed from the existing sidewalk demo.

Attachment:
none

COPIES:

Ron Murrell (RossTarrant Architects)
Michael Mays (RossTarrant Architects)

1962 Filiatreau Lane
Bardstown, Kentucky 40004



Phone: 502-348-2305
Fax: 502-348-2008
www.bcdinc.us

August 8, 2019

Ross Tarrant Architects
101 Old Lafayette Avenue
Lexington, KY 40502
Attn: Beth Bauer

RE: Mercer County District
Improvements - Change Order Request 9

Dear Beth:

The cost for conduit repairs made to lines that were unmarked. Per discussion with owner is an add of \$727.72. This item is not marked up, invoice is attached.

Remove and replace sidewalk/entrance at Intermediate School per unit prices as follows:

Demo Existing - \$25.00 x 13 =	\$ 325.00
4" reinforced concrete sidewalk - \$72.00 x 13 =	\$ 936.00
Total add	\$1,261.00

Very truly yours,

BCD, Inc.

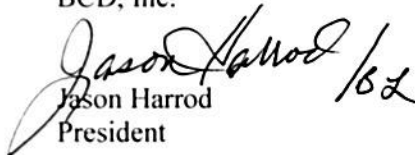
A handwritten signature in black ink, appearing to read "Jason Harrod", followed by the handwritten initials "JH".
Jason Harrod
President

JH/bcl

J:\wpdata\mercerc\coreq9.doc

REC'D JUL 30 2019

COPY



Remittance Address:
1193 Atkinson Hill Avenue
Bardstown, KY 40004

INVOICE

DATE	INVOICE #
7/29/2019	8839

BILL TO

BCD, Inc.
ATTN: Trish
1962 Filiatreau Lane
Bardstown KY 40004

TERMS	DUE DATE
Net 15	8/13/2019

Item	Quantity	Description	Rate	Amount
Labor	4	Mercer County Schools Friday July 12 2 Men with Excavator Repair Light Pole Conduit and Pull Wire Between Light Poles	110.00	440.00
Materials		Electrical Materials Furnished	287.72	287.72
<p>OK-PO_____ Field PO_____</p> <p>Adj. to PO_____ Unit Price PO_____</p> <p>I do not understand this invoice_____</p> <p>AP discuss with PM_____</p> <p>PM approval_____</p> <p style="text-align: right;">No PO?</p>				

PLEASE INCLUDE YOUR INVOICE # WITH PAYMENT

THANK YOU FOR YOUR BUSINESS!

TOTAL \$727.72**Payments/Credits** \$0.00**BALANCE DUE** \$727.72

126673