



CONVEYANCE OF RIGHT OF WAY

The Undersigned, **JEFFERSON COUNTY SCHOOL DISTRICT FINANCE CORPORATION**, a political subdivision of the Commonwealth of Kentucky, for valuable consideration, receipt of which is hereby acknowledged (said consideration for this instrument is not measurable in money), do hereby grant and convey unto **LOUISVILLE GAS AND ELECTRIC COMPANY**, a Kentucky corporation, 820 W. Broadway, PO Box 32020, Louisville, KY 40232, its successors and assigns (Company), the right and easement to construct, reconstruct, operate, and maintain an electric line or lines, communications systems, and all equipment and facilities related thereto, including, but not limited to, transformers, poles, conduit, cable and wires, over and/or under our property located at **Luhr Elementary, 6200 Fegenbush Lane, Parcel ID 00636-0048-0000**, in Jefferson County, Kentucky.

This easement is a ten foot (10') wide easement for service, overhead spans, and equipment, as constructed and shown as the cross-hatched area on attached Drawing WR No. 6193053, to determine the centerline of the easement.

Title to the property was acquired by the undersigned by deed dated the **25th day of September 2008**, and recorded in **Deed Book 09292, Page 0656**, in the Clerk's Office of Jefferson County, Kentucky. There shall be no buildings or structures erected within the limits of this easement. Company is further granted the right of ingress and egress over the lands of the undersigned to and from said line in the exercise of this easement and is further granted the right to do all trimming and removal of trees, shrubs, and branches for the proper clearance of said lines or equipment.

Furthermore, in consideration of Company bringing its service to the property of the undersigned, the undersigned granted to Company such right of way across their property as may be necessary to enable Company to make further extensions of its lines.

Company has the right to assign its rights hereunder.

It is further agreed that Company, at its option, will either repair, restore, or pay to the undersigned for damages that may be caused by them in the exercise of this easement.

[SIGNATURES ON FOLLOWING PAGES]

Agent: Sheri Gardner
Job: WR6193053

EASEMENTS NEC.

- ① EASEMENT FOR POLE REPLACEMENT AND OVERHEAD SECONDARY

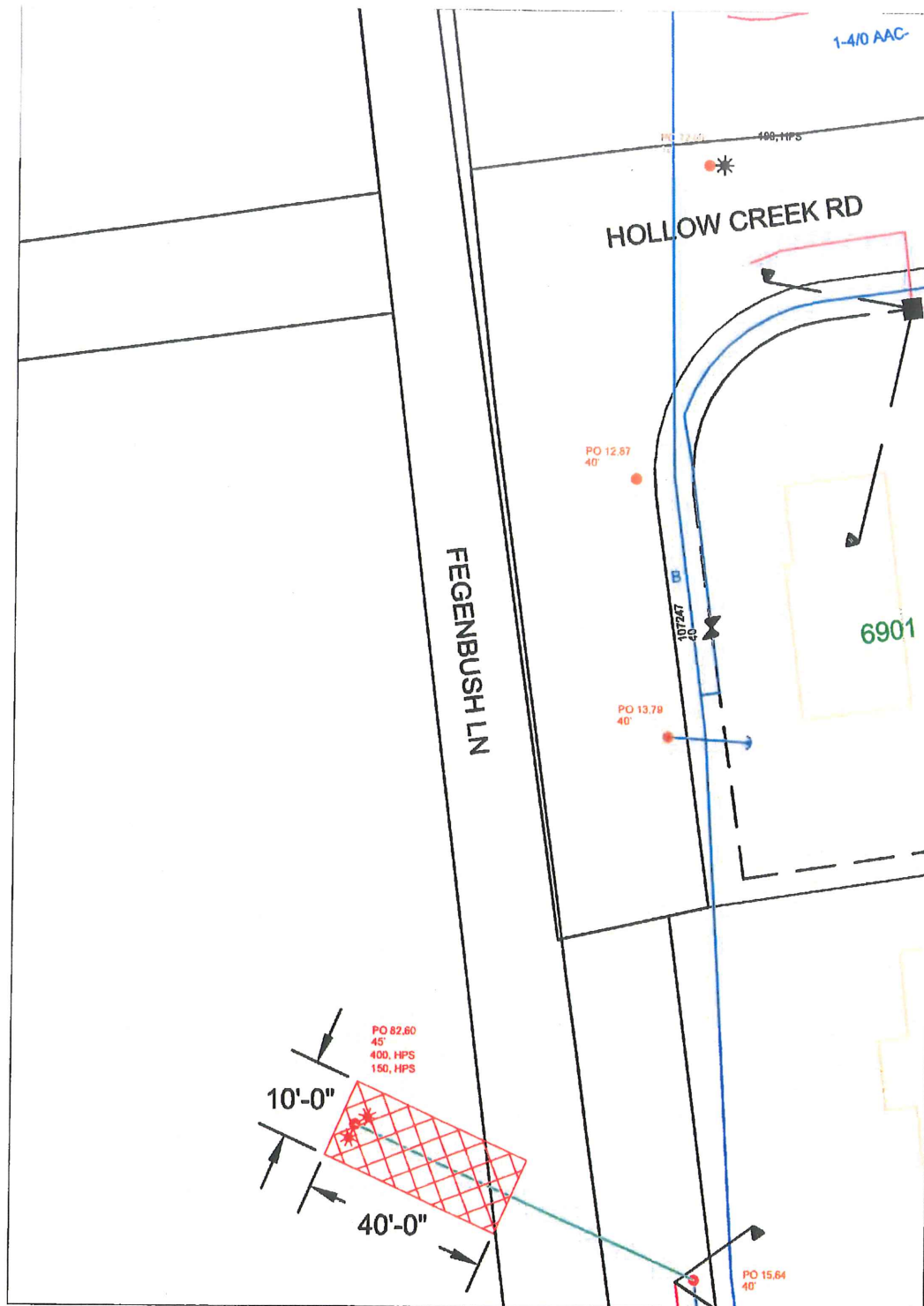

PROPOSED LG&E GAS, ELEC., & TELECOMM. EASEMENT

WR#: 6193053

PROJECT#: 155860
TASK#: 6193053101

10' SECONDARY EASEMENT
NEED TO SERVE ANTENNA POLE
AT 6900 FEGENBUSH LN

EASEMENT DRAWING

DRAWN BY:
BLANDFORD, BLAIR

DATE: 8/24/2018

PHONE #: XXX.XXX.XXXX

SCALE: NTS

SHEET 1 OF 1

LG&E KU.

LOUISVILLE GAS and ELECTRIC COMPANY
a PPL company
POWER DELIVERY ENGINEERING