

THIS IS A DECISION PAPER

TO: HARDIN COUNTY BOARD OF EDUCATION MEMBERS

FROM: NANNETTE JOHNSTON, SUPERINTENDENT

DATE: DECEMBER 18, 2008

SUBJECT: APPROVAL OF A CHANGE ORDER UNDER \$10,000.

FACTS:

The Board has requested that all change orders under \$10,000 be listed on the consent agenda for their approval. This procedure change will take less time at Board meetings but also allows the Board the option to pull items they may wish to discuss for further clarification.

The following change order items are presented to the board for consideration:

	Site	Item	Reason for Change	Amount of Change
1.1	ANNEX	Add second gas meter and reroute gas line piping.	To accommodate the emergency generator the gas lines required resizing. The gas piping was sized to accommodate HVAC needs but not the emergency generator. Additional it was determined that a second gas meter would better serve the building needs.	\$6,181.38
1.2	ANNEX	Landscape allowance adjustment.	An allowance of \$3,000 was included for landscaping on this project. The actual cost of landscaping used was \$778.17 thereby creating a credit of \$2,221.83 to the contract.	(\$2,221.83)
1.3	ANNEX	Revised exterior overhead door for TV from 10'-0" to 11'-3" height.	A new TV van was purchased that was taller than previous TV van. The door opening as a result required enlargement. This change provides for a sectional door in lieu of a coiling door being provided under contract. The door under contract will be turned over to the Buildings and Grounds Department for potential use on another project.	\$4,604.17

TOTAL CHANGES \$10,563

RECOMMENDATION

Approve change orders recommended by Associate Superintendent of Finance.

RECOMMENDED MOTION

I recommend that the Hardin County Board of Education approve change orders New Central Office Annex (1.1, 1.2, 1.3).

B & W BUILDING

1.1

DESCRIPTION	QUANT.	UNIT	UNIT PRICE	MATERIAL TOTAL	UNIT PRICE	LABOR TOTAL
CONCRETE FOR TRENCH	3.00	CY	75.34	226.02	45.00	135.00
PLANT	3.00	CY	3.00	9.00	3.00	9.00
SAWCUT	120.00	LF	0.25	30.00	1.75	210.00
EXCAVATE	25.00	cy	16.00	400.00	2.00	50.00
MESH	132.00	sf	0.19	25.08	0.10	13.20
FINISH	132.00	SF	0.75	99.00	0.15	19.80
CURE	132.00	SF	0.04	5.28	0.15	19.80
R/R FENCE	20.00	LF	0.00	0.00	4.00	80.00
SUB TOTAL				794.38		536.80
TAX				47.66		
PTI				187.88		
TOTAL				1029.92		536.80 1566.72
SUBCONTRACTOR						
DELETE GAS LINE FROM EXISTING METER						-12676.00
ADD GASLINE AS DISCUSSED WITH GAS COMPANY						15879.00
GAS TAP FEE						400.00
METER DEPOSIT						100.00
SUBTOTAL						5269.72
MARKUP						780.46
SUBTOTAL						6050.18
BOND						121.20
GRAND TOTAL						6181.38

FACSIMILE COVER SHEET

BCD, INC.

1200 ATKINSON HILL AVENUE
BARDSTOWN, KY 40004

PHONE: 502-348-2305

FAX: 502-348-2008

SEND TO Company Name	From MICHAEL SALSMAN
Attention: W THOMAS	Date 11/18/08
Fax Number 270-885-7978	Project: B & W METALS BUILDING

TOTAL PAGES INCLUDING COVER SHEET: 2

COMMENTS:

ATTACHED IS A SKETCH SHOWING THAT A 1" UNDERGROUND GAS LINE COMES FROM THE STREET TO A METER. OUT OF THE METER, WE WILL EXTEND A STEEL LINE, A 3" GAS LINE TO THE GENERATOR & A 2" GAS LINE TO THE HVAC UNIT WHICH WILL BE REDUCED AS APPROPRIATE AS WE PASS EACH UNIT. ONCE WE GET PASS THE THREE UNITS THAT ARE ON THE GENERATOR SIDE OF THE BUILDING, WE WILL GO INSIDE THE BUILDING AND RUN TO THE BACK OF THE BUILDING TO ACCOMMODATE THE HVAC UNIT IN THE BACK OF THE BUILDING AND THE UNIT HEATER IN THE BACK OF THE BUILDING. IF YOU HAVE ANY QUESTION REGARDING THIS, PLEASE CALL.

PLEASE NOTE THAT THE GAS COMPANY HAS INDICATED THAT THERE IS PROBABLY GOING TO HAVE TO BE SOME KIND OF GUARDS FOR THESE GAS LINES RUNNING TO THE GENERATOR AND HVAC UNIT, BUT I DON'T KNOW WHAT THEY ARE GOING TO EXPECT UNTIL WE GET IT INSTALLED.

CC: RUSTY TAYLOR, PECK FLANNERY GREAM

If transmission is unclear, or not as noted, please contact us at 502-348-2305 Thank you.

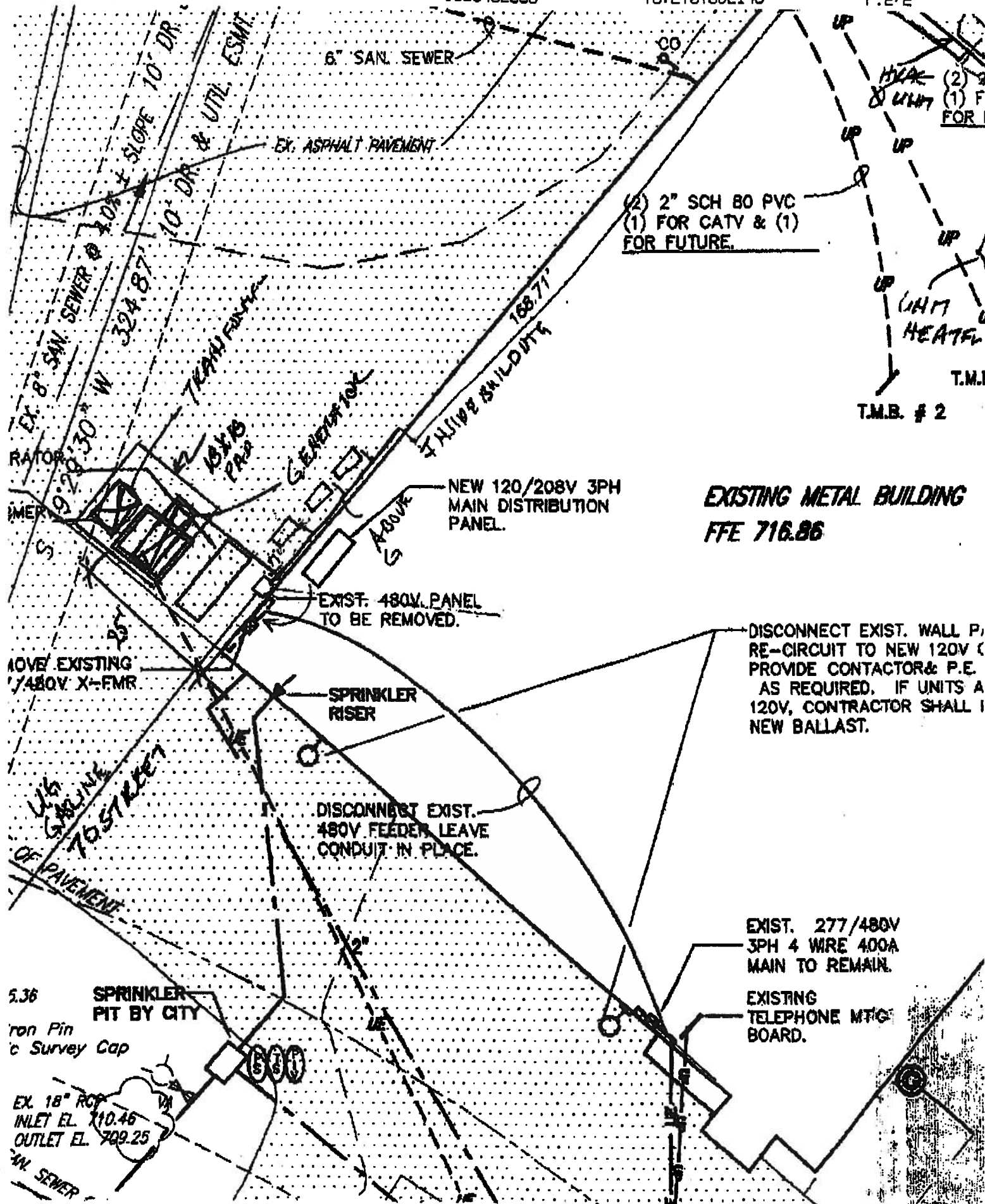

1200 Atkinson Hill Avenue
Bardstown, Kentucky 40004

Phone: 502-348-2305
Fax: 502-348-2008

1.2
BCD
Inc.

November 19, 2008

Peck Flannery Cream Warren, Inc.
112 North Main Street
Elizabethtown, KY 42701
Attn: Rusty Taylor

RE: B & W Metals Building

Dear Rusty:

The cost to furnish and install the trees as shown on your request is \$778.17.

This would result in a credit to the owner of \$2,221.83.

Please advise if we should proceed.

Very truly yours,

BCD, Inc.

J. Michael Salsman, P.E.
Vice President

JMS/bcl

J:\wpdata\b&wmetals\coreq\1



**PECK FLANNERY GREAM WARREN
ARCHITECTS, LLC**

(Larry Gream, Architect)

November 13, 2008

Mr. Michael Salsman
BCD, Inc.
1200 Atkinson Hill Ave.
Bardstown, KY 40004

RE: Renovation of B & W Metals Building for
Hardin County Board of Education
209 Corporate Drive
Elizabethtown, Kentucky 42701
PFGW # 0804

Dear Michael,

Attached is one (1) copy of MOD. 6 Drawing that defines the requirements for landscaping for the B&W Metals project.

Please note that the landscape requirements are very simple whereas only three (3) trees with newly sodded surrounds are all that will be required for this project.

Please forward a proposal for providing this landscaping as detailed. Please note that a \$3000.00 allowance for landscape materials was required by the original contract documents.

If you have any questions or require any additional information, please contact me at your convenience.

Sincerely,

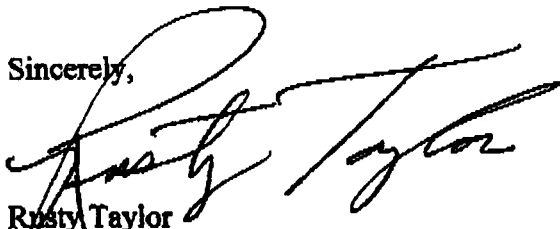

Rusty Taylor

Larry Gream

From: Rusty Taylor [taylor@pfgwarchitects.com]
Sent: Monday, December 08, 2008 8:13 AM
To: Larry Gream
Subject: Fw: B&W Metals Overhead Door

1.3

Larry,

Corrected change-order pricing from BCD on overhead door changes per your request.

Rusty

----- Original Message -----

From: Michael Salsman
To: Rusty Taylor
Sent: Monday, December 08, 2008 8:44 AM
Subject: Fw: B&W Metals Overhead Door

Revised below

Relocate angle brace	Labor	NIC	2 mn hrs
Patch drywall	Labor	NIC	3 mn hrs
Move header	Labor	462.00	8 mn hrs
Welder		NIC	
Trim	Mat.	75.00	
Trim	Labor	161.12	4 mn hrs
scaffold		75.00	
Sprinkler labor		0.00	
Sprinkler material		0.00	
Overhead Door Material			
Sectional overhad door		2870.00	

		3643.12
Markup		546.46
		4189.59
Bond		83.79
Grand total		4273.38

Add insulation. add 330.79 Total add \$4604.17

J. Michael Salsman, P.E.
 BCD,
 1200 Atkinson Hill Avenue
 Bardstown, Ky 40004
 Phone: 502-348-2305
 Fax: 502-348-2008

----- Original Message -----

From: Rusty Taylor
To: Michael Salsman