

Proposed Alterations (10,000 s.f.):

- Remove Mobile, associated ramps & stairs; restore grounds.
\$8,000
- Misc. Demo
\$25,000
- Remove & replace interior wood doors, frames, & hardware; new openings for Media Center spaces: (29) total openings
\$105,000
- Remove & replace existing flooring & base w/ carpet or VCT. Possible refinishing of wood flooring
\$80,000
- Fur out walls w/ metal studs & drywall, classroom partition infill; ceiling bulkheads, etc.
\$92,500
- Painting of walls, new frames, tin ceilings
\$35,000
- Replace acoustic ceilings
\$17,000
- New casework where indicated
\$170,000
- New lockers, fire extinguishers, visual display boards
\$65,000
- Complete renovation of (3) restrooms:
New flooring, fixtures, plumbing as required, new piping, etc. Paint is already included above. ADA features will be installed where possible, but most are too small to meet all ADA requirements. New (2) sinks in corridor. Also includes plumbing for new Science Classroom & demo table
\$122,500
- New electric (includes new (3) phase for VRF), outlets, LED lights, CT, fire alarm, etc.
\$275,000
- New HVAC
\$210,000
- Sprinkler
\$250,000
- Total = \$1,455,000
+ 30% [Includes 15% Contractor mark up + 15% soft costs (contingencies, permits, fees, etc.)]
= \$1,891,500

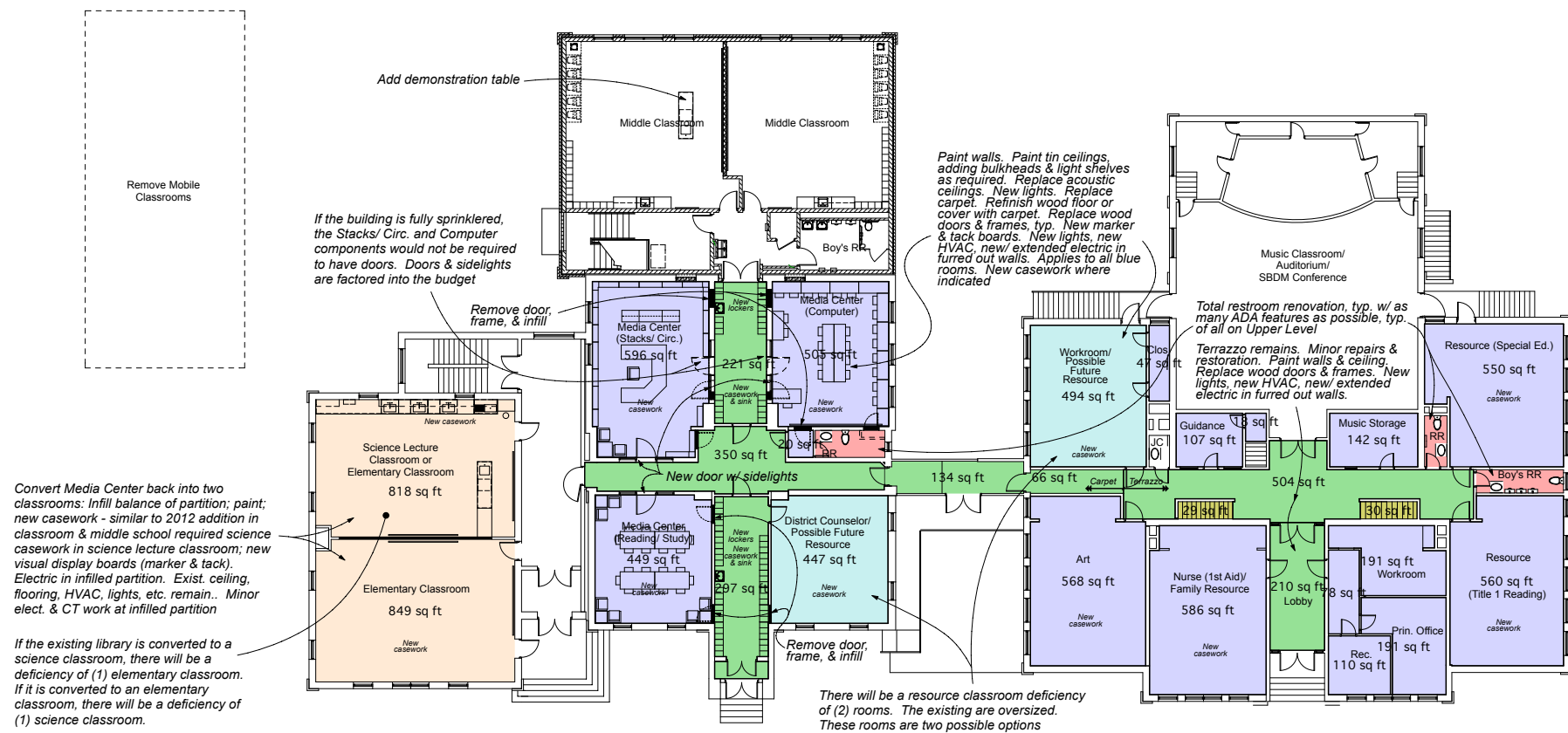

Upper Level Plan
Not to Scale

One classroom deficient under this scenario

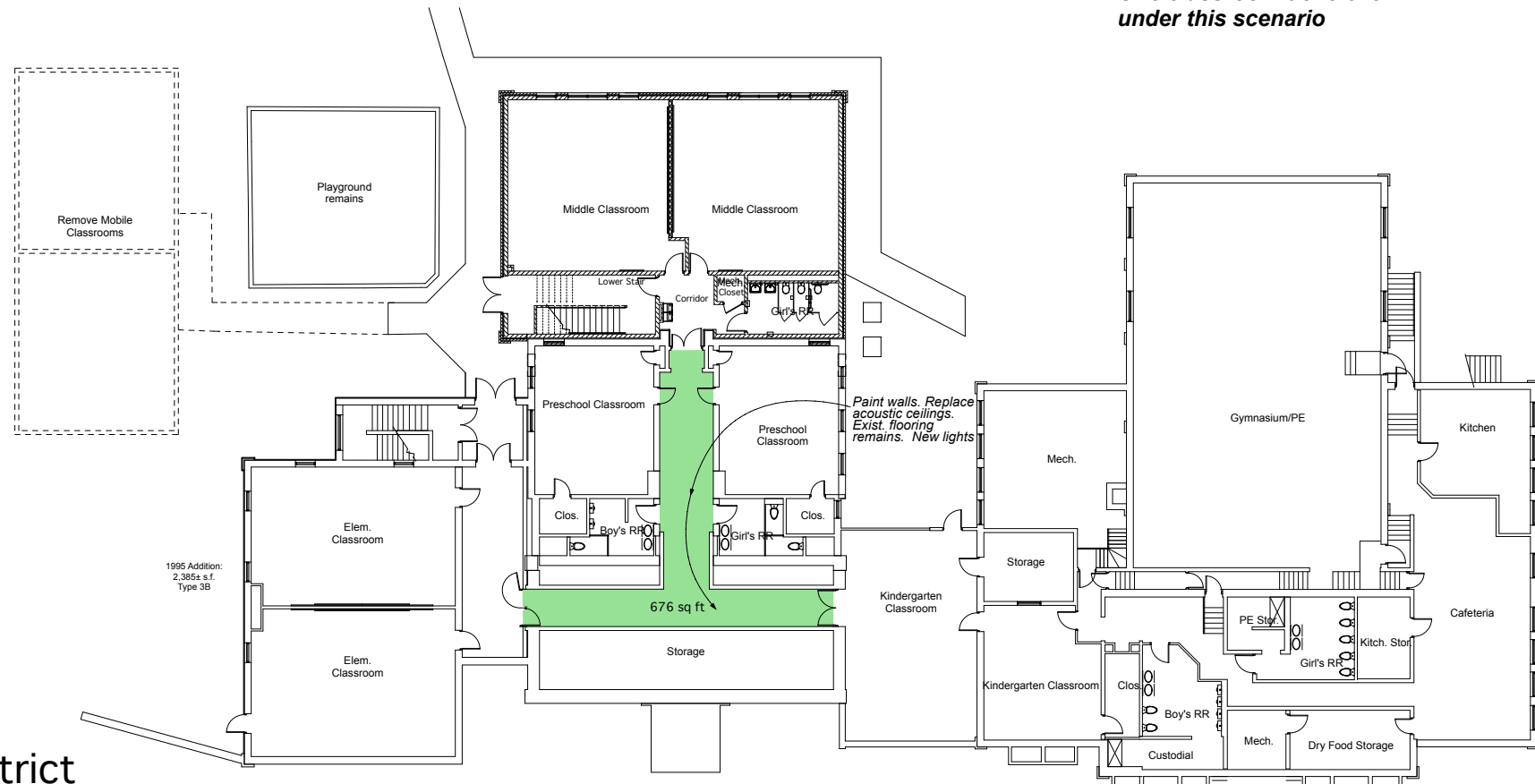

Lower Level Plan
Not to Scale