



McNutt Construction Company
P.O. Box 431 Elizabethtown, Kentucky. 42702
mcnutt@kvnet.org

(270) 737-8518
FAX (270) 737-0307
www.mcnutt-construction.com

July 16, 2007

Peck, Flannery, Gream & Warren Architects
112 North Main Street
Elizabethtown, KY 42701

ATTN: Larry Gream

RE: North Hardin High School
2007 Renovations
Radcliff, Kentucky

Dear Larry,

Per your request for Proposal dated June 8, 2007, we propose to furnish all the necessary material, labor and equipment to add a structural beam per your mod drawing 1.1, 1.2 & 1.3 for the sum of \$4,843.00.

Cost Breakdown

Dallas Welding	\$2,900.00
Commonwealth Masonry	867.00
G.M. Glass & Mirror	(324.00)
Material	106.00
Labor	608.00
Bond 1.3%	54.00
Overhead & Profit 15%	<u>632.00</u>
TOTAL	\$4,843.00

If you have any questions or need any further information please contact us at our office.

Sincerely,

Mark McNutt, President

MM:bs

DALLAS WELDING INC.

1757 West Main St.
P.O. Box 1779
Glasgow, KY 42142-1779

Telephone: (270) 678-3349
Facsimile: (270) 678-3351

FACSIMILE TRANSMITTAL SHEET

Total number of pages including this cover letter: 1

RECEIVED JUN 20 2007

Date: 6-19-07

Subject: North Hardin High School Renovation

To: Mark McNutt

From: Josh Poynter

Comments: We propose to fabricate and deliver 1 – W16x36 beam lintel with a continuous bottom plate PL3/8"x6" along with 2 – bearing plates PL3/8"x8"x8" per MOD. 1.1 & MOD. 1.2 for a total of \$1,400. Installation of the beam lintel will cost an additional \$1,500. Please advise any further action. Thank you.

Commonwealth Masonry, Inc.
Garry R. Grubbs
302 Presidential Boulevard
Hodgenville, KY 42748

TO: *M. Nutt Construction*

DATE	<i>7-9-07</i>
JOB	<i>North Hardin High School</i>
CONTRACT JOB NO.	<i>#0701 807 2007 RENOVATIONS</i>
PREPARED BY	<i>Garry Grubbs</i>
WORK TO BEGIN BY	
WORK TO BE COMPLETED BY	<i>RECEIVED JUL 9 2007</i>

PFGW MOD # 1.1, 1.2 & 1.3 DATED 6-8-07

Additional 3 course G.F. Block over New W16X36 Struct. STL.

The work covered by this order shall be performed under the same terms and conditions as that included in the Original Contract.

CHANGES APPROVED

PREVIOUS CONTRACT AMOUNT	\$ <i>223,700.⁰⁰</i>
AMOUNT OF THIS ORDER	\$ <i>867.⁴³</i>
TOTAL CONTRACT AND EXTRAS	\$ <i>224,567.⁴³</i>

NC3814

By: *Garry Grubbs*

Contract Change Order



**PECK FLANNERY GREAM WARREN
ARCHITECTS, LLC**

Larry Gream, Architect

June 8, 2007

McNitt Construction Company
P.O. Box 431
Elizabethtown, Kentucky 42702

RE: North Hardin High School
Architect Project No. 0701
PFGW MOD. #1.1, 1.2 and 1.3 dated 6-8-07

Dear Mark:

Don Taylor pointed out on site that the existing cmu wall is continuous thru the second floor to the roof. Tim Maurer and myself meet with Don Taylor on June 8, 2007 on site regarding the wall construction. Tim Maurer of MSE Structural Engineering has calculated the beam size required to span the new opening and carry the existing wall above.

Refer to the attached PFGW Mod. No. 1.1 and 1.2 drawings dated June 7, 2007 showing the installation of a W16x36 structural steel beam above aluminum storefront between Lobby #101 and Waiting #105.

Aluminum Storefront "AL-4" and Wood Door Type "F" have been modified per Mod. 1.3. All 4" spandrel glass and associated aluminum framing has been eliminated.

Please provide an itemized Cost Proposal for changes shown on the Mod. Drawings including credits for modifications of the aluminum storefront and door as shown.

If you have any questions or should you require additional information, please do not hesitate to call us.

Sincerely,

Phil Moyers

PM/jpm

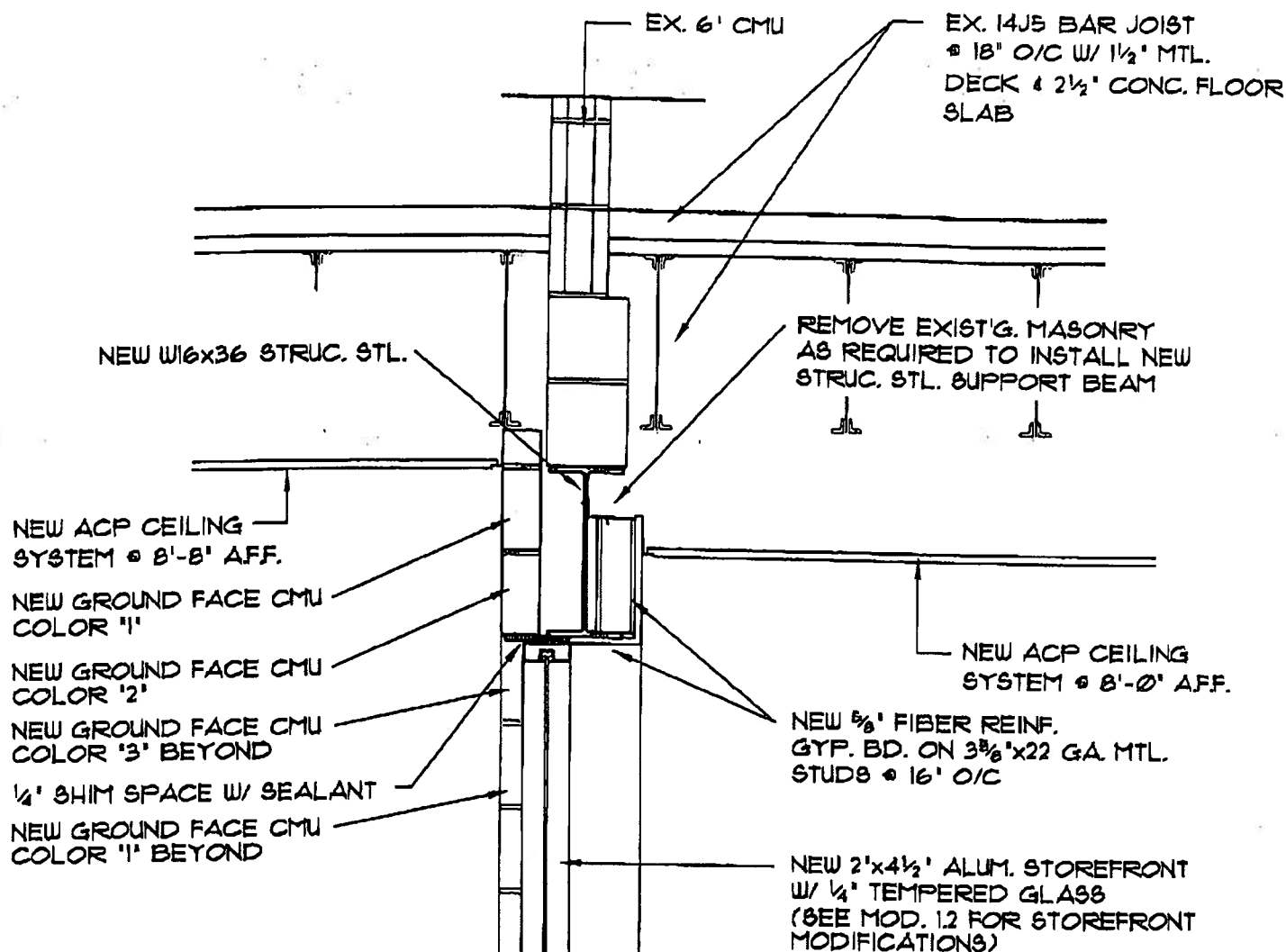

LOBBY
101

ADMIN. WAITING
105

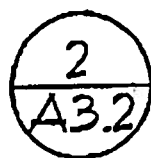

REVISED HEAD DTL.

SCALE: 3/4" = 1'-0"

NHHS 2007 RENOVATIONS		JOB NO.
 Peck Flannery Gream Warren Inc. architects <small>112 North Main Elizabethtown, Kentucky 40121</small>		0701
		DATE
		JUNE 8, 2007
		DRAWING
		MOD. 1.1

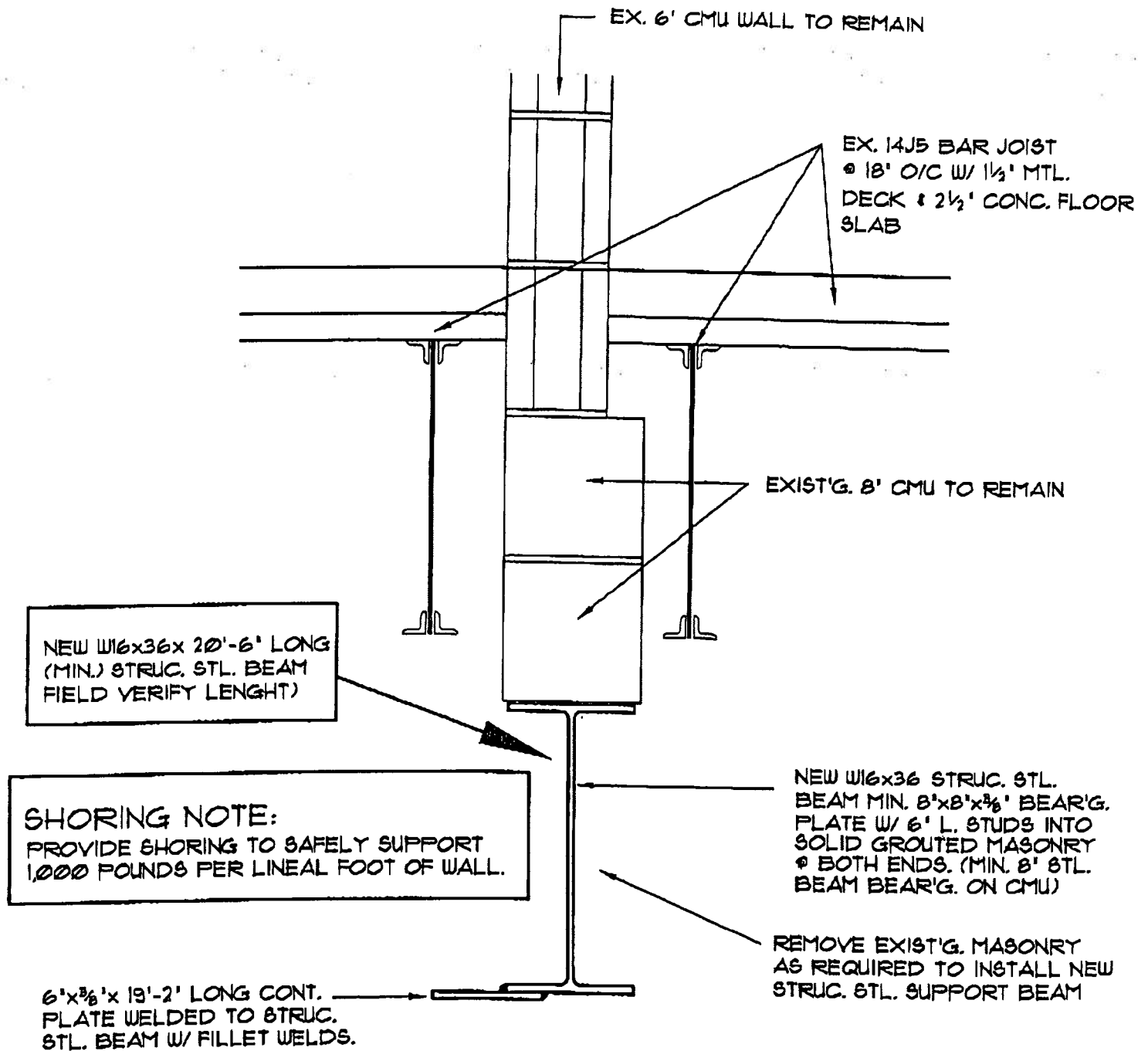

STRUC. STL. BEAM DTL.

SCALE: 1 1/2" = 1'-0"

NHHS 2007 RENOVATIONS



Peck Flannery Gream Warren Inc.
architects
112 North Main, Elizabethtown, Kentucky 42701

JOB NO.

0701

DATE

JUNE 8, 2007

DRAWING

MOD. 1.2

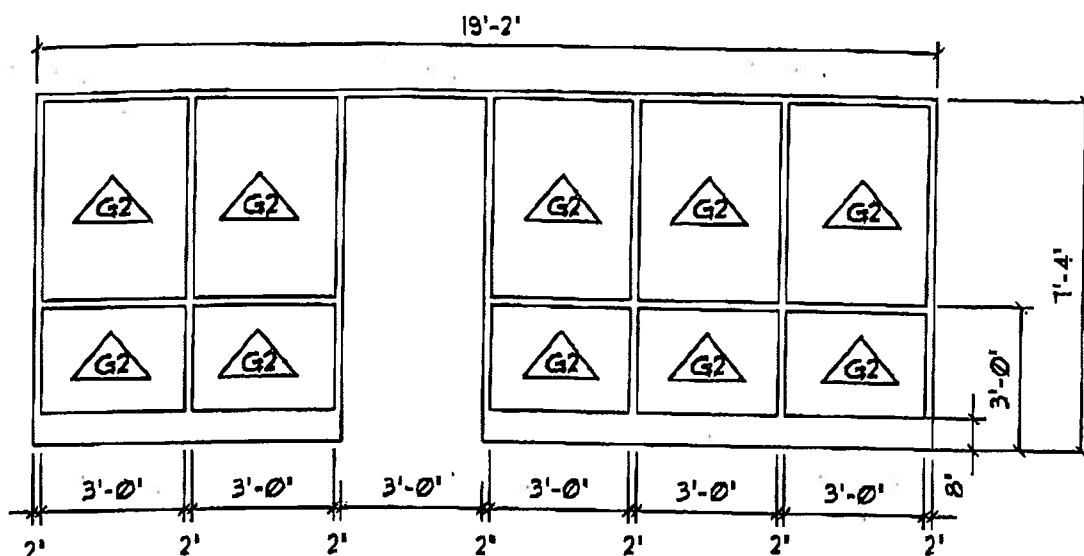

AL4

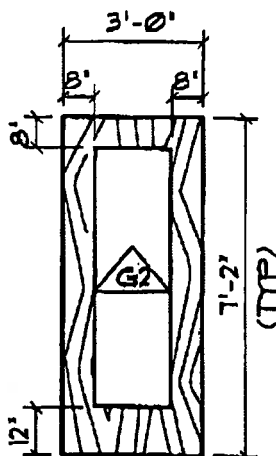

RED OAK DOOR
FULL GLASS

Ⓕ

STOREFRONT MODIFICATIONS

SCALE: 1/4" = 1'-0"

<h1>NHHS 2007 RENOVATIONS</h1>		JGS NO. 0701
 <div> <p>Peck Flannery Gream Warren Inc.</p> <p>architects</p> <p>718 North Main Elizabethtown, Kentucky 42701</p> </div>		DATE JUNE 8, 2007 DRAWING MOD. 1.3