

Change Order Request

Detailed (with Breakdown of PCOs), Grouped by Each Number

2.5

#0348- Rineyville Elementary School
275 Rineyville School Rd
Rineyville, KY 40162

Project # #0348
Tel: 270-769-0938

WHITTENBERG CONSTRUCTION CO.
Fax: 270-769-0204

Change Order Request: 029

Date: 7/18/2007

To: Larry Gream
PECK FLANNERY GREAM WARREN INC.
112 North Main Street
Elizabethtown, KY 42701

From: Chris Jones
WHITTENBERG CONSTRUCTION CO.
P.O. Box 9429
4774 Almond Av.
Louisville, KY 40208-9429

Description	Category	Status
Add Block Wall Partitions to Boys Restrooms 111 and 211	Change Order	In Review

Reference	Required By	Days Req	Amt Req
Baileys Masonry COR #6 dated 6/12/07, received on 7/17/07		0	1,024

Notes:

PCO No	Date	Reference	Amt Prop	Days Req	Category	Reason
029	7/17/2007		1,024	0	Change Order	Consultant Directive

Item No	Item Description	Amt Prop	Reference
001	Add 2 Block Walls in Boys 111 & 211 (see Baileys attached COR 6)	966	
002	WCC 5%	48	
003	Bond 1%	10	

Approved By:

Signature

Name

Date

Prolog Manager

Printed on: 7/18/2007 Whittenberg

Page 1

Commercial

Brick Block

Industrial

BAILEY'S MASONRY, INC.

Since 1980

**CHANGE ORDER REQUEST**

(WCC RECEIVED ON 7/17/07)

Customer			
Name	Whittenberg Construction Company		
Address	4774 Almond Avenue		
City	Louisville	State	Ky Zip 40209
Phone	502-361-8891	Fax	502-368-9192

Date	6/12/2007	Change Order	006
Rineyville Elementary School			
Rineyville, Ky., 40216			
Whittenberg No. 0348			

Qty	Description	Unit Price	Total
	Change Order - 006		\$965.68
6	Block two (2) partitions in boys bathrooms. All exposed corners to be bullnosed. Price is for both walls.		
5.5	Material		\$205.68
	Labor Hours		\$375.00
	Mason Hours		\$385.00
	Total Amount of Change Order		\$965.68
Signature <i>[Signature]</i>		CHANGE ORDER AMOUNT	\$965.68

240 West Dixie Avenue, Suite 200
 Elizabethtown, Ky., 42701

Phone: (270) 765-0969
 Fax: (270) 765-0976



**PECK FLANNERY GREAM WARREN
ARCHITECTS, LLC**

Larry Gream, Architect

June 8, 2007

Chris Jones
Whittenberg Construction Company
P. O. Box 9429
Louisville, Kentucky 40209-9429

RE: New Rineyville Elementary School
Rineyville, Kentucky
Architect File No: 0508
BG# 05-116

Dear Chris:

Attached are our drawings MOD 13.1 and 13.2. These drawings detail additional cmu walls in Boy's Toilet 111 and Boy's Toilet 211. Please construct these walls @ time and material rates.

Additionally please contact U. S. Specialities to determine if the toilet partitions at this location require hardware modification to accommodate a cmu end wall in lieu of a solid surface end wall. If the partitions have not been produced, please forward a credit to delete the end wall of the partitions at these locations.

Sincerely,

Larry Gream

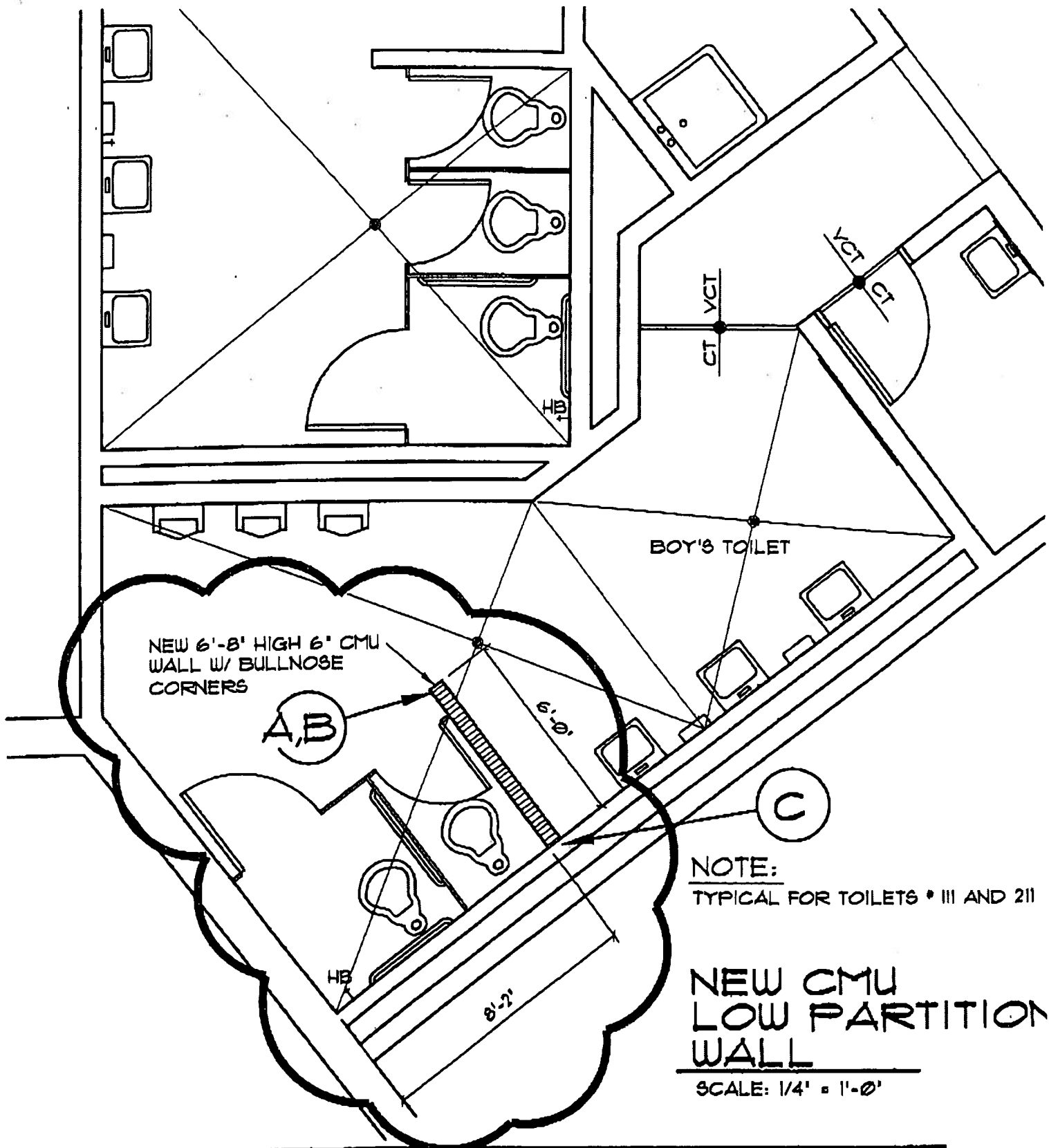

RINEYVILLE ELEM. SCHOOL



Peck Flannery Gream Warren Inc.
architects
84 North Main Elizabethtown, Kentucky 40121

JOB NO.

0508

DATE

JUNE 8, 2007

DRAWING

MOD. 13.1

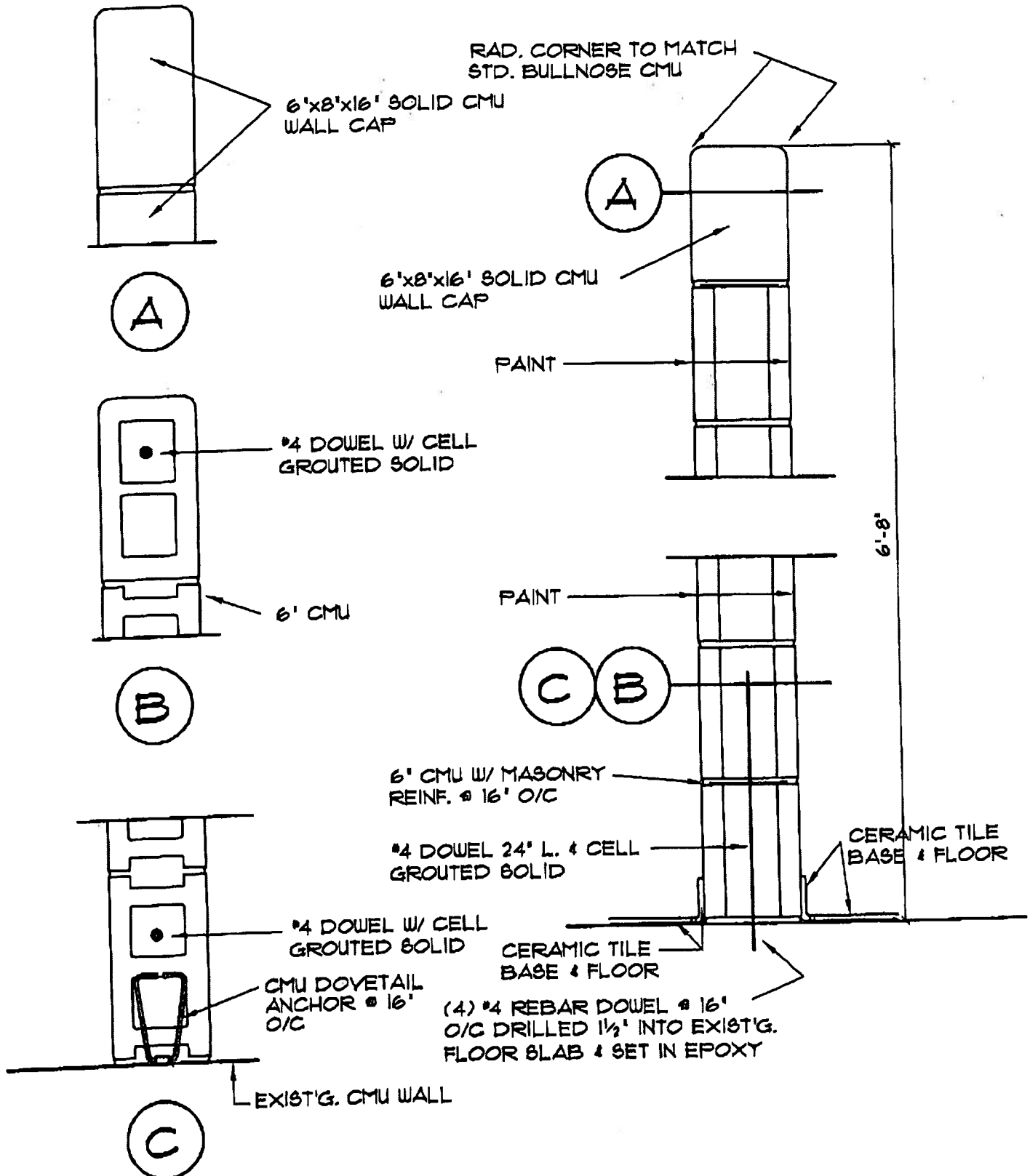

RINEYVILLE ELEM. SCHOOL



Peck Flannery Gream Warren Inc.

architects

112 North Main Elizabethtown, Kentucky 42701

JOB NO.

0508

DATE

JUNE 8, 2007

DRAWING

MOD. 13.2