



HARDIN COUNTY SCHOOLS EARLY COLLEGE AND CAREER CENTER

SCB Project No. 1309

Construction Update July 1, 2014



Original Construction Cost:	\$15,362,000.00
Present Construction Cost:	\$15,498,679.48 (<i>Revised by Change Order Nos. 5 and 6</i>)

Original Completion Dates	
Substantial Completion:	July 1, 2014
Final Completion:	August 1, 2014

Anticipated Completion Dates	
Substantial Completion:	July 15, 2014
Final Completion:	August 1, 2014

Progress Report

Past Two Weeks Progress:

1. Continue paving, curbs, sidewalks, and top soil placement
2. Installed screen wall gates
3. The cmu and brick is complete
4. Roofing and sheet metal is ongoing
5. Canopy installation is ongoing
6. Finishing GWB at windows and doors
7. Visual display board installations are ongoing
8. Painting is ongoing
9. Installed vinyl base on Lower Level
10. Ceiling grid installation is ongoing
11. Polishing of concrete floors is complete, Rooms 109, 140, and 136 are being reworked
12. Casework installation is ongoing
13. Kitchen equipment installation is ongoing
14. Exterior aluminum storefront and doors are installed, currently working on trim and caulk
15. Installed exterior louvers
16. Installed walk-in freezer/cooler
17. Continue fire suppression at the Upper Level (waiting on dry pendant heads)
18. Installing plumbing fixtures and hooking up kitchen equipment
19. Electrical rough-in is ongoing at both levels. Lights and devices are being installed
20. Testing cable and installing speakers and smartboards

Next Two Weeks Progress:

1. Complete sidewalks and topsoil
2. Complete canopies/walkway covers
3. Begin sunshade installation
4. Begin installing stone and remaining asphalt base
5. Begin landscaping
6. Install interior storefront at Lobby 100
7. Continue base and floor coverings
8. Complete casework and countertops
9. Complete roofing
10. Complete finishing GWB
11. Complete ceiling grid on Upper Level
12. Continue painting
13. Continue MEP rough-in
14. Begin final cleaning

Lower Level

4



1



2



3



4



Upper Level

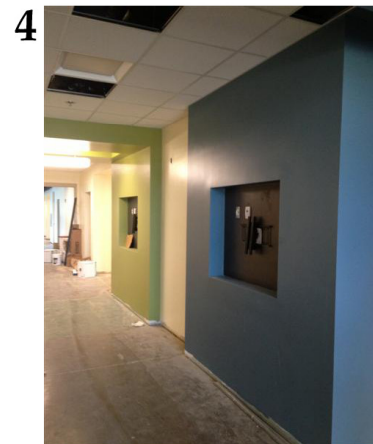
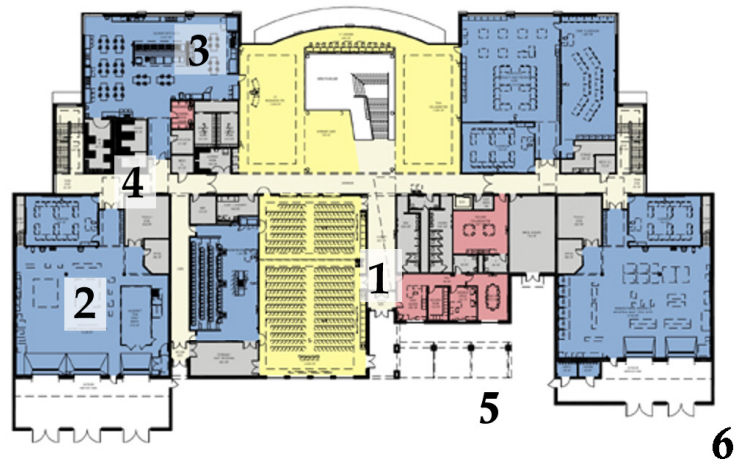

Upper Level

5



6

