

Legend

*** Drafting *** [Gis]

- drafting_areas.area_14
- drafting_lines.line_1
- drafting_lines.line_13
- Building Footprint.School Extent
- Building Footprint.Multi Family Extent
- Building Footprint.Unknown Extent
- Easement.Route
- Hydrology.River Route
- Hydrology.Stream Route
- Hydrology.River Extent
- Land Note.Arrow
- Misc. Transportation Feature.Other Route
- Parcel.Extent
- Right of Way.Route

*** Non Common *** [Land]

- County.Extent
- Foreign Facility.Route
- Misc Land Feature.Extent
- Service Territory.Electric Extent
- Service Territory.Gas Extent
- Town.Extent
- Anchor.Exist Dist Location
- Cutout Bank.Exist Dist Location - 2
- Head Guy.Exist Dist Route
- Junction Box.Exist Pedestal Location
- Open Point.Exist Dist Location
- Pole.Exist Dist Location - 1
- Primary OH Segment.Exist 1 Phase Route
- Primary OH Segment.Exist 3 Phase Route
- Primary UG Segment.Exist 1 Phase Route
- Primary UG Segment.Install 3 Phase Route
- Primary UG Segment.Remove 3 Phase Route
- Secondary UG Segment.Exist Second Route
- Transformer OH Bank.Exist Location
- Transformer OH Bank.Secondary Location
- Transformer UG Bank.Exist Location - 1
- Transformer UG Bank.Install Location - 3
- Transformer UG Bank.Remove Location - 3
- Transformer UG Bank.Secondary Location

*** Non Common Devices *** [Electric]

- Arrester.Exist Dist Location
- Light.Exist Location - On
- Switch Bank.Exist Location - 4

*** Non Common Structures *** [Electric]

- Street Light Pole.Exist Location
- Attachment Point.Location

DESCRIPTION

INSTALL:
1 - 750KVA, 3PH, 4 WIRE, 120/208V PADMOUNT TRANSFORMER
1 - 1/0 AL 3PH PRIMARY CABLE (+/- 200')
REMOVE:
1 - 500KVA, 3PH, 4 WIRE, 120/208V PADMOUNT TRANSFORMER
1 - 1/0 AL 3PH PRIMARY CABLE (+/-200')

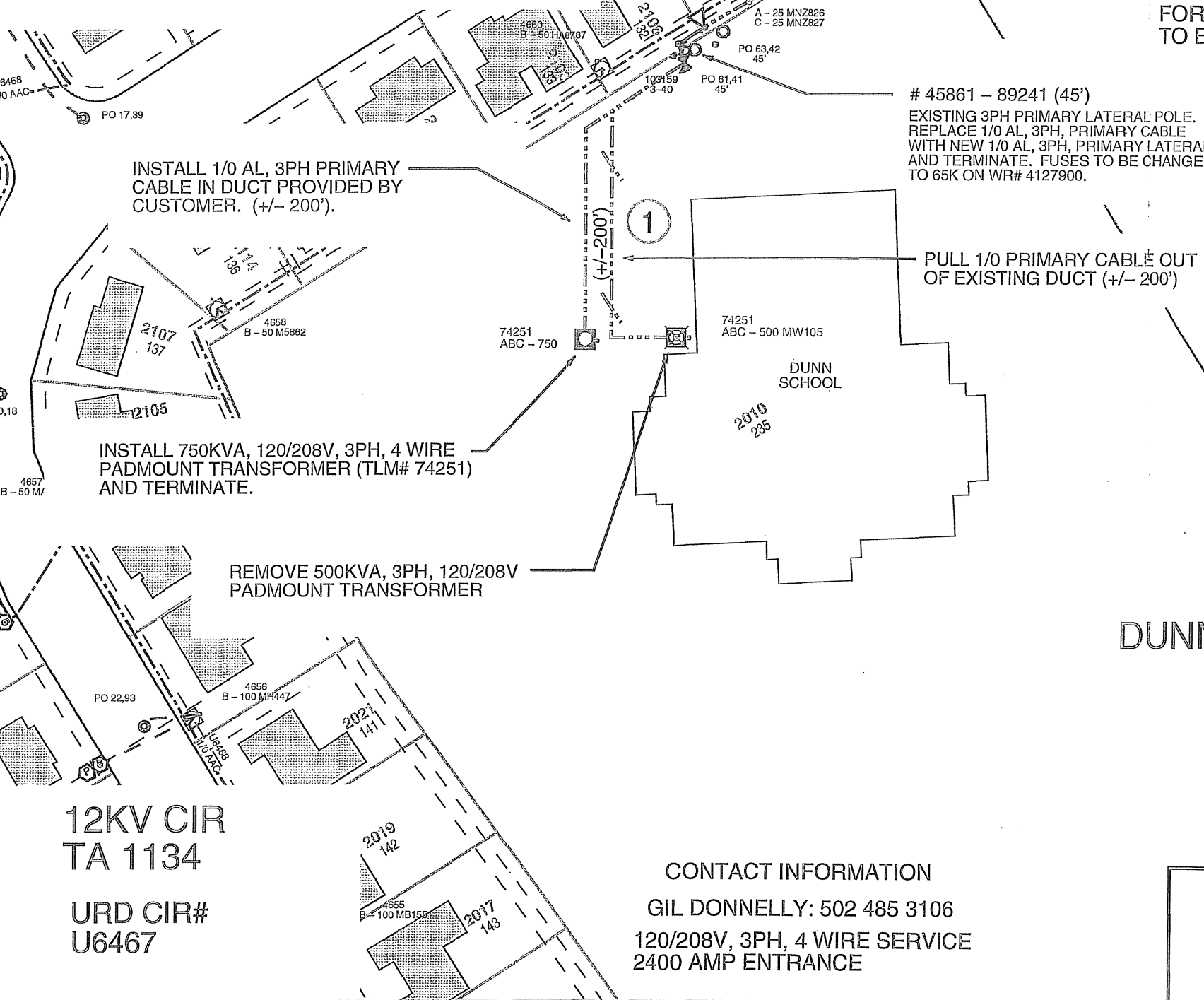

EASEMENTS NEC.

① 15' GRANTED ELECTRIC EASEMENT

*** NOTE ***

REFER TO WR# 4127900
FOR OVERHEAD WORK
TO BE DONE

DUNN ELEMENTARY SCHOOL
2010 RUDY LANE
WR# 4070873

CNBCD340U
3-24-14

CONTACT INFORMATION

GIL DONNELLY: 502 485 3106
120/208V, 3PH, 4 WIRE SERVICE
2400 AMP ENTRANCE

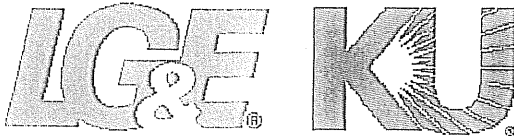

Unless otherwise indicated, all locations are taken from office records and must be verified in the field prior to any construction where there is a possibility of interference with existing KU/LG&E facilities. NOTICE: © 2002 Geographic Data Technology, Inc. All rights reserved. This material is an unpublished work under the Copyright Act of the United States. This material is considered a trade secret of Geographic Data Technology, Inc. You will be held liable for any unauthorized copying or disclosure of this material. NOTICE: © 2002 by Louisville and Jefferson County Metropolitan Sewer District (MSD) and Louisville Water Company (LWC). All rights reserved. No part of this map or data may be reproduced or transmitted in any form or by any means, electronic or mechanical, including photocopying and recording, or by any information storage or retrieval system, except as expressly permitted in writing by MSD and LWC. The information contained in/on this media is made without representation or warranty of any nature by LG&E Energy LLC or any affiliated company, is not guaranteed by LG&E Energy LLC or any affiliated company, and is furnished solely for the convenience of the contractor using it.

WORK REQUEST: 4070873
WORK TYPE: ENBCDUG
DESIGNER: PEAVLER, JESSICA
RELEASED TO CONSTRUCTION:
PAGE: 2 of 2

REV #: 1

[OHIO] 4070873

ELECTRIC NEW BUSINESS - COMMERCIAL UG