



HARDIN COUNTY SCHOOLS EARLY COLLEGE AND CAREER CENTER

SCB Project No. 1309

Construction Update **April 9, 2014**



Original Construction Cost:	\$15,362,000.00
Present Construction Cost:	\$15,344,207.43 (<i>Revised by Change Order No. 2</i>)

Original Completion Dates	
Substantial Completion:	July 1, 2014
Final Completion:	August 1, 2014

Anticipated Completion Dates	
Substantial Completion:	July 1, 2014
Final Completion:	August 1, 2014

Progress Report

Past Two Weeks Progress:

1. Completed joist and deck at the mezzanine and place the slabs
2. The CMU on the upper level is ongoing in Rooms 214 and 240
3. Brick installation is ongoing
4. Roofing, working on the 3 ply installation and parapet flashing
5. Metal stud framing, installing soffits on the Upper Level
6. Hanging and finishing drywall on Lower and Upper Levels
7. Spray foam insulation is complete
8. Wood blocking in walls is complete
9. OSB behind the metal panels is approximately 85% complete
10. Roofing blocking is ongoing
11. Setting door frames as needed
12. Ceramic tile in Lower Level is complete, work is ongoing on Upper Level
13. Painting is ongoing
14. Ceiling grid on the Lower Level has started
15. Polishing the floors has started in the Lower Level Classroom areas
16. Window installation has started
17. Elevator installation is ongoing
18. Upper level water piping and hydronic piping is ongoing
19. Heat pumps in the small mechanical rooms on the Lower Level are set in place
20. Duct work installation on the Upper Level is ongoing\
21. Electrical rough-in is ongoing, both levels, dropping lights in grid

Next Two Weeks Progress:

1. Continue brick and complete CMU walls
2. Complete canopy steel at rear entry
3. Complete roof blocking
4. Continue roofing
5. Start overhead doors
6. Complete metal stud framing and hanging drywall
7. Complete drywall finishing
8. Continue ceramic tile at restrooms
9. Start Quarry Tile at Culinary Arts
10. Continue painting, block billers, and primers
11. Continue window installation
12. Continue MEP rough-in

Lower Level

1



1



2



3



4



Upper Level

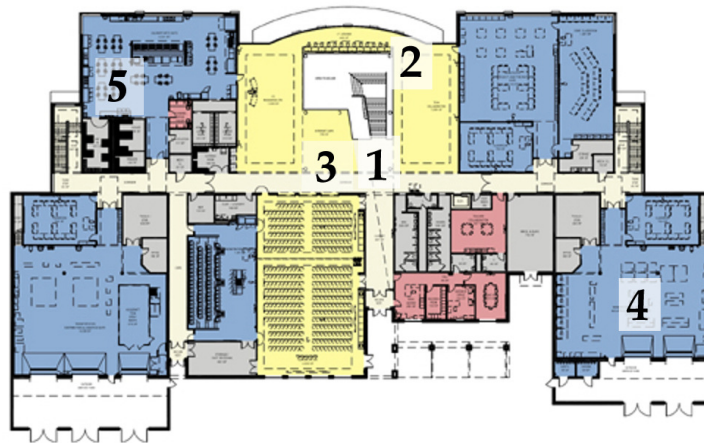

1



2



3



Upper Level

4



5

