



HARDIN COUNTY SCHOOLS EARLY COLLEGE AND CAREER CENTER

SCB Project No. 1309

Construction Update **March 10, 2014**



Original Construction Cost:	\$15,362,000.00
Present Construction Cost:	\$15,344,207.43 (<i>Revised by Change Order No. 2</i>)

Original Completion Dates	
Substantial Completion:	July 1, 2014
Final Completion:	August 1, 2014

Anticipated Completion Dates	
Substantial Completion:	July 1, 2014
Final Completion:	August 1, 2014

Progress Report

Past Two Weeks Progress:

1. Waiting on city approval to complete water
2. Connected the 8" roof drains to the storm sewer
3. Placed concrete slab at upper level office area
4. ICF bearing walls are complete
5. ICF parapet walls are complete on the low roof area
6. The CMU on lower level is 99% complete, and upper level is ongoing
7. Brick installation is ongoing
8. Installing roof joist and decking, the low roof is complete, working on the clerestory area and Industrial Suite 240
9. Installation of temporary roof and permanent roof is ongoing (as of 3/10/14 – all areas have at least temporary roofing in place except the Industrial Arts and Auto Tech Suites.
10. Metal stud framing, installing soffits on the lower level and walls around clerestory
11. Hanging gypsum wall board in dry areas on the lower and upper levels
12. Wood blocking on the lower level is complete
13. Roof blocking and plywood on parapet walls is ongoing
14. Setting door frames as needed
15. Started upper level piping
16. Ductwork installation on the lower level is complete, started on the upper level
17. Electrical rough-in is ongoing – both levels

Next Two Weeks Progress:

1. Continue slab on grade at upper level
2. Complete ICF parapet walls
3. Continue brick and CMU walls
4. Complete structural steel, joist and decking
5. Continue roof blocking
6. Continue metal stud framing and gypsum wall board
7. Continue MEP rough-in

Lower Level

1



1



2



3



Upper Level

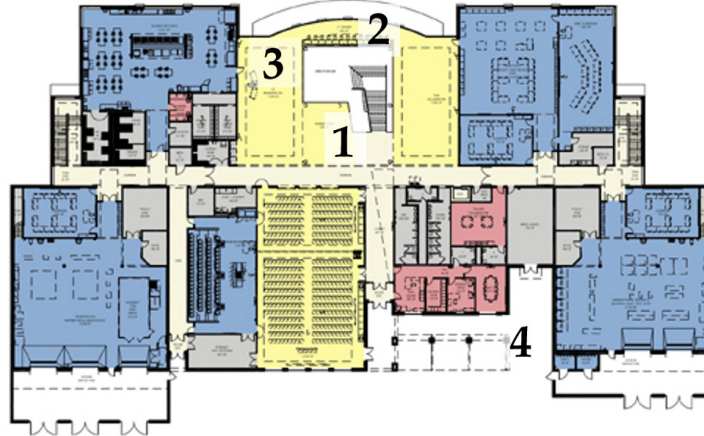

1



2



3



4

