

DATE: October 24, 2013

PR #: Sixteen (16)

TO: David Beiersdorfer Jr.
Endeavor Construction
977 State Route 28
Milford, Ohio 45150RE: Gallatin Co. Alternative School & Field House
Gallatin County, Kentucky
BG 12-133
RTA 0914

Please submit an itemized quotation for changes in the Contract Sum and/or Time incidental to proposed modifications to the Contract Documents described therein.

THIS IS NOT A CHANGE ORDER NOR A DIRECTION TO PROCEED WITH THE WORK DESCRIBED HEREIN.

DESCRIPTION: **Provide bollards at fire hydrant and electrical transformer. Install curbing along roadway.**

Provide material and labor to provide the following. Refer to sketch PR16.1 for additional information.

1. Install three (3) steel, concrete filled bollards at the electrical transformer. 2. Field verify bollard locations with existing utility lines and adjust as necessary for installation relative to the layout shown.
2. Install two (2) steel, concrete filled bollards at the fire hydrant. Field verify bollard locations with existing utility lines and adjust as necessary for installation relative to the layout shown.
3. Install curbing along roadway.

ATTACHMENTS: PR16.1

BY: John C. Gilbert, Assoc. AIA, LEED AP

C: Dorothy Perkins, Gallatin Co. Schools
Lenny Whalen, Gallatin Co. Schools
Ronald E. Murrell, Jr., AIA, LEED AP BD+C
File 0914-4B2
PR 16-0914

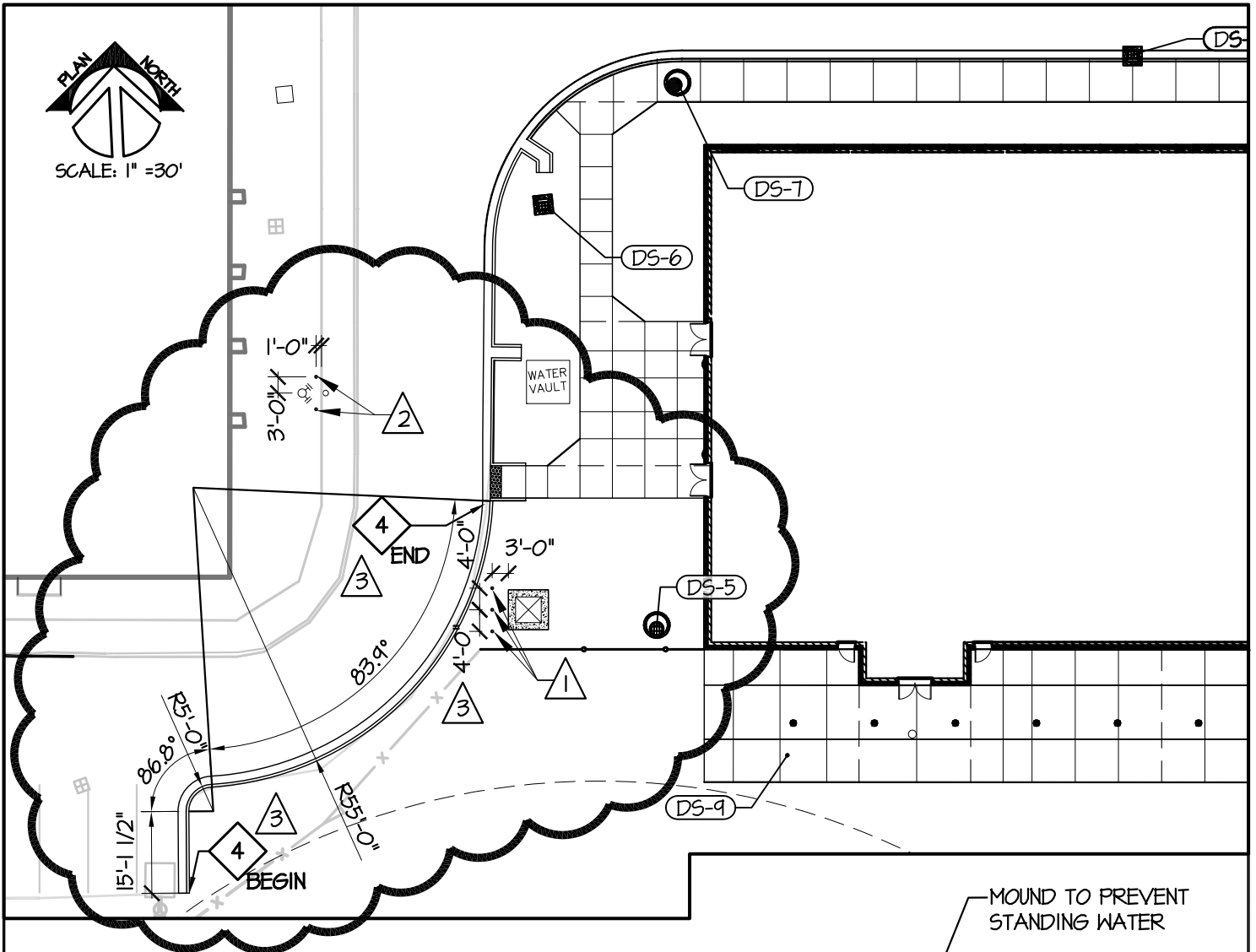

- 1 INSTALL THREE (3) STEEL CONCRETE FILLED BOLLARDS SPACED AT 4' APART. TYPICAL INSTALLATION FOR THE BOLLARD IS 3' OFF THE TRANSFORMER PAD, BUT IN NO CASE SHALL A BOLLARD BE WITHIN 3' OF THE ROADWAY. FIELD VERIFY BOLLARD LOCATIONS WITH EXISTING UTILITY LINES AND ADJUST AS NECESSARY FOR INSTALLATION RELATIVE TO THE LAYOUT SHOWN.
- 2 INSTALL TWO (2) STEEL CONCRETE FILLED BOLLARDS OFFSET 3' FROM THE FIRE HYDRANT, AND 1' OFF THE SIDEWALK. FIELD VERIFY BOLLARD LOCATIONS WITH EXISTING UTILITY LINES AND ADJUST AS NECESSARY FOR INSTALLATION RELATIVE TO THE LAYOUT SHOWN.
- 3 INSTALL CURB AND GUTTER ALONG ROADWAY. PATCH ASPHALT AS NECESSARY FOR CONSTRUCTION.

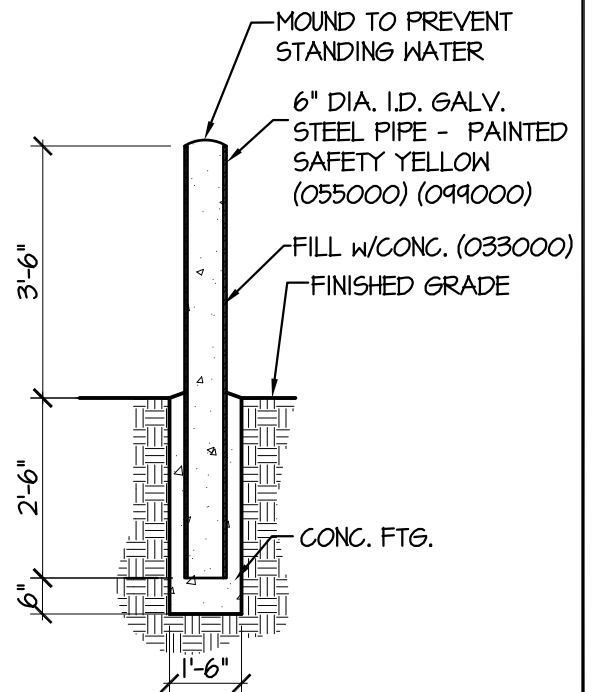

CONCRETE FILLED PIPE BOLLARD
N.T.S