

Legend

*** Drafting *** [Gis]

drafting_areas.area_14

drafting_lines.line_10

Building Footprint.Business Extent

Building Footprint.Unknown Extent

Easement.Route

Hydrology.Stream Route

Land Note.Arrow

Parcel.Extent

Right of Way.Route

Street.County Paved Route

Street.Interstate Paved Route

*** Non Common *** [Land]

County.Extent

Foreign Facility.Route

Service Territory.Electric Extent

Service Territory.Gas Extent

Town.Extent

Anchor.Exist Dist Location

Anchor.Install Dist Location

Connector.Location

Cutout Bank.Exist Dist Location - 2

Junction Box.Install Other Location

Pole.Exist Dist Location - 1

Pole.Exist Second Location - 1

Pole.Install Dist Location - 1

Primary OH Segment.Exist 3 Phase Route

Primary OH Segment.Install 3 Phase Route

Primary UG Segment.Exist 3 Phase Route

Secondary OH Segment.Exist Second Route

Secondary UG Segment.Exist Service Route

Transformer OH Bank.Install Location

Transformer UG Bank.Exist Location - 3

Transformer UG Bank.Secondary Location

*** Non Common Devices *** [Electric]

Arrester.Exist Dist Location

Light.Exist Location - On

Light.Structural Location

*** Non Common Structures *** [Electric]

Street Light Pole.Exist Location

*** Elec Related *** [Electric]

Attachment Point.Location

JOB BRIEFING

1.) HAZARDS ASSOCIATED WITH THE JOB

2.) WORK PROCEDURES INVOLVED

3.) SPECIAL PRECAUTIONS

4.) ENERGY SOURCE CONTROLS

5.) PERSONAL PROTECTIVE EQUIPMENT REQUIRED

Signature

Description

Installation:

(1) - 45' Pole

(4) - #123 AAAC Pri & Neutral (352' +/- Total)

3Ø Bank of (3) 15KW, 12KV, 120/208V, 4W Transformers

Frame Pole for 3Ø SEC Lateral to Customer Installed Splicebox

Using #500-500-500-350 Quadruplex.

Install (2) 20' Anchors w/ 12M D. Guys

Removal:

None

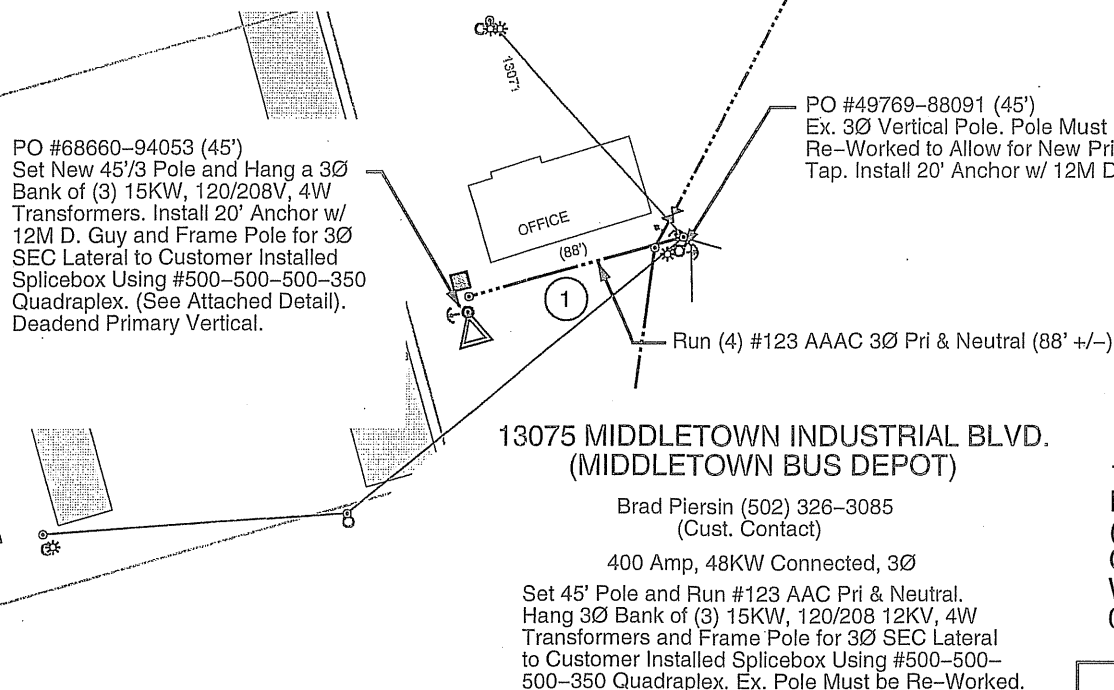

12KV CIR
AK1293

← To N. English Station Rd.

COPY

Easements Nec. 1

1 Granted 25' Elec E'smt

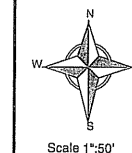

Staked by
Jon Morris

13075 Middletown
Industrial Blvd.
(Middletown School Bus Depot)
CNBCD3400
WR #3723004
04/22/2013



Unless otherwise indicated, all locations are taken from office records and must be verified in the field prior to any construction where there is a possibility of interference with existing KU/LG&E facilities. NOTICE: © 2002 Geographic Data Technology, Inc. All rights reserved. This material is an unpublished work under the Copyright Act of the United States. This material is considered a trade secret of Geographic Data Technology, Inc. You will be held liable for any unauthorized copying or disclosure of this material. NOTICE: © 2002 by Louisville and Jefferson County Metropolitan Sewer District (MSD) and Louisville Water Company (LWC). All rights reserved. No part of this map or data may be reproduced or transmitted in any form or by any means, electronic or mechanical, including photocopying and recording, or by any information storage or retrieval system, except as expressly permitted in writing by MSD and LWC. The information contained in/on this media is made without representation or warranty of any nature by LG&E Energy LLC or any affiliated company, is not guaranteed by LG&E Energy LLC or any affiliated company, and is furnished solely for the convenience of the contractor using it.

WORK REQUEST: 3723004
WORK TYPE: ENBCDOH
DESIGNER: MORRIS, JONATHAN
RELEASED TO CONSTRUCTION:
PAGE: 2 of 2

REV #: 1

SH 4/23/13