

SITE PLAN

SCALE - 1" = 50'

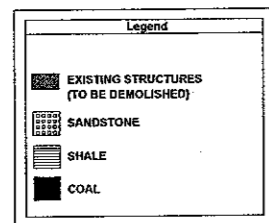
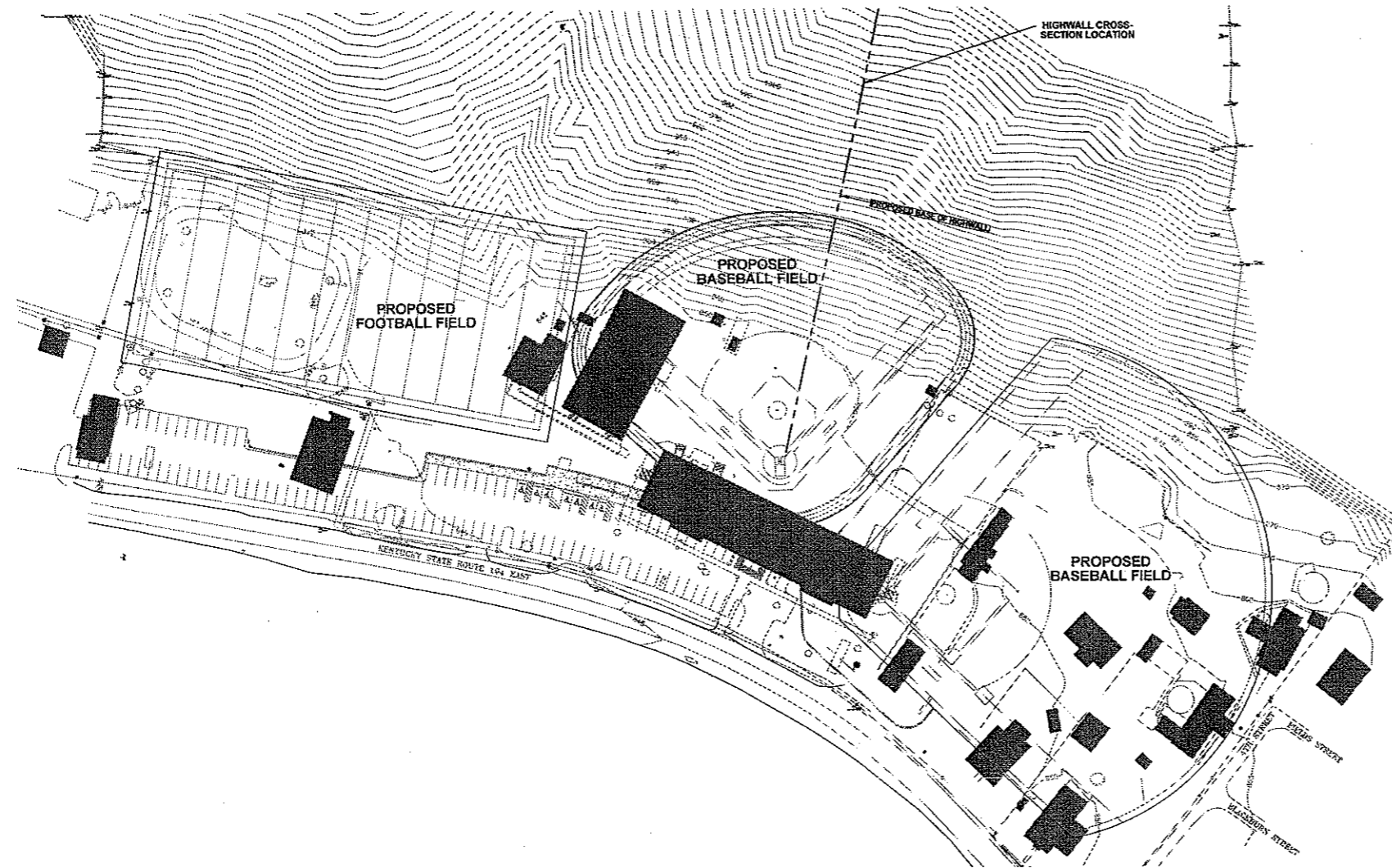

NOTES:

1. Site Plan base map supplied by Vision Engineering and was modified by CSI personnel.
2. Rock units as depicted were interpolated from open face logging of visible rock outcrops and cliffs.
3. After clearing and grubbing operations are completed, the slope configuration for the highwall design **MUST** be field verified by open face logging of the exposed rock face. This may require additional removal of overburden by excavation equipment.
4. The Cedar coal bed was not observed during open face logging. Coal bed as depicted was approximately located based on information from available geologic mapping of the Matewan Geologic Quadrangle.
5. The Eagle coal bed was not observed in the field during the open face logging process, and there are no mapped outcrops indicated on the Matewan Geologic Quadrangle. The geologic mapping indicates that it may be present in the area and could be encountered during highwall construction.
6. Based upon the elevations of the coal beds and the results of the open face logging verification during clearing and grubbing, the elevations of the benches and rock cut slopes may need to be adjusted accordingly.
7. During construction, remove all trees from the daylight point at the top of the highwall for a distance of 50 feet upslope. Leave the stumps intact to preserve the root zone.

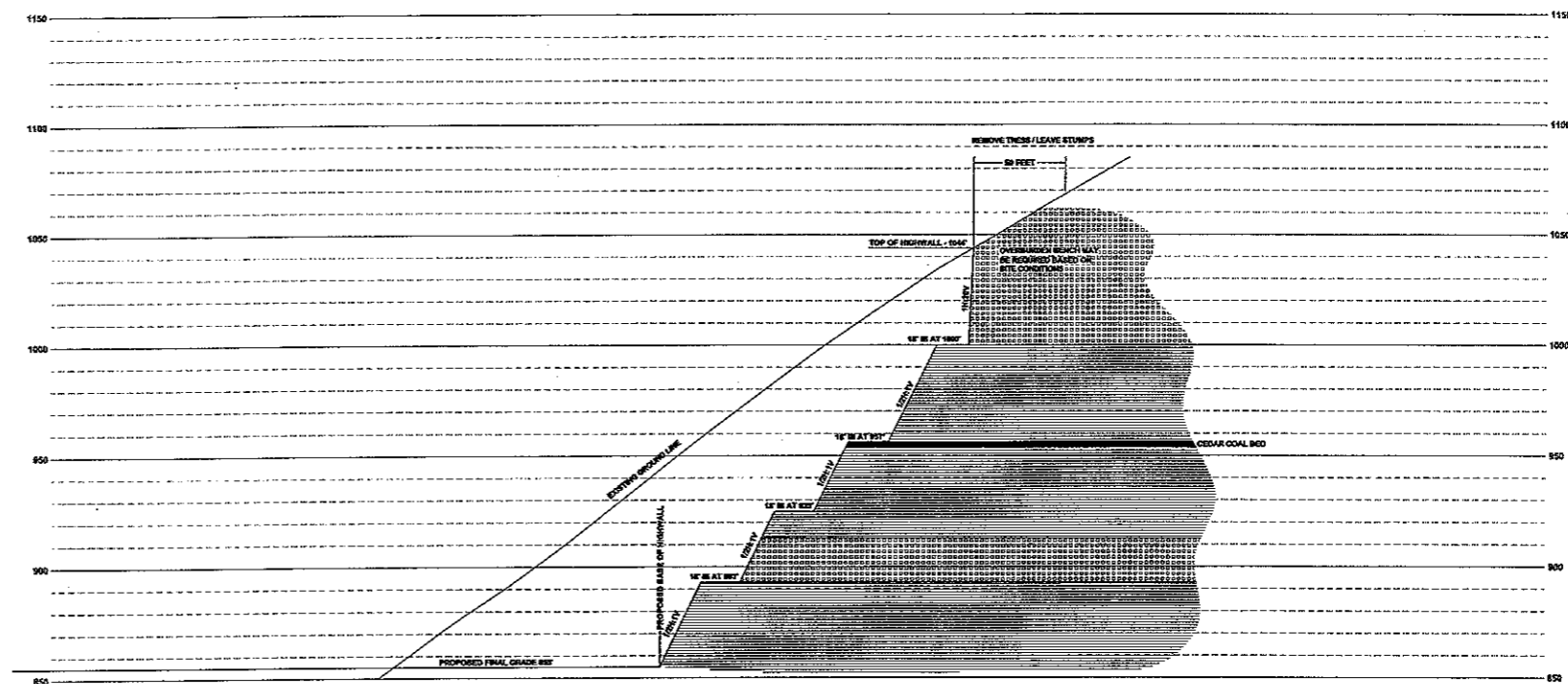

CROSS-SECTION OF HIGHWALL DESIGN
SCALE - 1" = 30'

JOB NAME
**PHELPS SCHOOLS
 SPORTS FACILITIES**
 38029 KENTUCKY STATE ROUTE 194 EAST
 PHELPS, PIKE COUNTY, KENTUCKY

SHEET TITLE
**PROPOSED
 HIGHWALL DESIGN
 FOR ATHLETIC
 FACILITIES**

3199 Pine Creek Road, Suite 210
 Lexington, KY 40502
 606.257.0009 fax.606.259.0233
 www.murphygraves.com
 © Copyright 2011

**MURPHY-GRAVES
 ARCHITECTS**

Consulting Engineer (Incorporated in Kentucky)
 250 Cave Run Road, Apt. 203
 606.336.8221 (Cave Run) 606.376.1721 Fax
 www.csi-engineers.com

JOB NO. -
 DATE - January 23, 2013
 PRODUCED BY:
 NOTES:

SHEET NUMBER
HW-1