

Sherman Carter Barnhart PSC
ARCHITECTURE • INTERIORS • LANDSCAPE ARCHITECTURE • ENGINEERING

May 7, 2012

Mr. Brett Beaverson, Director of Operations
Spencer County Public Schools
207 W. Main Street
Taylorsville, KY 40071

RE: New 650 Student Elementary School

Dear Brett:

Sherman Carter Barnhart is pleased to submit our letter of interest to design Spencer County's new elementary school. We have enjoyed working with you, Superintendent Adams, and the Board of Education over the years, and we look forward to the opportunity to continue to work with all of you on this new elementary. Sherman Carter Barnhart's beliefs, principles and practices are centered on the importance of the client's involvement. This involvement is continuous through all phases of the project and includes all stakeholders. We believe it is your project, and therefore you must be involved, for the project to be a success. A recognized leader in the design of schools, Sherman Carter Barnhart offers Spencer County the following benefits:

- A unique design philosophy and process that recognizes a successful school is one which is **Student And Teacher Centered**. A student and teacher centered school supports teaching and learning, creates a safe & secure environment, is community connected, environmentally sound and energy efficient, as well as cost efficient to build, operate and maintain.
- To create successful schools we have a dynamic, exciting, creative interactive design process, which brings together your unique knowledge of the district with our experience and knowledge of educational design to define your vision, goals, and program.
- As stewards of your money, we take seriously your obligation to the community to wisely spend their tax dollars. We feel 3 important ways we demonstrate fiscal responsibility are:
 1. **We design the school within your budget.** With over 32 years of experience, we have designed 55 new elementary schools, 19 of these in just the past 5 years. From this extensive experience we know how much a school costs. All of this information goes into our in-house cost estimating programs, which leads to accurate cost estimates and no big surprises on bid day.
 2. **We design schools that are easy to maintain.** Materials and finishes that do not require harsh chemicals or waxes. Mechanical mezzanines that make it easy to perform maintenance any time of day. All of these are examples of how the design of the school will not only save money by decreasing the cost of maintenance, but also by increasing the longevity of the school because it is so easy to maintain.
 3. **We design energy efficient schools.** We understand the same funds pay the utility bills, buy the text books, and pay the teachers. A leader in energy efficient designs, we have designed more Energy Star schools in Kentucky than any other architect. We also designed the first Net Zero Energy public school in the US, and have designed three net zero energy ready schools in Kentucky. All of this, creates the opportunity for districts to save thousands of dollars a year. By designing an energy efficient school for Spencer County, you will be able to direct the money saved on utilities to more important areas.

I'd also like to stress, Sherman Carter Barnhart's continued commitment to Spencer County. We have enjoyed working with the district for the past 12 years, and truly feel like we are your partner, working to achieve the same goals. We are extremely excited about the possibility of continuing to work with you and the entire district on this new elementary school. We look forward to hearing from you.

Sincerely,

Kenny Stanfield

Kenny Stanfield, AIA LEED AP
Principal

Justin McElfresh
Justin McElfresh, AIA, LEED AP BD+C
Project Manager



rosstarrant architects

architecture • civil engineering • landscape architecture • interior design

May 9, 2012

Mr. Brett Beaverson
Director of Operations
Spencer County Public Schools
207 West Main Street
Taylorsville, Kentucky 40071

Dear Mr. Beaverson:

Please accept our Letter of Interest in providing architectural services to your District. We would be delighted for the opportunity to work with the Spencer County Schools.

Why is RossTarrant Architects the best possible partner to design your new elementary?

We are the only firm in Kentucky that is totally committed to educational facility design

- Your project will benefit from the experience we have gained through collaboration with more than 50 different school districts over the past 42 years.
- At RossTarrant Architects, our ultimate goal is to enhance the environments in which students of all ages live and learn. We are committed to keeping you on the forefront of educational trends and practices that are shaping classrooms today.
- Our expertise in high performance school design will help you save energy, create a healthier space for students, faculty and staff, and minimize your burden on the environment. We will show you how to limit the dollars you spend on operations and maintenance and keep your money focused where you need it most—on your curriculum.
- Every design we create is unique. We don't do cookie-cutter schools. Our goal is to design a facility that will meet your individual needs better than any other school possibly could.

Recognized expertise

- Your project will benefit from the planning expertise of Martha Tarrant, who was named the 2010 Educational Facility Planner of the Year for the entire Southeastern United States.
- You will benefit from a diverse team of LEED Accredited Professionals specializing in architecture, interior design, civil engineering and landscape architecture. With numerous LEED certified and ENERGY STAR projects all across the state, RossTarrant is highly respected for our expertise in the design of high performance P-12 schools.
- Our experience with a wide variety of structural and MEP consultants will help you identify the team that is best suited to accomplish your goals for this specific project.
- Your project will benefit from the careful oversight and attention to detail that has earned our firm an outstanding reputation for the quality of our construction documents and accuracy of our cost opinions.

Our reputation is no accident

We gauge our own success by how happy our clients are with our work and service—and by that standard, we have been very fortunate to enjoy a long history of incredibly successful projects.

Thank you for the opportunity to express our interest in this exciting project. It would be such a pleasure to collaborate with you on the design of your new elementary school.

Sincerely,

Leonard Bowers, AIA
Principal

Enclosures

G. SCOTT & ASSOCIATES, ARCHITECTS

PLC

3 May 2012

Mr. Brett Beaverson, Director of Operations
Spencer County Public Schools
207 West Main Street
Taylorsville, KY 40071

RE: Professional Architectural Services
New Elementary School

Dear Mr. Beaverson:

I wish to strongly express our interest in working with you to design and build your new Elementary School. We have significant experience with just this type of building program, as well as with numerous Boards of Education, and with KDE. That experience is very important, but just as significant to our successful projects are the relationships we develop with our clients. We believe that providing personal attention and service are necessary to properly design our projects. These efforts cannot be presented on a list of buildings, but instead show in numerous ways during the design, construction, and post-construction process:

- closely working with the Kentucky Department of Transportation to determine if access is allowed to proposed sites
- program design quality and detail (taking time to listen)
- involvement of staff in discussion and decisions
- full coordination of project with KDE
- creative individualized/personalized designs
- regular reviews and feedback by Owner
- quality technical documents
- adherence to budgets
- low rates of changes in the work
- intense construction monitoring
- constantly acting as the Owner's advocate
- regular post-construction contact with Owner

The best way to discover just how we treat clients is to talk with them. Our commitment to providing personal service and individual attention to the Client, as well as to design and construction issues have been hallmarks of our success for over 25 years, and we expect them to serve us and our Clients well in the future. While we have designed numerous facilities (both new and renovation/additions) such as this, I am listing several current clients who can best tell you about our work and how we have served them:

- ▶ Tim Moore, Superintendent, and Kelly Middleton, Associate Superintendent, Mason County Schools, 606-564-5563
New Mason County Intermediate School, 100,000 s.f., \$14,000,000
- ▶ Tony Roth, Superintendent, and Rita Dials, Assistant Superintendent, Fleming County Schools, 606- 845-5851
Currently working on New Ewing Elementary School and Hillsboro Elementary Addition/Renovation
- ▶ Jim Frank, Superintendent, Green County Schools, 270-932-2391
New Greensburg Elementary School, 55,000 s.f. and Greensburg Intermediate School, 60,000 s.f.
- ▶ Patricia Hurt, Superintendent, Metcalfe County Schools, 270-432-3171
New Primary Center, 60,000 s.f. and New Middle School Addition to High School
- ▶ Mickey McFall, Superintendent, Clinton County Schools, 606-387-6480
Recently completed Early Childhood Learning Center at \$3.8 mil, and other projects

While we are familiar with the program type for a new Elementary School, we would insist on learning how your particular program is unique so the facility can reflect your own community needs and culture, as well as your educational program needs.

We look forward to discussing this new project with you and the Board. Thanks for your consideration.

Sincerely,



Craig G. Aosey, Managing Partner

12c001 wpd



Architecture
Engineering
Interiors
Landscapes
Planning

May 8, 2012

Brett Beaverson, Director of Operations
Spencer County Public Schools
207 W. Main Street
Taylorsville, KY 40071

**RE: Letter of Interest
New 650 Student Elementary School**

Dear Mr. Beaverson,

On behalf of Clotfelter-Samokar, PSC, I would like to express our interest in providing Architectural Services for your upcoming elementary school.

We feel our experience and qualifications make our firm the best choice for this project. Our firm provided the Architectural services for several of your facilities including: Spencer County Elementary School Renovations, Spencer County Primary School, and Spencer County High School Greenhouse.

By successfully completing these projects, our firm has gained intimate knowledge of the needs of your district. Clotfelter-Samokar and the Spencer County Board of Education have had a successful partnership on several projects, and we certainly wish to reestablish this relationship.

Thank you for the opportunities, both past and present, and we look forward to working together in the future.

Sincerely,

A handwritten signature in blue ink that reads "David M. Samokar". The signature is fluid and cursive, with a checkmark-like flourish at the end.

David M. Samokar, AIA
President

228 E. Reynolds Road
Suite One
Lexington, Kentucky 40517

859.273.3700 f
859.271.6605 f

clotfelter-samokar.com

**Grossman
Chapman
Klarer
Architects Inc.**

988 Swan Street
Louisville, Kentucky 40204
502-589-5552
fax 502-589-5554
email gckarch@belleouth.net

May 7, 2012

Mr. Brett Beaverson, Director of Operations
Spencer County Public Schools
207 W. Main Street
Taylorsville, KY 40071

RE: Letter of Interest for Professional Architectural Services for a New 650 Student Elementary Public School

Grossman Chapman Klarer Architects wish to express interest in being considered for the above referenced elementary school project. We have been in business since 1972 and while our projects and clients have been varied, a majority of our work over the last twelve years have been with nonprofit and governmental organizations.

Our experience with school design includes numerous projects with the Jefferson County Public School system as well as the design of a 600 student elementary school for The Catholic Community of St. Patrick, a parochial school that is part of the Archdiocese School system.

Recently completed projects include the Bingham Gardens (\$8.8 million) for the the State's Department of Health and Family Services which had as part of its program to be LEED certified.

The Louisville Scholar House project done in conjunction with the University of Louisville's College of Education and the non-profit group Family Scholar House (\$8.6 Million), included an Early Learning Center that integrated hands on learning opportunities for the U of L students with preschool children from both the housing component of the project and the children of faculty and students.

REFERENCES

Jefferson County Public Schools 3001 Crittenden, Louisville, KY.
Contact: Mr. John Lee 502-485-3315

The Catholic Community of Saint Patrick 10000 Beckley Station Rd, Louisville, KY.
Contact: Mr. Nagy Tawfik 502-244-8083

University of Louisville

Contacts: Mr. Ken Dietz, Director of University Planning, Design and Construction 502-852-6176;
Mr. Larry Owsley, Vice President of Business Affairs 502-852-5143

The 31 mile drive to Taylorsville is comparable to other projects we have completed in Salem, Indiana and Danville, Kentucky.

We look forward to hearing from you.

Sincerely,



Leo Klarer, President
Grossman Chapman Klarer Architects, Inc

K. Norman Berry Associates Architects PLLC

May 7, 2012

Mr. Brett Beaverson
Director of Operations
Spencer County Public Schools
207 West Main Street
Taylorsville, KY 40071

RE: Letter of Interest--Architectural Services-New 650 Student Capacity Elementary School
Spencer County, KY

Dear Mr. Beaverson:

We are very pleased to respond to your request for a letter of interest for architectural / engineering services for a new 650 student capacity Elementary School. The firm has extensive experience in designing educational facilities at all levels. We are currently providing architectural / engineering services for Shelby County Public Schools, Anchorage Public School, Jefferson County Public Schools, Bullitt County Public Schools and Oldham County Schools.

We recently were selected to design two projects for Shelby County Public Schools--a new 650 Student Elementary School (to replace Southside Elementary) and a new Early Childhood Center--the projects are in the construction document phase and design development phase--respectively.

For Oldham County Public Schools we are ready to solicit bids for a new 650 student capacity Brownsboro Elementary School--and have recently completed two High School addition/renovation projects at North Oldham High School and Oldham County High School.

K. Norman Berry Associates is an 11-person firm with seven registered architects and an annual construction volume exceeding \$50 million. We have been involved in educational construction, both primary and secondary, since starting business in 1971. Our firm has provided architectural services for the Jefferson County Board of Education since 1990 for a variety of projects, from small renovations to a new 650-student Breckinridge / Franklin Elementary School. We pride ourselves on repeat clients as evidenced by our continued work with Oldham County Schools (12 years); Anchorage Public School (10 years); Bullitt County Public School (9 years) and our newest client-Shelby County Public Schools since 2011.

We very interested in your project and would appreciate the opportunity to be considered and look forward to the next step in the selection process.

Sincerely,

K. NORMAN BERRY ASSOCIATES ARCHITECTS PLLC



Steven A. Eggers, AIA, LEED AP
Managing Principal
seggers@knbarch.com

O:\PROMOTIONAL\RFP Submissions\Spencer County Elementary School 2012\Cover Letter 060712see doc

POTTER & ASSOCIATES

A R C H I T E C T S P L L C

May 4, 2012

RE: Letter of Interest
Professional Architectural Services
New Elementary School

Dear Mr. Beaverson:

Potter & Associates Architects would like to express our interest in providing professional Architectural Design Services for a new 650-student elementary school.

Mr. Henry Potter, president of Potter & Associates Architects is a Kentucky licensed architect with thirty-eight years experience in all types of architectural design.

We currently have two projects with the Jefferson County Public School system, one at C. B. Young Service Center that is nearing completion and the other, an auditorium addition and classroom renovation project at Pleasure Ridge Park High School, is nearing construction document completion. Our experience also includes the complete renovation of St. Francis High School, which included new classrooms. We have also completed projects for the U.S. Department of Labor at numerous Job Corps Centers throughout Kentucky that included new and renovating classroom facilities.

Our firm has received numerous design awards, from the American Institute of Architects, Kentucky Society of Architects and Preservation Alliance of Louisville & Jefferson County, Inc. The recognition of our peers is indicative of the effort we take in producing high-quality buildings which are a credit to the client and the community in which they are built.

We would appreciate the opportunity to present our qualifications and experience and we look forward to hearing from you and the Spencer County Board of Education. Thank you.

Very truly yours,



Eileen Van Hoose, AIA, CID, LEED AP
Vice President

RECEIVED

MAY 14 2012

640 S. Fourth Street
Louisville, KY 40202
P.502.589.5674
F.502.584.7453
www.vbnarchitects.com

M

05.07.2012

Mr. Brett Beaverson
Director of Operations
Spencer County Public Schools
207 West Main Street
Taylorsville, KY 40071

Dear Mr. Beaverson:

We would like to express our interest in providing you with architectural services for the following project mentioned in your advertisement:

1. 650 Student Capacity Spencer County Elementary School

Voelker Blackburn Niehoff Architects, recognized in 2005 as the AIA Kentucky "Distinguished Firm of the Year", has an on-going 20+ year relationship with public schools in Kentucky that has resulted in many projects, from new schools to additions and renovations. We have designed several new elementary schools, including two 650-student prototypes that were completed in 2007. These two projects were constructed for \$132/s.f. If this cost per square foot is of interest to you, we would welcome the opportunity to explain our cost-saving techniques. Also, both of these schools earned Energy Star recognition from the United States Environmental Protection Agency for superior energy performance.

We have extensive experience with the Kentucky Department of Education requirements for educational facility planning and new construction.

Thank you for your consideration of this request. We look forward to the opportunity to provide additional information about our firm.

Very sincerely,

John B. Niehoff

John B. Niehoff, AIA
Partner / Architect

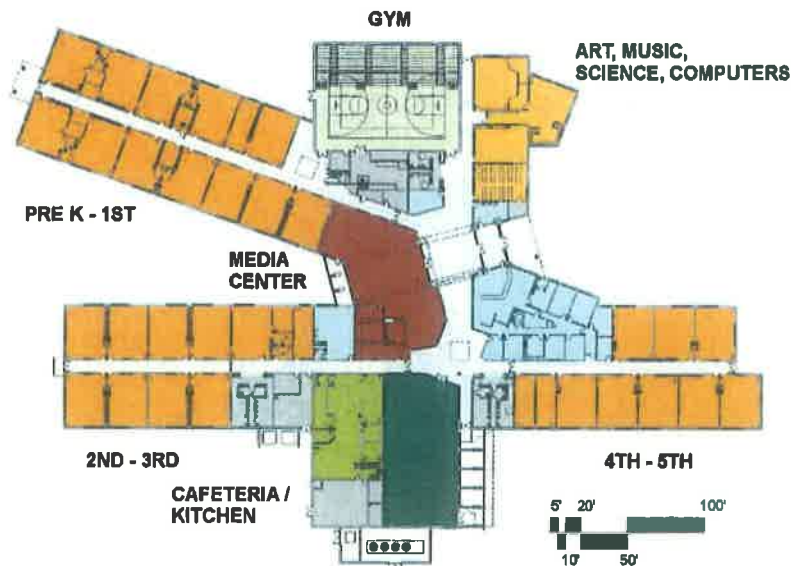

Plan -
Prototypical Elementary School

CLASSROOMS	GYMNASIUM
ART, MUSIC, SCIENCE, COMPUTER	CAFETERIA
MEDIA CENTER	KITCHEN
ADMINISTRATION	MECHANICAL/SUPPORT

M



May 7, 2012

Mr. Brett Beaverson, Director of Operations
Spencer County Public Schools
207 W. Main Street
Taylorsville, Kentucky 40071

RE: Professional Architectural Services for a new Elementary School

Dear Mr. Beaverson and Selection Committee Members,

On behalf of Murphy + Graves Architects, I would like to express our interest in the new elementary school project issued by the Spencer County Board of Education. Our professionals have been completing state-of-the-art educational buildings throughout the Commonwealth for more than 20 years and continue to maintain an unrivaled standard of excellence in our work. We are more than just an architectural design firm - we are industry leaders that take pride in offering our clients the highest caliber of service while producing cost-effective, student-focused facilities.

With expanding curriculum and evolving technology, the educational needs of today's students are constantly transforming. In order to meet these demands, it is more important than ever for Spencer County to have facilities that support academic excellence by being adequate in size and amenities, as well as flexible for future growth. From programming that engages staff and parents to an environment that promotes learning, creativity and healthy development, the new elementary school should be designed to serve the community for generations to come. Thus, an intricate understanding of elementary educational operations, familiarity with local and state regulations, as well as an unwavering dedication to achieving your unique vision are all vital to this project.

Our success is based on a reputation for quality and reliability, as well as a consistent track record of providing realistic, effective and sustainable solutions to each client. We recognize the impact a project of this nature will have on the community, and would be honored to assist in creating a foundation for its success. We truly appreciate the opportunity to submit this letter of interest and look forward to receiving more information about your project.

Sincerely,

Timothy A. Murphy, A.I.A., LEED AP
Principal
Murphy + Graves Architects
Tim@murphygraves.com

