



Peck Flannery Gream Warren Architects, LLC

112 North Main St.
Phone: 270-765-2147

Elizabethtown, Kentucky 42701
Fax: 270-765-2148

March 8, 2012

Nannette Johnston
Hardin County Board of Education
65 W.A. Jenkins Rd.
Elizabethtown, KY 42701

RE: March 2012
Hardin County Schools
(Report of Projects in Progress)

Dear Nannette:

Please consider the following as a report on projects which our firm is presently providing Architecture/Engineering services. I have one action item for board review/approval (Central Hardin Phase III HVAC Renovations).

1. NORTH HARDIN HIGH SCHOOL – PHASE 5
The two north tennis courts are complete. All new sports lighting and poles for all four courts have been installed. The two south tennis courts and completion of landscaping work are to be addressed pending appropriate weather.
2. JOHN HARDIN HIGH SCHOOL - Baseball/Softball Restroom/Concession Facility
Items remaining this project consist of review of suitable growth of grass in the spring, associated landscaping work and completion of closeout documents.
3. RENOVATIONS OF VINE GROVE ELEMENTARY SCHOOL
Phase 2.6 work is in progress. Attached are colored drawings showing phases 2.6 to 2.11. Those areas not colored have been addressed but in most cases require some additional and/or remedial work. The bulk of the remedial work is scheduled for this coming summer. Mark McNutt reports that Phase Two (colored areas remaining) will be complete by May 31.

Additionally, the major portion of the mezzanine level has been completed.

4. CENTRAL HARDIN HIGH SCHOOL PHASE III HVAC RENOVATIONS
Approval of construction documents is requested for this project under the action items.

5. NORTH HARDIN PHASE 6

Floor plans for the band, choral areas and site portions of the project are being finalized. Construction documents for these areas are in progress. Agriculture shop areas programming and floor plans, at present, have not been finalized.

Please give me a call if you have questions regarding this report.

Sincerely,

A handwritten signature in dark ink, appearing to read 'Larry Gream', with a stylized, flowing script.

Larry Gream

C: Gary Milby
David Wyatt

AREA "A" (SEE SHEET A1.2)

2.11 ROOMS
132/132A/133

2.6 ROOM
120

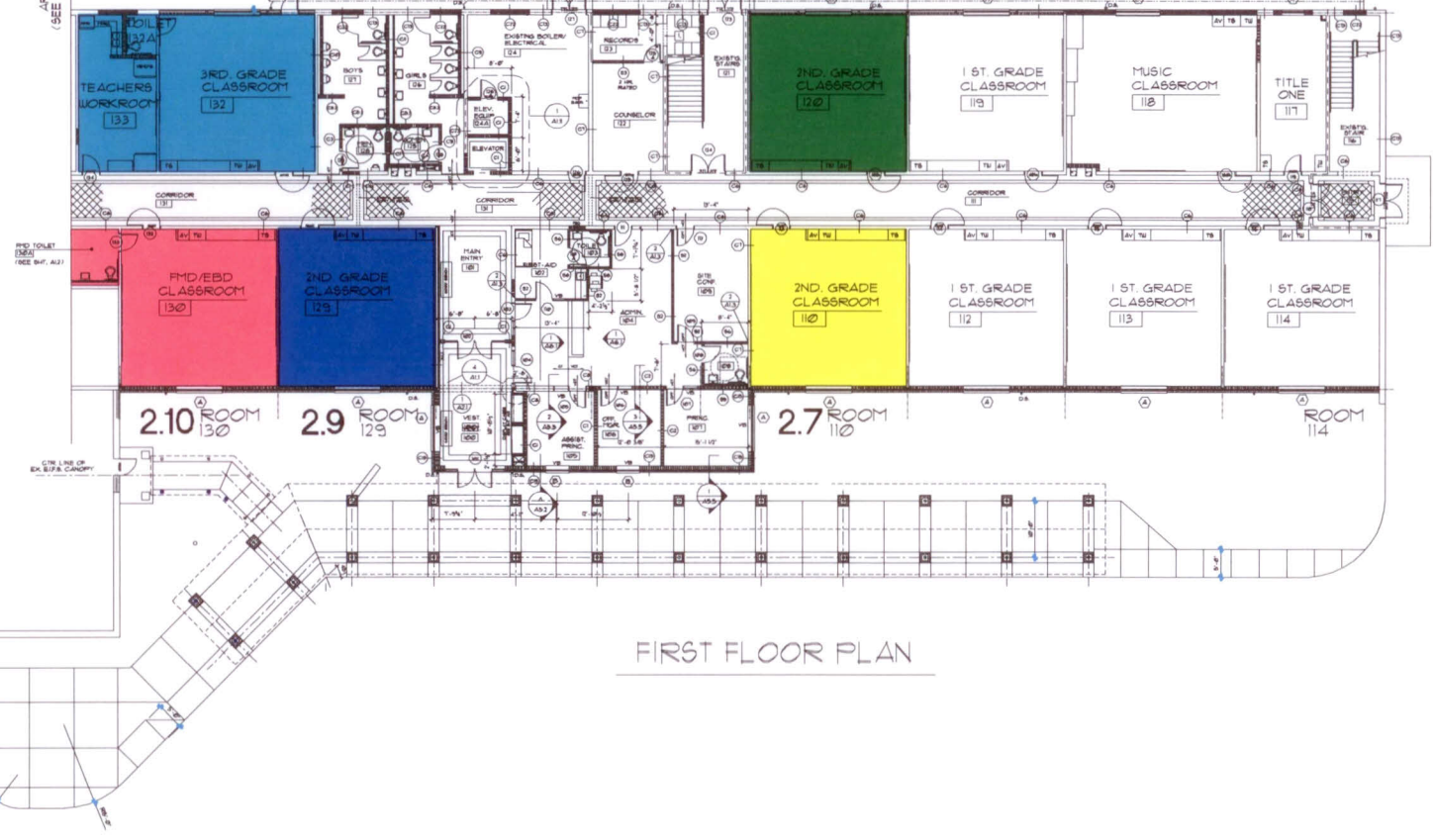

FIRST FLOOR PLAN



PECK FLANNERY GREAM WARREN
ARCHITECTS, LLC
112 NORTH MAIN STREET, LOUISVILLE, KENTUCKY 40202

PROJECT NO.	2011
DATE REVISED	11/11/11
DESIGNED BY	JOS
PROJECT DATE	11/11/11

AREA "A" PARTIAL FIRST FLOOR PLAN
2011 RENOVATIONS VINE GROVE ELEM
HARDIN COUNTY SCHOOL BOARD
204 FIRST STREET
VINE GROVE, KENTUCKY

A1.1



ENLARGED SECOND FLOOR PLAN

2011 RENOVATIONS VINE GROVE ELEM.
HARDIN COUNTY SCHOOL BOARD
000 FIRST STREET
VINE GROVE, KENTUCKY

A1.3