

# FACPAC Contract Change Order

## Supplemental Information Form (Ref# 63909)

Form Status: Saved

Tier 1 Project: CHHS Phase 2

BG Number: 23-403

Status: Active

District: Hardin County (HB678) (231)

Phase: Project Initiation (View Checklist)

Contract: Advanced Electrical Systems, Inc., 0015, Electrical

Type: CM Bid Package

Proposed

Change Order Number

15-5

Time Extension Required

No

Date Of Change Order

12/12/2025

Change Order Amount To Date

Increase

### Construction Contingency

Calculations below are project wide. Remaining negative Construction Contingency may require the submission of a revised BG1.

|                              |                |
|------------------------------|----------------|
| Current Approved Amount      | \$2,026,223.39 |
| Net Approved COs             | \$77,164.09    |
| Remaining After Approved COs | \$1,949,059.30 |
| Net All COs                  | \$309,332.15   |
| Remaining After All COs      | \$1,716,891.24 |

This Requested Change Order Amount \$3,514.82  
+/-

Change In A/E Fee This Change Order \$165.19  
+/-

Change In CM Fee This Change Order \$56.23  
+/-

Remaining Construction Contingency  
Balance

Contract Change Requested By

Architect/Engineer; Local Board of Education

Contract Change Reason Code

Expansion of Scope

Change Order Description And Justification

In accordance with PR #029 and the attached contractor pricing, contractor shall provide all required labor material and equipment required to complete this work as it relates to their particular scope.

Cost Benefit To Owner

Contract unit prices have been utilized No  
to support the cost associated with this

change order.

Detailed Cost Breakdown

Contract unit prices have not been utilized, provide a detailed cost breakdown which separates labor, material, profit and overhead.

| Detail Item   | Amount     | Percent of Total |
|---|------------|------------------|
| Labor   | \$2,328.25 | 66.24%           |
| Materials   | \$1,117.65 | 31.80%           |
| Profit and Overhead   |            | 0.00%            |
| Bond Insurance  | \$68.92    | 1.96%            |
| Cost Breakdown Total:   | \$3,514.82 |                  |
| Cost for this Change Order supported by an alternate bid or competitive price quote | No         |                  |
| Explain Why   |            |                  |

Change Order Supplemental Information Form Signature  
Page (Online Form Ref# 63909)



D. Robert Deal  
2025.12.15 10:53:46-05'00'

Architect

Date



12/15/2025

Construction Manager

Date

Finance Officer

Date

Local Board of Education Designee

Date



# AIA<sup>®</sup> Document G701/CMa<sup>™</sup> – 1992

## Change Order - Construction Manager-Adviser Edition

OWNER ☒  
 CONSTRUCTION MANAGER ☐  
 ARCHITECT ☐  
 CONTRACTOR ☐  
 FIELD ☐  
 OTHER ☐

**PROJECT** (Name and Address)  
 CENTRAL HARDIN HS PHASE II  
 3040 LEITCHFIELD ROAD  
 CECILIA, KY 42724

**CHANGE ORDER NUMBER:** 15-5  
**INITIATION DATE:** 12/12/2025

**TO CONTRACTOR** (Name and Address)  
 ADVANCED ELECTRICAL SYSTEMS,

**PROJECT NUMBERS:** 000826  
**CONTRACT DATE:** 1/29/2024  
**CONTRACT FOR:** BID PACKAGE #15-ELECTRICAL

**THE CONTRACT IS CHANGED AS FOLLOWS:** In accordance with PR #029 and the attached contractor pricing, contractor shall provide all required labor material and equipment required to complete this work as it relates to their particular scope.

|  |              |
|--|--------------|
| The original Contract Sum was  | 6,415,909.60 |
| Net change by previously authorized Change Orders                        | 12,496.85    |
| The Contract Sum prior to this Change Order was                          | 6,428,406.45 |
| The Contract Sum will be Increased by this Change Order in the amount of | 3,514.82     |
| The new Contract Sum including this Change Order will be                 | 6,431,921.27 |

The Contract Time will be adjusted by 0 days.  
 The date of Substantial Completion as of the date of this Change Order therefore is 12/1/2026.

### NOT VALID UNTIL SIGNED BY THE CONSTRUCTION MANAGER, ARCHITECT, CONTRACTOR AND OWNER.

CODELL CONSTRUCTION COMPANY

**CONSTRUCTION MANAGER** (Firm Name)  
 4475 ROCKWELL ROAD WINCHESTER, KY 40391

**ADDRESS**

BY (Signature)

(Typed Name)

DATE:

ADVANCED ELECTRICAL SYSTEMS,

**CONTRACTOR** (Firm Name)

**ADDRESS**

BY (Signature)

(Typed Name)

DATE:

JRA ARCHITECTS

**ARCHITECT** (Firm Name)  
 301 EAST VINE STREET LEXINGTON, KY 40507

**ADDRESS**

D. Robert Deal  
 2025.12.15 10:53:57-05'00'

BY (Signature)

(Typed Name)

DATE:

HARDIN COUNTY BOARD OF EDUCATION

**OWNER** (Firm Name)  
 65 W. A. JENKINS ROAD ELIZABETHTOWN, KY 42701

**ADDRESS**

BY (Signature)

(Typed Name)

DATE:

**AIA**<sup>®</sup>**Document G709<sup>™</sup> – 2018****Proposal Request**

**PROJECT:** *(name and address)*  
Central Hardin High School Phase 2  
Elizabethtown, KY

**CONTRACT INFORMATION:**  
Contract For:  
General Construction  
Date:  
10-17-2022

Architect's Project Number: 2019111 Ph 2  
Proposal Request Number: 29  
Proposal Request Date: 10-29-2025

**OWNER:** *(name and address)*  
Hardin County Board of Education  
65 W. A. Jenkins Road  
Elizabethtown, KY 42701

**ARCHITECT:** *(name and address)*  
JRA Architects  
301 E. Vine Street  
Lexington, KY 40507

**CONTRACTOR:** *(name and address)*  
Codell Construction Company  
4475 Rockwell Rd.  
Winchester, KY 40391

The Owner requests an itemized proposal for changes to the Contract Sum and Contract Time for proposed modifications to the Contract Documents described herein. The Contractor shall submit this proposal within ( 0 ) days or notify the Architect in writing of the anticipated date of submission.

*(Insert a detailed description of the proposed modifications to the Contract Documents and, if applicable, attach or reference specific exhibits.)*

The owner would like to remove 2 display cases and turn them into closets.

Provide pricing for demolition of the sliding window, CMU below and bottom of display case. Provide a 3'-0" by 7'-2" single "Type F" wood door with hollow metal frame.

Match door hardware on H215A door. Infill with CMU as required.

Match adjacent finishes and paint interior of room P-1, add B-1 rubber base, RT-1 rubber flooring and add light fixture.

**THIS IS NOT A CHANGE ORDER, A CONSTRUCTION CHANGE DIRECTIVE, OR A DIRECTION TO PROCEED WITH THE WORK DESCRIBED IN THE PROPOSED MODIFICATIONS.**

**REQUESTED BY THE ARCHITECT**

  
\_\_\_\_\_  
**ARCHITECT** *(Signature)*

BY: D. Robert Deal, AIA, President

\_\_\_\_\_  
*(Printed name, title, and license number if required)*

DOIO

H116

H114

EMR

H114

H111

EVATOR

EL-3

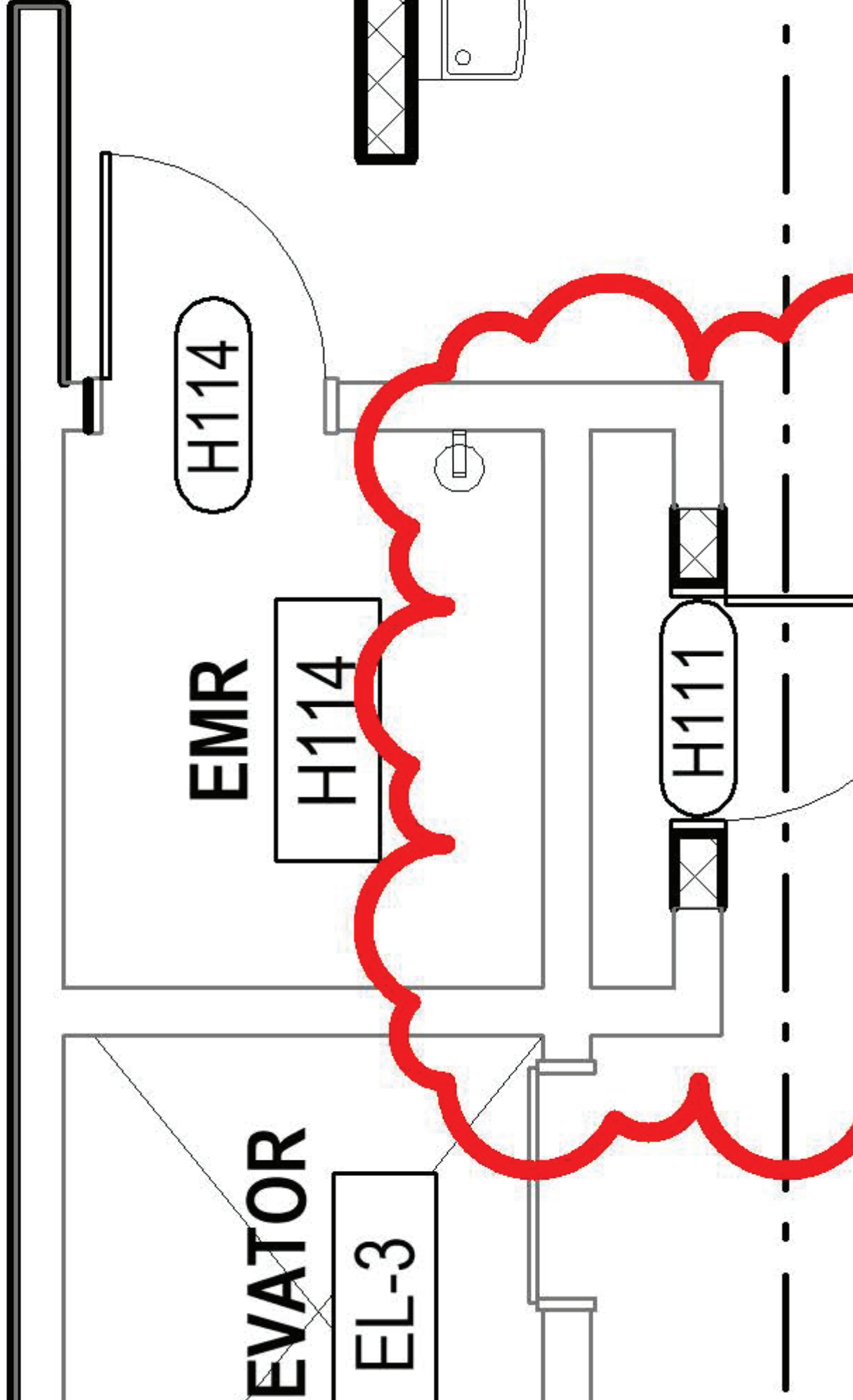



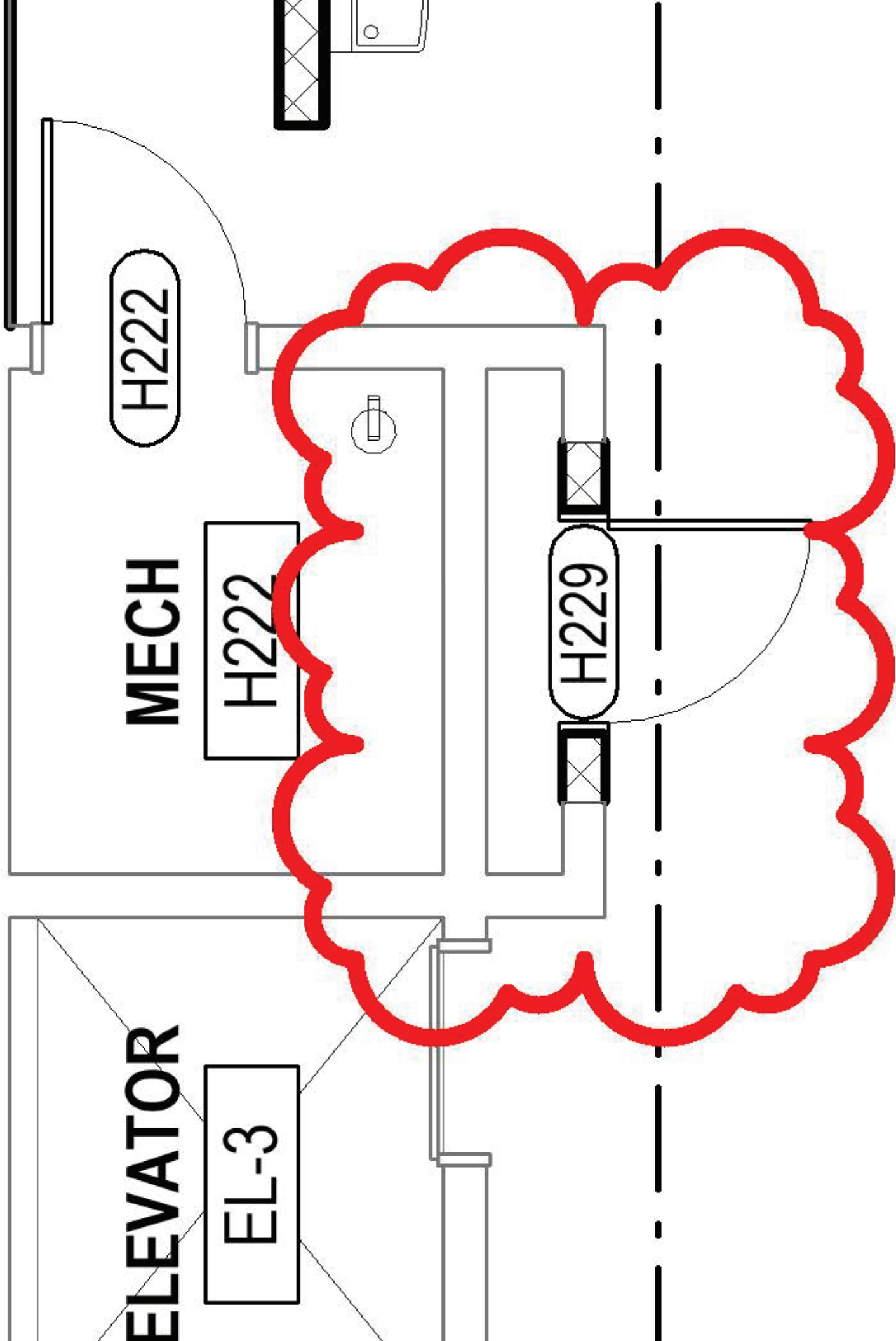



**ADVANCED ELECTRICAL SYSTEMS, INC.**  
**(502) 962-1102 Fax (502) 962-8836 www.aeslou.com**

**POWERING THE FUTURE!**

PO Box 36503 Louisville, KY 40233-6503  
 3312 Gilmore Industrial Blvd. Louisville, KY 40213

## Change Order Summary

Time & Material Summary:  
 Lump Sum: **X**

### Description of work:

**PR29 - Add (1) F1 light fixture in each of (2) new closets**

\*Light type not specified, we have quoted an F1 fixture  
 \*No lighting controls included  
 \*Lights will tie into closest circuit and operate off internal motion sensor

| DESCRIPTION               | Material  | Labor       |
|---------------------------|-----------|-------------|
| Misc Material             | \$ 265.28 | \$ 2,328.25 |
| Quote Fixtures            | \$ 438.40 | \$ -        |
| Fuel Surcharge - \$95     | \$ 95.00  | \$ -        |
| Material delivery - \$125 | \$ 125.00 | \$ -        |
| Subtotal Material & Labor | \$ 923.68 | \$ 2,328.25 |

| DEDUCT          | Material | Labor  |
|-----------------|----------|--------|
|                 | \$0.00   | \$0.00 |
| Subtotal Deduct | \$0.00   | \$0.00 |

| Labor Rate Calculations |       |           |            |  |
|-------------------------|-------|-----------|------------|--|
| CLASSIFICATION          | HOURS | RATE      | LABOR COST |  |
| AGF ST                  |       | \$ 98.25  | \$0.00     |  |
| Gen. F-man ST           | 0     | \$ 96.50  | \$0.00     |  |
| Foreman ST              | 2     | \$ 92.25  | \$184.50   |  |
| Journeyman ST           | 25    | \$ 85.75  | \$2,143.75 |  |
| Apprentice ST           | 0     | \$ 64.75  | \$0.00     |  |
| AGF TH                  | 0     | \$ 145.55 | \$0.00     |  |
| Gen. F-man TH           | 0     | \$ 141.75 | \$0.00     |  |
| Foreman TH              | 0     | \$ 127.45 | \$0.00     |  |
| Journeyman TH           | 0     | \$ 118.85 | \$0.00     |  |
| Apprentice TH           | 0     | \$ 87.25  | \$0.00     |  |
| AGF DT                  | 0     | \$ 171.25 | \$0.00     |  |
| Gen. F-man DT           | 0     | \$ 165.25 | \$0.00     |  |
| Foreman DT              | 0     | \$ 160.25 | \$0.00     |  |
| Journeyman DT           | 0     | \$ 148.25 | \$0.00     |  |
| Apprentice DT           | 0     | \$ 108.50 | \$0.00     |  |
| Safety                  | 0     | \$ 112.25 | \$0.00     |  |
| Other                   | 0     |           | \$0.00     |  |
| Subtotal Labor          | 27    |           | \$2,328.25 |  |

| Subcontractors          |    |   |
|-------------------------|----|---|
|                         |    |   |
| Subtotal Subcontractors | \$ | - |

| Equipment Rental (including tax) |    |   |
|----------------------------------|----|---|
|                                  |    |   |
| Subtotal Equipment Rental        | \$ | - |

**CUSTOMER ACCEPTANCE & AUTHORIZATION TO PROCEED WITH CHANGE ORDER :**

SIGNATURE TITLE DATE

PRINTED NAME CONTRACT / PO NUMBER

AES Change Order No. **10**  
 Contractor: **Advanced Electrical Systems, Inc.**  
 Date: **November 18, 2025**  
 Revision:  
 AES Job No.  
 Cust. Contract No.

Cust. RFP No.: **PR29**  
 Additional Days:  
 SWO #:  
 Clarification: **Price Valid for 30 Days**

## BID SUMMARY

|                             |    |                 |
|-----------------------------|----|-----------------|
| Material Cost               | \$ | 923.68          |
| Material Mark-up 15.0%      | \$ | 138.55          |
| Tax 6.0%                    | \$ | 55.42           |
| <b>Total Material Costs</b> | \$ | <b>1,117.65</b> |

|                                  |    |          |
|----------------------------------|----|----------|
| Sub Contractor Costs             | \$ | -        |
| Sub Contractor Mark-up 7.5%      | \$ | -        |
| <b>Total Sub Contractor Cost</b> | \$ | <b>-</b> |

|                                |    |          |
|--------------------------------|----|----------|
| Equipment Rental               | \$ | -        |
| Equipment Rental Mark-up 15.0% | \$ | -        |
| <b>Total Equipment Cost</b>    | \$ | <b>-</b> |

|                         |    |                 |
|-------------------------|----|-----------------|
| Labor Cost              | \$ | 2,328.25        |
| Markup on Labor         | \$ | -               |
| <b>Total Labor Cost</b> | \$ | <b>2,328.25</b> |

|                          |    |                 |
|--------------------------|----|-----------------|
| Subtotal Add Cost        | \$ | 3,445.90        |
| Bond Included 2.0%       | \$ | 68.92           |
| <b>Total CO Add Cost</b> | \$ | <b>3,514.82</b> |

|                             |          |
|-----------------------------|----------|
| Material Deduct             | -        |
| Tax on Deduct Material 6.0% | -        |
| Labor Deduct                | -        |
| Subcontractor Deduct        | -        |
| Equipment Rental Deduct     | -        |
| Subtotal                    | -        |
| Bond Included 2.0%          | -        |
| <b>Total CO Deduct Cost</b> | <b>-</b> |

**Change Order Total: \$ 3,514.82**



| Quantity   | Item Name                  | Price      | Ext Price | ...Labor... | Ext Labor... |
|--|----------------------------|------------|-----------|-------------|--------------|
| Combined->Combined->Combined->Combined->Combined |                            |            |           |             |              |
| Lighting Fixtures                                |                            |            |           |             |              |
| 2.00   | F1                         | \$0.00 Q   | \$0.00    | 1.36 E      | 24.37        |
| Branch Conduit                                   |                            |            |           |             |              |
| 100.00   | 3/4" EMT Conduit           | \$116.09 C | \$116.09  | 8.26 C      | 2.71         |
| 8.00   | 3/4" EMT/CMPI Connector    | \$54.29 C  | \$4.34    | 0.35 E      | 12.86        |
| 10.00  | 3/4" EMT/CMP Coupling      | \$59.88 C  | \$5.99    | 0.18 E      | 8.26         |
| Branch Roughin                                   |                            |            |           |             |              |
| 2.00   | 4" Sq 2-1/8"d 3/4" KO      | \$244.97 C | \$4.90    | 0.35 E      | 2.83         |
| 2.00   | 4" Sq Blank Cover          | \$165.18 C | \$3.30    | 9.44 C      | 1.77         |
| Conduit Support                                  |                            |            |           |             |              |
| 4.00   | 1/4" Steel Beam Clamp      | \$385.37 C | \$15.41   | 11.80 C     | 0.90         |
| Generic Supports                                 |                            |            |           |             |              |
| 2.00   | Gen /Supp 4' wall mount    | \$12.00 E  | \$24.00   | 1.18 E      | 0.71         |
| 14.00  | 3/4" EMT Generic/Supp      | \$145.74 C | \$20.40   | 7.08 C      | 0.19         |
| Branch Wire                                      |                            |            |           |             |              |
| 300.00   | #12 THHN Copper Stranded   | \$236.12 M | \$70.84   | 8.85 M      | 0.47         |
| Labor Only                                       |                            |            |           |             |              |
| 12.00  | #12ga. Termination (Labor) | \$0.00 X   | \$0.00    | 0.12 E      | 0.47         |
|  |                            |            | \$265.28  |             | 24.37        |



# Quote

**Job Name:** Central Hardin High School Phase II  
**Quote #:** 23-18341-15  
**Quote Label:** Type F1 Adder for (2)  
**Job Location:** Elizabethtown, Kentucky  
**Issue Date:** 11/18/2025  
**Good Through:** 2/28/2025  
**Quoted By:** Age, Damon

**LHI LIGHTING SALES INC**  
3943 CENTRAL AVENUE  
LOUISVILLE, KY 40218-2648  
(Phn) 502-964-9661  
(Fax) 502-964-7155

**Quoted To:** AES  
PO Box 36503  
Louisville, KY 40233

| Type                  |  | Qty | Manufacturer / Brand  |  | Catalog #                            | Line Comment | Unit \$  | Ext \$   |
|-----------------------|--|-----|-----------------------|--|--------------------------------------|--------------|----------|----------|
| F1                    |  | 2   | ABL-Lithonia Lighting |  | BLWP4 48L ADPT EZ1 LP850 N100 NESPD7 |              | \$219.20 |          |
| Subtotal              |  |     |                       |  |                                      |              |          | \$438.40 |
| PLUS FREIGHT          |  |     |                       |  |                                      |              |          |          |
| Grand Total: \$438.40 |  |     |                       |  |                                      |              |          |          |
| Notes                 |  |     |                       |  |                                      |              |          |          |

\* \*\*\* All quotes from Acuity Brands Lighting, Inc. ("ABL") are valid for 30 days from issue date, unless otherwise indicated through the ABL Expiration Date specified on the Quote. All quotes are subject to ABL's Standard Terms and Conditions as well as to its Standard Product Warranty Terms (Complete warranty terms located at [www.acuitybrands.com/CustomerResources/Terms\\_and\\_conditions.aspx](http://www.acuitybrands.com/CustomerResources/Terms_and_conditions.aspx)). Any request for terms and conditions and/or product warranty that differ from ABL's Standard Terms and Conditions and/or Standard Product Warranty terms, must be communicated separately to ABL for our consideration, quotation and approval. Any deviations (including any associated costs) not quoted and approved by ABL in advance will be the responsibility of the agency.